

**Welcome to
“March Madness”
at the Boca Grande Marina**

March 20-22, 2017



Cruise Leaders:

**Jan & Ron Austin
Sandy & Jerry Houlder**

March 20-22
Monday to Wednesday



Cruise Leaders Contact Information:

Ron's cell phone: 310-600-0102
Jan's cell phone: 310-503-0999
Sandy's cell phone: 239-281-2625

Getting there:

N 26° 44.832 W 82° 15.378

Hail Boca Grande Marina on VHF Channel 16 as you turn into the channel from the Intracoastal Waterway and they will help guide you through the Day Markers into the marina.

They are located approximately 1½ miles North of Boca Grande Pass & approximately 6 miles South of the Gasparilla Island Causeway.

Their channel entrance is located between Red Marker "2" and Green Marker "3" on the Intracoastal Waterway. Find Flashing Green "1" Day Marker and leave it to port, then follow the Day Markers through the channel.

CAUTION: SHOAL – DO NOT CUT FLASHING GREEN "7"

Proceed one boat length beyond Flashing Green "7" before turning port and favor the sea wall as you approach the marina, located just ahead on your starboard side.

Additional information regarding the marina can be found on their website:

http://www.bocagrandemarina.net/Home_JEBN.html

The dockmaster at Boca Grande Marina is Susan Lomas. She has asked that the cruise leaders be the only person contacting her regarding the cruise. Any additions, cancellations, golf cart requests, changes or questions must be directed through the cruise leaders.

Check-in time is 12:00 pm. Cruise leaders may be able to coordinate earlier arrivals with the dockmaster. Upon arrival at the marina please call the dockmaster on Channel 16 to request your slip assignment. A layout of the marina slips is included in the guide for your convenience.

Rate is \$2.75 per foot for single/double 30 amps or single 50 amps. Includes Wi-Fi Internet, BBQ grills & picnic area, clean restrooms, showers, laundry facilities & a pump-out station.

Cancellation Policy:

The marina has a 24-hour cancellation policy. Should you need to cancel please notify your cruise leaders at least 24-hours prior to the morning of your arrival. If cancellation is made the morning of arrival, vessels will be changed for 1 night's dockage.

Cruisers

Name	Boat Name	Cell Phone #
Jan & Ron Austin	Janine Marie	310-600-0102
Sandy & Jerry Houlder	Moonshadow	239-281-2625
Alina & Harvey Steele	Steele Away	239-671-8887
Gail & Hal West	West Wind	763-360-7445
Shirley & Ed Hatter	Mad Hatter	239-851-1084
Debbie & Bill Lussier	Marlin Striker	207-703-8862
Kerry & Rob Howard	Li'l Sum'n Sum'n	720-490-6199
Kris & Rich Weiner	Utopia	239-910-6133
Lindsey & Rick Scheinert	Rock On	239-464-8753
Fran & Dave Cooke*	Sea Sleigh	239-224-0632
Sandy & Al Fager	Allesandra at Sea	920-323-2206

*Guests on Sea Sleigh: John Darcy & Trish Ballantyne

Cruise Agenda

Monday, March 20th

Arrival time: Arrival time at the Boca Grande Marina is 12:00 noon.

Your cruise leaders will be there to greet you with a surprise to start off the cruise. Afternoon is on your own to enjoy the island.

Golf carts have been arranged for the members that requested them. They can be picked up when you sign-in at the ship store.

The evening event will be the start of our “March Madness” celebration. We will be on the marina dock eating around the picnic tables. Your cruise leaders are grilling the main course for dinner preparing hamburgers, turkey burgers and bratwurst with all the fixings! Please bring your favorite “basketball game goodies” to share!

The attire for our dinners (and the whole cruise) is to show support for your team – whether they made the play-offs or not. Wear their jersey, hat, shorts or anything that feels good!

5:30 pm Cocktails and appetizers

- Bring your own drink(s)

Appetizers to be brought by:

- Alina & Harvey Steele
- Fran & Dave Cooke

6:30 pm March Madness Dinner

- Cruise leaders are doing the grilling!
- Plates, napkins, utensils, etc. will be provided

Side dishes to be brought by:

- Shirley & Ed Hatter (Ed’s Caesar Salad!)
- Kris & Rich Weiner
- Sandy & Al Fager
- Debbie & Bill Lussier

Dessert to be brought by:

- Kerry & Rob Howard
- Jan & Ron Austin

Tuesday, March 21st

We are planning to make the games a bit more fun by placing some bets on Tuesday's games over breakfast. Bring your \$\$\$ to join in on the fun! You could be the big winner.

9:00 am Breakfast on the dock

- Come for Jerry's famous freshly made pancakes
- And for Ron's equally famous cooked-to-order eggs
- Bacon, bagels & fixings, yogurt and sweet rolls will be provided
- Bring your own coffee

Fruit for breakfast to be provided by:

- Lindsey & Rick Scheinert

5:30 pm Docktails – on the dock

6:30 pm **Group dinner at Eagle Grille**

- Private room at the restaurant
- Order off the menu
- **Wide screen TV in the room to watch the games! Payouts will be after dinner!**

Wednesday, March 22nd

Leave the beautiful Boca Grande Marina before the 11:00 am check-out and head for home. Thanks for joining us and safe travels!

We hope that you had a great time!

Jan & Ron

Sandy & Jerry

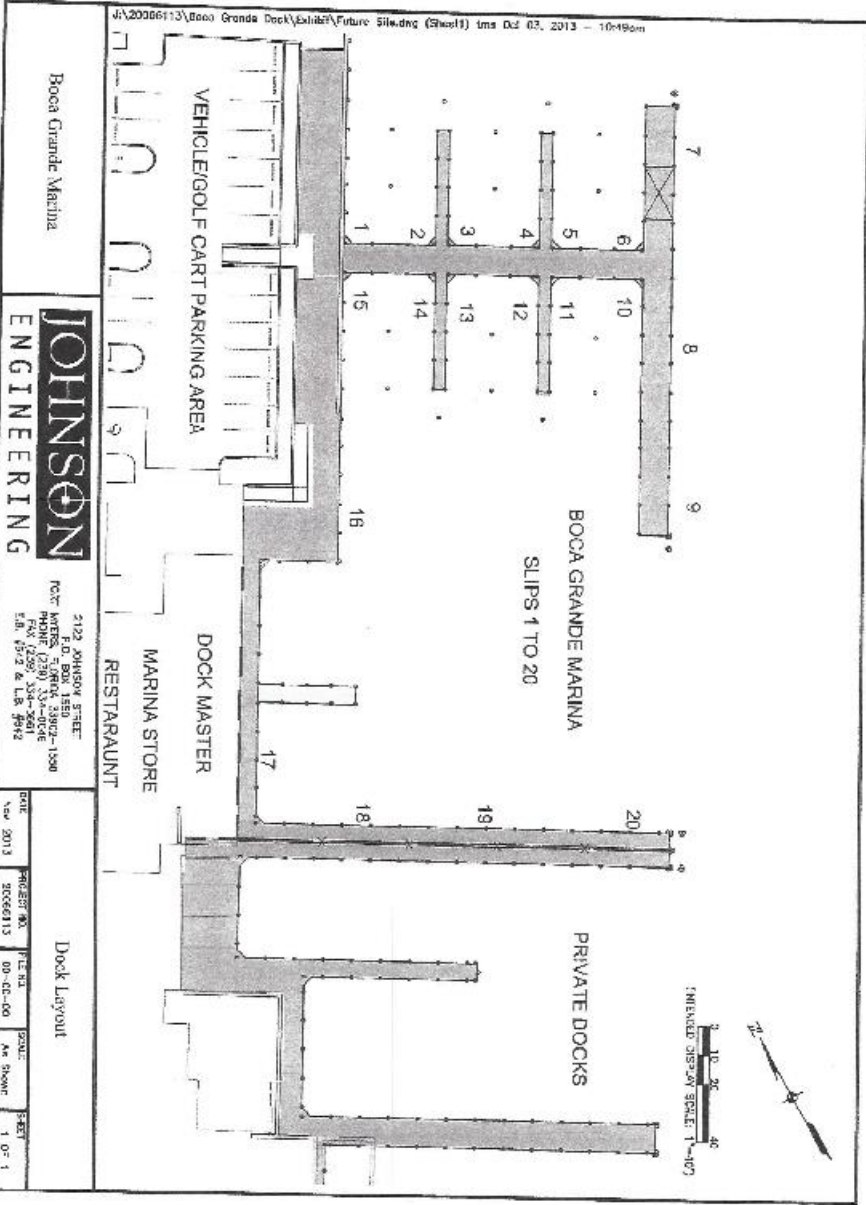

Boca Grande Marina

JOHNSON
ENGINEERING

2122 JOHNSON STREET
P.O. BOX 1838
BOCA GRANDE, FL 33909
TEL: (239) 334-2661
FAX: (239) 334-2661
E-MAIL: J@JOHNSON-ENG.COM

Project No. 20066113
Date 09-03-13
Scale 1" = 100'
Sheet 1 of 1