

Ohio Historic Preservation Office
 1985 Velma Avenue
 Columbus Ohio 43211
 614-466-1500



OHIO HISTORIC INVENTORY

| | | |
|---|--|--|
| 1. No. ERI-1573 2. County ERIE 3. Location of Negatives O.H.S. | 4. Present Name(s) <p style="text-align: center;">Island House Restaurant</p> 5. Other Name(s) <p style="text-align: center;">Henry Trieschman House</p> | 1. No. ERI-1573 2. County Erie 4. Present Name(s) Island house Restaurant 5. Other Name(s) Henry Trieschman House |
| 6. Specific Location West side of Division St., first house south of the stone school | 16. Thematic Category Ethnic, commerce, agric, mf | 28. No. of Stories 2 1/2 |
| 7. City or Town If Rural, Township & Vicinity Kelleys Island, Ohio | 17. Date(s) or Period 1876 | 29. Basement? 1/2 Yes <input checked="" type="checkbox"/> No <input type="checkbox"/> |
| 8. Site Plan with North Arrow | 18. Style or Design Italianate; Folk Victorian | 30. Foundation Material l.s. rubble & ashlar |
| 9. U.T.M. Reference 117 357430 4606060 a Easting Northing Site <input type="checkbox"/> Structure <input type="checkbox"/> Building <input checked="" type="checkbox"/> Object <input type="checkbox"/> | 19. Architect or Engineer - | 31. Wall Construction Wood frame |
| 11. On National Register? Yes <input type="checkbox"/> No <input checked="" type="checkbox"/> | 20. Contractor or Builder - | 32. Roof Type & Material Gable & truncat. hip/asph shp |
| 12. Is it Eligible? Yes <input checked="" type="checkbox"/> No <input type="checkbox"/> | 21. Original Use, if apparent Residence | 33. No. of Bays Front Side |
| 13. Part of Estab. Hist. Dist.? Yes <input type="checkbox"/> No <input checked="" type="checkbox"/> | 22. Present Use Restaurant | 34. Wall Treatment Weather Board/Bevel Bd |
| 14. District Potent'? Yes <input checked="" type="checkbox"/> No <input type="checkbox"/> | 23. Ownership Public <input type="checkbox"/> Private <input checked="" type="checkbox"/> | 35. Plan Shape irregular |
| 15. Name of Established District N/A | 24. Owner's Name & Address, if known Daniel J. Fresch 1214 Erie Blvd. Sandusky, Ohio 44870 | 36. Changes (Explain in #42) Addition <input checked="" type="checkbox"/> Altered <input type="checkbox"/> Moved <input type="checkbox"/> |
| 42. Further Description of Important Features (Continue on reverse if necessary). This substantial house exhibits three apparent episodes of construction. (A) The initial structure is the building's main block and consists of a front-gabled, 3-bay facade with 2 side bays and a rubble limestone foundation. The moderately pitched roof has a central brick chimney and is set-off by wide, overhanging eaves with pronounced cornice returns. Windows are all 2/2 with louvered shutters and are capped by triangular pediments decorated with a | 25. Open to Public? Yes <input checked="" type="checkbox"/> No <input type="checkbox"/> | 37. Condition Interior Good Exterior Exc. |
| 43. History and Significance This house was built in 1876 by Henry Trieschman. Born in 1843, Mr. Trieschman and his wife, Katherine, had emigrated from Hesse, Germany, to Sandusky, Ohio, and, with his brother, John, entered the butcher business. Henry and Katherine came to Kelleys Island a short time later, for the 1870 census shows Henry and Katherine and their 6 month old son, Albert, living in the home of Jake Hay (PR-357), and working as a butcher. His shop on | 26. Local Contact Person or Organization Kevin Pape: KI.Hist.Survey | 38. Preservation Underway? Yes <input checked="" type="checkbox"/> No <input type="checkbox"/> |
| 44. Description of Environment and Outbuildings The house is shaded on all sides by large, mature maples and catalpas, with a wooded lot at the rear. A driveway on the north side may once have led to a large barn, not extant. The Southwinds Gift Shop complex lies to the south. A pond to the west was once known as | 27. Other Surveys in Which Included <p style="text-align: center;">N/A</p> | 39. Endangered? By What? Yes <input type="checkbox"/> No <input checked="" type="checkbox"/> |
| Sources of Information Adrich, History of Erie County, 1899. Hill, History of Kelleys Island Census Records, Erie Co, 1874 Atlas Map of Erie Co. Oral Hist: J. Cleary, J. Dualla, Eva Erna, M. McMillan, P. Deborance | 46. Prepared by Betty Pape & Kevin Pape | 40. Visible from Public Road? Yes <input checked="" type="checkbox"/> No <input type="checkbox"/> |
| 48. Date 9/95 | 47. Organization KI.Planning Commission | 41. Distance from and Frontage on Road 46' / 114' x233' |
| 49. Revision Date(s) | | 48. Date 9/95 |



50. House Type No.

Code No. Name

51. Historic Outbuildings and Dependencies

Barn Type(s)

Code No. Type

Corn Crib or Shed Smoke House Privy
 Silo Spring House Carriage House
 Summer Kitchen or Ice House

Other _____

52. Archaeological Site on Property?

Yes Possible location of first KI
 No school.

Basis for Information

Owner Collection
 Above Ground Earthworks or Mound
 Cultural Materials Noted OAI No. Er348

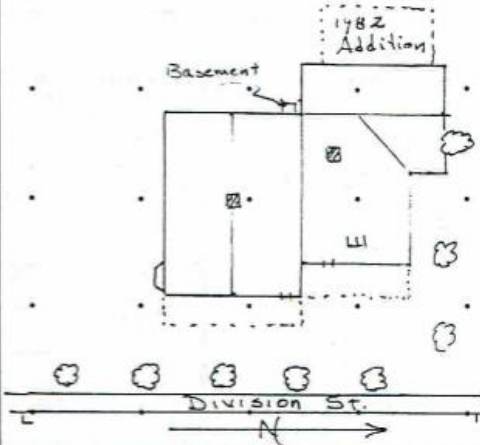

54. Photo

Roll No. 28 Picture No(s) 17, 20-21
16 11-14

43. (Cont'd.)

Division Street (ERI-1563) was already in place by 1874, but it is not clear whether this was already a part of the Huntington store complex (ERI-1562) or was added by Mr. Trieschman. The Trieschmans lived with Jake Hay until this house was built in 1876. Henry operated his own slaughter house on 35 a. of land on Monaghan Rd. which he purchased from Michael Hughes. Here he grazed his cattle which he brought from the mainland each year, either by boat or over the ice, until they were ready for slaughter. Later he purchased the remaining 35 acres of the Hughes farm to the south. This parcel contained the Hughes homestead which he used to house his employees who worked with the cattle and at the slaughter house. In addition to his meat business, Mr. Trieschman also owned 12 acres of vineyards, and was one of the organizers of the Sweet Valley Wine Co. (ERI-1618), and in 1887 became its president. In addition to his business activities, he was active in village affairs, serving as Township Trustee, and member of the School Board. His family of 7 children were also a vital part of the community. Henry, Jr. married Sarah Pringnitz (ERI-1636), built his own home on Woodford Rd. (ERI-1747), and carried on his father's business after Henry Sr's death. His daughter, Clara, married Robert L. Moysey, and served as her father's bookkeeper. Elda and Wesley, children of Henry, Jr., were the third generation to operate the meatmarket.

44. (Cont'd.) Treischman's Pond, is now known as Martin's Pond.

42. scroll emblem. Other trim features include plain frieze, end, and water table boards. Additions and alterations include a 5-sided bay on the south eave wall. It has a shed roof and ashlar foundation and is trimmed with floral brackets & pendants, and set upon a paneled base. The original block & panel columns of the front, shed-roofed porch have been replaced by wrought iron. (B) This section features a truncated hip roof with central brick chimney and a rubble limestone foundation. The street facade consists of 2 bays and has a gabled dormer in the center of the hipped gable. The dormer has two 1/1 windows and its gable end is trimmed with undulating board siding. Windows in this section are all 2/2

OHIO HISTORIC INVENTORY

No. ERI-1573
Erie County

Henry Trieschman House

ERI-1573 ERIE

Island House Restaurant

Henry Trieschman House

42. (Cont'd.)

And except for a different window pediment emblem on the north side, this section has the same trim and porch features as section (A).

(C) A third roofline dimension is created by this section. It features a steeply gabled roof with the same frieze boards and cornice returns described for section (A). Unlike the other two sections, however, this addition is built upon a coursed ashlar foundation. Windows are 2/2 and, on the east elevation, are trimmed as described for section (B); windows on west elevation are not trimmed. (D) This is a 1982, 1-story gabled addition used as kitchen space.

The interior floor plan and trim features are predominantly intact. Remodeling for restaurant use has had minor impact.