

OHIO HISTORIC INVENTORY

1. No. ERI-1658		4. Present Name(s) William Gorchester Property		1. No. ERI-1658	
2. County ERIE		5. Other Name(s) August Schaedler Wine Cellar			2. County Erie
3. Location of Negatives O.H.S.					
6. Specific Location Along eastern section of E. Lake Shore Dr., east of ERI-1654		16. Thematic Category Manufacturing, ethnic		5. Other Name(s) August Schaedler Wine Cellar	
7. City or Town If Rural, Township & Vicinity Kelleys Island		17. Date(s) or Period 1866			6. Present Name(s) William Gorchester Property
8. Site Plan with North Arrow 		18. Style or Design Vernacular		7. Present Name(s) William Gorchester Property	
9. U.T.M. Reference 17 358 610 460 498 0		19. Architect or Engineer -			8. Present Name(s) William Gorchester Property
10. Zone Easting Northing Site <input type="checkbox"/> Building <input checked="" type="checkbox"/> Structure <input type="checkbox"/> Object <input type="checkbox"/>		20. Contractor or Builder Paul Krohmen (?)		9. Present Name(s) William Gorchester Property	
11. On National Register? Yes <input type="checkbox"/> No <input checked="" type="checkbox"/>		21. Original Use, if apparent Winery			10. Present Name(s) William Gorchester Property
12. Is it Eligible? Yes <input type="checkbox"/> No <input checked="" type="checkbox"/>		22. Present Use Vacant		11. Present Name(s) William Gorchester Property	
13. Part of Estab. Hist. Dist.? Yes <input type="checkbox"/> No <input checked="" type="checkbox"/>		23. Ownership Public <input type="checkbox"/> Private <input checked="" type="checkbox"/>			12. Present Name(s) William Gorchester Property
14. District Potent'/? Yes <input type="checkbox"/> No <input checked="" type="checkbox"/>		24. Owner's Name & Address, if known Wm. & Ferne Gorchester, 2085 Coventry Rd., Cleveland Ohio, 44118		13. Present Name(s) William Gorchester Property	
15. Name of Established District N/A		25. Open to Public? Yes <input type="checkbox"/> No <input checked="" type="checkbox"/>			14. Present Name(s) William Gorchester Property
		26. Local Contact Person or Organization Kevin Pape; K.I.Hist Survey		15. Present Name(s) William Gorchester Property	
		27. Other Surveys in Which Included N/A			16. Present Name(s) William Gorchester Property
42. Further Description of Important Features (Continue on reverse if necessary) The remnants of an octagonal cupola and a wide frieze board highlight the roofline. Windows are variously double-hung 6/6, 3/1 and 1/1 and are treated with flat or segmental arches. A likely remodeled double door front entry includes side transom lights under a segmental arch. Stone stairways lead down to arched cellar openings on the north and south which are treated with				17. Present Name(s) William Gorchester Property	
43. History and Significance The August Schaedler Winery is believed to have consisted of this 1866 wine cellar and, later, a second nearby cellar. The storage capacity of the winery was estimated in 1890 at 65,000 gallons. Schaedler produced exclusively still wines such as Catawba and Delaware, and his annual production in 1879 totaled 12,000 gallons.					18. Present Name(s) William Gorchester Property
44. Description of Environment and Outbuildings The winery is located along the island's southeast shore. The August Schaedler residence sits immediately to the west. An arched cistern is located 10 feet south of the cellar's southwest corner. A barn was moved by Sam Myers to rear of winery in 1946. The cellars of 3 other wineries are nearby.				19. Present Name(s) William Gorchester Property	
45. Sources of Information Aldrich, History of Erie County, Ohio Sandusky Newspaper articles; Chas. Frohman Collection, Hayes Presidential Center Sanborn Insurance Map: 1886, 1893					20. Present Name(s) William Gorchester Property
		46. Prepared by Kevin Pape & Kyle Johannsen		21. Present Name(s) William Gorchester Property	
		47. Organization K.I. Planning Commis			22. Present Name(s) William Gorchester Property
		48. Date 8/85 49. Revision Date(s)		23. Present Name(s) William Gorchester Property	



50. House Type No.

Code No. _____

Name _____

53. Farmstead Plan

51. Historic Outbuildings and Dependencies

Barn Type(s)

Code No. _____

Type _____

Corn Crib or Shed
 Silo
 Summer Kitchen

Smoke House,
 Spring House
 or Ice House

Privy
 Carriage House

Other _____

52. Archaeological Site on Property?

Yes
 No

Basis for Information

Owner Collection
 Above Ground Earthworks or Mound
 Cultural Materials Noted

OAI No. _____

54. Photo

Roll No. 20

Picture No(s). 26a

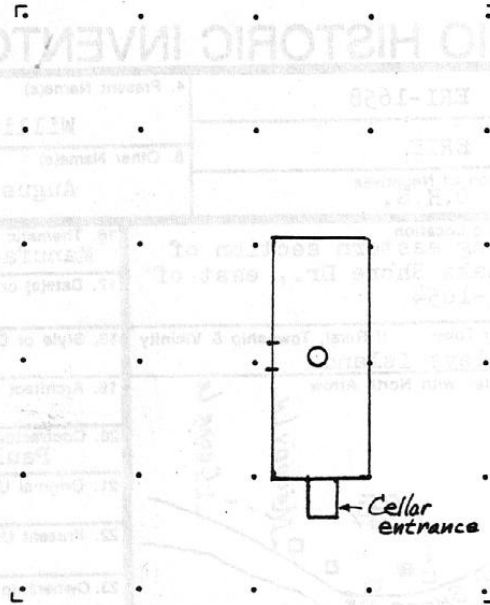

42. (Cont'd)

segmental arches. A date stone under the south gable bears the original owners initials and the year 1866, while a second stone above the north cellar opening lists the year 1866 and possibly the builders name. The cellar itself is of round arched construction with access to the upper levels provided by a centrally located circular opening. Six first floor narrow casement windows have been cut into the originally solid stone east wall.

43. (Cont'd.)

*Myers to the rear of the winery in 1946. The cellar of at least August Schaedler was one of the more successful Kelleys Island grape growers and vintners. His magnificent limestone residence (ERI-1654), built in 1873, was considered to be second on the island only to that of Addison Kelley. Its prominence reflected his prosperity and the success of the wine produced in his cellar. Built in 1866, the cellar was constructed just east of his residence, and had a capacity of 20,000 gallons. The structure's arched limestone basement served as the storage cellar. The first floor contained the pressing facilities and additional storage was maintained in the attic.

August Schaedler, with his brother-in-law, Louis Beatty, purchased the C. B. Wells wine cellar (ERI-1652) sometime prior to 1887. This property was owned by Schaedler but the cellar was known as the Louis Beatty Winery. Schaedler's interest in this second cellar increased his production capacity to 65,000 gallons. After August Schaedler died, his son-in-law, Wm. Vioght, looked after his estate. Around 1900, when the Sweet Valley Wine Co. (ERI-1618) moved its headquarters to Sandusky, Otto Brown and his brother, Louis, along with Frederick Kastning, formed the Union Wine Co. This was managed by the Browns, and their principal facility was the former Chas Wells Cellar (ERI-1652). The Union Wine Co. also owned the Louis Beatty Cellar (ERI-1653). The company enjoyed a prominent national reputation until its demise c.1911. This property was later owned by John Bauman, and known as "Sam's Place". It later belonged to the Ecklers.