



SMP 500hm Connectors

DC to 40GHz

Precision Series

Optimized Performance
Ruggedized Material Construction
Low VSWR & Insertion Loss
Op. Temp -65C to 165C
Allows Axial Misalignment
Excellent Shock & Vibration Performance

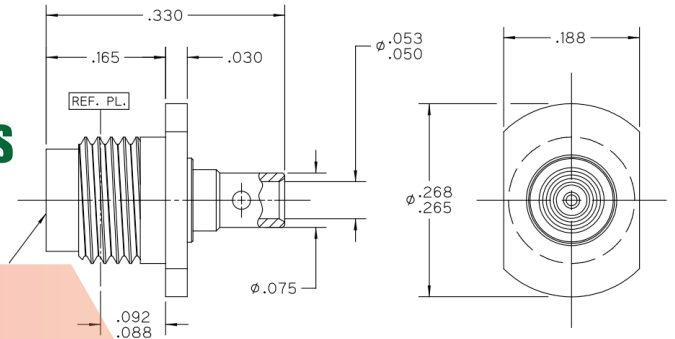

Description	ConductRF #	Frequency
SMP Socket, Female Contact - Direct Solder		
FOR .085-LL CABLE (.264 Long)	PPF11B-A28G01	DC to 40GHz
MITER RT. ANGLE, FOR TEMP-FLEX 047SC-2901	PPF21A-A33G01	DC to 40GHz
STRAIGHT FEMALE FOR 0.047	PPF11A-A33G01	DC to 40GHz
SMP Plug, Males Contact - Direct Solder		
FD, FOR .047-LL SEMI-RIGID (.2665 Flange)	PPM11A-A33G01	DC to 40GHz
BKHD PLUG, FD, FOR .047-LL S/R (.240 SQ Flange)	PPM11B-A33G01	DC to 40GHz
BKHD PLUG, FD/CM, FOR .047-LL S/R CABLE (.240 SQ Flange)	PPM12B-A33G01	DC to 40GHz
BKHD PLUG, SB/CM, FOR TEMP-FLEX 047SC-2901	PPM11C-A33G01	DC to 40GHz
BKHD PLUG, LD/CM, FOR TEMP-FLEX 047SC-2901	PPM12C-A33G01	DC to 40GHz
SMP Receptacles		
PLUG, FD, 2-HOLE FLANGE MOUNT, .030 DIA STUB CONTACT	PPM41A-2HLG01	DC to 40GHz

Images for illustration only, Data subject to change.

