

Technical Specifications

| | |
|------------------------|--|
| Transmitter type: | Crystal controlled 2-stage ("B" suffix denotes 3-stage) |
| Calibration tolerance: | ±2.5kHz |
| Frequency stability: | ±2.5kHz, -20°C to +40°C |
| Pulse rate and width: | Typical on time 20ms, off time 1100ms (controlled by uC) |
| Pulse rate variation: | 0.01%/volt, ±0.01% for temperatures -20°C to +40°C |
| Battery: | Lithium |
| Activation: | By removing magnet |
| Encapsulation: | Electrical resin, water-proof, specific gravity: 1.12 Coated with USP Class VI material |

| MODEL | BATTERY | BATTERY CAPACITY (days) | | | DIMENSIONS (mm) | | | WEIGHT (grams) | PRICE GROUP |
|---------------------|---------------|-------------------------|--------|--------|-----------------|----|----|----------------|-------------|
| | | 35 ppm* | 40 ppm | 55 ppm | A | B | C | | |
| F1810 | 3.5V 10-12 | 110 | 73 | 56 | 12 | 30 | 12 | 7.5 | E |
| F1815 | 10-18 | 250 | 182 | 140 | 12 | 36 | 12 | 8.0 | E |
| F1820 | 10-25 | 362 | 264 | 202 | 12 | 43 | 12 | 9.5 | E |
| F1830 | 10-35 | 500 | 365 | 280 | 12 | 54 | 12 | 11 | E |
| F1835 ⁺ | 1/2AA | 897 | 654 | 502 | 17 | 44 | 15 | 14 | B |
| F1835B ⁺ | 1/2AA | 366 | 249 | 185 | 17 | 48 | 15 | 16 | B |
| F1840 ⁺ | 2/3AA | 1078 | 787 | 603 | 17 | 52 | 15 | 20 | B |
| F1840B ⁺ | 2/3AA | 440 | 300 | 222 | 17 | 56 | 15 | 22 | B |
| F1845 ⁺ | 2/3A | 1510 | 1102 | 845 | 19 | 52 | 15 | 24 | B |
| F1845B ⁺ | 2/3A | 616 | 420 | 311 | 19 | 56 | 15 | 26 | B |
| F1850 ⁺ | AA | 1941 | 1416 | 1086 | 17 | 70 | 15 | 25 | B |
| F1850B ⁺ | AA | 792 | 540 | 400 | 17 | 72 | 15 | 27 | B |
| F1855B ⁺ | C | | 4 YR | 3 YR | 32 | 74 | 17 | 87 | C |
| F1860 ⁺ | D | | 12 YR | 10 YR | 38 | 85 | 17 | 162 | C |
| F1860B ⁺ | D | | 10 YR | 8 YR | 38 | 85 | 17 | 162 | C |

*15 ms pulse width

⁺Bottle shape optional

All models available with high accuracy temperature option, order as F18xxT.

Warranty life is 50% of battery capacity, maximum of two years.

470 First Ave. No. • Isanti, MN 55040
763.444.9267 • fax:763.444.9384 • sales@atstrack.com • www.atstrack.com

FISH IMPLANT

Triton Series F1800C Coded

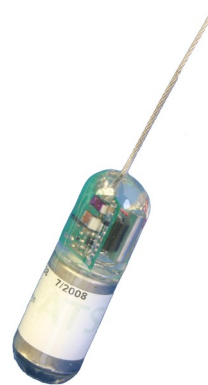
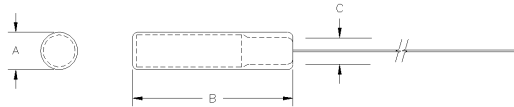

Technical Specifications

| | |
|------------------------|---|
| Transmitter type: | Crystal controlled 2-stage |
| Calibration tolerance: | ±2.5kHz |
| Frequency stability: | ±2.5kHz, -20°C to 40°C |
| Pulse rate and width: | Typical pulse train 20, 5, 5 ms (controlled by uC) |
| Pulse rate variation: | 0.01%/volt, ±0.01% for temperatures -20°C to 40°C |
| Battery: | Lithium |
| Activation: | By removing magnet |
| Encapsulation: | Electrical resin, water-proof, specific gravity: 1.12 |

| MODEL | BATTERY | BATTERY CAPACITY (days)* | | DIMENSIONS (mm) | | | WEIGHT (grams) | PRICE GROUP |
|---------------------|---------|--------------------------|----------|-----------------|----|----|----------------|-------------|
| | | 12 ppm | 30 ppm | A | B | C | | |
| | 3.5V | 12 ppm | 30 ppm | A | B | C | | |
| F1810C | 10-12 | 180-240 | 79-102 | 12 | 30 | 12 | 7.5 | E |
| F1815C | 10-18 | 450-599 | 199-254 | 12 | 36 | 12 | 8 | E |
| F1820C | 10-25 | 652-868 | 288-368 | 12 | 43 | 12 | 9.5 | E |
| F1830C | 10-35 | 901-1198 | 397-508 | 12 | 54 | 12 | 11 | E |
| F1835C ⁺ | 1/2AA | 1615-2149 | 712-910 | 17 | 44 | 15 | 14 | B |
| F1840C ⁺ | 2/3AA | 2143-2851 | 945-1208 | 17 | 52 | 15 | 20 | B |

*Life is dependent on code choices

⁺Bottle shape optional

Warranty life is 50% of battery capacity, maximum of two years.

470 First Ave. No. • Isanti, MN 55040
763.444.9267 • fax:763.444.9384 • sales@atstrack.com • www.atstrack.com