



INSTALLATION INSTRUCTIONS

D'TTACH DETHATCHER WHEEL KIT (DTWK-P)

*When referencing left and right sides of the machine, we always refer to the Operator left and right while you would be operating the machine.

Parts List			
ITEM	QTY	PART NUMBER	DESCRIPTION
1	1	69860100	Right Caster Arm
1A	1	69860100.1	Left Caster Arm
2	4	69860101	Caster Bushing
3	8	69860106	Wheel Spacer
4	2	DTWK66045	3/16" Snapper Pin
5	4	69730014	3/8-16 Flanged Nut
6	4	202100002	3/8-16 X 3/4" LG Flanged Hex Head Bolt
7	2	69860107	6 X 2 Semi-Pneumatic Wheel
8	2	69860108	Cotter Pin
9	1	69860109	Right Caster Yoke
10	1	69860110	Left Caster Yoke

TOOLS REQUIRED
9/16" Wrench

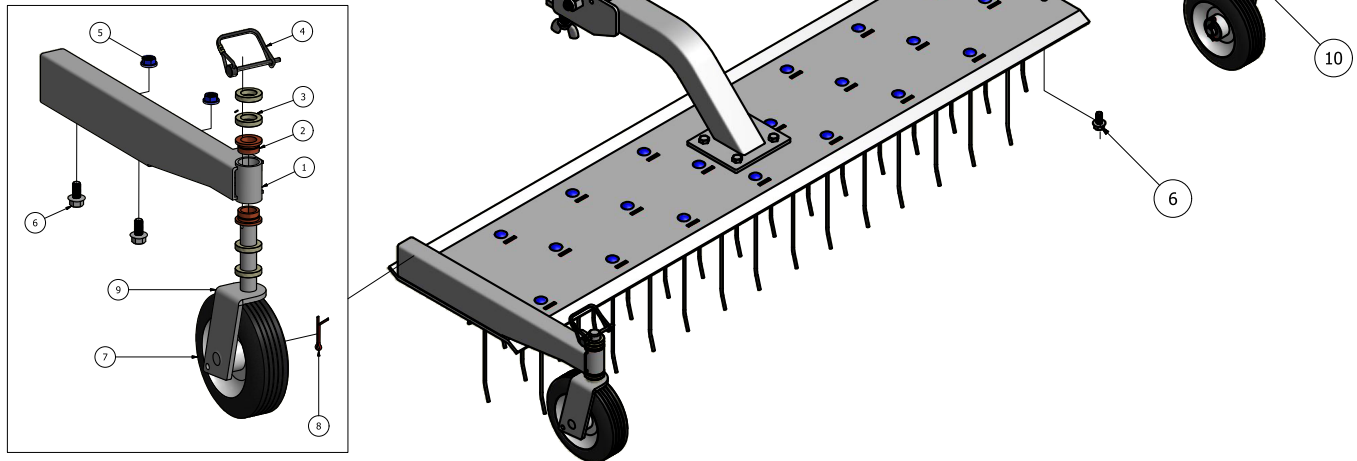

- 1) Install the DT Series Dethatcher Attachment to mower and lower to the operating position.
- 2) Align and install wheel assembly #1 on the *right side of the dethatcher using supplied bolts
- 3) The head of the bolt should be under the dethatcher plate and feed through the dethatcher plate and caster arm. Secure the caster arm with a flange nut using a 9/16" wrench
- 4) Repeat on *left side using assembly #1A

Position of caster assemblies 1 & 2 may vary upon position of installer. Open sides of assemblies should face each other.



Visit www.dttach.com/support.html

for Product Support, IPL's, Product Literature, Instructions & Tutorial Videos

D'ttach MFG. 83-A Comsewogue Rd, E. Setauket, NY 11733 631-642-7445

Follow Us @dttachmfg



DTWK INSTRUCTIONS.FS 10.1.19