

### OLD STYLE MORTISE LOCKS



199A

**199A 03 51**

- "Crystal" glass knob with die cast bottom
- Includes spindle and set screws
- 2" Diameter, projects 2-1/4"



215

**215 04 51**

- Complete set includes 2 knobs, threaded spindle, 214 04 51 lock body, 2 of 213 04 51 escutcheon, strike, screws and 2 keys

**216 03 51**

- Fits square spindle

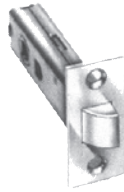

216

MFG #	DESCRIPTION	EZ #
199A 03 51	Glass Knobs	007289
212 03 51	Brass Roses	035632
213 04 51	Escutcheon Plate Only	007290
214 04 51	Mortise Lock Body Only	007291
215 04 51	Mortise Lock Set	007292
216 03 51	2-3/8" Spring Latch	026450

### CHAIN & PATIO LOCKS



201 03 51

**201**

- Door chain lock
- Brass finish



300 59 51

**300 59 51 KADF8**

- 1054UN steel stamped key
- 5 brass disc tumblers with 100 combinations
- KA DF8 keyway

MFG #	FINISH	DESCRIPTION	EZ #
201 03 51	Bright Brass	Door Chain Lock	035629
300 59 51 KADF8	Satin Silver	Patio Lock	060601