

GROVE COMMONS INDUSTRIAL PARK



R E B
LIMITED

Contact Information:

Randall E. Blum

Office **480-827-9591**

Mobile **602-376-7573**

Web Site: REBLTD.Com
for floor plans and
availability.

Listing Service:
Costar.com
Loopnet.com

FEATURES

- 7151 S. Harl Avenue, 1536, 1514, 1522 West Todd Drive, Tempe, AZ 85283
- 4 bldgs. totaling 113,606 Sq Ft multi-tenant, warehouse complex, Suites 3,497 sq ft up to 10,885 sq ft
- Parking: 2.62 spaces to 1,000 sq ft

- Freeway Access:
One mile East of Elliot Rd. & I-10
- 200 amp, 3 phase, 480 volt, upgrades available
- 24' ceiling height
- Grade and truck well loading

The multi tenant warehouse complex consists of four separate buildings totaling 113,606. Suite sizes range from 3,497 to 10,885 sq. ft. All ware house spaces have a ceiling height of 20' and are adjacent to grade and truck well loading. Parking ratio is 2.62 spaces per 1,000 sq. ft. of space. Each suite is individually electrically metered and offers a minimum service of 200 amp, three phase, 480-volt supply. Upgrades available.

LOCATION: Grove Commons Industrial Park is located one mile northeast of Elliot Road and Interstate 10. Tempe is currently an urban community located in the center of the Phoenix metropolitan region, bordered by Phoenix on the West, Scottsdale on the North, Mesa on the East, and Chandler on the South. Grove Commons central location is enhanced by its access to the extensive freeway network providing access to and from these surrounding communities. Grove Commons adds to Tempe's strong, diversified economy of more than 750 manufacturing firms. Located in the middle of the "Tech Oasis," where over two hundred high tech companies and other growing industries including bio-technology, financial and business services can be found.

R E B
LIMITED

123 N. Centennial Way, Suite 112, Mesa, AZ 85201 Tel 480-827-9591 Fax 480-827-2915

SITE PLAN

NORTH

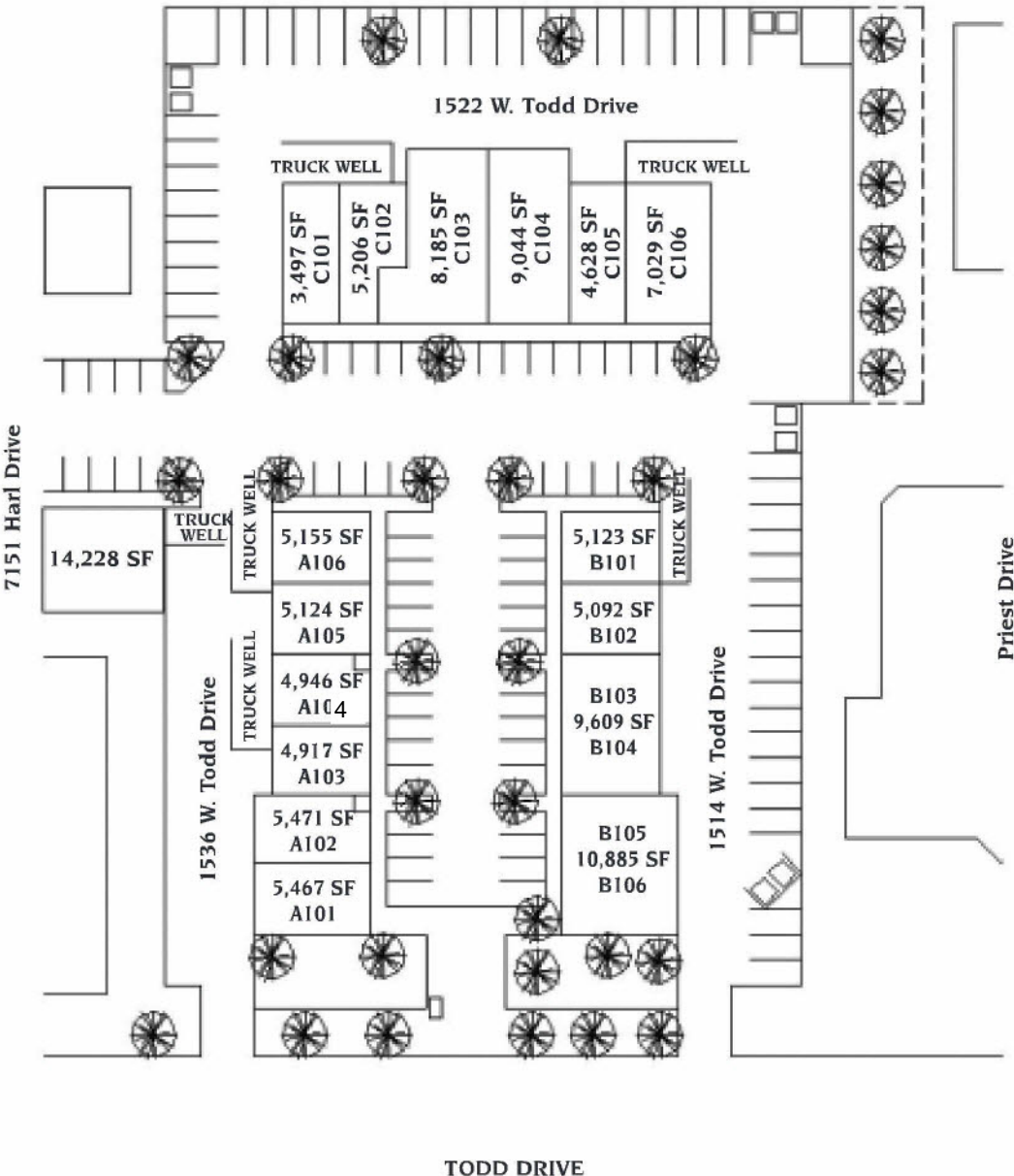

GROVE COMMONS INDUSTRIAL PARK

7151 S. Harl Avenue,
1536, 1514, 1522
West Todd Drive
Tempe, AZ 85283

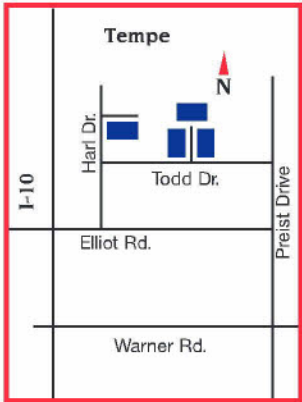

Contact Information:
Randall E. Blum
Office 480-827-9591
Mobile 602-376-7573

Web Site: REBLTD.Com
for floor plans and
availability.

Listing Service:
Costar.com
Loopnet.com