

# The Gardens Gate

June 2019  
Newsletter



Port St. Lucie  
Botanical Gardens



## TASTE OF THE TROPICS



Join us at The Gardens on **Saturday – June 15<sup>th</sup>, 2019** for our annual plant sale featuring a **Taste of the Tropics**. The plant sale will begin at **9am** and run through **1pm**. In cooperation with the Treasure Coast Rare Fruit Club, the Taste of the Tropics Plant Sale will feature our beautiful Botanical Gardens where you can explore the wonderful world of tropical fruits available on the Treasure Coast and join in tasting Tropical Fruit grown locally.

Additionally, browse the annuals, perennials and Florida-friendly plants as well as fruit trees, shrubs, native plants, orchids, exotics, bamboo and garden related crafts that will be available from The Gardens and numerous vendors. Find what you need to make your Garden grow and talk with the experts while you tour the Gardens. We hope to see you there.

## Contents

President's Message  
Board & Committees  
Video Of The Month  
Faerie Forrest Sponsorship Opportunities  
Garden Center Update

[Pg2](#)  
[Pg2](#)  
[Pg2](#)  
[Pg3](#)  
[Pg4](#)

Orchid Workshop Thank You  
Moonraker at The Gardens 2020  
June Calendar  
June Planting Calendar  
What's Flowering & Edibles to Plant  
Volunteer Help Needed  
Out & About with The Gardens  
Upcoming Events  
Are You A Member of Friends?

[Pg5](#)  
[Pg7](#)  
[Pg9](#)  
[Pg11](#)  
[Pg12](#)  
[Pg13](#)  
[Pg14](#)  
[Pg39](#)  
[Pg40](#)

## Reminder

**TASTE OF THE TROPICS  
& PLANT SALE  
SATURDAY • JUNE 15<sup>TH</sup>  
9:00 AM - 1:00 PM**



2410 SE Westmoreland Blvd.  
Port St. Lucie, FL 34952  
Phone: 772.337.1959  
Fax: 772.237.5952  
E-mail: [info@pslbg.org](mailto:info@pslbg.org)  
Web: [www.pslbg.org](http://www.pslbg.org)  
Hours: Wednesday - Saturday 10am - 4pm  
Sunday Noon - 4pm  
Closed Monday, Tuesday & Some Holidays  
Suggested Donations:  
Adults \$5  
Students \$2  
Children 12 & Under Welcome  
Free for FPSLBG Members and  
Active Military with family (IDs required)

### Mission Statement . . .

Friends' mission is to create and maintain a beautiful, serene sanctuary in the center of Port St. Lucie that is environmentally sound and naturally diverse and to provide educational, cultural and recreational opportunities for all who visit.

### Officers & Directors . . .

President: Joleen King  
Vice President: Heather Furnari  
Secretary: Claire Clark  
Treasurer: Brenda Gustafson  
Directors: Brett Ashley  
Jeff Chambers  
Melinda DeMarco  
Judy Nash-Wade  
Michelle Peterson  
Tim Sutton  
Mary Thomas

### Standing Committee Chairs . . .

Election Committee: Stephanie Alessandrini-Giarraffa  
Finance Committee: Brenda Gustafson  
Gift Shop Committee: Claire Clark  
Horticulture Committee: Brenda Gustafson  
Membership & Volunteer Committee: Mary Thomas  
Resource Development Committee: Melinda DeMarco  
Strategic Planning Committee: TBD

### Newsletter . . .

Editor & Design: Mark Barnes

The Gardens is managed and operated by Friends of the Port St. Lucie Botanical Gardens, Inc., a non-profit 501(c)(3) public charity organization, that was founded to help support the daily operations of The Gardens. Friends volunteers provide hands-on daily oversight of the facility, including staffing to handle the many visitors year round. Please consider becoming a member of Friends. Friends' is a 100% volunteer organization. In all cases, donations are deductible to the extent allowed by law.



## PRESIDENT'S MESSAGE...

June 21 this year marks the Summer Solstice and longest day of the year. At the Gardens, summer is a period of reduced visitor traffic, higher temperatures and humidity for working on hard labor projects outdoors, and a time when our volunteers look for creative ways to improve the Gardens without overtaxing anyone's ability to work. Some of the ambitious projects on the clipboard are: establishing a proper display staghorn ferns, a favorite of everyone; expansion of the container gardening display in the veranda of the Pavilion; changing the layout of our Gift shop to maximize retail floor space, and more!

The City's Westmoreland project Phase I has completed and we're quietly awaiting the next phase of that interesting neighbor project.

Plan to visit the Gardens during June. We can't promise low temperatures or humidity, but we can offer shade and A/C when you need it. Hope to see you soon!

Thank you.

**Joleen King**  
President

## VIDEO OF THE MONTH

**TAKING A STOLL THROUGH THE BUTTERFLY GARDEN**

# *Become A Faerie Forrest Sponsor*

## *Sponsorship Levels*

### **\$10,000 - Sponsor The Forrest**

Primary Sponsor with subtle signage, recognition on the FPSLBG website & promotional rack card, and a Full Page Newsletter Ad for 2 years.

### **\$750 - Faerie Faenatic**

Opportunity to name one of the Faeries, recognition on the FPSLBG website & promotional rack card.

### **\$100 - Faerie Friend**

General Donation to support The Gardens with recognition on the FPSLBG website.

Sponsorship opportunities for Faerie Faenatics, including a corporate sponsorship, are available for a limited time. Are you interested in becoming a Faerie Faenatic or a Corporate Sponsor? Call us today at 772-337-1959 or click the link below.





# Garden Center

at the Port St. Lucie Botanical Gardens



## SALE

### PSLBG Garden Center Sale

In Conjunction with Taste of the Tropics

Saturday, June 15th, 9:00AM - 1:00PM

#### KOKEDAMA FOR SALE

**NEW!**



#### BUTTERFLY PLANTERS FOR SALE

**NEW!**



**SPECIAL OFFER**

**20% OFF SALES of \$10+ Saturday's in June**  
*(Kokedama & Butterfly Planters not included)*



#### IT'S NO SECRET!

We have over 2000 Plants For Sale  
in our PSL Botanical Garden Center  
At very reasonable prices.

Please let your friends and family know!  
All proceeds go to the benefit of the Garden.  
*Visit us Soon!*

**SPECIAL \$5.00 BONUS OFFER**



#### Firespike—Great in a Butterfly Garden

- Height: 6' - 10' Width: 4' - 6'
- Upright evergreen shrub with lush deep green foliage and terminal spikes of lavender-purple flowers that appear summer through late winter to year-round, attractive to hummingbirds and butterflies
- tolerates most soils, water occasionally to regularly, but once established is drought tolerant
- Cold tolerant and can survive hard frost

# Ask the Experts - Orchid Workshop

*Thank You*



A Big Thank You to **John Erickson** for the excellent Orchid Workshop he provided. It was held overlooking the beautiful Orchid Garden Room to a packed crowd of Garden members. One of the benefits of being a member is our **FREE** workshops throughout the year.

**Look for more informative workshops coming soon.**





*Friends of the Port St. Lucie*  
**Botanical  
Gardens**

Beautiful plants & flowers, magnificent oaks & a lake, all nestled on 20 acres near the shore of the St Lucie River. The Port St. Lucie Botanical Gardens is a favorite venue for special events in our city. The Gardens offers picturesque settings for your special occasion.

**772.337.1959**

2410 SE Westmoreland Blvd.

Port St. Lucie, FL 34952

Events@PSLBG.org

pslbg.org/yourevent



## ATTENTION:

Nature Lovers, Butterfly Gardeners, Bird Watchers, Conservationists,  
And Those Who Enjoy Flowers and Plants.

The St. Lucie West Garden Club meets at the St. Lucie Trail Golf Club  
on the 3<sup>rd</sup> Monday of each month.

For more information please call President, **Dorothy Flora (772) 879-6986**,  
or our Membership Chairman, **Darlene Berube (508) 415-7345**.

See our Facebook page  
St. Lucie West Garden Club



St. Lucie West  
Garden Club



## EXPERIENCE COUNTS - AND SAVINGS ADD UP



Find out about the **Competitive Rates** and **Special Benefits** available  
through the AARP® Auto Insurance Program from The Hartford.

Ready to learn more? Contact our agency now:

### POST INSURANCE



**SEE HOW MUCH YOU COULD SAVE!**  
Call today for your **FREE**, no-obligation quote:

**772-878-8184**

#### POST INSURANCE

146 NW Central Park Plaza, Suite 102  
Port St. Lucie, FL, 34986

info@insurewithpost.com  
www.InsureWithPost.com

# 2020

Celebrating 10 Years

SAT • MARCH 28

Food  
Kiosks

Music &  
Dancing

Cigar  
Bar

Casino  
Fun

Raffles  
& Prizes

**MOONRAKER**  
at The Gardens

Cash  
Bar



6:00 PM - 10:00 PM

Save The Date  
Ticket & Pricing  
Coming Soon

Port St. Lucie Botanical Gardens  
2410 SE Westmoreland Blvd.  
Port St. Lucie, FL 34952  
www.PSLBG.org

[Sponsorship Opportunities Available - Click Here](#)



# JUNE

2 <sup>nd</sup>	Crosstown Chapel Sunday Service	9:30 - 11:45 am	All Welcome
3 <sup>rd</sup>	Art Show Committee	2:00 - 3:30 pm	All Welcome
5 <sup>th</sup>	Intermediate Spanish Class	10:00 - 11:30 am	All Welcome
9 <sup>th</sup>	Crosstown Chapel Sunday Service	9:30 - 11:45 am	All Welcome
10 <sup>th</sup>	2020 Planning Committee	3:00 - 4:15 pm	All Welcome
<b>10<sup>th</sup></b>	<b>FPSLBG Board of Directors Meeting</b>	<b>4:30 - 6:30 pm</b>	<b>Members Welcome</b>
11 <sup>th</sup>	PSL Angler's Meeting	5:30 - 9:30 pm	All Welcome
11 <sup>th</sup>	Master Naturalists Meeting	7:00 - 9:00 pm	Members Welcome
12 <sup>th</sup>	Intermediate Spanish Class	10:00 - 11:30 am	All Welcome
12 <sup>th</sup>	Ft. Pierce Jazz & Blues Jazz Jams	6:30 - 9:30 pm	\$7 Donation, \$6 Members
13 <sup>th</sup>	BOOtanical Halloween Committee	10:00 - 11:30 am	All Welcome
13 <sup>th</sup>	PSL Orchid Society	12:00 - 3:00 pm	All Welcome
<b>15<sup>th</sup></b>	<b>Taste of the Tropics &amp; Plant Sale</b>	<b>9:00 am - 1:00 pm</b>	<b>All Welcome</b>
16 <sup>th</sup>	Crosstown Chapel Sunday Service	9:30 - 11:45 am	All Welcome
19 <sup>th</sup>	Intermediate Spanish Class	10:00 - 11:30 am	All Welcome
20 <sup>th</sup>	Treasure Coast Rare Fruit Club Meeting	7:00 - 9:00 pm	All Welcome
22 <sup>nd</sup>	TC Bonsai Club Meeting	10:00 am - 12:00 pm	All Welcome
23 <sup>rd</sup>	Crosstown Chapel Sunday Service	9:30 - 11:45 am	All Welcome
24 <sup>th</sup>	Rio Lindo Monthly Meeting	12:30 - 4:00 pm	Members Welcome
24 <sup>th</sup>	TC Bromeliad Society & Tropicals	5:30 - 9:00 pm	Members Welcome
25 <sup>th</sup>	PSL Historical Society Board Meeting	4:00 - 5:30 pm	Members Welcome
26 <sup>th</sup>	Intermediate Spanish Class	10:00 - 11:30 am	All Welcome
26 <sup>th</sup>	German American Board Meeting	2:00 pm - 4:00 pm	Members Welcome
26 <sup>th</sup>	Ft. Pierce Jazz & Blues Jazz Jams	6:30 - 9:30 pm	\$7 Donation, \$6 Members
27 <sup>th</sup>	TC Professional Photographers Assoc.	6:00 - 8:30 pm	Members Welcome
30 <sup>th</sup>	Crosstown Chapel Sunday Service	9:30 - 11:45 am	All Welcome



[www.PSLBG.org](http://www.PSLBG.org) • The Pavilion is closed Mondays & Tuesdays  
For more information on events, please call 772.337.1959

# WHAT'S YOUR STATION?



**93.7 GYL**  
Today's Best Music!

**99.7 JACK fm**  
playing what we want!

**97.1 Ocean** FM  
WOSN



**B94.7** FM  
FRESH COUNTRY

**NEWSRADIO**  
**WTTB**  
105.7 FM • 1490 AM

PosterMyWall.com

 **Impact**  
**esigns**

Sign & Graphic Works, Inc.

**772.419.8048**

**ImpactDesigns101.com**

**ImpactPromos101.com**

**Signs** ▷ **Digital Printing** ▷ **Graphic Design**  
**Boat - Vehicle Wraps & Graphics** ▷ **T-Shirts**  
**Photographic Reproduction - Canvas Prints**  
**Banners** ▷ **Promotional Items... & More**

# UF | IFAS Extension

## UNIVERSITY of FLORIDA

### University of Florida IFAS Extension Central Florida Gardening Calendar - June

## What to Plant

**Annuals/Bedding Plants:** Annuals that can take full sun during the increasingly hot summer months include celosia, portulaca, vinca, and some coleus. **See Annuals:** [http://edis.ifas.ufl.edu/topic\\_annual\\_landscape\\_plants](http://edis.ifas.ufl.edu/topic_annual_landscape_plants)

**Palms:** Summer's warm, rainy months are the perfect time to plant palms. Make sure not to cover the trunk with soil. **See Palms:** [http://edis.ifas.ufl.edu/topic\\_palms](http://edis.ifas.ufl.edu/topic_palms)

**Herbs:** Plant heat-loving herbs, including basil, ginger, summer savory, cumin, Mexican tarragon, and rosemary. **See Herbs:** [http://edis.ifas.ufl.edu/topic\\_herbs](http://edis.ifas.ufl.edu/topic_herbs)

**Vegetables:** Plant tropical vegetables, such as boniato, calabaza, and chayote this month. **See South Florida Tropicals:** [http://edis.ifas.ufl.edu/topic\\_series\\_south\\_florida\\_tropicals](http://edis.ifas.ufl.edu/topic_series_south_florida_tropicals) and *Chayote:* [http://edis.ifas.ufl.edu/topic\\_chayote](http://edis.ifas.ufl.edu/topic_chayote)

## What to Do

**Pests:** Monitor the landscape and garden weekly for harmful insects. Knowing which insects attack a plant can aid in identification and treatment. **See Landscape Pest Management:** [http://edis.ifas.ufl.edu/topic\\_landscape\\_pests](http://edis.ifas.ufl.edu/topic_landscape_pests)

**Irrigation:** Watch for drought stress and water as needed if rainfall has been spotty. Focus on new plantings and follow watering restrictions. When rains begin, shut down the irrigation system. **See Landscape Irrigation:** [http://edis.ifas.ufl.edu/topic\\_landscape\\_irrigation](http://edis.ifas.ufl.edu/topic_landscape_irrigation)

**Propagation:** Produce more plants by air layering, grafting, division, or cuttings. **See Seeds and Propagation (Lawn and Garden):** [http://edis.ifas.ufl.edu/topic\\_garden\\_propagation](http://edis.ifas.ufl.edu/topic_garden_propagation)

**Palms and cycads:** Watch for nutrient deficiencies or other problems and use an appropriate treatment. **See Palm Care:** [http://edis.ifas.ufl.edu/topic\\_palm\\_care](http://edis.ifas.ufl.edu/topic_palm_care)

**Pruning:** Lightly prune summer-flowering shrubs, like hibiscus, oleander, and ixora, during the warmer months to increase blooming. **See Pruning Landscape Trees and Shrubs:** [http://edis.ifas.ufl.edu/topic\\_tree\\_pruning](http://edis.ifas.ufl.edu/topic_tree_pruning)

**Fertilizer Bans:** Numerous municipalities in south Florida prohibit the application of fertilizer to lawns and/or landscape plants during the summer rainy season (June–September). See if such an ordinance exists in your area.

**Lawns:** Check frequently for damaged areas and keep insects in check with early treatment. Determine whether yellow and brown lawn patches are caused by chinch bugs, disease, or lack of water. Take time to determine the cause so your remedy is effective. Rejuvenate areas where grass does not grow well by replacing it with versatile groundcovers. **See Garden Pest Insects:** [http://edis.ifas.ufl.edu/topic\\_garden\\_pest\\_insects](http://edis.ifas.ufl.edu/topic_garden_pest_insects), *The Florida-Friendly Landscaping™ Guide to Plant Selection & Landscape Design:* [https://ffl.ifas.ufl.edu/pdf/FYN\\_Plant\\_Selection\\_Guide\\_2015.pdf](https://ffl.ifas.ufl.edu/pdf/FYN_Plant_Selection_Guide_2015.pdf) and *Ground Covers:* [http://edis.ifas.ufl.edu/topic\\_ground\\_covers](http://edis.ifas.ufl.edu/topic_ground_covers). See *Lawn Fertilizer:* [http://edis.ifas.ufl.edu/topic\\_lawn\\_fertilization](http://edis.ifas.ufl.edu/topic_lawn_fertilization)

**Soil solarization:** Clean up your vegetable garden and solarize the soil for 4–6 weeks to kill pests and disease. **See Soil Solarization:** [http://edis.ifas.ufl.edu/topic\\_soil\\_solarization](http://edis.ifas.ufl.edu/topic_soil_solarization)

**Lightning safety:** Be safe outdoors during storm season.

# WHAT'S FLOWERING in Florida?

## JUNE

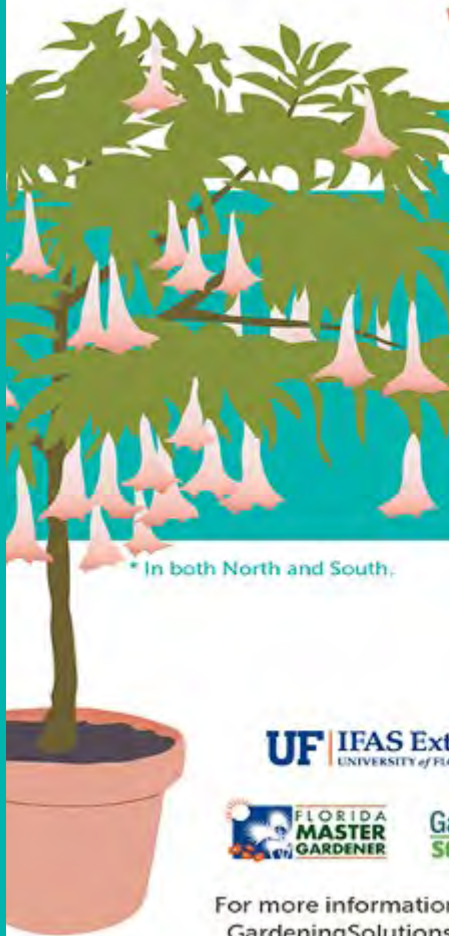

**NORTH/  
CENTRAL**

- Chaste Tree   
Non-native, deciduous (*Vitex agnus-castus*)
- Crapemyrtle   
Non-native, deciduous (*Lagerstroemia* spp.)
- Ixora\*   
Non-native, evergreen (*Ixora coccinea*)
- Jerusalem Thorn   
Non-native, deciduous (*Parkinsonia aculeata*)
- Oakleaf Hydrangea   
Native, deciduous (*Hydrangea quercifolia*)

\* In both North and South.

## Angel's Trumpet

Non-native, evergreen (*Brugmansia* spp.)

## Jacaranda

Non-native, semi-deciduous (*Jacaranda mimosifolia*)

## Ixora\*

## Orange Geiger Tree

Non-native, evergreen (*Cordia sebestena*)

## Yellow Poinciana

Non-native, semi-deciduous (*Peltophorum dubium*)

**SOUTH**

**UF** IFAS Extension  
UNIVERSITY of FLORIDA



For more information, please visit  
[GardeningSolutions.ifas.ufl.edu](http://GardeningSolutions.ifas.ufl.edu)

# EDIBLES TO PLANT IN JUNE

	North	Central	South
 Survives Transplanting	Sweet Potatoes	Sweet Potatoes	Sweet Potatoes
 Transplant With Care			
 Use Seeds	Okra Peas (southern)	Okra Peas (southern)	

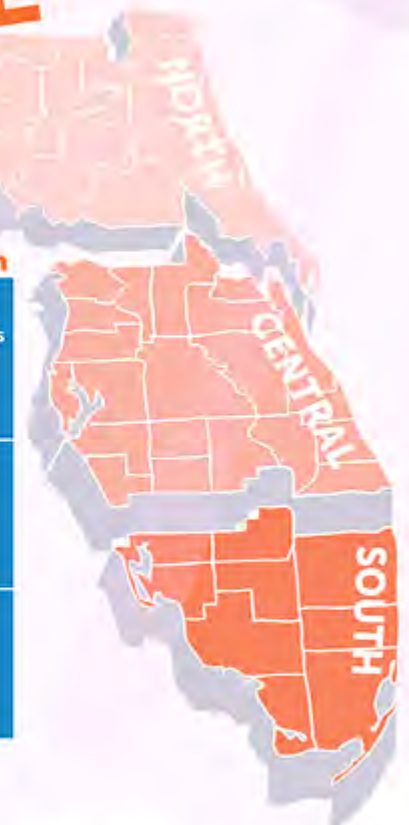

**UF** IFAS Extension  
UNIVERSITY of FLORIDA



**Gardening SOLUTIONS**

For more information, please visit  
[GardeningSolutions.ifas.ufl.edu](http://GardeningSolutions.ifas.ufl.edu)

# ARE YOU SERVING ON A COMMITTEE?

Have you thought about serving on a Gardens Committee? Do you have hidden talents that would help our Gardens to grow. We have openings on the following committees and can use your assistance and talents:

- Event Planning Committee - Social Assistants
- Propagation Committee • Dig in the Dirt
- Newsletter / Website Design Committee
- Hospitality Committee
- 2020 Planning Committee
- Gift Shop Committee
- Landscape Design Committee
- Art in the Gardens Committee
- Finance Committee

Give us a call at 772-337-1959 or email [info@pslbg.org](mailto:info@pslbg.org) to find out more or to volunteer for a specific committee.



## VOLUNTEER HELP NEEDED

TEAM LEADERS TO ASSIST WITH  
LANDSCAPE MAINTENANCE

Wednesday-Saturday • 10AM - 1PM OR 1PM - 4PM  
Sunday • 12PM - 4PM

### THIS IS A 4 HOUR, ONE DAY A WEEK COMMITMENT!

Team Leaders will supervise and oversee volunteers in the completion of gardening tasks throughout the Gardens.

The position requires a team player attitude, interpersonal and communication skills, attention to details and project coordination. The Landscape Maintenance Coordinator should have the ability to collaborate with and support the Horticulture Committee. *Training will be provided in all aspects of the maintenance.* **Master Gardeners Welcome!**

What better way to support your **Port St. Lucie Botanical Gardens** and spend time outside in this lovely growing garden. Call Mary Thomas or Brenda Gustafson at 772-337-1959.



# Out & About



## With The Gardens

Seen Around The Gardens & Beyond



Continued on Pg 15



# Local Theater Group Visits The Gardens





# TC Professional Photographers Styled Shoot Workshop









Prom Season





**Master Gardeners Frolic through the Garden**

**Visitor Pics**



# Butterfly House

# NOW OPEN!



**Pinder's  
Nursery**  
Palm City, Florida



Mon-Sat 9am - 5pm • Sun 10am - 4pm  
Since 1975, Locally Owned & Operated  
5500 SW Martin Hwy. Palm City

*...growing flowers, food and friendships!*

**772-781-8085**









**GLHOMES®**

**WELCOME HOME**

**GL Homes**

**VALENCIA CAY AT RIVERLAND  
PORT ST. LUCIE**

**55+ Lifestyle  
from the \$200s  
(772) 226-9000**



©2018 Pricing subject to change without notice. An equal housing opportunity. 0500-439 9-4-18



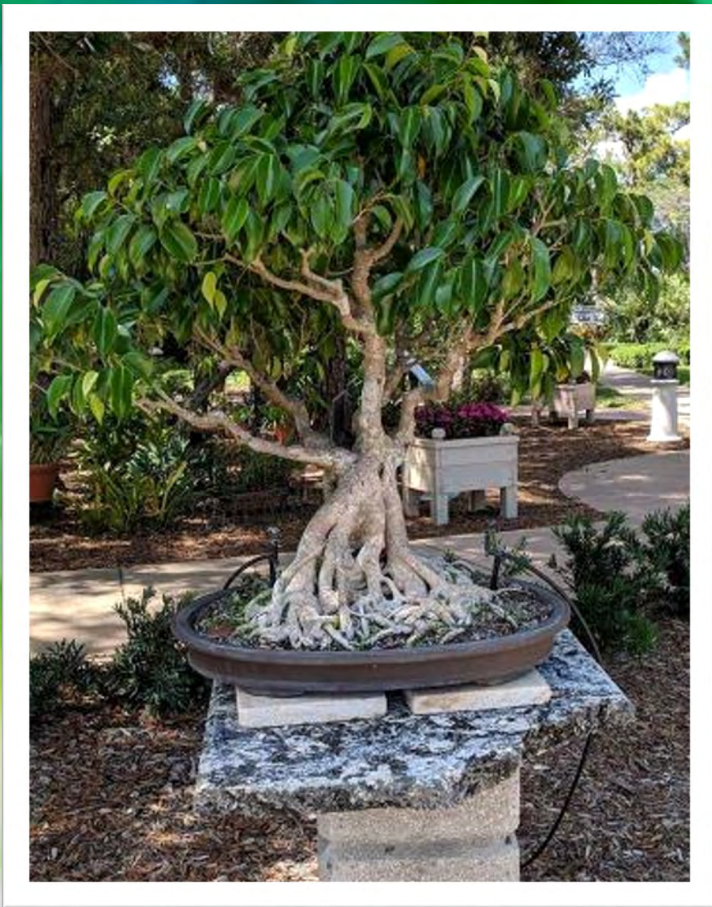





**SCOTT A. BARNABY, PGA**  
REALTOR® Sales Associate  
PGA Professional

917-797-3304 (Direct)  
772-340-4000 (Office) • 772-340-1557 (Fax)  
ScottBarnabyGolf@PGA.com  
"Connecting People to Property"



**THOMAS J. WHITE**  
REALTY

1555 NW ST. LUCIE WEST BLVD.  
SUITE 103  
PORT ST. LUCIE, FL 34986



[www.ThomasJWhiteRealty.com](http://www.ThomasJWhiteRealty.com) Each Office is Independently Owned and Operated

**VISIT OUR  
WEBSITE**



**"like" us on  
facebook**



PORT ST. LUCIE  
**PARKS &  
RECREATION**



**THE SAINTS**

*At Port St. Lucie Golf Course*  
[www.CityofPSL.com/Golf](http://www.CityofPSL.com/Golf)

2601 SE Morningside Blvd. • (772) 398-2901  
Port St. Lucie, FL 34952 • Fax: (772) 398-2778



**Mark A. Barnes**

*Making You & Your business Look Great*

**772.801.8800**  
[Mark@MarkBarnesMusic.com](mailto:Mark@MarkBarnesMusic.com)

- Business Card Designs
- Logo Designs
- Graphic Designs
- Specialty Cards
- Real Estate Ads & Designs
- Video Home Tours
- Basic Web Sites
- Copyright Services
- ASCAP & Music Site Setup
- QR Code Design
- Video Bios and Resumes
- Power Point Presentations
- Virtual Assistant
- Real Estate Services



**Jazz Jams**

at the Port St. Lucie Botanical Gardens

Presented By



**WEDNESDAY**  
**JUNE 12<sup>TH</sup> & 26<sup>ST</sup>**  
**6:30 - 9:30 PM**













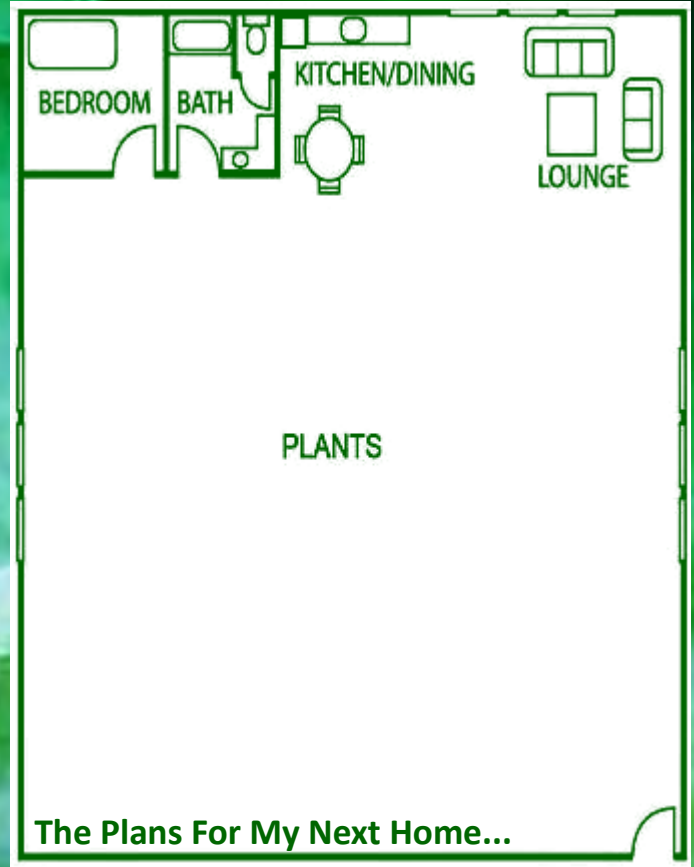



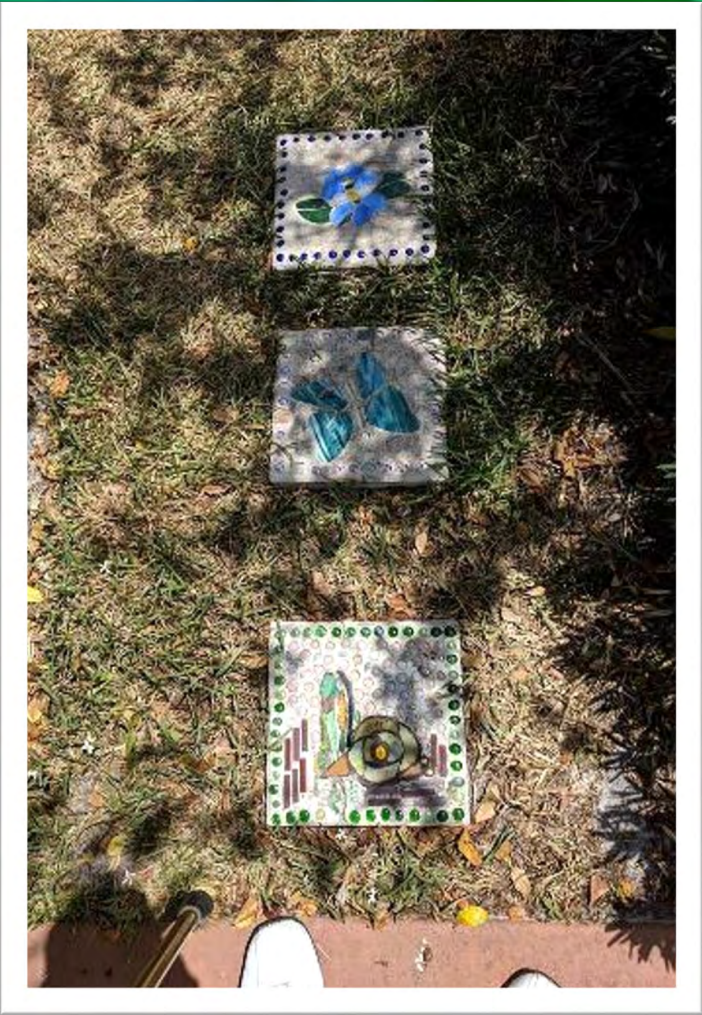





# Port St. Lucie Historical Society

## Port St. Lucie Historical Society

Find lots of memories and surprises when you explore our web site



[pslhistory.org](http://pslhistory.org)



Follow us on  
[Facebook](#)

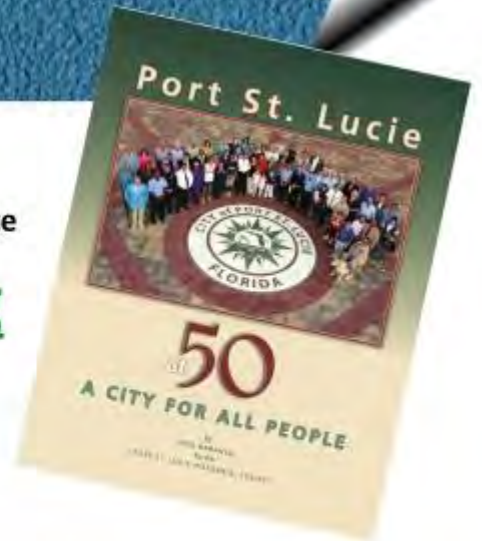

**GUETTLER BROTHERS CONSTRUCTION**



[WWW.GUETTLERCONSTRUCTION.COM](http://WWW.GUETTLERCONSTRUCTION.COM)

[CLICK HERE TO  
BECOME A VENDOR](#)



**SATURDAY • JUNE 15, 2019**

**9:00 a.m. - 1:00 p.m.**

*In cooperation with the  
Treasure Coast Rare Fruit Club  
Rare Tropical Fruit Tasting*

- Free parking, No admission. Tour the Botanical Gardens.
- Explore the wonderful world of tropical fruits available on the Treasure Coast.
- Annuals, perennials, Florida-friendly plants and Garden related crafts.
- Fruit trees and shrubs, Native plants, Orchids and exotics, Bamboo and more.
- Gift Shop & Propagation Garden Center Specials.
- Find what you need to make your Garden grow and talk with the experts.



**2410 SE Westmoreland Blvd, Port St Lucie - [WWW.PSLBG.ORG](http://WWW.PSLBG.ORG)**

*Donations to the Friends of the PSL Botanical Gardens are always gratefully appreciated*

# Are you a Member of Friends? Friends Membership is...



**Friends of the Port St. Lucie Botanical Gardens, Inc.,  
We Are A Growing Community!**



**Click Here to  
Join or Renew Your  
Membership Today**