

ORDINANCE NO. 2014- 5

**AN ORDINANCE APPROVING AGREEMENT FOR THE JURISDICTONAL  
TRANSFER OF ROADWAYS WITH THE STATE OF ILLINOIS DEPARTMENT OF  
TRANSPORTATION FOR THE VILLAGE OF CHAPIN, MORGAN COUNTY, ILLINOIS**

WHEREAS, the State of Illinois Department of Transportation has made certain improvements to U.S. Highway 67 including the construction of a four lane divided highway;

WHEREAS, the improvements made to U.S. Highway 67 by the State of Illinois required that portions of the Village of Chapin's water and sewer system be relocated;

WHEREAS, the State of Illinois agreed to reimburse the Village of Chapin for a portion of the costs associated with relocating a portion of the Village's water system, including water mains and sewer mains;

WHEREAS, the State of Illinois Department of Transportation desires to transfer to the Village of Chapin jurisdictional control over the following: a portion of improved Old U.S. Highway 67; the unimproved portion of the existing U.S. Highway 67/Illinois 104; an unimproved portion of Old U.S. Highway 67/Illinois 104; a portion of Cooper Street; New Street; a portion of Ash Street; a portion of the Relocated Crews Lane; and New Frontage Road; said roads or portions of road are more particularly described in a certain written *Agreement* (including Exhibits A, B, C, D, E, F, G and H thereto and the 13 pages of schematic drawings) a copy of which, marked as **Appendix 1**, is attached hereto and incorporated herein by this reference; and

WHEREAS, the corporate authorities of the Village of Chapin deem it advisable and in the best interest of the Village's residents to enter into the *Agreement* and to assume jurisdictional control of the roadways described in the *Agreement*.

NOW, THEREFORE, be it ordained by the President and Board of Trustees of the Village of Chapin, Morgan County, Illinois, as follows:

Section 1. The foregoing recitals are adopted and incorporated herein by this reference as if they had been restated verbatim.

Section 2: The *Agreement*, a copy of which is attached hereto as **Appendix 1**, is approved and accepted by the corporate authorities of the Village of Chapin. The Village, subject to the terms and conditions set forth in the *Agreement*, shall take over jurisdictional control of the roadways or portions of roadways including known as Cooper Street, New Street, Ash Street, Relocated Crews Lane, New Frontage Road, Old U.S. Highway 67, Old U.S. Highway 67/104, and the existing U.S. Highway 67/Illinois 104, more particularly shown and described in the *Agreement* and Exhibits A, B, C, D, E, F, G and H and the 13 pages of schematic drawings attached thereto,

Section 3: The Village President is directed to execute the *Agreement* and additional instruments on behalf of the Village of Chapin as necessary to effectuate the terms and conditions of the *Agreement*.

Section 4: This Ordinance shall be in full force and effect upon its passage and approval as provided by law.

Passed and Approved by the President and Board of Trustees of the Village of Chapin, Morgan County, Illinois, on the 9 day of July, 2014.

  
\_\_\_\_\_  
Ken Drake, Village President

Attest:

  
\_\_\_\_\_  
Rhea Drake, Village Clerk

STATE OF ILLINOIS     )  
  )ss  
COUNTY OF MORGAN    )

**CERTIFICATION**

I, Rhea Drake, Clerk of the Village of Chapin, Morgan County, Illinois, do hereby certify that the foregoing and attached copy of Ordinance No. 2014- 5 is a true and correct copy of an ordinance passed by the President and Board of Trustees of the Village of Chapin at a meeting of said Board of Trustees held on the 9 day of July, 2014, as appears from the original ordinance now on file in my office.

In Witness Whereof, I have hereunto set my hand and affixed the corporate seal of the Village of Chapin, this 9 day of July, 2014.

Rhea Drake  
Rhea Drake, Village Clerk

(SEAL)

**APPENDIX 1**

FAP Route 310 (US 67/IL 104)  
Section 69-3 (3HB)  
County Morgan  
Job No. C-96-037-08  
Agreement No. JT 611-001  
Contract No. 72667

**AGREEMENT**

This agreement entered into this \_\_\_\_\_ day of \_\_\_\_\_, A.D., 20\_\_\_\_, by and between the STATE OF ILLINOIS, acting by and through its DEPARTMENT OF TRANSPORTATION hereinafter called the STATE, and the Village of Chapin, of the State of Illinois, hereinafter called the VILLAGE.

**WITNESSETH:**

WHEREAS, the STATE in order to facilitate the free flow of traffic and insure safety to the motoring public, is desirous of building a four-lane expressway FAP Route 310 (US 67/IL 104), State Section 69-3 (3HB), from 0.2 mile east of Concord Road to 1.8 miles east of IL 100, a distance of 7.27 miles, along the existing US 67/ IL 104 route in Morgan County, providing two through traffic lanes in each direction, an interchange at Concord Road and by performing all other work necessary to complete the improvement in accordance with the approved plans and specifications; as shown on the location map marked 'Exhibit A' attached hereto and made a part hereof, and

WHEREAS, the VILLAGE is desirous of said improvement in that same will be of immediate benefit to the VILLAGE residents and permanent in nature;

NOW, THEREFORE, in consideration of the mutual covenants contained herein, the parties hereto agree as follows:

**JURISDICTIONAL TRANSFER**

1. The STATE agrees to make the surveys, obtain all necessary rights of way, prepare plans and specifications, receive bids and award the contract, furnish engineering inspection during construction and cause the improvement to be built in accordance with the plans, specifications and contract.
2. The STATE agrees to pay for all right-of-way, construction and engineering costs for the proposed construction project.
3. The VILLAGE agrees to enter into a future present worth value jurisdictional transfer of the Portion of Old US 67 improved with the previous contract from sta 63+00.00 to sta 60+00.00 and from sta 116+85.00 to sta 97+85 a length of 2200.00 lin ft. The unimproved portion of the existing US 67/ IL 104 from west of the interchange at Concord Road to Chapin from sta 48+50.00 to sta 3+00.00 a length of 4550.00 lin ft. The unimproved portion of Old US 67/ IL 104 from west of Chapin to Bethel from sta 556+00.00 to sta 524+75.00, a length of 3125.00 lin ft.
4. The VILLAGE and the State have agreed to the jurisdictional transfer of the portion of Cooper Street from sta 442+65.00 to sta 448+56.24 and from sta 451+07.48 to the south through edge of pavement of Crews Lane at sta 451+72.07 described in the Local Agency – State Jurisdictional Transfer document, attached hereto as "Exhibit B" and made a part hereof.

5. The VILLAGE and the State have agreed to the jurisdictional transfer of New Street from sta 300+12.00 to sta 313+23.25 described in the Local Agency – State Jurisdictional Transfer document, attached hereto as “Exhibit C” and made a part hereof.
6. The VILLAGE and the State have agreed to the jurisdictional transfer of the portion of Ash Street from sta 2+50.00 to sta 9+88.00 described in the Local Agency – State Jurisdictional Transfer document, attached hereto as “Exhibit D” and made a part hereof.
7. The VILLAGE and the State have agreed to the jurisdictional transfer of the portion of the Relocated Crews Lane from sta 38+57.25 to sta 57+03.00 described in the Local Agency – State Jurisdictional Transfer document, attached hereto as “Exhibit E” and made a part hereof.
8. The VILLAGE and the State have agreed to the jurisdictional transfer of the New Frontage Road at the interchange with Concord Road from sta 97+85.00 to sta 85+28.86 and sta 6+80.47 to sta 53+05.00 and sta 49+64.42 to sta 48+50.00 a length of 5995.09 lin ft. as described in the Local Agency – State Jurisdictional Transfer document, attached hereto as “Exhibit F” and made a part hereof.
9. The VILLAGE and the State have agreed to the jurisdictional transfer of portions of Old US 67/ IL 104 from sta 556+00.00 to sta 573+75 and from 578+95.00 to 592+54.25 a length of 3134.00 lin ft as described in the Local Agency – State Jurisdictional Transfer document, attached hereto as “Exhibit G” and made a part hereof.

10. The VILLAGE and the State have agreed to the jurisdictional transfer of portions of the New Frontage Road at Bethel from sta 510+25.39 to sta 524+68.00 a length of 1442.61 lin ft as described in the Local Agency – State Jurisdictional Transfer document, attached hereto as “Exhibit H” and made a part hereof.
11. The VILLAGE shall exercise its franchise rights to cause private utilities to be relocated, if required, at no expense to the STATE.
12. The VILLAGE agrees to cause its utilities installed on right of way after said right of way was acquired by the STATE or installed within the limits of a roadway after the said roadway’s jurisdiction was assumed by the STATE, to be relocated and/or adjusted, if required, at no expense to the STATE.
13. The VILLAGE agrees to obtain from the STATE an approved permit for the facility, and to abide by all conditions set forth therein.
14. Upon final field inspection of the improvement and so long as 310 (US 67/IL 104) is used as a State Highway, the STATE agrees to maintain or cause to be maintained the median, the four through traffic lanes lying two on either side of the median, and the left-turn and right-turn lanes, each lane being 12 feet and variable in width, and the stabilized shoulders and ditches adjacent to those traffic lanes and turn lanes to be maintained by the STATE.



15. Upon final field inspection of the improvement, the VILLAGE agrees to maintain or cause to be maintained the VILLAGE owned utilities including appurtenances thereto. The VILLAGE further agrees to remove snow on all side road approaches up to the through edge of pavement of US 67/ IL 104.
16. The VILLAGE agrees to provide written approval of that portion of the plans and specifications relative to the VILLAGE maintenance obligations described herein, prior to the STATE's advertising for the aforescribed proposed improvement.
17. Obligations of the STATE and VILLAGE will cease immediately without penalty or further payment being required if, in any fiscal year, the Illinois General Assembly or Federal funding source fails to appropriate or otherwise make available funds for this contract.
18. This AGREEMENT and the covenants contained herein shall be null and void in the event the contract covering the construction work contemplated herein is not awarded within the three years subsequent to execution of the agreement.
19. Under the penalties of perjury the Village certifies that 37-6015813 is their correct Federal Taxpayer Identification Number and they are doing business as a governmental entity.

This agreement shall be binding upon and to the benefit of the parties hereto, their successors and assigns.

Attest:

*Shea Drake*  
Clerk

(SEAL)

Village of Chapin

By: *Kenneth L. Drake*

TITLE: *Village President*

Date: \_\_\_\_\_

STATE OF ILLINOIS  
DEPARTMENT OF TRANSPORTATION

By: \_\_\_\_\_  
Omer Osman, P.E.  
Director of Highways  
Chief Engineer

MUNICIPAL  
CERTIFICATE

STATE OF ILLINOIS)  
COUNTY OF MORGAN)

I, Rhea Drake, Village Clerk, in and for the Village of Chapin of the State of Illinois, hereby certify that Ken Drake, Board President of the Village of Chapin, was duly authorized to execute the foregoing Agreement on behalf of the Village Board of the Village of Chapin, pursuant to an ordinance adopted by the Village Board at a meeting on

July 9, AD 20 14.

IN TESTIMONY WHEREOF, I have hereunto set my hand and seal this 9  
day of July, AD 20 14.

Rhea Drake  
Village Clerk

(SEAL)

PLAN APPROVAL

WHEREAS, in order to facilitate the improvement of FAP 310, known as US 67/ IL 104, State Section 69-3 (3HB) Village of Chapin, Morgan County, hereby approves that portion of the plans and specifications relative to the Village maintenance obligations for the proposed construction.

Approved \_\_\_\_\_  
(Date)

By \_\_\_\_\_

Title \_\_\_\_\_

# LOCATION MAP EXHIBIT A

END IMPROVEMENT  
STA 1145+73.37, 94.45° RT FAP 310

END SECTION 69-3  
STA 1133+50.00 (WBL)  
STA 1140+00.00 (EBL)

PROPOSED STRUCTURE CARRYING  
CONCORD ROAD OVER FAP 310  
STA 807+81.68  
S.N. 069-0513  
2 SPAN, P.P.C.I. BEAM (COMPOSITE)  
INTEGRAL ABUTMENTS  
202'-0" BK. TO BK. ABUTMENT

BEGIN IMPROVEMENT  
STA 762+05.00 FAP 310

BEGIN SECTION 69-3  
STA 800+00.00 (WBL)  
STA 800+00.00 (EBL)

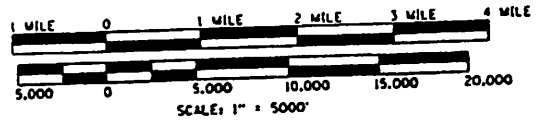
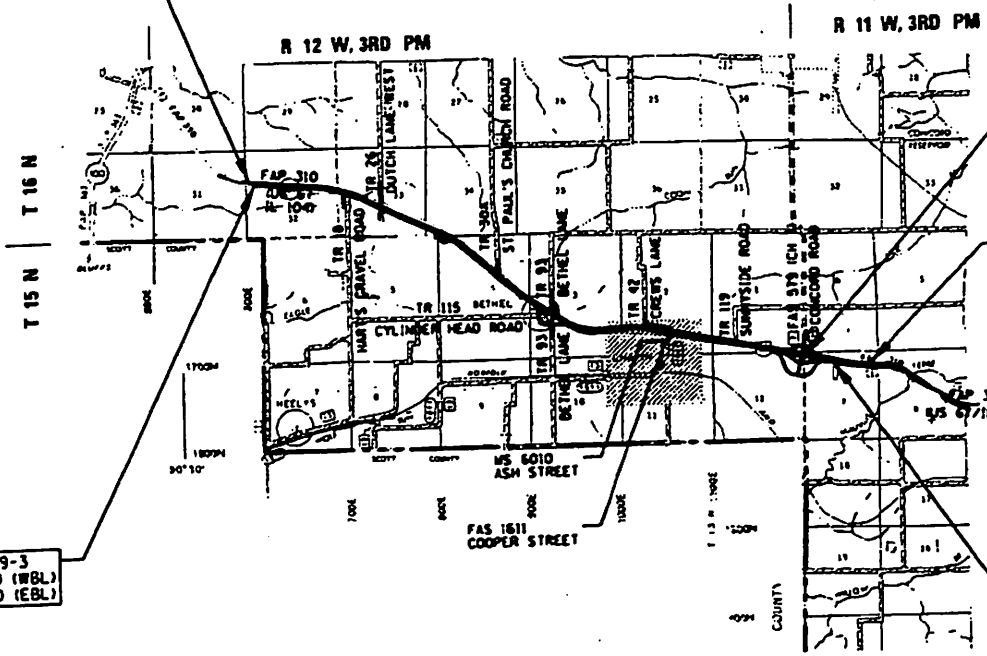



**Illinois Department  
of Transportation**

*EXHIBIT B*

**Local Agency-State  
Jurisdictional Transfer**

Local Agency	Type of Systems Transfer	
	Type 1	Type 2
Municipality: <u>Chapin</u>	From: State Highway System To: Local Highway System	From: Local Highway System To: State Highway System
Township/Road District:		
County:	Indicate Type of Systems Transfer: Type 1	
Section Number: <u>69-3 (3HB)</u>		

The above local agency, and the State of Illinois, acting by and through its Department of Transportation, agree to transfer the jurisdiction of the designated location in the manner indicated above under Type of Systems Transfer.

**Location Description**

Name Cooper Street Route \_\_\_\_\_ Length 655.83 lin ft  
 Termini sta 442+65.00 to sta 448+56.24 south of US 67 and from sta 451+07.48 to the south thru edge of pavement of  
Crews Lane at sta 451+72.07 in its entirety.

This transfer  does  does not include Structure No. N/A

This transfer  does  does not include a transfer to land rights (4-508). If it does, attach letter of intent approved by the department.

HEREAS, the authority to enter into this contract is granted the STATE by Section 4-409 of the Illinois Highway Code and the authority to make changes in the State Highway System is granted the State under Section 2-101 of the Illinois Highway Code.

**Include for Municipalities Only**

HEREAS, the authority to make changes to the Municipal Street System is granted to the Municipality by Section 7-101 of the Illinois Highway Code.

AND WHEREFORE IT IS AGREED that the corporate authority of said municipality will pass an ordinance providing for the transfer of the above location and shall attach hereto and make a part hereof a copy of a location map as Addendum No. 1 and a copy of the ordinance as Addendum No. 2, and

**Include for Counties Only**

HEREAS, the authority to make changes to the County Highway System is granted to the County by Section 5-105 of the Illinois Highway Code.

AND WHEREFORE IT IS AGREED that the County Board of said County will pass a resolution providing for the transfer of the above location and shall attach hereto and make a part hereof a copy of a location map as Addendum No. 1 and a copy of the resolution as Addendum No. 2, and

**Include for Township/Road Districts Only**

HEREAS, the authority to make changes to the Township/Road District System is granted to the Highway Commissioner under Section 6-201.3 of the Illinois Highway Code and said Highway Commissioner shall attach hereto and make a part hereof a copy of a location map as Addendum No. 1, and

THE PARTIES HERETO MUTUALLY AGREED, that this jurisdictional transfer will become effective 21 calendar days after:

- Check one)
- Final Inspection by the State (Type A)
  - Acceptance by the State
  - Execution of Agreement
  - Approval of Land Conveyance
  - Other: \_\_\_\_\_

**Supplements**

Additional information and/or stipulations, if any, are hereby attached and identified below as being a part of this jurisdictional transfer.

Supplement Location Map marked Exhibit I 1-4 ; B-1  
 (Insert supplement numbers of letters and page numbers, if applicable.)

THE PARTIES HERETO FURTHER AGREED, that the provisions of this jurisdictional transfer shall be binding and inure to the benefit of the parties hereto, their successors and assigns.



**Illinois Department of Transportation**

*EXHIBIT C*

**Local Agency-State Jurisdictional Transfer**

Local Agency		Type of Systems Transfer	
Municipality:	Chapin	Type 1	Type 2
Township/Road District:		From: State Highway System	From: Local Highway System
County:		To: Local Highway System	To: State Highway System
Section Number:	69-3 (3HB)	Indicate Type of Systems Transfer: Type 1	

The above local agency, and the State of Illinois, acting by and through its Department of Transportation, agree to transfer the jurisdiction of the designated location in the manner indicated above under Type of Systems Transfer.

**Location Description**

Name New Street Route \_\_\_\_\_ Length 1,311.25 lin ft (0.25 mi)  
 Termini sta 300+12.00 to sta 313+23.25  
 \_\_\_\_\_ in its entirety.

This transfer  does  does not include Structure No. N/A

The transfer  does  does not include a transfer to land rights (4-508). If it does, attach letter of intent approved by the department.

WHEREAS, the authority to enter into this contract is granted the STATE by Section 4-409 of the Illinois Highway Code and the authority to make changes in the State Highway System is granted the State under Section 2-101 of the Illinois Highway Code.

**Include for Municipalities Only**

HEREAS, the authority to make changes to the Municipal Street System is granted to the Municipality by Section 7-101 of the Illinois Highway Code.

AND WHEREFORE IT IS AGREED that the corporate authority of said municipality will pass an ordinance providing for the transfer of the above location and shall attach hereto and make a part hereof a copy of a location map as Addendum No. 1 and a copy of the ordinance as Addendum No. 2, and

**Include for Counties Only**

HEREAS, the authority to make changes to the County Highway System is granted to the County by Section 5-105 of the Illinois Highway Code.

AND WHEREFORE IT IS AGREED that the County Board of said County will pass a resolution providing for the transfer of the above location and shall attach hereto and make a part hereof a copy of a location map as Addendum No. 1 and a copy of the resolution as Addendum No. 2, and

**Include for Township/Road Districts Only**

HEREAS, the authority to make changes to the Township/Road District System is granted to the Highway Commissioner under Section 6-201.3 of the Illinois Highway Code and said Highway Commissioner shall attach hereto and make a part hereof a copy of a location map as Addendum No. 1, and

THE PARTIES HERETO ARE MUTUALLY AGREED, that this jurisdictional transfer will become effective 21 calendar days after:

- Check one)
- |   |  |
|---|--|
| <input type="checkbox"/> Final Inspection by the State (Type A) | <input type="checkbox"/> Execution of Agreement      |
| <input type="checkbox"/> Acceptance by the State                | <input type="checkbox"/> Approval of Land Conveyance |
|   | <input type="checkbox"/> Other: _____                |

**Supplements**

Additional information and/or stipulations, if any, are hereby attached and identified below as being a part of this jurisdictional transfer.

Supplement Location Map marked Exhibit I 1-4; C-1  
 (Insert supplement numbers or letters and page numbers, if applicable.)

THE PARTIES HERETO ARE FURTHER AGREED, that the provisions of this jurisdictional transfer shall be binding and inure to the benefit of the parties hereto, their successors and assigns.



**Illinois Department of Transportation**

*EXHIBIT D*

**Local Agency-State Jurisdictional Transfer**

Local Agency	Type of Systems Transfer	
Municipality: <u>Chapin</u>	Type 1	Type 2
Township/Road District:	From: State Highway System	From: Local Highway System
County:	To: Local Highway System	To: State Highway System
Section Number: <u>69-3 (3HB)</u>	Indicate Type of Systems Transfer: <u>Type 1</u>	

The above local agency, and the State of Illinois, acting by and through its Department of Transportation, agree to transfer the jurisdiction of the designated location in the manner indicated above under **Type of Systems Transfer**.

**Location Description**

Name Ash Street Route \_\_\_\_\_ Length 738 lin ft  
 Termini sta 2+50.00 to sta 9+88.00  
 \_\_\_\_\_ in its entirety

This transfer  does  does not include Structure No. N/A

The transfer  does  does not include a transfer to land rights (4-508). If it does, attach letter of intent approved by the department.

WHEREAS, the authority to enter into this contract is granted the STATE by Section 4-409 of the Illinois Highway Code and the authority to make changes in the State Highway System is granted the State under Section 2-101 of the Illinois Highway Code.

**Include for Municipalities Only**

WHEREAS, the authority to make changes to the Municipal Street System is granted to the Municipality by Section 7-101 of the Illinois Highway Code.

NOW HEREOFRE IT IS AGREED that the corporate authority of said municipality will pass an ordinance providing for the transfer of the above location and shall attach hereto and make a part hereof a copy of a location map as Addendum No. 1 and a copy of the ordinance as Addendum No. 2, and

**Include for Counties Only**

WHEREAS, the authority to make changes to the County Highway System is granted to the County by Section 5-105 of the Illinois Highway Code.

NOW THEREFORE IT IS AGREED that the County Board of said County will pass a resolution providing for the transfer of the above location and shall attach hereto and make a part hereof a copy of a location map as Addendum No. 1 and a copy of the resolution as Addendum No. 2, and

**Include for Township/Road Districts Only**

WHEREAS, the authority to make changes to the Township/Road District System is granted to the Highway Commissioner under Section 6-201.3 of the Illinois Highway Code and said Highway Commissioner shall attach hereto and make a part hereof a copy of a location map as Addendum No. 1, and

IT IS MUTUALLY AGREED, that this jurisdictional transfer will become effective 21 calendar days after:

- Week one)
- Final Inspection by the State (Type A)  Execution of Agreement
  - Acceptance by the State  Approval of Land Conveyance
  - Other: \_\_\_\_\_

**Supplements**

Additional information and/or stipulations, if any, are hereby attached and identified below as being a part of this jurisdictional transfer.

Attachment Location Map labeled EXHIBIT I 1-4 ; D-1  
 (Insert supplement numbers of letters and page numbers, if applicable.)

IT IS FURTHER AGREED, that the provisions of this jurisdictional transfer shall be binding and inure to the benefit of the parties hereto, their successors and assigns.





Local Agency	Type of Systems Transfer	
Municipality: Chapin	Type 1	Type 2
Township/Road District:	From: State Highway System	From: Local Highway System
County:	To: Local Highway System	To: State Highway System
Section Number: 69-3 (3HB)	Indicate Type of Systems Transfer: Type <u>A</u>	

The above local agency, and the State of Illinois, acting by and through its Department of Transportation, agree to transfer the jurisdiction of the designated location in the manner indicated above under Type of Systems Transfer.

Location Description

Name Crews Lane Route \_\_\_\_\_ Length 1845.75 lin ft (0.35 mi)  
Termini sta 38+57.25 to sta 57+03.00.00  
\_\_\_\_\_ in its entirety.

This transfer  does  does not include Structure No. N/A

The transfer  does  does not include a transfer to land rights (4-508). If it does, attach letter of intent approved by the Department.

WHEREAS, the authority to enter into this contract is granted the STATE by Section 4-409 of the Illinois Highway Code and the authority to make changes in the State Highway System is granted the State under Section 2-101 of the Illinois Highway Code.

Include for Municipalities Only

WHEREAS, the authority to make changes to the Municipal Street System is granted to the Municipality by Section 7-101 of the Illinois Highway Code.

WHEREFORE IT IS AGREED that the corporate authority of said municipality will pass an ordinance providing for the transfer of the above location and shall attach hereto and make a part hereof a copy of a location map as Addendum No. 1 and a copy of the ordinance as Addendum No. 2, and

Include for Counties Only

WHEREAS, the authority to make changes to the County Highway System is granted to the County by Section 5-105 of the Illinois Highway Code.

NOW THEREFORE IT IS AGREED that the County Board of said County will pass a resolution providing for the transfer of the above location and shall attach hereto and make a part hereof a copy of a location map as Addendum No. 1 and a copy of the resolution as Addendum No. 2, and

Include for Township/Road Districts Only

WHEREAS, the authority to make changes to the Township/Road District System is granted to the Highway Commissioner under Section 6-201.3 of the Illinois Highway Code and said Highway Commissioner shall attach hereto and make a part hereof a copy of a location map as Addendum No. 1, and

IS MUTUALLY AGREED, that this jurisdictional transfer will become effective 21 calendar days after:

- Check one)
  - Final Inspection by the State (Type A)
  - Execution of Agreement
  - Acceptance by the State
  - Approval of Land Conveyance
  - Other: \_\_\_\_\_

Supplements

Additional information and/or stipulations, if any, are hereby attached and identified below as being a part of this jurisdictional transfer.

Attachment Location Map labeled EXHIBIT E 1-4; E1,2  
(Insert supplement numbers of letters and page numbers, if applicable.)

IS FURTHER AGREED, that the provisions of this jurisdictional transfer shall be binding and inure to the benefit of the parties hereto, their successors and assigns.



Local Agency		Type of Systems Transfer	
Municipality:	Chapin	Type 1	Type 2
Township/Road District:		From: State Highway System	From: Local Highway System
County:		To: Local Highway System	To: State Highway System
Section Number:	69-3 (3HB)	Indicate Type of Systems Transfer: Type 1	

The above local agency, and the State of Illinois, acting by and through its Department of Transportation, agree to transfer the jurisdiction of the designated location in the manner indicated above under Type of Systems Transfer.

Location Description

Name New Frontage Road Route \_\_\_\_\_ Length 5995.09 lin ft (1.14 mi)  
Termini at the new interchange at Concord Road from sta 97+85.00 to sta 85+28.86 and sta 6+80.47 to sta 53+05.00  
and sta 49+64.42 to sta 48+50.00 in its entirety.

This transfer  does  does not include Structure No. n/a

The transfer  does  does not include a transfer to land rights (4-508). If it does, attach letter of intent approved by the Department.

WHEREAS, the authority to enter into this contract is granted the STATE by Section 4-409 of the Illinois Highway Code and the authority to make changes in the State Highway System is granted the State under Section 2-101 of the Illinois Highway Code.

Include for Municipalities Only

WHEREAS, the authority to make changes to the Municipal Street System is granted to the Municipality by Section 7-101 of the Illinois Highway Code.

NOW THEREFORE IT IS AGREED that the corporate authority of said municipality will pass an ordinance providing for the transfer of the above location and shall attach hereto and make a part hereof a copy of a location map as Addendum No. 1 and a copy of the ordinance as Addendum No. 2, and

Include for Counties Only

WHEREAS, the authority to make changes to the County Highway System is granted to the County by Section 5-105 of the Illinois Highway Code.

NOW THEREFORE IT IS AGREED that the County Board of said County will pass a resolution providing for the transfer of the above location and shall attach hereto and make a part hereof a copy of a location map as Addendum No. 1 and a copy of the resolution as Addendum No. 2, and

Include for Township/Road Districts Only

WHEREAS, the authority to make changes to the Township/Road District System is granted to the Highway Commissioner under Section 6-201.3 of the Illinois Highway Code and said Highway Commissioner shall attach hereto and make a part hereof a copy of a location map as Addendum No. 1, and

THE PARTIES ARE MUTUALLY AGREED, that this jurisdictional transfer will become effective 21 calendar days after:

- Check one)
- Final Inspection by the State (Type A)
  - Acceptance by the State
  - Execution of Agreement
  - Approval of Land Conveyance
  - Other: \_\_\_\_\_

Supplements

Additional information and/or stipulations, if any, are hereby attached and identified below as being a part of this jurisdictional transfer.

Attachment Location Map labeled EXHIBIT I 1-4;  
(Inser supplement numbers of letters and page numbers, if applicable.)

THE PARTIES ARE FURTHER AGREED, that the provisions of this jurisdictional transfer shall be binding and inure to the benefit of the parties hereto, their successors and assigns.



**Illinois Department of Transportation**

*EXHIBIT G*

**Local Agency-State Jurisdictional Transfer**

Local Agency	Type of Systems Transfer	
Municipality: Chapin	Type 1	Type 2
Township/Road District:	From: State Highway System	From: Local Highway System
County:	To: Local Highway System	To: State Highway System
Section Number: 69-3 (3HB)	Indicate Type of Systems Transfer: Type A	

The above local agency, and the State of Illinois, acting by and through its Department of Transportation, agree to transfer the jurisdiction of the designated location in the manner indicated above under Type of Systems Transfer.

**Location Description**

Name Old US 67/ IL 104 Route \_\_\_\_\_ Length 3134.00 lin ft (0.59 mi)  
 Termini sta 556+00.00 to sta 573+75.00 and from sta 578+95.00 to sta 592+54.00  
 \_\_\_\_\_ in its entirety.

This transfer  does  does not include Structure No. N/A

The transfer  does  does not include a transfer to land rights (4-508). If it does, attach letter of intent approved by the department.

WHEREAS, the authority to enter into this contract is granted the STATE by Section 4-409 of the Illinois Highway Code and the authority to make changes in the State Highway System is granted the State under Section 2-101 of the Illinois Highway Code.

**Include for Municipalities Only**

WHEREAS, the authority to make changes to the Municipal Street System is granted to the Municipality by Section 7-101 of the Illinois Highway Code.

NOW, WHEREFORE IT IS AGREED that the corporate authority of said municipality will pass an ordinance providing for the transfer of the above location and shall attach hereto and make a part hereof a copy of a location map as Addendum No. 1 and a copy of the ordinance as Addendum No. 2, and

**Include for Counties Only**

WHEREAS, the authority to make changes to the County Highway System is granted to the County by Section 5-105 of the Illinois Highway Code.

NOW THEREFORE IT IS AGREED that the County Board of said County will pass a resolution providing for the transfer of the above location and shall attach hereto and make a part hereof a copy of a location map as Addendum No. 1 and a copy of the resolution as Addendum No. 2, and

**Include for Township/Road Districts Only**

WHEREAS, the authority to make changes to the Township/Road District System is granted to the Highway Commissioner under Section 6-201.3 of the Illinois Highway Code and said Highway Commissioner shall attach hereto and make a part hereof a copy of a location map as Addendum No. 1, and

IT IS MUTUALLY AGREED, that this jurisdictional transfer will become effective 21 calendar days after:

- Check one)
- Final Inspection by the State (Type A)
  - Execution of Agreement
  - Acceptance by the State
  - Approval of Land Conveyance
  - Other: \_\_\_\_\_

**Supplements**

Additional information and/or stipulations, if any, are hereby attached and identified below as being a part of this jurisdictional transfer.

Attachment Location Map labeled EXHIBIT I 1-4 ; F-1 to F-4  
 (Insert supplement numbers of letters and page numbers, if applicable.)

IT IS FURTHER AGREED, that the provisions of this jurisdictional transfer shall be binding and inure to the benefit of the parties hereto, their successors and assigns.



**Illinois Department of Transportation**

*EXHIBIT H*

**Local Agency-State Jurisdictional Transfer**

Local Agency		Type of Systems Transfer	
Municipality:	Chapin	Type 1	Type 2
Township/Road District:		From: State Highway System	From: Local Highway System
County:		To: Local Highway System	To: State Highway System
Section Number:	69-3 (3HB)	Indicate Type of Systems Transfer: Type 1	

The above local agency, and the State of Illinois, acting by and through its Department of Transportation, agree to transfer the jurisdiction of the designated location in the manner indicated above under Type of Systems Transfer.

**Location Description**

Name New Frontage Road Route \_\_\_\_\_ Length 1442.61 lin ft (0.27 mi)  
 Termini in Bethel from sta 510+25.39 to sta 524+68.00  
 \_\_\_\_\_ in its entirety

This transfer  does  does not include Structure No. n/a

The transfer  does  does not include a transfer to land rights (4-508). If it does, attach letter of intent approved by the Department.

WHEREAS, the authority to enter into this contract is granted the STATE by Section 4-409 of the Illinois Highway Code and the authority to make changes in the State Highway System is granted the State under Section 2-101 of the Illinois Highway Code.

**Include for Municipalities Only**

WHEREAS, the authority to make changes to the Municipal Street System is granted to the Municipality by Section 7-101 of the Illinois Highway Code.

NOW THEREFORE IT IS AGREED that the corporate authority of said municipality will pass an ordinance providing for the transfer of the above location and shall attach hereto and make a part hereof a copy of a location map as Addendum No. 1 and a copy of the ordinance as Addendum No. 2, and

**Include for Counties Only**

WHEREAS, the authority to make changes to the County Highway System is granted to the County by Section 5-105 of the Illinois Highway Code.

NOW THEREFORE IT IS AGREED that the County Board of said County will pass a resolution providing for the transfer of the above location and shall attach hereto and make a part hereof a copy of a location map as Addendum No. 1 and a copy of the resolution as Addendum No. 2, and

**Include for Township/Road Districts Only**

WHEREAS, the authority to make changes to the Township/Road District System is granted to the Highway Commissioner under Section 6-201.3 of the Illinois Highway Code and said Highway Commissioner shall attach hereto and make a part hereof a copy of a location map as Addendum No. 1, and

IT IS MUTUALLY AGREED, that this jurisdictional transfer will become effective 21 calendar days after:

check one)

- Final Inspection by the State (Type A)
- Acceptance by the State

- Execution of Agreement
- Approval of Land Conveyance
- Other: \_\_\_\_\_

**Supplements**

Additional information and/or stipulations, if any, are hereby attached and identified below as being a part of this jurisdictional transfer.

Attachment Location Map labeled EXHIBIT I 1-4  
 (Insert supplement numbers of letters and page numbers, if applicable.)

IT IS FURTHER AGREED, that the provisions of this jurisdictional transfer shall be binding and inure to the benefit of the parties hereto, their successors and assigns.