

GOGEBIC COUNTY ROAD COMMISSION
2019 HMA PATCH PAVING SERVICES BID

Bid of _____ (hereinafter called "BIDDER"), organized and existing under the laws of the State of _____ doing business as _____*, to the Gogebic County Road Commission (hereinafter called "OWNER").

In compliance with your Advertisement for Bids, BIDDER hereby proposes to perform all work for the construction of 2019 HMA Patch Paving Services in accordance with the Contract Documents, within the time set forth herein, and at the prices stated below.

1. NOTICE TO BIDDERS

GCRC Bidding Instructions

The intent of the bid is to include all paving projects scheduled for work in Gogebic County. This includes areas of culvert patches and deteriorated areas. All work described below (including Measurement and Payment) shall be as described in the MDOT "2012 Standard Specifications for Construction" (Standard Specifications), except as modified herein. Mobilization shall be included in the bid items presented and will not be paid for separately.

Additional projects may be added to the proposal by the road commission as they arise throughout the summer. Negotiated cost will be agreed upon prior to any additional work being completed.

2. DESCRIPTION OF WORK

Machine Grading

After the maintenance gravel is removed to a depth of 3 inches relative to the adjacent roadway (Except for Planter Road – which will be 4 inches), the remaining gravel shall be graded and compacted. Patches will be saw cut by Contractor.

Machine Grading shall be paid for by the Syd, measured from shoulder hinge point to hinge point.

HMA, LVSP

HMA, LVSP shall include temporary maintenance gravel material, maintenance, and removal at the Patches between when the existing HMA is removed and the new HMA is paved.

The work shall consist of HMA, LVSP as shown in the typical sections. The work shall begin at Station 0+00 and run the entire length of the project. The work shall be completed in accordance with section 501 of the Standard Specifications for Construction. Refer to Special provision for Local Paving Project as attached.

1. For mainline paving projects – HMA application rate shall be two lifts at 165#/syd each (330# per syd total) paid by tons.
2. Planter Road: HMA application rate shall be two lifts at 220#/syd each (440# per syd total) paid by tons.
3. For overlay projects – HMA application rate shall be single lift at 220#/syd total paid by tons.
4. Performance Grade Asphalt shall be PG 52-34
5. Air Voids per MDOT Special Provision for Local Agency Projects 12SP-501J-05.

Maintaining Traffic, Minor Traffic Devices, Traffic Regulator Control, and Signage

Contractor shall be responsible for maintaining traffic, minor traffic devices, traffic regulator control and signage for the Contractor operation. Advance warning signage shall be in accordance with MDOT specification for lane closure or as agreed upon by the Engineer and Contractor. Traffic Regulator Control shall be provided during the operation of work with minor traffic devices used during construction and after working hours to provide safe travelable roadway for the public.

All Patches shall be constructed under traffic.

3. PROGRESS CLAUSE

Start work within ten (10) days after receiving notice of award of the contract or on or before the date designated as the starting date in the Detailed Progress Schedule. In no case, shall any work be commenced prior to receipt of formal notice of award by the department.

Completion Dates

All projects shall be completed in its entirety on or before **September 15, 2019**.

The approved low bidder(s) for the work covered by this proposal will be required to participate in a pre-construction meeting with local agency owner and/or department representatives to work out a detailed progress schedule. The schedule for this meeting will be set within one week after the contract is awarded.

The Gogebic County Road Commission will arrange the time and place for the meeting.

The Progress Schedule shall include, as a minimum, the controlling work items for the completion of the project and the planned dates (or work day for a work day project) that these work items will be controlling operations. When specified in the bidding proposal, the date the project is to be opened to traffic as well as the final project completion date shall also be included in the project schedule.

If the bidding proposal specifies other controlling dates, these shall also be included in the Progress Schedule.

4. METHOD OF MEASUREMENT AND PAYMENT

Measurement and payment shall be on the basis of the measured square yard, load ticket tonnage or lump sum quantities. The contractor shall measure the area with the Road Commission and submit an invoice for agreed quantity upon completion of all work.

6. BID DEADLINE

Sealed bids for the 2019 HMA Patch Paving Services will be received by the Gogebic County Road Commission, Courthouse Annex, Bessemer, MI 49911 until **11:00 A.M., central time on Tuesday, May 28, 2019**. All bids shall be publicly opened and read aloud at said office at that time.

7. INSURANCE

The Contractor shall not commence any work until they have obtained and provided a current Certificate of Insurance.

The Contractor shall carry "Public Liability Insurance" coverage to insure the Road Commission against claims arising out of negligence of the Contractor. The insurances shall meet all requirements as shown:

A. WORKERS COMPENSATION INSURANCE

The Contractor shall take out and maintain during the life of this contract, Workman's Compensation insurance for all of his employees employed at the site of the project and in case work is sub-contracted, the Contractor shall require the sub-contractor similarly to provide Workman's compensation insurance for all of the latter employees unless such employees are covered by the protection afforded by the Contractor.

State:	Statutory
Applicable Federal (e.g., Longshoreman's):	Statutory

* Insert "a corporation", "a partnership" or "an individual", as applicable.

Employer's Liability:	
Bodily Injury by Accident	\$2,000,000 Each Accident
Bodily Injury by Disease	\$2,000,000 Each Employee
Bodily Injury by Disease	\$2,000,000 Policy Limit

B. GENERAL LIABILITY

General Aggregate	\$2,000,000
Products- Completed Operations Aggregate	\$2,000,000
Personal and Advertising Injury	\$2,000,000
Each Occurrence (Bodily Injury and Property Damage)	\$2,000,000

a. Property Damage liability insurance will provide Explosion, Collapse, and Underground coverage where applicable.

b. Excess or Umbrella Liability

1) General Aggregate	\$2,000,000
2) Each Occurrence	\$2,000,000

Bodily Injury

Each Person	\$2,000,000
Each Accident	\$2,000,000

Property Damage:

Each Accident	\$500,000
---------------	-----------

Combines Single Limit (Bodily Injury and Property Damage)

Each Accident	\$2,000,000
---------------	-------------

C. CONTRACTUAL LIABILITY

Bodily Injury:

Each Accident	\$2,000,000
Annual Aggregate	\$2,000,000

Property Damage:

Each Accident	\$2,000,000
Annual Aggregate	\$2,000,000

The Gogebic County Road Commission shall be named as an additional insured, on a primary basis.

D. MOTOR VEHICLE LIABILITY

Bodily Injury Liability Insurance: \$1,000,000 each occurrence

Property Damage Liability Insurance: \$500,000 each occurrence

The BIDDER agrees to perform all described work in the Contract Documents for the following unit and/or lump sum prices. The BIDDER further agrees that the unit and/or lump sum prices include the furnishing of all labor, materials, tool, equipment, utilities, transportation, taxes, fees, etc., required to complete the work in strict accordance with the Contract Documents.

By submission of this Bid, each party thereto certifies as to his/her own organization, that this Bid has been arrived at independently, without consultation, communication or agreement as to any matter relating to this Bid with any other Bidder or with any competitor.

The Board reserves the right to reject or accept any bid or all bids or to waive irregularities and to accept any bid that, in the opinion of the Board, is to the best interest and advantage of the County of Gogebic.

The BIDDER acknowledges receipt of the following Addendum(s):

The BIDDER agrees to perform all described work in the Contract Documents for the following unit and/or lump sum prices. The BIDDER further agrees that the unit and/or lump sum prices include the furnishing of all labor, materials, tool, equipment, utilities, transportation, taxes, fees, etc., required to complete the work in strict accordance with the Contract Documents. The quantity shown in the Bid Schedule is an estimated minimum. If some of the optional sections are selected by the Townships, more will be added to the contract, but to be included in the two mobilizations.

BID SCHEDULE

A) CR 519 South (Bessemer Township ~5 miles south of US-2)

ITEM DESCRIPTION	APPROX QUANTITY	UNIT	UNIT PRICE	BID AMOUNT
Machine Grading	240	Syd		
Shoulder, Cl II, 3 Inch	40	Syd		
HMA Surface Remove	240	Syd		
HMA, LVSP	40	Ton		
Maintaining Traffic	1	Lsum		
TOTAL BID (CR519 South)				

B) Blackjack Road (Bessemer Township ~1 mile north of US-2)

ITEM DESCRIPTION	APPROX QUANTITY	UNIT	UNIT PRICE	BID AMOUNT
Excavation, Earth	32	CY		
Aggregate Base, 8 inch	150	Syd		
Shoulder, Cl II, 3 Inch	25	Syd		
Geotextile, Stabilization	150	Syd		
HMA Surface, Rem	125	Syd		
HMA, LVSP	20	Ton		
Maintaining Traffic	1	Lsum		
TOTAL BID (Blackjack Road)				

C) Prospect Road (Bessemer Township @ north side of US-2 intersection)

ITEM DESCRIPTION	APPROX QUANTITY	UNIT	UNIT PRICE	BID AMOUNT
Machine Grading	330	Syd		
Shoulder, Cl II, 3 Inch	50	Syd		
HMA Surface, Rem	281	Syd		
HMA, LVSP	50	Ton		
Maintaining Traffic	1	Lsum		
TOTAL BID (Prospect Road)				

D) Planter Road (Wakefield Township: 2 locations. 1) west side of CR 519N. 2) east side of Chippewa Drive)

ITEM DESCRIPTION	APPROX QUANTITY	UNIT	UNIT PRICE	BID AMOUNT
Machine Grading	725	Syd	_____	_____
Shoulder, Cl II, 3 Inch	110	Syd	_____	_____
HMA Surface, Rem	625	Syd	_____	_____
HMA, LVSP	140	Ton	_____	_____
Maintaining Traffic	1	Lsum	_____	_____
TOTAL BID (Planter Road)				_____

E) Nylund Road (Ironwood Township: west of Junet Road)

ITEM DESCRIPTION	APPROX QUANTITY	UNIT	UNIT PRICE	BID AMOUNT
Machine Grading	49	Syd	_____	_____
Shoulder, Cl II, 3 Inch	10	Syd	_____	_____
HMA Surface, Rem	49	Syd	_____	_____
HMA, LVSP	8	Ton	_____	_____
Maintaining Traffic	1	Lsum	_____	_____
TOTAL BID (Nylund Road)				_____

F) Piilola Road (Ironwood Township: west of Vanderhagen Road)

ITEM DESCRIPTION	APPROX QUANTITY	UNIT	UNIT PRICE	BID AMOUNT
Machine Grading	49	Syd	_____	_____
Shoulder, Cl II, 3 Inch	10	Syd	_____	_____
HMA Surface, Rem	49	Syd	_____	_____
HMA, LVSP	8	Ton	_____	_____
Maintaining Traffic	1	Lsum	_____	_____
TOTAL BID (Piilola Road)				_____

G) Sunset Road (Ironwood Township: east of Section 12 Road)

ITEM DESCRIPTION	APPROX QUANTITY	UNIT	UNIT PRICE	BID AMOUNT
Machine Grading	49	Syd	_____	_____
Shoulder, Cl II, 3 Inch	10	Syd	_____	_____
HMA Surface, Rem	49	Syd	_____	_____
HMA, LVSP	8	Ton	_____	_____
Maintaining Traffic	1	Lsum	_____	_____
TOTAL BID (Sunset Road)				_____

H) Copper Peak Road (Ironwood Township: < ½ mile NE of Black River Road)

ITEM DESCRIPTION	APPROX QUANTITY	UNIT	UNIT PRICE	BID AMOUNT
Machine Grading	188	Syd	_____	_____
Shoulder, Cl II, 3 Inch	29	Syd	_____	_____
HMA, LVSP	28	Ton	_____	_____
Maintaining Traffic	1	Lsum	_____	_____
TOTAL BID (Copper Peak Road)				_____

I) Riverside Road (Erwin Township: south of Norrie Park Road)

ITEM DESCRIPTION	APPROX QUANTITY	UNIT	UNIT PRICE	BID AMOUNT
Machine Grading	49	Syd	_____	_____
Shoulder, Cl II, 3 Inch	10	Syd	_____	_____
HMA Surface, Rem	49	Syd	_____	_____
HMA, LVSP	8	Ton	_____	_____
Maintaining Traffic	1	Lsum	_____	_____
TOTAL BID (Riverside Road)				_____

J) Powderhorn Road (Bessemer Township: 2 locations. 1) ~0.2 miles north US-2 intersection and 2) ~1.3 miles north of US-2)

ITEM DESCRIPTION	APPROX QUANTITY	UNIT	UNIT PRICE	BID AMOUNT
Machine Grading	173	Syd		
Shoulder, Cl II, 3 Inch	27	Syd		
HMA Surface, Rem	147	Syd		
HMA, LVSP	25	Ton		
Maintaining Traffic	1	Lsum		
TOTAL BID (Powderhorn Road)				

K) Ulvila Road (Wakefield Township: south of Old 2)

ITEM DESCRIPTION	APPROX QUANTITY	UNIT	UNIT PRICE	BID AMOUNT
Machine Grading	49	Syd		
Shoulder, Cl II, 3 Inch	10	Syd		
HMA Surface, Rem	49	Syd		
HMA, LVSP	8	Ton		
Maintaining Traffic	1	Lsum		
TOTAL BID (Ulvila Road)				

L) Curtis Street (Marenisco Township: west of Main Street)

ITEM DESCRIPTION	APPROX QUANTITY	UNIT	UNIT PRICE	BID AMOUNT
Machine Grading	49	Syd		
Shoulder, Cl II, 3 Inch	10	Syd		
HMA Surface, Rem	49	Syd		
HMA, LVSP	8	Ton		
Maintaining Traffic	1	Lsum		
TOTAL BID (Curtis Street)				

M) Camp Ojibway Road (Marenisco Township: east of M-64)

ITEM DESCRIPTION	APPROX QUANTITY	UNIT	UNIT PRICE	BID AMOUNT
Machine Grading	49	Syd	_____	_____
Shoulder, Cl II, 3 Inch	10	Syd	_____	_____
HMA Surface, Rem	49	Syd	_____	_____
HMA, LVSP	8	Ton	_____	_____
Maintaining Traffic	1	Lsum	_____	_____
TOTAL BID (Camp Ojibway Road)				_____

N) Old US2 W (Watersmeet Township: west of Cisco Lake Road)

ITEM DESCRIPTION	APPROX QUANTITY	UNIT	UNIT PRICE	BID AMOUNT
Machine Grading	49	Syd	_____	_____
Shoulder, Cl II, 3 Inch	10	Syd	_____	_____
HMA Surface, Rem	49	Syd	_____	_____
HMA, LVSP	8	Ton	_____	_____
Maintaining Traffic	1	Lsum	_____	_____
TOTAL BID (Old US2 W of Cisco Lake Road)				_____

O) Old US2 W (Watersmeet Township: west of Thousand Island Lake Road)

ITEM DESCRIPTION	APPROX QUANTITY	UNIT	UNIT PRICE	BID AMOUNT
Machine Grading	49	Syd	_____	_____
Shoulder, Cl II, 3 Inch	10	Syd	_____	_____
HMA Surface, Rem	49	Syd	_____	_____
HMA, LVSP	8	Ton	_____	_____
Maintaining Traffic	1	Lsum	_____	_____
TOTAL BID (Old US2 W of Thousand Island Rd)				_____

P) Old US2 W (Watersmeet Township: west of US-2)

ITEM DESCRIPTION	APPROX QUANTITY	UNIT	UNIT PRICE	BID AMOUNT
Machine Grading	49	Syd		
Shoulder, Cl II, 3 Inch	10	Syd		
HMA Surface, Rem	49	Syd		
HMA, LVSP	8	Ton		
Maintaining Traffic	1	Lsum		
TOTAL BID (Old US2 W of US2)				

TOTAL BID ITEMS A - P

The BIDDER declares that he/she has carefully examined the Contract Documents for the Project. The BIDDER declares, by submission of the Bid that the Bid is made according to the provisions and under the terms of the Contract Documents, which Contract Documents are hereby made part of the Bid.

The BIDDER understands that the OWNER reserves the right to reject any or all Bids.

The BIDDER agrees that this Bid shall be good and may not be withdrawn for a period of thirty (30) calendar days after the scheduled closing time for receiving Bids.

IN WITNESS WHEREOF, the undersigned has caused this instrument to be executed (and its seal affixed) by its duly authorized officer this _____ day of _____, 20 ____.

(SEAL)

Signature

Typed name

Title

Attest _____

Bidder Address:

Bidder Phone Number: _____

Bids will be received until **11:00 a.m. (CST) on Tuesday, May 28, 2019**. The Board will accept a fax bid at (906) 663-4807, provided it is followed by receipt of the original signed bid by mail. Bids will be opened and publicly read at the Board Room of the Gogebic County Road Commission office: 200 North More Street, Courthouse Annex, Bessemer, MI 49911. Any bids received after the time and date stated above will not be accepted. The Board reserves the right to reject or accept any bid or all bids or to waive irregularities and to accept any bid that, in the opinion of the Board, is to the best interest and advantage of the County of Gogebic.

Item 1
Riverside Road
(~20'x22')

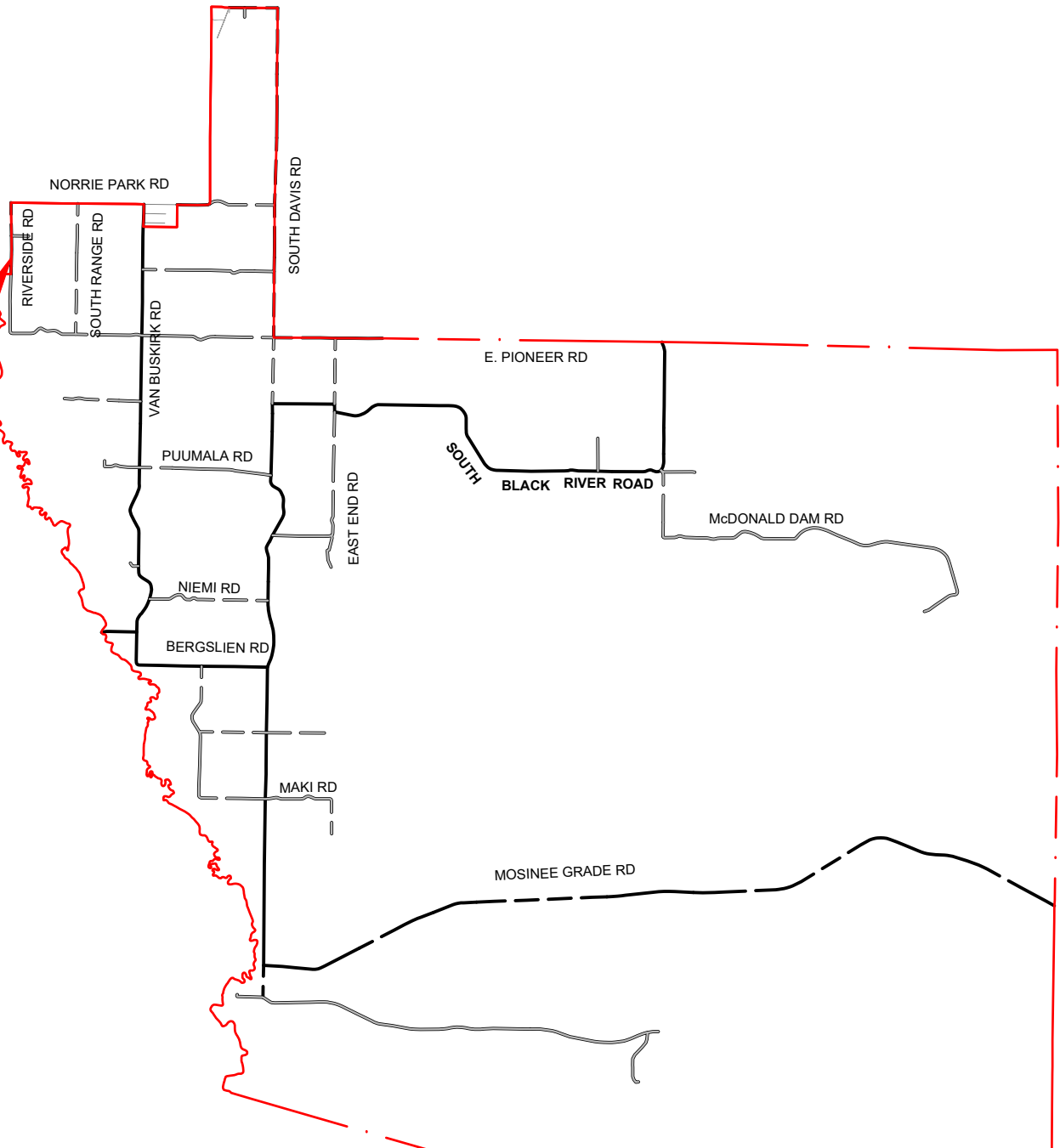

DRAWN BY: MDM	LOCATION <u>ERWIN TOWNSHIP</u>	STATE PROJECT NO.	STATE JOB NO.	COUNTY			SHEET NUMBER
SCALE: NO SCALE	OWNER _____			GOGEBIC			2 OF 6

Item J
Powderhorn Road
(2 Locations)
(~40'x22' and 20'x22')

Item C
Prospect Drive
(~110'x23')

Item A
Chaney Lake Road
(~95'x22')

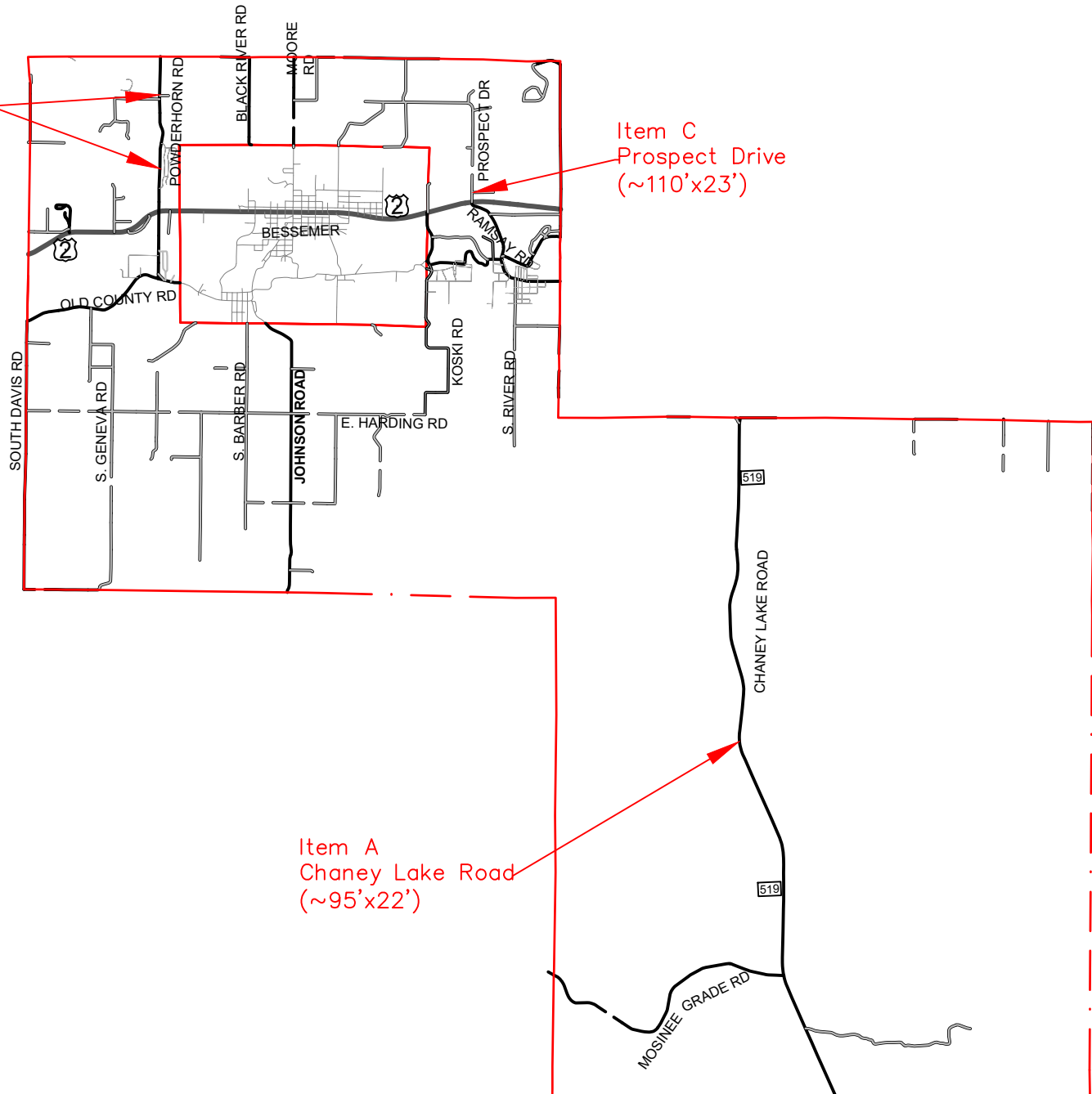

DRAWN BY: MDM	LOCATION <u>BESSEMER TOWNSHIP</u>	STATE PROJECT NO.	STATE JOB NO.	COUNTY			SHEET NUMBER
SCALE: NO SCALE	OWNER _____			GOGEBIC			3 OF 6

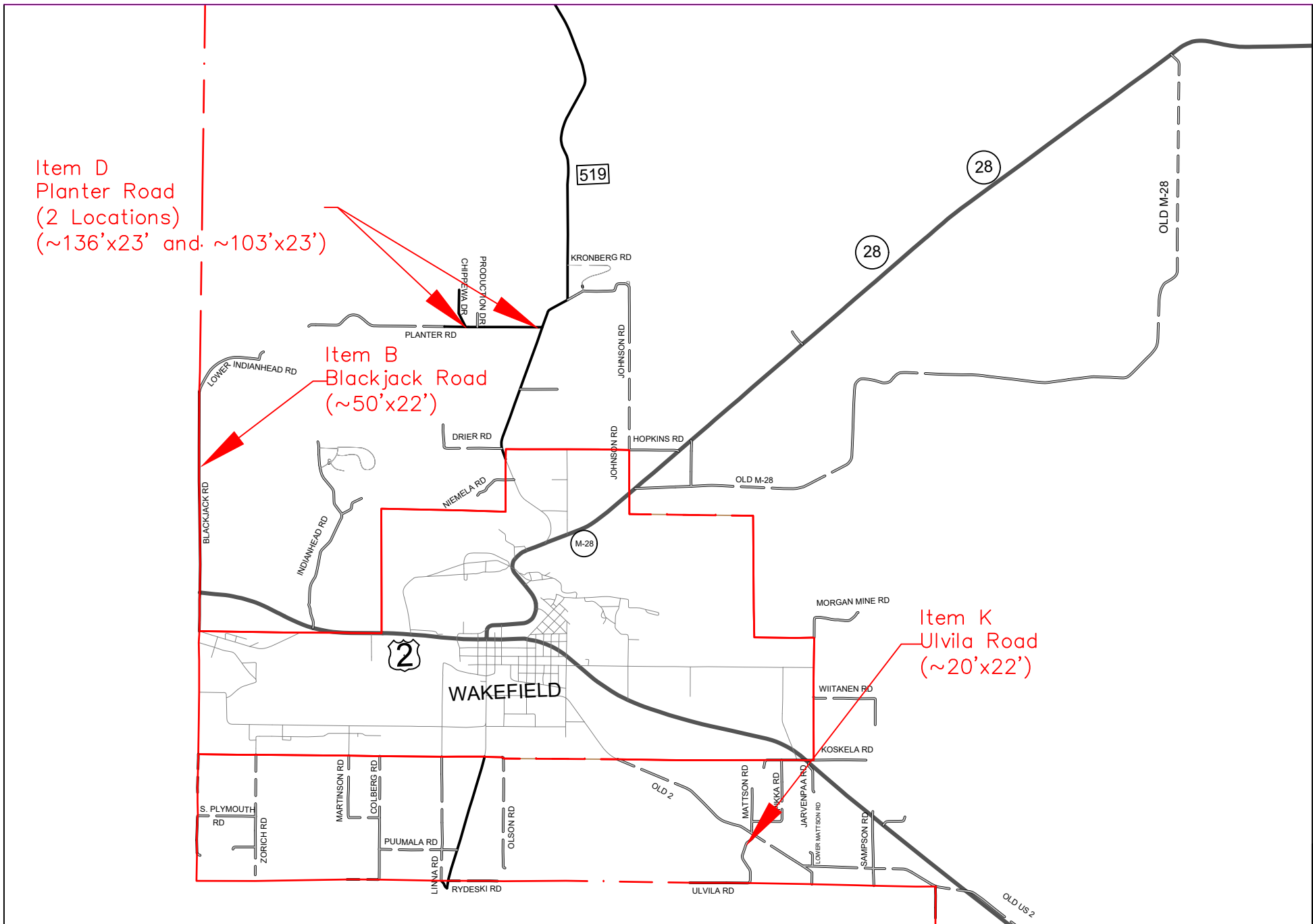

DRAWN BY: MDM	LOCATION WAKEFIELD TOWNSHIP	STATE PROJECT NO.	STATE JOB NO.	COUNTY			SHEET NUMBER
SCALE: NO SCALE	OWNER			GOGEBIC			4 of 6

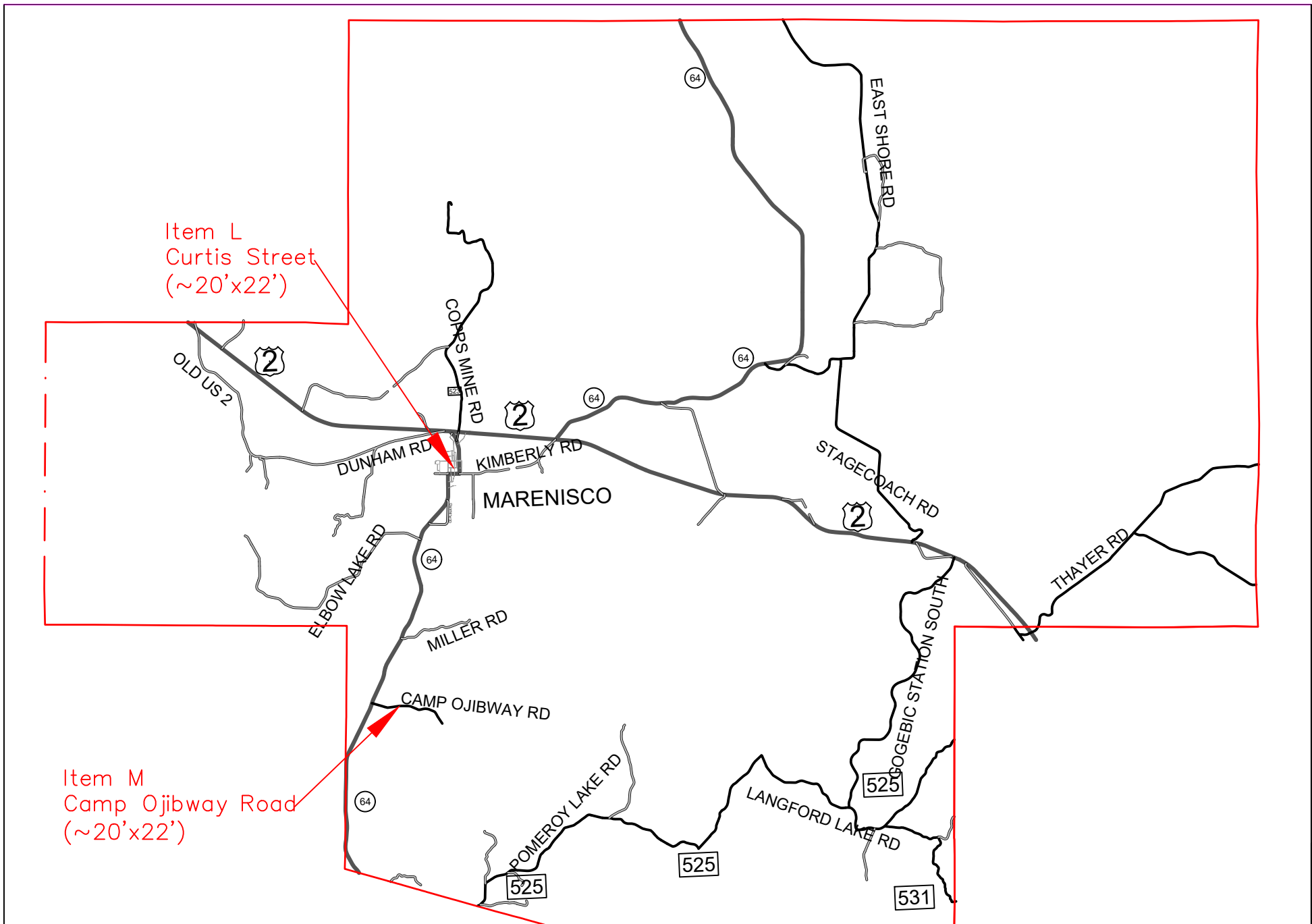

DRAWN BY: MDM	LOCATION MARENISCO TOWNSHIP	STATE PROJECT NO.	STATE JOB NO.	COUNTY			SHEET NUMBER
SCALE: NO SCALE	OWNER						5 OF 6

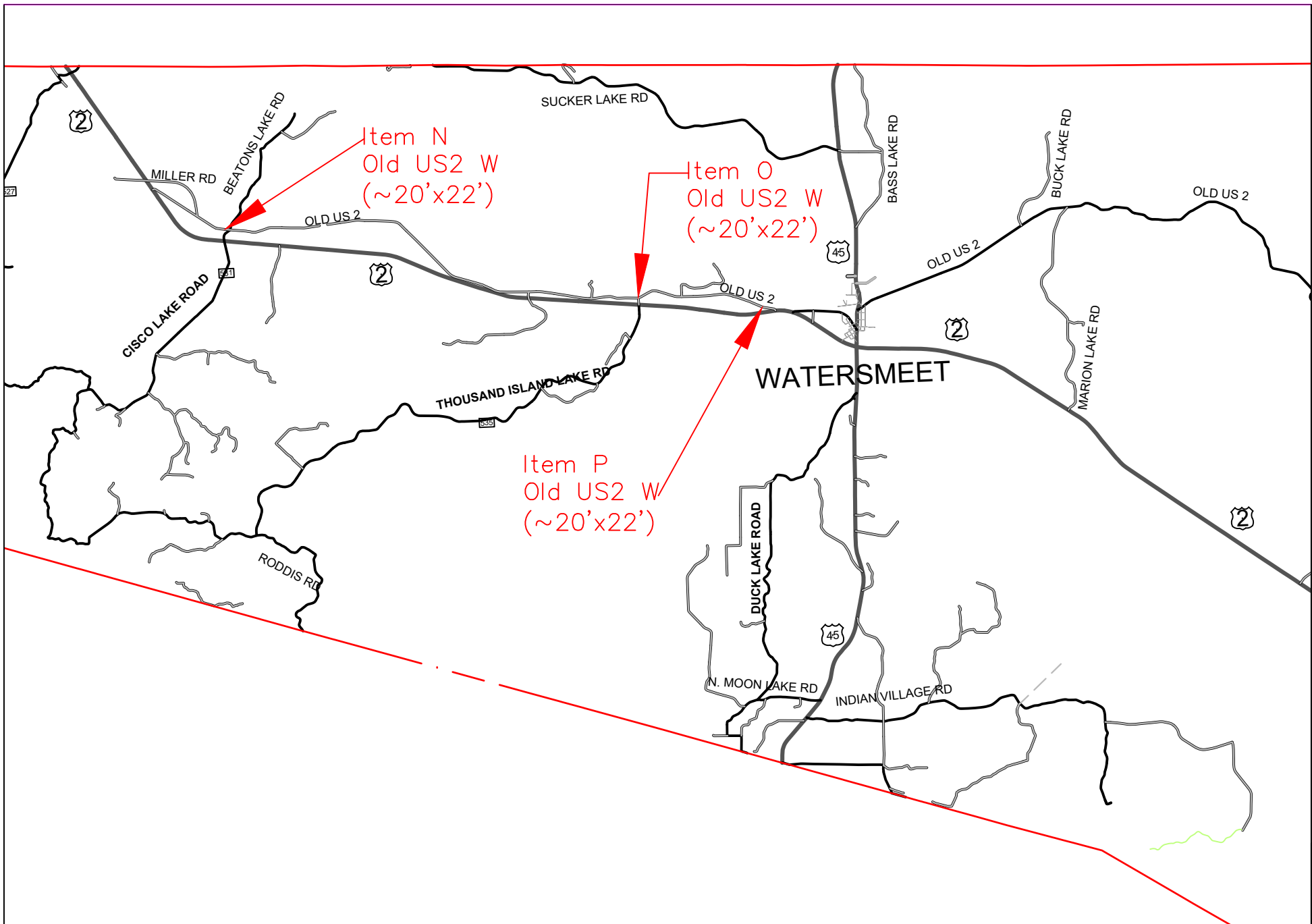

DRAWN BY: MDM	LOCATION <u>WATERSMEET TOWNSHIP</u>	STATE PROJECT NO.	STATE JOB NO.	COUNTY			SHEET NUMBER
SCALE: NO SCALE	OWNER _____						6 OF 6

TYPICAL SECTION

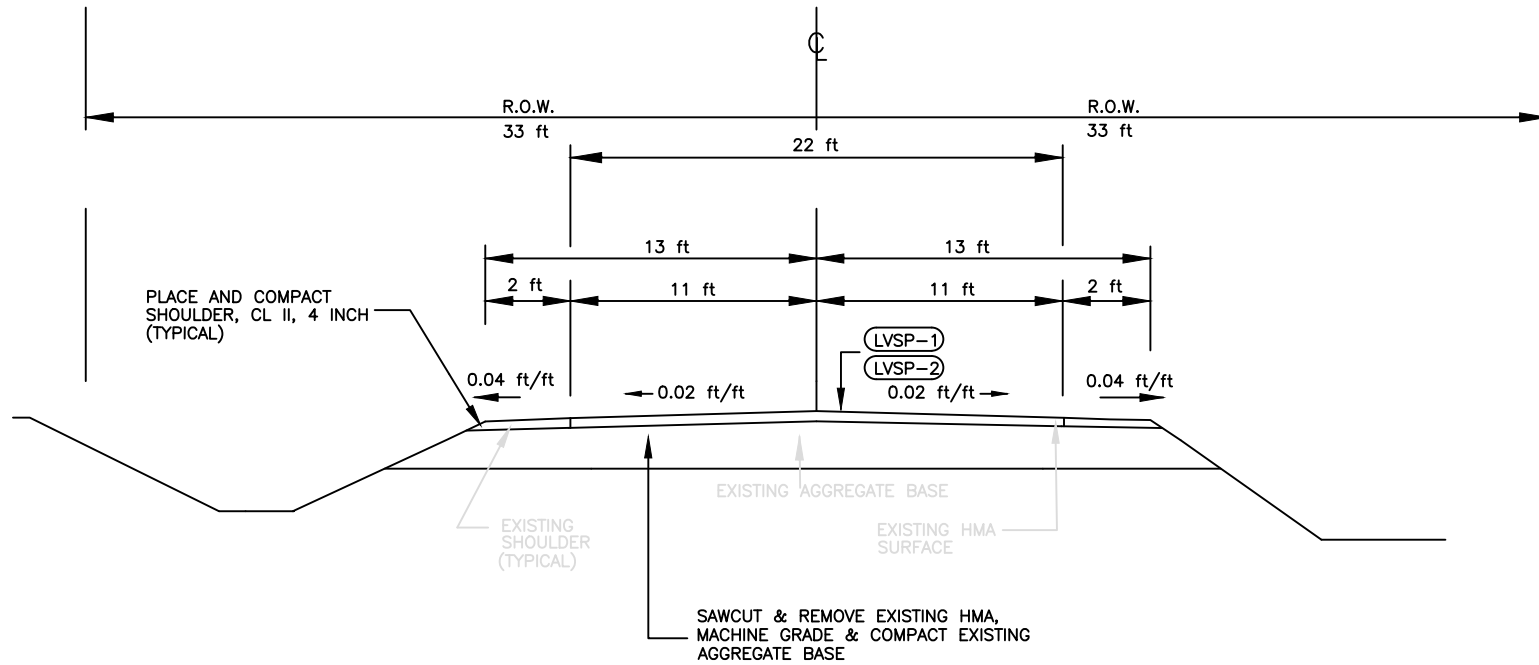

HMA APPLICATION TABLE

NO	ITEM	RATE PER SYD	PERFORMANCE GRADE	REMARKS (FOR INFO. ONLY)
LVSP-1	HMA, LVSP	220 LBS	P.G. 52-34	TOP COURSE
LVSP-2	HMA, LVSP	220 LBS	P.G. 52-34	LEVELING COURSE
	BOND COAT	0.05-0.15 GAL		NOT A PAY ITEM

AWI= 220 MIN.

DRAWN BY: MDM	ROAD NAME PLANTER ROAD	STATE PROJECT NO.	STATE JOB NO.	COUNTY		SHEET NUMBER	TOTAL SHEETS
SCALE: NO SCALE	OWNER			GOGEBIC			

TYPICAL SECTION

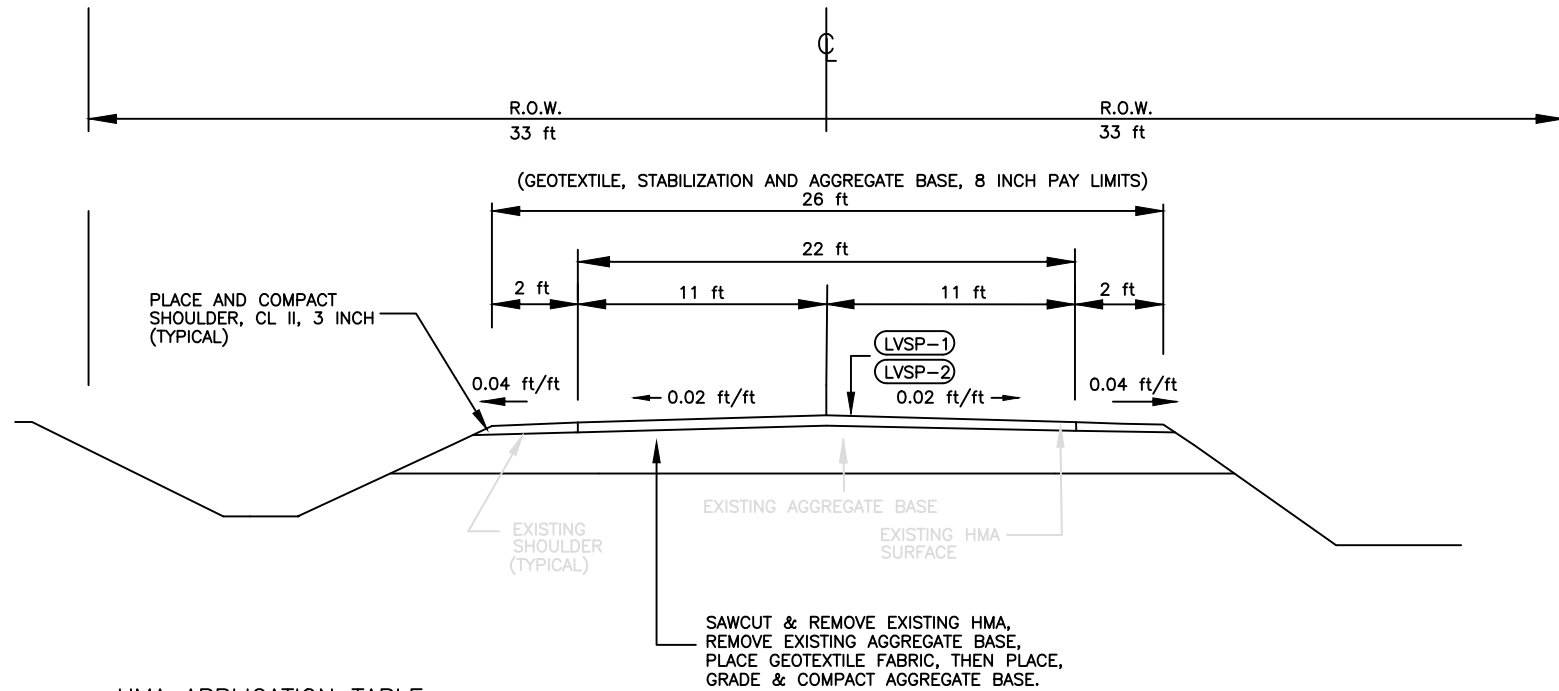

HMA APPLICATION TABLE

NO	ITEM	RATE PER SYD	PERFORMANCE GRADE	REMARKS (FOR INFO. ONLY)
LVSP-1	HMA, LVSP	165 LBS	P.G. 52-34	TOP COURSE
LVSP-2	HMA, LVSP	165 LBS	P.G. 52-34	LEVELING COURSE
	BOND COAT	0.05-0.15 GAL		NOT A PAY ITEM

AWI= 220 MIN.

DRAWN BY: MDM	ROAD NAME BLACKJACK ROAD	STATE PROJECT NO.	STATE JOB NO.	COUNTY		SHEET NUMBER	TOTAL SHEETS
SCALE: NO SCALE	OWNER			GOGEBIC			

TYPICAL SECTION

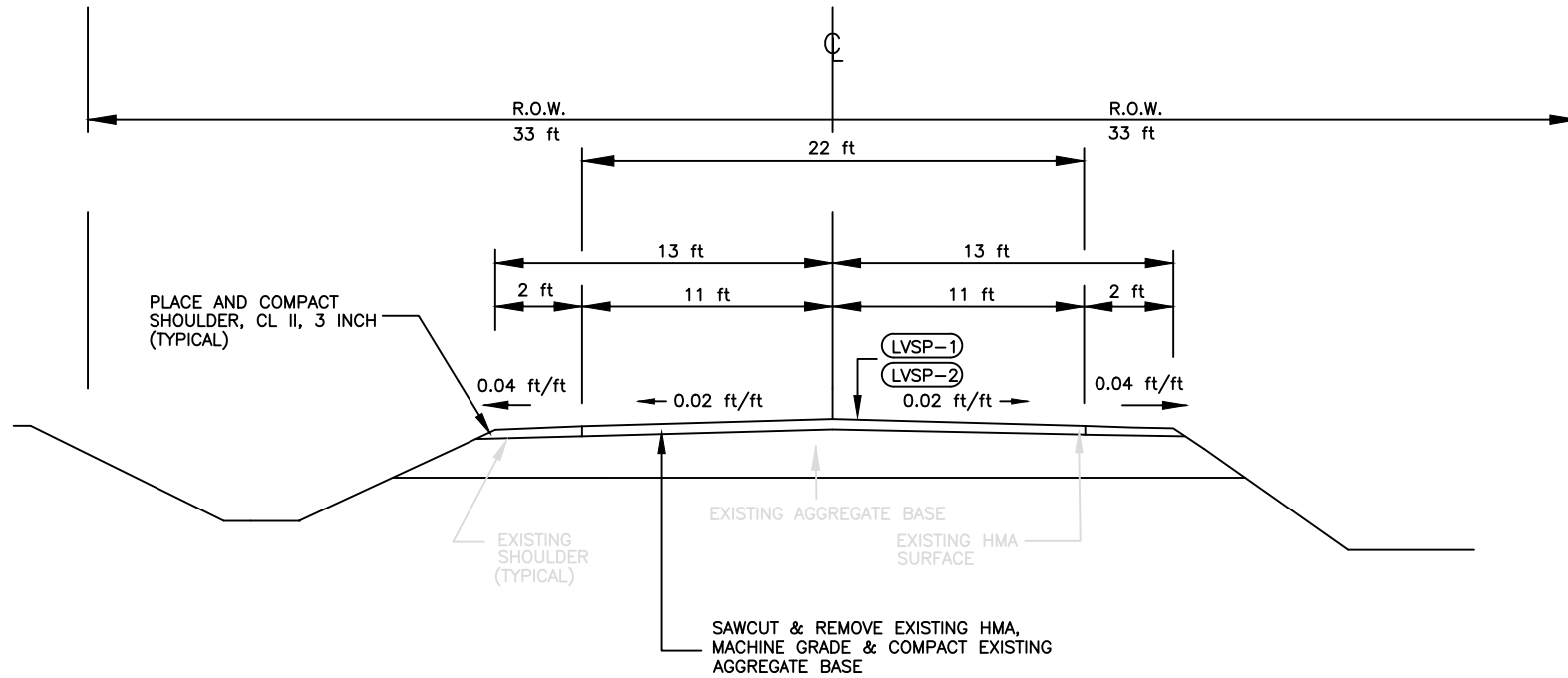

HMA APPLICATION TABLE

NO	ITEM	RATE PER SYD	PERFORMANCE GRADE	REMARKS (FOR INFO. ONLY)
LVSP-1	HMA, LVSP	165 LBS	P.G. 52-34	TOP COURSE
LVSP-2	HMA, LVSP	165 LBS	P.G. 52-34	LEVELING COURSE
	BOND COAT	0.05-0.15 GAL		NOT A PAY ITEM

AWI= 220 MIN.

DRAWN BY: MDM	ROAD NAME _____ ALL OTHER LOCATIONS _____	STATE PROJECT NO.	STATE JOB NO.	COUNTY		SHEET NUMBER	TOTAL SHEETS
SCALE: NO SCALE	OWNER _____			GOGEBIC			