

USEF/USDF #330927
Opening Date: Jan. 15, 2019

This show is a USEF Level 3 Competition
Closing Date: in secretary's hand by Friday, March 1, 2019
Equestrian On-Line Entries Accepted (See Page 3)



PRIZE LIST

The Good Horseman®/Massey Ferguson
Spring Dressage Show

USEF-licensed/USDF-recognized



March 23-24, 2019

Chattahoochee Hills Farm, Fairburn, GA

"Official Qualifying Competition for the 2019 Adequan FEI North American Youth Championships presented by Gotham North; the 2019 Children Dressage National Championship; the 2019 USEF Pony Rider Dressage National Championship; 2019 USEF Junior and Young Rider Dressage National Championships; and the 2019 USEF Young Adult 'Brentina Cup' Dressage National Championship presented by *Dressage Today*. Official Qualifying Competition for the 2019 Markel/USEF Young and Developing Horse Dressage Championships. Official Qualifying Competition for the 2019 FEI World Breeding Championships for Young Horses in Dressage (Five, Six, and Seven Year Olds)."

Also, an official qualifying competition for
***The 2019 Great American Insurance Group/USDF
Regional Championships***

The show features

The \$150 CBH Friesian/Baroque High-Score Awards
\$50 High Point Farm Jr./YR Award
\$50 Jockey Club T.I.P. Award for Thoroughbred Horses
The Still Waters Dressage Musical Freestyle Award
Maggie's Menagerie Holsteiner Award
National Dressage Pony Cup Test of Choice Class
The Through Connection High-Score Awards for Ponies
And The Massey Ferguson Scoreboard

DRESSAGE JUDGES: Sarah Geikie, USEF "S," MA; Beverly Rogers, USEF "S," AZ

USEF TECHNICAL DELEGATE: Joyce Hamblin, KY

SHOW MANAGER (Send entries here.)

Ann Genovese, 4567 Rockbridge Road #297, Pine Lake, GA 30072-0297
404-289-9328 cell; No FAX line—please use e-mail: goodhorseman@att.net
Website: www.goodhorseman.org for show information

SHOW-DAYS SECRETARY: Robin Boggs

SCORER: Kim Boggs Stansell

SAFETY OFFICER: Mark Fornwalt

SCHEDULING/AWARDS: Mary Lou Freil

ANNOUNCER: Anne Dearborn

BRAIDING: Trish Savard, 413-244-3763

EMT: Shane Bell, West Georgia Ambulance Service, 770-832-9689

SCRIBES' COORDINATOR: Danielle Perry, 404-219-1266; revelationfarm1911@gmail.com

NIGHT WATCH: Dennis Boggs, 770-855-7403 (also offers feeding/care service)

VETERINARIANS (ON CALL): Southern Crescent Equine Services, Newnan, GA, 770-252-6860

FARRIERS (ON CALL): Brian Fitzgerald, (310) 625-8712; Kevin Strandin, 678-427-6366;

Stan Davis, 678-410-9449; Jamie Wilcox, 706-248-3260

PROPERTY MANAGER: Hugh Lochore; Assistant: Ed Durden 678-850-0385

AWARDS

Six ribbons will be awarded in each class. First place winners will receive a Good Horseman memento. Winners must pick up mementos and large awards; only ribbons and sashes will be mailed. There must be at least three entries in any division for any division award to be given. All scores (except the awards given by the breed registries) in divisions involving several levels will be "weighted" according to the details below. Weighted scores must reach 60% to be eligible for awards (some sponsored awards may be excepted).

The GHF weighted system: Additional points will be added to scores in the following way: Training Level awarded no additional points: 1st level 1 point; 2nd Level 2 points; 3rd Level 3 points; 4th Level 4 points; FEI-Level 5 points. For the FEI Division: PSG 1 point, Intermediaire I 2 points; Intermediaire A and B 3 points; Intermediaire II 4 points; Grand Prix and Special 5 points.

• **Good Horseman's Cup for High-Scoring Horse:** A special neck sash will be given to the highest-scoring horse in the show age 4 years or older. Weighted scores will be taken from Training through Fourth Level and regular FEI-level (PSG through GP) dressage tests (Adult Amateur, Jr./YR and Open Divisions). The Brentina and Developing Horse tests are USEF tests and are not included in the FEI-level division. The name and breed of horse, rider and owner will be engraved on a name plate on the GHF Cup which will be displayed at each show. When the plate spaces are filled up on the base of the trophy, the lucky final winner will get to keep the silver champagne cooler. Offered at all GHF shows. See **AWARDS CLARIFICATION** in this prize list.

• **Show's High Score and Reserve High-Score** sashes will be given to the riders achieving the first and second highest scores in the show in the following divisions: FEI (PSG through GP scores only); Adult Amateur, Junior/Young Rider and Open divisions Training through Fourth Level; and Freestyle (First Level through Grand Prix tests). There must be at least three entries from any division and scores at 60% and above to qualify for high-score awards. If same person receives the top two or more scores, the reserve score will go to the next highest-scoring horse/rider combination. Winners receive a white dressage pad sponsored by **Pacific Rim Equine Products**, makers of good horse clothing. Specific FEI-level tests, i.e. Jr./YR, Brentina Cup, Developing Horse Grand Prix, etc., are not used in calculating high-score awards, including GHF Cup. See **AWARDS CLARIFICATION** in this prize list.

• **The Good Horseman "Good Rider" Award:** A dress sheet (cooler) will be awarded to the rider receiving scores of 8 or better in both rider places in the collective marks on their test at any Good Horseman show in an Adult Amateur, Junior/Young Rider and/or Open class. Only one cooler will be offered at each show; in case of a tie, the highest total score on the test will win. The award is sponsored by Karen McGoldrick. **Good Riders** will be eligible to receive only one cooler per year. Offered at all GHF USEF/USDF shows.

• **\$50 High Point Farm Junior/Young Rider Award:** This award encourages consistent excellence and is given to the Junior/Young Rider horse/rider combination with the highest weighted score on Saturday, regular tests Training Level through Grand Prix, including the FEI Jr./YR tests. Rider must be entered in the Sunday show and at ceremony to receive the special neck sash and \$50 prize. Award given at all five GHF shows.

• **\$50 Richard's Equine Video Adult Amateur Award** and sash will go to the rider receiving the highest weighted score in Adult Amateur classes Training through Grand Prix (regular tests) at the April and June shows. Scores will be taken from Saturday show. The award will be presented at the Awards Ceremony on Sunday. Must be present to win.

• **\$50 FEI Award:** Susanne Lauda is sponsoring the **Gertrud Herrmann de Lauda Memorial Award**—\$50 and a beautiful sash to the Adult Amateur in the FEI Division (Prix St. Georges through Grand Prix, excluding freestyles) receiving the highest weighted score for a test ridden on Saturday, given in memory of her mother. Award is presented at the Sunday awards ceremony at the April, June and September shows. Must be present at awards ceremony to win.

• **Still Waters Dressage Musical Freestyle Award** is sponsored by Kim Schisler Sosebee. A special high-score sash will go to the rider with the highest weighted freestyle score of any level and any division ridden on Saturday at the March, April, June, July and September Good Horseman shows. The sash will be presented at Sunday's Awards Ceremony (must be in Sunday show to win.) Ties broken by the higher technical score.

• **Holsteiner Award:** Maggie's Menagerie of Ila, GA, Maggie and Abby Sjoberg give a special neck sash to the highest-scoring registered Holsteiner horse in the show, competing on Saturday at Training through Grand Prix (excluding tests that are scored differently). Offered at all five GHF shows. Horse must have papers from the American Holsteiner Horse Association or the German Holsteiner Verband or have papers from other registries if the sire and dam are certified Holsteiners, i.e., as can happen with ISR/Old, and Belgian registries, for example. A copy of the certificate should be submitted with the entry form. The award will be presented in the Sunday awards Ceremony. Must in Sunday show and present to win.

• **\$150 Friesian/Baroque High-Score Awards**, sponsored by Caroline Hofland of CBH International at all GHF USDF/USEF shows. See application.

• **\$50 Jockey Club T.I.P. Award** is sponsored by **The Jockey Club's Thoroughbred Incentive Program**. The highest scoring Jockey Club registered horse in Saturday's show in regular tests Training through Fourth Level, PSG through Grand Prix tests (AA, Jr/YR, Open) will receive \$50 and a special Jockey Club ribbon. **The Jockey Club** requires the special T.I.P. entry form found in the show's prize list to be submitted for at least two Thoroughbreds competing for money to be awarded. A mounted awards ceremony will be held on Sunday right after lunch; must be present to receive awards. The results will be "weighted" (see GHF Cup details). Send registration papers with entry form. See application in this prize list.

• **Through Connection Pony Awards for Excellence in Dressage:** In memory of the late Dr. Nancy Ferebee of Alpharetta, GA, three special neck sashes are offered to ponies receiving the **highest weighted score**, ridden in regular Saturday classes (Training Level through Grand Prix) by a Jr./YR, Adult Amateur and an Open Division rider. Ponies are eligible if they measure 149cm or less when wearing shoes. Entries must have a USEF pony measurement card or must be measured by the show vet (see Page 6 for details). The sashes will be presented at the Sunday awards ceremony (must be present and in Sunday show to win).

• **International Georgian Grande Horse Registry's** high-point ribbon will be presented at Sunday's Awards Ceremony to the IGGHR-registered horse receiving the highest weighted score in regular Training through Grand Prix classes in the Saturday show. This award is offered at all five GHF shows. For more information: www.georgiangrande.com. Martene Carleton is the show's IGGHR representative: martenecarleton@hotmail.com.

• **Trakehner Award:** The American Trakehner Association gives a special ribbon to the best-scoring registered Trakehner horse in the show, competing in the regular tests at Training Level through Grand Prix. Owner should send proof of current ATA membership and a copy of the horse's ATA registration certificate with entry form. Contact ATA office for proof of current membership—www.americantrakehner.com.

• **AWS Award:** The American Warmblood Society will present an "AWS Champion" ribbon for the high-scoring AWS-registered horse in the show, regardless of levels, excluding tests that are scored differently. A copy of the horse's AWS registration papers and owner's current membership card copy should accompany entry form.

• **Morgan Award:** The American Morgan Horse Association gives a special award to the highest-scoring registered Morgan horse in the show, competing at Training Level through Grand Prix. A copy of the horse's registration papers should be with entry form.

GENERAL INFORMATION

QUICK OVERVIEW

Every rider/owner needs:

- Current USEF Card (or send application transaction receipt from USEF), OR \$45 USEF show pass fee
- Current USDF GMO or PM card (or send application transaction receipt from USDF) or \$35 USDF non-member fee

If qualifying, Rider/Owner needs:

- To add \$15 qualifying fee per qualifying class
- Current USEF card and Current USDF PM card (or application electronic transaction receipt from USEF)
- GHF signature page in this prize list, completely signed with emergency number

Every Trainer/Coach needs:

(Trainer is person responsible for horse on grounds, not the rider's instructor. Coach is person paid for lessons at show.)

- Current USEF card (or send application electronic transaction receipt from USEF)
- Must sign GHF signature page in this prize list

Every Horse/Pony Needs:

- USDF Horse Identification card/certificate or apply for HID card (send electronic transaction receipt from USDF)
- If rider is trying to qualify for USDF Regional Championships, horse needs:*
- USEF life or annual registration
 - USDF lifetime registration
 - Current USEF card and Current USDF PM card
 - Current Coggins and Influenza/Rhino shot record within six months. If from out of state, current health certificate.

For Ponies:

- Current or life USEF Pony Card or appointment for measuring with show's veterinarian and the show's USEF technical delegate. For measurement (see prize list details.)

REQUIREMENTS DETAILS:

The following requirements are for horses and riders entered in a USEF/USDF-recognized dressage show:

★ **CURRENT ENTRY FORM:** Competitors must fill out the entry form and signature page from the current GHF prize list. A fillable entry form has been posted on the Show Info/Ride Times page of the GHF website www.goodhorseman.org. CAUTION: See **SIGNATURES** below.

★ **USEF MEMBERSHIPS:** Riders, owners, trainers and coaches must be current members of the U.S. Equestrian Federation (USEF) or pay the USEF "Show Pass" non-member fee of \$45 per show. USEF cards are available on the USEF website: www.usef.org. Joint cards can be downloaded from www.goodhorseman.org Ride Times/Show Info page.

★ **SAFE SPORT PROGRAM:** See USEF page in this prize list for details. Every competitor must complete the SafeSport program. If a member, at renewal time, is not an exhibitor but becomes an exhibitor at a later date, they have 30 days after the competition to complete the Safe Sport Training.

★ **USDF MEMBERSHIPS:** Riders and owners/lessees must be current USDF members or pay the \$35 USDF non-member fee. The USDF non-member form is no longer required. Riders must have a USDF Participating Membership, Group Membership, or Non-Member ID number. Owners must have one of the above listed membership types or a USDF Business Membership. The USDF Education Membership is not an acceptable membership type for a rider or owner of a horse competing in USEF Licensed/USDF Recognized competitions. Riders and owners/lessees who are not able to present proper USDF membership, NM identification number, or USDF horse registration credentials to the competition secretary, must complete a USDF Competition Affidavit Form and pay the \$5 affidavit filing fee. Affidavits are not only for current non-members without a membership card; they are for anyone, members or non-members, that cannot provide verification of their USDF number or horse number. A copy of a completed USDF Competition Affidavit Form from another competition may also be used for verification purposes for up to 60 days. (Exception: Affidavits may not be used at Great American Insurance Group/USDF Regional Dressage Championships.) Those entered in USDF Introductory, Pas de Deux and Quadrille classes are exempt from USDF and USEF membership. Participants and horses competing in **Para-Equestrian** classes at USDF recognized competitions will no longer be exempt from USDF memberships. Para-Equestrian competitors are now required to have a USDF Group Membership, a USDF Participating Membership or a USDF Non-Member ID and pay the \$35 USDF Non-Member fee per competition. Owners of horses competing in the Para-Equestrian classes will be required to have a USDF Participating Membership, a USDF Business Membership, a USDF Group Membership or a USDF Non-Member ID and pay the \$35 Non-Member fee per competition. The horses competing in Para-Equestrian classes will be required to have a USDF HID number or be USDF Lifetime registered.

★ **SIGNATURES:** If you are using the "fillable" entry form, the signatures will fill in automatically and are "legal" with USEF and no other signatures are needed UNLESS the rider is different than the TRAINER, then the trainer signature line will appear blank and will require the trainer to sign in handwriting. The coach's auto-filled signature is legal too. If a paper (hard copy) entry form is used, the release page must be signed in ink by the rider, the owner or owner's agent, the trainer and (if any)

Show Fees (class fees in list on page 11):

USDF Qualifying Fee	\$ 15.00
Post-entry fee per class	\$ 20.00
Office Fee per entry (includes Perfekt Paket refund)	\$ 40.00
USEF Fee (including \$8 Drug Fee)	\$ 23.00
Dry Camp fee (for those not needing electricity) (no charge)	\$ —
Camper/RV fee per night (indicate 30 or 50 amps?)	\$ 50.00
USEF "Show Pass" fee (per rider, owner, trainer, coach)	\$ 45.00
USDF Non-Member fee (per rider and owner)	\$ 35.00
USDF affidavit fee for registered non-member without card	\$ 5.00
USDF HID horse recording fee for unregistered horses	\$ 35.00

EMT Fee (per entry)	\$ 5.00
EFT fee (per entry for electronic payment)	\$10.00

Stabling Fees:

Overnight Stabling/two bags of shavings	\$120.00
Friday through Sunday/two bags	\$150.00
Thursday through Sunday/two bags	\$175.00
Additional Day Stabling (Wednesday or Monday)	\$ 50.00
Tack Stall/no shavings/for weekend	\$ 95.00
Extra shavings/per bag (\$10 if purchased at show)	\$ 8.00
Night Watch Security fee (per horse <u>overnight</u> /weekend)	\$ 7.00

coach. The "trainer" signature is for the adult responsible for the horse at the show—initialed signatures are not accepted for rider/owner/trainer. If the rider has not reached age 18, usually the parent signs as trainer and the parent must be at the show with the rider. If the parent will not be at the show, then the instructor or other adult must sign for the junior. That person must be a USEF member or must pay the \$45 USEF "Show Pass" fee. The parent is not required to be a USEF member since the parent participates under the child's/rider's membership, unless the parent is the owner of the horse, then full membership requirements apply. The coach is the person being paid for lessons at the show and is responsible for the rider. That person also must be a USEF member or pay the USEF "Show Pass" non-member fee. An unpaid friend helping the rider does not have to sign as coach.

★ **HORSE ID:** All horses must have a USEF Lifetime or Annual membership and USDF Lifetime Registration certificate or a USDF Horse Identification number (HID). If not, the \$35 USDF HID fee must be paid with the entry and the HID form must be filled out at the show. Exceptions: some horses do not need a USDF HID number (see the USDF HID application).

★ **HORSE AGE:** No horse may compete in any under saddle class if it is under 36 months of age (of foaling date) at the time of competition. Horses competing at the Grand Prix Level must be at least eight (8) years of age and horses competing above Fourth Level must be at least seven (7) years of age; except for 3-year-olds, a horse's age is counted from Jan. 1 of the year of birth to Jan. 1 of the current competition year. DR 119.1 Proof of horse's date of foaling must accompany entries of three-year-old horses.

★ **QUALIFYING:** Riders and owners wishing their horses to be entered into Great American Insurance Group/USDF Regional Dressage Championships qualifying classes must be current members of USEF and Participating Members of USDF (not Group Members) or owners may be USDF Business Members, and their horses must have USEF Lifetime or Annual membership and USDF Lifetime Registration certificate. The qualifying fee now is \$15 per qualifying class. Copies of all cards are required with entry. Horse Identification (HID) numbers are not sufficient for qualifying classes.

★ **CITIZENSHIP:** Riders who are citizens of other countries must be members of USEF OR current members of their national federation and a copy of their foreign-member cards must accompany their entry form. If they are not members of USEF they are exempt from the non-member fee. Foreign rider licenses are no longer required.

★ **HEALTH CERTIFICATES:** Out-of-state horses must have a current health certificate (Georgia law) and a copy of that certificate should be received by mail or e-mail no later than the Wednesday before the show. Or you can take a picture of it with your I-phone and e-mail it. We no longer have a FAX line.

★ **VACCINATION:** Every horse (see rule below) on the grounds must include with their entry a copy of a current negative Coggins certificate within 12 months and documentation of Equine Influenza Virus and Equine Herpes Virus (Rhinopneumonitis) vaccinations within six months prior to entering the stables. (See complete USEF rule below). The name on the certificate must match the name on the entry form and on the Coggins certificate. The original Coggins certificate must travel with the horse (Georgia law).

GR845 Equine Vaccination Rule 1. At Federation licensed competitions, horses entering the grounds must be accompanied by documentation of Equine Influenza Virus and Equine Herpes Virus (Rhinopneumonitis) vaccinations within six months prior to entering the stables. Horses not in compliance with this rule may be required to leave the competition grounds upon request by Competition Management. Documentation should consist of one of the following methods mentioned below. The frequency of vaccine administration should be per the vaccine manufacturers' or veterinarian's recommendations. It is recommended that vaccines are administered by or under the direction of a veterinarian. 2. In the case of vaccines administered by a veterinarian, the exhibitor, upon request by Competition Management, must provide documentation from the veterinarian on documenting that the horse in question received the vaccinations; name of the vaccines and date of vaccine administration. 3. In the case of vaccines administered by a person other than a veterinarian, the exhibitor, upon request by Competition Management, must provide a receipt of the vaccine purchase which is signed by the owner, or agent with care, custody, and control of the horse; name, serial number and expiration date of the vaccine; and date of vaccine administration. 4. In the case of a horse that is unable to receive either of the vaccinations due to a history of adverse reactions, the exhibitor, upon request by Competition Management, must provide a letter from the veterinarian on official letterhead stating that the horse in question cannot be vaccinated due to medical concerns and a log of temperatures taken twice daily for the seven days prior to entering the competition grounds. These horses must also have their temperature taken and logged twice daily while on the competition grounds. The log of temperatures should be provided to the Competition Management, steward, or technical delegate when requested. 5. Competition Management may not amend or enhance vaccination requirements without prior approval of the Veterinary Committee. BOD 1/17/15 Effective 12/1/15.

MANDATORY NECROPSY: USEF GR850 requires that a necropsy be performed in all incidents of euthanasia or fatality. The University of Georgia Veterinary Hospital has the nearest pathology lab for this purpose. Phone number for the Necropsy Lab is 706-542-5568. Show manager has the referral form. See Emergency Equine Quarantine protocol plan on the Show Info/Ride Times page of our website.

ON-LINE ENTRIES: GHF shows accepts entries on line through Equestrian Entries: www.equestrianentries.com. There is a link to their website on the GHF website front page. If you do not already have a user account with Eq-Entries.com, you may sign up now. If you are a first-time user, you can get \$5 off your first paid on-line entry submission. Input the following in the Coupon Code in the payment section: "FIRSTENTRY". You can print your entry and mail it with a personal check, or pay on line with a credit card. If you choose to pay on line, a 5% service fee is added to your total at check out. There is no charge to join Eq-Entries, create an entry or print an entry. So if you choose to pay by personal check, the service is free.

CLOSING DATE AND LATE FEE: All paid entries will be accepted if received at the show office address (4567 Rockbridge Rd. #297, Pine Lake, GA 30072) or into the Equestrian On-Line Entries program on or before the closing date which is posted at the top of the front page of this prize list. Entries received after the closing date may be accepted with a \$20 late fee per entry, until such time as the show is full or the data base must be closed for scheduling. After that time, competitors may choose to come to the show as a non-competing entry and fill scratches on paying the \$20 post entry fee per class, in addition to regular class fees.

PERFEKT PAKET REFUND: We have increased the office fee to \$40 so that competitors whose entries are complete (Perfekt) on first receipt will get half of the office fee back--\$20 in cash--actually a reduction in the office fee for the careful competitor. If the entry has documents trickling in before the show but is complete when the rider gets to the show, the rider will receive a \$10 refund. See caveat below.

SHOW DOCUMENTS: The show accepts **ONLY** the signature page found in the show's prize list. To create a speedy check-in, competitors are asked to e-mail (not text) all missing documents to goodhorseman@att.net by the Thursday before the show. Documents e-mailed on Friday, a travel/load-in day for management, may not be received in the show office and the competitor may forfeit the Perfekt Paket Refund. Make sure your e-mail address is correct in Eq Entries so you will get important updates from the show.

REFUNDS will be given in full BEFORE to the closing date for any reason (See **Qualifying Fee**). After the closing date, there will be no refunds. However, in the case of illness or injury to horse or rider, a credit (excluding non-refundable drug fee, the office fee, any qualifying fees and cost of shavings if they are not recovered) may be issued toward a future Good Horseman show with a veterinarian's or physician's certificate (the certifying vet or doctor may not be owner, rider or trainer) received by management no later than 10 days after the show. To get credit, rider or representative must notify the show secretary in person before show starts so the riding times may be filled. Do not use messages or e-mails without confirmation of receipt by the show. USEF requires competitors to notify the secretary when leaving the grounds before show ends.

POST-ENTRIES/CLASS CHANGES may be accepted if space is available (to fill scratches, etc.) upon payment of regular show fees, regular class fees plus an additional post-entry fee of \$20 per class. Riders who add or withdraw **qualifying** to or from their entry may do so without penalty or charges, but there will be no refunds.

CORRECT NAMES?: Horses entered in qualifying classes must be entered under the same and complete official name registered with USEF and USDF, and the name of the owner must be correct on BOTH USEF and USDF cards. All documentation should match the names of the rider and owner on entry form.

COMPETITOR NAME CHANGE: If a competitor has changed his/her name but the horse recording is still listed under the previous name, the exhibitor must notify USEF and USDF of the name change by FAX, e-mail or letter. After USEF and USDF have made the name change, the exhibitor can print an on-line card with the correct name on the membership card and the on-line horse card. See USEF GR1105-1108.

NON-COMPETING HORSES will be accepted upon payment of stabling fee, night watch fee, EMT fee and office fee. Owners/riders must fill out a separate entry form for that horse and sign the signature page in all three places and send it to the entries secretary along with the horse's current Coggins certificate and health certificate for out-of-state horses. (See **Non-Competing Riders** below.)

NON-COMPETING RIDERS who are not entered in the show and are NOT signed as trainer or coach but need to ride horses which are entered must submit a filled-out and signed entry form listing the horses they are planning to ride—unless they are signed as trainer or coach on the horses they want to ride. There is no charge for this. They must also sign the entry form for a non-competing horse if they are not the entered rider, trainer or coach. They must comply with show and USEF rules.

THE TIME SCHEDULE will be posted in a conspicuous place by noon the day before the competition. Ride times will not be changed after noon the day before the start of the entire competition, except in compliance with GR830.5. Classes start at 8 a.m. each day, though a 7:30 start may be required in hot weather. Competitors will be notified of any change to the start times.

START TIMES: The show will tentatively start at 8 a.m. each day, though an earlier or later start may be necessary because of weather. Schedule will be posted on www.goodhorseman.org. See Ride Times page.

SPECIAL REQUESTS: We cannot accommodate all special scheduling requests because we cannot offer that service to everyone in the show as required to be in compliance with USEF rules.

SCHEDULING ADVISORIES: Riders entered on three horses or more per day do so at their own scheduling risk. If show management is not able to schedule the additional rides to the satisfaction of the rider/owner, the entry fees will not be refunded.

However, show management will try to accommodate them. Riders on multiple horses who have scheduling issues, please attach a sticky note to your entry form indicating which horse you would like to go first or if you need an early or late ride for some reason. Not every request can be satisfied—but we try.

ENTRIES may be paid by credit card or check. Entries may not be accepted unless accompanied by signed entry forms and COPIES of the rider's, owner's and horse's USDF and USEF cards, and trainer's and coach's (if any) current USEF cards. E-mailed entries may not be accepted without credit card information.

"NO SHOWS": Competition management may reserve the right to fill a competitor's subsequent ride times if that competitor fails to notify the competition of his/her intention to scratch (i.e., is a "no show"). (DR126.3)

AWARDS CEREMONY: An awards ceremony (weather permitting) will be held on Sunday following the last ride before the lunch break. This program is for the winners of the show's sponsored prizes for rides performed on Saturday. The announcer will call for the winners. Our awards coordinator will give instructions to those participating in the ceremony. Full-dress attire is required for everyone mounted—coats will not be waived for this event. A winner may receive an award on foot if it is too hot for him/her to wear a coat while mounted but the handler must wear a helmet—no exceptions.

AWARDS CLARIFICATION: If the award is a "horse award" the money/check should go to the owner and the sash/ribbon should go to the rider (they can choose to reverse this if they wish). If it is a "rider award," the rider will receive the sash/ribbon and the money/check, even if the owner is another person. If the award is for a GHF division high-scoring horse/rider combination, the owner should receive the sash/ribbon and the rider should receive the dressage pad.

HELMET RULE: USEF Rule (DR120.1) requires that secured protective headgear (as defined in DR120.5) must be worn at all times while riders are in competition or riding on the grounds at USEF competitions. This rule applies to ship-in days prior to and after the show, and after show hours, anywhere on show grounds. This requirement includes FEI-level riders and those who may not be entered in the show. This regulation will be strictly enforced. Penalties include elimination and possible charges.

COMPETITION "BRIDLE" NUMBERS: USEF rules require that every horse on the grounds wear his/her competition number while the horse is out of his stall. Bridle number should be worn on the left side. Competitors who arrive on Saturday or Sunday must come to the show office to get their paperwork and bridle number because the bridle number must be on the horse before unloading.

COMPETITOR NAME CHANGE: If a competitor has changed his/her name but the horse recording is still listed under the previous name, the exhibitor must notify USEF and USDF of the name change by FAX, e-mail or letter. After USEF and USDF have made the name change, the exhibitor can print an on-line card with the correct name on the membership card and the on-line horse card. See USEF GR1105-1108.

DOGS MUST BE LEASHED ON A LINE NO LONGER THAN SIX FEET.

DIRECTIONS: (See maps on pages 21 and 22.) To show entrance: 10045 Cedar Grove Road Fairburn, GA 30213

From I-75 North & South of Atlanta: Take I-285 West to Exit 62 Spur 14 S. Fulton Pkwy, then below. From I-20 heading West: Take I-285 heading south to Exit 62 Spur 14 S. Fulton Pkwy, then below.*

From I-85 heading South: Take Exit 69 Spur 14/South Fulton Parkway. From South Fulton Parkway, then below.*

***Below for all directions above:** Stay on S. Fulton Parkway for 7.5 miles then Right on Hwy 92/Campbellton/Fairburn Rd. Go 2 miles and turn left on Ridge Road. Go 0.3 mile then right on Cochran Mill Rd. Go 1/2 mile, then right onto Cedar Grove Road show entrance is 1.25 miles on the right.

From I-20 heading East: Take Exit 37 Hwy 92 Fairburn/Douglasville; end of ramp go Right on 92 South/ Fairburn Rd. Go 5.2 miles then go Right at light staying on 92 South Fairburn Rd. Go for 4.2 miles then at light go Right on Cascade Palmetto Rd. Go 0.3 miles then Right on Cochran Mill Rd. Go 1/2 mile, then right onto Cedar Grove Road show entrance is 1.25 miles on the right.

From I-85 heading North: Take Exit 61 Hwy. 74, Fairburn; end of ramp go left heading north on Hwy. 74. When the 4-lane lane turns into a 2-lane, stay straight (do not continue on Hwy. 74); go straight for 2.3 miles on Virlyn B. Smith Road until the road dead ends into Rivertown Road. (Advisory: Avoid Cedar Grove Road at this point—take it later.) Go left on Rivertown for 3.5 miles. Cross over S. Fulton Pkwy. staying on Rivertown for two miles, then right at 4-way stop onto Cochran Mill Road. Go three miles, then left at 4-way stop onto Cedar Grove Road. Show entrance is 1 and 1/4 mile on the right.

From farm to host hotel, Days Inn: Turn left onto Cedar Grove Road; go through the Cochran Mill 4-way stop to the traffic circle. Around the traffic circle to Ridge Rd.; turn right on Hwy 92 to Shannon Parkway (address below) on left, just before you get to I-85.

ACCOMMODATIONS: Show hotel: Days Inn and Suites, Union City (close to I-85) 6743 Shannon Pkwy, Union City, GA 30291; (770) 268-0393. Find other hotel rooms on <http://chatthillseventing.com/accommodations/> Reserve hotels early to get best rate.

All barns offer permanent stabling with stall mats. Please write your stabling requests (one name per group) on a Sticky Note or

separate sheet and attach to entry form with map request for large groups, or send it by e-mail to goodhorseman@att.net. Some levels of stabling come with two bags of shavings. Additional shavings may be ordered by adding them to your entry form (see **BEDDING** below). Which barns will be used will be announced on the Ride Times page of the GHF website www.goodhorseman.org. See farm maps on Pages 21 and 22. All barns have electricity, running water. The dimensions of stalls in Barns A, B and C are 12'x12'. Barn C is closest to the show office and will be assigned first. Your stall assignments will be posted on the GHF web site's Ride Times page the week before the show. Those wishing to stay over Sunday night must include an extra \$50 stabling fee. There are marked sites for dumping wheelbarrows behind the barns. Farm animals are not allowed at the show.

BEDDING: All stalls come with two bags of shavings. Additional shavings may be purchased at \$8 per bag by adding them to your entry form in the space provided. For shavings purchased at show, there will be bags of shavings on a pallet outside the show office and may be purchased from the show secretary for **\$10 per bag**.

LIMITED RV/CAMPER SPOTS: There is no charge for camping in trailers or RVs not requiring electrical or water hookups. A limited number of RV hook-ups are available. You must reserve and pay for these spaces by adding them to your entry form. Indicate if you need 30 or 50 amps capabilities on entry form. They are not interchangeable. Accepted on first-come basis.

GOLF CARTS: People needing golf carts should contact West Georgia Golf Carts at 770-947-2278.

ARENAS: At least two 20x60 meters PVC board arenas will be used in the upper Grand Prix arena that is 250'x350' with sand/fiber mix footing.

WARM-UP ARENAS: There will be two 125'x250' warm-up arenas with sand/fiber mix footing. The upper warm-up for Arenas B and C will be divided into two sections. The lower warm-up will be used for Arena A (FEI-level) rides only.

LUNGEING: Lungeing **ONLY** will be allowed in the lower ring all day Friday; on Saturday and Sunday Lungeing **ONLY** from 7 a.m. to 7:30 a.m.; and noon to 12:30 p.m. At **ALL** other times, that arena will be used exclusively for warm-up for Arena A (the FEI-level rides).

RESTROOMS/SHOWERS: There are new restrooms with hot/cold showers, located in the new show office building in the same area where the previous office trailer was parked.

FARM RULES: **No nails or screws** are allowed on the barn walls or stalls—penalty of \$50 per incident. Only hangers, hooks, ties that are removable may be used. No washing of horses in front of the barn. There are wash racks behind the barns for this purpose (see map in this prize list). **NO PARKING ON THE GRASS!** Parking permitted behind the barns only, or in the three-tiered parking lot in front of the show office. All participants will keep the grounds clean at all times and be respectful of the facilities and land owner and will be required to pay for any damage they or their horses or attendants cause to the property.

DAMAGE: Competitors will be charged \$50 or more (depending on the damage) by Chattahoochee Hills Farm management for any damage caused by you or your horse to the property during our shows. If, when you arrive at your stall, you find something out of line; i.e., broken boards, loose floor tiles, nails, screws, etc., be sure you report them to the show office immediately to avoid possible charges.

PARKING is allowed in designated areas only. There is no parking on the grass or inside the courtyard area. Vendor vehicles are permitted inside the courtyard area for loading and unloading only. **NO HORSE TRAILERS** are permitted inside the courtyard area.

FARRIERS AND WASH RACKS: Farriers usually shoe horses in the aisles of the barns. Wash racks are located behind Barns A, B and C which this show will be using. Horses may be bathed only in these areas and NOT ON GRASS or in front of barns.

NIGHT WATCH: Dennis Boggs is our night watchman. Dennis also offers personal care such as feeding and watering for an additional fee. Please call Dennis about this at 770-855-7403/cell. He is on the grounds or in the show office all night Friday and Saturday.

BRAIDER: Trish Savard offers braiding services. Call 413-244-3763 for appointment.

EMERGENCY NUMBERS: In case of emergency, call 911 or the direct line to the Chattahoochee Hills Police Department at (770) 463-8881 or call the show manager at 404-289-9328. The numbers of the show's veterinarian and farriers are published on the front page of this prize list, on the front of the show program and in prominent places at the facility.

CONCESSIONS STAND: Open each show day from 7 a.m. till end of show.

SHOW OFFICE: The show office is located in a new building near Barn C, right behind the announcers booth. It will be open for competitors at noon on Friday before the show; and opens at 7 a.m. each day before the show.

PONY CUP CLASSES: GHF is offering two National Dressage Pony Cup Test-of-Choice Classes (Training Level through Grand Prix) on Saturday and Sunday, open to all riders, Adults and Juniors. To participate in the awards ceremony, ponies must perform Saturday and Sunday in the NDPC Test of Choice Class. NDPC has its own weighted scale which the show will use (see <http://www.dressageponycup.com/degree-of-difficulty.html>) to evaluate the scores. Ponies must hold a USEF pony card or must be officially measured and certified at the show (see details below). Ponies will receive GHF ribbons to sixth place in their class each day. On Sunday, the scores will be averaged and the First through sixth-place National Dressage Pony Cup ribbons and a high-score ribbon will be presented at the Awards Ceremony on Sunday (for this purpose, our double shows in June and September will be considered single shows). An NDPC high-point ribbon will also be given. National Dressage Pony Cup is an organization dedicated to promoting ponies in dressage. Through their partner-show program, they encourage USDF-recognized dressage shows to include pony classes. Every pony/rider combination entered in pony-only classes at a partner show will automatically be entered the NDPC year-end awards program. This way ponies will be competing at their individual level and division throughout the entire country. For more information: www.dressageponycup.com. (See Introductory Division for Ponies.)

PONY MEASUREMENT: Owners of animals they wish to exhibit in a class limited to ponies or to be eligible for the *Through Connection Pony Awards* or for the NDPC classes (see above) must have a USEF pony measurement card or they must be measured by the show veterinarian and TD at cost to the exhibitor who will pay the veterinarian directly for a fee of no more than \$100. The show does not charge for this. Any pony entered in the show is eligible to be measured, but it is not required unless the pony is vying for pony awards or classes. Measurement must be performed ahead of time usually early Saturday morning, and at a place to be announced, so contact the show manager. (See FEI Ponies whip rule below.)

INTRODUCTORY DIVISION FOR PONIES: Classes coded UAP, UBP and UCP make up the Introductory Pony Division. Those entered in this division may not enter classes in any other division in the show. Ponies entered must have a current USEF pony measurement certificate. The tests ridden will be 2019 USDF Introductory Tests A, B and C (coded UA, UB and UC). Riders performing only 2019 USDF Introductory tests are exempt from the USEF and USDF non-member fees and USDF Horse ID fee. (See GR205-GR207)

WHIPS: USEF rules allow one whip no longer than 47.2 inches (120 cm), including lash may be carried in all classes, including most qualifying classes, except in USEF/USDF or FEI championships. See DR120.5 for more complete details. Riders in **FEI Pony tests** must carry a whip no longer than 100 cm. Whips are allowed in FEI/USEF/NAYC qualifying classes.

ANNOUNCER: Our announcer is provided as a courtesy for the rider. If you or your horse have a strange-sounding, hard to pronounce name, please go to the announcer and let her know the correct pronunciation.

MANAGEMENT: The show's competition management and USEF licensee (GR131) is The Good Horseman® Foundation, a non-profit USDF Group Member Organization founded in 1995. Its director and show manager is Ann Genovese; Director-at-Large is Karen McGoldrick; and Treasurer is Robin Boggs; Membership Chairman is Patricia Powell. All riders in GHF's recognized shows are eligible for GHF year-end awards and they do not have to apply or be GHF members to receive them.

SCRIBES' COORDINATOR: Danielle Perry is in charge of selecting scribes at our shows. Anyone interested in scribing may contact her at 404-219-1266 or by e-mail: revelationfarm1911@gmail.com.

ATTENTION, COMPETITORS: Each competitor is responsible for supplying management with correct federation/association numbers (USEF and USDF) for horse, owner, rider and trainer before the days of the competition. The scores of competitors who fail to supply correct numbers may not be counted toward national awards.

DEFINITIONS AND ELIGIBILITY: Adult Amateur entries must be registered as such with USEF and must enclose a copy of their current USEF membership card. Individuals are eligible to enter as Juniors until the end of the calendar year in which they reach the age of 18. Individuals are eligible to enter as Young Riders from the beginning of the calendar year in which they reach the age of 16 until the end of the calendar year in which they reach age 21. Competitors may compete as Adults from the beginning of the calendar year in which they reach age 22. Riders who are 16 and 17 years old may compete as either Juniors or Young Riders but not both in the same show. Open classes are open to anyone eligible to compete, including professionals. Green Horses, for the purpose of this show, are horses which have not reached their seventh birthday in the current competition year. Horses under 36 months of age to the date of birth may not compete in any dressage under-saddle class (DR119.1). Proof of age should accompany the entry form of all three-year-old horses.

QUALIFYING FEE: The USDF regional championships qualifying fee is \$15 per qualifying test. Sometimes there are valid reasons why a competitor may not want to add the qualifying fee to his/her entry before closing date. Qualifying fees may be added at the show without penalty and may be refunded if the rider notifies the secretary before the start of the class.

USDF JR./YR INFORMATION: To qualify for the **2019 Great American Insurance Group/USDF Regional Championships**, eligible Young Riders must ride the FEI Young Rider Team Test to qualify for the FEI Young Rider division. The FEI Young Rider Freestyle is no longer used to qualify for the regional championships. Junior Riders (age 14-18) must ride the FEI Junior Team Test to qualify for the FEI Junior Division. Prior to riding in the class, riders must pay \$15 Qualifying Class fee to the competition secretary. The FEI Junior Individual and the Pony Individual and Team tests are no longer used for **Great American/USDF Regional Championship** qualifying.

NAYC ADVISORY: For USEF/FEI qualifying for Children, Pony Riders, FEI NAYC and Brentina Cup (Young Adults), at no time during the competition may any horse entered in a USEF/FEI Qualifying class be ridden by anyone other than the athlete entered in that class on that horse, under penalty of disqualification from the class for USEF/FEI championship qualifying purposes. Exception: grooms riding on a loose rein. For purposes of this rule, the competition starts when horse and athlete arrive on the show grounds of the USEF/FEI Qualifying Competition and ends at the conclusion of the USEF-licensed Dressage Competition (DR 128.2).

QUALIFYING POSSIBILITIES: Horse/rider combinations may enter more than one qualifying test and qualifying Freestyle test at each level per day as Great American Insurance Group/USDF Regional Championships qualifying. (USEF DR 127.4). For further information:
<https://preview.usdf.org/competitions/competitions-championships/regionals/competitors.asp> or call (859) 971-2277.

2019 USEF RULE CHANGES: Please note any pending rule changes that may affect your participation in our competition. They will be posted on the USEF website, www.usef.org, Rule Book and Rule Changes.

RIDERS WITH DISABILITIES: Disabled riders must have a current USEF Presidential Modification or a current Dispensation Certificate in order to compete with special equipment or circumstances to compete in USEF classes. These letters must accompany their entry forms.

PARA-EQUESTRIAN RULE CHANGE: This show offers test-of-choice classes for Para-Equestrian Dressage riders. USDF now requires membership for rider, horse and owner or the USDF non-member fee will apply.

RESULTS: Please be aware that our shows' official results are the scores that are posted on the GHF website's Show Results page and not what you may see on line on Fox Village and other websites. There has been some confusion with this in the past for championships qualifying.

2019 FREESTYLE REQUIREMENTS: USEF Dressage rule 129.9: "Except for USEF/USDF Championship classes and for FEI Pony Riders, FEI Junior, FEI Young Rider and FEI Para-Equestrian Freestyles, in order to enter a freestyle class at any level, a horse/rider combination must have received a minimum score of 63% in the highest test of the declared freestyle level or any test of a higher level at a Federation Licensed or FEI recognized Dressage Competition or "open" Dressage class (i.e. open to all breeds) at a Federation Licensed Competition held prior to the competition where the horse/rider combination is entered to ride a freestyle class. A photocopy of the test verifying eligibility, or copy of the USDF score verification, must be submitted with the entry for a freestyle class." Freestyle CDs must be given to announcer and tested at least two hours before the scheduled ride time.

NEW USEF TESTS: This show will use the 2019 USEF dressage tests (see USEF website: www.usef.org), the 2019 USDF Introductory Tests A, B and C and the 2019 USDF Freestyle tests. USEF has discontinued the Rider Tests. This show will use the current FEI dressage tests—see the FEI website: www.fei.org.

2019 INTRODUCTORY RIDER DIVISION: Classes coded UA, UB and UC make up the Introductory Rider Division. Those entered in this division may not enter classes in any other division. This division is divided by Adults and Juniors/Young Riders if entries warrant. The tests ridden will be 2019 USDF Introductory Tests A, B and C (coded UA, UB and UC). Riders performing only 2019 USDF Introductory tests are exempt from the USEF and USDF non-member fees and USDF Horse ID fee. (See GR205-GR207)

GREEN HORSE DIVISION: The show offers an Open division for green horses (see Definitions), using the 2019 USDF Introductory Tests A, B and C (GA, GB and GC). Anyone may enter this division or cross enter into other divisions except the Introductory Rider Division.

SHARPS CONTAINERS: Competition management shall place a minimum of one sharps container per each competition, whether or not stabling is provided. Additionally, at least one sharps container per fifty occupied stalls for the disposal of needles and other disposable sharp instruments in convenient locations in barns housing competition horses. It is competition management's responsibility to replace such containers when full and dispose of them properly. Competition management may fine any individuals including trainers, owners, exhibitors, or their agents up to \$100 for improper disposal of needles or other sharp disposable instruments. **Competition management will place a notice of this requirement either in its prize list or on a specific handout given to trainers on check in at the competition.** If local law has different requirements, local law will prevail. GR1210.4.

MOTORIZED VEHICLES: Minors who do not have a valid driver's license, which allows them to operate a motorized vehicle in the state in which they reside, will not be permitted to operate a motorized vehicle of any kind including, but not limited to, golf carts, motorcycles, scooters or farm utility vehicles on the competition grounds of licensed competitions. Minors who have a valid temporary license may operate the above described motorized vehicles as long as they are accompanied by an adult with a valid driver's license. Violations of this rule will be cause for sanctions against the parent(s), guardian(s) and/or trainer(s) who are responsible for the child committing the offense. Penalties may include exclusion of the child, parent(s), guardian(s), and/or trainer(s) from the competition grounds for the remainder of the competition and charges being filed against any of the above individuals in accordance with Rule 6. Wheelchairs and other mobility assistance devices for individuals with disabilities are exempt from this rule. GR1301.7

NO LOOSE DOGS: Dogs are not permitted to be loose on competition grounds and must be on a leash no longer than 6 feet (no lunge lines) or otherwise contained. Individuals must not lead dogs on a leash while mounted. Dog owners failing to comply with this rule may be subject to penalty under Chapters 6 and 7, as well as issuance of warning cards. GR1301.6

CONFIRMATION OF ENTRIES: Receipt of all entries will be confirmed by e-mail upon receipt.

ADDRESS: Make checks payable to **The Good Horseman Foundation** and mail to 4567 Rockbridge Road #297, Pine Lake, GA 30072.

RETURNED CHECKS: A \$35 fee will be levied against any competitor whose check is returned from the bank (O.C. GA 16-9-20).

CANCELLATION OF CLASSES: There will be no refunds if classes are canceled because of weather, accident or other emergency beyond the control show management.

EVERY CLASS OFFERED HEREIN WHICH IS COVERED BY THE RULES AND SPECIFICATIONS OF THE CURRENT FEDERATION RULE BOOK WILL BE CONDUCTED AND JUDGED IN ACCORDANCE THEREWITH.

RIGHTS: The competition committee reserves the right to refuse or limit entries, to add or divide classes, to add or substitute judges or make whatever changes are required by circumstances to the competition specifications herein for the improvement of the competition. Entries will be accepted on a first-come basis before the closing date.



TENTATIVE CLASS SCHEDULE FOR BOTH DAYS (unless otherwise specified)

(Please specify by writing "Q" on entry form for classes in which you want to qualify.)

UA USDF Intro. Walk-Trot Test A—Intro. Rider Division \$30
 UB USDF Intro. Walk-Trot Test B—Intro. Rider Division \$30
 UC USDF Intro. Walk/Canter Test C—Intro. Rider Division \$30
 GA USDF Intro. Walk-Trot Test A—Green Horses (Open) \$30
 GB USDF Intro. Walk-Trot Test B—Green Horses (Open) \$30
 GC USDF Intro. Test C (with canter)—Green Horses (Open) \$30
 UAP USDF Intro. Walk-Trot Test A—Ponies (Open) \$30
 UBP USDF Intro. Walk-Trot Test B—Ponies (Open) \$30
 UCP USDF Intro. Test C (with canter)—Ponies (Open) \$30
 00Q Training Test of Choice Class (Q) \$40
 01A Training Level Test 1 Adult Amateur \$40
 01Y Training Level Test 1 Junior/Young Rider \$40
 01O Training Level Test 1 Open \$40
 03A Training Level Test 3 Adult Amateur (Q) \$40
 03Y Training Level Test 3 Junior/Young Rider (Q) \$40
 03O Training Level Test 3 Open (Q) \$40
 03P Training Level Test 3 Ponies (Q) \$40
 10Q First Level Test of Choice (Q) \$40
 11A First Level Test 1 Adult Amateur \$40
 11Y First Level Test 1 Junior/Young Rider \$40
 11O First Level Test 1 Open \$40
 13A First Level Test 3 Adult Amateur (Q) \$40
 13Y First Level Test 3 Junior/Young Rider (Q) \$40
 13O First Level Test 3 Open (Q) \$40
 13P First Level Test 3 Ponies (Q) \$40
 20Q Second Level Test of Choice (Q) \$45
 21A Second Level Test 1 Adult Amateur \$45
 21Y Second Level Test 1 Jr./YR \$45
 21O Second Level Test 1 Open \$45
 23A Second Level Test 3 Adult Amateur (Q) \$45
 23Y Second Level Test 3 Jr./YR (Q) \$45
 23O Second Level Test 3 Open (Q) \$45
 23P Second Level Test 3 Ponies (Q) \$45
 30Q Third Test of Choice Class (Q) \$50
 31A Third Level Test 1 Adult Amateur \$50
 31Y Third Level Test 1 Jr./YR \$50
 31O Third Level Test 1 Open \$50
 33A Third Level Test 3 Adult Amateur (Q) \$50
 33Y Third Level Test 3 Jr./YR (Q) \$50
 33O Third Level Test 3 Open (Q) \$50
 33P Third Level Test 3 Ponies (Q) \$50
 40Q Fourth Test of Choice (Q) \$50
 41A Fourth Level Test 1 Adult Amateur \$50
 41Y Fourth Level Test 1 Jr./YR \$50
 41O Fourth Level Test 1 Open \$50
 43A Fourth Level Test 3 AA (Q) \$50
 43Y Fourth Level Test 3 Jr./YR (Q) \$50
 43O Fourth Level Test 3 Open (Q) \$50
 43P Fourth Level Test 3 Ponies (Q) \$50

Freestyles Classes:

U0Q USDF Freestyle Test of Choice Class (Q) \$50
 F0Q FEI Freestyle Test of Choice Class (Q) \$60
 FPD USEF Para-Eq. Freestyle Test of Choice (Sun. only) \$50

FEI-Level Classes:

FEI FEI-Level Test of Choice Class (Q) \$60
 PGO Prix St. Georges Open (Q) \$60
 PGA Prix St. Georges AA (Q) \$60
 PGY Prix St. Georges Jr./YR (Q) \$60
 61O Intermediaire I Open (Q) \$60
 61A Intermediaire I AA (Q) \$60
 61Y Intermediaire I Jr./YR (Q) \$60
 7AO Intermediaire Test A Open \$60
 7BO Intermediaire Test B Open \$60
 72A Intermediaire II Adult Amateur (Q) \$60
 72O Intermediaire II Open (Q) \$60
 72Y Intermediaire II Jr./YR (Q) \$60
 GPA Grand Prix Adult Amateur (Q) \$60
 GPY Grand Prix Jr./YR (Q) \$60
 GPO Grand Prix Open (Q) \$60
 GPS Grand Prix Special Open (Sunday only) \$60

Other tests:

NPC National Dressage Pony Cup Test of Choice Class (Q) \$45
 PET USEF/FEI Para-Equestrian Dressage Test of Choice Class \$50

USEF/NAYC/Young Horse/WBC Warm-Up Classes:

BRW FEI Grand Prix 16-25 Warm-up (Sat.)—\$60
 72W FEI Intermediaire II 16-25 Warm-up (Sat.) \$60
 Y4W USEF 4-Year-Old Young Horse Warm-Up (Sat) \$60
 Y5P *5 YR Old Preliminary Test – WBC Q (Sat)
 Y6P *6 YR Old Preliminary Test – WBC Q (Sat)
 Y7P *7 YR Old Preliminary Test – WBC Q (Sat)
 DEW USEF Developing Horse PSG Warm-up (Sat) \$60
 GPW USEF Developing Horse Grand Prix Warm-up (Sat) \$60

★USEF/NAYC/Young Horse Qualifying Classes:

9YT ★FEI Young Rider Team Test (PSG) (Saturday) (**Q) \$60
 9YI ★FEI Young Rider Individual Test (Sunday) \$60
 9YF ★FEI Young Rider Freestyle Test (Sunday) \$60
 9JT ★FEI Junior Team Test (**Q) (Saturday) \$60
 9JI ★FEI Junior Individual Test (Sunday) \$60
 9JF ★FEI Junior Freestyle Test (Sunday) \$60
 B72 ★FEI Intermediaire II 16-25 (Sunday) \$60
 PRT ★FEI Pony Rider Team Test (Saturday) \$60
 PRI ★FEI Pony Rider Individual Test (Sunday) \$60
 PRF ★FEI Pony Rider Freestyle Test (Sunday) \$60
 CHT ★FEI Children Team Test (Saturday) \$60
 CHI ★FEI Children Individual Test (Sunday) \$60
 BGP ★FEI Grand Prix 16-25 (Sunday) \$60
 YH4 ★USEF 4-Year-Old Young Horse (Sunday) \$60
 YH5 ★*5 YR Final Test – USEF/WBC Q (Sunday) \$60
 YH6 ★*6 YR Final Test – USEF/WBC Q (Sunday) \$60
 YH7 *7 YH Final Test – WBC Q (Sunday) \$60
 DEQ ★USEF Developing Horse PSG (Sunday) \$60
 GPQ ★USEF Developing Horse Grand Prix (Sunday) \$60

(Please specify by writing "Q" on entry form for classes in which you want to qualify.)

★Indicates 2019 USEF/NAYC/Young Horse qualifying classes which will count as qualifying scores for the ranking lists for the USEF Championships and North American Youth Championships.

*Indicates a qualifier for the 2019 FEI World Breeding Championships.

Qualifying class (Q) for the 2019 Great American Insurance Group/USDF Regional Championships. Please add the \$15 USDF qualifying fee to each qualifying class entry fee.

For further information, please consult the 2019 Great American Insurance Group/USDF Regional Championship rules page in this prize list.

Please be aware that qualifying is not mandatory in any class marked for qualifying or in the Dressage Test of Choice classes that are also marked (Q) for qualifying. Tests 1, 2 or 3 in all USEF levels may be ridden in the Test of Choice classes.

ATTENTION, COMPETITORS: Each competitor is responsible for supplying management with correct federation/association numbers (USEF and USDF) for horse, owner, rider and trainer before the days of the competition. The scores of competitors who fail to supply correct numbers may not be counted toward national awards.



The Good Horseman® Foundation

e-mail: goodhorseman@att.net
website: www.goodhorseman.org
cell: 404-289-9328

OFFICE USE ONLY:

Date received _____

Amount _____

2019 MEMBERSHIP FORM

The Good Horseman® Foundation is a non-profit, tax-exempt, 501 (c) (3) organization of experienced members of the dressage community, including equine professionals, dressage instructors, trainers, competitors, judges, "L" Graduates and members of dressage competition management. The Foundation is a Group Member Organization (GMO) of The United States Dressage Federation and participates in USDF programs such as the Instructor Certification and the "L" Judges Education Programs. Your membership makes you a GROUP MEMBER of USDF. All members are eligible to compete for USDF rider awards, adult camps and will receive a subscription to the USDF national newsletter. Those wishing to qualify for the USDF Regional Championships must apply directly to USDF to become a PARTICIPATING MEMBER to be eligible.

The amount of your GHF annual dues is \$30 single membership (\$20 goes to USDF per person and \$10 remains in the Foundation as your dues); \$45 family membership for two listed persons (include \$10 per each additional family member).

The objective of the Foundation is for the preservation and protection of the sport and art of dressage and to encourage its development to the highest levels. The Foundation's work will be limited to the organization of dressage competitions and the creation of educational opportunities such as seminars, clinics, scholarships and forums. An annual meeting is held every January, but no monthly meetings since most of our work is done by phone and e-mail.

Membership dues and renewals will be due Nov. 1st for the next year. Those joining for the first time after Sept. 1 will members for the next year.

We will use our GHF e-mail lists to send out prize lists for our upcoming shows. Information about other GHF activities can be found on our website.

Riders competing in GHF Schooling Shows will be automatically enrolled as GHF members for that year if they complete this membership form and attach it to their entry form.

(revised 9/30/2018)

Name _____ USDF No. _____

☐ Joined at show?

☐ New?

☐ Renewal?

☐ Lapsed?

Farm or Horse-Related Business Name _____

Address _____

City _____ State _____ ZIP _____

Phone _____ (home) _____ (work)

E-mail address (Please print clearly) _____

Website (Please print) _____

Junior/Young Rider Birth Date (for USDF) _____

Are you willing to volunteer at GHF events? ☐ Yes ☐ No. If yes, please list your interests and abilities ? _____

Make checks payable to **The Good Horseman® Foundation** and mail to:

Patricia Powell, GHF Membership Chairman
6178 Yellow Creek Road
Murrayville, GA 30564
404-275-3447



A Group Member Organization of the United States Dressage Federation, Inc.

Visa/MC No. _____ Exp. date _____ CSV Code _____ \$10 EFT Fee

Name on card _____ Zip Code where credit card statement is received _____

Entry No.	Time	Location	Notes
1	10:00	1000	1000
2	10:05	1000	1000
3	10:10	1000	1000
4	10:15	1000	1000
5	10:20	1000	1000
6	10:25	1000	1000
7	10:30	1000	1000
8	10:35	1000	1000
9	10:40	1000	1000
10	10:45	1000	1000
11	10:50	1000	1000
12	10:55	1000	1000
13	11:00	1000	1000
14	11:05	1000	1000
15	11:10	1000	1000
16	11:15	1000	1000
17	11:20	1000	1000
18	11:25	1000	1000
19	11:30	1000	1000
20	11:35	1000	1000
21	11:40	1000	1000
22	11:45	1000	1000
23	11:50	1000	1000
24	11:55	1000	1000
25	12:00	1000	1000
26	12:05	1000	1000
27	12:10	1000	1000
28	12:15	1000	1000
29	12:20	1000	1000
30	12:25	1000	1000
31	12:30	1000	1000
32	12:35	1000	1000
33	12:40	1000	1000
34	12:45	1000	1000
35	12:50	1000	1000
36	12:55	1000	1000
37	13:00	1000	1000
38	13:05	1000	1000
39	13:10	1000	1000
40	13:15	1000	1000
41	13:20	1000	1000
42	13:25	1000	1000
43	13:30	1000	1000
44	13:35	1000	1000
45	13:40	1000	1000
46	13:45	1000	1000
47	13:50	1000	1000
48	13:55	1000	1000
49	14:00	1000	1000
50	14:05	1000	1000
51	14:10	1000	1000
52	14:15	1000	1000
53	14:20	1000	1000
54	14:25	1000	1000
55	14:30	1000	1000
56	14:35	1000	1000
57	14:40	1000	1000
58	14:45	1000	1000
59	14:50	1000	1000
60	14:55	1000	1000
61	15:00	1000	1000
62	15:05	1000	1000
63	15:10	1000	1000
64	15:15	1000	1000
65	15:20	1000	1000
66	15:25	1000	1000
67	15:30	1000	1000
68	15:35	1000	1000
69	15:40	1000	1000
70	15:45	1000	1000
71	15:50	1000	1000
72	15:55	1000	1000
73	16:00	1000	1000
74	16:05	1000	1000
75	16:10	1000	1000
76	16:15	1000	1000
77	16:20	1000	1000
78	16:25	1000	1000
79	16:30	1000	1000
80	16:35	1000	1000
81	16:40	1000	1000
82	16:45	1000	1000
83	16:50	1000	1000
84	16:55	1000	1000
85	17:00	1000	1000
86	17:05	1000	1000
87	17:10	1000	1000
88	17:15	1000	1000

Chattahoochee Hills Farm, Fairburn, GA
ENTRY FORM (include signature page)

Entries may not be accepted without all signatures, full payment of fees and copies of all certification including USEF/USDF cards and Coggins and USDF horse recording and/or registration certificates. Those entering qualifying classes should read the USDF Regional Championships information page included in this prize list. **One entry form per horse/rider combination.**

Date Rec'd _____

Amt. _____

Coggins _____ HC _____

Rhino Shot record _____

Signatures _____

USEF Level 3 Competition

Rider	Owner	Trainer (person responsible for horse)		Coach (for paid instruction at show)	
Jr/YR Date of Birth _____	Street Address	Street Address		Street Address	
Street Address		City,State,ZIP		City,State,ZIP	
City,State,ZIP	City,State,ZIP	Phones: _____ home _____ work		Phones: _____ home _____ work	
Phones: _____ home _____ work	Phones: _____ home _____ work	E-mail (please print): _____		E-mail (please print): _____	
E-mail (please print): _____	E-mail (please print): _____	USEF card (enclose copy): _____		USEF card (enclose copy): _____	
USEF card (enclose copy):	USEF card (enclose copy):	Day	Class Code	Class Description	Q?
USDF card (enclose copy):	USDF card (enclose copy):				Fees

Horse's Name _____ ☐ check if for sale

Breed _____ Sex _____ Height _____ Color _____ Year foaled _____

Horse's USEF No. (include copy) _____

Horse's USDF No. (include copy) _____

Name of Sire _____

Name of Dam _____

Name of Dam's Sire _____

Breeder _____ Country where foaled _____

Stabling: For large groups, make stabling map and attach to entry form. Please use one name for groups.

Group Name: _____

If you are traveling from out of state, don't forget horse's health certificate copy. Fill out separate form for non-competing horse.

**ENTRIES WILL NOT BE ACCEPTED WITHOUT
ALL SIGNATURES ON FOLLOWING PAGE—EVEN IF IT IS THE SAME
PERSON. BOTH PAGES REQUIRED FOR ENTRY.**

Visa/MC No. _____

Exp. date _____ CVS Code _____ \$10 EFT Fee ☐

Name on card _____

Zip Code where credit card statement is received _____

Day	Class Code	Class Description	Q?	Fees
Total Class Fees (Add \$15 to class fee for USDF qualifying)				
USEF "Show Pass" non-member fee (\$45.00) per rider, owner, trainer, coach)				
USDF Non-Member fee (35.00) per rider and owner				
USEF Federation Fee Per Horse (D&M fee \$8.00)				\$23.00
USDF Horse ID (HID) number fee \$35 (for unregistered horses)				
Stabling Fee (See STABLING)				
Tack Stall Fee (\$95.00) /per show) No shavings.				
Extra shavings delivered at \$8.00 per bag (How many bags? _____)				
Late Fee \$20.00 per entry (for entries accepted after closing date)				
Office Fee (per entry) (includes Perfekt Paket refund)				\$40.00
Night Watch fee per horse for weekend				\$7.00
EFT fee (for Visa/MC payment) \$10.00				
EMT Fee (per entry)				\$5.00
Camper/RV Hook-up (\$50/night) (How many nights? _____) Need 30 Amps? _____ Need 50 amps? _____				
GHF Membership/\$30 (optional—see Membership Page.)				
Total				

Federation Entry Agreement

By entering a Federation-licensed Competition and signing this entry blank as the Owner, Lessee, Trainer, Manager, Agent, Coach, Driver, Rider, Handler, Vaulteur or Longeur and on behalf of myself and my principals, representatives, employees and agents, I agree that I am subject to the Bylaws and Rules of The United States Equestrian Federation, Inc. (the "Federation") and the local rules of (Competition). I agree to be bound by the Bylaws and Rules of the Federation and of the competition. I will accept as final the decision of the Hearing Committee on any question arising under the Rules, and agree to release and hold harmless the competition, the Federation, their officials, directors and employees for any action taken under the Rules. I represent that I am eligible to enter and/or participate under the Rules, and every horse I am entering is eligible as entered. I also agree that as a condition of and in consideration of acceptance of entry, the Federation and/or the Competition may use or assign photographs, videos, audios, cable-casts, broadcasts, internet, film, new media or other likenesses of me and my horse taken during the course of the competition for the promotion, coverage or benefit of the competition, sport, or the Federation. Those likenesses shall not be used to advertise a product and they may not be used in such a way as to jeopardize amateur status. I hereby expressly and irrevocably waive and release any rights in connection with such use, including any claim to compensation, invasion of privacy, right of publicity, or to misappropriation. The construction and application of Federation rules are governed by the laws of the State of New York, and any action instituted against the Federation must be filed in New York State. See GR908.4.

Federation Release, Assumption of Risk, Waiver, and Indemnification

This document waives important legal rights. Read it carefully before signing.

I AGREE in consideration for my participation in this Competition to the following:

I AGREE that the "Federation" and "Competition" as used herein includes the Licensee and Competition Management, as well as all of their officials, officers, directors, employees, agents, personnel, volunteers and Federation affiliates.

I AGREE that I choose to participate voluntarily in the Competition with my horse, as a rider, driver, handler, vaulteur, longeur, lessee, owner, agent, coach, trainer, or as parent or guardian of a junior exhibitor. I am fully aware and acknowledge that horse sports and the Competition involve inherent dangerous risks of accident, loss, and serious bodily injury including broken bones, head injuries, trauma, pain, suffering, or death. ("Harm").

I AGREE to hold harmless and release the Federation and the Competition from all claims for money damages or otherwise for any Harm to me or my horse and for any Harm of any nature caused by me or my horse to others, even if the Harm arises or results, directly or indirectly, from the negligence of the Federation or the Competition.

I AGREE to expressly assume all risks of Harm to me or my horse, including Harm resulting from the negligence of the Federation or the Competition.

I AGREE to indemnify (that is, to pay any losses, damages, or costs incurred by) the Federation and the Competition and to hold them harmless with respect to claims for Harm to me or my horse, and for claims made by others for any Harm caused by me or my horse while at the Competition. I have read the Federation Rules about protective equipment, including GR801 and, if applicable, EV114, and I understand that I am entitled to wear protective equipment without penalty, and I acknowledge that the Federation strongly encourages me to do so while **WARNING** that no protective equipment can guard against all injuries. If I am a parent or guardian of a junior exhibitor, I consent to the child's participation and **AGREE** to all of the above provisions and **AGREE** to assume all of the obligations of this Release on the child's behalf, I represent that I have the requisite training, coaching and abilities to safely compete in this competition.

I AGREE that if I am injured at this competition, the medical personnel treating my injuries may provide information on my injury and treatment to the Federation on the official USEF accident/injury report form.

BY SIGNING BELOW, I AGREE to be bound by all applicable Federation Rules and all terms and provisions of this entry blank and all terms and provisions of this Prize List. If I am signing and submitting this Agreement electronically, I acknowledge that my electronic signature **shall have the same validity, force and effect as if I affixed my signature by my own hand.** BOD 1/23/11 Effective 12/1/11

Rider/Driver/Handler/

Vaulteur/Longeur (mandatory)

Owner/Agent (mandatory)

Trainer (mandatory)

Coach (if applicable)

Signature: _____ **Signature:** _____ **Signature:** _____ **Signature:** _____

Print Name: _____ **Print Name:** _____ **Print Name:** _____ **Print Name:** _____

Date of signing _____ **Emergency Contact Phone No. (USEF requirement GR906.3.)** _____

Parent/Guardian Signature: _____
(Required if Rider/Driver/Handler/Vaulteur/Longeur is a minor)

Print Parent/Guardian Name: _____

Is Rider/Driver/Vaulteur a U.S. Citizen? _____ **If no, what country?** _____ **Is rider an Adult Amateur?** _____

Is rider under age 23? If so, please list date of birth: _____

“WARNING: Under Georgia Law, an equine activity sponsor or equine professional is not liable for an injury to or the death of a participant in equine activities pursuant to Chapter 12 Title 4 of the Official Code of Georgia Annotated.”

USEF Competition Name:

The Good Horseman/Massey Ferguson Spring Dressage Show

Division and Level: *Dressage, Level 3*

USEF # 330927

ATTENTION COMPETITORS



USEF SAFE SPORT TRAINING REQUIREMENT

Starting January 1, 2019, if you are a USEF Competing Member 18 years of age or older you are required to complete the core Safe Sport Training within 30 days of activating your membership.

If you do not complete the training, you are ineligible to participate in all USEF activities including competitions.

TAKE the SAFE SPORT TRAINING at USEF.org by logging into your member dashboard.

#youarenotalone



USEF MEMBERSHIP STATEMENT

Life, senior active and junior active members shall be eligible to participate in all classes at Regular Competitions, Eventing Competitions at the Preliminary Level or above and Combined Driving Competitions at the Advanced Level, Dressage, Reining and Vaulting Competitions and Endurance Rides. A nonmember may participate as a handler, rider, driver, owner, lessee, agent, coach or trainer at Regular Competitions, Eventing Competitions, Dressage Competitions, Reining Competitions and Combined Driving Competitions upon payment of a \$45 Show Pass fee. Participants in the following classes are exempted from the Requirements of this rule: 1) leadline; 2) exhibitions; 3) games and races; 4) classes for 4-H members; 5) walk trot (exception: Friesian performance FR222) and academy classes (academy classes are classes limited to horses used regularly in a lesson program); 6) USDF introductory level tests, pas de deux and quadrille classes; 7) NRHA Endorsed Reining Competitions. 8) Opportunity classes, 9) citizens of other nations who have proof, in English, of current membership in good standing of their own National Federation, 10) USEA beginner novice division; and 11) assistant handlers in Dressage Sport Horse Breeding classes.

2019 GHF YEAR-END AWARDS

Riders do not have to be GHF members to be eligible for these awards nor do they have to submit their scores. Scores from all Good Horseman USDF/USEF-recognized shows will be used. Final tabulations will be done by the GHF office at the end of the year following the September show.

It is the competitors' responsibility to check their scores that are published when the year-end results are posted on the GHF website's Awards page following the September show and to report any possible errors to the GHF office.

A certificate in a special frame will be mailed to the top horse/rider combination achieving the highest percentile (averaged percentage) in the following levels: Training through Fourth Level, Prix St. Georges, Intermediaire I, II, A and B, Grand Prix and Freestyle (any level). The Intermediaire tests will count as one level. Scores used will be from the Open, Adult Amateur and Jr./YR divisions only.

Certificates will be mailed to the reserve high-score winners.

To compete for this award, riders must have at least three scores of 60% and above to be averaged (no scores will be dropped). Results below 60% will not be awarded.

Also awarded will be **The Good Horseman Medal** which will be given to riders achieving scores of 75% or better at Training through the FEI levels (Adult Amateur, Jr./Young Rider and Open divisions), excluding Freestyle, Introductory, the FEI Young Horse and Rider tests which are scored differently and cannot be compared.

USDF Statement on Animal Welfare

USDF Statement on Animal Welfare The United States Dressage Federation, Inc. (USDF), a federation of over 100 independent organizations throughout the United States with a membership of nearly 30,000 members, supports the concept of ethical treatment of animals. Dressage is a classical method of training horses, based upon the horse's natural responses, as carried out in a gradual, planned program during which the horse's athletic abilities are improved in a systematic manner. As a result, the horse becomes capable, comfortable, and responsive in partnership with the rider without the use of force. Dressage competition at various levels of achievement is the ultimate test of the training program to determine whether the desired harmony between horse and rider has been achieved. The rules pertaining to dressage competition prohibit the use of artificial appliances, training aids, and drugs, which would force the horse to submit. Instead, the emphasis is upon training and a cooperative partnership with the rider. Major competitions are carefully monitored to assure that there is no unnecessary force or harshness displayed. Unlike other horse sports in which horses enter training at a relatively immature state, dressage training is usually not seriously begun until the horse is three or four. The top levels of achievement require five or more years of progressive training and it is not unusual to see horses in international competition in their late teens. This, in itself, places a premium on good care and soundness throughout the horse's life. While supporting the concept of animal welfare in its broadest form, the United States Dressage Federation, Inc., also recognizes that it is unrealistic to ascribe human emotions and responses to the horse which in its wild state is a creature of flight, living a hard and precarious existence. Under domestication, the horse is assured of ample food, water, and shelter, as well as protection against infectious diseases and damaging parasites, thus leading a longer and healthier life with a high rate of survival. As an educational organization, USDF has numerous programs, which teach people how to pursue the accepted, humane training methods. A program of certifying instructors also emphasizes protecting the horse's welfare in pursuit of dressage training.

United States Dressage Federation

4051 Iron Works Parkway, Lexington, KY 40511

Phone: 859-971-2277, Fax: 859-971-7722, usdressage@usdf.org www.usdf.org

Application for the Jockey Club Thoroughbred Incentive Program (T.I.P) Awards



T.I.P. Entry Information Form

This form should be submitted by an exhibitor directly to a horse show offering T.I.P. classes and awards. For purposes of eligibility for all T.I.P. classes and awards, a "Thoroughbred" is defined as any horse that has been registered with The Jockey Club.

Exhibitors: Please fill out this section, attach a copy of your proof of eligibility and submit both this form and the copy to the Horse Show with your entry and/or bring the originals to the horse show for presentation upon request.

Proof of Eligibility:

- The Jockey Club Certificate of Foal Registration; or
- The horse's lip tattoo, the horse's 5-cross pedigree and the successful tattoo lookup result from The Jockey Club's Tattoo Identification Services (located at registry.jockeyclub.com); or
- A letter from The Jockey Club acknowledging eligibility for participation in T.I.P. (please email tjctip@jockeyclub.com to obtain).

Horse Show Name & Date	GHF/Massey Ferguson Spring Dressage Show,
Your Name	
Thoroughbred's Registered Name	
Thoroughbred's Show Name	
Thoroughbred's Registration No. or Tattoo No.	
Sire's Name	
Dam's Name	

For Horse Show Use only:

Based on the information provided, the above referenced Thoroughbred is

☐ **Eligible** ☐ **Ineligible**

Please return these forms (or a copy thereof) upon the completion of the horse show to The Jockey Club Thoroughbred Incentive Program, 821 Corporate Dr., Lexington, KY 40503.



\$150 Friesian/Baroque High-Score Awards

Sponsored by CBH International, Inc.

APPLICATION

This form should be submitted by the exhibitor directly to the show offering the \$150 Friesian/Baroque Awards. For purposes of eligibility for this award, exhibitors must submit this form, with the entry form and valid registration certificates from the following registries: Friesian and Baroque (limited to PRE, Andalusian, Lusitano and Lippizan.)

Exhibitors: Please fill out this section, attach a copy of your proof of eligibility and submit both this form and a copy of the registration certificate to the show secretary along with your regular entry form.

Details:

*Awards will be given to the top six registered Friesian or Baroque horses in the Saturday show in Training Level through Fourth Level, PSG through Grand Prix (Adult Amateur, Open and Junior/Young Rider classes). Introductory, Green Horse, Freestyle, Rider and Young Horse tests do not count.

*There must be at least three eligible Friesian or Baroque horses competing for money to be given.

***CBH International, Inc.**, will give \$100 to the 1st place winner and \$50 to the second place winner, along with special neck sashes.

*A mounted awards ceremony will be held on Sunday right after lunch break.

*There is no special fee only the class fee. Only one highest score will be used per horse. The results will be “weighted” which means that the higher the test the more percentage points the performance receives, i.e. Training Level, no additional points; First Level, 1 point; Second Level, 2 points; Third Level 3 points; Fourth Level 4 points; FEI Level 5 points. The registration papers should accompany entry form.

Show Name	GHF/Massey Ferguson Spring Dressage Show
Rider's Name	
Owner's Name	
Horse's Registered Name	
Horse's Show Name (if different)	
Horse's Registration Number	
Sire's Name	
Dam's Name	
Breeder's Name	



THE GOOD HORSEMAN® FOUNDATION



2019 CALENDAR

◆ **March 23-24 GHF/Massey Ferguson Spring Dressage Show (USDF/USEF),** (2019 USEF/NAYC/Young Horse qualifier), Chattahoochee Hills Farm, Fairburn, GA.

Judges: Beverly Rogers and Sarah Geikie

◆ **April 27-28 GHF/Massey Ferguson Dressage at the Horse Park (USDF/USEF),** (2019 USEF/NAYC/Young Horse qualifier), Covered Arena, Georgia International Horse Park, Conyers, GA.

Judges: Debbie Riehl-Rodriguez and Kathy Rowse

◆ **June 8-9 GHF/Massey Ferguson Annual Dressage Show 1st and 2nd Editions,** (USDF/USEF), (2019 USEF/NAYC/Young Horse qualifier), Covered Arena, Georgia International Horse Park, Conyers, GA.

Judges: Janet Foy and Elizabeth Lewis

◆ **July 27-28 GHF/Massey Ferguson Dressage at the Horse Park (USDF/USEF),** (2019 USEF/NAYC/Young Horse qualifier), Chattahoochee Hills Farm, Fairburn, GA.

Judges: Marilyn Heath and Susan Roberto Buchanan

◆ **Sept. 15-16 GHF/Massey Ferguson Fall Dressage Shows #1 and #2,** (USDF/USEF), (2019 USDF RC qualifier and 2020 USEF/NAYC qualifier) Covered Arena, Georgia International Horse Park, Conyers, GA.

Judges: Debra Rodriguez and Marilyn Payne

Call 404-289-9328 cell

**or e-mail: goodhorseman@att.net
www.goodhorseman.org**



2019 Great American Insurance Group/USDF Regional Dressage Championships

A single Regional Dressage Championship program organized by the United States Dressage Federation (USDF), and recognized by the United States Equestrian Federation, Inc. (USEF), will be held in each of the nine USDF regions. In addition, Alaska and Hawaii may each hold state championships if an official request from a Group Member Organization (GMO) is received by April 1 of the prior year. The Regional Championship Program Rules can be found on the USDF website at www.usdf.org. Please refer to the 2019 USDF Member Guide for the comprehensive list of rules and requirements for this program.

Membership/Registration Requirements for Qualifying and Championships

All memberships and registrations/recordings must be correct and current at the time qualifying scores are earned and at the time of the championships.

Rider:

- Must have a USDF Participating* Membership (PM).
- Must have a USEF membership (Junior Active, Senior Active, or Life).

Horse:

- Must have a USDF Lifetime Horse Registration (LHR).
 - Must have a USEF (Annual or Lifetime) Horse recording.
 - USDF horse registration and USEF horse recording must be in the name(s) of the current owner(s) or lessee(s) of record.
- A horse is not required to have breed registry papers.

Owner:

- Must have a USDF Participating or Business Membership and a USEF membership (Junior Active, Senior Active, Life, or Recorded Farm (with Active Farm Owner)). If the horse has more than one owner, at least one owner must have both active USEF membership and active USDF Participating or Business Membership and must be the owner of record with USEF and USDF. For a business or farm to be the valid owner under this requirement, it must be listed as an owner of the horse with both USEF and USDF.

* PMs are USDF members who join USDF directly. USDF Group Members (GM) are ineligible.

Minimum Qualifying Scores: One set of nationally-standardized qualifying scores has been established for all USEF/USDF Regional Championships, for Training Level through Grand Prix, in three divisions: open, adult amateur and junior/young rider. FEI Junior and FEI Young Rider classes have only one respective division. Freestyles have only open divisions.

The minimum percentages are as follows:

	OPEN	AA	JR/YR
Training Level (Test 3)	68%	63%	63%
First Level (Test 3)	66%	62%	62%
Second Level (Test 3)	64%	61%	61%
Third Level (Test 3)	62%	60%	60%
Fourth Level (Test 3)	62%	60%	60%
FEI Junior (Team Test)	—	—	60%
FEI Young Rider (Team Test)	—	—	60%
Prix St. Georges	62%	60%	60%
Intermediate I	62%	60%	60%
Intermediate II	62%	60%	60%
Grand Prix	60%	60%	60%
FREESTYLE	OPEN	AA	JR/YR
First Level	65%	—	—
Second Level	65%	—	—
Third Level	65%	—	—
Fourth Level	65%	—	—
Intermediate I	65%	—	—
Grand Prix	65%	—	—

USDF Membership Benefits: USDF is dedicated to education, the recognition of achievement, and promotion of dressage. For details on member benefits, including educational programs, awards, and other opportunities, refer to the *USDF Member Guide* or the USDF website at www.usdf.org.

**This
competition
is recognized
by USDF
for 2019**

Membership Requirements for USEF-licensed/USDF-recognized Competitions: Owners and riders, including foreign riders and owners who are not residents of the US, wishing to participate in a USEF-licensed/USDF-recognized competition as a rider or owner/lessee, must have either a USDF Group Membership (GM), Participating Membership (PM), or have a USDF Non-Member (NM) identification number and pay the USDF Non-Member (NM) fee. (Note: USDF Business Members can own horses but cannot compete as riders with their USDF Business Membership.) Individuals cannot compete at a USEF-licensed/USDF-recognized competition with a USDF Education Membership.

Horses competing at USEF-licensed/USDF-recognized competitions must have either a USDF Horse Identification (HID) number or a USDF Lifetime Horse Registration (LHR). Proper credentials or verification certificates must be presented to the competition secretary.

Riders and owners wishing to participate in a USEF-licensed/USDF-recognized competition, and not able to present the competition secretary with verification of a USDF membership or NM identification, and USDF LHR or USDF HID, must complete a USDF Competition Affidavit Form and pay the \$5 affidavit filing fee. A copy of a completed affidavit form from another competition may also be used for verification purposes for up to 60 days. (Exception: Affidavits cannot be used at Great American Insurance Group/USDF Regional Dressage Championships.)

Exceptions:

- Horses competing only in Individual Breed Classes (IBCs) at DSHB competitions, sires and dams of horses in DSHB group classes, where those sires or dams are not actually competing in the same competition, horses competing only in breed restricted dressage or DSHB classes at Regular Competitions (e.g. all Arabian, all Friesian, or all Morgan classes), or in USDF Introductory Level tests, pas de deux or quadrille, are exempt from this requirement. Also exempt are horses ridden in leadline, exhibitions, games and races, classes for 4-H members, walk-trot, academy, and opportunity classes.
- Riders and owners/lessees competing only in classes which are exempt from the USDF HID requirements are also exempt from the USDF NM identification number and NM fee requirements. Also exempt are handlers of horses competing in DSHB In-Hand or Group classes.

Memberships Defined

Participating Membership (PM): A membership issued to an individual directly by USDF. The membership year is December 1 through November 30. PMs are available for 1-year (\$90), 5-years (\$360), or life (\$1,800). A USDF Youth Participating Membership (YPM) is available for individuals who have not reached their 21st birthday by December 1 of the current membership year (\$72). A PM allows the member to compete at USEF-licensed/USDF-recognized competitions and to participate as a rider and/or owner/lessee for all Adequan®/USDF Year-End Awards and the Great American Insurance Group/USDF Regional Dressage Championship program.

Group Membership (GM): A membership issued to an individual by USDF when the member name and dues are submitted to USDF through an affiliate Group Member Organization (GMO). The GM year begins December 1 and ends November 30. A GM allows the member to compete at USEF-licensed/USDF-recognized competitions and participate in the USDF Rider Awards program.

Business Membership (BM): A membership that runs December 1 through November 30 and is issued to a business or organization directly by USDF. The USDF BM (\$240) offers a wider variety of advertising benefits. BMs satisfy requirements of horse ownership only.

Education Membership (EM): A membership issued to an individual directly by USDF. This online education only membership expires 12 months after the date joined. This membership type does NOT allow an individual to compete at a USEF-licensed/USDF-recognized competition.

Non-Member (NM) Identification Number: For each USDF NM owner/lessee and USDF NM rider there will be a USDF NM fee of \$35 per competition that must be collected by the show secretary and submitted to USDF, along with the USDF Report of Fees document and the \$5 affidavit fee and Competition Affidavit Form if the person cannot provide a copy of their USDF NM card. Owners/lessees or riders exempt from the NM number requirements are also exempt from paying the USDF NM fee. If there are multiple owners of a horse and all are NMs, only one of the owners must pay the NM fee. If the horse has at least one owner who is a current USDF PM, GM, or BM there is no NM fee assessed. Competition management will be invoiced for all applicable USDF NM fees not received with the USDF post-competition paperwork, along with a report listing all USDF NMs. Competition management is then required to submit the NM fees within 30 days to the USDF. An individual with a USDF NM identification number is not eligible for any USDF membership benefits. Once a USDF NM number has been assigned, a USDF NM card can be obtained from the USDF website.

Horse Identification (HID) Number: A one-time tracking number for horses (\$35). Scores earned by a horse with an HID number will be recorded, but will NOT be counted towards Adequan®/USDF Year-End Awards. A horse with an HID number is not eligible to compete in Great American Insurance Group/USDF Regional qualifying or championship classes. An HID number can be upgraded to a Lifetime Horse Registration (LHR) for a fee of \$80. If a horse has a USDF LHR it does not need an HID number. An HID number is a one-time fee that does not need to be renewed.

Lifetime Horse Registration (LHR): A horse with an LHR (\$115) is eligible for Adequan®/USDF Year-End Awards, and eligible to compete in Great American Insurance Group/USDF Regional qualifying and championship classes, assuming requirements for the owner and rider are met. If a horse has an LHR it does not need an HID number. An LHR does not need to be renewed.

How to Join USDF

Applications for USDF Participating Membership (PM), Business Membership (BM), Horse Identification (HID) number, and Lifetime Horse Registration (LHR) may be found in the following locations:

- On the USDF website: www.usdf.org. You can submit the application online or download the form and fax or mail it to the USDF office.
- In the show office at USEF-licensed/USDF-recognized competitions classified by USEF as Dressage Competitions, and Regular Competitions which are open to all breeds.
- By calling or writing the USDF office at (859) 971-2277, 4051 Iron Works Parkway, Lexington, KY 40511

The effective date of membership is the date the form and correct fees are received in the USDF office or, if applying at a competition, the date accepted by the competition secretary, provided the application is signed and dated by the competition secretary, member, and/or horse owner on that same day.

The Good Horseman®'s Dressage Events



Ann Genovese, Organizer
4567 Rockbridge Road #297
Pine Lake, GA 30072
404-289-9328 cell (No FAX, please e-mail)
e-mail: goodhorseman@att.net
website: www.goodhorseman.org



*The Good Horseman® Foundation is a 501-c-3 non-profit educational organization
and a Group Member Organization of The United States Dressage Federation (USDF).*

Advertising Rates

We have type-setting capabilities. You may **handwrite** what you would like to have in your ad.
We will need clean, clear reproductions of photos, logos or other art.
Make checks payable to The Good Horseman® Foundation, and mail to address above.

Show Program (circle one)

- Full page (7½x 10"): \$ 175
- Full-color full page \$ 200
- Half-page (7½x5"): \$ 100
- Full-color half page \$ 125
- Quarter Page (7½x3½"): \$ 75
- Full-color quarter page: \$100

Name of Event _____ Event Date _____

Name of Company _____

Name of Person in Charge _____

Address _____ City _____ State _____ ZIP _____

Phone _____ Did you include ad copy? ☐ Yes ☐ No

E-mail: _____

RECEIPT

The Good Horseman® Foundation (IRS Tax ID #58-2163463)

Received \$ _____ from _____ (contributor's name)

Signed _____ (Foundation member) Date _____

Visa/MC No. _____ Exp. date _____

Name on card _____ \$10 EFT Fee _____ Total _____

22

Zip Code where credit card statement received _____ CSV# _____ Total _____

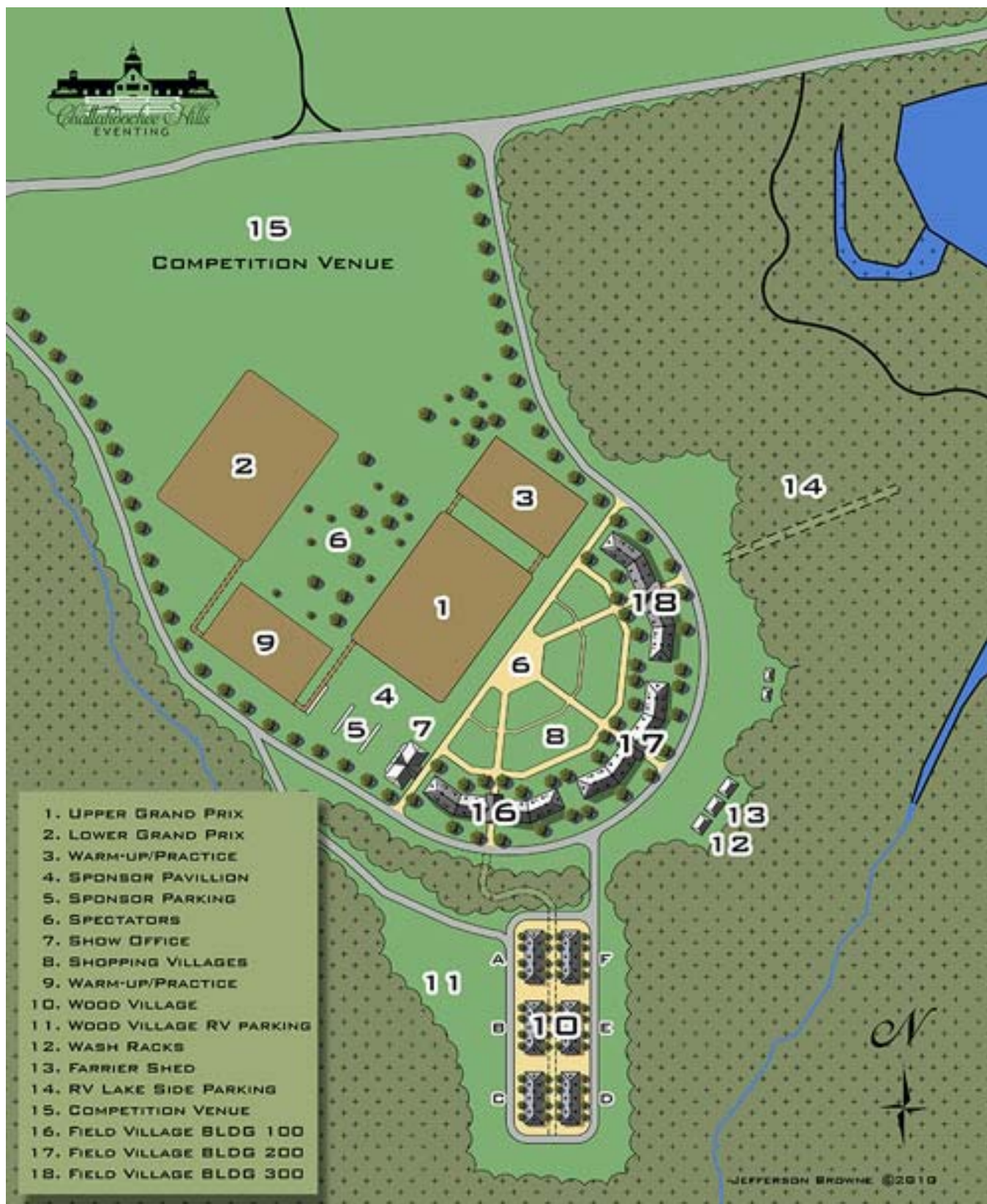



1. BOUCKAERT FARM
MAIN BARN COMPLEX
2. COMPETITION VENUE
3. TURF DRESSAGE
4. CROSS COUNTRY
5. SECURITY CHECK IN
6. ENTRANCE GATE
7. WEST CABIN
8. EAST CABIN
9. RV LAKE SIDE PARKING

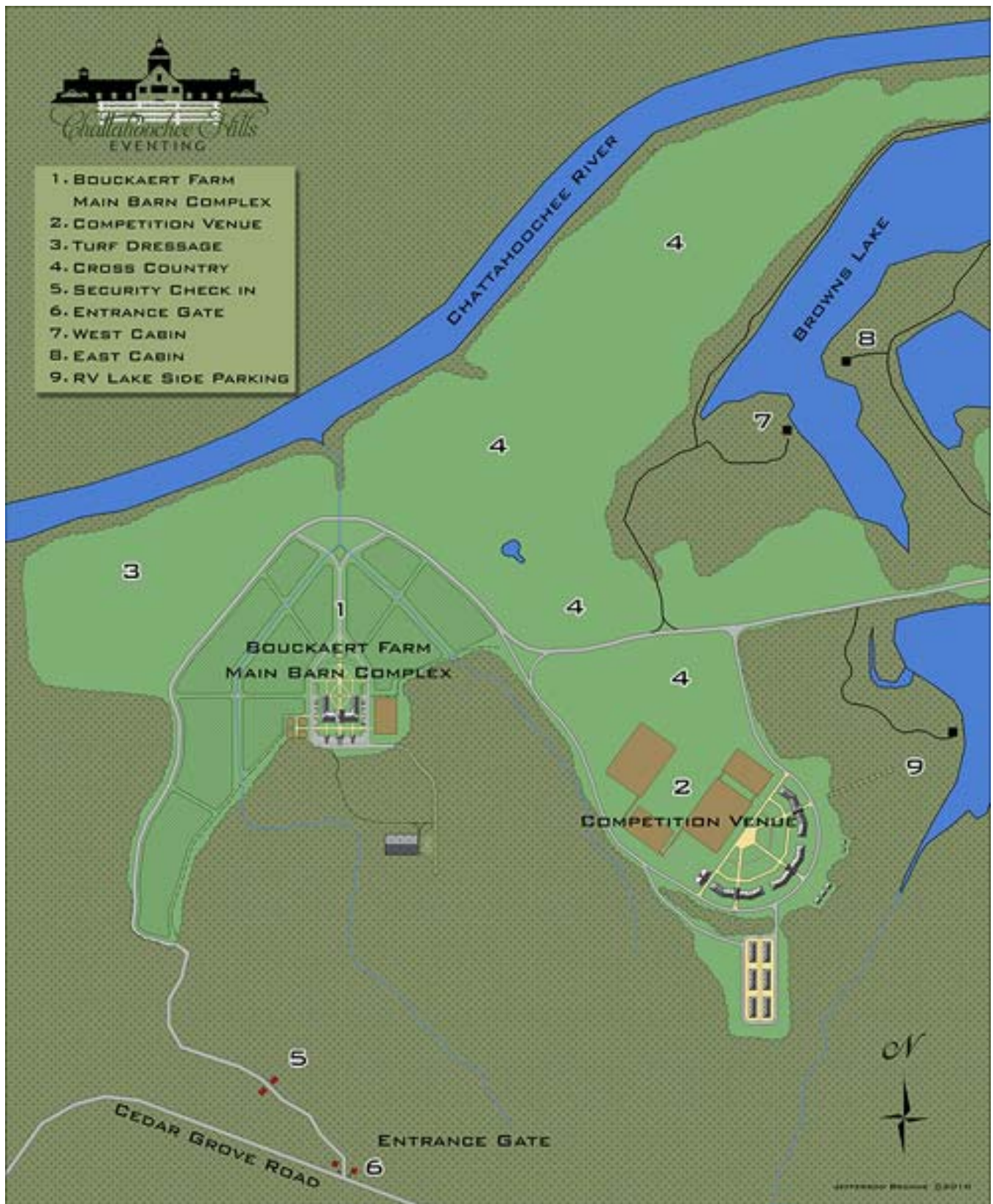



MASSEY FERGUSON

THE LAST TRACTOR YOU'LL EVER NEED

Bought my MF135, and it's still working hard today.

Years later, my son bought a compact tractor for his first piece of land.

I set aside a few acres for my first grandson. But he'll need to get his own Massey Ferguson.

1968
1970
1972
1974
1976
1978
1980
1982
1984
1986
1988
1990
1992
1994
1996
1998
2000
2002
2004
2006
2008
2010
2012
2014
2016
2018
2020
2022
2024
2026

Tough. Versatile. Dependable. Our tractors have been running in families for generations. Visit a dealer today and ask about our latest compact and mid-range tractors.