

# 4000 sq.ft. For Lease

## 26405 Northline Rd, Taylor, MI 48180



Listing ID: 30334662  
Status: Active  
Property Type: Industrial For Lease  
Industrial Type: Flex Space, Industrial-Business Park  
Contiguous Space: 4,000 SF  
Total Available: 4,000 SF  
Lease Rate: \$6 - 6.25 PSF (Annual)  
Base Monthly Rent: \$2,000 - 2,083  
Lease Type: Modified Gross  
Ceiling: 18 - 20 ft.  
Office SF: 550 SF  
Drive-In Bays: 1 Bay



### Overview/Comments

4,000 sq.ft. of light industrial for lease in Taylor Trade Center 1. Call Rea Construction at 734-946-8730 for a tour. 1 Mile From Detroit Metropolitan Airport.

### QR Code

Scan this image with your mobile device:



### General Information

Tax ID/APN:	263960770	Building Name:	Taylor Trade Center 1
Industrial Type:	Flex Space, Industrial-Business Park, Manufacturing, Mixed Use, Light Industrial, Self Storage, Warehouse/Distribution	Gross Building Area:	45,000 SF
		Building/Unit Size (RSF):	4,000 SF
		Usable Size (USF):	4,000 SF
Zoning:	LIGHT INDUSTRIAL	Land Area:	4 Acres

### Available Space

Suite/Unit Number:	26405	Rent Escalators:	Fixed Lease
Space Available:	4,000 SF	Offices:	1
Minimum Divisible:	4,000 SF	Office SF:	550 SF
Maximum Contiguous:	4,000 SF	Parking Spaces:	0
Space Type:	Relet	Drive In Bays:	1
Date Available:	10/01/2018	Ceiling Height:	20
Lease Rate:	\$6 - 6.25 PSF (Annual)	Clear Height:	18
Lease Type:	Modified Gross		

### Area & Location

Property Located Between: Beech Daly and Lang  
Highway Access: I94  
Airports: Detroit Metropolitan

### Building Related

Total Number of Buildings:	2	Parking Type:	Surface
Number of Stories:	1	Total Parking Spaces:	8
Office Space SF:	550 SF	Column Spacing:	40
Property Condition:	Good	Passenger Elevators:	0
Year Built:	1978	Freight Elevators:	0
Year Renovated:	2014	Amps:	200
Roof Type:	Flat	Volts:	220
Construction/Siding:	Brick	X-Phase:	3
Parking Ratio:	1.8 (per 1000 SF)	Heat Type:	Natural Gas

Lighting: Metal Halide  
Internet Access: Cable

Land Related

Water Service: Municipal  
Sewer Type: Municipal

Location

Address: 26405 Northline Rd, Taylor, MI 48180      MSA: Detroit-Warren-Dearborn  
County: Wayne      Submarket: Airport District



Property Images



taylor trade center 2



26405 Northline  
Taylor Trade Center 1

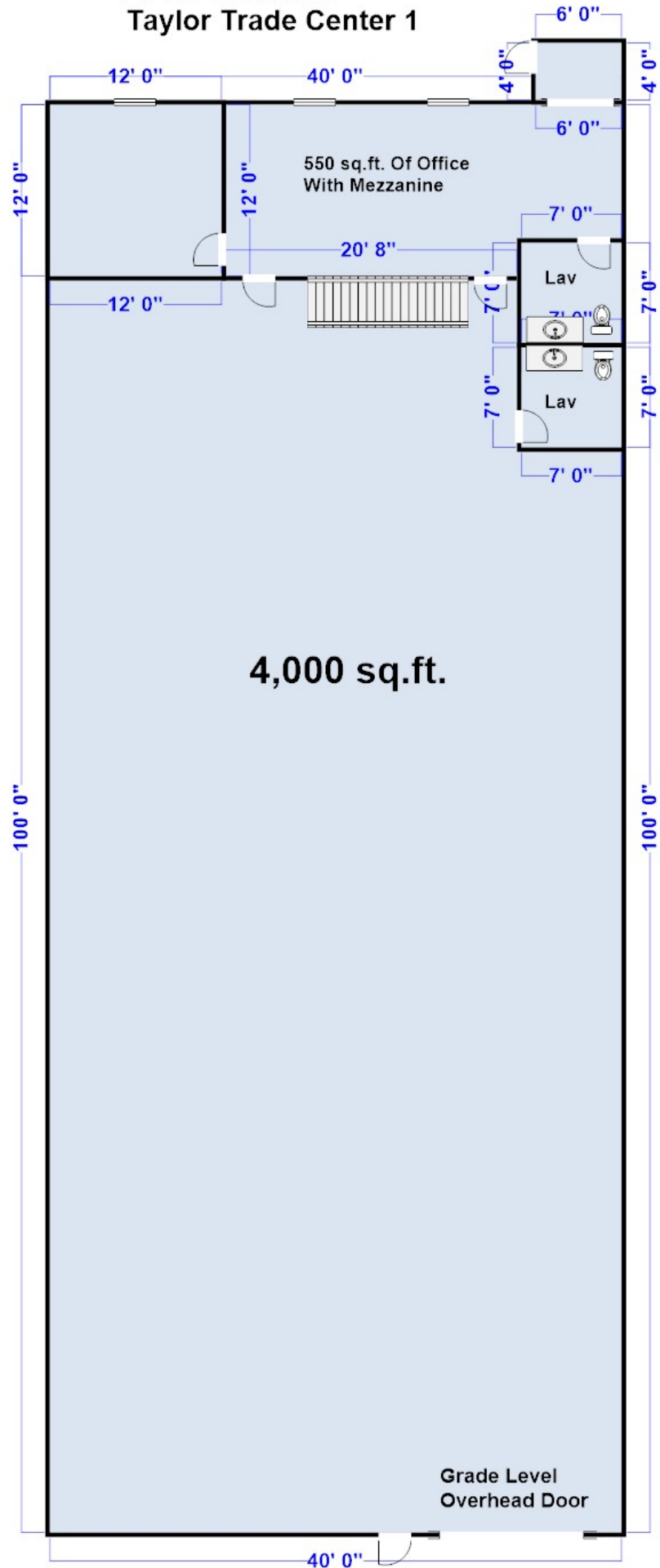

## Property Contacts

---



### **Yvon Rea**

Rea Construction

248-217-0482 [M]

734-946-8730 [O]

[darren@reaconstruction.net](mailto:darren@reaconstruction.net)