

CLEAR CREEK OFFICE PARK

FOR LEASE



\$14.00-\$20.00 SF

4251 Kipling St. Wheat Ridge, CO 80033

Property Summary

Building Size:	77,581 RSF
Parking:	3 : 1,000
Space Available:	1,297 - 7,854 RSF
Lease Rate:	\$14.00-\$20.00 RSF
Year Built:	1982
Stories:	Five (5)

Features

- * **NEW OWNERSHIP!!**
- * Common Area Conference Room & Breakroom
- * Lockers and Storage
- * Meticulously maintained building
- * Beautiful Outside area on Clear Creek
- * Ample Parking

For more information, please contact:

Rick Giarratano

T: 303.226.4765

rick@denverofficespace.com

Mike Lindquist

T: 303-226-4768

mike@denverofficespace.com

John Fairbairn

T: 303.226.4764

john@denverofficespace.com

1873 S. Bellaire Street | Suite 1200 | Denver, CO 80222 | 303-765-4344



The information above has been obtained from sources believed reliable. While we do not doubt its accuracy, we have not verified it and make no guarantee, warranty or representation about it. It is your responsibility to independently confirm its accuracy and completeness. Any projections, opinions, assumptions or estimates used for example only and do not represent the current or future performance of the property. The value of the transaction to you depends on tax and other factors which should be evaluated by your tax, financial and legal advisors. You and your advisors should conduct a careful, independent investigation of the property to determine to your satisfaction the suitability of the property for your needs.

CLEAR CREEK OFFICE PARK

FOR LEASE

RSF	Suite	Availability	Layout
1,297	160	Immediate	Spec Suite. Four exterior offices, kitchen with sink and reception.
2,276	110	Immediate	Five offices, large open area, kitchen with sink
2,495	525	Immediate	Reception, large open area, 4 offices
7,854	230	2/1/2016	Reception, multiple open areas, 9 offices, storage, kitchen with sink, western views (entire western portion of 2 nd floor). Divisible to approx. 1,500 SF.
2,291	540	Immediate	Plug and Play Medical space. Large waiting room, 5 exam rooms with sinks, storage, nurse's station, and doctor's office. Mountain and creek views



For more information, please contact:

Rick Giarratano

T: 303.226.4765

rick@denverofficespace.com

Mike Lindquist

T: 303-226-4768

mike@denverofficespace.com

John Fairbairn

T: 303.226.4764

john@denverofficespace.com



1873 S. Bellaire Street | Suite 1200 | Denver, CO 80222 | 303-765-4344

www.denverofficespace.com

The information above has been obtained from sources believed reliable. While we do not doubt its accuracy, we have not verified it and make no guarantee, warranty or representation about it. It is your responsibility to independently confirm its accuracy and completeness. Any projections, opinions, assumptions or estimates used for example only and do not represent the current or future performance of the property. The value of the transaction to you depends on tax and other factors which should be evaluated by your tax, financial and legal advisors. You and your advisors should conduct a careful, independent investigation of the property to determine to your satisfaction the suitability of the property for your needs.

CLEAR CREEK OFFICE PARK

MEDICAL SPACE FOR LEASE



\$20-\$21/ SF Full Service
4251 Kipling St. Wheat Ridge, CO 80033

Property Summary

Building Size:	77,581 RSF
Parking:	3 : 1,000
Space Available:	2,291 RSF
Lease Rate:	\$20-\$21 RSF
Year Built:	1982
Stories:	Five (5)

Features

- * New interior upgrades
- * Common Area Conference Room & Breakroom
- * Lockers and Storage
- * Meticulously maintained building
- * Beautiful Outside area on Clear Creek
- * Ample Parking
- * Available December 2015

For more information, please contact:

Rick Giarratano

T: 303.226.4765

rick@denverofficespace.com

Mike Lindquist

T: 303-226-4768

mike@denverofficespace.com

John Fairbairn

T: 303.226.4764

john@denverofficespace.com

1873 S. Bellaire Street | Suite 1200 | Denver, CO 80222 | 303-765-4344



www.denverofficespace.com

The information above has been obtained from sources believed reliable. While we do not doubt its accuracy, we have not verified it and make no guarantee, warranty or representation about it. It is your responsibility to independently confirm its accuracy and completeness. Any projections, opinions, assumptions or estimates used for example only and do not represent the current or future performance of the property. The value of the transaction to you depends on tax and other factors which should be evaluated by your tax, financial and legal advisors. You and your advisors should conduct a careful, independent investigation of the property to determine to your satisfaction the suitability of the property for your needs.

CLEAR CREEK OFFICE PARK

MEDICAL SPACE FOR LEASE

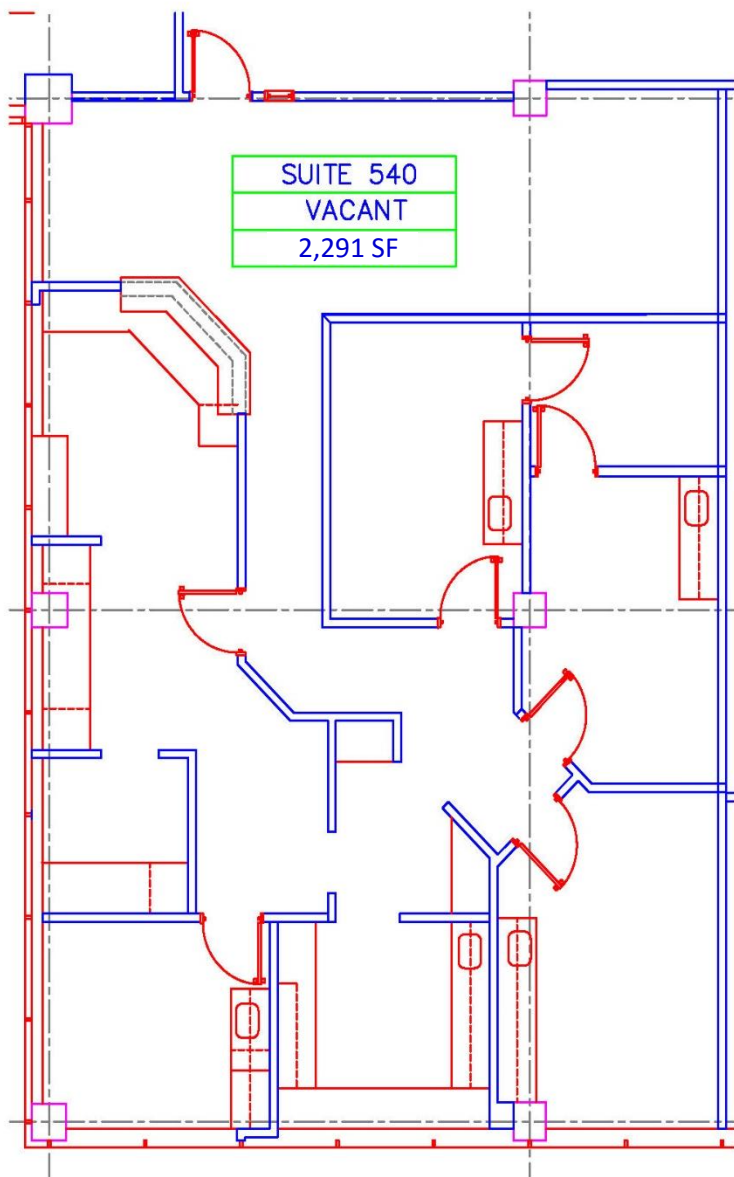

Suite 540 Amenities

- Plug and Play Medical Suite
- Configuration suits all medical practices
- \$20-\$21/sf Full Service Gross
- Sink in every exam room
- Professional nurses station
- Beautiful views of Clear Creek
- Close Proximity to Lutheran Hospital
- Easy access to I-70 & Mountains

Suite 540 - 2,291 RSF

4251 Kipling Street, Wheat Ridge, CO



For more information, please contact:

Rick Giarratano

T: 303.226.4765

rick@denverofficespace.com

Mike Lindquist

T: 303-226-4768

mike@denverofficespace.com

John Fairbairn

T: 303.226.4764

john@denverofficespace.com



1873 S. Bellaire Street | Suite 1200 | Denver, CO 80222 | 303-765-4344

www.denverofficespace.com

The information above has been obtained from sources believed reliable. While we do not doubt its accuracy, we have not verified it and make no guarantee, warranty or representation about it. It is your responsibility to independently confirm its accuracy and completeness. Any projections, opinions, assumptions or estimates used for example only and do not represent the current or future performance of the property. The value of the transaction to you depends on tax and other factors which should be evaluated by your tax, financial and legal advisors. You and your advisors should conduct a careful, independent investigation of the property to determine to your satisfaction the suitability of the property for your needs.