



## Features

### Frame Offering

- < Dedicated composite door outerframe heights of 68mm with matching sidelight frame and 38mm PVC low threshold frame
- < 88mm mullion for integrated side and top light options
- < Choice of 3 sidelight transom/midrail widths of 72mm, 86mm and 116mm
- < Aluminium disability low threshold with centre flipper seal
- < All sections available fully featured.

### Weatherseals

- < Outerframes incorporate a triple sealing system which includes the Q-Lon flipper gasket for improved compression and weathering
- < Aluminium low threshold incorporating double sealing system.

### Reinforcement

- < Dedicated galvanised steel and aluminium reinforcements.

### Finishes

- < Available in both standard white and brilliant white
- < Framing predominantly white, for use with solid coloured slabs. Available in woodgrain finishes to match woodgrain effect door slabs.

### Glazing

- < Fixed lights can be glazed with 24mm, 28mm and 36mm unit widths, dedicated beads for glazing 44mm slabs
- < Side panel glazing up to 44mm.

### Ancillaries

- < A comprehensive range of ancillaries, including add-ons, corner posts and couplers.

### Hardware

- < Designed to accept multi-point locks and various hinge types to achieved desired security levels
- < Handles, hinges and letterplates available in white, black, gold and chrome
- < Secured By Design and Part Q specification available.

### Ventilation

- < Proprietary ventilation devices can be used on all designs
- < A range of head details available including head extensions and one piece head vent with facility of recessed outer grill.

# Composite Door

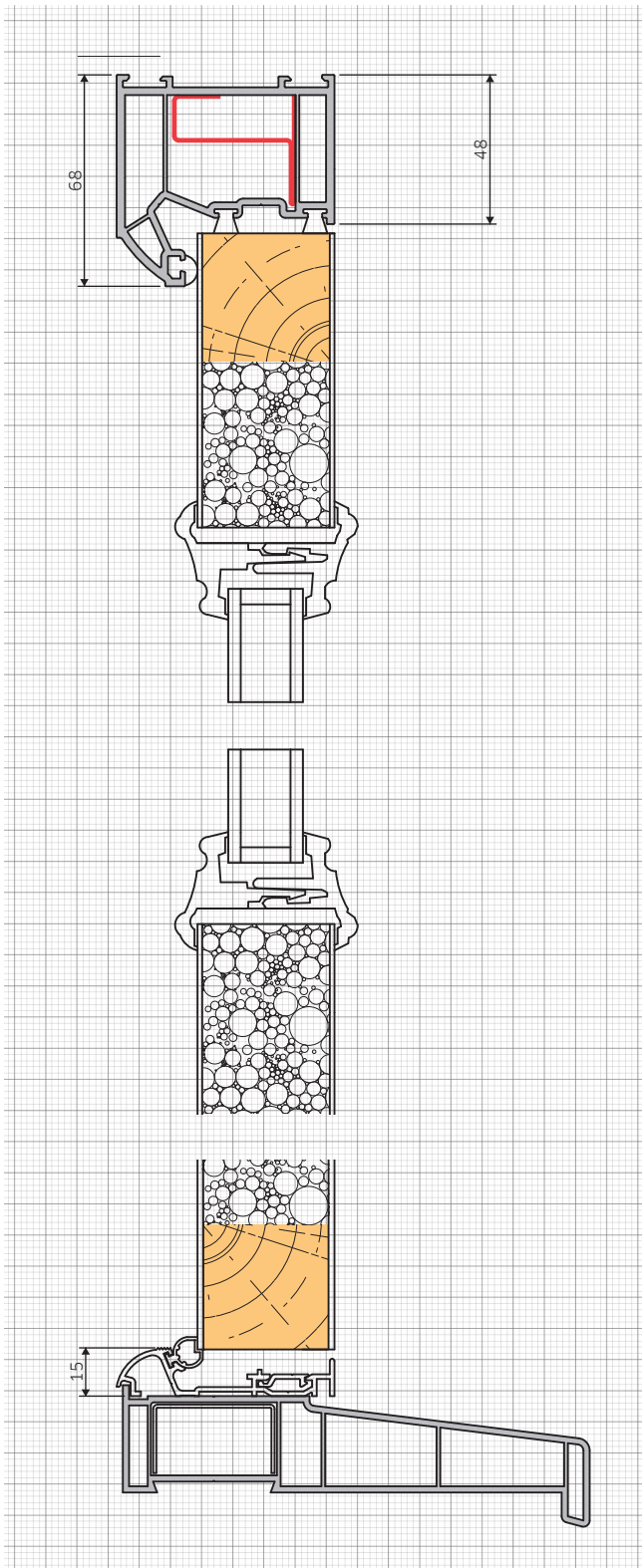

## Performance

### Security

- Multi-point high security locks available with hook and deadbolt locking to achieve Secured By Design status.

### Thermal

- A number of simulations have been carried out by 'approved' simulators at Duraflex providing a range of DER's for Doors following the introduction of doors to the Energy scheme in December 2011
- 'U' value simulations have been carried out to ensure the Building Regulations are met. Further detailed simulations are being carried out and added to our already comprehensive portfolio.

## General Features

- Q-Lon** - 99% compression recovery, high performance acoustic and weathersealing properties with lifetime guarantee. Operates perfectly in temperatures ranging from -20°C to 70°C
- Lead Free** - environmentally friendly, calcium organic lead free formulation
- Finishes** - comprehensive range of natural wood and solid colour foils
- Structural** - comprehensive range of coupling sections to suit various applications.

**Composite Door  
PVC Low Threshold**

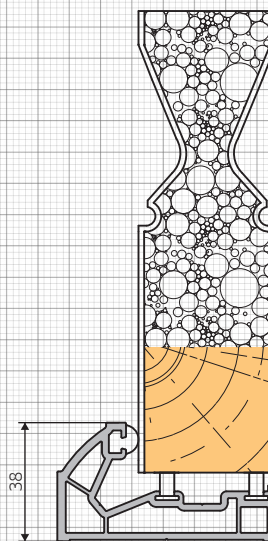

**Composite Door  
44mm Panel Glazing Bead**

