

LARGE MAMMAL COLLAR

Series M2700

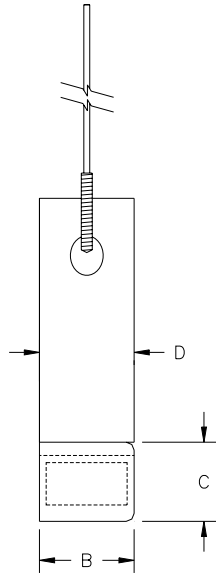
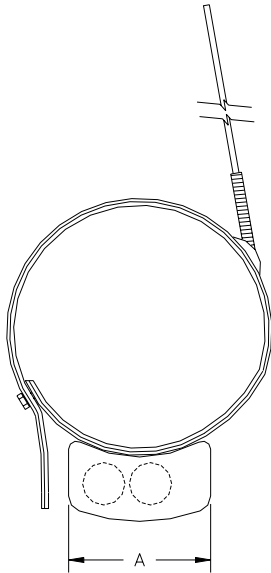

Technical Specifications

Transmitter type:	Crystal controlled 3-stage
Calibration tolerance:	± 2.5kHz
Frequency stability:	± 2.5kHz, -20°C to 40°C
Pulse rate and width:	Typical on time 20ms, off time 1100ms (controlled by uC)
Pulse rate variation:	0.01%/volt, ± 0.01% for temperatures -20°C to +40°C
Battery:	Lithium
Activation:	By removing magnet
Encapsulation:	Electrical resin, water-proof, specific gravity: 1.12

MODEL	BATTERY	BATTERY CAPACITY (days)		DIMENSIONS (mm)				WEIGHT ⁺ (grams)	PRICE GROUP
		40 ppm	55 ppm	A	B	C	D		
M2710B	D	20 YRS	15 YRS	115	78	60	76	1250	J

⁺ Weight for 3-ply butyl material inside and 3-ply neoprene collar outside. Other widths and material available.

Factors other than battery capacity may reduce life.

Warranty life is 50% of battery capacity, maximum of three years.