

## ICE CREAM HARDENING CABINET

### ICH-1D



#### CABINET CONSTRUCTION

- Stainless Steel Exterior
- Aluminum Interior
- Ice Cream Hardening Freezer On Top And Bottom
- Stay-Open Door Feature For Easy Product Loading
- 20 Gauge Stainless Steel Half-Doors
- Magnetic Door Switch Automatically Activates Interior LED Light
- Heavy-Duty Cylinder Locks
- Stainless Steel Interior Door Liner
- One Piece, Snap-In Magnetic Door Gaskets
- Low Profile Vertical Door Handles
- Hinged Front Shroud
- 6" High Adjustable Stainless Steel Legs
- 8' Cord And Plug (see electrical data for details)

#### FEATURES

- Full Electronic Control
- Expansion Valve Technology
- Anti-Condensate Perimeter Heater

#### REFRIGERATION

- Refrigeration System Uses R-290 Refrigerant To Comply With All Environmental Concerns
- Adaptive Defrost For Reduced Energy Consumption And More Consistent Product Temperatures
- Epoxy Coated Evaporator Coil
- Top And Bottom Ice Cream Hardening Freezer Capable Of Operating At -15°F To -25°F



▶ **2 Year Parts & Labor Warranty**  
 Plus An Additional 3 Year Compressor Warranty

#### OPTIONS & ACCESSORIES

- Additional Shelves : 50346001
- 6" Casters (set of four) : 0-0140-105
- 6" Seismic Legs (set of four) : 00C31-055A
- Shelf Clips (4 needed per shelf) : 50022601

#### Mention at time of order:

- Stainless Steel Case Back
- Door Swing Orientation

3779 Champion Blvd, Winston-Salem, NC 27105

ph: (888) 845-9800 | fax: (800) 253-5168

Sales@VictoryRefrigeration.com | VictoryRefrigeration.com | Icecream.carpigiani.com

Rev. 10/26/21 Printed in U.S.A.

APPROVAL: \_\_\_\_\_ DATE: \_\_\_\_\_

# ICE CREAM HARDENING CABINET

## ICH-1D

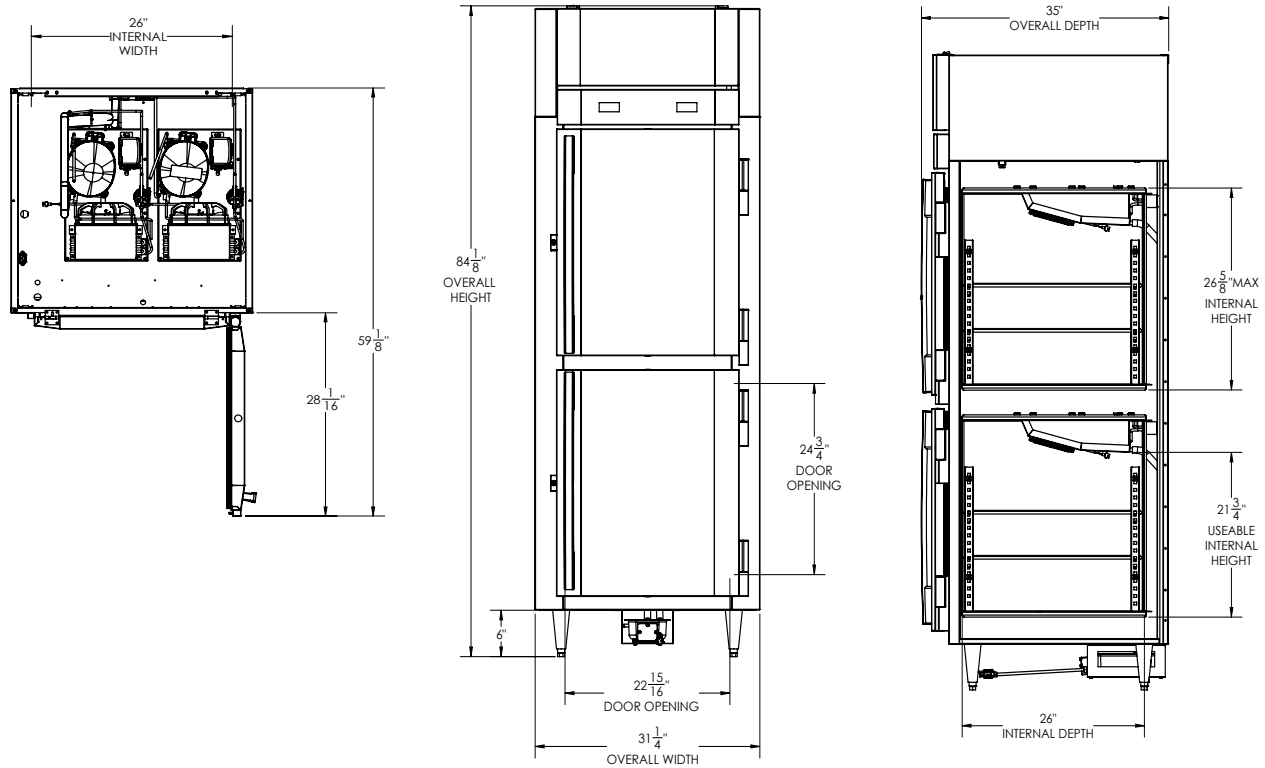

We reserve the right to change specifications and product design without notice. Such revisions do not entitle the buyer to corresponding changes, improvements, additions or replacements for previously purchased equipment. Dimensional tolerances +/- .14". Metric dimensions (MM)

12" Top and 3" rear clearance is required

CHARACTERISTICS		ELECTRICAL DATA (Note: There Are Two Power Cords)		SHIPPING DETAILS	
Net Capacity (cubic ft.)	2 x 10.2	Cabinet Voltage	115/60/1	Height	87"
Width, Overall (in.)	31 1/4"	Total Amperes	2X 7.2	Width	39"
Depth, Overall (with handle)	35"	NEMA Plug (8' cord)	2X 5-15P	Depth	41"
Height Overall (6" legs)	84 1/8"	REFRIGERATION DATA		Crated Weight	462 lbs
Depth, Door Open 90°	59 1/8"	Condensing Unit Size, HP	2X 3/4	For Optimum Performance, The Equipment Is Intended For Use In Rooms Having An Ambient Condition Of 75°F With 50% Relative Humidity Or Less.	
Door Opening (in.)	22 15/16" x 24 3/4"	Refrigerant	R-290		
No. Of Doors/Shelves	2/4	Capacity (BTU/HR) (100°F/20°F)	2X 1600		
		Heat Rejection (BTU/HR)	2X 2400		
		Charge (grams)	2X 85 g		

CAPACITIES					
2.5 Gallon Ice Cream Tubs With Racks	16	3 Gallon Ice Cream Tubs Without Racks	16	Full Size Sheet Pans (26" x 18") (additional shelves required)	8
2.5 Gallon Ice Cream Tubs Without Racks	24	5 Liter Std (14.17 x 6.49 x 4.72) Pans	28		
3 Gallon Ice Cream Tubs With Racks	12	Large 5 Liter (14.17 x 9.84 x 3.14) Pans	16		

3779 Champion Blvd, Winston-Salem, NC 27105 | ph: (888) 845-9800 | fax: (800) 253-5168

Sales@VictoryRefrigeration.com | VictoryRefrigeration.com | Icecream.carpigiani.com

Rev. 10/26/21 Printed in U.S.A.

ELECTRICAL CONNECTION  
DEDICATED CIRCUIT



115/60/1  
NEMA 5-15P

an Ali Group Company



The Spirit of Excellence