

**MITSUBISHI
ELECTRIC**
SPLIT-TYPE AIR CONDITIONERS

Changes for the Better

Mitsubishi
Electric
Quality

R22

CEILING CONCEALED

PAC07SA

Line-up

MITSUBISHI ELECTRIC offer a wide range of lineup to meet all air-conditioning needs of offices, shops, or workplaces.

A wide variety of highly-designed and high-performance/sophisticated products enabling efficient air-conditioning offer the best solution to your needs.

Ceiling Concealed



Refrigerant	Cooling Only	Heat Pump	Compressor	Control	5HP	6HP	8HP	
R22	●		Fixed speed	AK control	PE-5GAK	PE-6GAK	PE-8GAK	
					PU-5YJSA	PU-6YJSA	PU-8YAKD	
R22		●	Fixed speed	AK control	PEH-5GAK	PEH-6GAK		
					PUH-5YKSA	PUH-6YKSA		
				A control			PEH-8GA	
							PUH-8YKA	

Special Model

	Model name	Service reference	
Indoor Unit	PE-5 / 6 / 8 / 10 / 12 / 16 / 20GAK	PE-5 / 6 / 8 / 10 / 12 / 16 / 20 GAK.TH	
		PE-5 / 6 / 8 / 10 GAK.TH-SP	
		PE-5 / 6 / 8 / 10 / 12 GAK.TH-MF	
		PE-5 / 6 / 8 / 10 GAK.TH-SPMF	
	PEH-5 / 6GAK PEH-8 / 10 / 16 / 20GA	PEH-5 / 6 / 8 / 10 / 16 / 20 GA(K).TH	
		PEH-5 / 6 / 8 / 10 GA(K).TH-SP	
		PEH-5 / 6 / 8 / 10 GA(K).TH-MF	
		PEH-5 / 6 / 8 / 10 GA(K).TH-SPMF	
Outdoor Unit	PU-5 / 6YJSA PU-8 / 10 / 12YAKD	PU-5 / 6 YJSA.TH	
		PU-8 / 10 / 12 YAKD.TH	
		PU-8 / 10 / 12 YAKD.TH-BS	
	PUH-5 / 6YKSA PUH-8 / 10YKA	PUH-5 / 6 YKSA ₁ .TH	
		PUH-8 / 10 YKA.TH	
		PUH-8 / 10 YKA.TH-BS	





《 Model name structure 》

P	E	H	-	5	G	AK
①	②	③		④	⑤	⑥ ⑦

- ① : **P** Packaged air conditioner
- ② : **E** Ceiling concealed ducted type
- ③ : **None** Cooling only
H Heatpump
- ④ : **None** R22 refrigerant
- ⑤ : Capacity of the unit
- ⑥ : Series number
- ⑦ : **A** A-control
AK AK-control

	10HP	12HP	16HP	20HP	Page
	PE-10GAK	PE-12GAK	PE-16GAK	PE-20GAK	7~11
	PU-10YAKD	PU-12YAKD	PU-8YAKD × 2	PU-10YAKD × 2	
					13~17
	PEH-10GA		PEH-16GA	PEH-20GA	
	PUH-10YKA		PUH-8YKA × 2	PUH-10YKA × 2	

			Line up						
	Special model		5HP	6HP	8HP	10HP	12HP	16HP	20HP
	Normal	-	○	○	○	○	○	○	○
	High static motor (150Pa)	A	○	○	○	○	-	-	-
	With Metal fan	B	○	○	○	○	○	-	-
	A + B	C	○	○	○	○	-	-	-
	Normal	-	○	○	○	○	-	○	○
	High static motor (150Pa)	A	○	○	○	○	-	-	-
	With Metal fan	B	○	○	○	○	-	-	-
	A + B	C	○	○	○	○	-	-	-
	Normal	-	○	○	-	-	-	-	-
	Normal	-	-	-	○	○	○	-	-
	Salt resistant fin	1	-	-	○	○	○	-	-
	Normal	-	○	○	-	-	-	-	-
	Normal	-	-	-	○	○	-	-	-
	Salt resistant fin	1	-	-	○	○	-	-	-

	Refrigerant	Compressor	Control	Power source
ICON				

A-CONTROL REMOTE CONTROLLER

MA DELUXE REMOTE CONTROLLER PAR-21MAA

Dot liquid-crystal display is applied

Symbols, Japanese, Chinese, English, Germany, Spanish, Russian, Italian, French display can be selected freely.



Dot Liquid Crystal Display

Acknowledging the operation and control status at a glance. The large size display upgrades visual acknowledgement capability. The operation and control status can be understood promptly.

Display example [Operation mode]
Dot liquid crystal display section

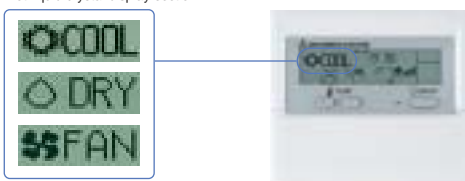

Multi-language Display

Multi-language

8 languages
can be displayed.

Display can be switched over for 8 kinds of language.



Operation Control Function

Limiting the set temperature range

Air conditioning operation always within a limited temperature range

Auto Off timer

Automatic turning off of air conditioning operation

Operation locking





Preventing the random modification of setting

Weekly Timer

The function of the weekly timer equipped can change the set temperature in addition to the ON/OFF control. Up to 8 patterns can be set for each calendar day.

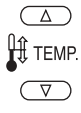
Functions

□:Each unit ○:Each group X:Not available

Item	Description	Operations	Display	Item	Description	Operations	Display
ON/OFF	Run and stop operation for a single group	○	○	Prohibition/permission of specified mode (Cooling prohibited /heating prohibited /cooling-heating prohibited)	By the setting from System Controller, the operation for the following modes is prohibited. At cooling prohibited : Cool, Dry, Auto, At heating prohibited : Heat, Auto, At cooling-heating prohibited : Cool, Heat, Dry, Auto	X	○
 Operation mode switching	Switches between Cool / Dry / Auto / Fan / Heat. Operation modes vary depending on the air conditioner unit.	○	○	Indoor unit intake temperature	Measures the intake temperature of the indoor unit when the indoor unit is operating.	X	○
 TEMP. Temperature setting	Sets the temperature for a single group Range of temperature setting Cool/Dry : 19°C - 30°C (66°F - 86°F) Heat : 17°C - 28°C (63°F - 82°F) Auto : 19°C - 28°C (66°F - 82°F)	○	○	Error	When an error is currently occurring on an air conditioner unit, the afflicted unit and the error code are displayed.	X	□
 Fan speed setting	Models with 4 air flow speed settings: Hi/Mid-2/Mid-1/Low Models with 3 air flow speed settings: Hi/Mid/Low Models with 2 air flow speed settings: Hi/Low	○	○	Test run	This operates air conditioner units in test run mode.	○	○
 Air flow direction setting	Air flow direction angles 100% - 80% - 60% - 40%, Swing, Louver ON/OFF Air flow direction settings vary depending on the model.	○	○	 Ventilation equipment	Up to 16 indoor units can be connected to an interlocked system that has one LOSSNAY. LOSSNAY items that can be set are "Hi" "Low" "Stop". Ventilation mode switching is not available.	○	○
Weekly scheduler	ON/OFF/Temperature setting can be done up to 8 times one day in the week. The time can be set by the minute.	○	○	Function to limit the setting range of room temperature (Set temperature range limit)	The range of room temperature setting can be limited by the initial setting. The lowest limit temperature can be made higher than the usual (19°C) at cooling/drying, while the upper limit temperature lower than the usual (28°C) at heating.	○	○
Permit / Prohibit local operation	Individually prohibit operation of each local remote control function (Start/Stop, Change operation mode, Set temperature, Reset filter). *1: When the local remote controller inactivation command is received from the master system controller, "E" is displayed.	X	*1 ○	Easy-to-operate simplified locking function (Auto lock function)	Setting/releasing of simplified locking for remote control switch can be performed. · Locking of all switches · Locking of all switches except Start/Stop switch	○	○

External dimension

Unit:mm

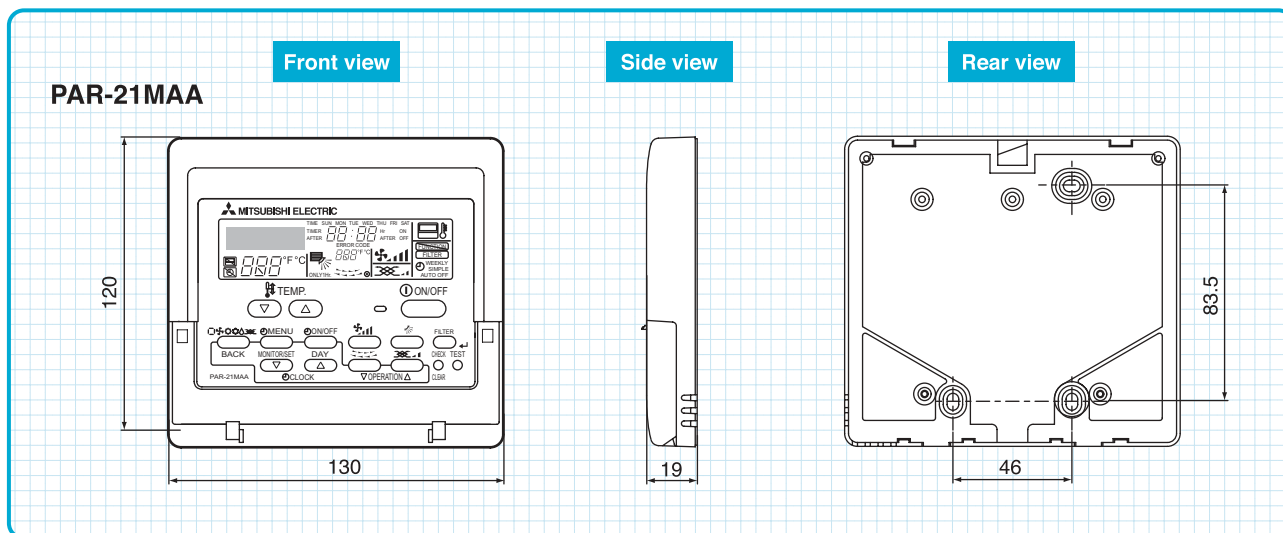

CENTRALIZED REMOTE CONTROLLER

NEXT GENERATION CONTROLLER G-50A

Up to 50 units of packaged air conditioners can freely be monitored and operated!
Furthermore, it has enabled the Monitoring and Operation Via a Web Browser on a Personal Computer connected by using a LAN or telephone line!



First in the industry
With Web Server
Functions!



- **Simple and Flexible**

This new generation controller is suitable for small to large systems with simple to complex functions available.

- **Web Browser**

Enables monitoring and operation of air conditioning units using a PC with Microsoft Internet Explorer.

- **Remote Access**

Allows users to remotely monitor and operate the air conditioning units using a PC connected to a telephone line.

- **Auto Alarm**

In case of any malfunction, necessary information will be sent to a mobile phone and/or personal computer by e-mail.

- **Easy to Upgrade**

Various new functions will be introduced gradually and can easily be down loaded into any existing G-50A.

Example : Energy Monitoring
Demand Control
Annual Schedule

Example of display icons (air conditioner icons)

	Operation		In timer operation
	Stop		Lossnay on
	Occurrence of abnormality		Under energy-saving control
	Operation/ Occurrence of a filter sign		

System Structure (Example)

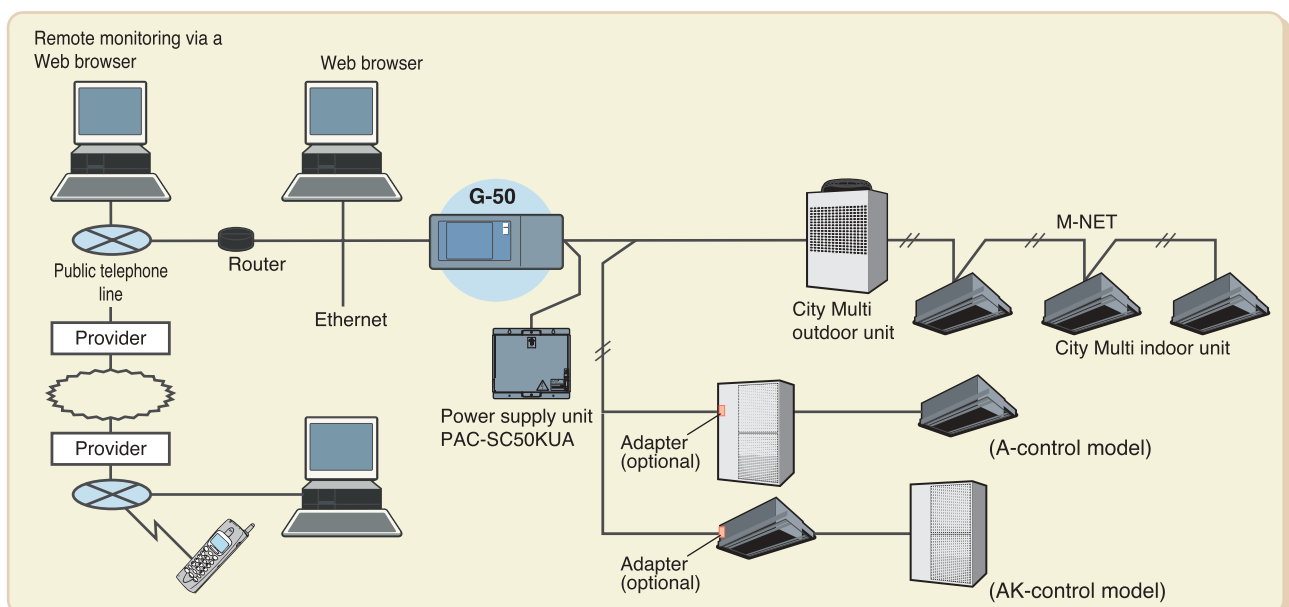

CENTRALIZED REMOTE CONTROLLER

NEXT GENERATION CONTROLLER G-50A

Functions

□ : Each unit ○ : Each group X : Not available

Item	Description	Operations	Display
ON/OFF	Run and stop operation for the air conditioner units	○	○
Operation mode switching	Switches between Cool / Dry / Auto / Fan / Heat. (Group of LOSSNAY unit : automatic ventilation/ vent - heat interchange/ normal ventilation) Operation modes vary depending on the air conditioner unit.	○	○
Temperature setting	Range of temperature setting Cool/Dry : 19°C - 30°C (66°F - 86°F) Heat : 17°C - 28°C (63°F - 82°F) Auto : 19°C - 28°C (66°F - 82°F) * Range of temperature settings vary depending on model.	○	○
Fan speed setting	Models with 4 air flow speed settings: Hi/Mid-2/Mid-1/Low Models with 3 air flow speed settings: Hi/Mid/Low Models with 2 air flow speed settings: Hi/Low	○	○
Air flow direction setting	Air flow direction angles 100% - 80% - 60% - 40%, Swing, *1: Louver cannot be set. Air flow direction settings vary depending on the model.	*1 ○	○
Timer operation	For one day, you can set start/stop three times and you can set enable/disable three times. For a week's schedule, you can store three start/stop patterns and one enable/disable pattern. *2: When the timer is set, "Timer enabled" is shown on the operation setting screen of the LCD.	○	*2 ○
Permit / Prohibit local operation	Individually prohibit operation of each local remote control function (Start/Stop, Change operation mode, Set temperature, Reset filter). *3: When the local remote controller inactivation command is received from the master system controller, "Disabled" appears in inverted display on the operation setting screen.	○	*3 ○

Item	Description	Operations	Display
Indoor unit intake temperature	Measures the intake temperature of the indoor unit only when the indoor unit is operating.	X	○
Error	When an error is currently occurring on an air conditioner unit, the afflicted unit and the error code are displayed. *4: When an error occurs, the LED flashes. The operation monitor screen shows the abnormal unit by flashing it. The error monitor screen shows the abnormal unit address, error code and source of detection. The error log monitor screen shows the time and date, the abnormal unit address, error code and source of detection.	X	*4 □
Test run	This operates air conditioner units in test run mode.	○	○
Ventilation equipment	The interlocked system settings can be performed by the master system controller. When setting the interlocked system, you can use the ventilation switch to switch the free plan LOSSNAY settings between "Hi", "Low" and "Stop". When setting a group of only free plan LOSSNAY units, you can switch between "Normal ventilation", "Interchange ventilation" and "Automatic ventilation".	○	○
External input/output	By using accessory cables you can set and monitor the following. Input By level signal: "Batch start/stop", "Batch emergency stop" By pulse signal: "Batch start/stop", "Enable/disable local remote controller" Output "Start/stop", "Error/Normal" *5: Requires the external I/O cable (PAC-YG10HA-E) sold separately.	*5 ○ collective	*5 ○ collective

External dimension

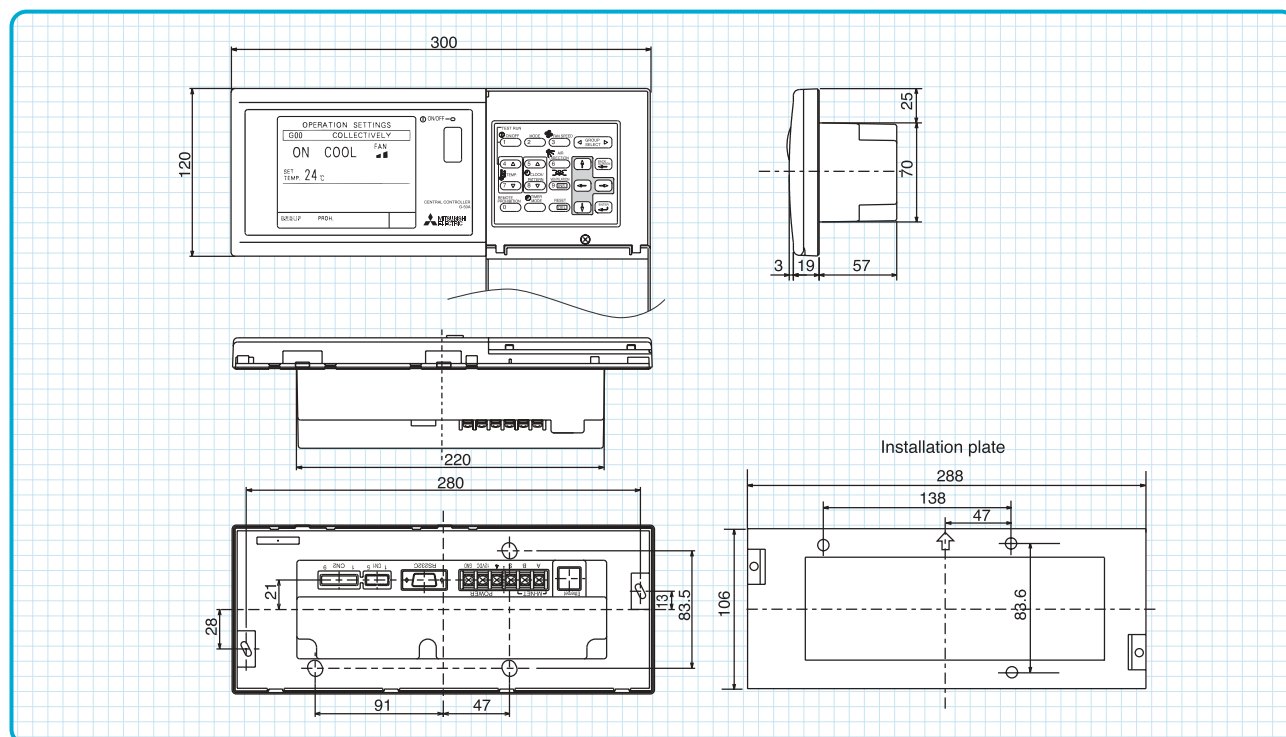

Series **COOLING ONLY** PE-5,6,8,10,12,16,20GAK

**50
Hz**



Fixed Speed



[FEATURES]

Wide range of capacities (5HP-20HP)

Flexible duct design by using high static pressure specifications (150Pa option)



PE-GAK

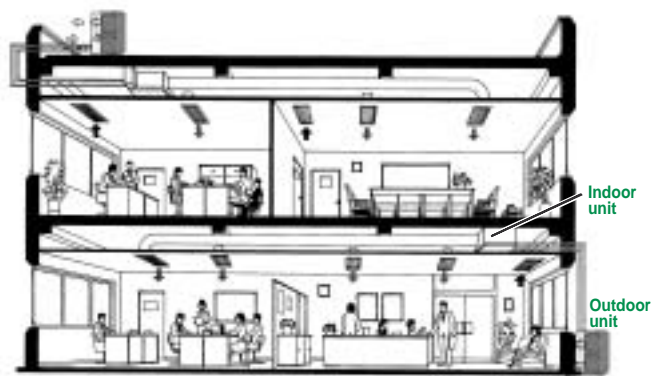

Highly-functional remote controller

Weekly timer and Multi-language display enables Comfort control and Ease of Use.



PU-YJSA
PU-YAKD



PAR-21MAA



SPECIFICATIONS

(50Hz)

Model name				PE-5GAK		PE-6GAK		PE-8GAK		PE-10GAK		PE-12GAK		PE-16GAK		PE-20GAK		
Power source				1N~ 220/230/240V 50Hz				3N~ 380/400/415V 50Hz										
Cooling	*2	Capacity	kW	12.1	15.7	21.6		26.7		30.8		43.2		53.4				
			kcal/h	10,400	13,400	18,500		22,900		26,400		37,100		45,900				
	Btu/h		41,000	54,000	74,000		91,000		105,000		147,000		182,000					
	Sensible Capacity	kW	9.9	12.9	16.0		20.0		22.8		29.8		36.8					
		kcal/h	8,500	11,000	13,700		17,200		19,500		25,600		31,600					
		Btu/h	34,000	44,000	55,000		68,000		78,000		102,000		126,000					
	Power input	kW	0.87			1.00		1.12 (-SP 1.18)		1.22		1.55		2.84				
	Current input	A	4.0			1.8 (-SP 2.0)		2.0 (-SP 2.3)		2.3		3.8		5.4				
Temperature range of cooling		Indoor	W.B.	15.5°CWB-22.5°CWB				15°CWB-24°CWB										
		Outdoor	D.B	(21)-46°CDB				(20)-52°CDB ((20)-43°CDB with PAC-SG208SG-E)										
Capacity control				0/100														
Fan	Type x Quantity			Sirocco fan x 1 (-MF Metal fan)				Sirocco fan x 2 (-MF Metal fan)				Sirocco fan x 2 (Metal fan)						
	Air flow rate (Hi-Lo)	CMM	50-40		55-44		65-52		80-64		90-72		120		160			
	External static pressure	Pa	100 (-SP 150)										100		150		150	
	Motor output	kW	0.46 (-SP 0.54)				0.75 (-SP 0.77)				0.77		1.3		1.8			
External finish				Galvanized steel														
External dimension		H x W x D	mm	400 x 1,180 x 634				400 x 1,400 x 634		400 x 1,600 x 634				595 x 1,947 x 764				
Heat exchanger type				Cross fin														
Air filter				Option														
Refrigerant piping diameter Liquid / Gas			mm	ø9.52 / ø19.05				ø15.88 / ø25.4		ø15.88 / ø28.6				ø15.88 / ø25.4 x 2		ø15.88 / ø28.6 x 2		
Drain piping dimension			mm	25.4 (R1)														
Noise level		*3	dB(A)	46-42 (-SP 48-45)		49-45 (-SP 51-48)				50-46 (-SP 52-49)		51-48		52		53		
Net weight			kg	56		59		70		77		77		130		133		
Remote controller				PAR-21MAA (attached)														
Model name				PU-5YJSA		PU-6YJSA		PU-8YAKD		PU-10YAKD		PU-12YAKD		PU-8YAKD x 2		PU-10YAKD x 2		
Power source				3N~ 380/400/415V 50Hz														
Cooling	*1	Power input	kW	4.82	5.35	6.65		9.13		10.15		6.65 x 2		9.13 x 2				
		Current input	A	8.2	9.1	13.0		16.6		17.9		13.0 x 2		16.6 x 2				
		Starting current(50Hz)	A	66	74	95.0		125.0		118.0		108		141.6				
Refrigerant		Type	R22															
		Original charge	kg	5.1	5.7	6		6.5		7		6 x 2		6.5 x 2				
Refrigerant control				Capillary														
Fan	Type x Quantity			Propeller fan x 2										(Propeller fan x 2) x 2				
	Air flow rate	CMM	100				160						160 x 2					
	Motor output	kW	0.1 x 2				0.15 x 2						(0.15 x 2) x 2					
Compressor		Type	Hermetically closed scroll															
		Motor output	kW	3.5	4.2	5.6		7.5		8.6		5.6 x 2		7.5 x 2				
		Lubricant	SONTEX 200LT															
		Crankcase heater	kW	—				0.09				0.09 x 2						
External finish				Polyester resin coating														
Color				Munsell 3Y7.8/1.1														
External dimension		H x W x D	mm	1,258 x 970 x 345 + 24				1,480 x 1,047 x 547				(1,480 x 1,047 x 547) x 2						
Heat exchanger type				Cross fin														
Refrigerant piping diameter Liquid / Gas			mm	ø9.52 / ø19.05				ø15.88 / ø25.4		ø15.88 / ø28.6				ø15.88 / ø25.4 x 2		ø15.88 / ø28.6 x 2		
Noise level		*4	Cooling	dB(A)	55	56	66											
Net weight			kg	114		117		197		206		208		197 x 2		206 x 2		
Protection devices				High pressure / Thermal switch Thermal relay / Anti phase Internal inherent motor protection				High pressure / Low pressure / OCR Internal inherent motor protection of COMP / Internal inherent motor protection										

Note 1. Nominal cooling conditions
Indoor: 27°CDB/19°CWB
Outdoor: 35°CDB
Pipe length: 5m(5.6HP) , 7.5m(8-20HP)
2. Cooling capacity is gross capacity which do not include a deduction for evaporator fan motor heat.
3. Measured at 1.5m from the unit's bottom in an anechoic room.
4. Measured at 1m from the unit in an anechoic room.

Optional parts

Item	Special model	Optional part	Applicable model
High-static motor	-SP model		PE-5/6/8/10GAK
Metal fan	-MF model		PE-5/6/8/10/12GAK
Anti-corrosion fin	-BS model		PU-8/10/12YAKD
Air filter		PAC-KE206AF	PE-5/6GAK
		PAC-KE208AF	PE-8GAK
		PAC-KE210AF	PE-10/12GAK
		PAC-KE220AF	PE-16/20GAK
		PAC-SK209PG-E	PU-8/10/12YAKD
Pressure gauge		PAC-292SG-D	PU-5/6YJSA
Air outlet guide		PAC-SG208SG-E	PU-8/10/12YAKD
Air outlet guide (2pcs/pack)		MAC-399IF-E	PE-5/6/8/10/12/16/20GAK
M-NET interface		PAC-SA47DS-E	PU-5/6YJSA
Drain socket			

OUTLINE DIMENSIONS

PE-10,12

<Accessory>

- Pipe cover 2pcs.
 (For dew condensation prevention of local piping and unit connection.)
- Remote controller 1pc.

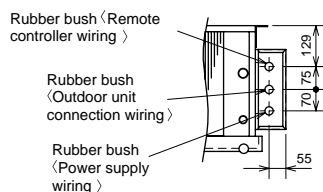

A

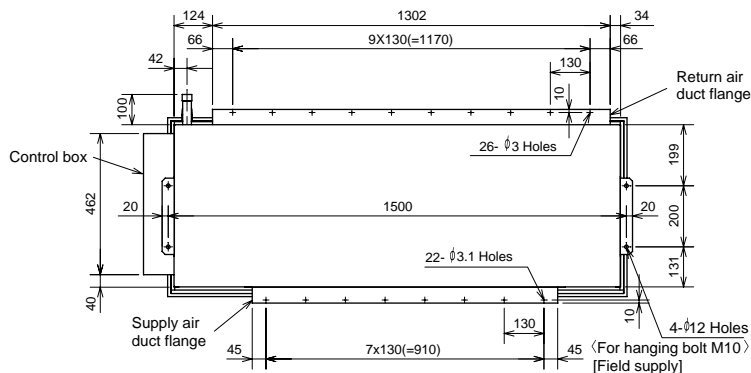

Top view

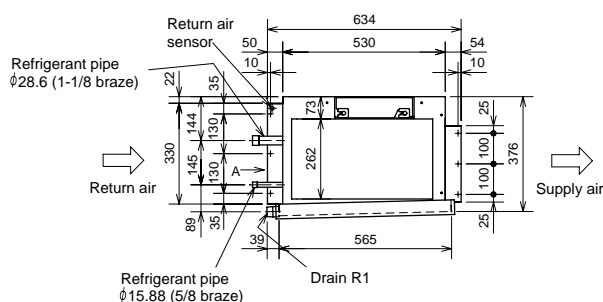

Left side view

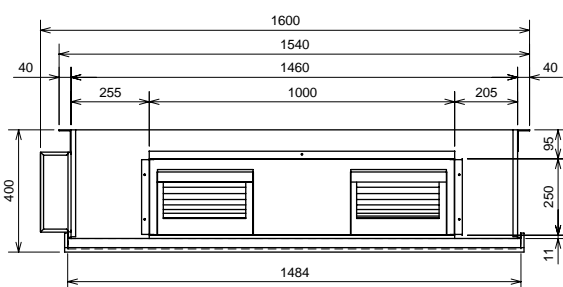

Front view

PE-16,20

<Accessory>

- Pipe cover 4pcs.
 (For dew condensation prevention of local piping and unit connection.)
- Remote controller 1pc.

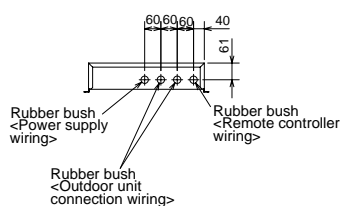

A

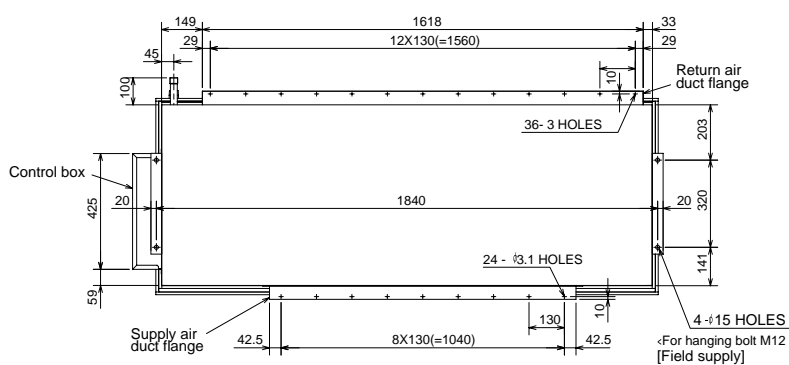

Top view

Refrigerant pipe
 PE-16GAK(T), PEH-16GA
 : φ25.4 (1 braze)
 PE-20GAK(T), PEH-20GA
 : φ28.6 (1-1/8 braze)
 [2 places (*1 part)]

Refrigerant pipe
 φ15.88 (5/8 braze)
 [2 places (*2 part)]

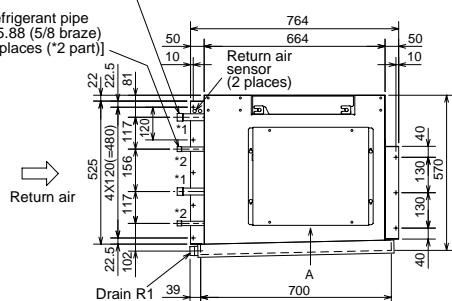

Left side view

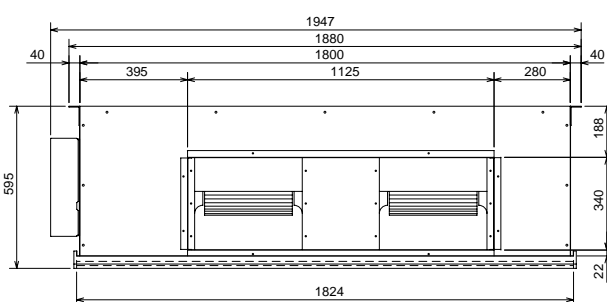

Front view

OUTLINE DIMENSIONS

PU-5,6

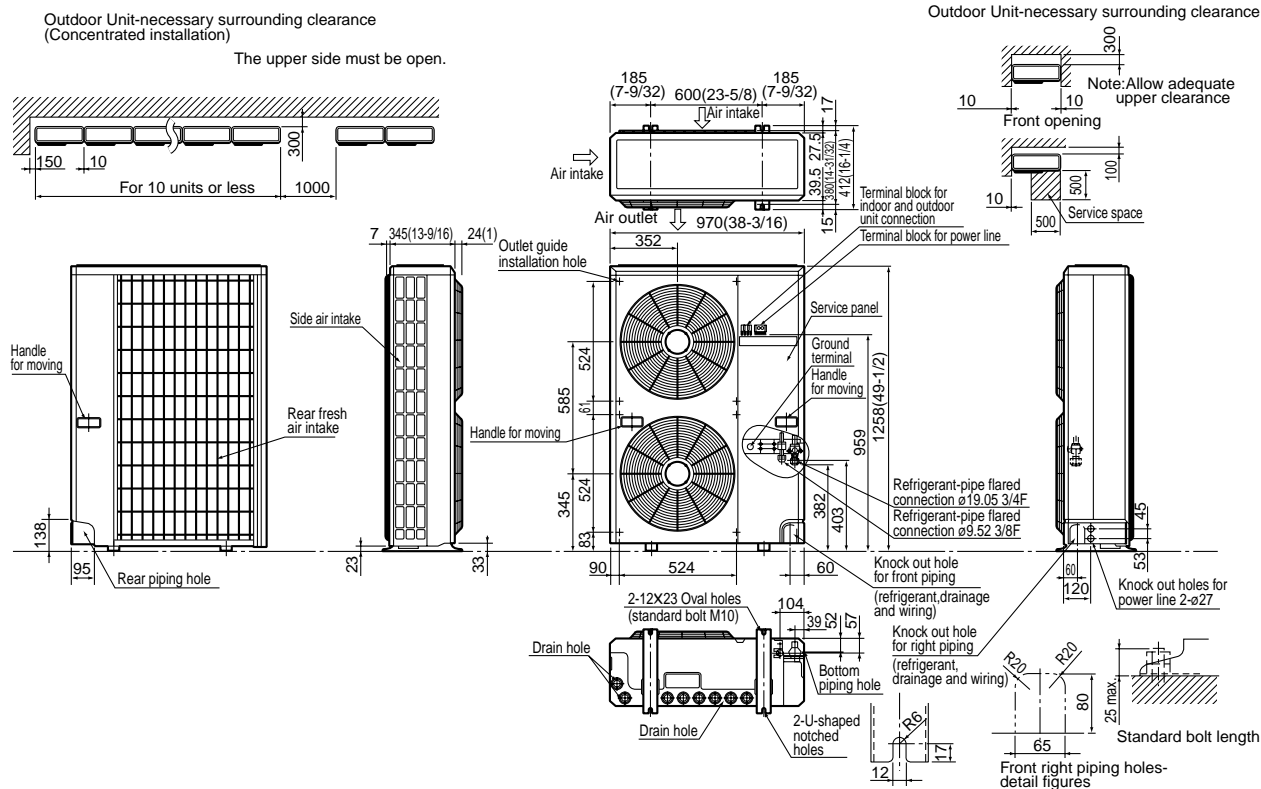

PU-8,10,12

<Accessory>
-Conduit mounting plate
(Painted the same color as the unit body)
a) $\phi 27$1pc.
b) $\phi 34$1pc.
-Tapping screw 4512.....4pcs.
-Connection pipe.....1pc.
-Packing.....1pc

Note 1. It is possible to change to $\phi 27$ or $\phi 34$ by selecting the conduit mounting plate a, b.

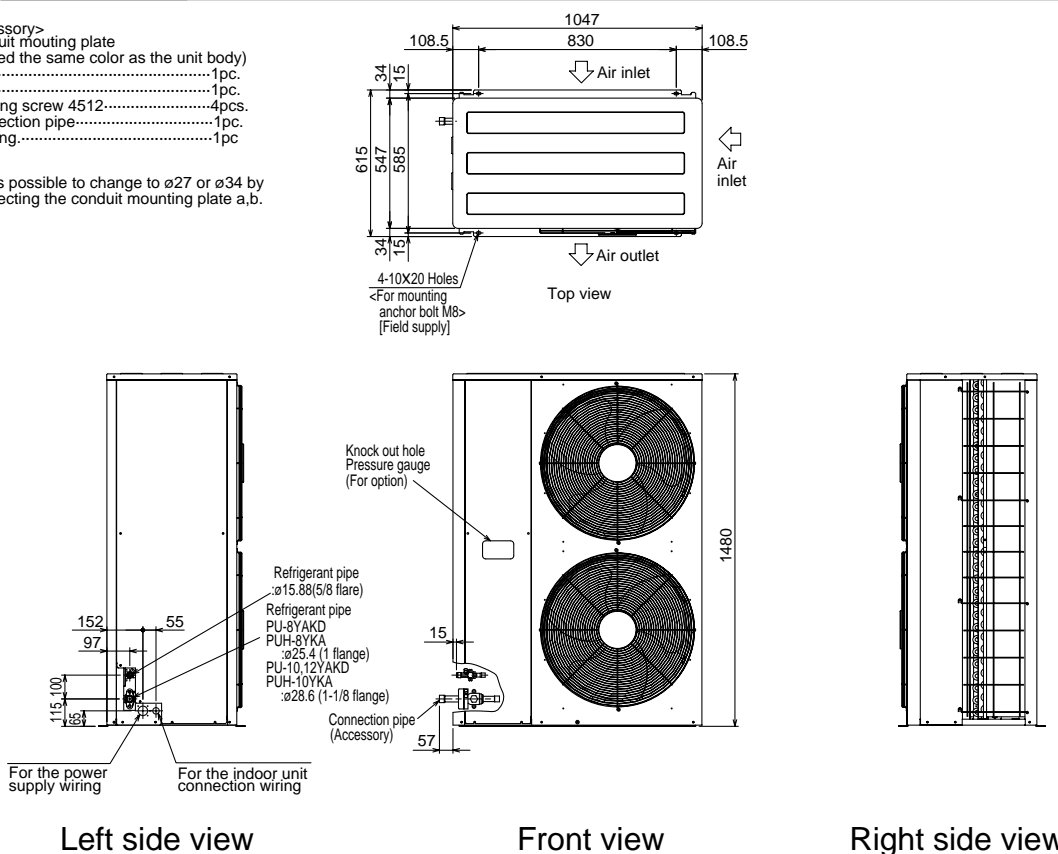

M E M O

Series HEAT PUMP PEH-5,6,8,10,16,20GA(K)

50
Hz



Fixed Speed



[FEATURES]

Wide range of capacities (5HP-20HP)

Flexible duct design by using high static pressure specifications (150Pa option)



PEH-GA(K)

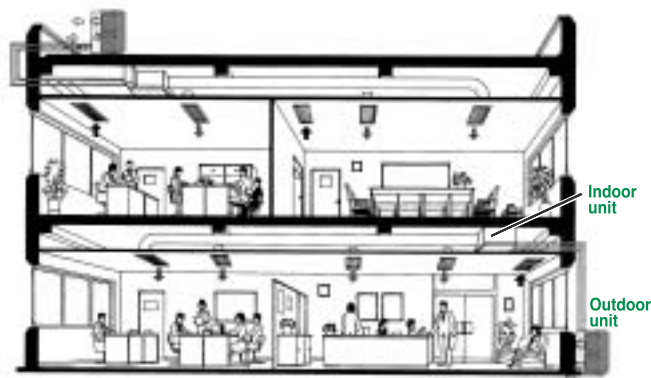

Highly-functional remote controller

Weekly timer and Multi-language display enables Comfort control and Ease of Use.



PUH-YK(S)A



PAR-21MAA



SPECIFICATIONS

(50Hz)

Model name			PEH-5GAK		PEH-6GAK		PEH-8GA		PEH-10GA		PEH-16GA		PEH-20GA	
Power source			1N~ 220/230/240V 50Hz				3N~ 380/400/415V 50Hz							
Cooling *3	Capacity	kW	12.1		15.7		21.6		26.7		43.2		53.4	
		kcal/h	10,400		13,400		18,500		22,900		37,100		45,900	
		Btu/h	41,000		54,000		74,000		91,000		147,000		182,000	
	Sensible Capacity	kW	9.9		12.9		16.0		20.0		29.8		36.8	
		kcal/h	8,500		11,000		13,700		17,200		25,600		31,600	
		Btu/h	34,000		44,000		55,000		68,000		102,000		126,000	
	Power input	kW	0.87				1.00		1.12 (-SP 1.18)		1.55		2.84	
Current input	A	4.0				1.8 (-SP 2.0)		2.0 (-SP 2.3)		3.8		5.4		
Temperature range of cooling	Indoor	W.B.	15.5°CWB-22.5°CWB				15°CWB-24°CWB							
	Outdoor	D.B	-5°CDB-46°CDB				-5°CDB-46°CDB (-5°CDB-43°CDB with PAC-SG208SG-E)							
Heating	Capacity	kW	15.5		18.5		24.6		30.9		49.2		61.8	
		kcal/h	13,300		15,900		21,100		26,500		42,300		53,100	
		Btu/h	53,000		63,000		84,000		105,000		168,000		211,000	
	Power input	kW	0.87				1.00		1.12 (-SP 1.15)		1.55		2.84	
	Current input	A	4.0				1.8 (-SP 1.9)		2.0 (-SP 2.2)		3.8		5.4	
Temperature range of heating	Indoor	D.B.	20°CDB-27°CDB				15°CDB-27°CDB							
	Out door	W.B	-9.5°CWB-15.5°CWB				-15°CWB-15°CWB							
Capacity control			0 / 100								0 / 50 / 100			
Fan	Type x Quantity		Sirocco fan x 1 (-MF Metal fan)				Sirocco fan x 2 (-MF Metal fan)				Sirocco fan x 2 (Metal fan)			
	Air flow rate (Hi-Lo)	CMM	50-40		55-44		65-52		80-64		120		160	
	External static pressure	Pa	100 (-SP 150)								150			
	Motor output	kW	0.46 (-SP 0.54)				0.75 (-SP 0.77)				1.3		1.8	
External finish			Galvanized steel											
External dimension	H x W x D	mm	400 x 1,180 x 634				400 x 1,400 x 634		400 x 1,600 x 634		595 x 1,947 x 764			
Heat exchanger type			Cross fin											
Air filter			Option											
Refrigerant piping diameter Liquid / Gas		mm	ø9.52 / ø19.05				ø15.88 / ø25.4		ø15.88 / ø28.6		(ø15.88 / ø25.4) x 2		(ø15.88 / ø28.6) x 2	
Drain piping dimension		mm	25.4 (R1)											
Noise level *4		dB(A)	46-42 (-SP 48-45)		49-45 (-SP 51-48)		50-46 (-SP 52-49)		52		53			
Net weight		kg	56		59		70		77		130		133	
Remote controller			PAR-21MAA (attached)											
Outdoor unitModel name			PUH-5YKSA		PUH-6YKSA		PUH-8YKA		PUH-10YKA		PUH-8YKA x 2		PUH-10YKA x 2	
Power source			3N~ 380/400/415V 50Hz											
Cooling *1	Power input	kW	4.17		4.74		6.85		9.14		6.85 x 2		9.14 x 2	
	Current input	A	8.0		8.5		13.6		16.8		13.6 x 2		16.8 x 2	
	Starting current(50Hz)	A	53		74		96.0		126.0		109.6		142.8	
Heating *2	Power input	kW	4.35		4.69		6.68		8.52		6.68 x 2		8.52 x 2	
	Current input	A	8.2		8.3		13.2		16.3		13.2 x 2		16.3 x 2	
	Starting current(50Hz)	A	53		74		96.0		126.0		109.2		142.3	
Refrigerant	Type		R22											
	Original charge	kg	5.4		5.0		5.5		6.0		5.5 x 2		6.0 x 2	
Refrigerant control			Capillary											
Fan	Type x Quantity		Propeller fan x 2								(Propeller fan x 2) x 2			
	Air flow rate	CMM	95		100		140				140 x 2			
	Motor output	kW	0.085 x 2		0.1 x 2		0.15 x 2				(0.15 x 2) x 2			
Compressor	Type		Hermetically closed scroll											
	Motor output	kW	3.5		4.0		5.6		7.5		5.6 x 2		7.5 x 2	
	Lubricant		SONTEX 200LT											
	Crankcase heater	kW	0.032 / 0.035 / 0.038				0.09				0.09 x 2			
External finish			Polyester resin coating											
Color			Munsell 3Y7.8/1.1											
External dimension	H x W x D	mm	1,258 x 970 x 345 + 24				1,480 x 1,047 x 547				(1,480 x 1,047 x 547) x 2			
Heat exchanger type			Cross fin											
Refrigerant piping diameter Liquid / Gas		mm	ø9.52 / ø19.05				ø15.88 / ø25.4		ø15.88 / ø28.6		(ø15.88 / ø25.4) x 2		(ø15.88 / ø28.6) x 2	
Noise level *5	Cooling	dB(A)	55		56		61							
	Heating	dB(A)	55		56		63							
Net weight		kg	114		117		200		208		200 x 2		208 x 2	
Protection devices			High pressure / discharge thermostat / thermal relay Internal inherent motor protection of COMP Internal inherent motor protection				High pressure / Low pressure / Discharge thermistor Anti phase / OCR / Internal inherent motor protection of COMP Internal inherent motor protection							
Defrosting method			Hot gas reverse											

Note 1. Nominal cooling conditions Indoor: 27°CDB/19°CWB Outdoor: 35°CDB Pipe length: 5m (5.6tP) , 7.5m (8-20tP)
2. Nominal heating conditions Indoor: 20°CDB Outdoor: 7°CDB/6°CWB Pipe length: 5m (5.6tP) , 7.5m (8-20tP)
3. Cooling capacity is gross capacity which do not include a deduction for evaporator fan motor heat.
4. Measured at 1.5m from the unit's bottom in an anechoic room.
5. Measured at 1m from the unit in an anechoic room.

Optional parts

Item	Special model	Optional part	Applicable model
High-static motor	-SP model		PEH-5/6/8/10GA(K)
Metal fan	-MF model		PEH-5/6/8/10GA(K)
Anti-corrosion fin	-BS model		PUH-8/10YKA
Air filter		PAC-KE206AF	PEH-5/6GAK
		PAC-KE208AF	PEH-8GA
		PAC-KE210AF	PEH-10GA
		PAC-KE220AF	PEH-16/20GA
		PAC-SK209PG-E	PUH-8/10YKA
Pressure gauge		PAC-292SG-D	PUH-5/6YKSA
Air outlet guide		PAC-SG208SG-E	PUH-8/10YKA
Air outlet guide (2pcs/pack)		MAC-399IF-E	PEH-5/6GAK
M-NET interface		PAC-SF80MA-E	PUH-8/10YKA
M-NET converter		PAC-SA47DS-E	PUH-5/6YKSA
Drain socket			

OUTLINE DIMENSIONS

PEH-5,6

<Accessory>

- Pipe cover 2pcs.
 (For dew condensation prevention of local piping and unit connection.)
- Remote controller 1pc.

Rubber bush <Remote controller wiring>

Rubber bush <Outdoor unit connection wiring>

Rubber bush <Power supply wiring>

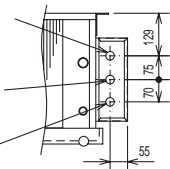

A

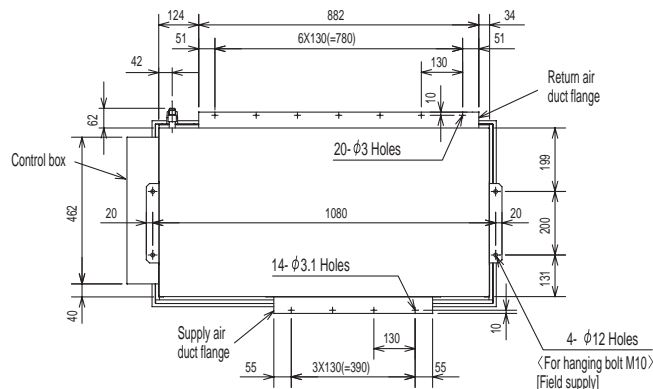

Top view

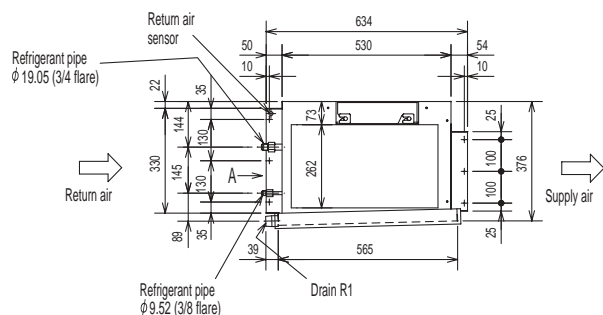

Left side view

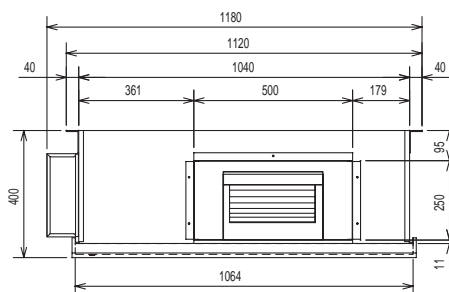

Front view

PEH-8

<Accessory>

- Pipe cover 2pcs.
 (For dew condensation prevention of local piping and unit connection.)
- Remote controller 1pcs.

Rubber bush <Remote controller wiring>

Rubber bush <Outdoor unit connection wiring>

Rubber bush <Power supply wiring>

A

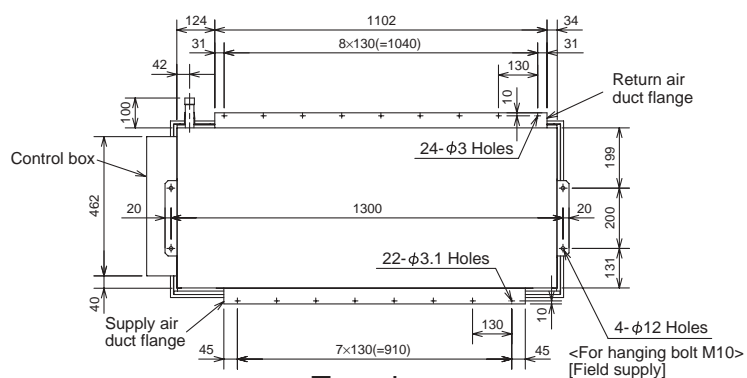

Top view

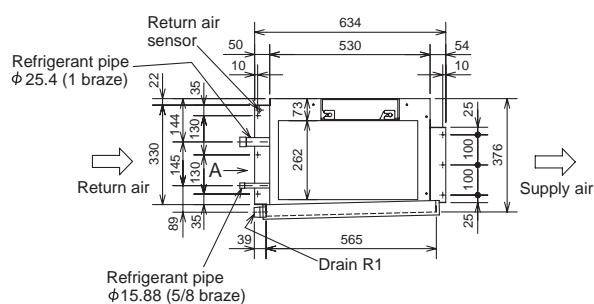

Left side view

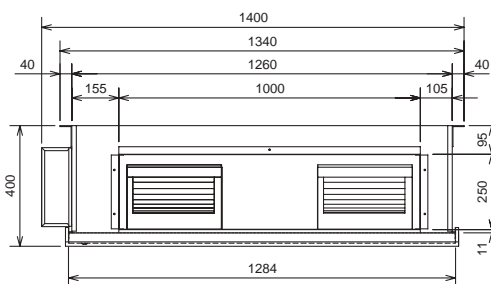

Front view

OUTLINE DIMENSIONS

PEH-10

<Accessory>

- Pipe cover.....2pcs.
(For dew condensation prevention of local piping and unit connection.)
- Remote controller.....1pcs.

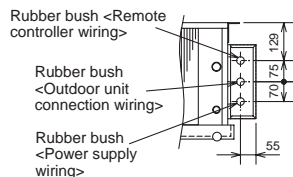

A

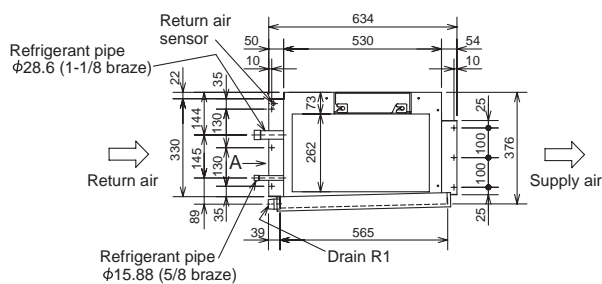

Left side view

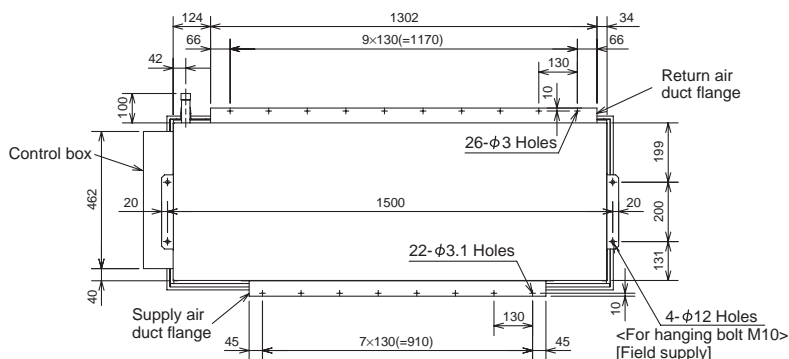

Top view

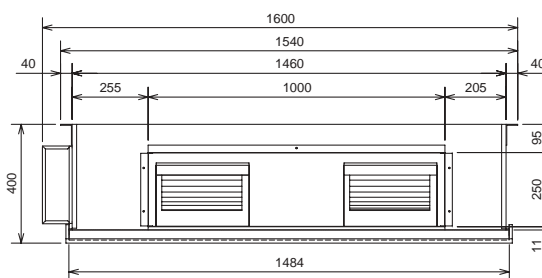

Front view

PEH-16,20

<Accessory>

- Pipe cover.....4pcs.
(For dew condensation prevention of local piping and unit connection.)
- Remote controller.....1pc.

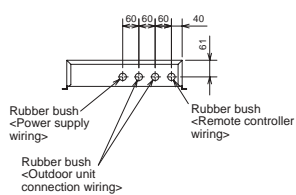

A

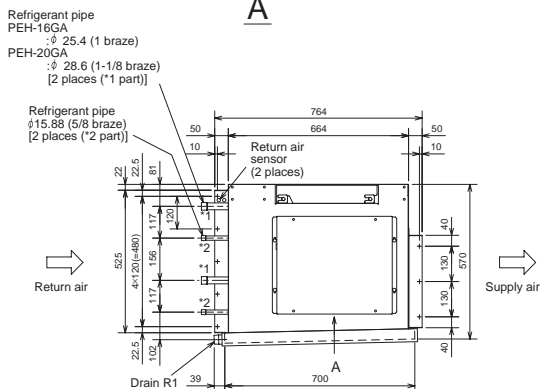

Left side view

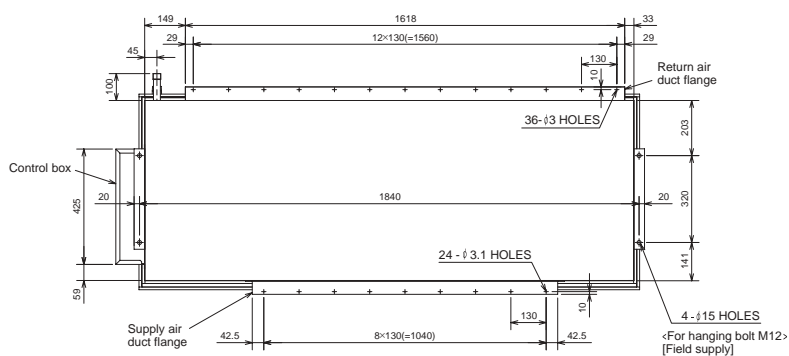

Top view

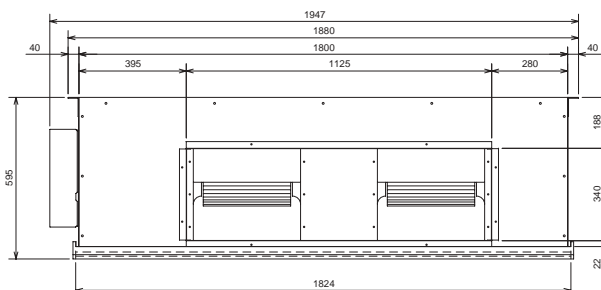

Front view

OUTLINE DIMENSIONS

PUH-5,6

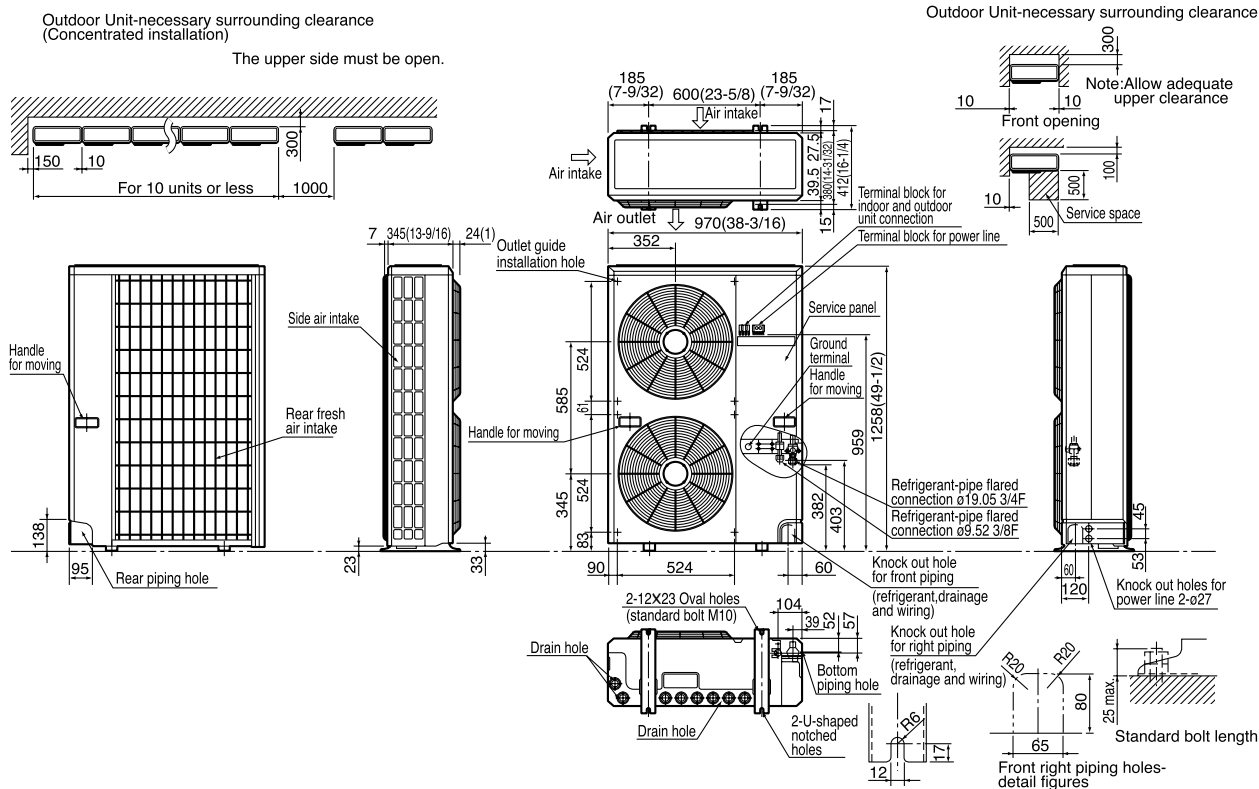

PUH-8,10

- <Accessory>
- Conduit mounting plate (Painted the same color as the unit body)
 - a) $\phi 27$1pc.
 - b) $\phi 34$1pc.
 - Tapping screw 4512.....4pcs.
 - Connection pipe.....1pc.
 - Packing.....1pc.

Note 1. It is possible to change to $\phi 27$ or $\phi 34$ by selecting the conduit mounting plate a, b.

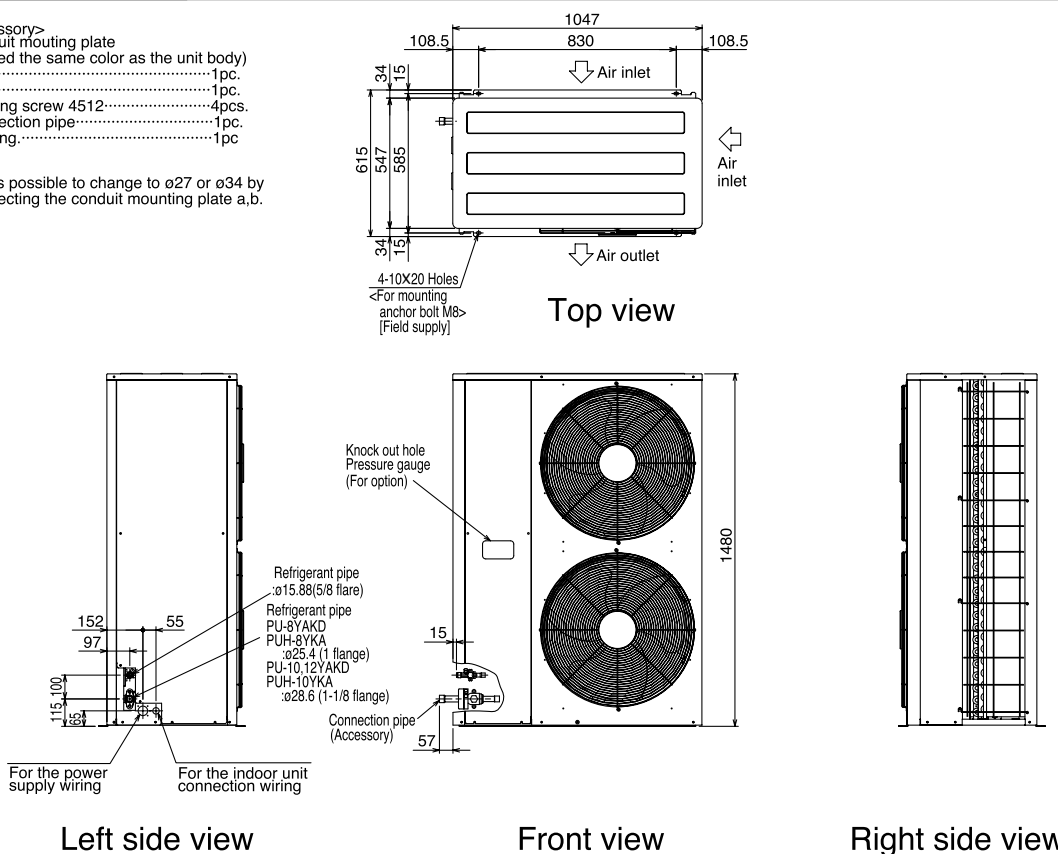

M E M O

Main Optional Parts

Model name	Description	Applicable Models						
		PE-5/6/8/10/12/16/20GAK.TH	PEH-5/6GAK.TH	PEH-8/10/16/20GA.TH	PU-5/6YJSA.TH	PU-8/10/12YAKD.TH	PUH-5/6YKSA.TH	PUH-8/10YKA.TH
PAC-SE41TS-E	Remote Sensor	●	●	●				
PAC-SE55RA-E	Remote On/Off Adapter	●	●	●				
PAC-SF40RM-E	Remote Operation Adapter	●	●	●				
PAC-SA88HA-E	Remote Controller Adapter	●	●	●				
MAC-399IF-E	M-NET Interface	●	●					
PAC-SF80MA-E	M-NET Converter							●
MAC-397IF-E	MA & Contact Terminal Interface	●	●					
MAC-821SC-E	Centralized On/Off Remote Controller (MAC-397IF-E)	●	●					
PAR-FL32MA-E	Wireless Remote Controller	●	●	●				
PAR-SA9CA-E	Signal Receiver Unit	●	●	●				
PAC-KE206AF	Air filter (5/6HP)	●	●					
PAC-KE208AF	Air filter (8HP)	●		●				
PAC-KE210AF	Air filter (10/12HP)	●		●				
PAC-KE220AF	Air filter (16/20HP)	●		●				
PAC-SK209PG-E	Pressure gauge					●		●
PAC-292SG-D	Air outlet guide				●		●	
PAC-SG208SG-E	Air outlet guide (2pcs/pack)					●		●
PAC-SA47DS-E	Drain socket				●		●	

M E M O



FM 33568 / ISO 9001;2000

The Air Conditioning & Refrigeration Systems Works acquired ISO 9001 certification under Series 9000 of the International Standard Organization (ISO) based on a review of Quality , management for the production of refrigeration and air conditioning equipment.

ISO Authorization System

The ISO 9000 series is a plant authorization system relating to quality management as stipulated by the ISO. ISO 9001 certifies quality management based on the "design, development, production, installation and auxiliary services" for products built at an authorized plant.



Certificate Number EC97J1227

The Air Conditioning & Refrigeration Systems Works acquired environmental management system standard ISO 14001 certification.

The ISO 14000 series is a set of standards applying to environmental protection set by the International Standard Organization (ISO).