

ACCUFAST[®]

The ACCUFAST XL

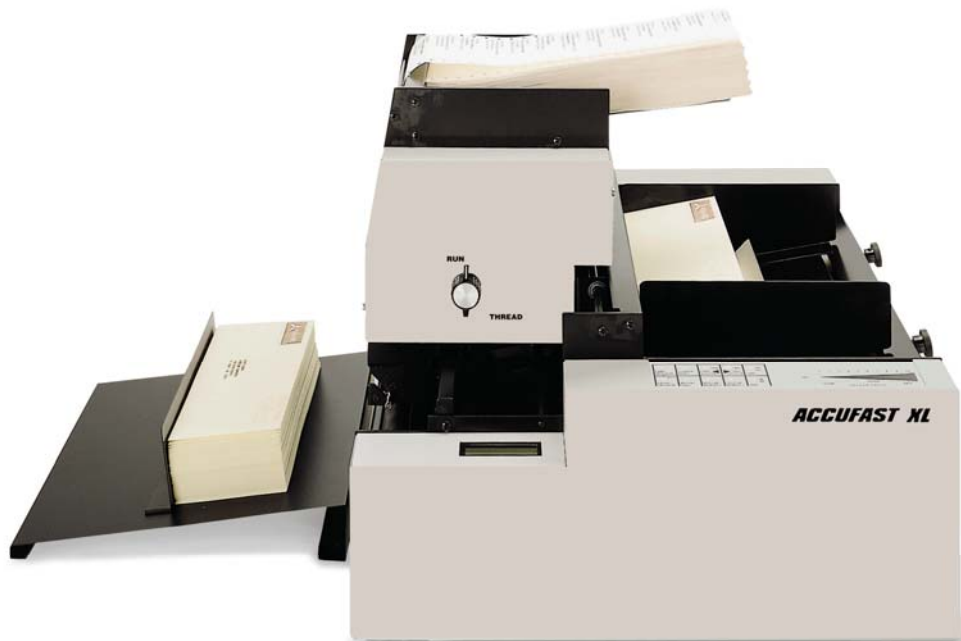

The ACCUFAST XL has become the industry standard in pressure sensitive labelers. Ask anyone who owns one or any dealer who sells ACCUFAST.

The XL is at the top. Key features such as reliability, dependability and ease of use make a lasting impression with everyone who has an ACCUFAST XL. Very few things in life are as certain.

The ACCUFAST XL Address Labeler

PHONE 877-870-6805 / FAX 813-870-6808



ACCUFAST XL

- labels up to 15,000 pieces per hour
- labels pieces 5" to 16" wide, from 20 lb. thin to 1/4" thick, coated and uncoated
- runs machine-grade labels 1" to 4" high, up to 6" wide on backer with or without tractor holes
- no need to re-thread labels, splicing takes seconds
- labels are applied in plain sight
- job set-ups are programmed and saved with up-to-the-minute digital electronics
- built-in diagnostics
- built-in waste take-up spool and counter
- English and Metric units
- Zip Code® sorting at the push of a button
- weighs 69 pounds, measures 20"l x 16"h x 21"w
- uses 115 volts 2 amps 60 hz or 230 volts 1 amp 50 hz
- goes in-line with ACCUFAST and other tabletop Tabbers and Conveyors
- optional roll label adapter
- optional stamp roll adapter
- optional catch tray or conveyor
- sliding head for simple and exact label positioning
- Liquid Crystal Display (LCD) status panel lets you know when there's a jam, a full take-up spool, the exact label position and everything else
- easy all-over access means quick maintenance
- its outstanding feature is its one-touch "on the fly" adjustment for almost everything

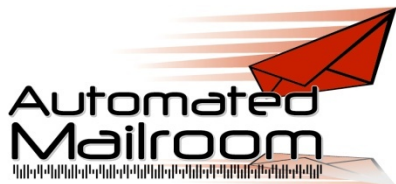

Authorized Dealer
3629 W. Cypress Street
Tampa, FL 33607



PHONE 813-870-6805 / FAX 813-870-6808