

STAKE OUT			
A-C	6'11-1/4"	B-C	8'10-1/4"
A-D	11'8"	B-D	6'
A-E	10'3-1/4"	B-E	14'10-1/8"
A-F	16'3-1/4"	B-F	19'5-3/4"
A-G	18'3-3/8"	B-G	20'2-3/4"
A-H	21'5-1/4"	B-H	18'3-3/8"
A-I	20'10-3/4"	B-I	16'2-1/4"
A-J	24'10-1/4"	B-J	18'3-1/8"
A-K	26'1-3/4"	B-K	17'8-3/4"
A-L	24'1-1/4"	B-L	14'6-3/4"
A-M	21'9"	B-M	12'

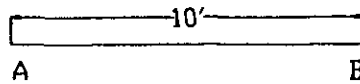
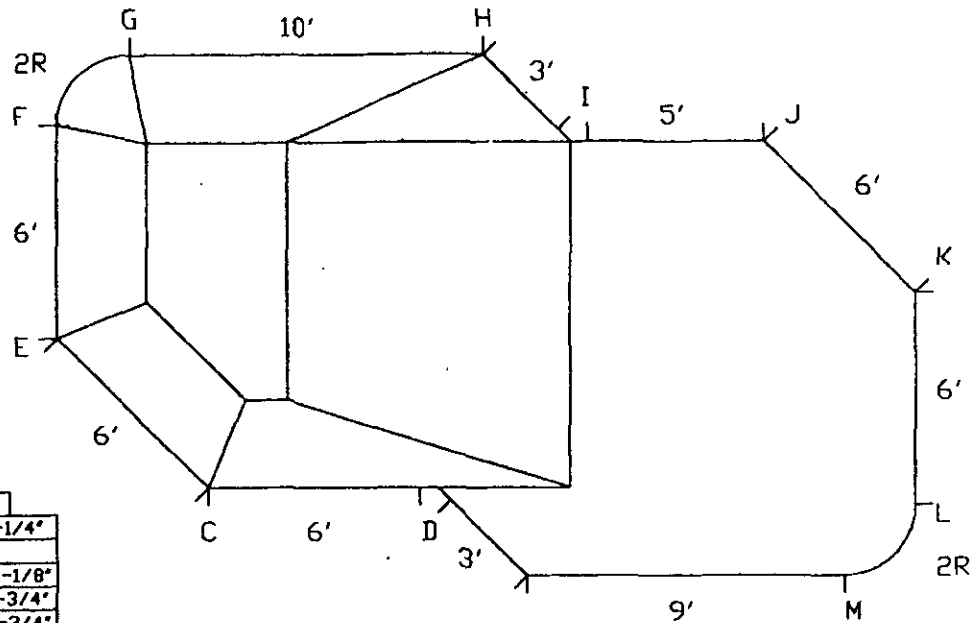

24 BAKER ST, P.O. BOX 100, HASTINGS DN, KOL-1Y0
 705-696-2385, 1-800-465-3433, FAX 705-696-1922

12'X24' R.H. COZUMEL

QTY.	LENGTH	RADIUS	TYPE
1	10'0"	NA	SKIMMER
1	9'0"	NA	PLAIN
3	6'0"	NA	PLAIN
2	6'0"	NA	RETURN
1	5'0"	NA	PLAIN
2	3'0"	NA	PLAIN
2	3'2"	2'0"	CORNER
2	6'X6'	NA	225° REV CORNER
6	-	NA	45° OUTSIDE CORNER
4	-	NA	A-FRAME
1	-	NA	N&B PKG
			S.A: 268 sq.ft.
			PER: 68'4"
1224COZC			DATE: 10-11-00

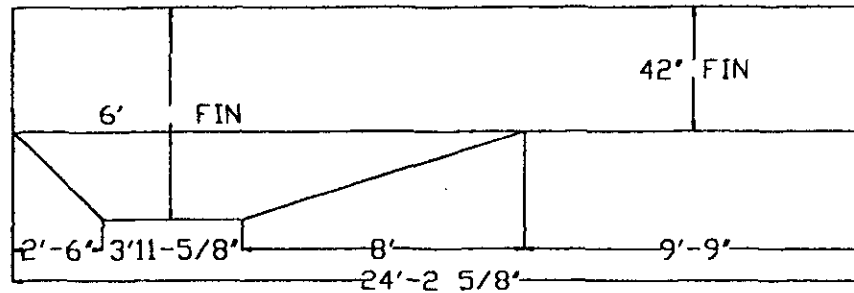

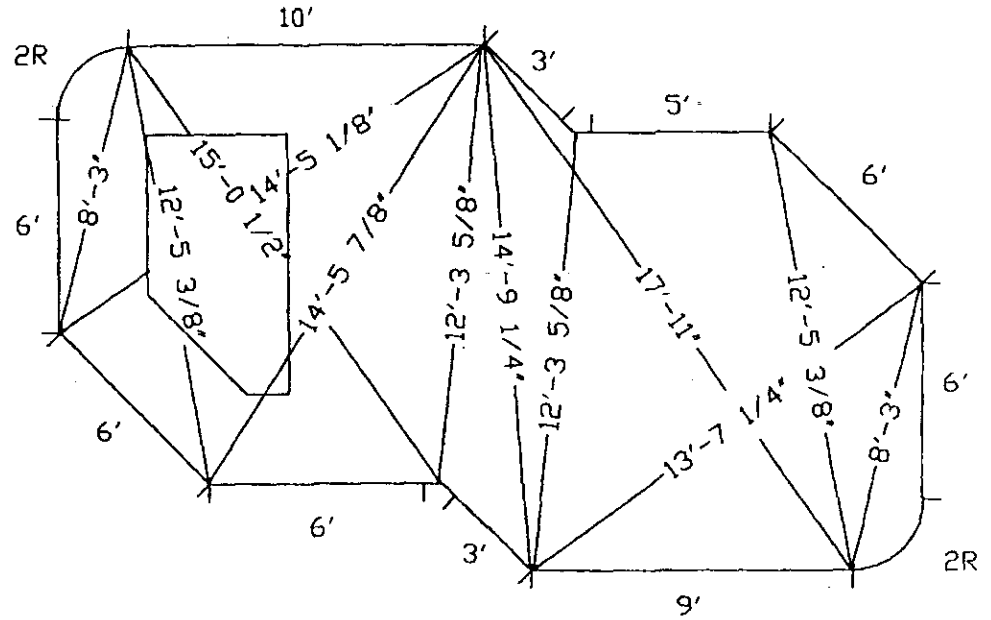
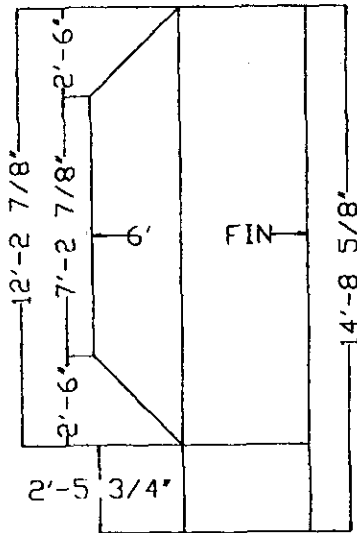

24 BAKER ST., P.O. BOX 100, HASTINGS DN. KOL. - 1Y0
705-696-2385, 1-800-465-3433, FAX: 705-696-1922

12'X24' R.H. COZUMEL

QTY.	LENGTH	RADIUS	TYPE
1	10'0"	NA	SKIMMER
1	9'0"	NA	PLAIN
3	6'0"	NA	PLAIN
2	6'0"	NA	RETURN
1	5'0"	NA	PLAIN
2	3'0"	NA	PLAIN
2	3'2"	2'0"	CORNER
2	6'X6'	NA	225° REV CORNER
6	-	NA	45° OUTSIDE CORNER
4	-	NA	A-FRAME
1	-	NA	N&B PKG
			S.A.: 268 sq.ft.
			PER: 68'4"
1224CDZC			DATE: 10-11-00

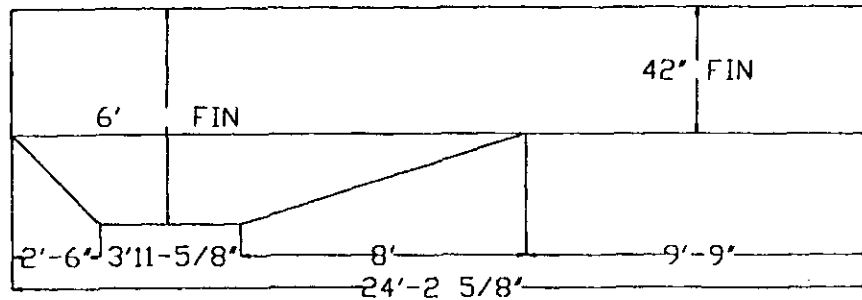

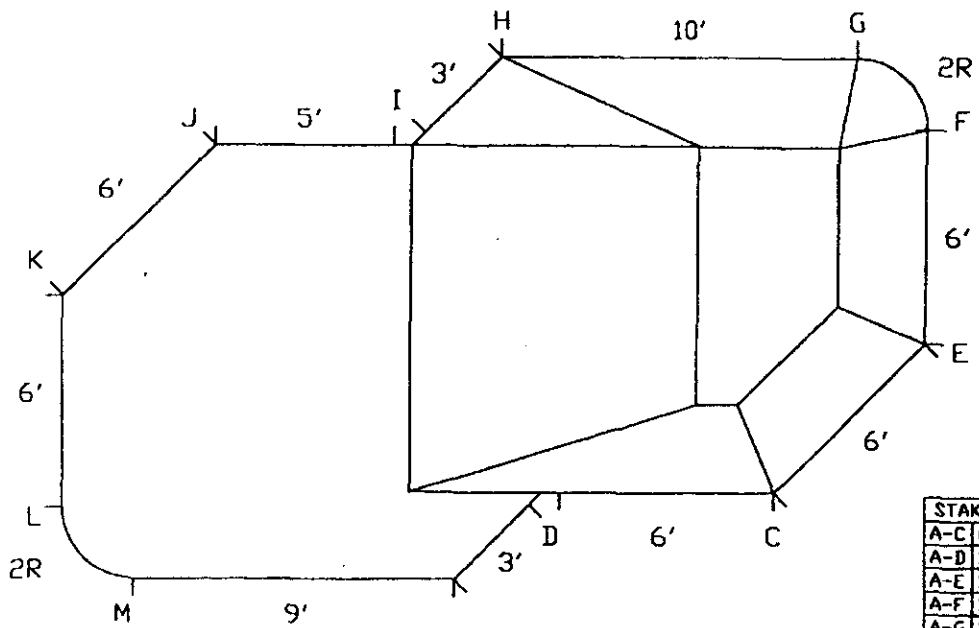

STAKE OUT		
A-C	6'11-1/4"	B-C 8'10-1/4"
A-D	11'8"	B-D 6'
A-E	10'3-1/4"	B-E 14'10-1/8"
A-F	16'3-1/4"	B-F 19'5-3/4"
A-G	18'3-3/8"	B-G 20'2-3/4"
A-H	21'5-1/4"	B-H 18'3-3/8"
A-I	20'10-3/4"	B-I 16'2-1/4"
A-J	24'10-1/4"	B-J 18'3-1/8"
A-K	26'1-3/4"	B-K 17'8-3/4"
A-L	24'1-1/4"	B-L 14'6-3/4"
A-M	21'9"	B-M 12'

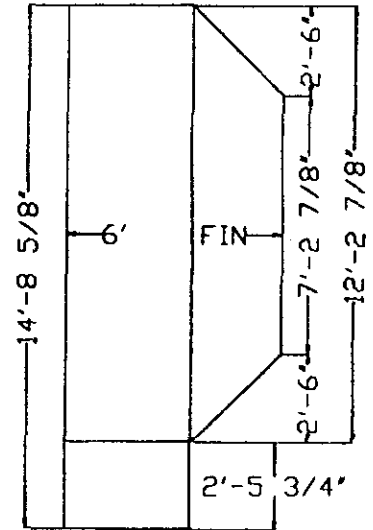

24 BAKER ST. P.O. BOX 100, HASTINGS ON KOL - 1Y0
 705-696-2385 1-800-465-3433 FAX: 705-696-1922

12'X24' L.H. COZUMEL

QTY.	LENGTH	RADIUS	TYPE
1	10'0"	NA	SKIMMER
1	9'0"	NA	PLAIN
3	6'0"	NA	PLAIN
2	6'0"	NA	RETURN
1	5'0"	NA	PLAIN
2	3'0"	NA	PLAIN
2	3'2"	2'0"	CORNER
2	6'X6'	NA	225° REV CORNER
6	-	NA	45° OUTSIDE CORNER
4	-	NA	A-FRAME
1	-	NA	N&B PKG
			S.A.: 268 sq.ft.
			PER: 68'4"
1224COZC			DATE: 10-11-00

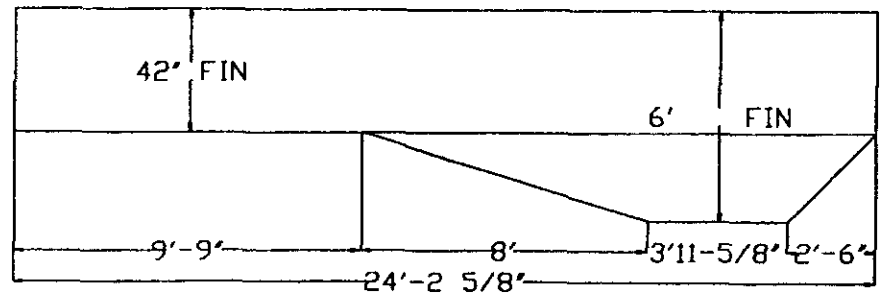

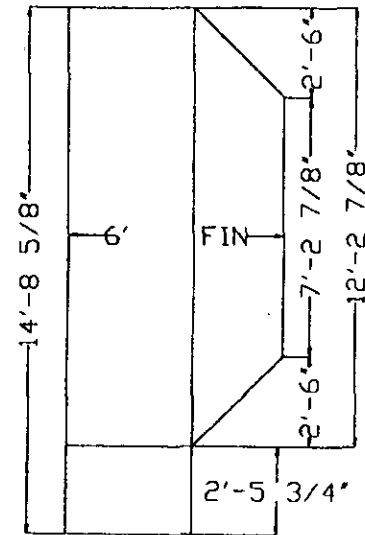
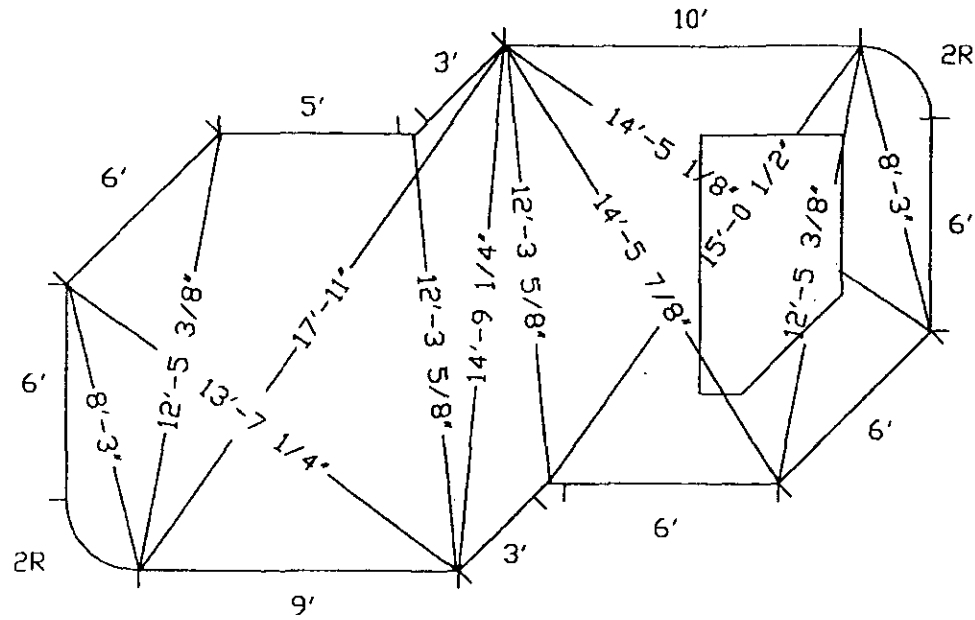

24 BAKER ST., P.O. BOX 100, HASTINGS DN, KOL-110
705-696-2385, 1-800-465-3433, FAX 705-696-1922

12'X24' L.H. COZUMEL

QTY.	LENGTH	RADIUS	TYPE
1	10'0"	NA	SKIMMER
1	9'0"	NA	PLAIN
3	6'0"	NA	PLAIN
2	6'0"	NA	RETURN
1	5'0"	NA	PLAIN
2	3'0"	NA	PLAIN
2	3'2"	2'0"	CORNER
2	6'X6'	NA	225° REV CORNER
6	-	NA	45° OUTSIDE CORNER
4	-	NA	A-FRAME
1	-	NA	N&B PKG
			S.A. 268 sq.ft.
			PER. 68'4"
1224COZC			DATE: 10-11-00

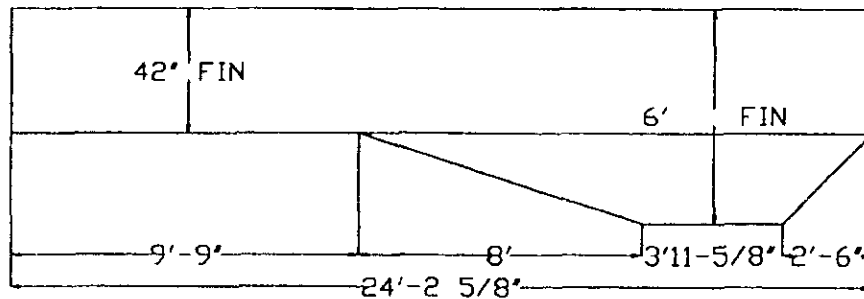

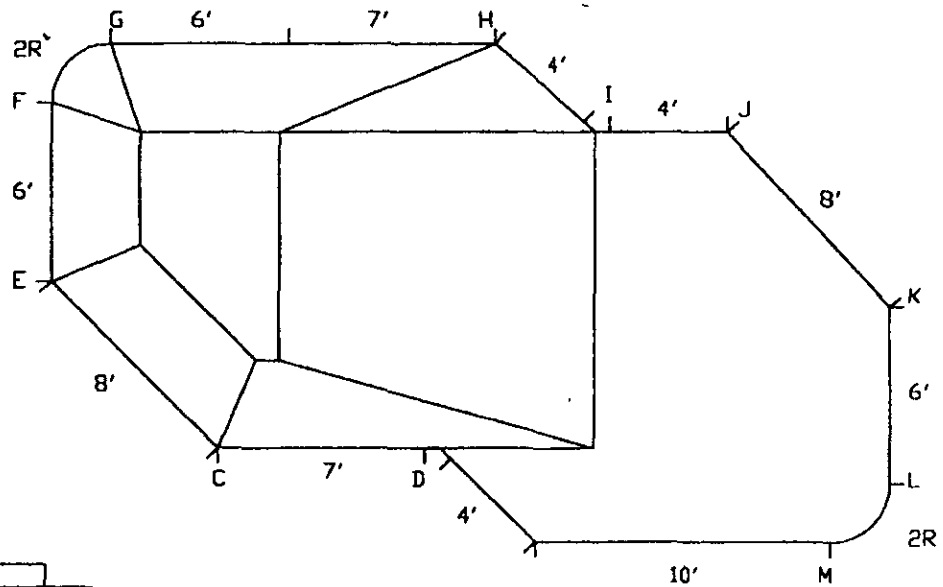
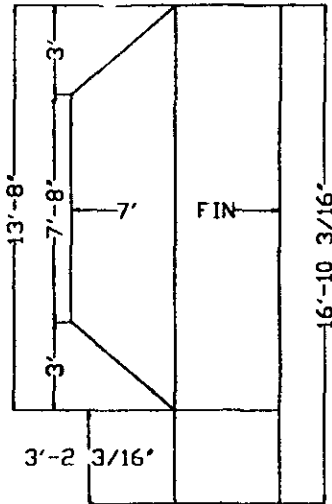

STAKE OUT			
A-C	6'6"	B-C	9'7-1/2"
A-D	11'8"	B-D	6'
A-E	12'1"	B-E	17'7"
A-F	17'11-3/8"	B-F	22'-3/8"
A-G	19'8-3/8"	B-G	22'7-3/8"
A-H	22'11-1/2"	B-H	19'9"
A-I	22'7-1/4"	B-I	17'6"
A-J	25'10-1/8"	B-J	19'4"
A-K	27'4-7/8"	B-K	18'7-3/4"
A-L	23'7-3/4"	B-L	15'11-1/8"
A-M	23'4-1/4"	B-M	13'5-3/4"

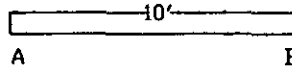

24 BAKER ST. P.O. BOX 100, HASTINGS ON KOL-1Y0
705-696-2385, 1-800-465-3433, FAX 705-696-1922

14'X28' R.H. COZUMEL

QTY.	LENGTH	RADIUS	TYPE
1	10'0"	NA	PLAIN
2	8'0"	NA	PLAIN
2	7'0"	NA	PLAIN
2	6'0"	NA	RETURN
1	6'0"	NA	SKIMMER
3	4'0"	NA	PLAIN
2	3'2"	2'0"	CORNER
2	6'X6'	NA	225° REV CORNER
6	-	NA	45° OUTSIDE CORNER
5	-	NA	A-FRAME
1	-	NA	N&B PKG
			S.A: 359 sq.ft.
			PER: 78'4"
1428CQZC			DATE: 10-11-00

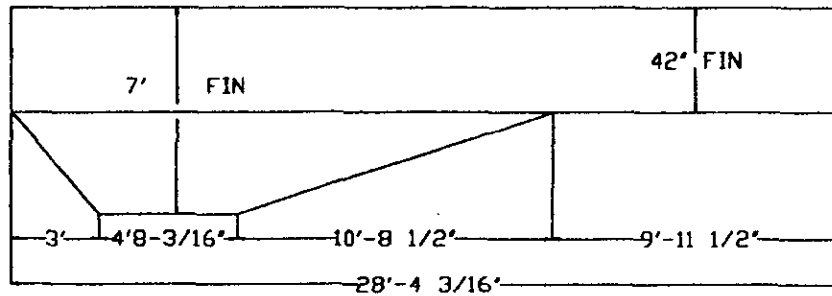

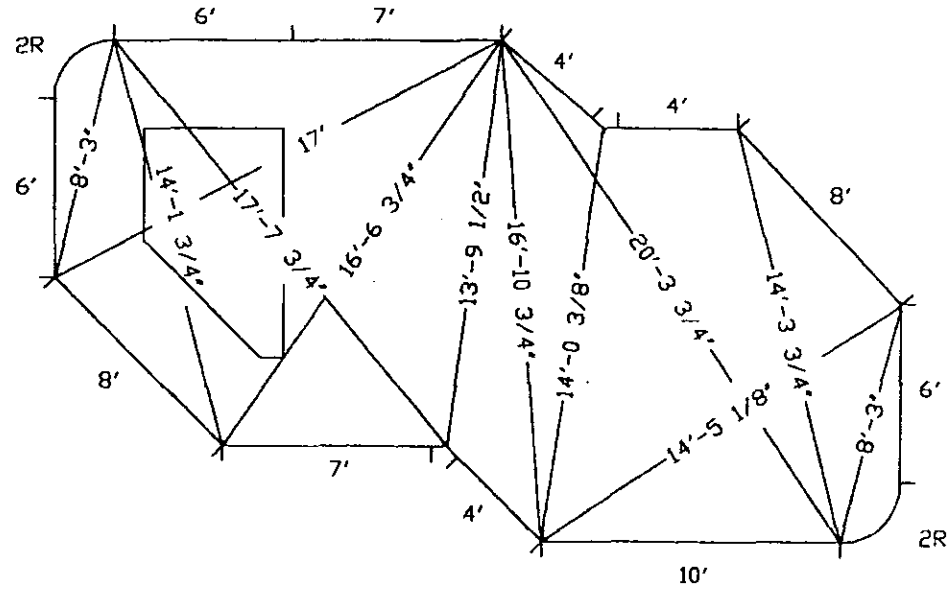
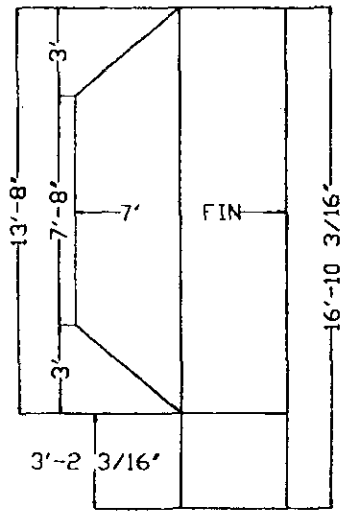

24 BAKER ST., P.O. BOX 100, HASTINGS ON KOL - 1Y0
 705-696-2385, 1-800-465-3433, FAX 705-696-1922

14'X28' R.H. COZUMEL

QTY.	LENGTH	RADIUS	TYPE
1	10'0"	NA	PLAIN
2	8'0"	NA	PLAIN
2	7'0"	NA	PLAIN
2	6'0"	NA	RETURN
1	6'0"	NA	SKIMMER
3	4'0"	NA	PLAIN
2	3'2"	2'0"	CORNER
2	6'X6'	NA	225° REV CORNER
6	-	NA	45° OUTSIDE CORNER
5	-	NA	A-FRAME
1	-	NA	N&B PKG
			S.A.: 359 sq.ft.
			PER: 78'4"
1428C02C			DATE: 10-11-00

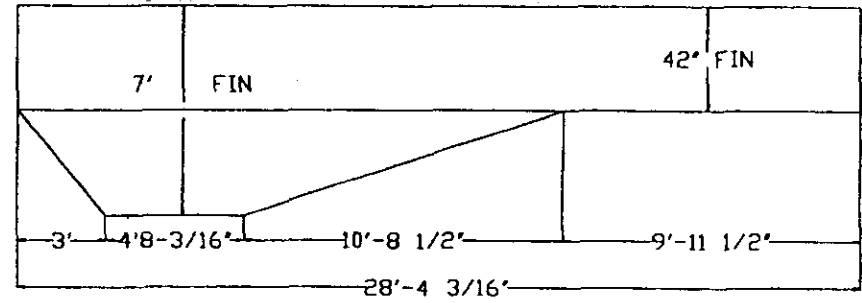

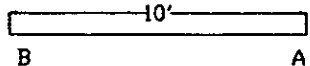
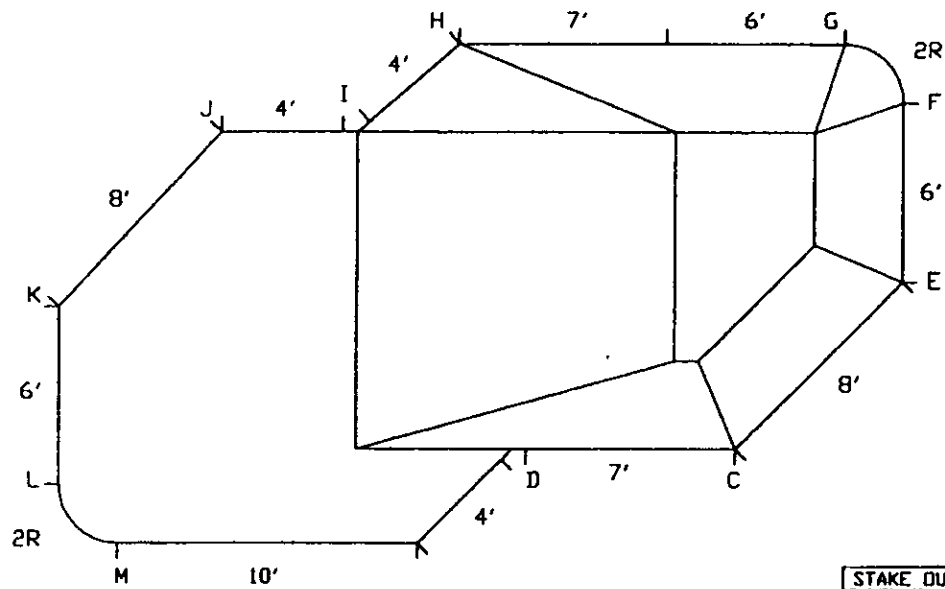

STAKE OUT			
A-C	6'6"	B-C	9'7-1/2"
A-D	11'8"	B-D	6'
A-E	12'1"	B-E	17'7"
A-F	17'11-3/8"	B-F	22'-3/8"
A-G	19'8-3/8"	B-G	22'7-3/8"
A-H	22'11-1/2"	B-H	19'9"
A-I	22'7-1/4"	B-I	17'6"
A-J	25'10-1/8"	B-J	19'4"
A-K	27'4-7/8"	B-K	18'7-3/4"
A-L	25'7-3/4"	B-L	15'11-1/8"
A-M	23'4-1/4"	B-M	13'5-3/4"

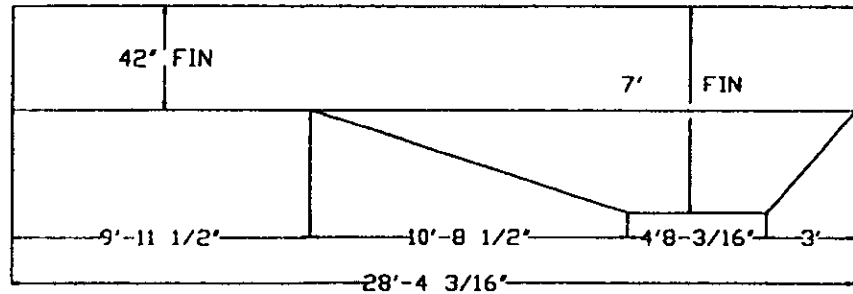
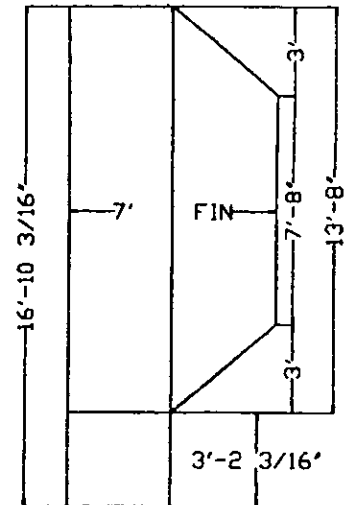

24 BAKER ST. P.O. BOX 100, HASTINGS ON KOL - 1Y0
705-696-2385, 1-800-465-3433, FAX: 705-696-1922

14'X28' L.H. COZUMEL

QTY.	LENGTH	RADIUS	TYPE
1	10'0"	NA	PLAIN
2	8'0"	NA	PLAIN
2	7'0"	NA	PLAIN
2	6'0"	NA	RETURN
1	6'0"	NA	SKIMMER
3	4'0"	NA	PLAIN
2	3'2"	2'0"	CORNER
2	6'X6'	NA	225° REV CORNER
6	-	NA	45° OUTSIDE CORNER
5	-	NA	A-FRAME
1	-	NA	N&B PKG
			S.A. 359 sq.ft.
			PER: 78'4"
1428COZC			DATE: 10-11-00

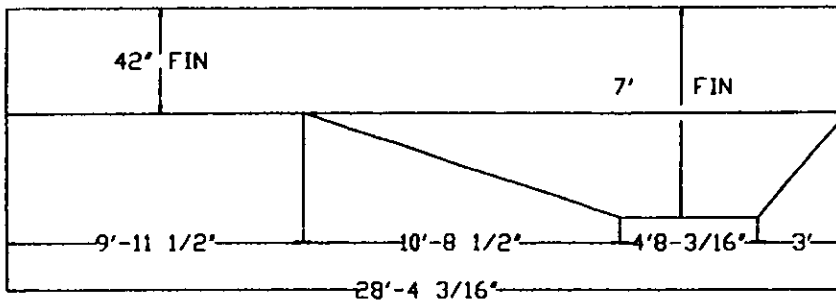
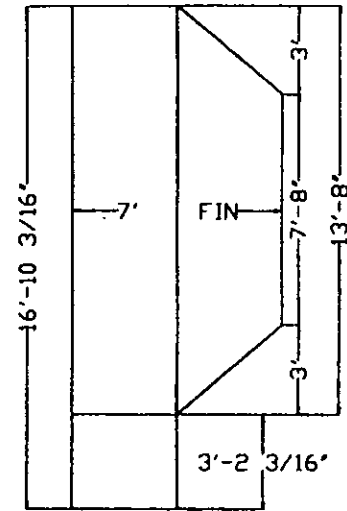
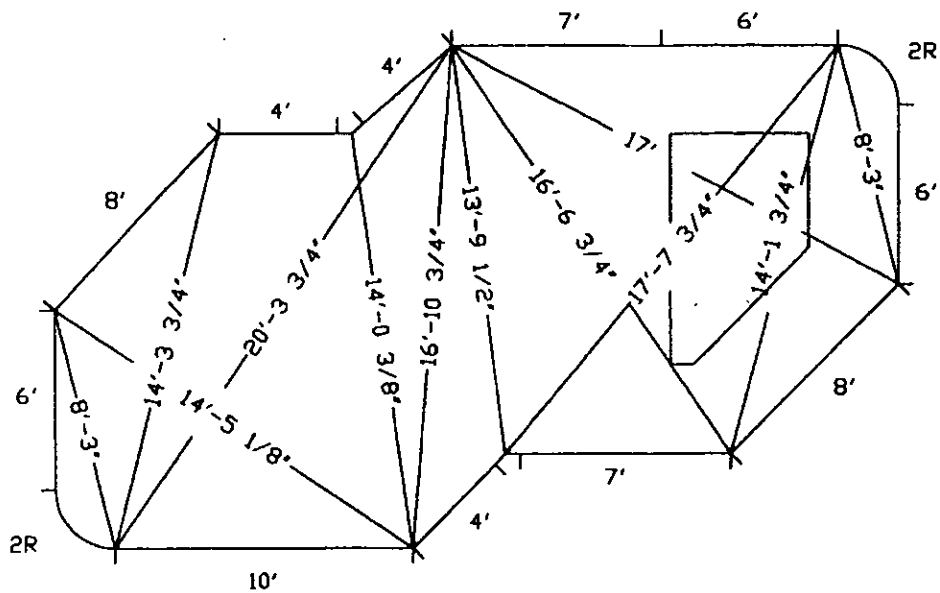

24 BAKER ST. P.O. BOX 100, HASTINGS DNKOL-1Y0
705-696-2385 1-800-465-3433 FAX 705-696-1922

14'X28' L.H. COZUMEL

QTY.	LENGTH	RADIUS	TYPE
1	10'0"	NA	PLAIN
2	8'0"	NA	PLAIN
2	7'0"	NA	PLAIN
2	6'0"	NA	RETURN
1	6'0"	NA	SKIMMER
3	4'0"	NA	PLAIN
2	3'2"	2'0"	CORNER
2	6'X6'	NA	225° REV CORNER
6	-	NA	45° OUTSIDE CORNER
5	-	NA	A-FRAME
1	-	NA	N&B PKG
			S.A. 359 sq.ft.
			PER: 78'4"
1428COZC			DATE: 10-11-00

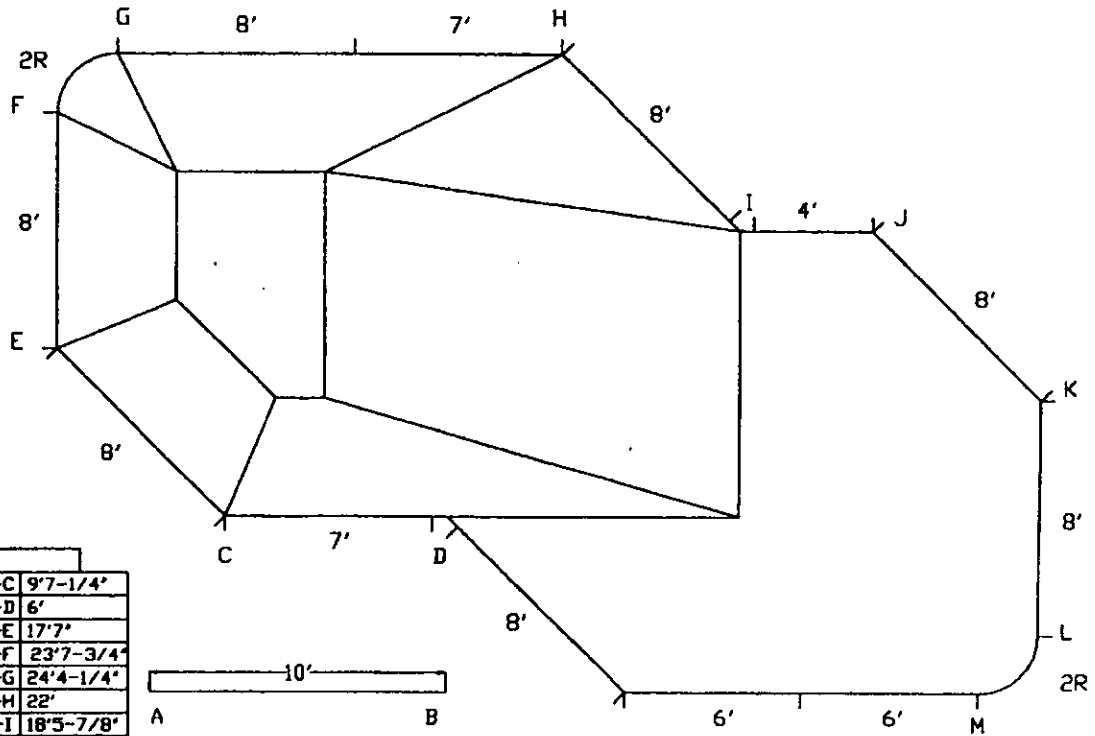
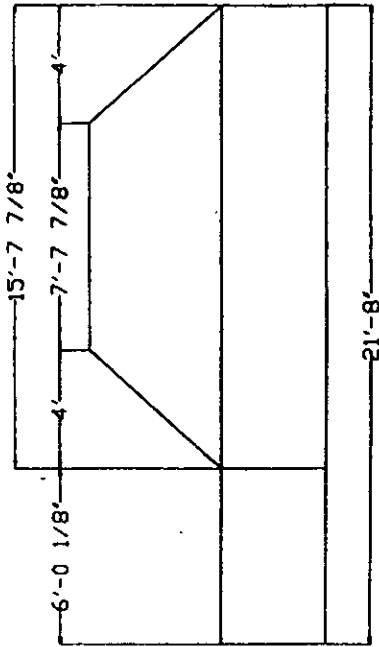

STAKE OUT			
A-C	6'6"	B-C	9'7-1/4"
A-D	11'8"	B-D	6'
A-E	12'1"	B-E	17'7"
A-F	19'10-7/8"	B-F	23'7-3/4"
A-G	21'8-1/4"	B-G	24'4-1/4"
A-H	25'8-1/2"	B-H	22'
A-I	25'3-1/4"	B-I	18'5-7/8"
A-J	28'11-3/8"	B-J	21'2-3/4"
A-K	31'7-1/2"	B-K	22'4-3/8"
A-L	30'1"	B-L	20'1-1/4"
A-M	28'	B-M	18'

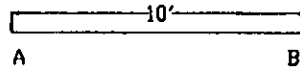

24 BAKER ST. P.O. BOX 100, HASTINGS ON KOL - 1Y0
 705-696-2385, 1-800-465-3433, FAX: 705-696-1922

16'X33' R.H. COZUMEL

QTY.	LENGTH	RADIUS	TYPE
4	8'0"	NA	PLAIN
2	8'0"	NA	RETURN
1	8'0"	NA	SKIMMER
2	7'0"	NA	PLAIN
2	6'0"	NA	PLAIN
1	4'0"	NA	PLAIN
2	3'2"	2'0"	CORNER
2	6'X6'	NA	225° REV CORNER
6	-	NA	45° OUTSIDE CORNER
6	-	NA	A-FRAME
1	-	NA	N&B PKG
			S.A. 509 sq.ft.
			PER: 94'4"
1633COZC			DATE: 10-11-00

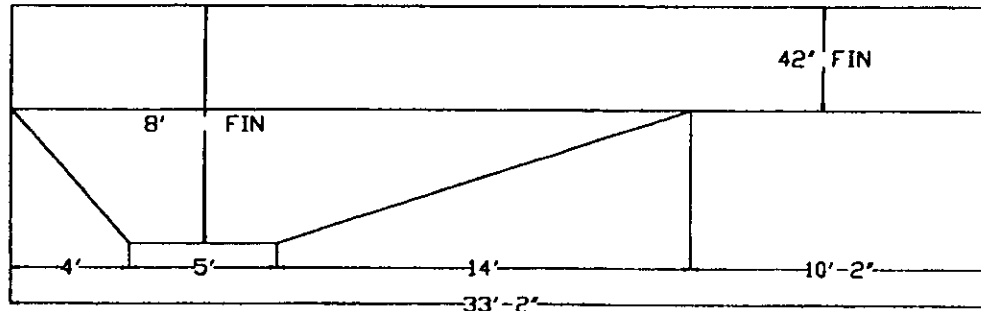

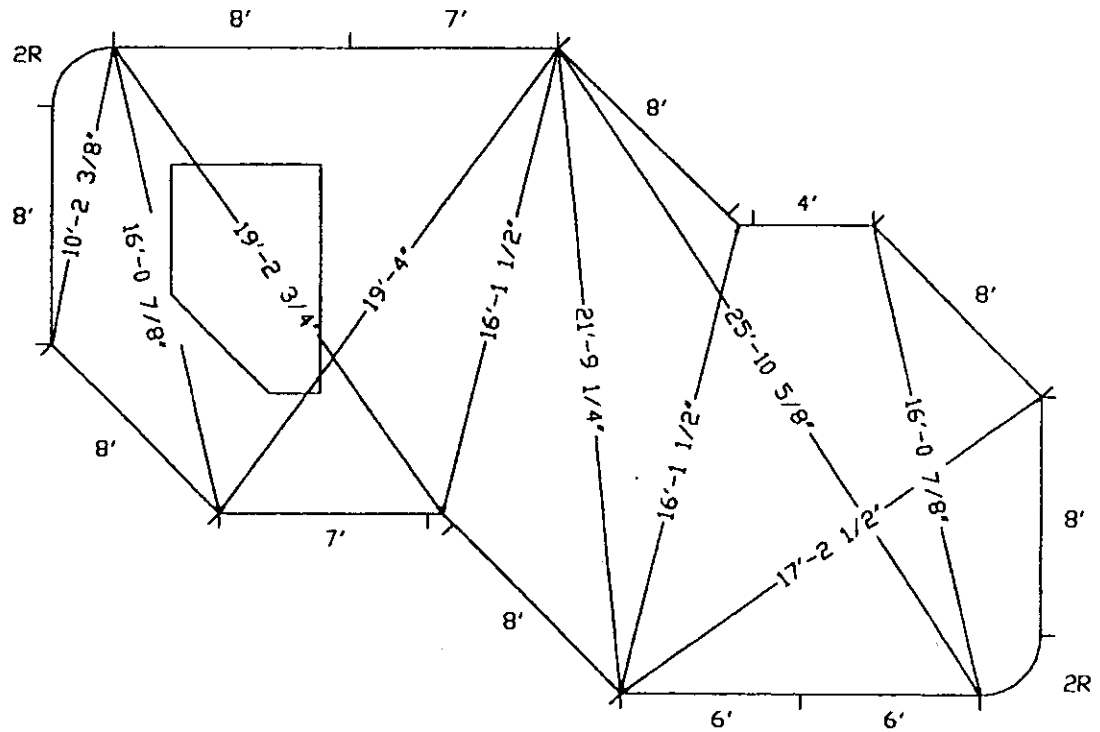
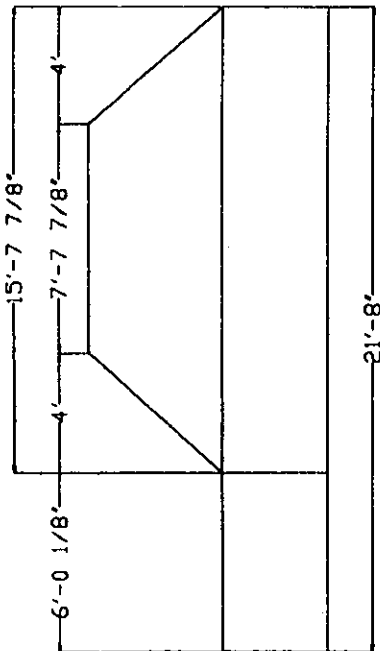

24 BAKER ST. P.O. BOX 100, HASTINGS DN. KOL-1Y0
 705-696-2385, 1-800-465-3433, FAX: 705-696-1922

16'X33' R.H. COZUMEL

QTY.	LENGTH	RADIUS	TYPE
4	8'0"	NA	PLAIN
2	8'0"	NA	RETURN
1	8'0"	NA	SKIMMER
2	7'0"	NA	PLAIN
2	6'0"	NA	PLAIN
1	4'0"	NA	PLAIN
2	3'2"	2'0"	CORNER
2	6'X6'	NA	225° REV CORNER
6	-	NA	45° OUTSIDE CORNER
6	-	NA	A-FRAME
1	-	NA	N&B PKG
			S.A. 509 sq.ft.
			PER: 94'4'
1633COZC			DATE: 10-11-00

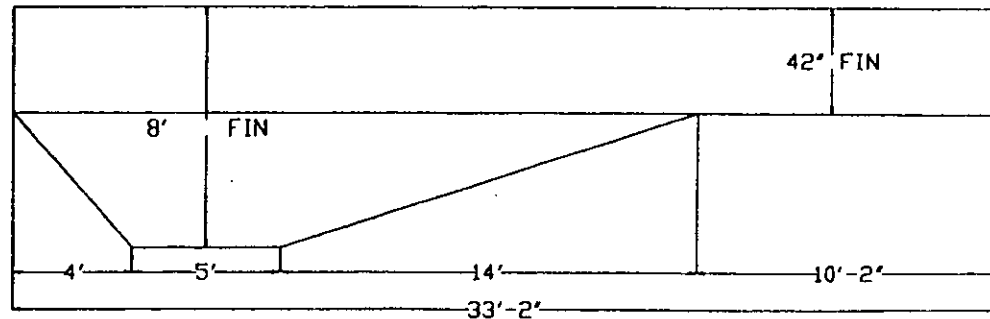

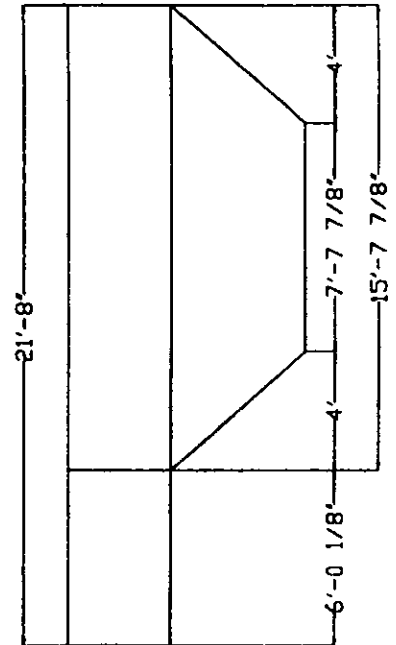
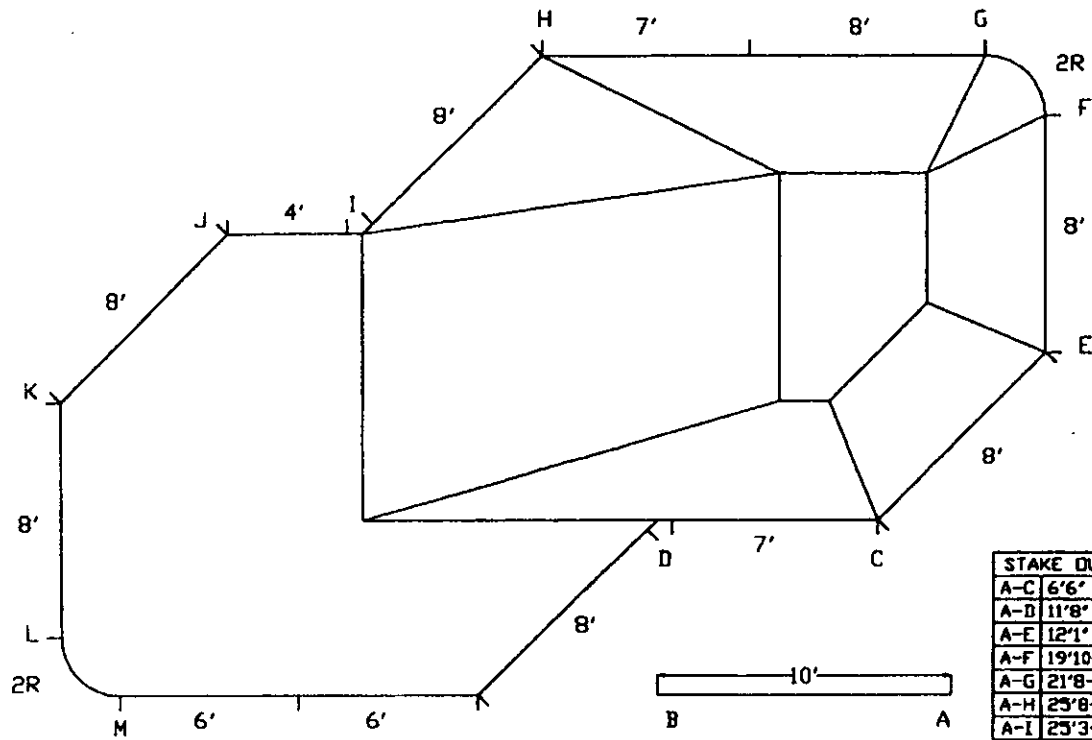

STAKE OUT			
A-C	6'6"	B-C	9'7-1/4"
A-D	11'8"	B-D	6'
A-E	12'1"	B-E	17'7"
A-F	19'10-7/8"	B-F	23'7-3/4"
A-G	21'8-1/4"	B-G	24'4-1/4"
A-H	23'8-1/2"	B-H	22'
A-I	23'3-1/4"	B-I	18'5-7/8"
A-J	28'11-3/8"	B-J	21'2-3/4"
A-K	31'7-1/2"	B-K	22'4-3/8"
A-L	30'1"	B-L	20'1-1/4"
A-M	28'	B-M	18'



24 BAKER ST., P.O. BOX 100, HASTINGS ON KOL - 1Y0
 705-696-2385, 1-800-465-3433, FAX: 705-696-1922

16'X33' L.H. COZUMEL

QTY.	LENGTH	RADIUS	TYPE
4	8'0"	NA	PLAIN
2	8'0"	NA	RETURN
1	8'0"	NA	SKIMMER
2	7'0"	NA	PLAIN
2	6'0"	NA	PLAIN
1	4'0"	NA	PLAIN
2	3'2"	2'0"	CORNER
2	6'X6'	NA	225° REV CORNER
6	-	NA	45° OUTSIDE CORNER
6	-	NA	A-FRAME
1	-	NA	N&B PKG
			S.A. 509 sq.ft.
			PER 94'4"
1633COZC			DATE: 10-11-00

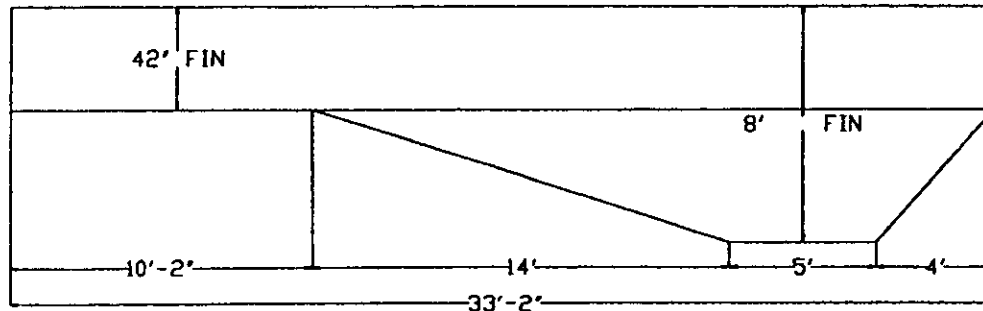

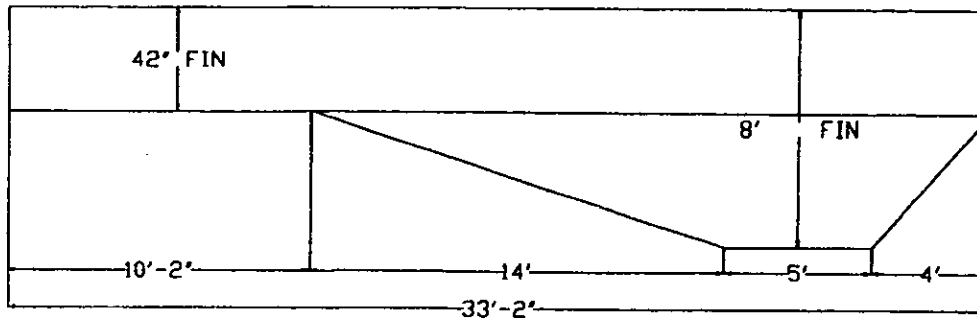
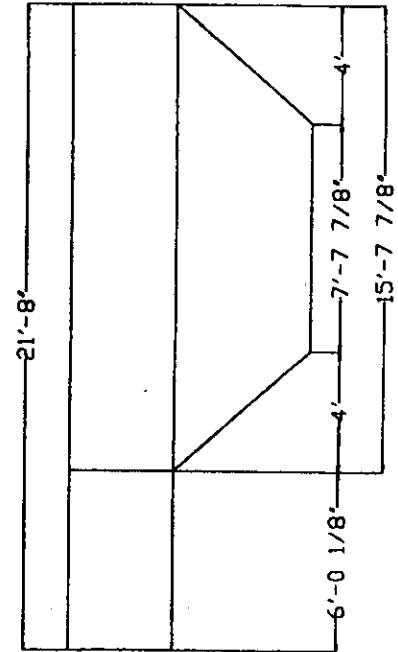
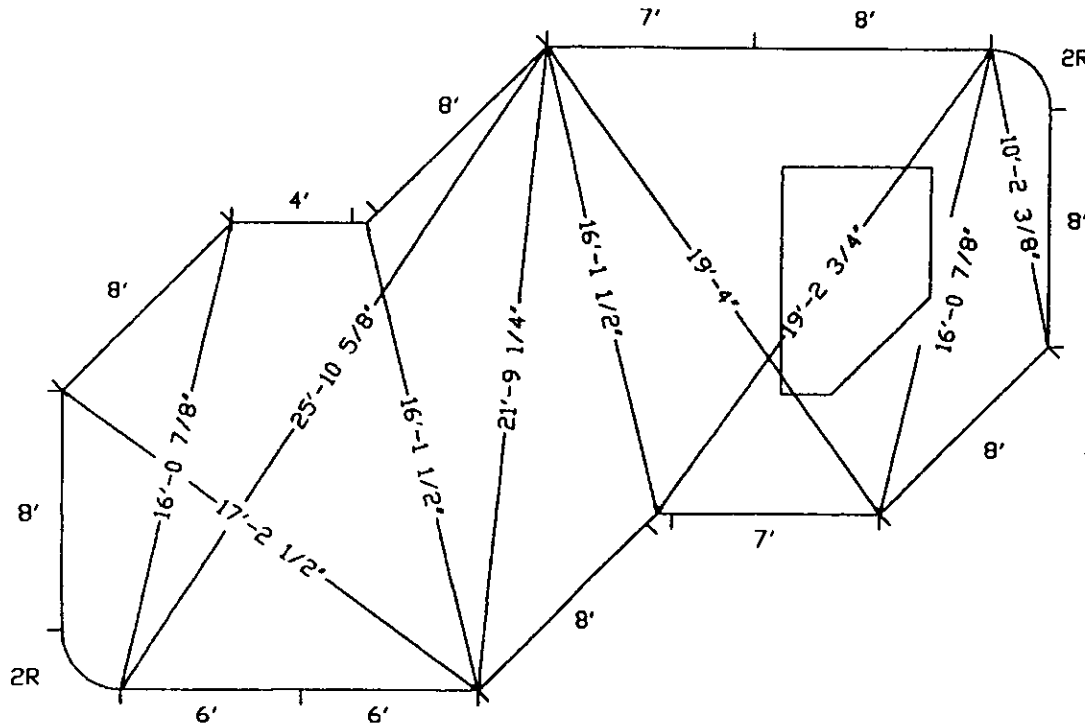

24 BAKER ST. P.O. BOX 100, HASTINGS ON KOL - 1YO
705-696-2385 1-800-465-3433 FAX 705-696-1922

16'X33' L.H. COZUMEL

QTY.	LENGTH	RADIUS	TYPE
4	8'0"	NA	PLAIN
2	8'0"	NA	RETURN
1	8'0"	NA	SKIMMER
2	7'0"	NA	PLAIN
2	6'0"	NA	PLAIN
1	4'0"	NA	PLAIN
2	3'2"	2'0"	CORNER
2	6'X6'	NA	225° REV CORNER
6	-	NA	45° OUTSIDE CORNER
6	-	NA	A-FRAME
1	-	NA	N&B PKG
			S.A. 509 sq.ft.
			PER: 94'4"
1633COZC			DATE: 10-11-00

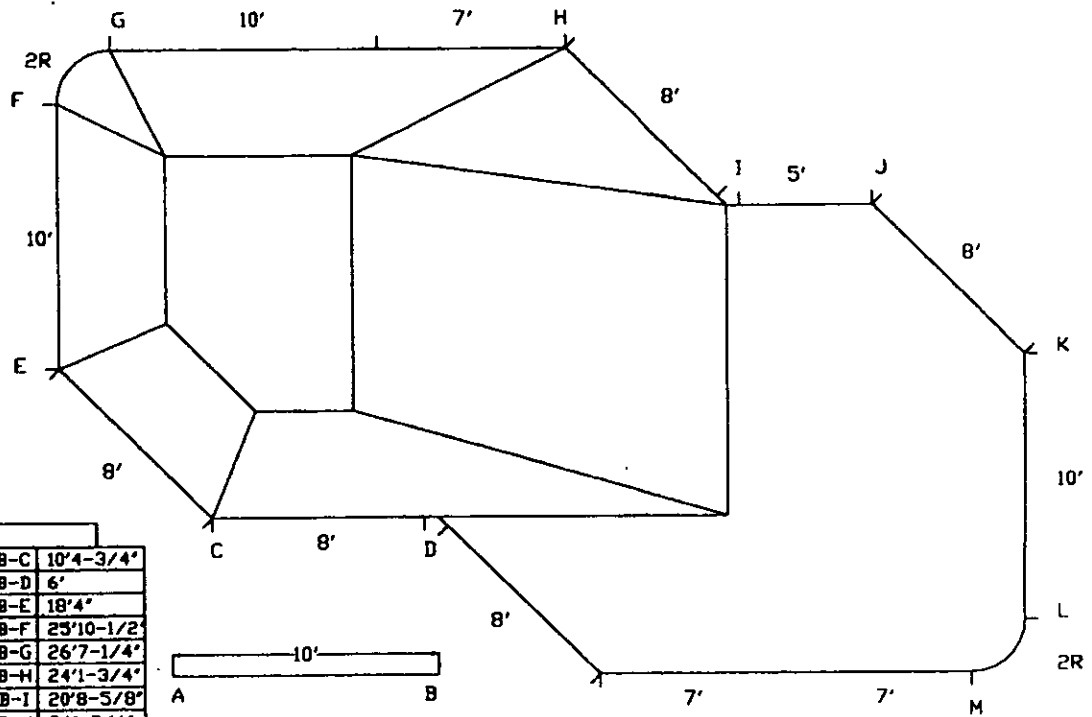
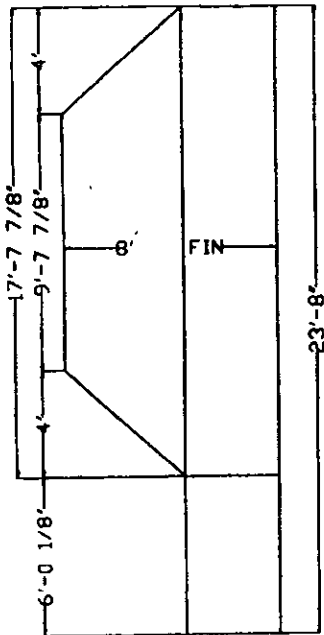

STAKE OUT			
A-C	6'2-1/4'	B-C	10'4-3/4'
A-D	11'8"	B-D	6'
A-E	12'4-1/2"	B-E	18'4"
A-F	22'-5/8"	B-F	23'10-1/2"
A-G	23'9"	B-G	26'7-1/4"
A-H	27'11"	B-H	24'1-3/4"
A-I	27'3-3/4"	B-I	20'8-5/8"
A-J	31'8-1/2"	B-J	24'-3/4"
A-K	34'2-1/4"	B-K	25'-3/4"
A-L	32'-7/8"	B-L	22'1-1/4"
A-M	30'-1/8"	B-M	20'-1/8"



24 BAKER ST. P.O. BOX 100, HASTINGS ON KOL - 1Y0
 705-696-2385 1-800-465-3433 FAX 705-696-1922

18'X36' R.H. COZUMEL

QTY.	LENGTH	RADIUS	TYPE
2	10'0"	NA	RETURN
1	10'0"	NA	SKIMMER
5	8'0"	NA	PLAIN
3	7'0"	NA	PLAIN
1	5'0"	NA	PLAIN
2	3'2"	2'0"	CORNER
2	6'X6'	NA	225° REV CORNER
6	-	NA	45° OUTSIDE CORNER
6	-	NA	A-FRAME
1	-	NA	N&B PKG
			S.A. 634 sq.ft.
			PER: 104'4"
1836COZC			DATE: 13-11-00

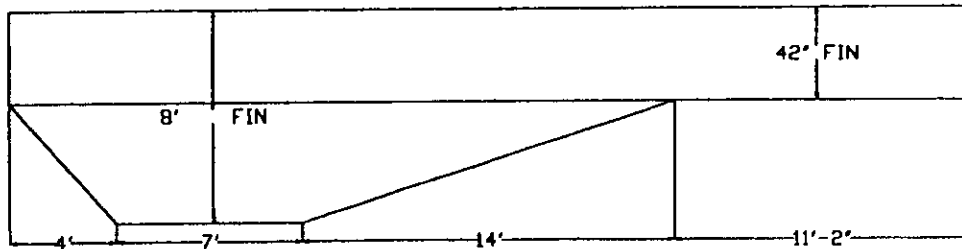

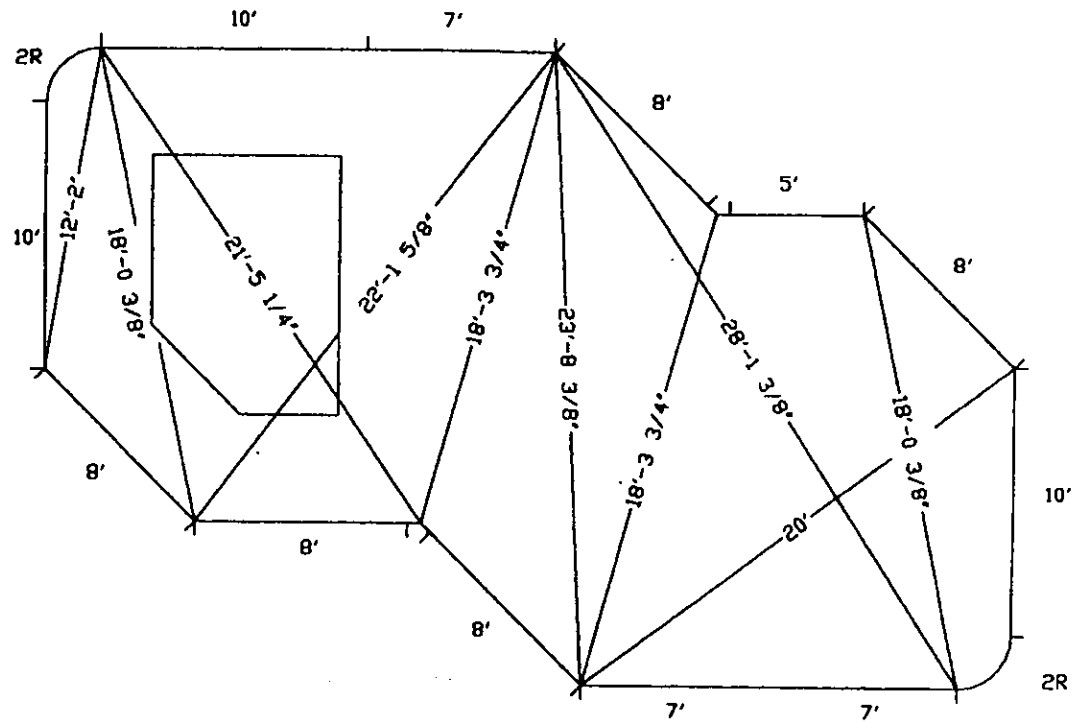
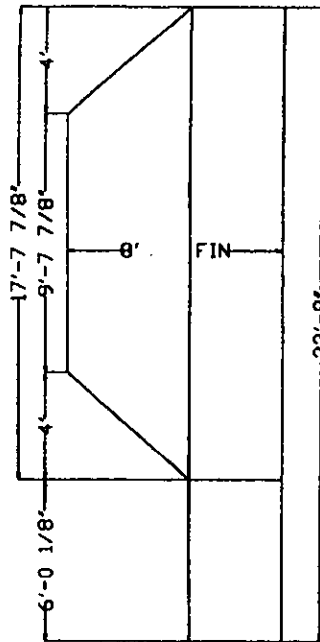

24 BAKER ST. P.O. BOX 100, HASTINGS ON KOL-1Y0
 705-696-2383, 1-800-465-3433, FAX: 705-696-1922

18'X36' R.H. COZUMEL

QTY.	LENGTH	RADIUS	TYPE
2	10'0"	NA	RETURN
1	10'0"	NA	SKIMMER
5	8'0"	NA	PLAIN
3	7'0"	NA	PLAIN
1	5'0"	NA	PLAIN
2	3'2"	2'0"	CORNER
2	6'X6'	NA	225° REV CORNER
6	-	NA	45° OUTSIDE CORNER
6	-	NA	A-FRAME
1	-	NA	N&B PKG
			S.A. 634 sq.ft.
			PER: 104'4'
1836COZC			DATE: 13-11-00

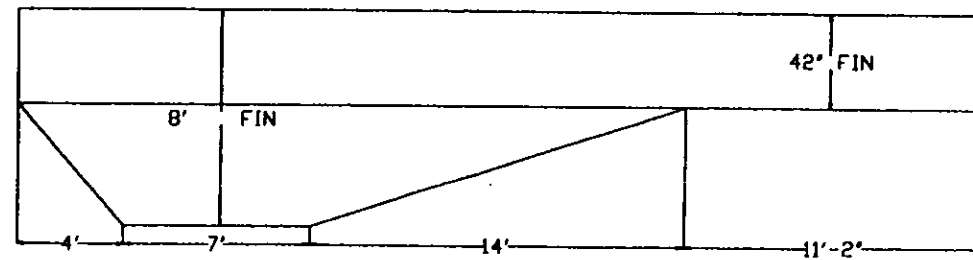

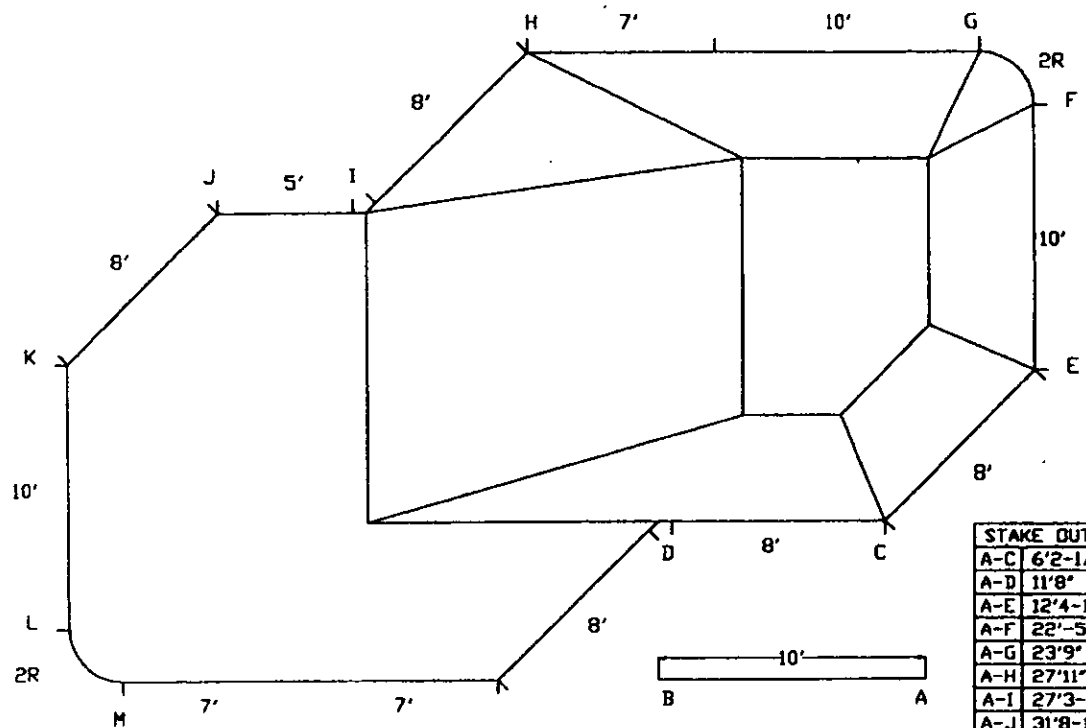

STAKE OUT			
A-C	6'2-1/4"	B-C	10'4-3/4"
A-D	11'8"	B-D	6'
A-E	12'4-1/2"	B-E	18'4"
A-F	22'-5/8"	B-F	23'10-1/2"
A-G	23'9"	B-G	26'7-1/4"
A-H	27'11"	B-H	24'1-3/4"
A-I	27'3-3/4"	B-I	20'8-5/8"
A-J	31'8-1/2"	B-J	24'-3/4"
A-K	34'2-1/4"	B-K	25'-3/4"
A-L	32'-7/8"	B-L	22'1-1/4"
A-M	30'-1/8"	B-M	20'-1/8"

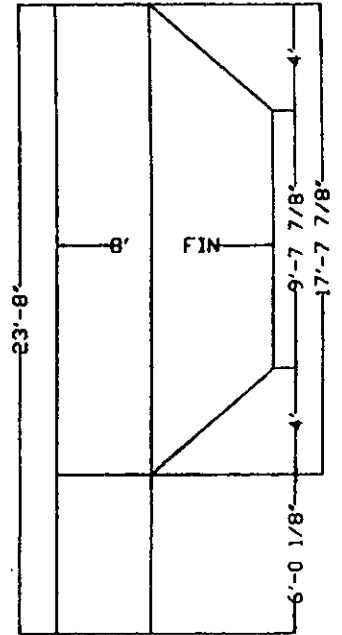

24 BAKER ST. P.O. BOX 100, HASTINGS DNKOL-1YO
 705-696-2385, 1-800-465-3433, FAX 705-696-1922

18'X36' L.H. COZUMEL

QTY.	LENGTH	RADIUS	TYPE
2	10'0"	NA	RETURN
1	10'0"	NA	SKIMMER
5	8'0"	NA	PLAIN
3	7'0"	NA	PLAIN
1	5'0"	NA	PLAIN
2	3'2"	2'0"	CORNER
2	6'X6'	NA	225' REV CORNER
6	-	NA	45° OUTSIDE CORNER
6	-	NA	A-FRAME
1	-	NA	N&B PKG
			S.A. 634 sq.ft.
			PER: 104'4"
1836COZC			DATE: 13-11-00

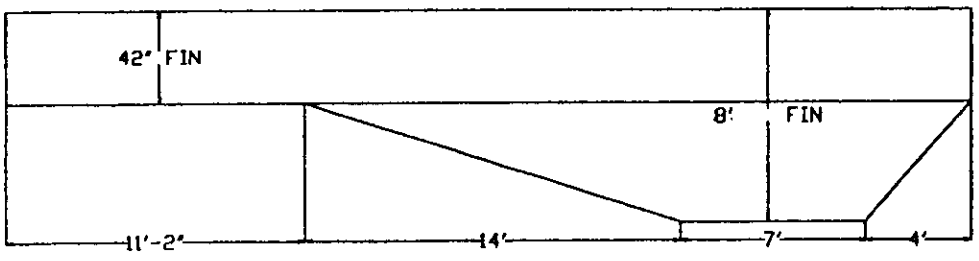

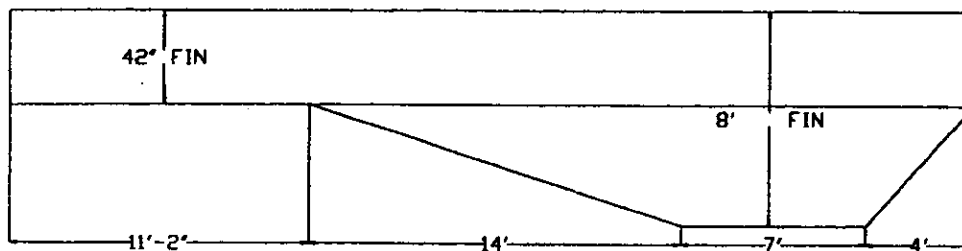
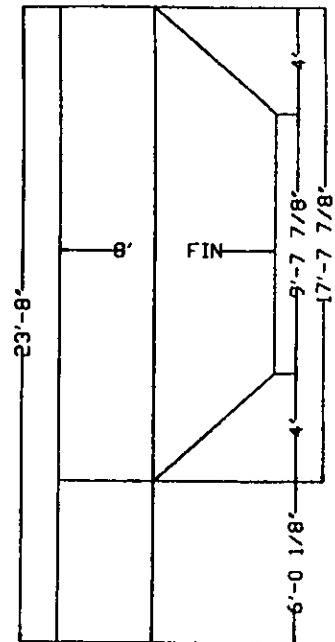
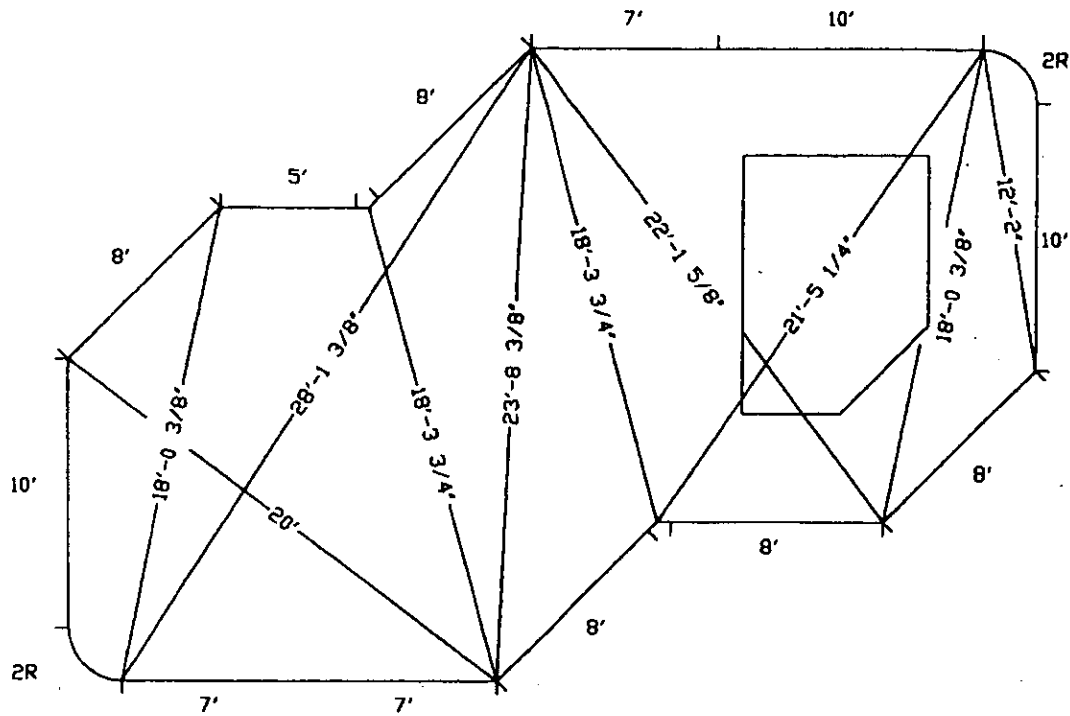

24 BAKER ST. P.O. BOX 100, HASTINGS ON KOL. - IYO
705-696-2385, 1-800-465-3433, FAX 705-696-1922

18'X36' L.H. COZUMEL

QTY.	LENGTH	RADIUS	TYPE
2	10'0"	NA	RETURN
1	10'0"	NA	SKIMMER
5	8'0"	NA	PLAIN
3	7'0"	NA	PLAIN
1	5'0"	NA	PLAIN
2	3'2"	2'0"	CORNER
2	6'X6'	NA	225° REV CORNER

6	-	NA	45° OUTSIDE CORNER
6	-	NA	A-FRAME
1	-	NA	N&B PKG
			S.A: 634 sq.ft.
			PER: 104'4"
1836COZC			DATE: 13-11-00

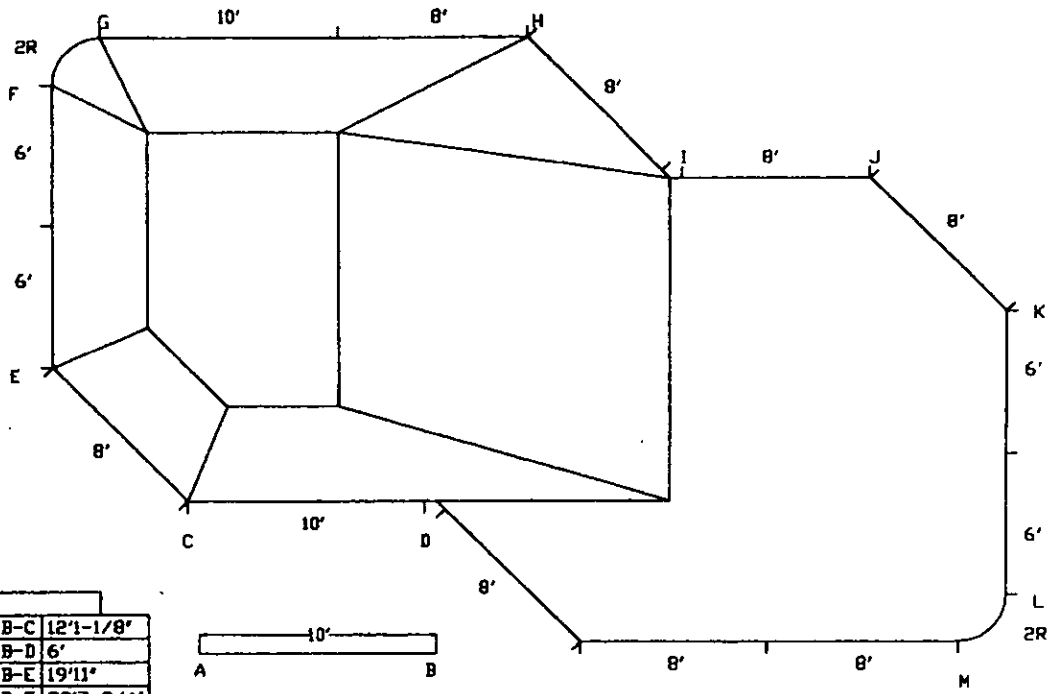
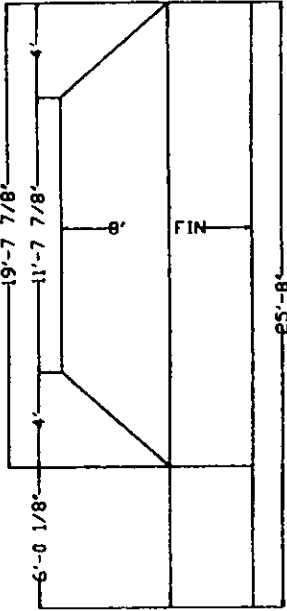

STAKE OUT			
A-C	6'-1/4"	B-C	12'-1-1/8"
A-D	11'8"	B-D	6'
A-E	13'-2-1/4"	B-E	19'11"
A-F	24'-5-1/4"	B-F	28'-7-3/4"
A-G	25'-11-7/8"	B-G	29'-3-5/8"
A-H	29'-1-3/4"	B-H	25'-11-1/4"
A-I	27'-11-1/4"	B-I	21'-11-3/4"
A-J	34'6"	B-J	26'-10-5/8"
A-K	36'-9-1/4"	B-K	27'-9-1/2"
A-L	34'-3/4"	B-L	24'-1-1/8"
A-M	32'-1/8"	B-M	22'-1/8"



24 BAKER ST. P.O. BOX 100, HASTINGS ON KOL - 1YO
 705-696-2385, 1-800-465-3433, FAX 705-696-1922

20'X40' R.H. COZUMEL

QTY.	LENGTH	RADIUS	TYPE
1	10'0"	NA	PLAIN
1	10'0"	NA	SKIMMER
8	8'0"	NA	PLAIN
2	6'0"	NA	RETURN
2	6'0"	NA	PLAIN
2	3'2"	2'0"	CORNER
2	6'X6'	NA	225° REV CORNER
6	-	NA	45° OUTSIDE CORNER
8	-	NA	A-FRAME
1	-	NA	N&B PKG
			S.A.: 779 sq.ft.
			PER: 116'4"
2040C02C			DATE: 13-11-00

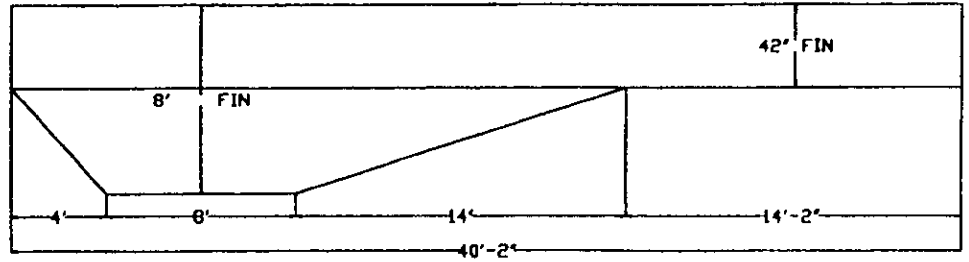

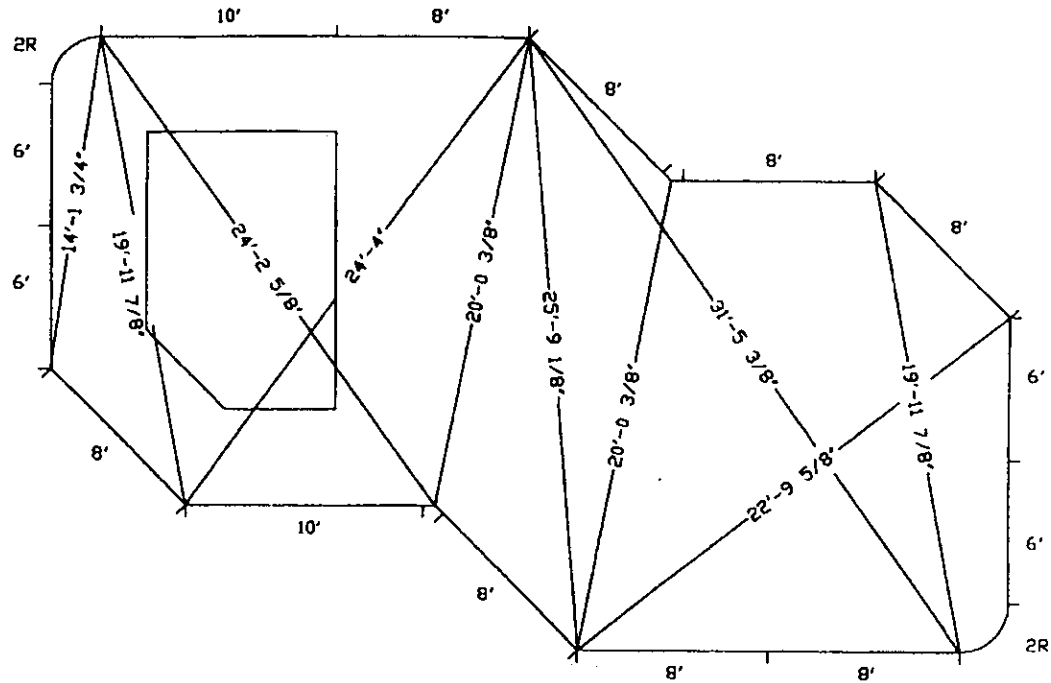
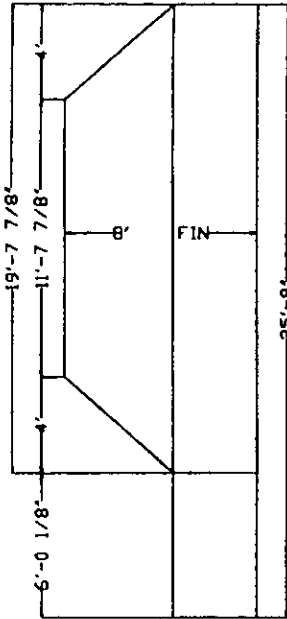

24 BAKER ST. P.O. BOX 100, HASTINGS DN. KOL-1Y0
705-696-2385, 1-800-465-3433, FAX: 705-696-1922

20' X 40' R.H. COZUMEL

QTY.	LENGTH	RADIUS	TYPE
1	10'0"	NA	PLAIN
1	10'0"	NA	SKIMMER
8	8'0"	NA	PLAIN
2	6'0"	NA	RETURN
2	6'0"	NA	PLAIN
2	3'2"	2'0"	CORNER
2	6'X6'	NA	225° REV CORNER
6	-	NA	45° OUTSIDE CORNER
8	-	NA	A-FRAME
1	-	NA	N&B PKG
S.A. 779 sq.ft.			
PER. 116'4"			
DATE: 13-11-00			

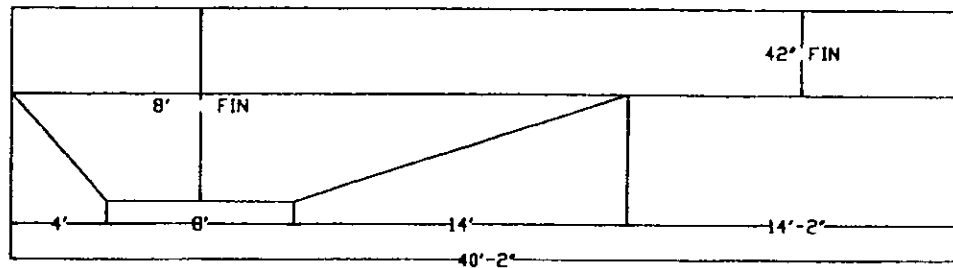

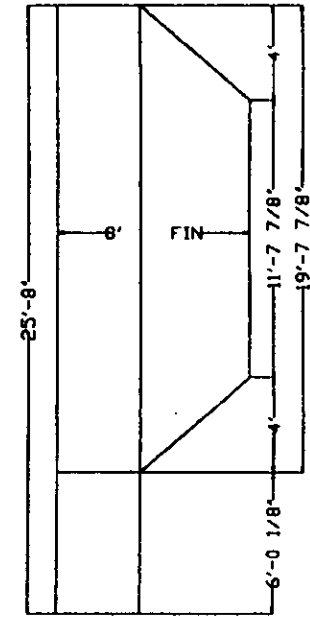
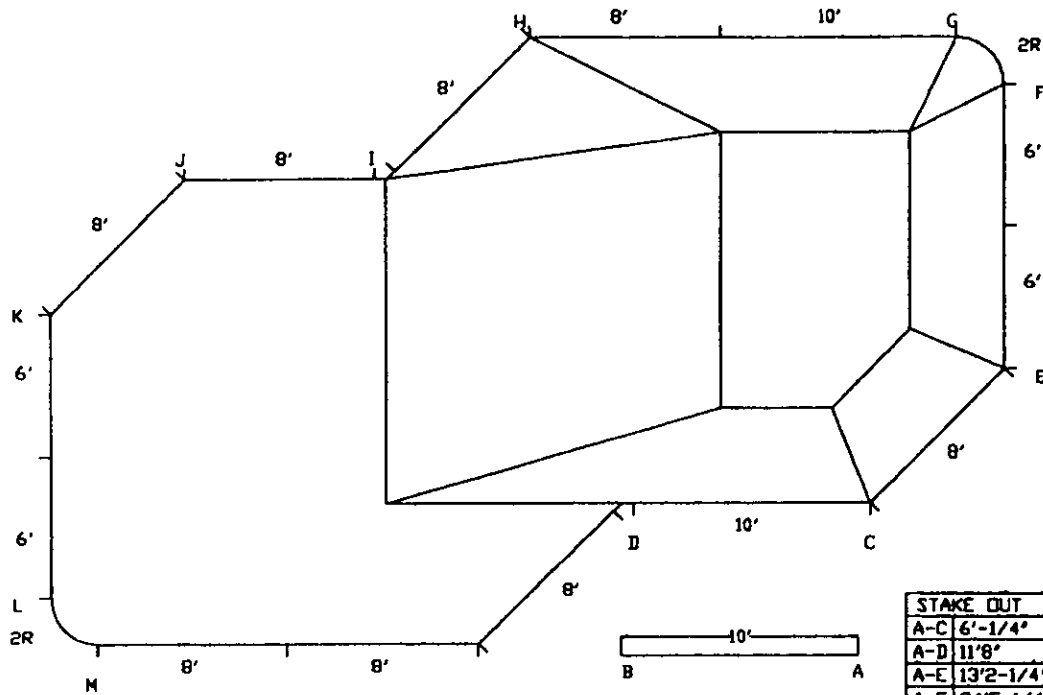

STAKE OUT			
A-C	6'-1/4"	B-C	12'-1-1/8"
A-D	11'8"	B-D	6'
A-E	13'-2-1/4"	B-E	19'11"
A-F	24'-5-1/4"	B-F	28'-7-3/4"
A-G	25'-11-7/8"	B-G	29'-3-5/8"
A-H	29'-1-3/4"	B-H	25'-11-1/4"
A-I	27'-11-1/4"	B-I	21'-11-3/4"
A-J	34'6"	B-J	26'-10-5/8"
A-K	36'-9-1/4"	B-K	27'-9-1/2"
A-L	34'-3/4"	B-L	24'-1-1/8"
A-M	32'-1/8"	B-M	22'-1/8"



24 BAKER ST. P.O. BOX 100, HASTINGS ON KOL - 1Y0
 705-696-2385, 1-800-465-3433, FAX 705-696-1922

20' X 40' L.H. COZUMEL

QTY.	LENGTH	RADIUS	TYPE
1	10'0"	NA	PLAIN
1	10'0"	NA	SKIMMER
8	8'0"	NA	PLAIN
2	6'0"	NA	RETURN
2	6'0"	NA	PLAIN
2	3'2"	2'0"	CORNER
2	6'X6'	NA	225° REV CORNER

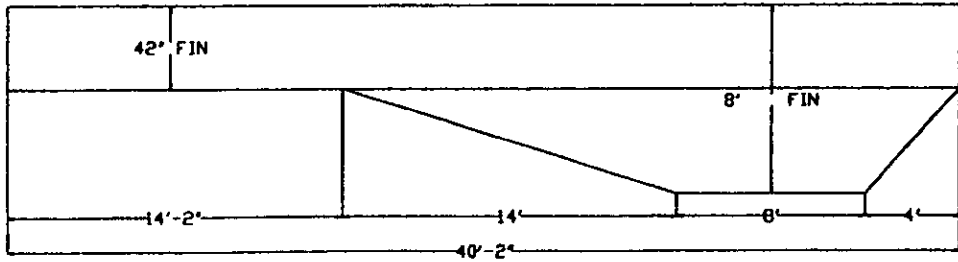

6	-	NA	45° OUTSIDE CORNER
8	-	NA	A-FRAME
1	-	NA	N&B PKG
			SA: 779 sq.ft.
			PER: 116'4"
2040COZC			DATE: 13-11-00

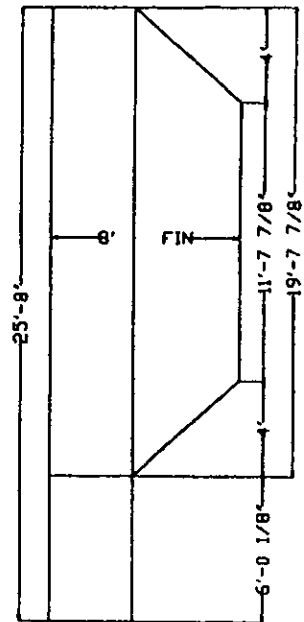
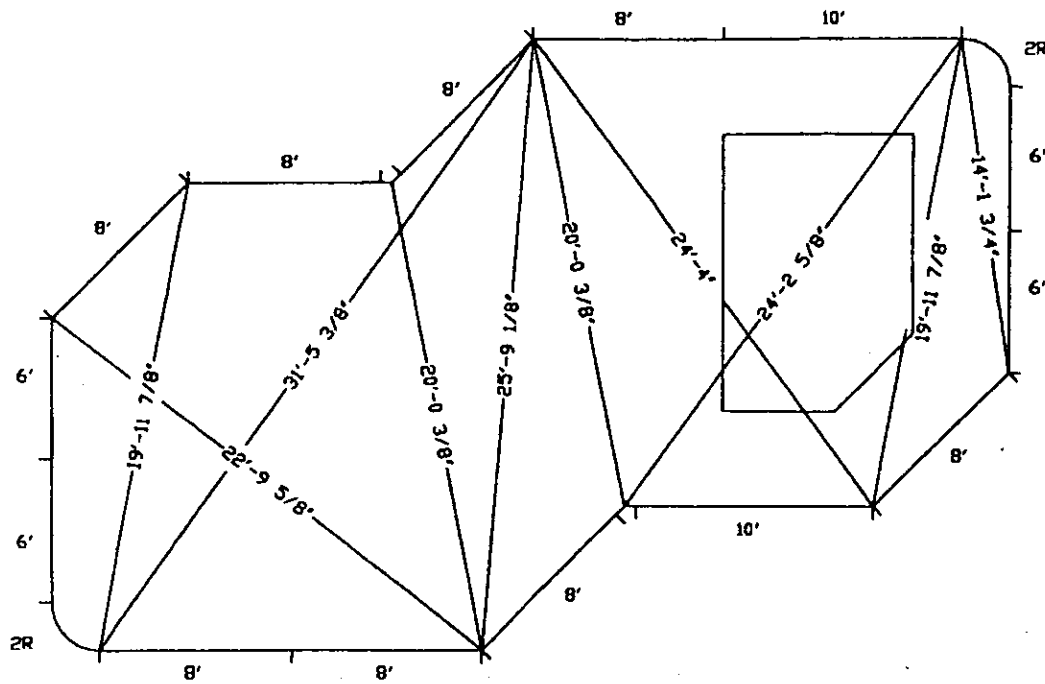

24 BAKER ST. P.O. BOX 100 HASTINGS ON KCL - 1Y0
705-696-2385 1-800-465-3433 FAX 705-696-1922

20' X 40' L.H. COZUMEL

QTY.	LENGTH	RADIUS	TYPE
1	10'0"	NA	PLAIN
1	10'0"	NA	SKIMMER
8	8'0"	NA	PLAIN
2	6'0"	NA	RETURN
2	6'0"	NA	PLAIN
2	3'2"	2'0"	CORNER
2	6'X6'	NA	225' REV CORNER
6	-	NA	45' OUTSIDE CORNER
8	-	NA	A-FRAME
1	-	NA	N&B PKG
			S.A. 779 sq.ft.
			PER. 116'4"
2040CDZC			DATE: 13-11-00

