

TOWN OF HEMPSTEAD
 DEPARTMENT OF ENGINEERING
 NASSAU COUNTY, NEW YORK

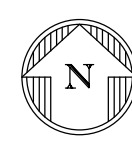

CONTRACT DRAWINGS FOR
SHORELINE STABILIZATION
BALDWIN HARBOR PARK
BALDWIN, N.Y.
 FEBRUARY 2020



NASSAU COUNTY FILE NO.

NASSAU COUNTY APPROVALS

WARNING - It is a violation of the Education Law for any person, unless acting under the direction of a licensed professional engineer, to alter any item on these plans in any way.

P.W. #

New York Rising Community
 Reconstruction Program



GOSR
 Governor's Office of Storm Recovery

APPROVED BY

DOUGLAS L. TUMAN, P.E., ESQ.
 COMMISSIONER OF ENGINEERING

DATE

FRANK ZANGLA
 COMMISSIONER OF PARKS & RECREATION

DATE

SUBMITTED FOR APPROVAL BY

JEFFREY M. TIERNEY
 DEPUTY COMMISSIONER OF ENGINEERING

DATE

SCALE: 1" = 800'

LOCATION PLAN

SHADED AREA INDICATES CONTRACT LIMITS

BASE MAP LEGEND		BASE MAP LEGEND		DRAWING INDEX																																																																																																																															
<p>MANHOLES</p> <p>STORM DRAIN </p> <p>ELECTRIC </p> <p>GAS </p> <p>SANITARY SEWER </p> <p>SANITARY SEWER CLEANOUT </p> <p>TRAFFIC </p> <p>TELEPHONE </p> <p>UNKNOWN </p> <p>WATER </p> <p>CATCH BASIN INLETS</p> <p>COMB. CURB INLET & GRATE </p> <p>CURB INLET </p> <p>DOUBLE CURB INLET </p> <p>FLUSH GRATE </p> <p>ROUND GRATE </p> <p>UTILITIES</p> <p>STORM DRAINAGE PIPE </p> <p>ELECTRIC </p> <p>GAS MAIN </p> <p>SANITARY SEWER PIPE </p> <p>TELEPHONE </p> <p>TRAFFIC </p> <p>WATER </p> <p>UTILITY PAINT</p> <p>ELECTRIC </p> <p>ELECTRIC OFFSET </p> <p>GAS </p> <p>GAS OFFSET </p> <p>GAS SERVICE </p> <p>SEWER HOUSE CONNECTION </p> <p>TELEPHONE </p> <p>TELEPHONE OFFSET </p> <p>WATER </p> <p>WATER SERVICE </p> <p>WATER OFFSET </p> <p>UTILITY HARDWARE</p> <p>ELECTRIC VAULT </p> <p>GAS MAIN VALVE </p> <p>GAS SERVICE VALVE </p> <p>GAS VENT </p> <p>HYDRANT </p> <p>HYDRANT VALVE </p> <p>OIL FILLER VALVE </p> <p>SANITARY SEWER VENT </p> <p>TRAFFIC DETECTOR </p> <p>TRAFFIC LOOP </p> <p>UNIDENTIFIED VAULT </p> <p>UNKNOWN VALVE </p> <p>WATER MAIN VALVE </p> <p>WATER METER </p> <p>WATER SERVICE VALVE </p> <p>UTILITY POLES</p> <p>METAL POLE WITH LIGHT </p> <p>METAL POLE WITH TRAFFIC </p> <p>PEDESTRIAN STANCHION </p> <p>WOODEN UTILITY POLE </p> <p>WOODEN UTILITY POLE WITH LIGHT </p> <p>VEGETATION</p> <p>BUSH </p> <p>4' HIGH HEDGE </p> <p>15" DIA. DECIDUOUS TREE </p> <p>EVERGREEN </p> <p>GUARD RAIL </p> <p>METAL FENCE </p> <p>RETAINING WALL </p> <p>WOODEN FENC </p> <p>VINYL FENCE </p>		<p>MISCELLANEOUS</p> <p>BASELINE & STATION </p> <p>BASKETBALL BACKBOARD POST </p> <p>CELLAR DOOR </p> <p>COLUMN </p> <p>CURB </p> <p>CURB & GUTTER </p> <p>EDGE OF PAVEMENT </p> <p>FIRST FLOOR ENTRANCE </p> <p>FLAGPOLE </p> <p>GARAGE ENTRANCE </p> <p>GUARDOPOST </p> <p>GUYWIRE & ANCHOR </p> <p>HANDICAP RAMP </p> <p>LOT LINE </p> <p>MAILBOX </p> <p>MONUMENT </p> <p>PARKING METER </p> <p>POLICE BOX </p> <p>PROPERTY LINE </p> <p>ROOF DRAIN </p> <p>ROADWAY CENTERLINE </p> <p>SIGN - SINGLE POST </p> <p>SIGN - DOUBLE POST </p> <p>TELEPHONE BOOTH </p> <p>TEST HOLE </p>		<table border="1"> <thead> <tr> <th>SHEET NUMBER</th> <th>SHEET TITLE</th> </tr> </thead> <tbody> <tr> <td>1</td> <td>TITLE SHEET</td> </tr> <tr> <td>2</td> <td>LEGENDS, ABBREVIATIONS, NOTES, AND DRAWING INDEX DIAGRAM</td> </tr> <tr> <td>3</td> <td>EXISTING CONDITIONS - NORTHERN PORTION</td> </tr> <tr> <td>4</td> <td>EXISTING CONDITIONS- SOUTHERN PORTION</td> </tr> <tr> <td>5</td> <td>CONSTRUCTION PLAN - NORTHERN PORTION</td> </tr> <tr> <td>6</td> <td>CONSTRUCTION PLAN - SOUTHERN PORTION</td> </tr> <tr> <td>7</td> <td>LIVING SHORELINE DETAIL</td> </tr> <tr> <td>8</td> <td>GABION TERMINATION AND KAYAK LAUNCH DETAIL</td> </tr> <tr> <td>9</td> <td>BULKHEAD DETAIL</td> </tr> <tr> <td>10</td> <td>DETAILS</td> </tr> </tbody> </table>		SHEET NUMBER	SHEET TITLE	1	TITLE SHEET	2	LEGENDS, ABBREVIATIONS, NOTES, AND DRAWING INDEX DIAGRAM	3	EXISTING CONDITIONS - NORTHERN PORTION	4	EXISTING CONDITIONS- SOUTHERN PORTION	5	CONSTRUCTION PLAN - NORTHERN PORTION	6	CONSTRUCTION PLAN - SOUTHERN PORTION	7	LIVING SHORELINE DETAIL	8	GABION TERMINATION AND KAYAK LAUNCH DETAIL	9	BULKHEAD DETAIL	10	DETAILS																																																																																																								
SHEET NUMBER	SHEET TITLE																																																																																																																																		
1	TITLE SHEET																																																																																																																																		
2	LEGENDS, ABBREVIATIONS, NOTES, AND DRAWING INDEX DIAGRAM																																																																																																																																		
3	EXISTING CONDITIONS - NORTHERN PORTION																																																																																																																																		
4	EXISTING CONDITIONS- SOUTHERN PORTION																																																																																																																																		
5	CONSTRUCTION PLAN - NORTHERN PORTION																																																																																																																																		
6	CONSTRUCTION PLAN - SOUTHERN PORTION																																																																																																																																		
7	LIVING SHORELINE DETAIL																																																																																																																																		
8	GABION TERMINATION AND KAYAK LAUNCH DETAIL																																																																																																																																		
9	BULKHEAD DETAIL																																																																																																																																		
10	DETAILS																																																																																																																																		
		<p>ABBREVIATIONS</p> <table border="0"> <tr> <td>ABAND.</td> <td>ABANDONED</td> </tr> <tr> <td>ALUM</td> <td>ALUMINUM</td> </tr> <tr> <td>A.O.B.E.</td> <td>AS ORDERED BY ENGINEER</td> </tr> <tr> <td>APT.</td> <td>APARTMENT</td> </tr> <tr> <td>ASPH.</td> <td>ASPHALT</td> </tr> <tr> <td>BOP</td> <td>BEGINNING OF PROFILE</td> </tr> <tr> <td>B. BLK</td> <td>BELGIAN BLOCK</td> </tr> <tr> <td>B.C.</td> <td>BOTTOM OF CURB</td> </tr> <tr> <td>B.T.</td> <td>BLACKTOP</td> </tr> <tr> <td>BIT</td> <td>BITUMINOUS</td> </tr> <tr> <td>BLK</td> <td>BLOCK</td> </tr> <tr> <td>B.M.</td> <td>BENCH MARK</td> </tr> <tr> <td>BRK</td> <td>BRICK</td> </tr> <tr> <td>B.W.</td> <td>BACK OF SIDEWALK</td> </tr> <tr> <td>CB</td> <td>CATCH BASIN</td> </tr> <tr> <td>CL</td> <td>CENTERLINE OF ROADWAY</td> </tr> <tr> <td>CONC.</td> <td>CONCRETE</td> </tr> <tr> <td>CH. L.K. FE.</td> <td>CHAIN LINK FENCE</td> </tr> <tr> <td>D.I.C.B.</td> <td>DOUBLE INLET CATCH BASIN</td> </tr> <tr> <td>DILAP.</td> <td>DILAPIDATED</td> </tr> <tr> <td>(E)</td> <td>EAST</td> </tr> <tr> <td>EL</td> <td>ELEVATION</td> </tr> <tr> <td>EOP</td> <td>EDGE OF PAVEMENT</td> </tr> <tr> <td>EXIST.</td> <td>EXISTING</td> </tr> <tr> <td>FF1.25</td> <td>FIRST FLOOR ELEVATION</td> </tr> <tr> <td>FR</td> <td>FRAME</td> </tr> <tr> <td>F.W.</td> <td>FRONT OF SIDEWALK</td> </tr> <tr> <td>G</td> <td>GUTTER</td> </tr> <tr> <td>GF18.30</td> <td>GARAGE FLOOR ELEVATION</td> </tr> <tr> <td>H.C.R.</td> <td>HANDICAP RAMP</td> </tr> <tr> <td>HP 5.90C</td> <td>HIGH POINT ELEVATION AT CURB</td> </tr> <tr> <td>H.D.P.E.</td> <td>HIGH DENSITY POLYETHYLENE PIPE</td> </tr> <tr> <td>INV. = 7.00</td> <td>INVERT ELEVATION</td> </tr> <tr> <td>L.</td> <td>LEFT</td> </tr> <tr> <td>L/C</td> <td>LEFT CURB</td> </tr> <tr> <td>MH</td> <td>MANHOLE</td> </tr> <tr> <td>MID C.L.</td> <td>MIDCENTERLINE OF ROADWAY</td> </tr> <tr> <td>(N)</td> <td>NORTH</td> </tr> <tr> <td>N.I.C.</td> <td>NOT IN CONTRACT</td> </tr> <tr> <td>PC</td> <td>POINT OF CURVATURE</td> </tr> <tr> <td>RAIL FE.</td> <td>POST AND RAIL FENCE</td> </tr> <tr> <td>*107</td> <td>RESIDENCE NO. 107</td> </tr> <tr> <td>RCP</td> <td>REINFORCED CONCRETE PIPE</td> </tr> <tr> <td>R.</td> <td>RIGHT</td> </tr> <tr> <td>R/C</td> <td>RIGHT CURB</td> </tr> <tr> <td>R=32.65</td> <td>RIM ELEVATION OF MANHOLE</td> </tr> <tr> <td>S.I.C.B.</td> <td>SINGLE INLET CATCH BASIN</td> </tr> <tr> <td>SSHCC</td> <td>SANITARY SEWER HOUSE CONNECTION</td> </tr> <tr> <td>SLT.</td> <td>SLATE</td> </tr> <tr> <td>(S)</td> <td>SOUTH</td> </tr> <tr> <td>STA</td> <td>STATION</td> </tr> <tr> <td>STOCK FE.</td> <td>STOCKADE FENCE</td> </tr> <tr> <td>STY</td> <td>STORY</td> </tr> <tr> <td>T.B.M.</td> <td>TEMPORARY BENCH MARK</td> </tr> <tr> <td>T.C.</td> <td>TOP OF CURB</td> </tr> <tr> <td>TH #3</td> <td>TEST HOLE</td> </tr> <tr> <td>THEO.</td> <td>THEORETICAL</td> </tr> <tr> <td>TTC</td> <td>THEORETICAL TOP OF CURB</td> </tr> <tr> <td>TYP.</td> <td>TYPICAL</td> </tr> <tr> <td>U.G.</td> <td>UNDERGROUND</td> </tr> <tr> <td>VAC.</td> <td>VACANT</td> </tr> <tr> <td>VP1</td> <td>VERTICAL POINT OF INTERSECTION</td> </tr> <tr> <td>(W)</td> <td>WEST</td> </tr> <tr> <td>WD</td> <td>WOOD</td> </tr> </table>		ABAND.	ABANDONED	ALUM	ALUMINUM	A.O.B.E.	AS ORDERED BY ENGINEER	APT.	APARTMENT	ASPH.	ASPHALT	BOP	BEGINNING OF PROFILE	B. BLK	BELGIAN BLOCK	B.C.	BOTTOM OF CURB	B.T.	BLACKTOP	BIT	BITUMINOUS	BLK	BLOCK	B.M.	BENCH MARK	BRK	BRICK	B.W.	BACK OF SIDEWALK	CB	CATCH BASIN	CL	CENTERLINE OF ROADWAY	CONC.	CONCRETE	CH. L.K. FE.	CHAIN LINK FENCE	D.I.C.B.	DOUBLE INLET CATCH BASIN	DILAP.	DILAPIDATED	(E)	EAST	EL	ELEVATION	EOP	EDGE OF PAVEMENT	EXIST.	EXISTING	FF1.25	FIRST FLOOR ELEVATION	FR	FRAME	F.W.	FRONT OF SIDEWALK	G	GUTTER	GF18.30	GARAGE FLOOR ELEVATION	H.C.R.	HANDICAP RAMP	HP 5.90C	HIGH POINT ELEVATION AT CURB	H.D.P.E.	HIGH DENSITY POLYETHYLENE PIPE	INV. = 7.00	INVERT ELEVATION	L.	LEFT	L/C	LEFT CURB	MH	MANHOLE	MID C.L.	MIDCENTERLINE OF ROADWAY	(N)	NORTH	N.I.C.	NOT IN CONTRACT	PC	POINT OF CURVATURE	RAIL FE.	POST AND RAIL FENCE	*107	RESIDENCE NO. 107	RCP	REINFORCED CONCRETE PIPE	R.	RIGHT	R/C	RIGHT CURB	R=32.65	RIM ELEVATION OF MANHOLE	S.I.C.B.	SINGLE INLET CATCH BASIN	SSHCC	SANITARY SEWER HOUSE CONNECTION	SLT.	SLATE	(S)	SOUTH	STA	STATION	STOCK FE.	STOCKADE FENCE	STY	STORY	T.B.M.	TEMPORARY BENCH MARK	T.C.	TOP OF CURB	TH #3	TEST HOLE	THEO.	THEORETICAL	TTC	THEORETICAL TOP OF CURB	TYP.	TYPICAL	U.G.	UNDERGROUND	VAC.	VACANT	VP1	VERTICAL POINT OF INTERSECTION	(W)	WEST	WD	WOOD
ABAND.	ABANDONED																																																																																																																																		
ALUM	ALUMINUM																																																																																																																																		
A.O.B.E.	AS ORDERED BY ENGINEER																																																																																																																																		
APT.	APARTMENT																																																																																																																																		
ASPH.	ASPHALT																																																																																																																																		
BOP	BEGINNING OF PROFILE																																																																																																																																		
B. BLK	BELGIAN BLOCK																																																																																																																																		
B.C.	BOTTOM OF CURB																																																																																																																																		
B.T.	BLACKTOP																																																																																																																																		
BIT	BITUMINOUS																																																																																																																																		
BLK	BLOCK																																																																																																																																		
B.M.	BENCH MARK																																																																																																																																		
BRK	BRICK																																																																																																																																		
B.W.	BACK OF SIDEWALK																																																																																																																																		
CB	CATCH BASIN																																																																																																																																		
CL	CENTERLINE OF ROADWAY																																																																																																																																		
CONC.	CONCRETE																																																																																																																																		
CH. L.K. FE.	CHAIN LINK FENCE																																																																																																																																		
D.I.C.B.	DOUBLE INLET CATCH BASIN																																																																																																																																		
DILAP.	DILAPIDATED																																																																																																																																		
(E)	EAST																																																																																																																																		
EL	ELEVATION																																																																																																																																		
EOP	EDGE OF PAVEMENT																																																																																																																																		
EXIST.	EXISTING																																																																																																																																		
FF1.25	FIRST FLOOR ELEVATION																																																																																																																																		
FR	FRAME																																																																																																																																		
F.W.	FRONT OF SIDEWALK																																																																																																																																		
G	GUTTER																																																																																																																																		
GF18.30	GARAGE FLOOR ELEVATION																																																																																																																																		
H.C.R.	HANDICAP RAMP																																																																																																																																		
HP 5.90C	HIGH POINT ELEVATION AT CURB																																																																																																																																		
H.D.P.E.	HIGH DENSITY POLYETHYLENE PIPE																																																																																																																																		
INV. = 7.00	INVERT ELEVATION																																																																																																																																		
L.	LEFT																																																																																																																																		
L/C	LEFT CURB																																																																																																																																		
MH	MANHOLE																																																																																																																																		
MID C.L.	MIDCENTERLINE OF ROADWAY																																																																																																																																		
(N)	NORTH																																																																																																																																		
N.I.C.	NOT IN CONTRACT																																																																																																																																		
PC	POINT OF CURVATURE																																																																																																																																		
RAIL FE.	POST AND RAIL FENCE																																																																																																																																		
*107	RESIDENCE NO. 107																																																																																																																																		
RCP	REINFORCED CONCRETE PIPE																																																																																																																																		
R.	RIGHT																																																																																																																																		
R/C	RIGHT CURB																																																																																																																																		
R=32.65	RIM ELEVATION OF MANHOLE																																																																																																																																		
S.I.C.B.	SINGLE INLET CATCH BASIN																																																																																																																																		
SSHCC	SANITARY SEWER HOUSE CONNECTION																																																																																																																																		
SLT.	SLATE																																																																																																																																		
(S)	SOUTH																																																																																																																																		
STA	STATION																																																																																																																																		
STOCK FE.	STOCKADE FENCE																																																																																																																																		
STY	STORY																																																																																																																																		
T.B.M.	TEMPORARY BENCH MARK																																																																																																																																		
T.C.	TOP OF CURB																																																																																																																																		
TH #3	TEST HOLE																																																																																																																																		
THEO.	THEORETICAL																																																																																																																																		
TTC	THEORETICAL TOP OF CURB																																																																																																																																		
TYP.	TYPICAL																																																																																																																																		
U.G.	UNDERGROUND																																																																																																																																		
VAC.	VACANT																																																																																																																																		
VP1	VERTICAL POINT OF INTERSECTION																																																																																																																																		
(W)	WEST																																																																																																																																		
WD	WOOD																																																																																																																																		

NO.	DATE	REVISIONS

In Charge:	D.L.T.
Compilation:	J.M.T.
Design:	J.M.T.
Drawn:	J.M.T./D.R.R.
Checked:	J.M.T.
Reviewed:	D.L.T.



Department of Engineering

LEGENDS, ABBREVIATIONS, NOTES AND DRAWING INDEX

SHORELINE STABILIZATION
BALDWIN HARBOR PARK
BALDWIN, N.Y.

Scale:	NONE
Date:	FEB. 2020
File No.:	
Dwg No.:	
Sheet No.:	2 of 10

OAKWOOD CANAL

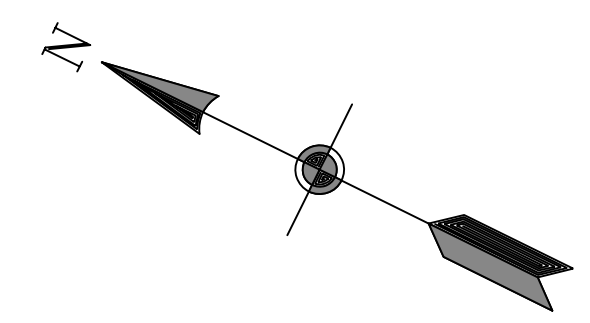
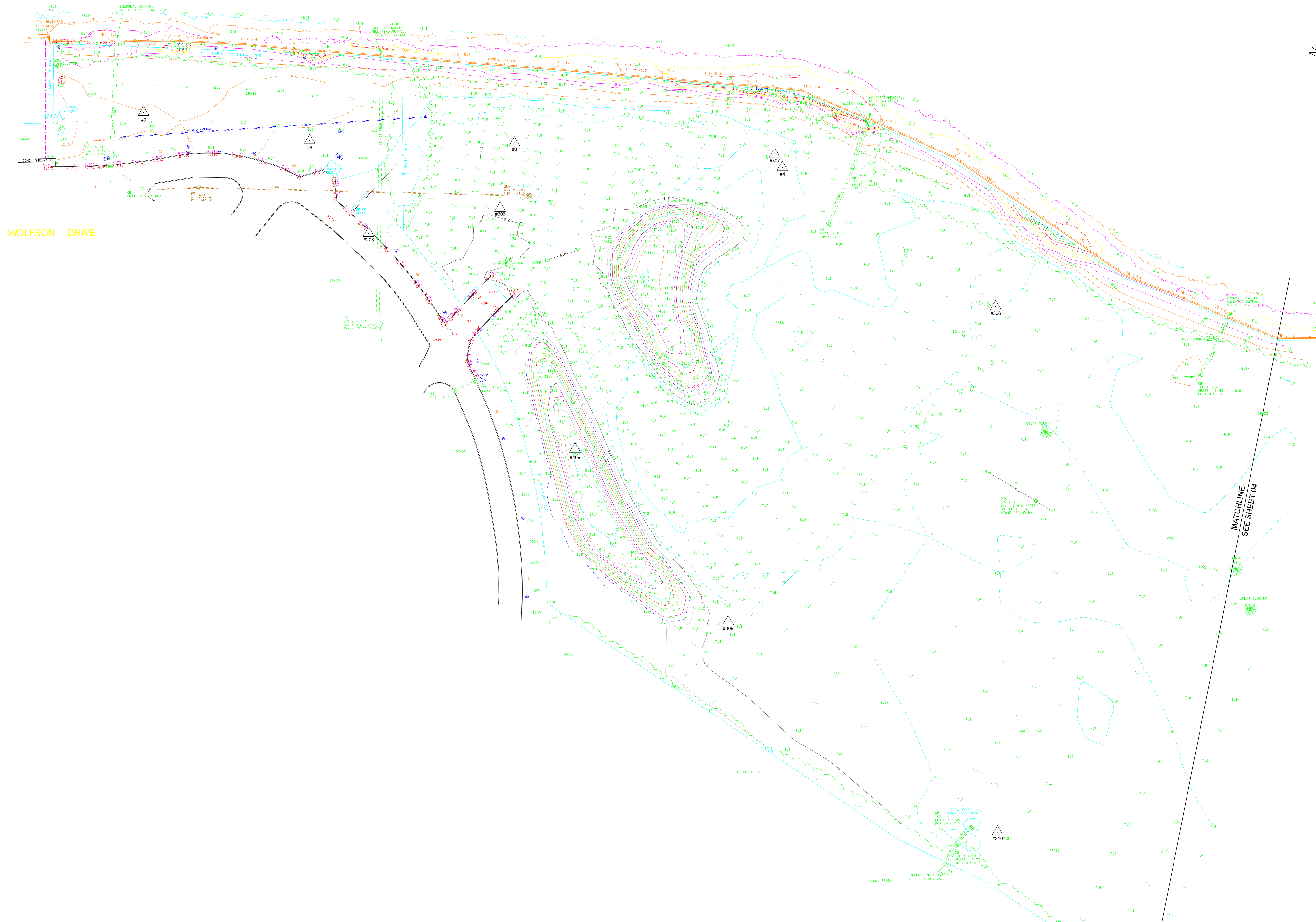

STAKE #	NORTHING	EASTING	ELEVATION
9	168473.34	1094376.95	6.21
8	168336.17	1094420.70	6.74
208	168256.25	1094372.18	7.02
3	168179.10	1094495.45	7.91
308	168165.37	1094440.56	8.66
409	168018.03	1094284.76	15.27
307	167976.24	1094584.67	8.22
4	167965.59	1094577.19	7.40
309	167836.53	1094210.36	8.01
306	167750.52	1094551.01	7.89
310	167552.27	1094150.91	7.71
305	167473.28	1094622.71	7.83
5	167404.97	1094612.63	6.82
311	167093.28	1094168.32	8.37
304	167185.09	1094615.06	7.19
303	167020.78	1094652.74	7.17
2	166980.31	1094654.99	7.12
302	166828.76	1094556.19	7.41
301	166712.75	1094567.35	7.57
6	166548.76	1094494.42	13.50
7	166546.79	1094411.48	7.33

MATCHLINE
SEE SHEET 04

NO.	DATE	REVISIONS

In Charge:	D.L.T.
Compilation:	J.M.T.
Design:	J.M.T.
Drawn:	J.M.T./D.R.R.
Checked:	J.M.T.
Reviewed:	D.L.T.

NOTES:
 1. EXISTING CONDITIONS SHOWN AS OF JANUARY 2018.
 2. UNDERGROUND UTILITIES SHOWN ARE BASED UPON LIMITED SCHEMATIC INFORMATION PROVIDED BY OTHERS. NOT ALL EXISTING UNDERGROUND UTILITY BRANCHES AND SERVICES ARE SHOWN. PRIVATE UTILITIES, IF EXISTING, ARE NOT SHOWN OR INDICATED.
 3. HORIZONTAL AND VERTICAL CONTROL INDICATED IS IN NASSAU COUNTY DATUM. HORIZONTAL CONTROL INDICATED IS NAD83 (1996) US SURVEY FEET. VERTICAL CONTROL INDICATED IS NAVD (1988) FEET.

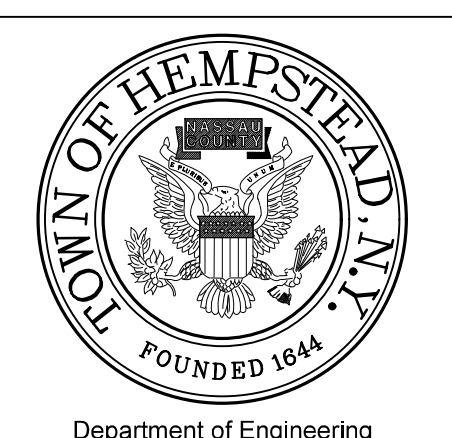

Department of Engineering

EXISTING CONDITIONS
NORTHERN PORTION

SHORELINE STABILIZATION
BALDWIN HARBOR PARK
BALDWIN, N.Y.

Scale: 1" = 40'
 Date: FEB. 2020
 File No.:
 Dwg No.:
 Sheet No.: 3 of 10

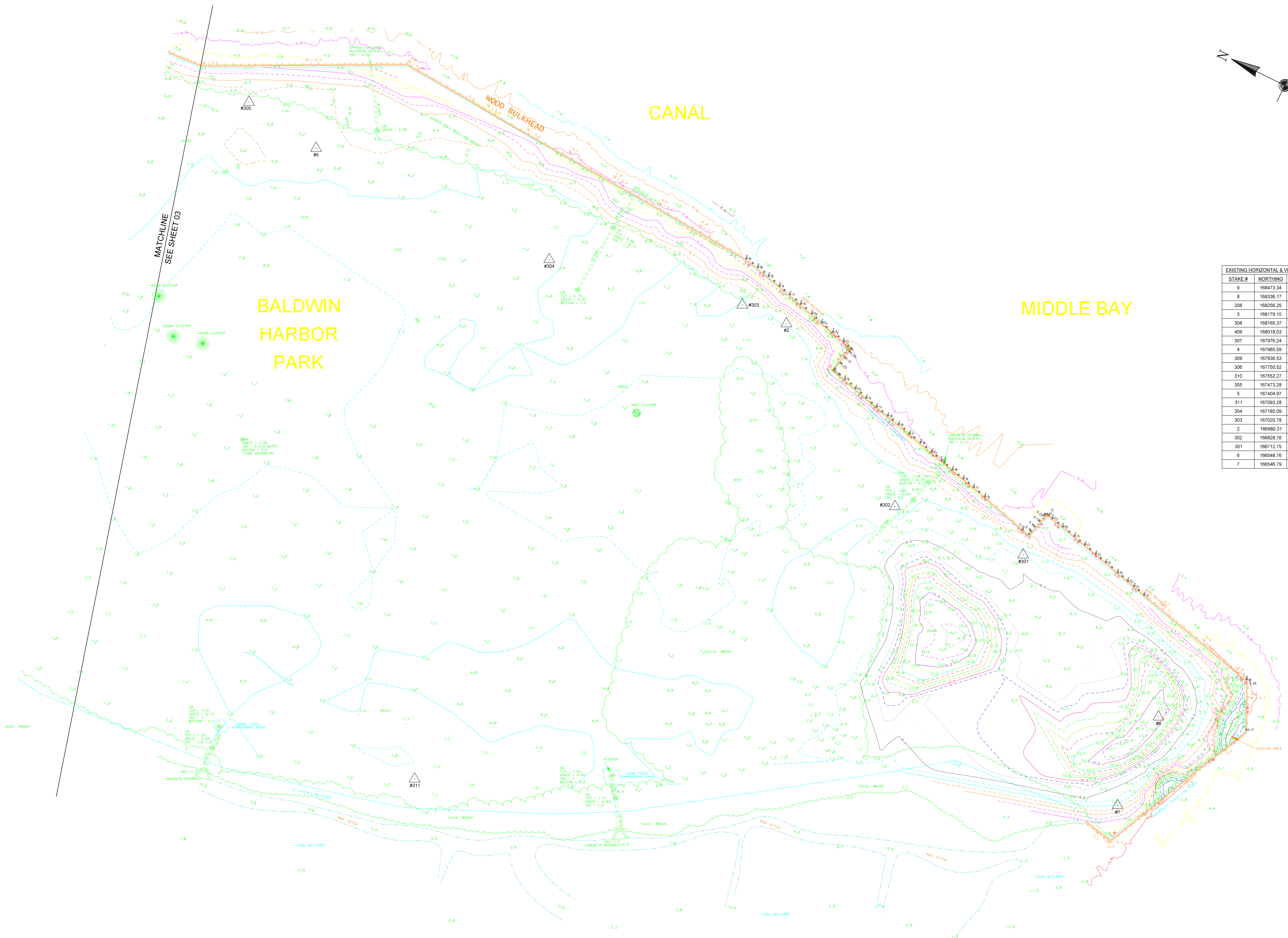
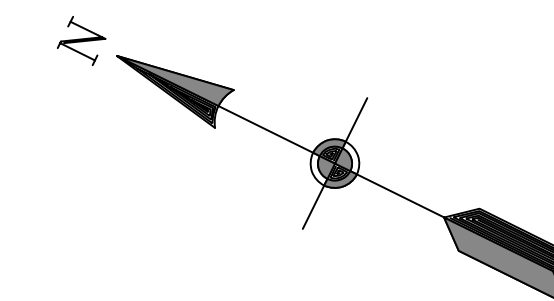

EXISTING HORIZONTAL & VERTICAL CONTROL CHART			
STAKE #	NORTHING	EASTING	ELEVATION
9	188473.34	1084379.95	6.21
8	188336.17	1084420.70	6.74
208	188256.25	1084372.18	7.02
3	188179.10	1084456.45	7.91
308	188165.37	1084440.56	8.66
409	188018.03	1084284.76	15.27
307	187976.24	1084584.67	8.22
4	187965.59	1084577.19	7.40
309	187836.53	1084210.36	8.01
306	187750.52	1084551.01	7.89
310	187552.27	1084150.91	7.71
305	187473.28	1084622.71	7.83
5	187404.97	1084612.63	6.82
311	187093.28	1084168.32	8.37
304	187185.09	1084615.05	7.19
303	187020.78	1084652.74	7.12
2	186980.31	1084654.99	7.12
302	186828.76	1084556.19	7.41
301	186712.75	1084567.35	7.57
6	186548.76	1084494.42	13.50
7	186548.79	1084411.48	7.33

In Charge:	D.L.T.	
Compilation:	J.M.T.	
Design:	J.M.T.	
Drawn:	J.M.T./D.R.R.	
Checked:	J.M.T.	
Reviewed:	D.L.T.	
NO.	DATE	REVISIONS

NOTES:
 1. EXISTING CONDITIONS SHOWN AS OF JANUARY 2018.
 2. UNDERGROUND UTILITIES SHOWN ARE BASED UPON LIMITED SCHEMATIC INFORMATION PROVIDED BY OTHERS. NOT ALL EXISTING UNDERGROUND UTILITY BRANCHES AND SERVICES ARE SHOWN. PRIVATE UTILITIES, IF EXISTING, ARE NOT SHOWN OR INDICATED.
 3. HORIZONTAL AND VERTICAL CONTROL INDICATED IS IN NASSAU COUNTY DATUM. HORIZONTAL CONTROL INDICATED IS NAD83 (1996) US SURVEY FEET. VERTICAL CONTROL INDICATED IS NAVD (1988) FEET.



Department of Engineering

EXISTING CONDITIONS
SOUTHERN PORTION

SHORELINE STABILIZATION
BALDWIN HARBOR PARK
BALDWIN, N.Y.

Scale: 1" = 40'
 Date: FEB. 2020
 File No.:
 Dwg No.:
 Sheet No.: 4 of 10

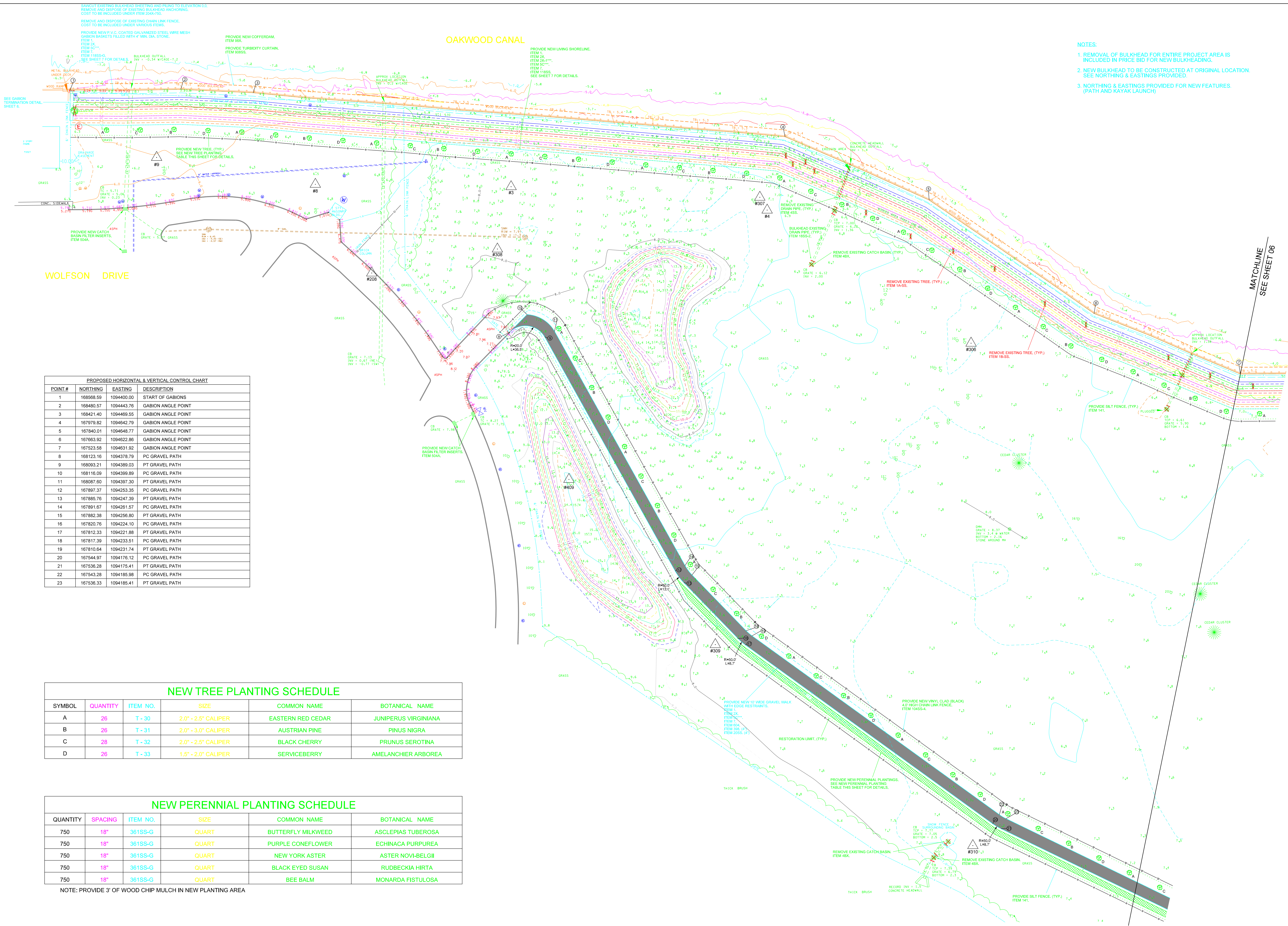

- NOTES:**
1. REMOVAL OF BULKHEAD FOR ENTIRE PROJECT AREA IS INCLUDED IN PRICE BID FOR NEW BULKHEADING.
 2. NEW BULKHEAD TO BE CONSTRUCTED AT ORIGINAL LOCATION. SEE NORTHING & EASTINGS PROVIDED.
 3. NORTHING & EASTINGS PROVIDED FOR NEW FEATURES. (PATH AND KAYAK LAUNCH)

PROPOSED HORIZONTAL & VERTICAL CONTROL CHART

POINT #	NORTHING	EASTING	DESCRIPTION
1	188568.59	1094400.00	START OF GABIONS
2	188480.57	1094443.76	GABION ANGLE POINT
3	188421.40	1094469.55	GABION ANGLE POINT
4	187979.82	1094842.79	GABION ANGLE POINT
5	187840.01	1094848.77	GABION ANGLE POINT
6	187663.92	1094822.86	GABION ANGLE POINT
7	187523.58	1094831.92	GABION ANGLE POINT
8	188123.16	1094378.79	PC GRAVEL PATH
9	188093.21	1094389.03	PT GRAVEL PATH
10	188116.09	1094399.89	PC GRAVEL PATH
11	188087.60	1094397.30	PT GRAVEL PATH
12	187897.37	1094253.35	PC GRAVEL PATH
13	187885.76	1094247.39	PT GRAVEL PATH
14	187891.67	1094261.57	PC GRAVEL PATH
15	187882.38	1094266.80	PT GRAVEL PATH
16	187820.76	1094224.10	PC GRAVEL PATH
17	187812.33	109421.88	PT GRAVEL PATH
18	187817.39	1094233.51	PC GRAVEL PATH
19	187810.64	1094231.74	PT GRAVEL PATH
20	187544.97	1094176.12	PC GRAVEL PATH
21	187536.28	1094175.41	PT GRAVEL PATH
22	187543.28	1094185.98	PC GRAVEL PATH
23	187536.33	1094185.41	PT GRAVEL PATH

NEW TREE PLANTING SCHEDULE

SYMBOL	QUANTITY	ITEM NO.	SIZE	COMMON NAME	BOTANICAL NAME
A	26	T - 30	2.0" - 2.5" CALIPER	EASTERN RED CEDAR	JUNIPERUS VIRGINIANA
B	26	T - 31	2.0" - 3.0" CALIPER	AUSTRIAN PINE	PINUS NIGRA
C	26	T - 32	2.0" - 2.5" CALIPER	BLACK CHERRY	PRUNUS SEROTINA
D	26	T - 33	1.5" - 2.0" CALIPER	SERVICEBERRY	AMELANCHIER ARBOREA

NEW PERENNIAL PLANTING SCHEDULE

QUANTITY	SPACING	ITEM NO.	SIZE	COMMON NAME	BOTANICAL NAME
750	18"	361SS-G	QUART	BUTTERFLY MILKWEED	ASCLEPIAS TUBEROSA
750	18"	361SS-G	QUART	PURPLE CONEFLOWER	ECHINACA PURPUREA
750	18"	361SS-G	QUART	NEW YORK ASTER	ASTER NOVI-BELGII
750	18"	361SS-G	QUART	BLACK EYED SUSAN	RUDBECKIA HIRTA
750	18"	361SS-G	QUART	BEE BALM	MONARDA FISTULOSA

NOTE: PROVIDE 3" OF WOOD CHIP MULCH IN NEW PLANTING AREA

In Charge:	D.L.T.
Compilation:	J.M.T.
Design:	J.M.T.
Drawn:	J.M.T./D.R.R.
Checked:	J.M.T.
Reviewed:	D.L.T.

NOTES:

1. EXISTING CONDITIONS SHOWN AS OF JANUARY 2018.
2. UNDERGROUND UTILITIES SHOWN ARE BASED UPON LIMITED SCHEMATIC INFORMATION PROVIDED BY OTHERS. NOT ALL EXISTING UNDERGROUND UTILITY BRANCHES AND SERVICES ARE SHOWN. PRIVATE UTILITIES, IF EXISTING, ARE NOT SHOWN OR INDICATED.
3. HORIZONTAL AND VERTICAL CONTROL INDICATED IS IN NASSAU COUNTY DATUM. HORIZONTAL CONTROL INDICATED IS NAD83 (1996) US SURVEY FEET. VERTICAL CONTROL INDICATED IS NAVD (1988) FEET.

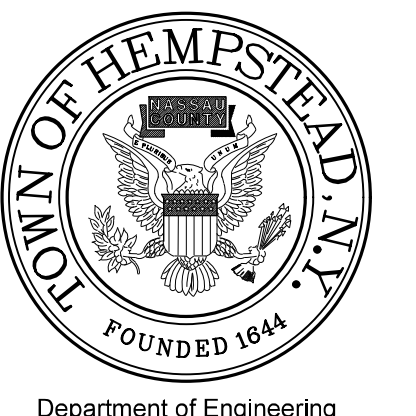

Department of Engineering

**CONSTRUCTION PLAN
NORTHERN PORTION**

**SHORELINE STABILIZATION
BALDWIN HARBOR PARK
BALDWIN, N.Y.**

Scale:	1" = 40'
Date:	FEB. 2020
File No.:	
Dwg No.:	
Sheet No.:	5 of 10

NO.	DATE	REVISIONS

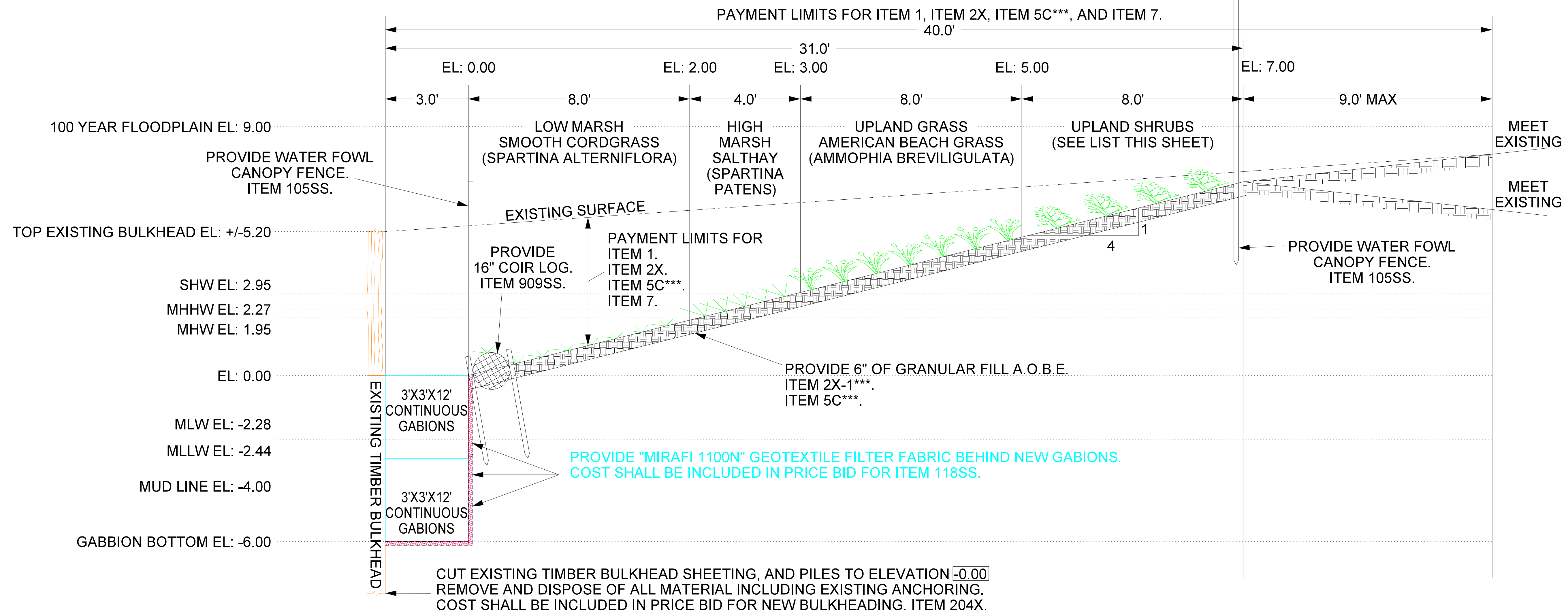

PLANTING SPECIFICATIONS

LOW MARSH:

Smooth Cordgrass (*Spartina Alteriflora*)
All plants to be Nursery Grown in 2" Peat pots, planted on 18" centers. Stagger rows.

HIGH MARSH:

Saltmeadow Cordgrass (*Spartina Patens*)
All plants to be Nursery Grown in 2" Peat pots, planted on 18" centers. Stagger rows.

UPLAND GRASS:

American Beachgrass (*Ammonphila Breviligulata*)
Install on 18" centers. 3 culms/planting unit. Stagger rows.
Fertilize in early spring. 30lbs inorganic nitrogen/acre.

UPLAND SHRUBS:

Bayberry (*Myrica Pennsylvanica*)
Beach Plum (*Prunus Maritima*)
Groudsel Tree (*Baccharis Hamlimifolia*)
All plants to be Nursery Grown, 2 Gallon Minimum. Install on 6' centers.
Fertilize with 1 tablespoon of Osmocote 18-6-12 per planting hole.

NOTE:

Smooth Cordgrass plantings to be installed prior to Saltmeadow Cordgrass plantings to prevent disturbance.
Saltmeadow Cordgrass plantings to be installed prior to upland plantings to prevent disturbance.
All plant installation and seeding to occur between March 15 and May 15 or September 15 to October 15.

In Charge:	D.L.T.	
Compilation:	J.M.T.	
Design:	J.M.T.	
Drawn:	J.M.T./D.R.R.	
Checked:	J.M.T.	
Reviewed:	D.L.T.	
NO.	DATE	REVISIONS

NOTE:
HORIZONTAL AND VERTICAL CONTROL INDICATED IS IN NASSAU COUNTY DATUM.
HORIZONTAL CONTROL INDICATED IS NAD83 (1998) US SURVEY FEET.
VERTICAL CONTROL INDICATED IS NAVD (1988) US SURVEY FEET.



Department of Engineering

LIVING SHORELINE DETAILS

SHORELINE STABILIZATION
BALDWIN HARBOR PARK
BALDWIN, N.Y.

Scale: NONE
Date: FEB. 2020
File No.:
Dwg No.:
Sheet No.: 7 of 10

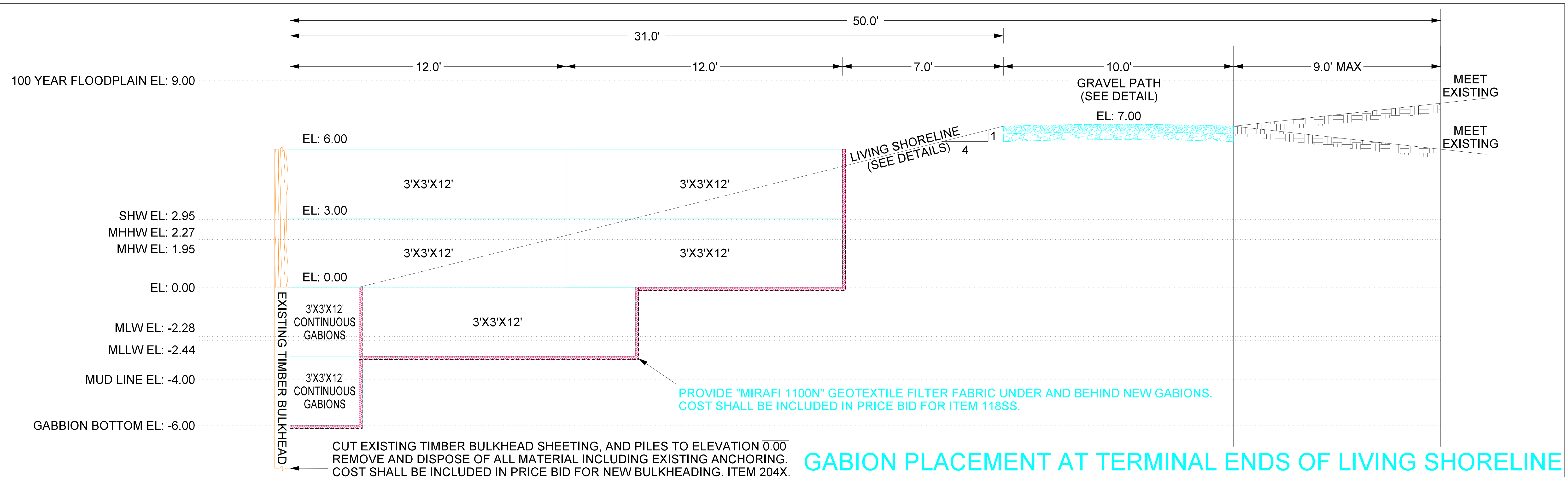

GABION PLACEMENT AT TERMINAL ENDS OF LIVING SHORELINE

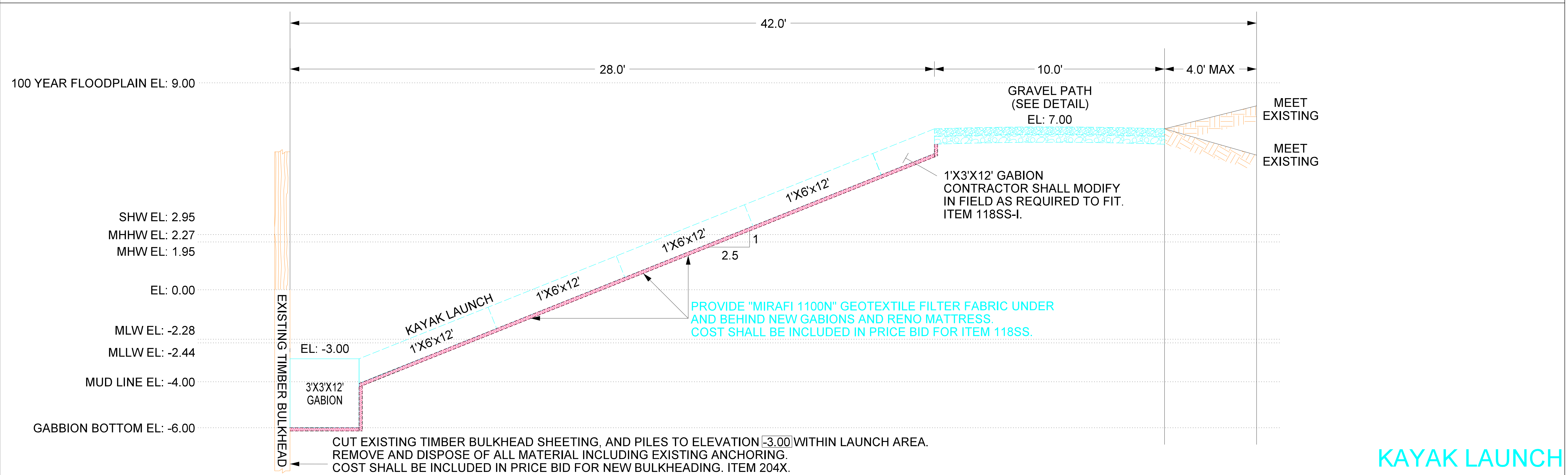

KAYAK LAUNCH

In Charge:	D.L.T.
Compilation:	J.M.T.
Design:	J.M.T.
Drawn:	J.M.T./D.R.R.
Checked:	J.M.T.
Reviewed:	D.L.T.

NO.	DATE	REVISIONS

NOTE:
 HORIZONTAL AND VERTICAL CONTROL INDICATED IS IN NASSAU COUNTY DATUM.
 HORIZONTAL CONTROL INDICATED IS NAD83 (1998) US SURVEY FEET.
 VERTICAL CONTROL INDICATED IS NAVD (1988) US SURVEY FEET.

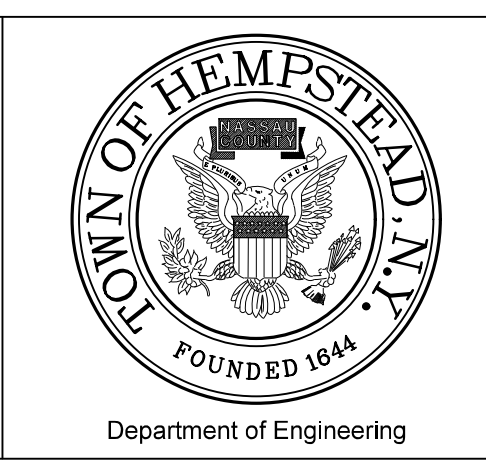

Department of Engineering

GABION TERMINATION AND
 KAYAK LAUNCH DETAIL

SHORELINE STABILIZATION
 BALDWIN HARBOR PARK
 BALDWIN, N.Y.

Scale: NONE
 Date: FEB. 2020
 File No.:
 Dwg No.:
 Sheet No.: 8 of 10

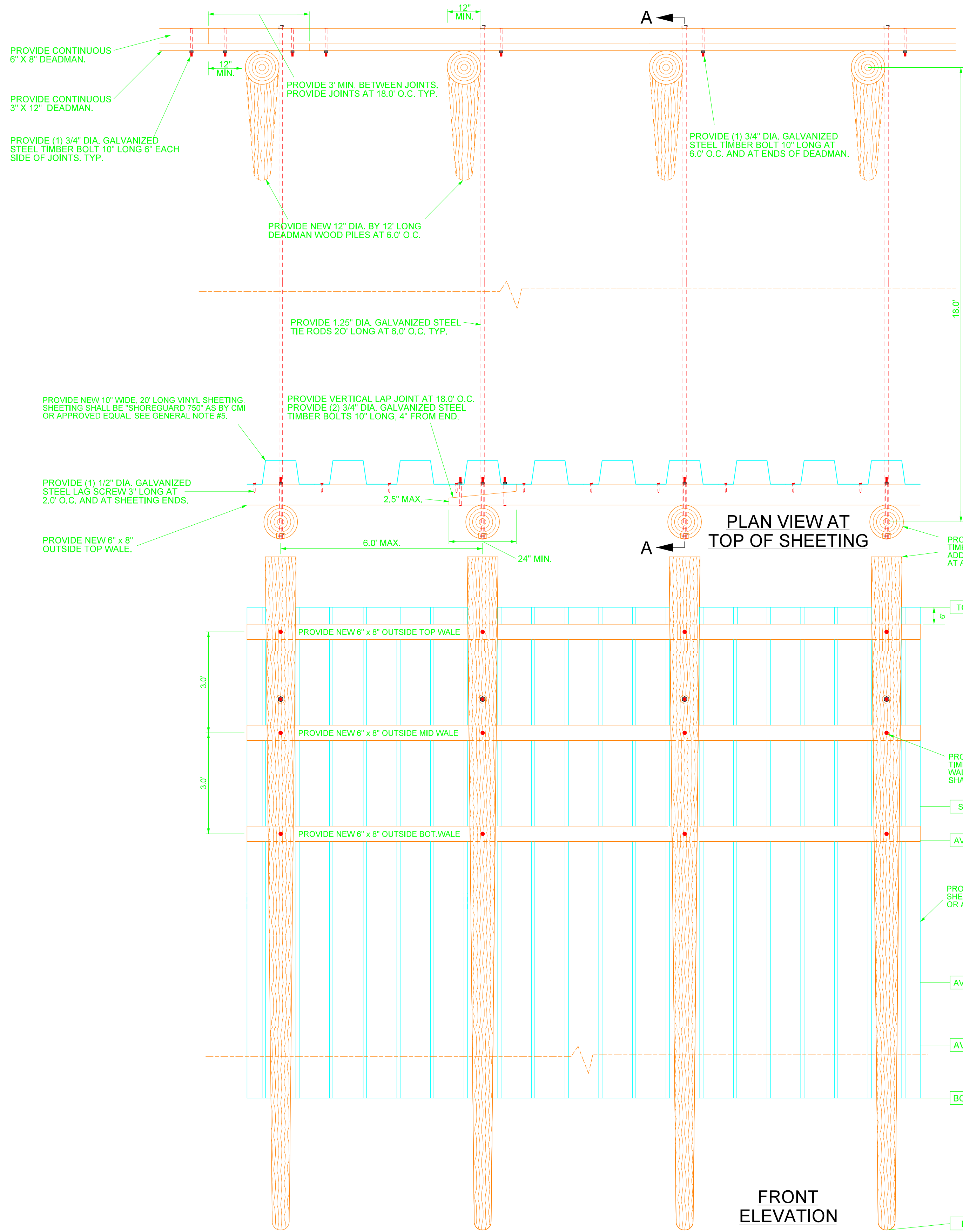

ITEM 204X GENERAL NOTES:

1. ALL LUMBER AND TIMBER SIZES INDICATED ARE NOMINAL. ALL DIMENSIONS INDICATED ARE FINISHED.
2. ALL LUMBER AND TIMBER SHALL BE CCA AND PRESSURE TREATED TO OBTAIN A MINIMUM RETENTION OF 2.5 LBS/CF.
3. NEW RETURNS AND CONNECTIONS TO EXISTING BULKHEADS AT LIMITS OF NEW BULKHEAD SHALL BE DETERMINED IN FIELD A.O.B.E.
4. EXISTING BULKHEADS AND EXISTING BULKHEAD ANCHORING COMPONENTS SHALL BE COMPLETELY REMOVED AND DISPOSED OF BY THE CONTRACTOR. THE COST SHALL BE INCLUDED IN THE PRICE BID FOR ITEM 204X.
5. SEE PLANS FOR NEW TOP OF SHEETING ELEVATIONS, NEW SHEETING LENGTHS AND NEW PILE LENGTHS.
6. ALL TIMBER AND CARRIAGE BOLTS SHALL BE PROVIDED WITH ONE N.Y.D.D. WASHER AND NUT AT EACH END.
7. ALL LAG SCREWS SHALL BE PROVIDED WITH ONE N.Y.D.D. WASHER AT HEAD END.
8. ALL TIE RODS SHALL BE PROVIDED WITH TWO N.Y.D.D. WASHERS AND NUTS AT EACH END.
9. ALL BOLTS AND TIE RODS SHALL BE CUT FLUSH AT NUT END WHERE SHOWN AND WHERE NECESSARY TO INSTALL NEW BULKHEAD COMPONENTS.
10. ALL TIE RODS SHALL BE CUT FLUSH AT FRONT OF PILES. NUTS AND WASHERS SHALL BE COUNTERSUNK.
11. ALL HARDWARE AND FASTENERS SHALL BE GALVANIZED STEEL UNLESS OTHERWISE SHOWN AND MEET N.C.D.P.W SPECIFICATIONS.
12. ALL OPENINGS IN NEW SHEETING FOR TIE RODS SHALL BE LIMITED IN SIZE AS FOLLOWS: THRU WALL DIMENSION PLUS ONE INCH.

PLAN VIEW AT TOP OF SHEETING

FRONT ELEVATION

SECTION A-A



NOTE:
 HORIZONTAL AND VERTICAL CONTROL INDICATED IS IN NASSAU COUNTY DATUM.
 HORIZONTAL CONTROL INDICATED IS NAD83 (1996) US SURVEY FEET.
 VERTICAL CONTROL INDICATED IS NAVD (1988) US SURVEY FEET.

BULKHEAD DETAILS

**SHORELINE STABILIZATION
 BALDWIN HARBOR PARK
 BALDWIN, N.Y.**

Scale: **NONE**
 Date: **FEB. 2020**
 File No.: _____
 Dwg No.: _____
 Sheet No.: **9** of **10**

In Charge:	D.L.T.	
Compilation:	J.M.T.	
Design:	J.M.T.	
Drawn:	J.M.T./D.R.R.	
Checked:	J.M.T.	
Reviewed:	D.L.T.	
NO.	DATE	REVISIONS

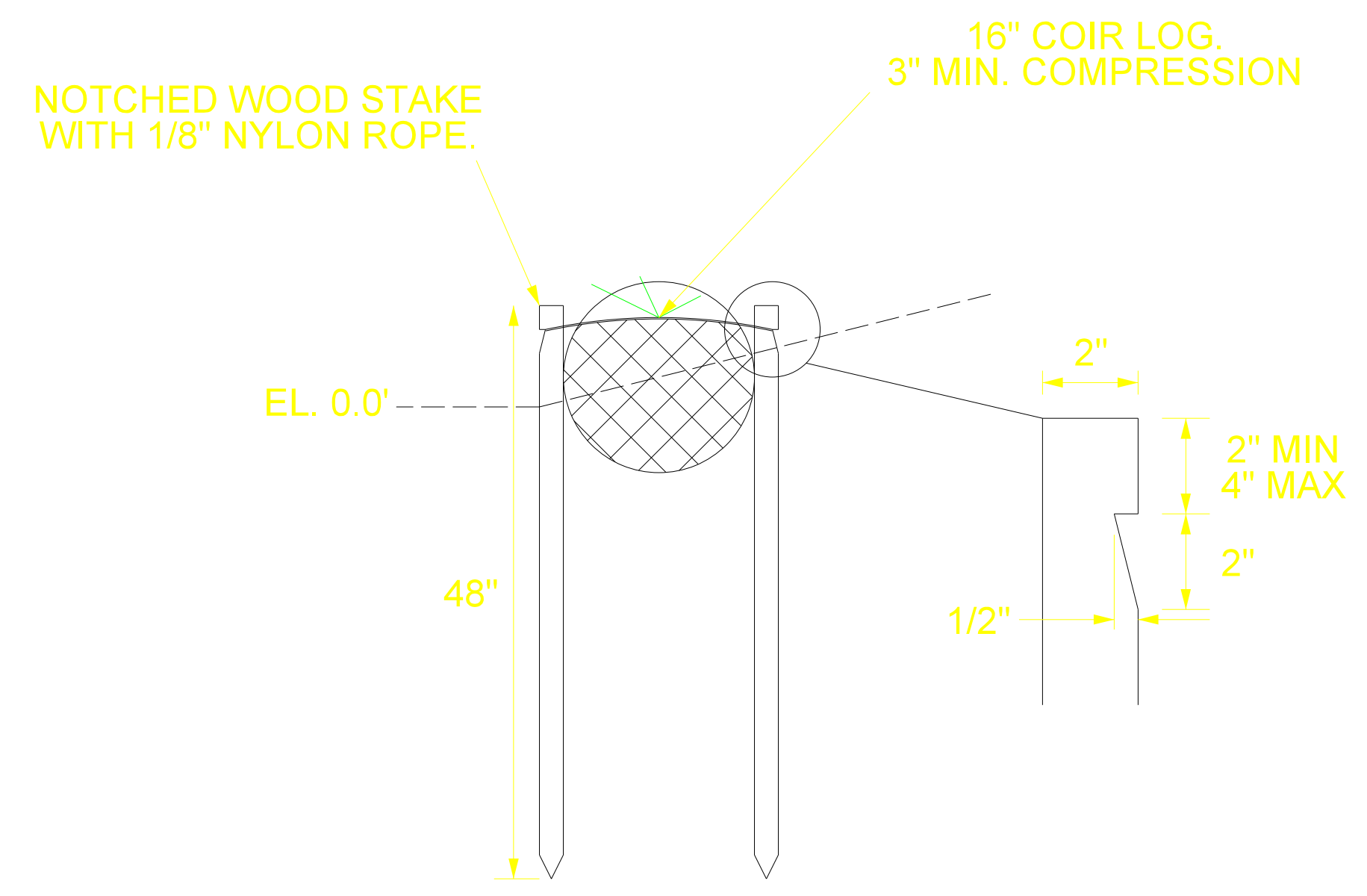

COIR LOG DETAIL
ITEM 909SS
NOT TO SCALE

DETAIL OF NEW BULKHEAD FOR STORM DRAINAGE PIPE

ITEM 18SS-2
NOT TO SCALE

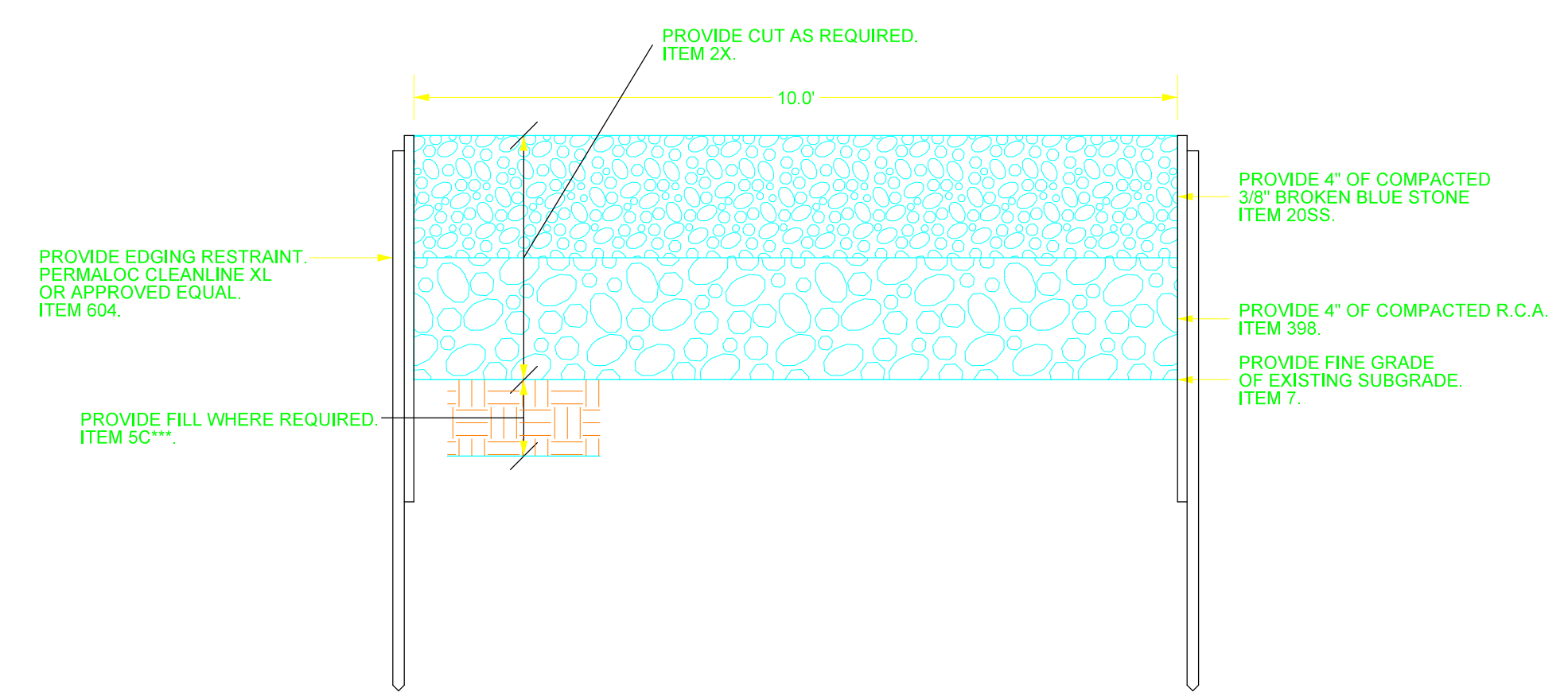

GRAVEL PATH DETAIL
NOT TO SCALE

UTILITY CONTACTS		
UTILITY	TEL. #	CONTACT
NATIONAL GRID	631-755-3460	STEVEN CHAU
PSEG-LI	516-645-6218	YAT MAR
TOWN OF HEMPSTEAD STREET LIGHTING	516-378-2260	JOHN BONNER
COUNTY OF NASSAU DIVISION OF PUBLIC WORKS	516-571-9485	DONALD HOHN
CABLEVISION	516-803-7352	PAUL CORRADO
VERIZON	631-206-7471	LOU MARTONE
NEW YORK AMERICAN WATER	516-406-2625	JOHN KILPATRICK

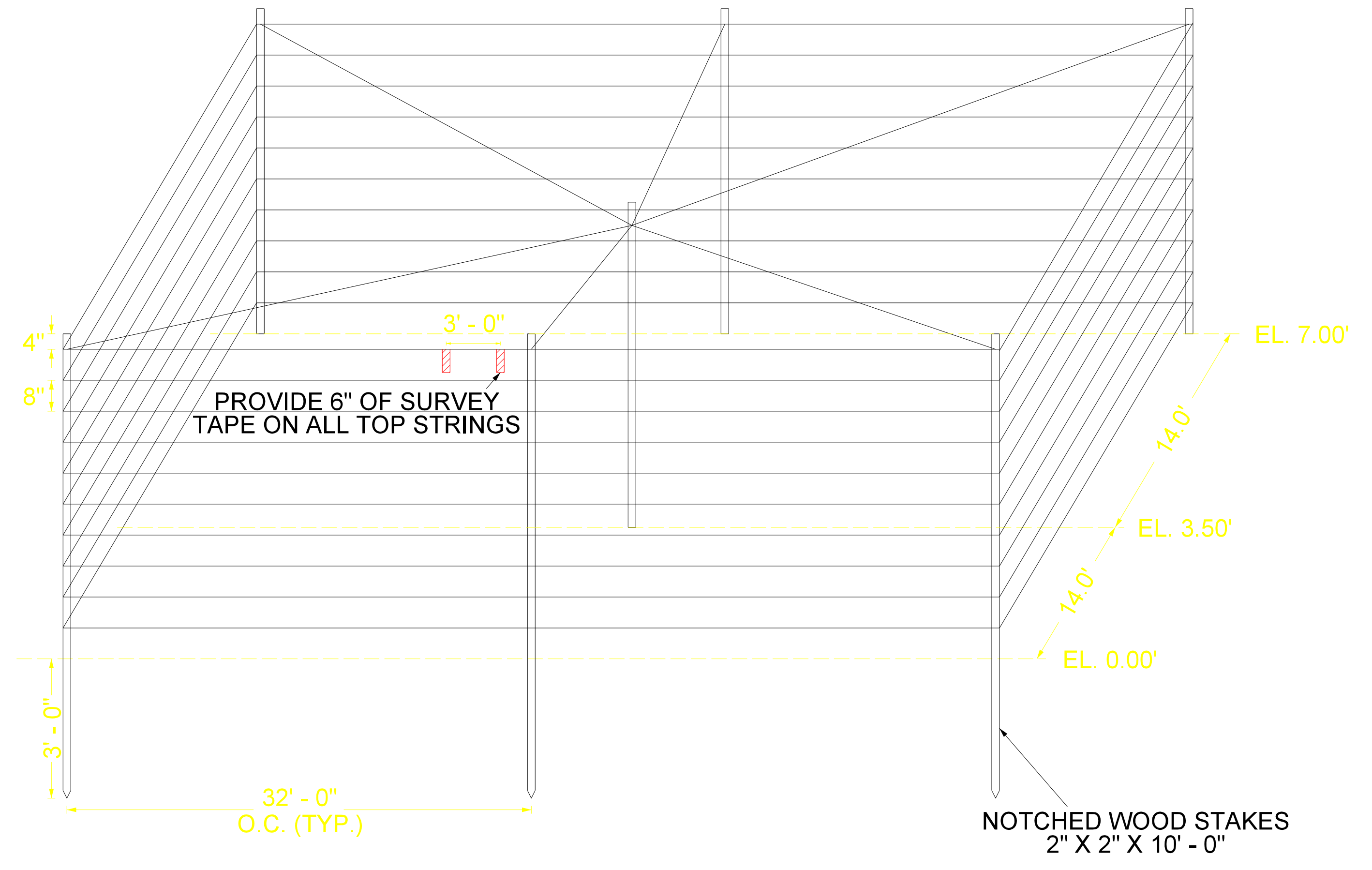

WATER FOWL CANOPY FENCE
ITEM 105SS
NOT TO SCALE

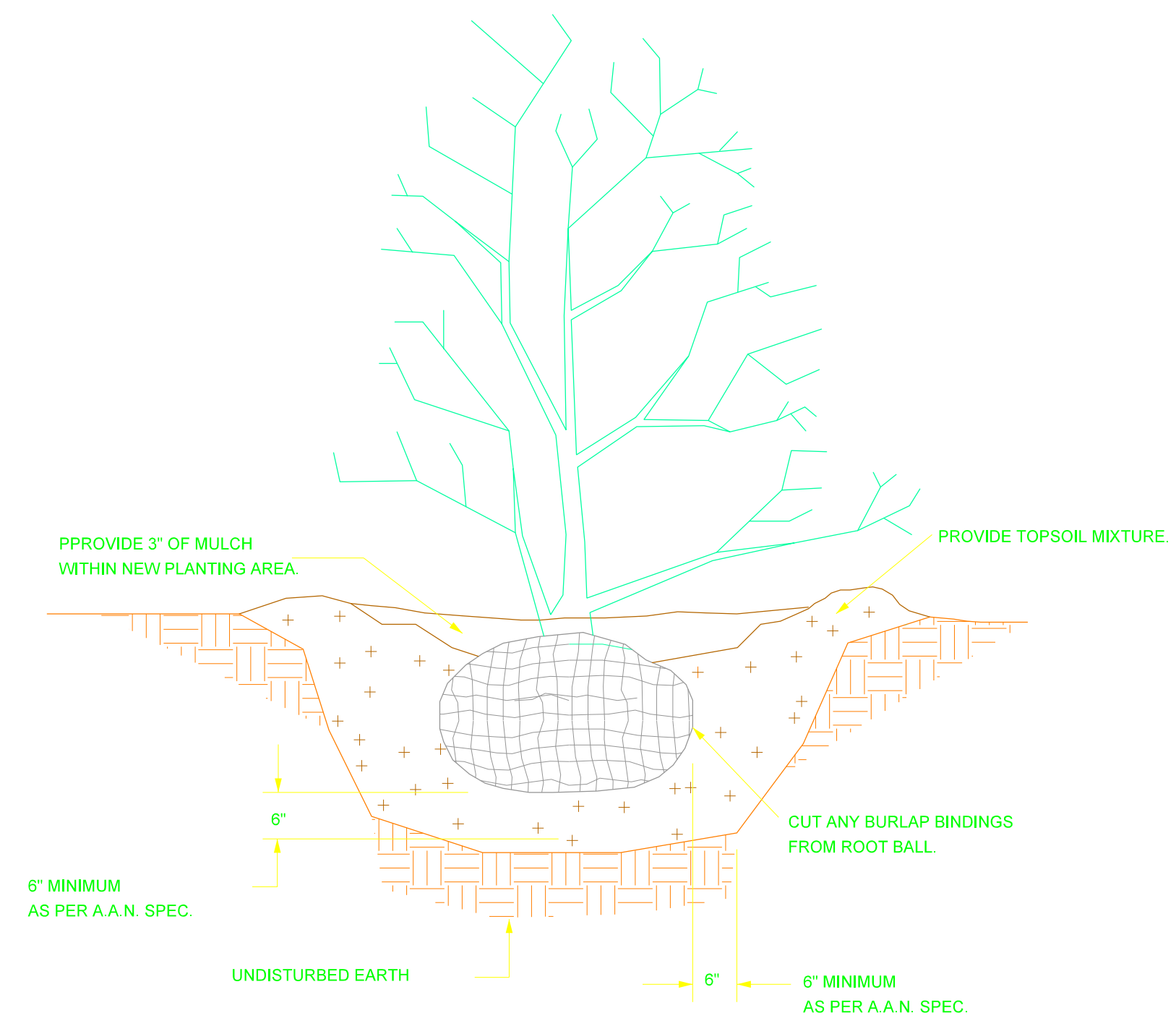

SHRUB PLANTING DETAIL
NOT TO SCALE

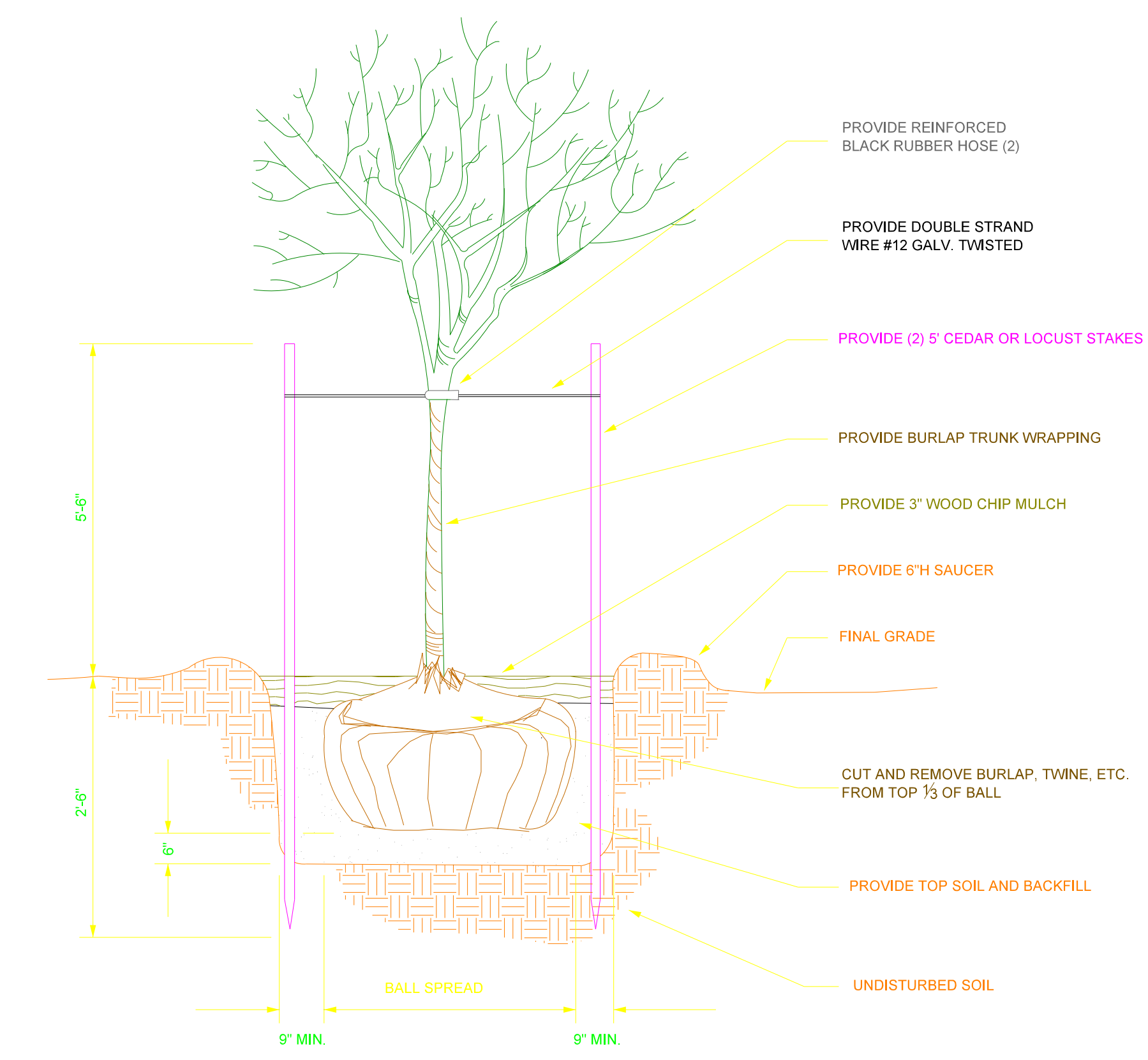

TYPICAL NEW TREE PLANTING DETAIL
NOT TO SCALE

In Charge:	D.L.T.
Compilation:	J.M.T.
Design:	J.M.T.
Drawn:	J.M.T./D.R.R.
Checked:	J.M.T.
Reviewed:	D.L.T.

NO.	DATE	REVISIONS



Department of Engineering

DETAILS

SHORELINE STABILIZATION
BALDWIN HARBOR PARK
BALDWIN, N.Y.

Scale: **NONE**

Date: **FEB. 2020**

File No.: _____

Dwg No.: _____

Sheet No.: **10** of **10**