

EXHIBIT "A"

MAP OF

LOTS 1 THRU 14, BLOCK 2; LOTS 1 THRU 18, BLOCK 7; LOTS 1 THRU 16, BLOCK 8; AND DEDICATED PUBLIC RIGHT OF WAYS; ALL IN WONDERLAND HOMES SUBDIVISION, LOCATED IN LOT 1 OF LENLU ESTATES SUBDIVISION, WHICH IS FORMERLY A PART OF LOT A OF SW1/4 AND A PART OF LOT B OF SE1/4 IN SECTION 24, T3N, R6E, BHM, MEADE COUNTY, SOUTH DAKOTA, RECORDED IN PLAT BOOK 10, PAGE 26 (CORRECTIONS BY AFFIDAVIT, BOOK 333, PAGE 142)

LOTS 1 THRU 6, BLOCK 1; LOTS 15 THRU 25, BLOCK 2; LOTS 1 THRU 12, BLOCK 3; LOTS 1 THRU 12, BLOCK 4; LOTS 1 THRU 15, BLOCK 5; LOTS 1 THRU 14, BLOCK 6; AND DEDICATED PUBLIC RIGHT OF WAYS AS SHOWN HEREON; ALL IN WONDERLAND HOMES SUBDIVISION, LOCATED IN LOT 1 OF LENLU ESTATES SUBDIVISION; WHICH IS FORMERLY A PART OF LOT A OF SW1/4 AND A PART OF LOT B OF SE1/4 ALL IN SECTION 24, T3N, R6E, BHM, MEADE COUNTY, SOUTH DAKOTA, RECORDED IN PLAT BOOK 10, PAGE 48

LOT 3A AND EASEMENTS AS SHOWN HEREON; LOCATED IN A PORTION OF LOT 2 OF LENLU ESTATES SUBDIVISION WHICH IS FORMERLY A PART OF LOT A OF SW1/4 AND LOT B OF SE1/4, SECTION 24, T3N, R6E, BHM, MEADE COUNTY, SOUTH DAKOTA, RECORDED IN PLAT BOOK 10 PAGE 50

LOTS 1 THRU 12, BLOCK 12; AND PUBLIC USE AREAS AND DEDICATED PUBLIC RIGHT OF WAYS AS SHOWN HEREON; ALL IN WONDERLAND HOMES SUBDIVISION LOCATED IN EASTRIDGE ACRES, IN THE NW1/4SE1/4 SECTION 24, T3N, R6E, BHM, MEADE COUNTY, SOUTH DAKOTA, RECORDED IN PLAT BOOK 10, PAGE 88

LOTS 1 THRU 12 OF BLOCK 9; LOTS 1 THRU 23 OF BLOCK 10; AND LOTS 1 THRU 19 OF BLOCK 11 ALL IN WONDERLAND HOMES SUBDIVISION LOCATED IN LOT 1 OF LENLU ESTATES SUBDIVISION WHICH IS FORMERLY A PART OF LOT A OF SW1/4 OF SECTION 24, T3N, R6E, BHM, MEADE COUNTY, SOUTH DAKOTA, RECORDED IN PLAT BOOK 11, PAGE 32

A PORTION OF WONDERLAND HOMES SUBDIVISION IN THE COUNTY OF MEADE, INCLUDING LOTS 4R, 5R, 6R, A& 7R (FORMERLY LOTS 4 THRU 7) OF BLOCK 5 OF WONDERLAND HOMES SUBDIVISION LOCATED IN LOT 1 OF LENLU ESTATES SUBDIVISION WHICH IS FORMERLY A PART OF LOT A OF SW1/4 AND A PART OF LOT B OF SE1/4 ALL IN SECTION 24, T3N, R6E, BHM, MEADE COUNTY, SOUTH DAKOTA, RECORDED IN PLAT BOOK 11, PAGE 77.

LOTS 3B, 3C, AND 3D IN LOT 2 OF LENLU ESTATES SUBDIVISION WHICH IS FORMERLY A PART OF LOT A OF SW1/4 OF SECTION 24, T3N, R6E, BHM, MEADE COUNTY, SOUTH DAKOTA, RECORDED IN PLAT BOOK 11, PAGE 94

LOTS 1 THRU 14 OF BLOCK 13; LOTS 1 THRU 23 OF BLOCK 14; LOTS 1 THRU 13 OF BLOCK 15, AND LOTS 1 THRU 13 OF BLOCK 16, ALL IN WONDERLAND HOMES SUBDIVISION LOCATED IN LOT 3D IN LOT 2 OF LENLU ESTATES SUBDIVISION WHICH IS FORMERLY A PART OF LOT A OF SW1/4 OF SECTION 24, T3N, R6E, BHM, MEADE COUNTY, SOUTH DAKOTA, RECORDED IN PLAT BOOK 11, PAGE 95

LOT 14R OF BLOCK 16 AND LOTS 1 THRU 14 OF BLOCK 17 OF WONDERLAND HOMES SUBDIVISION (WHICH WERE FORMERLY LOTS 14 THRU 20 OF BLOCK 16 OF WONDERLAND HOMES SUBDIVISION AND PORTIONS OF LOTS 3A AND 3C OF LENLU ESTATES SUBDIVISION) LOCATED IN LOTS 3A, 3C, AND 3D IN LOT 2 OF LENLU ESTATES SUBDIVISION WHICH IS FORMERLY A PART OF LOT A OF SW1/4 OF SECTION 24, T3N, R6E, BHM, MEADE COUNTY, SOUTH DAKOTA, AND

LOTS A AND B OF LOT 3C IN LOT 2 OF LENLU ESTATES SUBDIVISION WHICH IS FORMERLY A PART OF LOT A OF SW1/4 OF SECTION 24, T3N, R6E, BHM, MEADE COUNTY, SOUTH DAKOTA, RECORDED IN PLAT BOOK 12, PAGE 51

WELL LOT 2 OF WONDERLAND HOMES SUBDIVISION; FORMERLY AN UN-PLATTED PORTION OF THE REMAINDER OF THE NW1/4 OF SECTION 24, LOCATED IN THE SE1/4 OF THE SW1/4 OF THE NW1/4 OF SECTION 24, T3N, R6E, BHM, MEADE COUNTY, SOUTH DAKOTA, RECORDED IN PLAT BOOK 27, PAGE 72

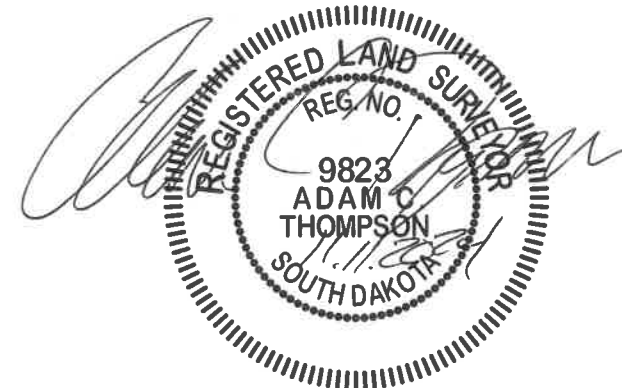

Interstate Engineering
120 Industrial Drive, Suite 2
P.O. Box 226
Spearfish, SD 57783
(605) 642.4772
www.interstateeng.com

MEADE COUNTY, SOUTH DAKOTA	
OWNER(S): _____	
FOR: WONDERLAND HOMES WATER AND SEWER	
PURPOSE: ROAD DISTRICT EXHIBIT	
DRAWN BY: BLG	SURVEYED BY: _____
CHECKED BY: ACT	DESIGNED BY: _____
PROJECT NO: WC24-11-111	
DATE: 11/08/2024	

SEC	T	R
24	3N	6E

1	OF	2
SHEET NO.		

EXHIBIT "A"

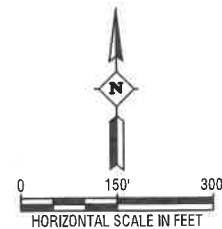

SURVEYORS CERTIFICATE
I, Adam C. Thompson, Registered Land Surveyor #9823 in the State of South Dakota, do hereby state that this drawing was completed under my supervision from documents of record. No survey was performed to confirm true direction or dimensions of the lines shown hereon. This drawing does not constitute a title search to determine ownership or easements of record.

Adam C. Thompson,
South Dakota PLS No. 9823

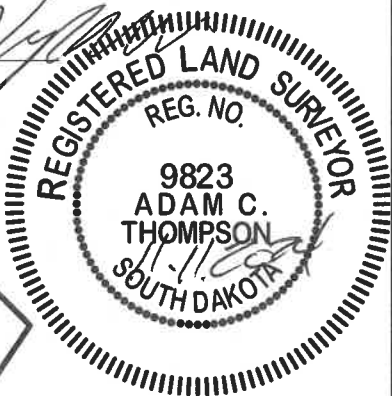

NOTES:

1. PLAT OF LOTS 1 THRU 14, BLOCK 2; LOTS 1 THRU 18, BLOCK 7; LOTS 1 THRU 16, BLOCK 8; AND DEDICATED PUBLIC RIGHT OF WAYS; ALL IN WONDERLAND HOMES SUBDIVISION, LOCATED IN LOT 1 OF LENLU ESTATES SUBDIVISION, WHICH IS FORMERLY A PART OF LOT A OF SW1/4 AND A PART OF LOT B OF SE1/4 IN SECTION 24, T3N, R6E, BHM, MEADE COUNTY, SOUTH DAKOTA, RECORDED IN PLAT BOOK 10, PAGE 26 (CORRECTIONS BY AFFIDAVIT, BOOK 333, PAGE 416)
2. PLAT OF LOTS 1 THRU 6, BLOCK 1; LOTS 15 THRU 25, BLOCK 2; LOTS 1 THRU 12, BLOCK 3; LOTS 1 THRU 12, BLOCK 4; LOTS 1 THRU 15, BLOCK 5; LOTS 1 THRU 14, BLOCK 6; AND DEDICATED PUBLIC RIGHT OF WAYS AS SHOWN HEREON; ALL IN WONDERLAND HOMES SUBDIVISION, LOCATED IN LOT 1 OF LENLU ESTATES SUBDIVISION, WHICH IS FORMERLY A PART OF LOT A OF SW1/4 AND A PART OF LOT B OF SE1/4 ALL IN SECTION 24, T3N, R6E, BHM, MEADE COUNTY, SOUTH DAKOTA, RECORDED IN PLAT BOOK 10, PAGE 48
3. PLAT OF LOT 3A AND EASEMENTS AS SHOWN HEREON; LOCATED IN A PORTION OF LOT 2 OF LENLU ESTATES SUBDIVISION WHICH IS FORMERLY A PART OF LOT A OF SW1/4 AND LOT B OF SE1/4, SECTION 24, T3N, R6E, BHM, MEADE COUNTY, SOUTH DAKOTA, RECORDED IN PLAT BOOK 10 PAGE 50
4. PLAT OF LOTS 1 THRU 12, BLOCK 12; AND PUBLIC USE AREAS AND DEDICATED PUBLIC RIGHT OF WAYS AS SHOWN HEREON; ALL IN WONDERLAND HOMES SUBDIVISION LOCATED IN EASTRIDGE ACRES, IN THE NW1/4SE1/4 SECTION 24, T3N, R6E, BHM, MEADE COUNTY, SOUTH DAKOTA, RECORDED IN PLAT BOOK 10, PAGE 88
5. PLAT OF LOTS 1 THRU 12 OF BLOCK 9; LOTS 1 THRU 23 OF BLOCK 10; AND LOTS 1 THRU 19 OF BLOCK 11 ALL IN WONDERLAND HOMES SUBDIVISION LOCATED IN LOT 1 OF LENLU ESTATES SUBDIVISION WHICH IS FORMERLY A PART OF LOT A OF SW1/4 OF SECTION 24, T3N, R6E, BHM, MEADE COUNTY, SOUTH DAKOTA, RECORDED IN PLAT BOOK 11, PAGE 32
6. PLAT OF A PORTION OF WONDERLAND HOMES SUBDIVISION IN THE COUNTY OF MEADE, INCLUDING LOTS 4R, 5R, 6R, A & 7R (FORMERLY LOTS 4 THRU 7) OF BLOCK 5 OF WONDERLAND HOMES SUBDIVISION LOCATED IN LOT 1 OF LENLU ESTATES SUBDIVISION WHICH IS FORMERLY A PART OF LOT A OF SW1/4 AND A PART OF LOT B OF SE1/4 ALL IN SECTION 24, T3N, R6E, BHM, MEADE COUNTY, SOUTH DAKOTA, RECORDED IN PLAT BOOK 11, PAGE 77.
7. PLAT OF LOTS 3B, 3C, AND 3D IN LOT 2 OF LENLU ESTATES SUBDIVISION WHICH IS FORMERLY A PART OF LOT A OF SW1/4 OF SECTION 24, T3N, R6E, BHM, MEADE COUNTY, SOUTH DAKOTA, RECORDED IN PLAT BOOK 11, PAGE 94
8. PLAT OF LOTS 1 THRU 14 OF BLOCK 13; LOTS 1 THRU 23 OF BLOCK 14; LOTS 1 THRU 13 OF BLOCK 15, AND LOTS 1 THRU 13 OF BLOCK 16, ALL IN WONDERLAND HOMES SUBDIVISION LOCATED IN LOT 3D IN LOT 2 OF LENLU ESTATES SUBDIVISION WHICH IS FORMERLY A PART OF LOT A OF SW1/4 OF SECTION 24, T3N, R6E, BHM, MEADE COUNTY, SOUTH DAKOTA, RECORDED IN PLAT BOOK 11, PAGE 95
9. PLAT OF LOT 14R OF BLOCK 16 AND LOTS 1 THRU 14 OF BLOCK 17 OF WONDERLAND HOMES SUBDIVISION (WHICH WERE FORMERLY LOTS 14 THRU 20 OF BLOCK 16 OF WONDERLAND HOMES SUBDIVISION AND PORTIONS OF LOTS 3A AND 3C OF LENLU ESTATES SUBDIVISION) LOCATED IN LOTS 3A, 3C, AND 3D IN LOT 2 OF LENLU ESTATES SUBDIVISION WHICH IS FORMERLY A PART OF LOT A OF SW1/4 OF SECTION 24, T3N, R6E, BHM, MEADE COUNTY, SOUTH DAKOTA, AND PLAT OF LOTS A AND B OF LOT 3C IN LOT 2 OF LENLU ESTATES SUBDIVISION WHICH IS FORMERLY A PART OF LOT A OF SW1/4 OF SECTION 24, T3N, R6E, BHM, MEADE COUNTY, SOUTH DAKOTA, RECORDED IN PLAT BOOK 12, PAGE 51
10. PLAT OF WELL LOT 2 OF WONDERLAND HOMES SUBDIVISION; FORMERLY AN UN-PLATTED PORTION OF THE REMAINDER OF THE NW1/4 OF SECTION 24, LOCATED IN THE SE1/4 OF THE SW1/4 OF THE NW1/4 OF SECTION 24, T3N, R6E, BHM, MEADE COUNTY, SOUTH DAKOTA, RECORDED IN PLAT BOOK 27, PAGE 72



PREPARED BY:
INTERSTATE ENGINEERING
Professionals you need, people you trust.

Interstate Engineering
120 Industrial Drive, Suite 2
P.O. Box 226
Spearfish, SD 57783
(605) 642.4772
www.interstateeng.com

MEADE COUNTY, SOUTH DAKOTA

OWNER(S):
FOR: WONDERLAND HOMES WATER AND SEWER
PURPOSE: ROAD DISTRICT EXHIBIT
DRAWN BY: BLG SURVEYED BY: PROJECT NO: WC24-11-111
CHECKED BY: ACT DESIGNED BY: DATE: 11/08/2024

SEC	T	R
24	3N	6E

2 OF 2

SHEET NO.