



**FREE  
AIRFARE**

See back for details

**11 DAY RIVER CRUISE HOLIDAY**

Including two nights in  
Lucerne, Switzerland

# Tulip Time on Jewels of the Rhine

the Netherlands • Germany • France • Switzerland

**2021 Departure Dates:** April 9, 13, 21



**Mayflower**  
CRUISES & TOURS



# Tulip Time on Jewels of the Rhine

**11 Days • 23 Meals** Enjoy a relaxing and inspiring cruise on the Romantic Rhine, Europe's longest river. Travel onboard a luxurious river ship, during tulip time, visiting iconic ports of call, sampling incredible cuisine, and absorbing the local culture.

## EXCEPTIONAL INCLUSIONS

- ❖ **23 Meals:** 9 breakfasts, 6 lunches and 8 dinners
- ❖ **Airport transfers** on tour dates when air is provided by Mayflower Cruises & Tours
- ❖ Visit **four countries**
- ❖ **Seven-nights in a suite or stateroom** of your choice onboard the vessel
- ❖ **First-class service** by an English-speaking crew
- ❖ **All gratuities included**
- ❖ Explore the magnificent **Keukenhof Gardens**
- ❖ **Shore excursions** with English-speaking local guides
- ❖ Visit **UNESCO World Heritage Sites**
- ❖ Personal **listening device** for shore excursions
- ❖ **All meals included** onboard
- ❖ Variety of **international cuisine**
- ❖ Complimentary **regional wines, beer and soft drinks** with onboard lunches and dinners
- ❖ **Onboard Activity Manager** will support all EmeraldACTIVE excursions and host daily onboard wellness activities, games, classes and evening entertainment
- ❖ Complimentary **bottled water** in your stateroom
- ❖ Complimentary **WiFi onboard**
- ❖ Complimentary **bicycles onboard** for use ashore
- ❖ All port charges included
- ❖ Two-night **hotel stay and touring** in Lucerne
- ❖ \$55 in **Mayflower Money**

## CRUISE AND HOTEL ACCOMMODATIONS

**Days Two through Eight** – Aboard an Emerald Waterways Star-Ship

**Days Nine and Ten** – Hotel Europe or similar, Lucerne, Switzerland

*Pre cruise hotel stays available in Amsterdam. Call for details.*



Enjoy seven-nights cruising along the Romantic Rhine River

### DAY 1 – Depart the USA

Depart the USA on your overnight flight to Amsterdam, the Netherlands.

### DAY 2 – Amsterdam, the Netherlands

Welcome to Amsterdam, a fascinating 700-year-old city of picturesque canals, world class museums, theatres and cafés. You will be met and transferred from the airport to your Emerald Waterways luxury river cruise ship. Become acquainted with the amenities of your ship, or begin exploring the city. This evening, join your fellow travelers for dinner onboard. **Meal: D**

### DAY 3 – Keukenhof Gardens

This morning, depart by coach for an included visit to Keukenhof Gardens. Discover why it's called the 'Garden of Europe' as you admire gorgeous flowers at the peak of tulip season. Return to the ship for your first day cruising through the Dutch countryside, passing windmills and sailing through locks towards the Rhine River. Tonight, enjoy a welcome reception and gala dinner. **Meals: B, L, D**

**EmeraldPLUS:** A visit to Keukenhof Gardens

### DAY 4 – Cologne, Germany

Cruise along the Rhine River to Cologne. Founded by the Romans, the city is one of Germany's oldest and famous for its magnificent World-Heritage listed gothic cathedral. After lunch onboard, join your local guide for an included walking tour of the city, touching on the historical charm of the Old Town. Traverse quaint alleyways and see historic monuments. The tour concludes at the cathedral, whose twin spires dominate the skyline. **Meals: B, L, D**

### DAY 5 – Koblenz, Germany

Cruise to the 2000-year-old town of Koblenz, situated at the confluence of the Rhine and Moselle Rivers. Enjoy a walking tour of Koblenz and visit the Ehrenbreitstein Fortress on the opposite side of the river. This fortress was part of the Prussian defense against the French in the 19th century and later used as a headquarters for the American military during WWII. This afternoon, sail through the spectacular Rhine Gorge. Pass countless medieval castles and vineyards lining the shores of this section of the river, with photo







Flowers and fragrances fill Keukenhof Gardens



Explore Heidelberg on an included excursion with wine tasting

opportunities around every bend. See the infamous Lorelei statue and Pfalzgrafenstein Castle, built on an island in the middle of the river as a medieval toll station. **Meals: B, L, D**

**DiscoverMORE:** Moselle & Cochem (Reichsburg) Castle Visit (additional expense)

NOTE: You can choose either the included tour of Koblenz OR the DiscoverMORE option, as both tours operate at the same time.

#### DAY 6 – Mannheim / Heidelberg, Germany

Continue downstream to the town of Mannheim, located at the confluence of the Rhine and Neckar Rivers. From there, travel by coach to Heidelberg where you have the opportunity to either visit the medieval town of Heidelberg on a walking tour, or take part in an active hike to Heidelberg Hill. **Meals: B, L, D**

**EmeraldPLUS:** Guided tour of Heidelberg with wine tasting

**EmeraldACTIVE:** Hike from Mount Königstuhl to Heidelberg

#### DAY 7 – Kehl / Strasbourg, France

Once docked in Kehl, travel by coach across the river to Strasbourg, the capital of the Alsace region in France. Your guided walking tour includes the Grande Île - the historical city center and UNESCO World Heritage Site. Known for its medieval black and white timber-framed buildings, old tanning houses, baroque sandstone buildings, canals and river locks, the city's star attraction is the cathedral, dominating the main square. **Meals: B, L, D**

**EmeraldPLUS:** Guided tour of Strasbourg

**DiscoverMORE:** Tour of Riquewihr (additional expense)

#### DAY 8 – Breisach

On today's adventure, visit a typical Black Forest village, full of charm, cuckoo clocks and other German specialties. Alternatively, take part in a guided hike along some of the Black Forest trails.

**Meals: B, L, D**

**EmeraldPLUS:** Black Forest Cake demonstration and tasting

**EmeraldACTIVE:** Guided hike in the Black Forest

#### DAY 9 – Basel to Lucerne, Switzerland

After breakfast, disembark the ship in Basel and begin your Swiss adventure. Depart by coach to Lucerne, a picturesque town surrounded by mountains and meadows. An included walking tour

highlights the city's landmark - the famous 14th-century Chapel Bridge. See the 17th-century Renaissance Town Hall and town squares, all set amongst the beautiful backdrop of the Swiss Alps. The remainder of the day is at leisure. **Meal: B**

#### DAY 10 – Optional Excursion: Mt. Pilatus

Your last day is left free of planned activities. Explore on your own, or join the optional excursion to Mt. Pilatus – a mountain overlooking Lucerne that offers a unique alpine experience! This evening, get together for an included dinner at the hotel. **Meals: B, D**

#### DAY 11 – Lucerne / USA

Bid 'auf wiedersehen' to Europe and return home with memories of life enriching experiences from your European adventure and cruise along the Rhine River during tulip time. **Meal: B**

*Itinerary is subject to change.*



Cross the Reuss River via the historic Chapel Bridge in Lucerne, Switzerland



Seven nights accommodations aboard an

# Emerald Waterways Star-Ship

Built: 2014-2017 Speed: 15.5 mph Staterooms: 80 Suites: 12 Length: 443 ft. Crew: 47

## SUN DECK

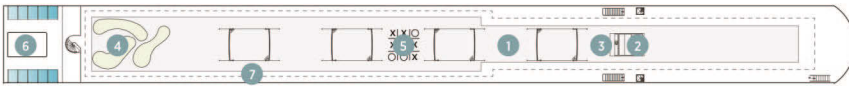

## HORIZON DECK

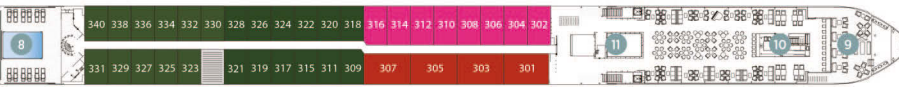

## VISTA DECK

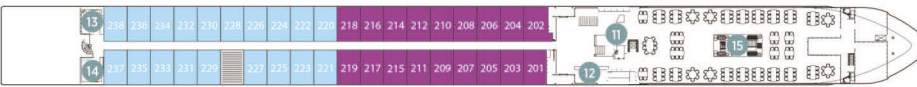

## RIVIERA DECK

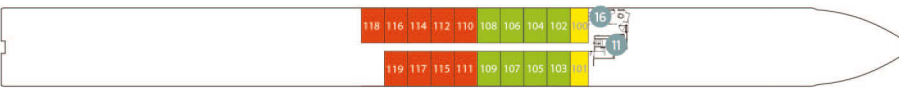

## Public Areas and Ship Amenities

- 1 Sun Deck with Deck Chairs
- 2 Navigation Bridge
- 3 Sky Barbecue
- 4 Golf Putting Green
- 5 Games Area
- 6 Retractable Glass Roof
- 7 Walking Track
- 8 Daytime Pool & Bar / Evening Cinema
- 9 The Terrace
- 10 Horizon Bar and Lounge
- 11 Elevator
- 12 Reception
- 13 Wellness Area
- 14 Fitness Area
- 15 Reflections Restaurant
- 16 Hairdresser

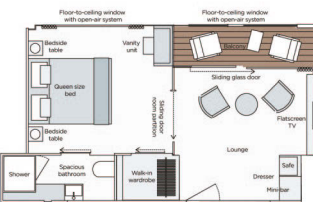

### Owner's One-Bedroom Suite

315ft<sup>2</sup>

SA

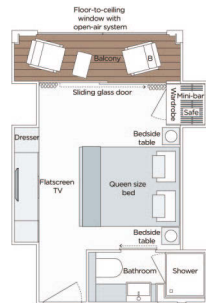

### Grand Balcony Suite

210ft<sup>2</sup>

S

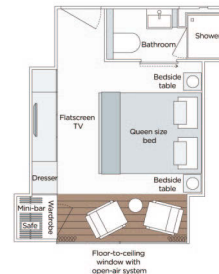

### Panorama Balcony Suite

180ft<sup>2</sup>

A B C

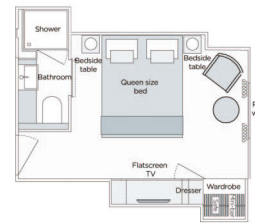

### Emerald Stateroom

162ft<sup>2</sup>

D E

## 2021 Departure Dates: April 9, 13, 21

| CATEGORY                     | DECK    | PER PERSON TWIN RATE | SINGLE ROOM |
|------------------------------|---------|----------------------|-------------|
| E Emerald Stateroom          | Riviera | \$4,299              | add \$2,795 |
| D Emerald Stateroom          | Riviera | \$4,399              | add \$2,859 |
| C Panorama Balcony Suite     | Vista   | \$4,949              | add \$3,219 |
| B Panorama Balcony Suite     | Vista   | \$5,199              | add \$3,379 |
| A Panorama Balcony Suite     | Horizon | \$5,399              | add \$3,509 |
| S Grand Balcony Suite        | Horizon | \$5,799              | N/A         |
| SA Owner's One-Bedroom Suite | Horizon | \$6,599              | N/A         |

**Free Airfare from major U.S. cities when booked by March 31, 2020.**

Call for schedules from your city to Amsterdam, the Netherlands, returning from Zurich, Switzerland

## TOUR ACTIVITY LEVEL



## Travelers Protection Plan (TPP) for River Cruises

This nonrefundable fee will provide a refund to you during the instance that you have to cancel your trip. The cancellation has to be for a covered reason (see Plan for details on coverage) and we have to be notified at least one day prior to departure. If you must leave the tour early due to personal illness or the illness or death of an immediate family member, TPP will provide a refund for any unused services after the departure of the tour. Other benefits include medical expenses for illness and injury, emergency transportation, 24 hour hot line and lost or stolen baggage assistance. Return air transportation is included ONLY if your air tickets are purchased through Mayflower Cruises & Tours. Please review the Plan for details on coverage.

## Cancellation Charges Without Traveler's Protection Plan (TPP)

- 91 days or more ..... Deposit Amount
- 90 days to day of departure ..... 100% of the total tour
- No refund on unused portions of the tour

Plan and benefits offered and administered by Trip Mate, Inc.



FOR RESERVATIONS OR INFORMATION CONTACT:

