

SEE ADDENDUM FOR ADDITIONAL/CORRECTED INFORMATION



Ohio Historic Preservation Office

1985 Verna Avenue
Columbus, Ohio 43211
614/496-1500

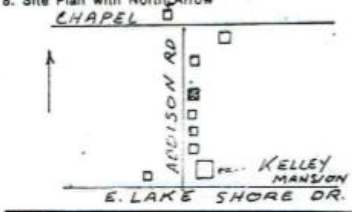

OHIO HISTORICAL SOCIETY
SINCE 1895

OHIO HISTORIC INVENTORY

1. No. ERI-1528		4. Present Name(s) Hodgson/Bockerman House		1. No. ERI-1528	
2. County ERIE		5. Other Name(s) Elfers/Bockerman House			2. County Erie
3. Location of Negatives O.H.S.					
6. Specific Location East side of Addison Pl., 4th house from its inter. with E. Lake Shore Dr.		16. Thematic Category Ethnic, Commercial, Agric.		4. Present Name(s) Hodgson / Bockerman	
7. City or Town If Rural, Township & Vicinity Kelleys Island, Ohio		17. Date(s) or Period c. 1880			
8. Site Plan with North Arrow 		18. Style or Design Italianate, vernacular		5. Other Name(s) Elfers / Bockerman	
9. U.T.M. Reference 17 357710 9605980		19. Architect or Engineer			
10. Site Building <input checked="" type="checkbox"/> Structure <input type="checkbox"/> Object <input type="checkbox"/>		20. Contractor or Builder			
11. On National Register? Yes <input type="checkbox"/> No <input checked="" type="checkbox"/>		21. Original Use, if apparent Residence			
12. Is It Eligible? Yes <input checked="" type="checkbox"/> No <input type="checkbox"/>		22. Present Use Residence			
13. Part of Estab. Yes <input type="checkbox"/> No <input checked="" type="checkbox"/>		23. Ownership Public <input type="checkbox"/> Private <input checked="" type="checkbox"/>			
14. District Potent? Yes <input checked="" type="checkbox"/> No <input type="checkbox"/>		24. Owner's Name & Address, if known James Hodgson 1438 Northland Ave., Lakewood, Ohio, 44107			
15. Name of Established District N/A		25. Open to Public? Yes <input type="checkbox"/> No <input checked="" type="checkbox"/>			
16. Further Description of Important Features (Continue on reverse if necessary) This gable-front-and-wing building features a five bay, front facade with doorways in both the gable and eave walls. The moderately sloping gable roof has overhanging eaves which project over a wide frieze board set on end boards. Trim elements are focused on doors and windows which feature framed surrounds and pedimented lintels with pendant drips and a central milled design. Both front doors are access		26. Local Contact Person or Organization Kevin Pape: K.I. Hist. Survey			
17. History and Significance This house was built in the early 1880's by Frederick Elfers, merchant and grape grower, who came to Kelleys Island in 1861 as a boy of 15, from his home in Hanover, Germany. It was probably at the suggestion of his brother, Henry, who had arrived on the island 2 years earlier. By 1865 Frederick was living with a Swiss farmer, Charles Earvey, and working in		27. Other Surveys in Which Included N/A			
18. Description of Environment and Outbuildings The house sits on a well kept lawn, shaded by mature trees. A huge block of limestone, placed there by the previous owner, makes a dramatic statement. Henry Elfers had built a house, similar in plan and exterior,		28. No. of Stories 2			
19. Sources of Information Census Records; Schedule 2, Prod. of Agriculture Aldrich, <u>History of Erie County, Ohio</u> Hill, <u>History of Kelleys Island, Ohio</u> M. Bockerman Hamilton Collection, Hayes Presidential Center		29. Basement? Yes <input checked="" type="checkbox"/> No <input type="checkbox"/>			
		30. Foundation Material Limestone ashlar			
		31. Wall Construction Wood frame			
		32. Roof Type & Material Gable/asph shingle			
		33. No. of Bays Front 5 Side 2			
		34. Wall Treatment Weather/Bevel Bd.			
		35. Plan Shape irreg.			
		36. Changes (Explain in #42) Addition <input checked="" type="checkbox"/> Altered <input type="checkbox"/> Moved <input type="checkbox"/>			
		37. Condition Interior Excellent Exterior Excellent			
		38. Preservation Underway? Yes <input checked="" type="checkbox"/> No <input type="checkbox"/>			
		39. Endangered? By What? Yes <input type="checkbox"/> No <input checked="" type="checkbox"/>			
		40. Visible from Public Road? Yes <input checked="" type="checkbox"/> No <input type="checkbox"/>			
		41. Distance from and Frontage on Road 50'			
45. Prepared by Kevin & B. Pape					
46. Organization K.I. Planning Comm.					
47. Date 10/85 48. Revision Date(s)					

50. House Type No.

Code No. Name

51. Historic Outbuildings and Dependencies

Barn Type(s)

Code No. Type

Corn Crib or Shed Silo Summer Kitchen

Smoke House Spring House or Ice House

Prhy Carriage House

Other _____

52. Archaeological Site on Property?

Yes

No

Basis for Information

Owner Collection

Above Ground Earthworks or Mound

Cultural Materials Noted OAI No. _____

53. Farmstead Plan

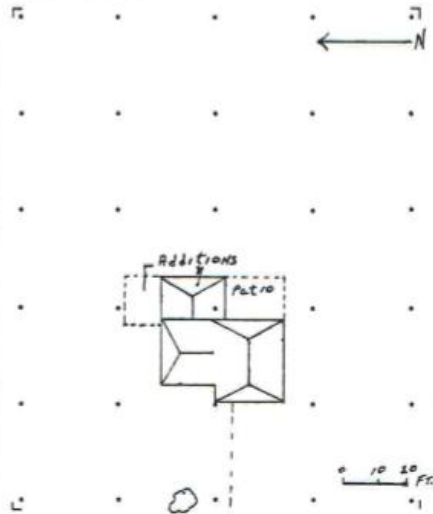

54. Photo

Roll No. 6 Picture No(s). 5

the vineyards. When only 19 he started business for himself by leasing 5½ acres of vineyards on an indenture basis from Addison Kelley, a lease which he continued even after 1888. In 1876, 5 years after his marriage to Sophia Koster, sister of Herman Koster, and with no previous experience, he entered the mercantile business. With A. Heckerman, a carpenter, also from Hanover, they built and stocked the second general store on the island. This building probably preceeded the present Gerlach/McKillips workshop (ERI-1626) 2 blocks north on Division St. In 1883, when John Reinheimer left his general store (ERI-1559) to operate the Boat Dock (ERI-1628), Fred took over this store, and in 1884 when appointed Post Master, built a small edition to the south wall of his store to house the Post Office. A year later he contracted with August Schaedler to build a "fine new store" across Division St. that was to incorporate the newest in technical and decorative innovations (ERI-1564) including the first electric lighting system in Erie County. A mechanical and inventive genius, Mr. Elfers devised many labor saving devices which he incorporated in to both his home and his store. He was the first photographer on the island and built a darkroom in his home. He was also the first to have a speed boat.

44. (Cont'd.)

and at approximately the same time. This house was later used as the rectory for St. Michael's Church, but burned in 1935. The house to the north of this now vacant lot (ERI-1528) was also in the Elfers family.

42. (Cont'd.) ed by dressed limestone steps. Windows are predominantly 2/2, double-hung. Additions and alterations include an exterior, eave-wall, rubble limestone chimney that is pierced by "French" doors in the second story on the south wall. A single-story wing is attached to the eastern eave wall and a shed-roofed utility addition has been built onto its northern wall. Other alterations include a twelve, a fifteen, and an eighteen light, single sash window in the rear of the house.