

1. Install Remote Control Batteries

1. Turn over the remote control and open the back cover by finding the indentation at the bottom edge of the remote control and then separate the back cover from the remote control.
2. Insert two (2) AAA alkaline batteries. Make sure the positive and negative ends are facing the correct direction, and replace the back cover.
3. Once batteries are properly installed, the NORMAN® logo will light.

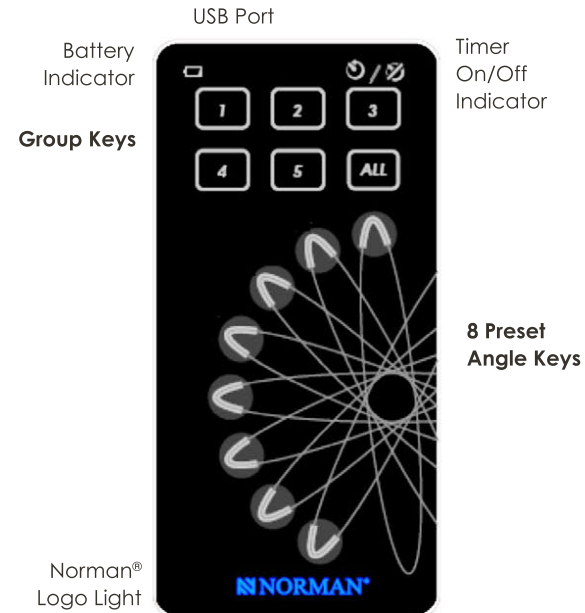

When operating the remote, make sure the device is awake and the Norman® logo light is on.

2. QUICK SETUP

How to Group Shutters (Step 1)

Your PerfectTilt® RF system has not been pre-programmed. To begin programming, only install the batteries into the motors you'd like to assign to the first group. At this point, do not install the batteries for motors that are to be assigned in other groups, since any motor that has been powered on with batteries and can receive a signal from the remote control, and has not been already programmed, will be programmed in this step.

For installing motor batteries, please refer to section 5

With batteries installed in all group 1 motors only, press any one of the eight "Angle" keys. It does not matter which one you push. Now, press a single "Group" key (numbered 1 through 5) that corresponds to the group number you'd like to assign to the motors that have been powered on. For instance, if you'd like to assign button "1" to all the motors powered on right now, press "1" now.

How to Group Shutters (Step 2)

After you have pressed "1", this concludes the first step. In the second step, install all group 2 batteries. Do not take out the batteries from the motors that have already been assigned to group 1. With batteries installed in all group 1 and group 2 motors only, press any one of the eight "Angle" keys. It does not matter which one you push. Now, press a single "Group" key that corresponds to the group number you'd like to assign to the motors in the second group. For instance, if you'd like to assign button "2" to the second group of motors you have just installed batteries for, press "2". This concludes step two. You can repeat the process for up to 5 groups.

3. USING YOUR REMOTE

With all groups programmed, you can easily tilt any group of shutters. To begin, first press the "Angle" key that corresponds to the angle you wish to tilt. Then press the "Group" key that corresponds to the group number you'd wish to tilt: this will tilt all shutters in that group to the desired position. To tilt all shutters at once, press the desired "Angle" key and then press the "All" key.

4. RESET GROUPS AT ANY TIME

If you want to reset any of the motors at any point, just take out the battery and then re-install it.

5. INSTALL PERFECTILT™ MOTOR BATTERIES

Note: Each motor requires six (6) AA alkaline batteries.

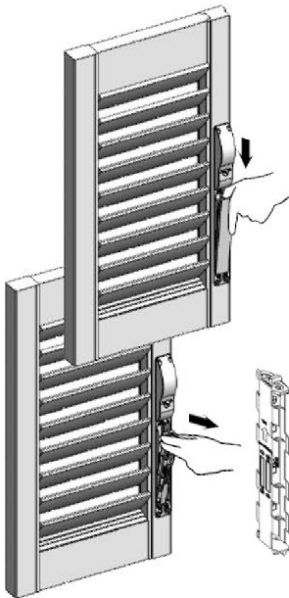

1. Open the battery cover and remove the battery cartridge.

2. Insert six (6) AA alkaline batteries. Make sure the positive and negative ends are facing the correct direction, and replace the battery cartridge and battery cover.

SHUTTER DIAGRAM

THIS SIDE FACES THE WINDOW



Motor
Includes motor and battery pack

Manual Switch
Use a coin to release the clutch to switch to "M" (manual mode)

Battery Pack
Includes battery cartridge and cover

MANUAL MODE

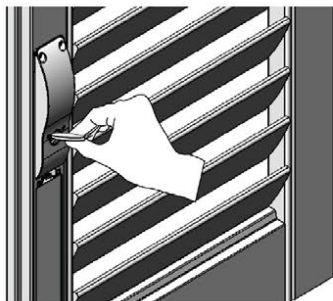

Do not tilt PerfectTilt® RF by hand (without the remote control) while it is in "R" mode (remote control mode); doing so will severely damage your shutter. To tilt manually (by hand), locate the manual switch and use a coin to flip the clutch from "R" to "M". Revert to remote control mode by flipping the switch to "R".