

COUNTRY CLUB PARK

Office Space for Lease



2260 S. Xanadu Way, Aurora, CO 80014

PROPERTY SUMMARY

Building Size:	46,284 RSF
Space Available:	7,007 RSF
Lease Rates:	\$13.00 SF - \$15.00 SF
Suite Size:	638 - 2,440 SF
Parking:	3 : 1,000 Surface and Covered
Year Built:	1980

FEATURING

- Close proximity to I-225
- Common conference room
- Reserved covered parking
- Spectacular mountain and golf course views
- Well-maintained courtyard with water feature
- Abundant retail and restaurant amenities within walking distance
- Short walk to the future I-225 light rail station

For more information, please contact:

Rick Giarratano
T 303.226.4765

rick@denverofficespace.com

Mike Lindquist
T 303.226.4768

mike@denverofficespace.com

John Fairbairn
T 303.226.4764

john@denverofficespace.com



1873 S. Bellaire Street | Suite 1200 | Denver, CO 80222 | 303-765-4344

www.denverofficespace.com

The information above has been obtained from sources believed reliable. While we do not doubt its accuracy, we have not verified it and make no guarantee, warranty or representation about it. It is your responsibility to independently confirm its accuracy and completeness. Any projections, opinions, assumptions or estimates used for example only and do not represent the current or future performance of the property. The value of the transaction to you depends on tax and other factors which should be evaluated by your tax, financial and legal advisors. You and your advisors should conduct a careful, independent investigation of the property to determine to your satisfaction the suitability of the property for your needs.

COUNTRY CLUB PARK

Office Space for Lease

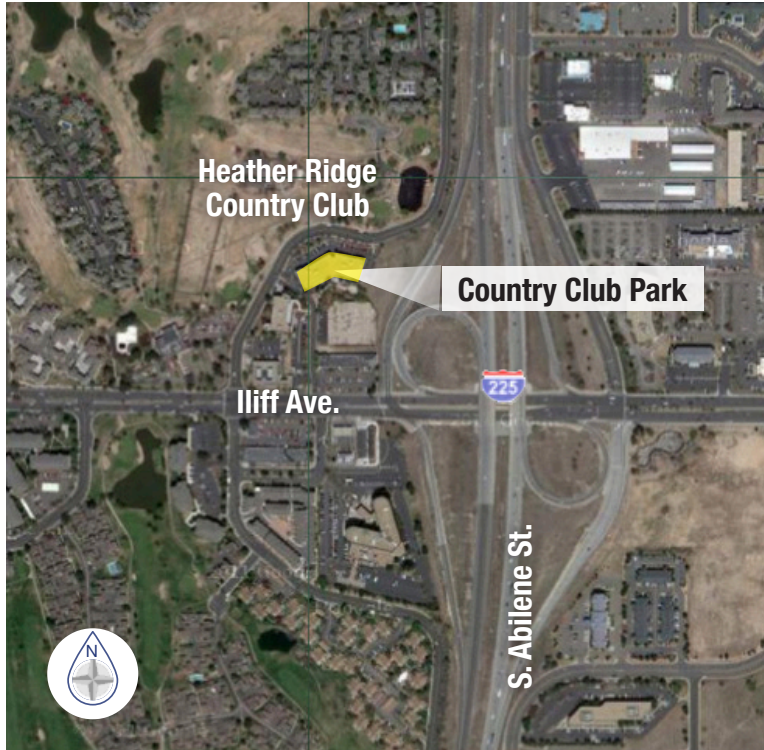

Country Club Park at Heather Ridge:

- Right on Golf Course
- Seconds to Iliff / I-225 access ramps
- Great for CPA's, attorneys, medical and health professionals, marketing and advertising firms, financial and insurance advisors, non-profits and start-ups
- Choose from brand new suites ranging in size of less than 700 SF to nearly 2,500 SF
- Free rent is offered
- Free use of common area conference
- Enjoy the expansive courtyard with its floral and water displays and picnic area

2260 S. Xanadu Way, Aurora, CO 80014

AVAILABILITY

<u>Suite</u>	<u>Size SF</u>	<u>Configuration</u>
210	2,200	• Golf course view, reception, large conference room, large open area
265 spec suite	698	• Golf course & mountain view, large executive office, open area
242	1,127	• Open space
280	2,440	• 5 offices on glass, conference room, breakroom, work and storage room with built-in cabinetry.
290	542	• Small kitchen

For more information, please contact:

Mike Lindquist

T 303.226.4768

mike@denverofficespace.com

Rick Giarratano

T 303.226.4765

rick@denverofficespace.com

John Fairbairn

T 303.226.4764

john@denverofficespace.com

1873 S. Bellaire Street | Suite 1200 | Denver, CO 80222

www.denverofficespace.com



The information above has been obtained from sources believed reliable. While we do not doubt its accuracy, we have not verified it and make no guarantee, warranty or representation about it. It is your responsibility to independently confirm its accuracy and completeness. Any projections, opinions, assumptions or estimates used for example only and do not represent the current or future performance of the property. The value of the transaction to you depends on tax and other factors which should be evaluated by your tax, financial and legal advisors. You and your advisors should conduct a careful, independent investigation of the property to determine to your satisfaction the suitability of the property for your needs.