

# One Owner **AUCTION**

*Internet Bidding  
Available*

**Bruce Jones Oilfield Construction Equipment**

**SATURDAY • JANUARY 23, 2021 • 10:00 A.M.**

**LINDSAY, OKLAHOMA**

**Sale Site: Lindsay, Oklahoma**



**Can't  
Attend?**

**FOR ONLINE BIDDING**  
**Go to [mgrammauctioneers.com](http://mgrammauctioneers.com)**



*Internet Bidding  
Available*

**No  
Minimums!  
No  
Reserves!**

**GRAHAM**  
**Auctioneers**

# BRUCE JONES OILFIELD CONSTRUCTION EQUIPMENT LINDSAY, OKLAHOMA SATURDAY, JANUARY 23, 2021 – 10:00 A.M.

## ABSOLUTE TERMS

The items in this auction have been honestly and conscientiously described by the owners and auctioneer, and are believed to be true and correct. There is no warranty or guarantee intended or implied by the owners, auctioneers or previous advertisers!

Complete payments on date of sale with cash, cashier's check or other checks covered by a Bank Letter of Credit! **EVERYTHING SELLS WITHOUT MINIMUM OR RESERVATION. TAX EXEMPT BUYERS MUST BRING COPY OF TAX NUMBER.**

**OUT OF STATE AGRICULTURE BUYERS CONTACT AUCTION COMPANY FOR INFORMATION REGARDING OKLAHOMA AGRICULTURE EXEMPTION.**

## INFORMATION

**Mike Graham Auctioneers**  
580/658-5553 • 405/403-4303

Visit our website:  
[mgramhamauctioneers.com](http://mgramhamauctioneers.com)

## AUCTION LOCATION

**Bruce Jones Construction Yard**  
East of Lindsay on Hwy. 19 and intersection of 59B, go north on 59B approximately 1 & 1/4 mile, west side of Hwy.

**TAX EXEMPT  
BUYERS MUST  
BRING COPY OF  
TAX NUMBER**

## ACCOMMODATIONS

**Best Western Hotel**  
Hwy. 76 & Hwy. 19  
Lindsay, OK

## AIRPORT

**Oklahoma City Will Rogers**  
918-426-1463

## LIVE & ONLINE AUCTION

In the event the auction cannot have onsite bidders then the auction will go virtual online with auctioneer. It is best to pre-register online in the event of a shut down. We will follow CDC and State regulations on social distancing, mask wearing etc. for preview days and sale day.

**Can't  
Attend?**

**"Unable to attend this auction? Now you can bid from ANYWHERE!"**  
**Go to [mgramhamauctioneers.com](http://mgramhamauctioneers.com)**

All purchases made will be subject to an internet fee of 2% of the purchase price. Internet Buyers must pre-register by 1:00 p.m. Thursday, January 21st.

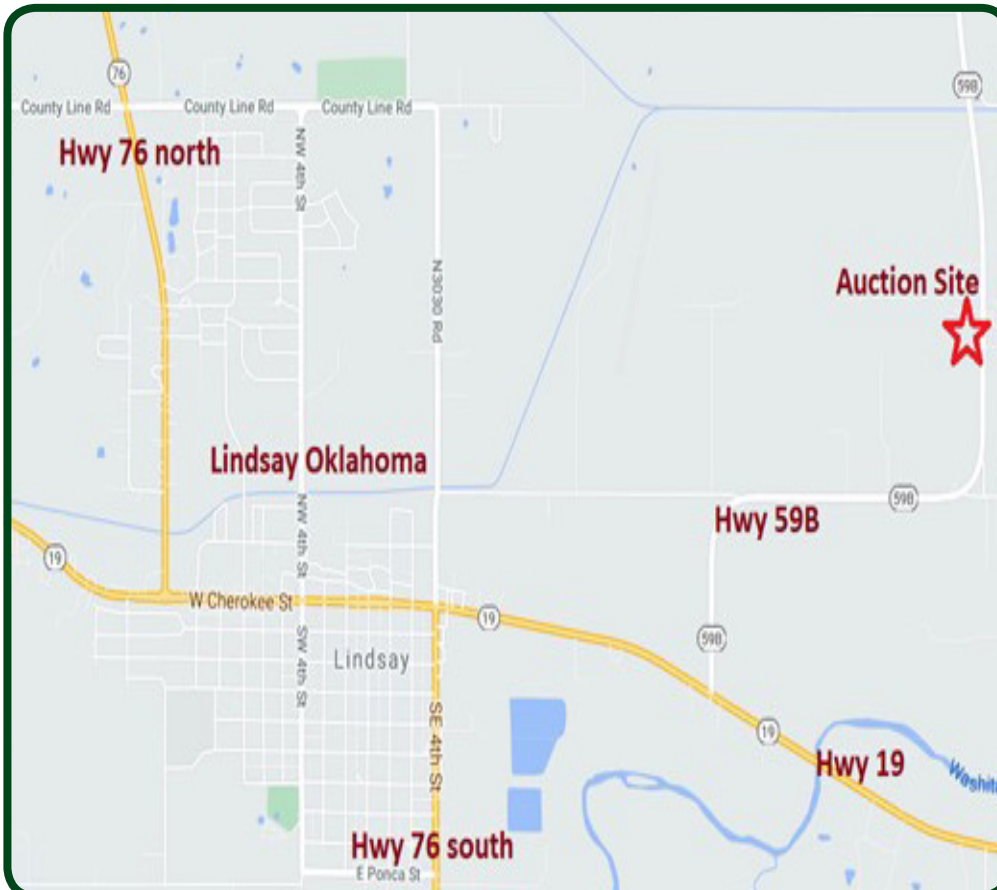

## CONSTRUCTION EQUIPMENT

### Cat D6D Crawler

**Tractor**, s/n 6v3247, s/blade w/tilt, sweeps, cab, hour meter reads 2276 hrs, winch.

### Cat D6D Crawler

**Tractor**, s/n 4x4441, s/blade w/tilt, sweeps, cab, hour meter reads 2895 hrs, winch.

**John Deere 770BH Motor Grader**, s/n 549838, 14' m.b, cab, hour meter reads 12784 hrs, ripper.

### 2012 John Deere 310SK

**4x4 Loader Backhoe**, s/n 232749, g.p bkt, cab, hour meter reads 4502 hrs, extendahoe, bkt.

### 2001 Case 580 Super M

**4x4 Loader Backhoe**, s/n 0280152, g.p bkt, cab, hour meter reads 7204 hrs, extendahoe, bkt.

### 1995 Case 580 Super L

**Loader Backhoe**, s/n 0189086, g.p bkt, cab, hour meter reads 7004 hrs, extendahoe, bkt.





### TRUCK TRACTORS DUMP TRUCKS WATER TRUCKS

**2019 Mack CHU613 T/A Truck Tractor,**  
s/n 1m1an07y1km028600,  
mack mp8 505c eng, eaton  
13 spd trans, od reads 49735  
miles, hour meter reads 1629  
hrs, def, a/r.

**2015 Mack CHU613 T/A Truck Tractor,**  
s/n 1m1an07y7fm019681,  
mack mp8 505c eng, eaton  
13 spd trans, od reads 201352  
miles, def, nve challenger 607  
pump, tula winch, a/r.

**2015 Mack CHU613 T/A Truck Tractor,**  
s/n 1m1an07yxfm020825,  
mack mp8 505c eng, eaton  
13 spd trans, od reads  
208089 miles, def, nve  
challenger 607p-fd pump, a/r.

**2006 Mack CHN613 T/A Truck Tractor,**  
s/n 1m1aj06y66n003592,  
mack e7 427 eng, eaton  
13 spd trans, od reads 388518  
miles, hour meter reads 15440  
hrs, wallenstein pump, a/r.

**2003 Mack CH613 T/A Truck Tractor,**  
s/n 1m1aa18y53w150771,  
mack e7 427 eng, eaton 13 spd  
trans, od reads 465511 miles,  
hour meter reads 16113 hrs.



### TRUCK TRACTORS DUMP TRUCKS WATER TRUCKS

**2007 Mack CXN612 S/A Truck Tractor,**  
s/n 1m1ak01y67n004506,  
mack ac 310/330 eng, meritor  
10 spd trans, od reads 234322  
miles, 5th wheel plate, pintle  
hitch, a/r.

**2001 Mack CH612 S/A Truck Tractor,**  
s/n 1m1aa08y91w023240,  
mack e7 eng, eaton 10 spd  
trans, od reads 402506 miles,  
toolbox, 5th wheel plate,  
gooseneck ball, pintle hitch, a/r.

**2007 Mack CHN613 T/A Dump Truck,**  
s/n 1m1aj07y57n008492,  
mack eng, maxitorque es  
13 spd trans, od reads 419157  
miles, 14-16yd dump bed,  
electric tarp, a/r.

**1985 Freightliner FLC T/A Dump Truck,**  
s/n 1fupysyb2fh251985, cat eng,  
9 spd trans, od reads 556450  
miles, 14-16 yd bed, a/r.

**1992 Ford F700 S/A Dump Truck,**  
s/n 1fdnk74c2pva08848,  
diesel eng, 6 spd trans, od  
reads 164340 miles.

**2004 Freightliner FL70 S/A Water Truck,**  
s/n 1fvabtak44hm60340,



### TRUCK TRACTORS DUMP TRUCKS WATER TRUCKS

cat 3126 eng, 6 spd trans, od  
reads 251215 miles, front &  
rear spray bar, rear gravity bar.

**1999 Freightliner FL70 S/A Water Truck,**  
s/n 1fv6hfaaxxhb50181,  
cummins 24 valve eng, auto  
trans, od reads 48539 miles,  
front & rear spray bar, rear  
gravity bar.

### PICKUPS

**2012 Chevy Silverado 3500 Crewcab 4x4 Flatbed Pickup,**  
s/n 1gb4kzc67cf231055, v8  
gas eng, auto trans, od reads  
156131 miles.

**2009 Chevy Silverado 2500 4x4 Extcab Pickup,**  
s/n 1gchk59k49e159585, v8  
gas eng, auto trans, od reads  
239228 miles.

**2007 Chevy Silverado 2500 4x4 Crewcab Pickup,**  
s/n 1gchk23k07f505095, v8  
gas eng, auto trans, od reads  
281358 miles.

**2007 Dodge Ram 3500 4x4 Crewcab Flatbed Pickup,**  
s/n 3d6wh48a386116141,  
cummins eng, 6 spd trans, od  
reads 149542 miles.







## PICKUPS cont.

### 2001 Ford F350 Flatbed Pickup,

s/n 1fdsf34f92ea34012, pwr stroke eng, auto trans, od reads 258930 miles.

### 2001 Dodge Ram 2500 4x4 Extcab Pickup,

s/n 1b7kf23z81j604176, v8 gas eng, auto trans, od reads 150057 miles, fuel tank.

### 2000 Dodge Ram 1500 Extcab Pickup,

s/n 1b7hc13y81j280909, v8 gas eng, auto trans, od reads 178097 miles.

### 1997 Ford F350 Flatbed Pickup,

s/n 3felf47f2vma58359, pwr stroke eng, 5 spd trans.

### 1996 Ford F150 XLT Extcab Pickup,

s/n 1ftex15n9tka59312, gas eng, auto trans, od reads 150033 miles, toolbox.

### 1992 Chevy Silverado 1500 Extcab Pickup,

s/n 2gcec19k3n1144385, v8 gas eng, auto trans, od reads 155662 miles.

### 1983 Chevy Scottsdale 20 Pickup,

s/n 1gcgc24w0ds152810, v8 gas eng, auto trans, od reads 100752 miles.



## VACUUM TRAILERS

### 2015 PCI 130BBL T/A Vacuum Trailer,

s/n 56cpa1u29ft600526, s/r.

### 2015 PCI 130BBL T/A Vacuum Trailer,

s/n 56cpa1u29ft600428, s/r.

### 2013 PCI 130BBL T/A Vacuum Trailer,

s/n 56cpa1u43dt600181, s/r.

## BELLY DUMP ROCK TRAILERS

### 2000 CPS T/A Singlegate Belly Dump Rock Trailer,

s/n 4z4111622yp003081, s/r.

### 1992 CPS T/A Singlegate Belly Dump Rock Trailer,

s/n 1cp99962xnp389447, s/r.

### 1999 CPS T/A Singlegate Belly Dump Rock Trailer,

s/n 4z4111624xp002089.

### 1995 Belt Mfg T/A Singlegate Belly Dump Rock Trailer,

s/n 1c9ss4022s1424315.

## EQUIPMENT TRAILERS

### 2006 Belshe 25' Pintle Hitch T/A Flatbed Trailer,

s/n 16jf0252961041820, 5' dove w/ramps.

### Belshe 20' Pintle Hitch T/A Flatbed Trailer,

s/n 16jf0192421036684, 5' dove w/ramps.



## EQUIPMENT TRAILERS cont.

### 2005 Transcraft TL2000H Spread Axle Flatbed Trailer,

48'x102", Bill of Sale.

### Belshe DT-22 Pintle Hitch Flatbed Trailer,

s/n 16jf0192111036236, 5' dove w/ramps.

### Belshe DT235 Pintle Hitch Flatbed Trailer,

s/n 16jf02028v1030569, 5' dove w/ramps.

### Belshe T4 Pintle Hitch Tri Axle Flatbed Trailer,

s/n 16jf01835r1025553, 5' dove w/ramps.

### 1998 Oklahoma Trailer MFG 25' Pintle Hitch T/A Flatbed Trailer,

s/n 0932, 5' dove w/ramps.

### Oklahoma Trailer MFG 25' Gooseneck Flatbed Trailer,

s/n 4y4gd3027wc000331, 5' dove w/ ramps.

### 1997 Oklahoma Trailer MFG 28' Gooseneck T/A Flatbed Trailer,

4' dove.

### 36' Gooseneck T/A Flatbed Trailer.

### CM 14' T/A Enclosed Bumperpull Trailer.

(5) 16' Bumperpull T/A.







## EQUIPMENT TRAILERS cont.

**28' Bumperpull T/A Pipe Trailer.**

**10' Bumperpull S/A Trailer**  
w/ porta potty.

**2016 RoadBoss 16' T/A  
Trash Trailer,**  
s/n 520tr1629hp009747.  
**(4) 16' Bumperpull T/A  
Trash Trailer.**

## FARM TRACTORS

**John Deere 2440 Farm  
Tractor,** s/n 264575t, canopy,  
hour meter reads 3155 hrs,  
3pt, 540 pto, 1 remote.  
**Ford 2600 Farm Tractor,**  
3pt, 540 pto.  
**Cimarron 6' 3pt Disc.**  
**John Deere MX7 7' 3pt  
Brush Hog.**

## MISCELLANEOUS

**Miller Bobcat 250 Welder/  
Generator,** kohler gas eng,  
hour meter reads 1831 hrs.  
**Miller Bobcat 250 Welder/  
generator,** kohler gas eng,  
hour meter reads 288 hrs.  
**30 Gallon Air Compressor,**  
Kohler gas eng.  
**(2) Grease Hose Reels.**  
**Air Hose Reel.**



## MISCELLANEOUS cont.

**Poly Pipe Fusion Machine.**  
**Rigid Pipe Treader 1/8 to 2".**

**(2) Backhoe Bkts.**

**Gannon Backhoe Bkt.**

**Excavator Bucket.**

**Hensley Rock Bucket.**

**Various Fittings.**

**Truck Tires.**

**Pickup Tires.**

**Tractor / Implement Tires.**

**Catwalks & Ladders.**

**Skidded Pump Jack &**

**Fiberglass Tank.**

**Various Culverts.**

**Large Fiberglass Tank.**

**(6) Large Metal Tanks.**

**Various plastic pipe.**

**Assorted chain link  
fencing.**

**Marathon 75 hp electric  
motor.**

**(3) Concrete Storm  
Shelters.**

**Cross ties approx 60.**

**Wooden Posts.**

**Hyd Cattle Chute.**

**Various Tool Boxes.**

**(3) L Shape Fuel tanks.**  
**Tools.**





RETURN TO

Graham Auctioneers  
403 W. Main  
Marlow, OK 73055

FIRST CLASS MAIL  
Presorted  
U.S. Postage PAID  
Denton, TX  
Permit No. 438

FIRST CLASS MAIL

## BRUCE JONES OILFIELD CONSTRUCTION EQUIPMENT AUCTION



**UPCOMING  
AUCTION**  
March 12th - 13th  
Elk City, Oklahoma  
For more information  
go to [mgramhamauctioneers.com](http://mgramhamauctioneers.com)

