

# EXHIBIT HALLS, BALLROOMS AND MEETING ROOMS



## Level

## Exhibit Halls, Ballrooms and Meeting Rooms



	Dimensions	GSF	Theatre	Classroom 30' Tables	Classroom 18' Tables	Banquet 66" Round	Ceiling Height Footage	Booths 10' x 10'
<b>Exhibit Halls</b>								
Exhibit Hall 1	210' x 210'	44,100	4,032	1,728	2,464	(As drawn)	31	225
Exhibit Hall 2	120' x 272'	32,640	3,024	1,300	1,600	(As drawn)	31	179
Exhibit Hall 3	181' x 272'	49,232	4,392	2,052	2,568	(As drawn)	31	280
Exhibit Hall 4	260' x 305'	79,525	5,285	3,954	4,838	(As drawn)	31	410
Exhibit Hall 5	183' x 227'	41,555	3,600	1,982	2,402	(As drawn)	31	195
<b>Totals (1-5)</b>		<b>247,052</b>	<b>20,333</b>	<b>11,016</b>	<b>13,872</b>			<b>1,289</b>
<b>Ballrooms Level 1</b>								
		<b>Sq. Footage</b>						
Ballroom A	104' x 147'	15,288	1,432	724	766	994	35	
Ballroom B	53' x 73'	3,896	373	164	176	224	35	
Ballroom C	58' x 73'	4,234	396	184	200	254	35	
<b>Totals (A,B,C)</b>		<b>23,418</b>	<b>2,291</b>	<b>1,012</b>	<b>1,135</b>	<b>1,644</b>		
<b>Meeting Rooms Level 1</b>								
1	29' x 31'	996	83	47	54	64	9	
2	28' x 38'	1,121	112	62	64	64	18	
3	34' x 45'	1,576	157	76	89	104	18	

Room dimensions are based on usable space. They do not include alcoves, angled walls or entry ways; therefore, the dimensions may be less than the gross square footage.

# MEZZANINE LEVEL SHOW OFFICES

# 2

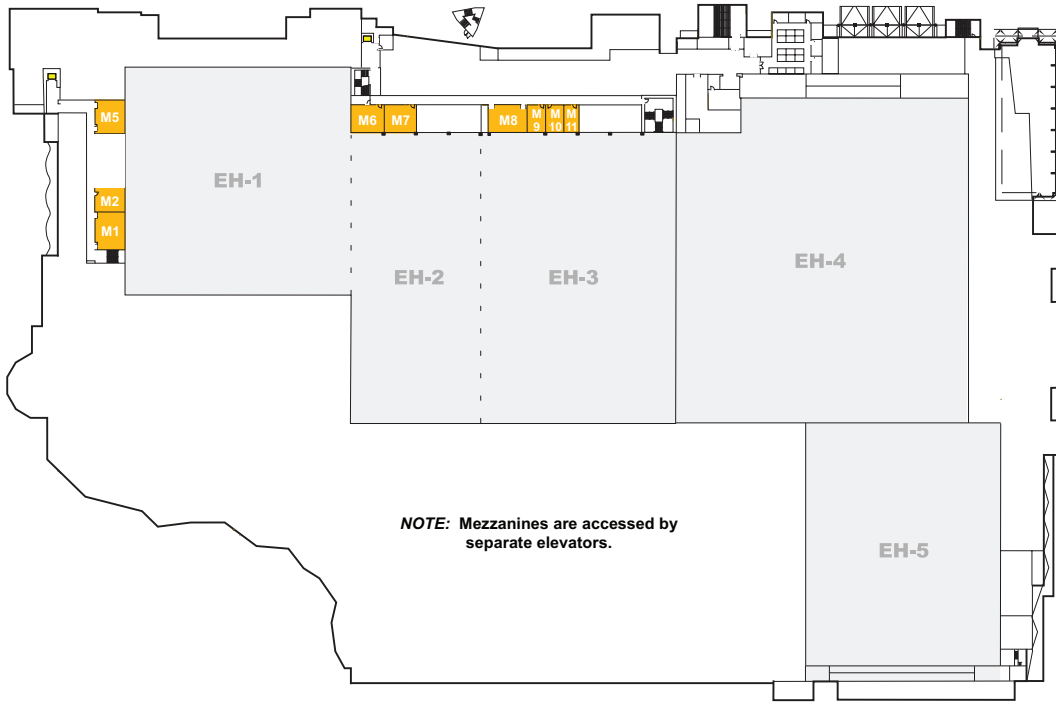

## Level

# 2

## Mezzanine Level Show Offices

### Show Offices

Show Offices	Dimensions	GSF
ML Show Office 1	27' x 35'	950
ML Show Office 2	21' x 27'	586
ML Show Office 5	27' x 30'	850
ML Show Office 6	26' x 28'	928
ML Show Office 7	26' x 30'	880
ML Show Office 8	22' x 36'	826
ML Show Office 9	16' x 24'	399
ML Show Office 10	16' x 25'	500
ML Show Office 11	13' x 24'	375

# AUSTIN SUITE, MEETING ROOMS

# 3



## Level

## Austin Suite, Meeting Rooms and Show Offices

# 3

	Dimensions	GSF	Theatre	Classroom 30" Tables	Classroom 18" Tables	Banquet 66" Rounds	Ceiling Height Footage
4A	26' x 29'	770	84	34	41	44	17
4B	17' x 26'	442	48	22	25	24	17
4C	21' x 28'	595	68	28	32	34	17
<b>4 (A, B, C)</b>		<b>1807</b>	<b>184</b>	<b>79</b>	<b>100</b>	<b>104</b>	17
5A	22' x 35'	770	78	36	36	44	17
5B	23' x 29'	840	68	32	31	44	17
5C	25' x 29'	875	69	27	31	44	17
<b>5 (A, B, C)</b>		<b>2485</b>	<b>225</b>	<b>88</b>	<b>104</b>	<b>124</b>	17
6A	42' x 38'	1806	177	88	95	114	17
6B	35' x 37'	1512	144	74	74	94	17
<b>6 (A, B)</b>		<b>3318</b>	<b>331</b>	<b>158</b>	<b>193</b>	<b>204</b>	17
7	28' x 38'	1287	120	64	62	64	17
8A	26' x 38'	1014	95	37	40	44	17
8B	20' x 31'	780	61	25	28	44	17
8C	34' x 31'	1365	113	53	57	64	17
<b>8 (A, B, C)</b>		<b>3159</b>	<b>298</b>	<b>114</b>	<b>144</b>	<b>174</b>	17
9A	26' x 42'	1274	125	54	64	64	17
9B	30' x 42'	1470	147	67	76	64	17
9C	49' x 42'	2401	272	106	118	124	17
<b>9 (A, B, C)</b>		<b>5145</b>	<b>504</b>	<b>229</b>	<b>289</b>	<b>324</b>	17
10A	30' x 37'	1318	130	56	69	84	17
10B	45' x 42'	1913	188	83	101	104	17
<b>10 (A, B)</b>		<b>3231</b>	<b>319</b>	<b>144</b>	<b>172</b>	<b>184</b>	17
10C	29' x 46'	1350	131	56	76	74	12
Austin Suite	37' x 43'		▶ Permanent seating for 24 with full AV/IT capabilities				
Show Office 12	19.5' x 28'	546					
Show Office 13	20' x 28'	560					
Show Office 14	20' x 27'	540					
Show Office 15	19.5' x 21'	409.5					
Show Office 16	19.5' x 21'	409.5					

# GRAND BALLROOM, MEETING ROOMS

# 4

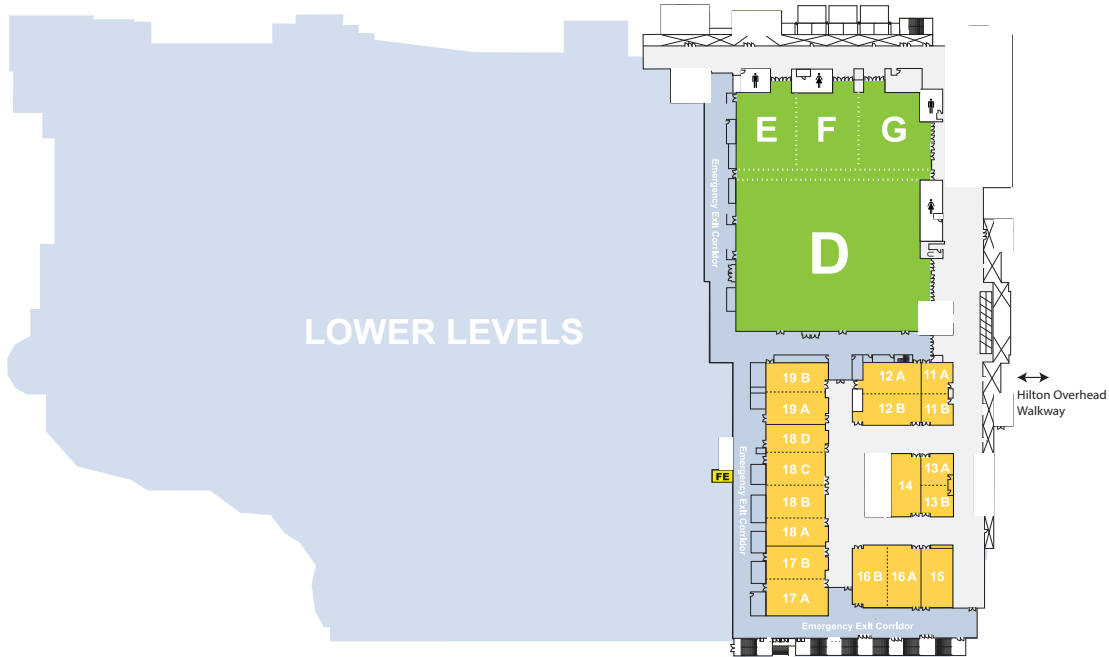

## Level

## Grand Ballroom and Meeting Rooms

# 4

	Dimensions	GSF	Theatre	Classroom 30" Tables	Classroom 18" Tables	Banquet 66" Rounds	Ceiling Height Footage
Ballroom D	148' x 178'	26,540	2,408	1,236	1,516	1,824	26
Ballroom E	72' x 59'	4,470	471	212	274	274	26
Ballroom F	72' x 59'	4,570	481	243	293	274	26
Ballroom G	72' x 68'	4,930	452	194	235	274	26
<b>Totals (D-G)</b>		<b>40,510</b>	<b>3,940</b>	<b>2,172</b>	<b>2,488</b>	<b>3,084</b>	26
<b>Meeting Rooms Level 4</b>							
11A	24' x 30'	827	70	34	41	44	15
11B	27' x 24'	770	70	33	40	44	15
<b>11 (A, B)</b>		<b>1,597</b>	<b>160</b>	<b>72</b>	<b>94</b>	<b>104</b>	15
12A	30' x 54'	1,690	200	88	109	114	15
12B	31' x 54'	1,750	190	93	105	114	15
<b>12 (A, B)</b>		<b>3,440</b>	<b>393</b>	<b>172</b>	<b>211</b>	<b>244</b>	15
13A	23' x 29'	815	67	37	47	44	15
13B	23' x 26'	754	67	33	40	44	15
<b>13 (A, B)</b>		<b>1,569</b>	<b>152</b>	<b>79</b>	<b>94</b>	<b>104</b>	15
14	55' x 28'	1,650	207	104	128	94	15
15	28' x 57'	1,617	207	104	128	94	15
16A	32' x 57'	1,859	202	115	124	124	15
16B	33' x 59'	1,952	230	123	137	124	15
<b>16 (A, B)</b>		<b>3,811</b>	<b>424</b>	<b>207</b>	<b>257</b>	<b>244</b>	15
17A	56' x 36'	2,103	257	124	156	144	15
17B	56' x 31'	1,790	219	102	128	134	15
<b>17 (A, B)</b>		<b>3,893</b>	<b>488</b>	<b>211</b>	<b>273</b>	<b>254</b>	15
18A	56' x 26'	1,516	181	88	110	94	15
18B	56' x 32'	1,803	222	110	138	124	15
18C	56' x 32'	1,803	222	108	136	124	15
18D	56' x 26'	1,503	182	85	107	94	15
<b>18 (A, B, C, D)</b>		<b>6,625</b>	<b>820</b>	<b>378</b>	<b>466</b>	<b>504</b>	15
19A	56' x 30'	1,790	212	102	128	124	15
19B	56' x 28'	1,610	184	94	118	94	15
<b>19 (A, B)</b>		<b>3,400</b>	<b>424</b>	<b>185</b>	<b>235</b>	<b>274</b>	15