

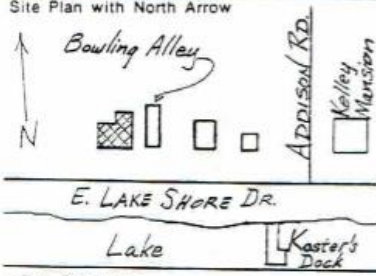

# OHIO HISTORIC INVENTORY

No. <b>ERI-1642</b>		4. Present Name(s) <b>The Himmelein House</b>		1. No. <b>ERI-1642</b>
<b>ERIE</b>		5. Other Name(s)		
Location of Negatives <b>O.H.S.</b>				2. County <b>Erie</b>
Specific Location <b>E. Lake Shore Dr., west of Addison Rd.</b>		16. Thematic Category <b>Commerce, ethnic</b>		
City or Town If Rural, Township & Vicinity <b>Kelleys Island</b>		17. Date(s) or Period <b>c.1859</b>		4. Present Name(s) <b>The Himmelein House</b>
Site Plan with North Arrow 		18. Style or Design <b>Stick</b>		
U.T.M. Reference <b>7 3 5 76 5 0 4 6 0 5 8 5 0</b>		19. Architect or Engineer		6. Specific Address or Location <b>The Himmelein House</b>
13. Easting Northing Site <input type="checkbox"/> Structure <input type="checkbox"/> Building <input checked="" type="checkbox"/> Object <input type="checkbox"/>		20. Contractor or Builder		
11. National Register? Yes <input checked="" type="checkbox"/> No <input type="checkbox"/>		21. Original Use, if apparent <b>Hotel</b>		3. Present Name(s) <b>The Himmelein House</b>
12. Is it Eligible? Yes <input type="checkbox"/> No <input type="checkbox"/>		22. Present Use <b>Pvt. Residence</b>		
14. District Potent? Yes <input type="checkbox"/> No <input type="checkbox"/>		23. Ownership Public <input type="checkbox"/> Private <input checked="" type="checkbox"/>		7. Date of Survey <b>1985</b>
Name of Established District <b>K.I. South Shore District</b>		24. Owner's Name & Address, if known <b>Robert I. Coulon 47782 Sonnett Dr. Mt. Clemens, Mich</b>		
42. Further Description of Important Interior and Exterior Features (Continue on reverse if necessary)		25. Open to Public? Yes <input type="checkbox"/> No <input checked="" type="checkbox"/>		8. Date of Inventory <b>1985</b>
43. History and Significance (Continue on reverse if necessary) <b>This fine, three story Victorian structure grew from a modest three room house, to one of the show places of Kelleys Island. It was built by Johann and Johanna Himmelein ca. 1859 on a 4 acre tract purchased from Alfred S. Kelley. Some uncertainty as to the exact</b>		26. Local Contact Person or Organization <b>Kevin Pape: KI Hist Survey</b>		
44. Description of Environment and Outbuildings (See #52) <b>Located on a bluff above the lake, the former hotel is still shaded by a few remaining poplars that once had formed a grove at its front. There had formerly been a drive curving up to the porch entrance from either</b>		27. Other Surveys in Which Included <b>N/A</b>		9. Date of Inventory <b>1985</b>
45. Sources of Information <b>Census Records, Erie County, Ohio 1886, 1893, 1938 Sanborn Insurance Maps 1870, 1880, 1887, 1890 Erie County Grand List for KI</b>		28. No. of Stories <b>3 1/2</b>		
		29. Basement? Yes <input type="checkbox"/> No <input checked="" type="checkbox"/>		10. Date of Inventory <b>1985</b>
		30. Foundation Material <b>Lm. St. Coursed rubble</b>		
		31. Wall Construction <b>Wood frame</b>		11. Date of Inventory <b>1985</b>
		32. Roof Type & Material		
		33. No. of Bays Front Side		12. Date of Inventory <b>1985</b>
		34. Wall Treatment <b>Beveled siding</b>		
		35. Plan Shape <b>Irregular</b>		13. Date of Inventory <b>1985</b>
		36. Changes (Explain in #42) Addition <input type="checkbox"/> Altered <input checked="" type="checkbox"/> Moved <input type="checkbox"/>		
		37. Condition Interior <b>Good</b> Exterior <b>Excel.</b>		14. Date of Inventory <b>1985</b>
		38. Preservation Underway? Yes <input type="checkbox"/> No <input checked="" type="checkbox"/>		
		39. Endangered? By What? Yes <input type="checkbox"/> No <input checked="" type="checkbox"/>		15. Date of Inventory <b>1985</b>
		40. Visible from Public Road? Yes <input checked="" type="checkbox"/> No <input type="checkbox"/>		
		41. Distance from and Frontage on Road <b>75' / 135</b>		16. Date of Inventory <b>1985</b>
		46. Prepared by <b>H. Coulona Betty &amp; Kevin Pape</b>		
		47. Organization <b>KI Planning Commis</b>		17. Date of Inventory <b>1985</b>
		48. Date Recorded in Field <b>1985</b>		
		49. Revised by		18. Date of Inventory <b>1985</b>
		50a. Date Revised		
		50b. Reviewed by		19. Date of Inventory <b>1985</b>

51. Condition of Property

- |                                       |   |
|---------------------------------------|---|
| <input type="checkbox"/> Excellent    | <input type="checkbox"/> Ruin             |
| <input type="checkbox"/> Good/Fair    | <input type="checkbox"/> Destroyed/Burned |
| <input type="checkbox"/> Deteriorated | Date _____                                |

52. Historic Outbuildings and Dependencies

Barn Type(s)

\_\_\_\_\_

- |  |                                       |                                 |
|--|---------------------------------------|---------------------------------|
| Corn Crib or Shed <input type="checkbox"/>           | Smoke House <input type="checkbox"/>  | Privy <input type="checkbox"/>  |
| Summer Kitchen <input type="checkbox"/>              | Spring House <input type="checkbox"/> | Garage <input type="checkbox"/> |
| Silo <input type="checkbox"/>                        | Ice House <input type="checkbox"/>    |                                 |
| Designed landscape features <input type="checkbox"/> |                                       |                                 |

53. Affiliated OAI Site Number(s) \_\_\_\_\_ one \_\_\_\_\_ multiple

Archaeological Feature:	Observed	Expected on Basis of Archival Research
Well	_____	_____
Privy	_____	_____
Cistern	_____	_____
Foundation	_____	_____
Structural Rubble	_____	_____
Formal Trash Dump	_____	_____
Other _____	_____	_____

54. Farmstead Plan

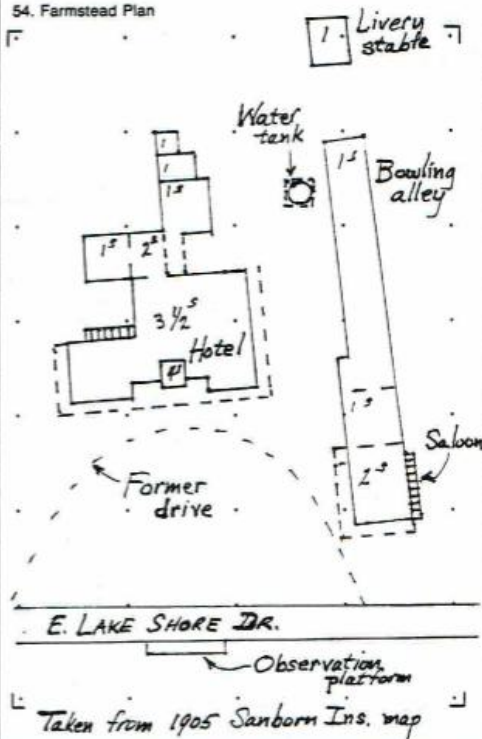

43 Cont'd

date of purchase exists. Aldrich cites 1859; Erie County Records gives date as August, 1864 (Vol 21, pgs 576 & 77); a deed from A.S. Kelley to Frederick Gehrkin of May 1863 uses "the north-east corner of land contracted by A.S. Kelley to John Himmelein" as a point of reference; and the 1860 Census finds the family living at the present site. These factors point to the certainty that the property was purchased on a land contract ca. 1859-60, and deeded outright in 1864. (There is historic evidence of this method being used frequently by the Kelleys.)

Family tradition indicates that Johann built the original core as a residence, but he and his wife were such popular hosts that they decided to convert their home to a hotel. Aldrich gives this date as 1861 and the 1870 Census does find Johann listed as a Hotel Keeper. An interesting question is raised in the 1860 Census, however, as it records Johann's occupation as Saloon Keeper and shows him boarding three other "saloon keepers" as well. This would indicate an establishment of some size that would use four bartenders, and it is possible to surmise that John and his boarders would have been working for the Kelley's Island House Hotel located nearby at what is now the Village Park.

The business did prosper to the extent that the Himmeleins enlarged their building in 1875 with the addition of two wings, and in 1876, "additional improvements" were made. This may refer to the two story saloon erected on the grounds east of the hotel building. Joahnn had also set out vineyards to the rear of his hotel, pressing about 200 barrels of wine yearly that would have served his guests.



## OHIO HISTORIC INVENTORY

ERIE COUNTY  
 ERI-1642  
 O.H.S.

The Himmelein House

## 43. (Cont'd.)

Johann died in 1879, but his wife carried on the family business and planned even greater improvements, for in 1882 a third floor and handsome central turret were added to the hotel building which could now accommodate 100 guests.

Aided by her sons, Charles, John and Richard, many additional amenities were added including the construction of a summer kitchen, livery stable, and water tower with pump for running water. In 1886 a bowling alley, or skittles alley as it was then called, was built a few feet to the north of the saloon with a room in front for billiards. Newspaper articles and Nichol's Guide Book of 1888 describes the hotel as being "set in a lovely grove of poplar trees facing the lake with every facility to cater to the pleasures of the excursionist, with spacious rooms and suites to accommodate both short and long term stays, a dining room to seat 125 guests noted for its delicious cuisine where dances and masquerades were held; a bathing beach equipped with bath houses, safety ropes and floats, and a bandstand and viewing platform on the lawn." Many guests stayed for the entire season, and accommodations for servants were provided on the third floor.

After the mother's death, sons John and Richard Himmelein, carried on the business for a few years. Since the early 1880's the Howard Wall Model Comedy Company had used the hotel as a base to study their seasonal repertoire, frequently putting on performances at the island's Town Hall (ERI-1560). Through this contact, young John became enamored of the stage and joined this stock company as its agent. His work took him off the island a great part of the year. Finally, ca. 1915 the Himmelein House ceased operation as a hotel, and in 1920 shares of the holdings were divided among the heirs who then used the building for their summer residence, and thus it remains to this date.

## 44. (Cont'd.)

side of the property which was fronted by a picket fence. The fence and drive are gone now, and high water has covered any vestige of beach and bath house. However, the stairs to the beach and remains of an old observation platform can still be seen on the south side of the road. The drive has been replaced by a smooth lawn, and the summer kitchen moved to the east property line, and used for storage. The saloon was razed before 1920, but the bowling alley remains, converted to a summer cottage in 1922 by Richard Himmelein and Fritz Pape. (See ERI-1643). All other out-buildings are gone.

45. (Cont'd.)

Nichol's Handy Guide to Put-In-Bay, Middlebass, & Kelleys Island. 1888.  
The Sandusky Library

The Sandusky Register, June 17, 1872 and August 19, 1885, Hayes Center  
"The Islander II", September, 1937

Johannsen, Kyle. "The Wine Growing Industries of the Lake Erie Islands.  
Region". Masters Thesis, Bowling Green University., Ohio.

The Hamilton Collection, Hays Presidential Center, Freemont, Ohio

Erie County Deeds, Vol 21, pgs. 576 & 77; Vol. 21, p. 100.

Kelleys Island Cemetery Records, KI Branch Library

Helen Himmelein Coulon

F. William Pape