



## Owner's Manual



## PORTABLE SECURITY SAFE with electronic lock

11E20 11E30

### **WARNING**

This product can expose you to chemicals including lead, which is known to the State of California to cause cancer, and DEHP, which is known to the State of California to cause birth defects or other reproductive harm. For more information go to

[www.P65Warnings.ca.gov](http://www.P65Warnings.ca.gov)

V-2021-01

**HERITAGE SECURITY PRODUCTS**

1212 S Naper Blvd Ste 119 #163 Naperville IL 60540-7349 PH: 888-577-9823

**HERITAGE SECURITY PRODUCTS**

## IMPORTANT NOTICES

1. Do not leave safe unattended while open.
2. Keep Children Away from safe.
3. Keep your safe locked and closed at all times when not in use.
4. Place your safe in a cool and dry location.
5. Remember to record the serial number of your safe from the tag on the back of your safe. You will need this serial number for all warranty or customer service inquiries.
6. Electronic media, photographic media and all audio-visual media should not be stored in the safe for fire protection.

## WARNING

**Safe must be secured as detailed in these instructions. Failure to secure the safe can result in death or serious injury.**

## PRODUCT DIAGRAM

Photo of outside of safe



Photo of inside of safe



1. Backlit Buttons
2. Key Hole
3. Battery Compartment
4. Reset Button

- A. Back-Up Keys
- B. Steel Cable

## OPENING THE SAFE FOR THE FIRST TIME



Insert the back up key into the keyhole and turn counterclockwise until the door automatically opens.

**WARNING:** Do not store your back up keys inside the safe.

**NOTE:** You must turn the key back to the locked position before you are able to close and lock the door.

## BATTERY INSTALLATION AND REPLACEMENT

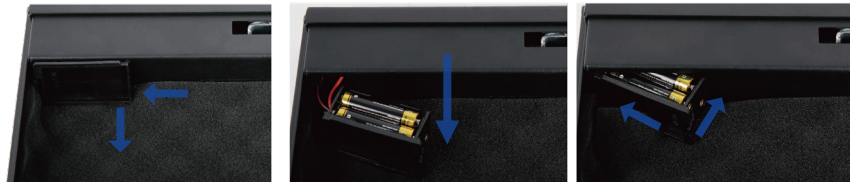

1. Pull the foam upward and away from the battery compartment. Remove the battery compartment by pushing the tab and pulling the compartment out as shown.
2. Install (4) AAA alkaline batteries as shown. Follow the positive (+) and negative (-) guides in the compartment.
3. Reinstall the compartment by hooking the back end in place and snapping shut.

**NOTE:** During the use of safe, Red light flashing indicates low battery. Be careful not to pinch any wires while reinstalling the battery compartment.

## PROGRAMMING YOUR PASSCODE



1. Press the reset button and then release it. There will be 2 audible beeps and all 3 buttons will flash blue twice.
2. Enter your passcode (must be 3-8 button combination). For each combination entry, there will be 1 audible beep and all the buttons will light up green. There will be 5 seconds for each combination entry or you will have to start over from step 1.
3. After you have finished entering your combination, you will have 5 seconds to press the reset button to record your new combination or you will have to start over from step 1. There will be 2 audible beeps and all 3 buttons will flash blue twice. This means your passcode has successfully been entered.
4. If you forget your code, you can use your back up keys at any time to open your safe and reset the code.

**NOTE:** To confirm your combination was entered correctly, turn the key to the locked position (the lid may remain open) and follow the instructions in "unlocking the safe" section.

If the combination you entered does not activate the locking mechanism, you will need to go back to step 1.

## UNLOCKING THE SAFE



1. Input your new 3-8 button combination. The button will light up green and there will be 1 audible beep for each entry.
2. If you entered the correct combination, the buttons will flash green and the safe will open.
3. If the red light flashes with 3 audible beeps, your passcode was not entered correctly, please input your passcode again.

### NOTE:

You will have 2 seconds between individual entries before the safe assumes you have entered your complete combination.

If 3 invalid passcode attempts are made in succession, this will cause the red light to flash with 5 audible beeps and lock the user out for 1 minute. You can still use your back up key at any time to open the safe.

If 1 more invalid passcode attempt is made in succession, this will cause the red light to flash with 5 audible beeps and lock the user out for 5 minutes. You can still use your back up key at any time to open the safe.

There will be 1 audible beep with the green light flashing. This means the lockout period is over.

## LOCKING THE SAFE



To lock your safe, simply push down the top cover closed until locked.

## SECURING THE SAFE



For optimal security, this safe must be mounted to an isolated, dry and secure area.

**WARNING:** THE SAFE SHOULD ALWAYS BE KEPT OUT OF THE REACH OF CHILDREN.

**NOTE:** This case is designed to be secured with a cable that is attached to a fixed object. Failure to do so will compromise the safety and security of the case.

To secure the case to a fixed object, loop the cable around the object and place the cable's small end into the notch on the side of the case. Tip the cable end down while inserting in the notch. Locking the case will secure the cable end inside the case.

## TURNING THE KEYPAD SOUND OFF/ON



1. To turn the "beep" sound off, press all the buttons at the same time and holding for 3 seconds until the green light flashes.
2. To turn the "beep" sound on, press the left and middle button at the same time and hold for 3 seconds until the green light flashes.



## WARRANTY

### LOCK AND PAINTED SURFACE WARRANTY

Locks and painted surfaces are warranted to be free from defects in workmanship and materials for a period of two years from the date of purchase.

Heritage Security Products takes seriously its obligation to stand behind its product with this warranty as long as the safe is properly installed and cared for as instructed in the Owner's Instruction Manual. The warranty does not apply to safes or parts that have been misused, neglected or subjected to unusual or extreme conditions and/or environments, or to unreasonable wear and tear. Changing or modifying the safe in ways that affect its intended use will void this warranty. The safe must be registered within 60 days of the purchase and must be on file at the time of the incident. **Please go to [www.Fortresssafe.com](http://www.Fortresssafe.com) to register your product.**

**Limitation of Remedies:** In no case shall Heritage Security Products be liable for any special, incidental, or consequential damages based upon breach of warranty, breach of contract, negligence, strict tort, or any other legal theory. Such damages include, but are not limited to, loss of profits, loss of savings or revenue, loss of the contents of the safe or vault door, loss of use of the safe or vault door, or any associated equipment, cost of capital, cost of any substitute equipment, facilities or services, downtime, the claims of third parties including customers, and injury to property.

Heritage Security Products provides this warranty in place of all other warranties and assurances whether expressed or implied. Heritage Security Products accepts no liability for incidental or consequential damage or loss by anyone as a result of using this safe.

**This warranty is only applicable to the Safe itself and does not extend to the contents of the Safe.** For optimal security and protection, safes should be bolted down. Please refer to your Instruction Sheet for details on anchoring your safe.



**1-888-577-9823**

**Email: [cs@heritagesafe.com](mailto:cs@heritagesafe.com)**

## KEY REPLACEMENT SERVICE

Upon Verification of ownership, replacement keys are available for purchase through customer service.

Contact Customer Service for more information.

**Remember to record the serial number of your safe from the tag on the back of your safe. You will need this serial number for all warranty or customer service inquiries.**

## NOTES