



# Custom Pushrod Order Form

Part Number:

Date:

## Male-Female Style

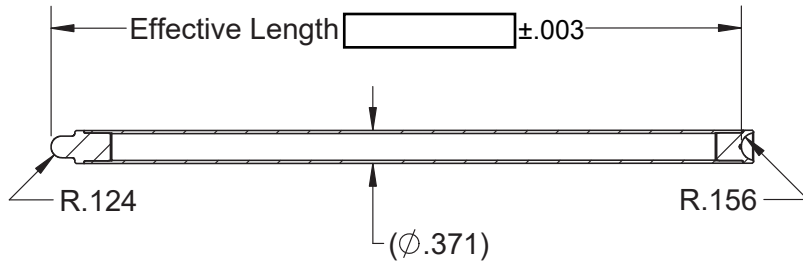

## Female-Female Style

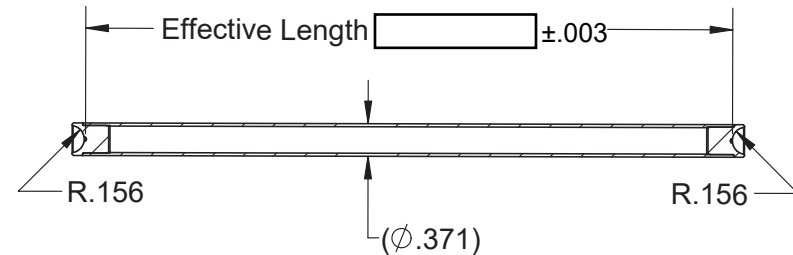

	A:	∅.371 OD	<b>Machining Information:</b> 						
	B:	9.120 Overall Length							
	C:	∅.305 ID Before Machining							
	D	R.156	E	0.420		D	R.124	E	0.675
	F	0.120	G	0.310		F	0.375	G	0.310

[1] Break ID edge only at .015" x 45°

KPMI P/N	Kit Includes	Model	Material	Retail Pricing
90502-2	2 Female Ended Pushrods / 2 Loose Male Endpieces	Various	•Thin Wall Chrome Moly Tube •H.T. Steel Tips	\$63.05
90512-2	2 Female Ended Pushrods / 2 Loose Female Endpieces			
90502-4	4 Female Ended Pushrods / 4 Loose Male Endpieces	Various	•Thin Wall Chrome Moly Tube •H.T. Steel Tips	\$126.13
90512-4	4 Female Ended Pushrods / 4 Loose Female Endpieces			

Customer Information				
Contact Name:				
Company Name:				
Phone:				
E-mail:				
Make:	Model:	Disp:	Years:	

Pushrod Information				
KPMI Blank P/N:	Male-Female			
	90502-2 QTY:		90502-4 QTY:	
KPMI Blank P/N:	Female-Female			
	90512-2 QTY:		90512-4 QTY:	
Custom Work Pricing:	KPMI® will custom machine and finish 2 or 4 pushrods for a flat fee of \$120.00.			
Notes:	Please visit <a href="http://www.kpmi.us">www.kpmi.us</a> for our complete lineup of pushrods and more.			

Customer Approval:		Date:	
--------------------	--	-------	--