

# BATIK MAPLE LEAF BLOCK LOTTO SEPTEMBER 2023

Quilt block 9 1/2" x 9 1/2" unfinished



**Color way: BATIK Fall Colors**

**You will need:**

Fabric A Background – 3ea. – 4" Low Volume Cream Background square

1ea. – 3.5" Low Volume Cream Background square

Fabric B Leaf – 2ea. – 4" Fall Color Batik squares

3ea. – 3.5" x 3.5" Fall Color Batik squares

1ea. – 1.25" x 5" Fall Color Batik rectangle

**Quilt block construction:**

With a 1/4" seam allowance:

1. Make ½ square triangles with the 2 cream 4" background fabrics and 2 batik 4" fabrics.
2. Trim blocks to 3.5". Press seams toward dark fabrics.
3. Stem: Cut a 4" cream square on the diagonal. (fig 1.) Finger press triangle in half. Fold the 1.25" x 5" rectangle in half and finger press a crease (fig 2.) Match up the middle crease of the cream background to the crease of the rectangle stem and stitch a ¼" seam (fig. 3). Do the same for the other side. Trim block to 3.5" sq. (fig.4).

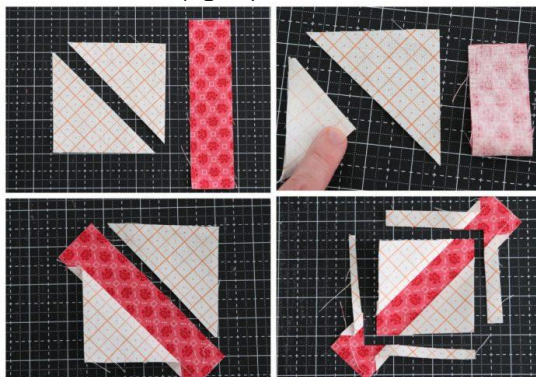

4. Look at the leaf photo for placement of your squares. Sew squares together with a ¼" seam. Press seams.
5. Trim block to 9.5" x 9.5" unfinished.