

# PANGBOURNE MAGAZINE

ISSUE 154    JANUARY/FEBRUARY 2020





**BREEDON  
PLACE**  
PANGBOURNE



**NEW YEAR, NEW HOME,  
NEW MEMORIES**

**OVER 50% SOLD**

Discover 3, 4 & 5 bedroom homes made to Millgate's renowned specification, including generous open-plan rooms, thoughtfully designed kitchens and spacious bedrooms. With a natural play area on your doorstep and surrounding picturesque views, find your dream home today at Breedon Place and make 2020 a year to remember.

**PRICES FROM £595,000**



Visit Our Show Homes Open Daily, 10am - 5pm

0118 4300 040 | [breedonplacebymillgate.co.uk](http://breedonplacebymillgate.co.uk)

Breedon Place, Pangbourne Hill,  
Pangbourne, Berkshire RG8 7FY



Backed by  
HM Government



**MILLGATE**  
Part of the Countryside Group

Help to Buy available on selected plots only. Prices correct at time of print. Computer generated image is indicative only and subject to planning. Interior photography of existing show home at Breedon Place.

## CONTENTS

Local News .....	4
What's On .....	10
Church News .....	15
Pangbourne Sports & Social Clubs .....	18
Local Clubs .....	23
Crossword .....	38
Pangbourne Schools .....	39
Pangbourne College .....	42
Pangbourne Place-Names .....	47
Environmental News .....	50
Council News .....	54
Classified Ads .....	61
Useful Numbers .....	62

Whilst every effort is made to ensure the accuracy of information printed in the Pangbourne Magazine, the Editor and publishers cannot accept any responsibility for the consequences of any errors that may occur. The opinions expressed in this magazine are those of the contributors and are not necessarily those of the Editor or of the Committee. Articles in the Pangbourne Magazine, or the information contained in them, may not be used or reproduced by other publications without the express permission of the Magazine Committee. Whilst care is taken to establish that our advertisers are bona fide, readers are advised to take precautions before entering into any agreement.

## THE PANGBOURNE MAGAZINE

Production/Advertising/Finance:  
**Herald Graphics – 0118 9311488**

Submission of articles\* and adverts:  
**pangbourne@heraldgraphics.co.uk**  
*(\*receipt of an article is not a guarantee of inclusion)*

Deadline for inclusion in the  
 March/April Magazine:  
**Friday, 7 February 2020**  
*(for distribution end of the month)*

Distribution: Jennifer Holmes – 07745 560255



## TIMETABLE CHANGES

The timetable has changed and there will be significant changes to our weekday operation. As well as the time of services changing, many services also have different calling patterns. It is therefore going to be really important for customers, particularly regular travellers, to check the timetable before travel.

This is the biggest change in 40 years, and GWR will be watching closely to make sure all goes as smoothly as possible. Making changes is the culmination of Network Rail's investment in electrification and improved infrastructure, combined with investment in more staff and new trains.

*Mark Hopwood*  
 Managing Director  
 Great Western Railway

### EVENING PEAK RESTRICTIONS DEPARTING LONDON PADDINGTON

Below is a list of weekday departures to Reading between 1600 and 1925 where **OFF-PEAK DAY** tickets and Travelcards are valid until 15 May 2020.

DEPART	ARRIVE	JOURNEY TIME	DESTINATION	OPERATOR
1613	1711	58	Reading	TfL Rail
1628	1727	59	Reading	TfL Rail
1643	1741	58	Reading	TfL Rail
1658	1758	60	Reading	TfL Rail
1713	1811	58	Reading	TfL Rail
1728	1825	57	Reading	TfL Rail
1743	1841	58	Reading	TfL Rail
1756	1844	48	Reading	GWR
1758	1857	59	Reading	TfL Rail
1813	1911	58	Reading	TfL Rail
1826	1914	48	Reading	GWR
1828	1926	58	Reading	TfL Rail
1843	1941	58	Reading	TfL Rail
1849	1930	41	Didcot Parkway	GWR
1856	1944	48	Reading	GWR
1907	1934	27	Bedwyn	GWR
1913	2014	61	Reading	TfL Rail
1920	1955	35	Didcot Parkway	GWR

### ALL OTHER TRAINS REQUIRE ANYTIME OR SEASON TICKETS.

*Customers who start their journey from stations other than London Paddington may be exempt from these restrictions. Please check your ticket is valid before you travel.*

Front cover picture:  
 Pangbourne Meadows (Dec 2019),  
 supplied by Herald Graphics.

IF YOU WOULD LIKE TO SUBMIT A PHOTOGRAPH FOR THE PANGBOURNE MAGAZINE FRONT COVER, PLEASE SEND IT TO PANGBOURNE@HERALDGRAPHICS.CO.UK FOR CONSIDERATION. YOUR IMAGE WOULD NEED TO BE HIGH RESOLUTION AND CONTENT SHOULD BE OF LOCAL INTEREST.



**Finding it difficult getting to medical appointments?**

**Pangbourne & District Volunteer Centre**  
**0118 984 4586**  
**Weekdays 9:30-11:30am**

- Ashampstead
- Basildon
- Pangbourne
- Purley
- Sulham
- Tidmarsh
- Tilehurst (RG31 6xx)
- Whitchurch
- Whitchurch Hill

Registered charity: 276587



## PANGBOURNE – NEWBURY FRIDAY BUS SERVICE

A scheduled bus service now operates every Friday from Pangbourne to Newbury. It departs around 9am and returns at lunchtime. West Berkshire bus passes are valid, or the fare is £4.80 return.

The Route 75 service is provided through the Carebus Volunteer Group (CVG). Their minibus has a wheelchair lift making the service fully accessible.

Pre-booking is essential as the exact pick-up route can vary according to demand. Please telephone 0118 930 4837 before 6pm Thursday.

CVG provides minibus and accessible-car transport for elderly, disabled, isolated and vulnerable people in Pangbourne and surrounding areas of West Berkshire.

If you would like to know more about CVG, Route 75 or other services, or can offer any help as a volunteer driver, please visit, call 0118 930 4837, or email [carebusct@btconnect.com](mailto:carebusct@btconnect.com).

## CHEESE ETC, THE PANGBOURNE CHEESE SHOP NAMED FINALIST IN SHOP OF THE YEAR 2020



The Guild of Fine Food's annual Shop of the Year awards, an accreditation scheme which recognises and promotes excellence in independent retail, has announced its finalists for 2020 and **Cheese Etc, The Pangbourne Cheese Shop** is among those in the running to win the Specialist Cheese Shop category. Having had its written entry reviewed by a panel of respected industry experts, Cheese Etc, The Pangbourne Cheese Shop will now undergo two further rounds of judging, including an announced visit from one of the judges and a mystery shop carried out by Insight6.

Owner and Cheesemonger, Jen tells us "we are honoured to have been shortlisted for the Guild of Fine Food's Shop of the Year. We are a small village shop, so it means a lot to be recognised in this way. We are passionate about providing our customers with an unrivalled selection of Artisan cheeses, many of which are made within 10 miles of Pangbourne and we are so grateful for the support of all our customers, most of whom are local, but some travel quite a distance or use our delivery service to have cheese delivered to their door."

From the overall shopping experience and financial performance to staff training opportunities and environmental initiatives, the panel of highly experienced judges, which includes Edward Berry of The Flying Fork, Stuart Gates, former managing director at Fortnum & Mason and senior buyer at Harrods, award-winning retailer Tracey Colley and food writer, Patrick McGuigan will rate, score and provide feedback on every aspect of Cheese Etc, The Pangbourne Cheese Shop before agreeing on an overall category winner.

Shop of the Year 2020 will reach its exciting finale on 9th March, when the world of fine food gathers at Fodder Farm Shop and Café in Harrogate, to find out the winners of each category.

For more information contact Jen on 0118 984 3323 or [sales@cheese-etc.co.uk](mailto:sales@cheese-etc.co.uk)  
Twitter: @PangCheeseShop  
Instagram: pangcheeseshop



## PANGBOURNE CHRISTMAS EVENING



PHOTO BY COURTESY OF JIM DONAHUE

Thanks to everyone involved with arranging the Village Christmas Event on Friday 6th December, special thanks go to those in the businesses who put in a huge effort, those who helped erect and remove the Village Tree on the forecourt of The George Hotel and particular thanks to owners of the George for giving permission to site it there. Thanks also to all who sold charity raffle tickets, organised carols, to the Silver Band and to anyone who organised other events on the night. Nearly all of these were volunteers who all helped bring a little Christmas sparkle to the village.

Pangbourne Parish Council

## RECOVERY IN MIND

Recovery in Mind is a social enterprise that provides free of charge courses to any adults living in West Berkshire with mental health challenges based at Broadway House in Newbury. Angela Ryan, founder and lead peer trainer says "We enable people to manage their own mental health through attending a wide variety of free courses.

At Recovery in Mind we aim to help people take back control of their lives, find hope and to make the most of life's opportunities, whilst working out their own goals and aspirations and how to work towards them.

We believe that both people who have 'lived experience' of mental health challenges and those who are professionally qualified in the field of mental health share the important role of course trainers. In fact, our peer trainers are people who started out on their journey with Recovery in Mind as students.

Come and experience our courses for yourself by starting out by attending the 'Introduction to Recovery' Bitesize session. We look forward to meeting you soon.

*"A friendly and welcoming place to start your recovery journey."*

*"Recovery in Mind makes you look at mental health issues in a very different way."*

*"I would like to say thank you to the Recovery in Mind team. The course was really helpful and I do feel the benefits after the six week foundation course. I'd like to carry on and join the regular mindful walks and other creative workshops."*

*"I found the courses so helpful – they are not aimed at individual counselling but are about learning/studying together in a safe, caring environment. They are supportive, positive and forward looking; encouraging you to accept yourself and develop your own personal 'wellness toolbox'."*

For more information about Recovery in Mind please visit our website [www.recoveryinmind2016.com](http://www.recoveryinmind2016.com). You can also follow us on Facebook, Twitter or Instagram.





If you have an upcoming event or some news you'd like to tell Pangbourne about, contact us on [pangbourne@heraldgraphics.co.uk](mailto:pangbourne@heraldgraphics.co.uk)

ISSUE	COPY DEADLINE	DISTRIBUTED
155 (Mar/Apr)	7th February	27th February
156 (May/June)	3rd April	30th April
157 (Jul/Aug)	5th June	25th June
158 (Sep/Oct)	7th August	27th August
159 (Nov/Dec)	9th October	29th October



Could you make a difference in your neighbourhood ?

**Drivers needed**

to assist with medical appointments



Mileage reimbursed

Hours to suit you

**Pangbourne & District  
Volunteer Centre**

**0118 984 4586**

**Weekdays 9:30-11:30am**

Registered charity: 276587

## HELEN BOWDEN

11TH NOVEMBER 1973 – 9TH AUGUST 2019



Helen grew up in and lived most of her life in Pangbourne. A tomboy with a wicked sense of humour, Helen was a water baby who especially loved visits to Torquay and the Isles of Scilly.

She fought bravely against the odds, surviving a brain tumour at 10 years old before having to cope with Type 1 diabetes and then two strokes, after which she was not as strong.

Helen was a Venture Scout Leader in Pangbourne and helped several teenagers gain skills and confidence. She enjoyed being Aunty to Ollie and Ava, Richard and Helen's children. Helen was a great character and is fondly remembered for her babysitting skills and storytelling. When in New Zealand on a work placement with College, Helen was thrilled to do two tandem skydives.

She obtained an O.N.D. in Construction and then an H.N.D. in Conservation. Helen was a Park Ranger for nine years in a nature reserve, until her health deteriorated.

We are very proud of her and remember all her achievements and the many happy times we shared together.

Thank you to the residents of Pangbourne for all your support and lovely cards. They have helped us in our time of grief.

*We miss her every day – Helen's family*



## NINO'S LONDON MARATHON 2020

I'm absolutely delighted to announce that I've been offered a place by Duchess of Kent Hospice to run the April 2020 London Marathon. Having supported them for a few years now through our coffee mornings and charitable menu dishes, it's an honour to have been selected to run in such a prestigious fundraising event.



We lost Dad in March of 2018, after being diagnosed terminally ill in October 2017. From the moment dad was admitted to the Duchess of Kent Hospice, the whole team were nothing short of incredible. They were so kind and caring, and throughout Dad's stay we genuinely saw miraculous improvements in him, both physically and emotionally. These improvements are a testament to the amazing care he received, and thanks to the hospice we were able to have so many more quality months with him than the original prognosis suggested. I passionately want to support Sue Ryder so that they can continue to be there for all other families in need, like they were there for us when we needed them.

This will be by far my biggest challenge to date, as other than "running" around the restaurant, I have little previous running experience! The training required will be a huge extra time commitment on top of the long restaurant hours... But anyone that knows me will know that I enjoy a project and love to keep busy! The opportunity ahead is incredibly exciting.

Dad touched so many peoples lives – particularly through his restaurants – and was an incredibly loved member of the community. In his memory, I really hope that people will support me in this fundraiser. I would be so grateful for anything that anyone could donate, no matter how small. You can donate via my fundraising page online at [www.justgiving.com/fundraising/ninoslondonmarathon](http://www.justgiving.com/fundraising/ninoslondonmarathon) or alternatively pop in to see me at the restaurant where we have sponsorship forms! Thank you.

*Nino Junior*



### Would you like to?

- Improve your general health and wellbeing
- Reduce feelings of isolation
- Volunteer your own time and experiences
- Find bereavement support
- Access social groups and parenting classes
- Explore support for housing, employment, benefits, debt and legal advice
- Become more active
- Get involved in your local community
- Discover local self-help groups, clubs and befriending agencies



**If so, make an appointment with the social prescriber at your local GP surgery to help you achieve these goals**

Our social prescribing service is available to anyone registered at Mortimer Surgery, Chapel Row Surgery, The Boathouse Surgery or Theale Medical Centre. Talk to your healthcare professional about a referral. Alternatively, call Lucy Hill on 07933 944 556.

### West Reading Villages PCN

*Mortimer Surgery | Chapel Row Surgery | The Boathouse Surgery | Theale Medical Centre*



## Chiropractic the McTimoney Way

for people and  
small animals

Multi-disciplinary clinic offering integrated  
health care in a friendly, relaxed setting  
**Chiropody & Podiatry**  
**Sports & Remedial Massage**  
**Acupuncture & Homeopathy**

*Suitable for all ages. Free spine check available.  
Evening and weekend appointments available.*

### *For Health Chiropractic*

**0118 984 3473**

Unit 2, The Old Mill  
61 Reading Road  
Pangbourne  
RG8 7HY

[www.forhealthchiropractic.co.uk](http://www.forhealthchiropractic.co.uk)



**everybody  
needs balance**

**indigo blue  
reflexology**

APPOINTMENTS AVAILABLE AT BRADFIELD COLLEGE SPORTS COMPLEX

Contact: **Angela Mitchell (MAR)**  
T: **07909 992348**  
[www.indigoablureflex.co.uk](http://www.indigoablureflex.co.uk)

**GARLANDS**  
organic & natural

**Garlands for high quality food and much more.**  
Seeds, nuts and grains | Sustainably caught fish |  
Organic fruit and veg | Artisan bread | Dairy &  
Non-dairy chilled foods | Speciality and "Free from"  
foods | COOK remarkable food for your freezer | Local  
beer | Organic wines | Health supplements | Natural  
Cosmetics | Eco-friendly household products |  
BOODY bamboo clothing | Candles |  
Essential Oils | Loyalty scheme

6 Reading Road, Pangbourne, RG8 7LY  
0118 9844770 [orders@garlandsorganic.co.uk](mailto:orders@garlandsorganic.co.uk)  
[garlandsorganic.co.uk](http://garlandsorganic.co.uk)

Do you.....

- ◆ Feel stuck in a career rut?
- ◆ Have a business idea you need to sort out?
- ◆ Want help creating a big birthday or bucket list?
- ◆ Just want to figure out what to do next?

**Change Agents**

Sounds like you could do with a local *Change Agents* coach to help you  
unlock the answers.

Take the first step to making that change and contact us for a free  
discovery session.

Email: [wycling@changeagents.co.uk](mailto:wycling@changeagents.co.uk)

**FINNHAIR** Since 1973

Book your hair or beauty  
appointment online now at  
[www.finnhair.co.uk](http://www.finnhair.co.uk)

- ✓ Wella Master Colour Experts
- ✓ Hair-up Specialists
- ✓ Keratin Complex Hair Smoothing
- ✓ Caci non-surgical face lift
- ✓ Nails – Bio Sculpture & OPI Gel
- ✓ Virtually Pain Free Lycon Waxing

[www.finnhair.co.uk](http://www.finnhair.co.uk)

**PANGBOURNE SALON**  
**0118 9842719**



# Nino's

TRATTORIA ITALIANA

FORTY YEARS 1978-2018

*An independent, family run,  
traditional Italian restaurant  
in the heart of Pangbourne.*

Lunch: Tue-Sat 12pm – 2pm

Evening: Mon-Sat 6pm – 10pm

Tel: 0118 984 1333

nino@ninos-trattoria.co.uk

11 READING ROAD, PANGBOURNE RG8 7LR





## Tennis Membership

### Indoor and Outdoor Facilities

Entry to the Club Wimbledon Ballot  
Dedicated Coaching Team with weekly courses  
Preferential rates on our Portugal Tennis holiday packages  
Discounted Rates on Courts and Courses

## Join Now

   @BradfieldTennis





Pangbourne Village Hall

SAT 20<sup>th</sup> JUNE 2020



## Camp Albion

by Danielle Pearson

*'I went to the woods because I wished to live deliberately...'*

Newbury, 1996. Nine miles of ancient woodland under threat, and the local community bitterly divided over the proposed route of the new bypass. When Cassie returns home for the university holidays, she meets Dylan, a beguiling road protester who draws her into a world of rickety treehouses, lentil stew, druidic rituals and stoic resistance. But her mother has other ideas, and as battle lines are drawn, Cassie must face the personal cost of activism.

In a time before smartphones, Twitter, Greta Thunberg and Extinction Rebellion, the 'Third Battle of Newbury' was one of the definitive environmental campaigns of the 1990s. A new play with music, Camp Albion explores the heroism, humour and heated debate of this extraordinary moment in the town's history.

Tickets £15 Available through the Watermill Box Office which is due to open late January



### Tai chi and Qigong classes

in Pangbourne Village Hall on  
Tuesdays 10:30 to 11:30 from January 2020!

Gentle exercise that can have many benefits to health and wellbeing, including improvements in:

- ✓ Posture
- ✓ Co-ordination
- ✓ Balance
- ✓ Strength
- ✓ Concentration
- ✓ Vitality

If you find other forms of exercise too strenuous or if you have difficulty with floor-based classes such as pilates or yoga, this could be a good alternative for you.

For more information or to book please go to  
[www.rookeholistic.co.uk/tai-chi-qigong](http://www.rookeholistic.co.uk/tai-chi-qigong)  
Or call Wendy on 07528 708650  
Email [wendy@rookeholistic.co.uk](mailto:wendy@rookeholistic.co.uk)



Every 3rd MONDAY

2pm to 4pm

20th January and

17th February

2020



Dorman Rooms  
St Bernadettes Church  
Horseshoe Road, Pangbourne  
Contact Di 0118 9842473

## THE UNIQUE DINNER & THEATRE EXPERIENCE



THEATRE, COMEDY,  
MUSIC AND  
DELICIOUS FOOD



ALL SHOW TICKETS  
COME WITH A TWO  
COURSE DINNER!



RIVERSIDE TERRACE  
AND EXCITING  
BAR EVENTS



BOX OFFICE : ☎ (0118) 969 8000 : 💻 [millatsonning.com](http://millatsonning.com)

THE MILL AT SONNING THEATRE LTD. SONNING EYE, READING, RG4 6TY

### THURSDAY CLUB INVITES



We have invited several speakers along to our Thursday Club on different ways to stay safe, including:

Christine, from Nat West, has helped many people with their banking and ensuring they and their money stay safe.

Nat West Bank  
Safe Banking  
and Scams

Fire and  
Rescue

Fire Brigade will speak about safety at home and ways to make you safe.

Age UK would like to inform everybody of the help and benefits which are available to everybody.

Age UK

Please join us in January for tea and cake



Sponsored by **GRAVITY PERS & INTEL**  
and supported by  
The George Hotel and Green's of Pangbourne



For more information contact  
Gill 9841122 or Di 9842473



### Get more out of life in Pangbourne

Pop along for social  
events with the **Oddfellows  
Games & Visits Group.**

**Weds 5 February**  
Mexican Train Dominoes

**Weds 4 March**  
Trivial Pursuits

**Weds 1 April**  
'Beautiful Berkshire' Quiz

Meeting at The Elephant,  
Church Road, Pangbourne  
at 7.30pm til 10pm.

For more information contact  
Doug on **0118 961 4610**



f Reading Oddfellows  
[www.oddfellows.co.uk](http://www.oddfellows.co.uk)

The Oddfellows is the trading name of The Independent Order of Odd Fellows Manchester Unity Friendly Society Limited, Incorporated and registered in England and Wales No. 223F. Registered Office Oddfellows House, 184-186 Deansgate, Manchester M3 3WB.



**Neil Houldey**  
**QUALITY PAINTING AND DECORATING**

- All types of interior and exterior work completed
- General maintenance and repairs undertaken
- Gold CSCS card accreditation
- City & Guilds qualified
- 30 years experience
- Fully insured
- Pangbourne and surrounding areas

**07731 476100 • 0118 9845532**  
**neil.houldey@yahoo.com**



- Tree Surgery
- Tree Felling
- Hedge Cutting
- Logs
- Fencing
- Fully Insured
- Fully Qualified
- Free Quotations
- 24 Hour Callouts
- Competitive Prices

**01488 647204 07979 507 195**  
**robfox@foxestreeservices.co.uk**  
**www.foxestreesurgery.com**  
 Local business based in Newbury

Hedge Cutting Fencing Plant Hire Obstructive Trees Complete Tree Care Stump Grinding

**JWJ INTERIORS**

Providing friendly interior advice, curtains, upholstery and more to clients across Berkshire, Oxfordshire, London and further afield.

Full interior design service or simple advice  
 Upholstery  
 Curtain and blind making  
 Cushions  
 Footstools  
 Headboards  
 Bedspreads and valances  
 Decorating  
 Flooring  
 Lighting  
 Sofas and armchairs  
 Fabric, wallpaper and paint supply



info@jwjinteriors.co.uk • 07769 682 689 • www.jwjinteriors.co.uk



Beautifully designed gardens by experienced, qualified, local garden designer

**Andrea Newill MSGD, MBAII**  
 T: 0118 9710450 w: andreanewill.co.uk

follow us on   



**CLEAN HOUSE SERVICES**

We are a small friendly company offering high standard domestic and commercial cleaning services, moving and (un)lading services, using professional equipment and products. We are also offering carpet cleaning service, and cleaning of furniture, windows and ovens.

Regular & One-Off Cleaning  
 Home & Office Cleaning  
 End of Tenancy Cleaning  
 Before & After Party Cleaning  
 Pre/Post Holiday Cleaning  
 Spring Cleaning

Curtain Alteration Service  
 Domestic Carpet Cleaning  
 Moving (free collection & delivery)



Call: 0759 362 7139  
 info@cleanhouseservices.co.uk



**ABBOTTS**  
**SHOE REPAIRS & LEATHER GOODS**

18 Reading Road, Pangbourne, Berks.  
**Telephone (0118) 984 1155**



**DO YOU NEED A WILL OR LASTING POWER OF ATTORNEY?**

If so contact **Hillhampton Wills**, a local company, on 0118 984 3167 or email joanne@hillhamptonwills.com

Joanne will visit you at your home. Appointments last approximately 1 hour and can be held during the day, evening or weekend.

A Single Will costs £160, a pair of Mirror Wills £210, a single Power of Attorney £250.

For further information visit **www.hillhamptonwills.com**

A MEMBER OF THE INSTITUTE OF PROFESSIONAL WILLWRITERS AND FULLY INSURED



*An exceptional Montessori Nursery School offering 'Outstanding' early years education to children aged 2½- 5 years*



*Set in five acres of meadowland. We welcome visitors, so please get in touch*  
**0118 974 4643, [info@montessorinursery.org.uk](mailto:info@montessorinursery.org.uk)**

*Cock Lane, Bradfield RG7 6HW  
Headteacher Mrs J D Maclean*



**Perfect Boundary Limited**



**Hard Landscaping, Groundworks,  
Paving and Driveways, Construction**

*Professional Service. Call for a Quotation.*

Email: [info@perfectboundarylimited.co.uk](mailto:info@perfectboundarylimited.co.uk)

[www.perfectboundarylimited.co.uk](http://www.perfectboundarylimited.co.uk)

Tel: 0118 996 8009 Mob: 07796 202217



**SKIN HEALTH**

# Berkshire's Exclusive Skin Health & Laser Clinic

## Radiant skin, the natural way...

... can be yours with our non-surgical laser facelift and bespoke skin health programs, uniquely developed using science and technology from around the world.

**As a specialist laser and skin clinic, we are here to help you.**

- Non-surgical laser face & neck lifting
- Acne & rosacea specialists
- Pain-free laser hair removal
- Wrinkle & skin remodelling
- Tattoo removal
- Emsella for incontinence
- Pelvic floor rehabilitation
- Non-surgical blepharoplasty



**Andresa Aesthetics Exclusive Skin Health & Laser Clinic**  
Tel: 01635 800183 | [info@andresa.co.uk](mailto:info@andresa.co.uk) | [www.andresa.co.uk](http://www.andresa.co.uk)  
Lower Wasing Barn, Wasing Lane, Nr Woolhampton RG7 4LY



**KJ cosmetics**  
www.permanentcosmetics.co.uk

Semi Permanent Makeup  
 Eyebrows / Eyeliner  
 Lips

Skin Treatments  
 Dermabrasion / Skin Peels  
 Microdermabrasion

Specialist Treatments  
 Lash Lift / Lash Tint  
 Lash Extensions



Local Salon | Free Parking | Free Consultation  
Weekend & Evening Appointments

**Contact us**  
**0118-974-4471**



[www.kjcosmetics.co.uk](http://www.kjcosmetics.co.uk)  
[kate@kjcosmetics.co.uk](mailto:kate@kjcosmetics.co.uk)

Hewitts Wood Farm  
 Bradfield, RG7 6DH



**The Orchard Clinic**

Osteopathy & Cranial Osteopathy  
 Remedial & Sports Massage  
 Relaxation Massage  
 Podiatry & Chiropody  
 Reflexology  
 Life Coaching  
 Psychotherapy & Counselling

[info@theorchardclinic.co.uk](mailto:info@theorchardclinic.co.uk)  
 Tel: 01491 672332

*Gardeners Lane Upper Basildon RG8 8NP*

[www.theorchardclinic.co.uk](http://www.theorchardclinic.co.uk)



# Diagnose. Plan. Rehabilitate.



At Boathouse Physiotherapy our primary aim is to return you to pain-free life and help you return to the activities that are important to you.

**No referral required.**

**0118 976 7189**

[boathouse.physio@nhs.net](mailto:boathouse.physio@nhs.net) | [www.boathousephysiotherapy.co.uk](http://www.boathousephysiotherapy.co.uk)

## THE PARISH OF PANGBOURNE WITH TIDMARSH AND SULHAM



A Christian presence in every community in 2020

### Sunday Worship each week in St James the Less, Pangbourne

**7.45am**      **Holy Communion**      Book of Common Prayer  
**10am**        **Sunday at Ten**            Worship for all ages

Prayer, preaching, communion and baptism, Bible teaching, singing and music, sharing faith, serving our community



#### Midweek Communion

**Wednesday at 10am in St James**

A short, peaceful time of worship followed by coffee and chat. Especially good for those who can't make Sunday worship due to work or family commitments.

#### Sunday Worship in our Parish at 11am

1<sup>st</sup> Sunday Family Worship      St Laurence, Tidmarsh  
2<sup>nd</sup> Sunday Holy Communion      St Laurence, Tidmarsh  
3<sup>rd</sup> Sunday Family Worship      St Nicholas, Sulham



## NOAH'S ARK

**Every Friday morning  
during term time**

**10am to 11.30am**

**St James the Less, Pangbourne**

For babies, toddlers, preschoolers, parents, grandparents and carers.

Playtime, story time, craft, songs, chat and friendship

Great coffee, tea and biscuits for adults, healthy snacks for children

#### Tuesday Teas

For seniors monthly  
in Pangbourne Village Hall  
on the second Tuesday each  
month from 2pm

*Join us for tea and entertainment*



#### Lent begins Wednesday 26<sup>th</sup> February

For Christian discipleship and  
study groups

see the website during February

[www.pangbournechurches.org](http://www.pangbournechurches.org)



#### Crocus Sunday

**St Nicholas Church, Sulham**

Join us on Crocus Sunday in February and see the wonderful display of crocuses and snowdrops in St Nicholas churchyard.

See our website nearer the time for exact date.

[www.pangbournechurches.org](http://www.pangbournechurches.org)

#### Would you like to be confirmed?

*If you missed out on **Confirmation** when you were younger, or maybe you are beginning to think now might be the right time to explore your faith journey, please get in touch with Rev Heather Parbury*

[rector@pangbournechurches.info](mailto:rector@pangbournechurches.info)

# Woodborough HOUSE

AWARD-WINNING DENTAL PRACTICE  
OFFERING AWARD-WINNING EXPERTISE IN DENTAL  
IMPLANTS WITH OUR HIGHLY-REGARDED TEAM AND  
OUR SPECIALIST PROSTHODONTIST, DR NICK FAHEY.

WINNER: PRIVATE DENTISTRY AWARDS '16  
BEST HIGH TECHNOLOGY PRACTICE

★  
WINNER: PRIVATE DENTISTRY AWARDS '13  
BEST IMPLANT PRACTICE

★  
WINNER: SMILE AWARDS '12  
BEST MULTIPLE IMPLANT AWARD

★  
TAKE THE FIRST STEP TO A CONFIDENT SMILE

CALL US TODAY ON:

 0118 984 3108

WWW.WOODBOROUGHHOUSE.COM

## SMILE WITH CONFIDENCE



LIFE'S JOURNEYS  
SHOULDN'T BE  
INTERRUPTED.

DISCOVER DENTAL  
IMPLANTS FOR A PERMANENT  
ALTERNATIVE TO DENTURES AND  
MISSING TEETH

## OSTEOPATHS

trained  
to  
fight

PAIN



Goring & Streatley Clinic  
The Community Centre  
Station Road, Goring

For treatment of  
Pulled Ligaments  
Strained Muscles  
Rheumatism  
Arthritis, Sciatica  
Backache, Lumbago  
Joint Pains, Sports Injuries  
Headaches & Stress

07775 714 300  
or  
01491 873 874

Victoria Swan DO  
Natalia Beddoe BSc(Hons)Ost  
Registered Osteopaths

## SINGLESPORT

THE SKI SPECIALIST FOR SOLO TRAVELLERS

SingleSport organises eight ski holidays  
and two active summer holidays each year.

All of the holidays are very sociable  
no matter whether you are an expert or  
complete beginner at your chosen sport.

All the details are here [www.singlesport.com](http://www.singlesport.com)  
or call Ruth 0118 9842755



GET FIT,  
HAVE FUN,  
MAKE FRIENDS  
ALL WITH...

# ZUMBA

WEEKLY CLASSES:  
SATURDAYS, 11AM,  
TIDMARSH VILLAGE HALL

MONDAYS, 6.30PM,  
PANGBOURNE PRIMARY SCHOOL

WEDNESDAYS, 6.15PM,  
PANGBOURNE WORKING  
MEN'S CLUB

ALL WELCOME! no dance experience  
required - just come and join in!  
Wear trainers and comfy clothes,  
bring a towel and water  
Email Rachel with any questions -  
[rachelzumba4043@gmail.com](mailto:rachelzumba4043@gmail.com)  
Special offer: 1 pass per person at the  
reduced price, to be bought in January 2020.







# 3 months to get results

Fast fitness results with our dedicated team  
Improved wellbeing  
No joining fee or contract

## Join Now

\*Terms and Conditions apply\*



BRADFIELD COLLEGE SPORTS COMPLEX

email: [frontdesk@bradfieldcollege.org.uk](mailto:frontdesk@bradfieldcollege.org.uk) tel: 0118 964 4600

[www.bradfieldsportscomplex.co.uk](http://www.bradfieldsportscomplex.co.uk)  

Swimming · Fitness Classes · Sports Hall · Gym · Wellbeing

# PANGBOURNE SPORT & SOCIAL CLUBS

All these groups offer a warm welcome to newcomers. Please contact the organiser if you would like to join.

Monday			
09.30	Boxercise	Gareth France – 07853 381449, gareth.france@sky.com	Dolphin
10.30, 19.45	Pilates (2 classes)	Vicky – 07775 638611, info@themovementclinic.co.uk	Movement Clinic
14.00	Coffee and Craft	0118 9844117, pangbournelibrary@westberks.gov.uk	Pang Library
15.30	Draw/Paint	Jean – 07500862025, art-course@hotmail.com, www.drawing-painting.com	Dolphin
18.00, 19.00	Yoga (2 classes)	Helma – 078104 25593, yogabyhelma@gmail.com	Whitchurch VH
18.30	Zumba	Rachel – 07885 444510, rachelzumba4043@gmail.com (VH in holidays)	Pang Primary
19.30	Badminton	webmaster@pangbournebadminton.club, www.pangbournebadminton.club	Pang College
Tuesday			
09.30	Hand Bell Ringers	Len Palfrey – palfrey62@btinternet.com	Various homes
11.30	Otago Fall Prevention	Daniela – 07900 307520, d.capasso67@gmail.com, www.yogawithdaniela.co.uk	Pang VH
11.30	Yoga	info@pangbourneclub.co.uk	Pang WMC
17.00, 18.15, 19.20	Pilates (3 classes)	Julia – julia@tilehurst-pilates.co.uk	Dolphin
19.30	Yoga (mixed ability)	Jean – 01235 868 004, 07484 4113401, jcosham@live.com	Pang Primary
19.30	Radiant Body Yoga	Joy – 07956 620868, joy.golding30@gmail.com	Movement Clinic
Wednesday			
09.30	Circuits	Gareth France – 07853 381449, gareth.france@sky.com	Pang VH
09.30	Pilates	Julia – julia@tilehurst-pilates.co.uk	Dolphin
09.30	Radiant Body Yoga	Joy – 07956 620868, joy.golding30@gmail.com	Movement Clinic
10.00	Keep Fit 50+	Jo Cassells – 01491 578076, jo.cassells@live.co.uk	Whitchurch VH
11.00, 12.00	Fitsteps (2 classes)	Kayleigh – 07970 074 683, kayleighrixon@gmail.com	Dolphin
11.30	Gardening	nick.digby@virgin.net, www.goringgapbc.org.uk/?s=gardening+	Lower Basildon
13.00	Art Group	margharita.wade@gmail.com	Pang VH
18.15	Zumba	Rachel – 07885 444510, rachelzumba4043@gmail.com	Pang WMC
18.30	Cricket Practice	Pangbourne Cricket Club. Dan Booth – 07956 526505, www.pangbournecc.org	Pang College
19.00	Hatha Yoga	Helma – 07810 425593, yogabyhelma@gmail.com	Whitchurch Artcafe
19.15	Vocal Locals Choir	Claudia – 07796 776461, c@claudgibson.com	Pang Primary
19.30	Dance Fitness Class	Andrea – 07717 023007, turners.the@icloud.com	Pang Primary
19.30	Langtree Sinfonia	nrkiff@tiscali.co.uk, www.langtreesinfonia.co.uk	Langtree school
20.00	Camera Club	Alan – 01491 681471, alan@alancopeland.co.uk, www.whitchurchhillcameraclub.co.uk	Whitchurch VH
20.00	Pangbourne Band	Stewart – 07786 694491, www.pangbourneband.org.uk	Pang VH
Thursday			
08.15, 09.30	Pilates (2 classes)	julia@tilehurst-pilates.co.uk	Dolphin
10.00	Draw/Paint	Jean – 07500 862025, art-course@hotmail.com, www.drawing-painting.com	Pang VH
10.00	Vinyasa Yoga	Kim – 07811 385 411, kim@kalmnkindyoga.co.uk	Floating Point
10.30, 19.00, 20.00	Pilates (3 classes)	Vicky – 07775 638611, info@themovementclinic.co.uk	Movement Clinic
18.00	Hatha Yoga	Kim – 07811 385 411, kim@kalmnkindyoga.co.uk	Floating Point
19.30	AC Pilates	Anna – 07754 598627, actraining@hotmail.com, www.acpilates.co.uk	Pang VH



**Dance  
fit FUN**  
DANCE AEROBICS  
FOR ALL AGES & ABILITIES

Kayleigh – 07970 074 683  
kayleighrixon@gmail.com  
Facebook: Dance Fit Fun

**Fitsteps is coming  
to Pangbourne!**

EVERY WEDNESDAY FROM 8TH JANUARY AT THE DOLPHIN CENTRE

**FITSTEPS – 11am**  
A unique ballroom and latin fitness class where you can dance all of your favourite dances from Strictly Come Dancing.

**FITSTEPS FAB – 12pm**  
The lower impact and lighter intensity fitness workout. Learn classic dances from a Waltz to a Charleston whilst getting fit and having fun.

*Strictly no partner required.*

only **£6** pay as you go!



“Dance like nobody is watching!”

# PANGBOURNE SPORT & SOCIAL CLUBS

Compiled by Ruth Paul. If you would like to add a group to this list please email [ruth@singlesport.com](mailto:ruth@singlesport.com).

Thursday cont'd			
20.00	Pilates (intermediate)	Vicky – 07775 638611, <a href="mailto:info@themovementclinic.co.uk">info@themovementclinic.co.uk</a>	Movement Clinic
20.00	Bingo	<a href="mailto:info@pangbourneclub.co.uk">info@pangbourneclub.co.uk</a>	Pang WMC
20.00	Bell Ringing	Len Palfrey – <a href="mailto:palfrey62@btinternet.com">palfrey62@btinternet.com</a>	St James
Friday			
09.30	Kettlebells	Gareth France – 07853 381449, <a href="mailto:gareth.france@sky.com">gareth.france@sky.com</a>	Pang VH
Saturday			
09.00	Rowing	Nick or Alastair – <a href="mailto:captainofrowing@goringgapbc.org.uk">captainofrowing@goringgapbc.org.uk</a> , <a href="http://www.goringgapbc.org.uk">www.goringgapbc.org.uk</a>	Lower Basildon
09.15	Radiant Body Yoga	Joy – 07956 620868, <a href="mailto:joy.golding30@gmail.com">joy.golding30@gmail.com</a>	Movement Clinic
09.30	Shop Bike Ride	Toby – 0118 9842823, <a href="mailto:info@pankhurstcycles.co.uk">info@pankhurstcycles.co.uk</a> , <a href="http://www.pankhurstcycles.co.uk">www.pankhurstcycles.co.uk</a>	Pankhurst Cycles
10.30	Tennis	Louise – 07554 432216, <a href="mailto:info@pangbournetennis.org">info@pangbournetennis.org</a>	Pang Tennis Club
11.00	Zumba	Rachel – 07885 444510, <a href="mailto:rachelzumba4043@gmail.com">rachelzumba4043@gmail.com</a>	Tidmarsh VH
Sunday			
10.00	Rowing	Nick or Alastair – <a href="mailto:captainofrowing@goringgapbc.org.uk">captainofrowing@goringgapbc.org.uk</a> , <a href="http://www.goringgapbc.org.uk">www.goringgapbc.org.uk</a>	Lower Basildon
11.30	Tennis	Louise – 07554 432216, <a href="mailto:info@pangbournetennis.org">info@pangbournetennis.org</a>	Pang Tennis Club
13.30	Cricket Matches	Pangbourne Cricket Club. Dan Booth 07956 526505, <a href="http://www.pangbournecc.org">www.pangbournecc.org</a>	See fixture list
Held monthly			
2nd Mon 14.00	Tea	Doreen – 0118 9715350	Dorman Rooms
3rd Mon 14.00	Cribbage	Di – 0118 9842473	Dorman Rooms
1st & 3rd Tue 19.30	Social Bridge	Stephen Billyeald – <a href="mailto:stephenbillyeald@btinternet.com">stephenbillyeald@btinternet.com</a> , 0118 9843368	Dorman Rooms
1st & 3rd Tue 19.45	Natural History	<a href="mailto:jan.haseler@btinternet.com">jan.haseler@btinternet.com</a> , <a href="http://www.rdnhs.org.uk">www.rdnhs.org.uk</a>	Pang VH
2nd Tue 14.30	W.I.	Judy – 0118 9841565, <a href="mailto:judyschurer@gmail.com">judyschurer@gmail.com</a>	Pang VH
2nd Tue 20.00	RSPB	<a href="mailto:info@reading-rspb.org">info@reading-rspb.org</a> , <a href="http://www.reading-rspb.org">www.reading-rspb.org</a>	Pang VH
4th Tue 14.00	Tea	Jill Palfrey – 0118 9842698	Pang VH
1st Wed 12.30	Carers Support	Carers Hub – 0118 3247333	Pang VH
1st Wed 19.30	Games/Quizzes	Doug – 0118 9614610, <a href="mailto:lynn.harrison@oddfellows.co.uk">lynn.harrison@oddfellows.co.uk</a> , <a href="http://www.oddfellows.co.uk">www.oddfellows.co.uk</a>	The Elephant
Alt Thu 10.00	Storytime	0118 9844117, <a href="mailto:pangbournelibrary@westberks.gov.uk">pangbournelibrary@westberks.gov.uk</a>	Pang Library
3rd Thu	Thursday Club	Various social events. Di – 07971 226548 and Gill – 01189 841122	George Hotel
2nd Sat 11.00	Gardening	<a href="mailto:nick.digby@virgin.net">nick.digby@virgin.net</a> , <a href="http://www.goringgapbc.org.uk/?s=gardening+">www.goringgapbc.org.uk/?s=gardening+</a>	Lower Basildon
1st Sun 10.00	Go Row	<a href="mailto:captainofrowing@goringgapbc.org.uk">captainofrowing@goringgapbc.org.uk</a> , <a href="http://www.goringgapbc.org.uk/?s=go+row">www.goringgapbc.org.uk/?s=go+row</a>	Lower Basildon
1st Sun 19.30	Jazz	Keith – <a href="mailto:pangbournejazzclub@gmail.com">pangbournejazzclub@gmail.com</a> , <a href="http://www.pangbournejazzclub.co.uk">www.pangbournejazzclub.co.uk</a>	Pang WMC
Last Sun 19.30	French Film Night	Pangbourne Twinning Association, <a href="http://www.pangbourne-twinning.org">www.pangbourne-twinning.org</a>	Parish Hall
Various	Bowls	Alan – 01491 681471, <a href="mailto:alan@alancopeland.co.uk">alan@alancopeland.co.uk</a> , <a href="http://www.pangbournebowls.co.uk">www.pangbournebowls.co.uk</a>	Rec Ground
Various	Church Flowers	Pauline Jones – 0118 9844051, <a href="mailto:pauline.heronridge@btopenworld.com">pauline.heronridge@btopenworld.com</a>	St James the Less
Various	Brownies	<a href="mailto:2ndpangbournebrownies@gmail.com">2ndpangbournebrownies@gmail.com</a>	Pang VH
Various	Guides	<a href="mailto:helenguides@yahoo.com">helenguides@yahoo.com</a>	Pang VH
Various	Ladies Walk Group	Nicki Woodward – 07768 986799, <a href="http://www.purleypathfinders.co.uk">www.purleypathfinders.co.uk</a>	Various

## Mixed Ability Yoga Class

With Jean Cosham BWY Dip

Pangbourne Primary School,  
Tuesday Evenings 7.30 – 9.30

For more information  
please ring **01235 868 004**,  
or **07484 4113401**  
or email [jcosham@live.com](mailto:jcosham@live.com)





individual  
conservatories  
and orangeries  
by **Malbrook**



please contact us to arrange a design consultation

TEL: 020 8780 5522 • EMAIL: [info@malbrook.co.uk](mailto:info@malbrook.co.uk)

[www.malbrook.co.uk](http://www.malbrook.co.uk)

## Shaun Guard TV & WIFI SERVICES

- Aerials - supplied, repaired & poor reception solved
- Satellite - Sky Q dish upgrades, discreet dish installations also foreign TV
- Internet - blackspots cured, data cables to your TVs / computer
- TVs - hung on your wall or set up & tuned
- CCTV & Door Entry - domestic installations

 OXFORD AERIALS

Call Pangbourne 01189 639113  
[www.oxfordaerials.co.uk](http://www.oxfordaerials.co.uk)

## ROBERT'S UPHOLSTERY

**01635 869176**

**07882 344537**

- Antique and modern re-upholstery
- Foam cushion filling service:  
sofas, mattresses, window seating

FREE ESTIMATE. GOOD RANGE OF SAMPLES.  
OVER 30 YEARS TRADE EXPERIENCE.

[www.robertsupholstery-thatcham.co.uk](http://www.robertsupholstery-thatcham.co.uk)  
[robertsupholstery@yahoo.co.uk](mailto:robertsupholstery@yahoo.co.uk)

## THE BOUTIQUE ROOM

*Handcrafted Jewellery*  
by Sandy Ebdon-Jackson

*Ladies' Clothing*  
by Jenny Gill – Off the Rails

**Pangbourne Village Hall  
RG8 7AN**

First Saturday of every month  
10.00am – 3.00pm

## *Duncan Agar Painter and Decorator*

- Highly Experienced, Professional Tradesman
- All Aspects of Interior and Exterior Decorating
  - Traditional and Modern Finishes
  - Period Properties a Speciality
  - Free Quotations and Advice
    - References Available

*Tel: 0118 971 2340  
& 07787 552 983*



Royal Berkshire  
Shooting School

**PURDEY**  
LONDON 1814

The Royal Berkshire  
Shooting School.  
Tuition, Gun Room &  
Country Store, Sporting Agency  
And so much more...

 Schöffel

Barbour

PURDEY  
*Gun & Rifle Makers*  
LONDON 1814

MUSTO

 LAKSEN

 GAMEBORE

 HULL  
CARTRIDGE

 BROWNING

Perazzi

 BERETTA

01491 672900 | [www.rbss.co.uk](http://www.rbss.co.uk)

# Treating you like family from one generation to the next.

In a good way, of course...

## **We make buying, selling and letting easy for you.**

People come to us because they know we always do the right thing.

Because we get results and are always there when they need us.

And, most of all, because we always treat them like family...

## **Family values go such a long way...**

For more than 70 years, we've been treating people like one of our own – in Reading, Tilehurst, Pangbourne and beyond.

You'll find us friendly, knowledgeable, professional – and here for you.

With Patrick Williams, you're family.  
Give us a call and find out for yourself.

Reading: 0118 957 3579  
Tilehurst: 0118 942 0777  
Pangbourne: 0118 984 4444  
[info@patrickwilliams.co.uk](mailto:info@patrickwilliams.co.uk)



[www.patrickwilliams.co.uk](http://www.patrickwilliams.co.uk)

## PLENTY TO CELEBRATE FOR PANGBOURNE YOUTH FC

It's been a busy first half of the season for Pangbourne Youth FC and there's plenty to shout about. Despite a wet autumn, with several matches cancelled due to the weather, spirits in the PYFC teams certainly haven't been dampened. Playing a mixture of league and cup games there were some excellent performances with teams showing great spirit and sportsmanship irrespective of the final score.

And there have certainly been some notable successes to celebrate. There was a first victory for one of our newest teams, the Phoenixes (under 10s); several teams progressed through their challenging cup matches to reach round 3, including Panthers (under 11s), Pumas (under 12s), and Falcons (under 14s) who are also enjoying great success in their first season in the East Berkshire Alliance League, currently third in their division.

Off the pitch PYFC was chosen as one of Waitrose's green token partners and thanks to the support of local shoppers we received a cheque for £250 towards club funds. Fundraising and sponsorship is vital to the continued success of the club, if your business is interested in sponsoring a team please get in touch.

Several of our teams currently have space for more players so we would welcome enquiries from girls and boys wanting to join our friendly squad. Contact us via our website for more information – [www.pangbourneyouth.co.uk](http://www.pangbourneyouth.co.uk).



*Celebrating victory – Phoenixes*



*A Waitrose green token partner*

### **Hurricanes – Under 7 (school year 1 or 2)**

Not currently in a league but train at Pangbourne recreation ground on Saturday mornings.

### **Hurricanes – Under 8 (school year 2 or 3)**

Play in the Berkshire Youth Development League (BYDL) on Saturday mornings.

### **Red Kites – Under 9 (School year 3 or 4)**

Play in the BYDL on Saturday mornings.

### **Phoenixes – Under 10 (school year 4 or 5)**

Play in the BYDL on Saturday mornings.

### **Piranhas & Panthers – Under 11 (school year 6)**

Two teams. Play in the BYDL on Saturdays.

### **Pumas – Under 12 (school year 7)**

Play in the BYDL on Saturday mornings.

### **Falcons – Under 14 (school year 8 or 9)**

Play in the East Berkshire Alliance League on Saturday mornings.

### **Under 17 (01/09/02 – 31/08/04 age band)**

Play in the Oxford Mail Youth Football League – Division B on Sundays.

*Pangbourne Youth FC is grateful to the following businesses for their sponsorship:*



# LOCAL CLUBS

---



## PANGBOURNE ACTION FOR THE HOMELESS

The spirit of Christmas came to Pangbourne in November. In that month Pangbourne Action for the Homeless held two collections in aid of needy people in Reading. The first was on Saturday 9th November when six volunteers stood in the biting cold for an hour each. They were fund raising on behalf of Launchpad Reading and made £95.34, which was further increased by donations amounting to £110. Launchpad is Reading's leading homelessness prevention charity, providing vital information and support for individuals as well as couples and families who don't have a stable place to live, or are at risk of losing their home. In addition to raising money the hope was

also to raise awareness of the situation faced by many of our neighbours in Reading. Most encouragingly we learnt from several of the young supporters that they were well aware of Launchpad and were great advocates for it.

This sense of awareness manifested itself again on Friday 29 November. Once more six supporters stood for an hour each beside a shopping trolley in the Pangbourne Co-operative store. Shoppers were asked to consider buying an extra item to put in the trolley whose contents would be given to ReadiFood, the Reading Food Bank. The volunteers received many messages of support for the work of ReadiFood and by the end of the day the collection amounted to three large shopping trolleys filled with festive looking gifts. These will be added to others at the food bank warehouse where parcels are being made up for many needy families at Christmas. This generous donation complements the regular gifts made throughout the year because the Co-op has a standing collection point available every day for donations. These are taken regularly to the warehouse where they are much appreciated and very necessary. Unfortunately the need for such support is increasing, not decreasing.

The committee would like to thank everyone who contributes, and continues to give to help those who are working so hard on behalf of our needy neighbours.

*Judith Colegate (Group Co-ordinator)*

---

## PANGBOURNE HERITAGE GROUP

### JANUARY/FEBRUARY REPORT



Our meeting in November gave us all an insight into the cinema era in Reading, and I for one learnt a lot about how numerous they were, and what has happened to the various venues since then. In December we welcomed members and guests to our annual Christmas Social, which is just that, a time to get together as a group.

We have a proposed calendar for next year, 2020, and although changes may occur, arrangements for the first two months have been confirmed.

January 8	In House meeting, Favourite Holiday Memories or Souvenirs
February 12	Margaret Simons: Suffragettes in Berkshire
March 11	Royal Berkshire Hospital Exhibition visit (actual date and time to be confirmed)
April 8	Speaker: subject tbc.
May 13	Visit to the Records Office for special exhibition
June 10	Speaker: subject tbc.
July 8	Local walk
August 12	no meeting
September 9	Ellie Thorne: subject tbc.
October 14	AGM
November 11	In House Memorabilia Evening: WW1 and 2
December 9	Christmas Social

All meetings are well advertised in the village, so please look for updates and information. Members are notified by email, but please feel free to come along and join in a meeting for the first time. Everyone is welcome.

*Lesley Crimp*



## THURSDAY CLUB

Before we opened in September we held a Dementia Friends afternoon which was very successful. As a result we now have 13 new Dementia Friends. We hope to run another course which will be open to the people of the village and to the local businesses. I must say we had someone from the medical profession on the course and their words at the end of the session was "I wish I had done this earlier". The course gives a different aspect of dementia and hopefully people go away with a greater understanding, after all there are over 100 types of dementia each taking a different route, different actions, different language which we all need to be mindful of when dealing with people who are living with dementia.

The Thursday Club opened this year with Kitty who entertained us with all the old songs which we sang along with some of us taking to the floor managing a few steps. We had a lovely lunch – chicken pie, mixed veg and mash; the pies were gifted to the club by local business man Jack Patel in memory of his nephew who suddenly passed away whilst on holiday aged 27. Jack and his wife, Varsha, own Westholme Stores in Goring and have done since 1988, during this time they have helped many people in Goring village caring for the village elders delivering papers, groceries, etc. We at the Thursday Club thank them very much for their kind generosity.

In October we welcomed Jambalaya a musical duo who sang folk and country songs. It is their first year out on the circuit and, after a recommendation from Sue Ryder, Nettlebed, we jumped in quick and booked them for afternoon tea in October, they didn't disappoint, I think everyone joined in singing, hand clapping, foot tapping etc. A great time had by all. In November we invited Graham Swanell who is a local entertainer who does the rounds around very many old folk homes and clubs. He

came with his guitar and sang some old folk songs which were a bit before my time but our guests seemed to know them. In between the songs he recited some funny stories raising a few giggles as we could all relate to many of them.

Langtree School invited us to their Christmas Party which we thoroughly enjoyed. We were entertained by a very talented group of students playing in the orchestra and singing in the choir. We had an additional treat by Woodcote Primary school choir who opened proceedings with a repertoire of carols and Year 7 drama club re-enacted *Twas the night before Christmas* which was very entertaining. To top the lot we enjoyed a very nice afternoon tea followed by everybody joining in singing carols. The Thursday club would like to thank the students and staff of Langtree School for a lovely afternoon and we wish them all a very merry Christmas.

At the time of going to print we are all looking forward to "Christmas Singing Bingo" with Jack and Matthew and of course we are hoping for our annual visitation from Santa Claus.

We would like to thank Tony Gale who has very kindly donated £100.00 towards the running of our club and also to the Business Forum who have donated 50% of the proceeds from the Christmas raffle to the club. Thank you to you all for making a difference.

We would like to thank Kiren Sharma (Gravity Personal), Devashi (The George Hotel), and Greens of Pangbourne for their constant support during the year

Best wishes to one and all for a peaceful and Happy New Year.

*For further information please contact Gill 9841122 or Di 9842473.*



# LOCAL CLUBS

---

## PANGBOURNE ART GROUP

As we near the end of this year, our Art Group has had a very busy few weeks. As the weather has got wetter and colder, we haven't been able to get out and do some plein air painting, so it's nice to be in the warm and dry in the hall. We have welcomed several new members this year who have all added to the variety and diversity of our group.

Everyone had been working hard towards our Annual Exhibition which took place on the 9th and 10th November. Overall Our Exhibition was successful. On the Saturday the attendance was affected by the bad weather, but Sunday was a much better day. Even so we sold 29 framed and unframed paintings. We also sold 68 single greetings card and several packs of cards also. It has been a lot of hard work, but thanks to the committee, some members and members 'other halves' helping, we had it all set up in good time. The favourite painting voted for by the public was a very fine one called *Mad Dash* by Maureen Richardson.

To finish up the rest of this year we will have our annual Christmas Lunch and this year it will be at the Goring and Streatley Golf Club on 6th December. On our last day 11th December, everyone brings along a Christmas Card they have painted and everyone votes for their favourite one, the winner gets a bottle of wine.



We also annually have the Ellie Soar Award. This was created for us by Ellie who was a professional artist who lived locally in a beautiful house that went down to the river in Pangbourne. It is presented to the person who has most improved their artistic talents in the past 12 months.

Looking forward to 2020, Maureen Futter our Secretary has booked two workshops, the first one will be our old friend Paul Weaver who will be doing a watercolour workshop in March. Later on in the year we will be having a new tutor for us, Mark Warner who will be doing an Acrylics, so lots to look forward to! For more information about our group, please look on our website.

*Elizabeth Ford*  
[www.pangbourneartgroup.com](http://www.pangbourneartgroup.com)



---

## THE WHITCHURCH & DISTRICT THEATRE CLUB

We visit musicals, plays, ballets, operas, classical concerts etc. once a month or more. Salisbury, Windsor, Guildford, Stratford and Chichester, amongst others, are often visited.

Major London venues and productions. Mainly matinees in the week, but sometimes evening performances and weekends. Holiday trips away.

Tickets purchased at group/concessionary rates. Coaches depart from Pangbourne.

For our forthcoming programme please check the Whitchurch-on-Thames Website.

*Subscriptions: £14 per annum but £12 if paid online.*

Organiser: Christine Martin, "Sonia", Goring Heath Road, Whitchurch Hill, RG8 7PG  
Tel: 0118 9844252 email: [whitchurchtheatreclub@gmail.com](mailto:whitchurchtheatreclub@gmail.com)

## ROYAL BRITISH LEGION

Dear Pangbourne,

Once again you've dug deep into your pockets, wallets, purses and anywhere else you store your money, to support the Royal British Legion in their annual Poppy Appeal! Our Appeal Officer, Bob Logue, had his merry band of volunteers braving the elements, standing outside the Pharmacy and Co-op with their buckets. In the previous week, collection tins and Poppy boxes were distributed throughout the shops and hostelrys and the lampposts decorated with giant poppies throughout the village. Many shops displayed their support for the cause with beautiful displays of poppies. Thank you all for that. It really conveys the village's support for our troops. A special mention must go to the village scout troop who steadfastly turned out on two Sundays and raised a whopping £694! In all, the street collection and shop and business boxes raised a total of over £6000!! Another record year for us!

On Friday November 8th, our Annual Legion Dinner was held at "The Ellie". Eighty Branch Officers and guests took their seats at their "Regiment" themed tables. Following the Eulogy given by our President and two minutes silence, Reverend Heather led the prayers in recognition of the fallen and our serving troops. The Branch Chairman then welcomed everyone and outlined the evening's programme. A beautiful meal followed, during which, our guest of honour, Major Mark McFarlane, a serving officer in The Rifles, gave us an inspiring speech. He told us that more servicemen and women have taken their own lives after participation in recent conflicts than lost their lives in the conflicts themselves. So the RBL is still, today, contrary to some people's thoughts, extremely relevant in the provision of much needed support to military families and communities. The work and funds that branches like ours achieve are so much appreciated and therefore very essential.

We had one very surprised gentleman in our midst who thought he was there just to enjoy himself. In fact, he had been invited so that we could honour his achievement in street collections over the years. John Harland of Tidmarsh was presented a Restaurant voucher for collecting over £4200 since 2012 in his area! What a single handed triumph! (This year he raised a massive £703!)

Then came our big fundraising highlight of the evening – raffle and auction! We'd sold out of raffle tickets earlier than ever and everyone was invited to check their numbers for winners so that we could get the grand auction underway! Again, we had a diverse selection of items ranging from "boozy bottles" to the ever popular "Champagne River Cruise" and our two auctioneers, Claire and Shelley, badgered, cajoled and persuaded (!) our guests to part with their money! Proceedings were fast and furious and the Treasurer was kept very busy counting money and checking pledges made to pay up later! Our final grand net total, including raffle funds, was yet another record, beating last year by more than £300! We have sent a cheque to Poppy Appeal headquarters for a massive £4809! None of this could have been achieved without the support



of our dinner guests but of course, it is the support of our local shops, businesses, friends and family who so generously donated our prizes for the night. Please allow me to thank the following: Academy Insurance, Aston Martin, Bagatelle, Bentley, Cheese Shop, Classic Flooring, Collins, Co-op, Costa, Cozze, Cross Keys, Davis Tate, The Elephant, Finn Hair, Forresters, Garlands, The George Hotel, Greens, JMC Cars, Lamborghini, Londis, Miahs, Neville Turner, Ninos, Premier Heating, Rechner Ltd., Ruby and Grace, Singleton and Daughter, Strutt and Parker, Tesco, Triangle Travel, Vision Express, WH Smith, Wine Society, What Katie Did, Woodborough Dental Practice, X P Power and of course our members, friends and family. Without your continued support, we wouldn't have the success in which we are wallowing!!

Dancing and more drinking followed, led by the ever effervescent DJ, James Blandly.

True to tradition, on the Sunday, Remembrance Sunday, the village came out to pay homage to the fallen and honour our wonderful troops, past and present. At 2.30 prompt, Pangbourne College Marching Band and the Legion Standard Bearer led the parade followed by the Officers and members of Pangbourne and District Royal British Legion. Closely behind them were three members of the armed forces, reservist and full serving and then the various children's groups, Parish Council, Fire Brigade, Police and Merchant Navy and anyone who wished to honour the troops. At St James the Less, the parade halted and wreaths were laid followed by a moving church service where the names of the fallen were read out by our Chairman. Following muster we marched back to the Square and after dismissal, again, we were spoiled with wonderfully welcome sandwiches provided by The George. Many Thanks!

Once again we've had a magnificent year, sending a massive total of more than £10800 to the Poppy Appeal! So again, on behalf of all those who need the Legion, THANK YOU PANGBOURNE!

### FUTURE EVENTS:

20th March – Murder Mystery Evening at The George. Limited places, tickets £45 including 3 course dinner.

Bottle Stall at Pangbourne Fete. All bottle donations gratefully received.

Friday 6th November – Annual Legion Dinner.

*Denise Saunders (Branch Treasurer)*  
saunders939@btinternet.com

## ACTION FOR PANGBOURNE TOILETS (APT) COMMUNITY TRUST

The latter half of 2019 has been a busy period for APT, particularly on the fundraising front and planned upgrades and as a result 2020 promises to be a year when significant improvements are made to the Station Road Community Toilets.

As reported in issue 152 APT was selected to be one of the charities supported by the Glastonbury festival and as a result we recently received £2,400 from them for which we were very grateful.

In October we were granted a New Project by the Good Exchange (Number 17267) to raise funds for our running costs for the next operational year (ie, October 2020 – September 2021). The Greenham Trust has also agreed to match fund the first £5,000 donated to this project. So, if you would like to support us please go to <https://www.thegoodexchange.com> and search for 'toilets' and any donation you make will be matched by the Greenham Trust.

On Friday 22nd November we were presented with a cheque from the Coop for £5,305 (see below) for being one of the three local charities that they had supported during the last 12 months. We were very pleased to be selected by the Coop for this scheme, and very grateful to all the Coop Members who nominated us as their chosen local charity. This was a project set up with the specific aim of raising money for the upgrading of the Disabled Toilet facility.

APT have received permission from West Berkshire Council (WBC) for the installation of a Public Drinking Fountain and Bottle Filling station on the outside of the toilets, near the car park ticket machine. This is being partly funded by Pangbourne & Whitchurch Sustainability (PAWS) group, who wish to encourage use of refillable bottles to reduce single use plastic bottles. APT has purchased the necessary components and will be installing it in early Spring, after the frostiest months!

WBC has also given APT permission to upgrade the Disabled Toilet. This requires moving the current wall between the Disabled Toilet and the Ladies Toilet (at the expense of one of the four Ladies cubicles) to ensure the space in the Disabled Toilet meets current standards. APT are seeking advice from the British Toilet Association (BTA) regarding fittings and fixtures to ensure we have a pleasant, good quality toilet, that meets all current recommendations, not only for those with physical difficulties but also those with cognitive impairments. The upgrade is expected to be done in the Spring.

We have been so successful with our 'upgrade' fundraising that we are considering bringing forward the Ladies toilet upgrade (previously scheduled for 2021) and implementing it at the same time as the Disabled Toilet. A decision will be taken early in 2020 after we have received quotes for the work.

Considerable work has been taking place on the 'shrubbery bed' between the toilets and the car park wall. Our thanks go to our Trustee, Lyn Higgs and Supporter, Ian Lewis who have been working with local people to clear and start replanting it. Golden Privet has been planted to form a low 'hedge' alongside the wall and skimmias have been planted alongside to provide a contrast. More work is planned for the Spring.

Finally, the toilets are well used with 80-90 users a day during the Summer months and we continue to get thanks from grateful users.

Please keep in touch with us via [actionforpangbournetoilets@gmail.com](mailto:actionforpangbournetoilets@gmail.com) or via Facebook ([www.facebook.com/APTCommunityTrust](http://www.facebook.com/APTCommunityTrust)) or on Twitter @pangbourneloos.

*We remain 'at your convenience'!  
The APT Community Trust team*



## WHITCHURCH HILL CAMERA CLUB

We meet mainly on a Wednesday at 8.00pm at Whitchurch Hill Village Hall, Manor Road, Whitchurch on Thames. Join us as an annual member or 'cherry pick' your visits to fit with your busy life, with an 'on the night' fee, our details on our website: [www.whitchurchhillcameraclub.co.uk](http://www.whitchurchhillcameraclub.co.uk)

### PROGRAMME

#### January 8th: Curiosities in the Chilterns

Presented by our Chairman Alan Copeland just back from his Christmas cruise (he'll be sporting a tan).

#### January 15th: Print Competition No 2. Subject 'Flowing Water'

The second round, this time the turn of the members who prefer to produce their images as a hard copy. Presentation/framing plays a component part of the marks achieved.

#### January 16th: Rosebowl Competition, 2 of 3

WHCC came joint first in our round one encounter – HOORAH. Let's see if we can see off all of the opposition this time. Our host High Wycombe Photographic Society, our adversaries this round are the Hemel Hempstead and Oxford Clubs.

#### January 22nd: Creative Photography

Presented by professional local photographer John Hailstone. There is mention, a nod, to Ansel Adams for his observations, visualisation and realisation. This through the medium of today's digital formatting – AA a difficult act to aspire to!

#### January 29th: Home match– WHCC v Goring Gap

We go head to head with our near neighbours. To be judged on twenty-five digital images per club. Individual, successful images come together to represent their club – may the best club win!!!



#### February 5th: 6 x 4 Competition/Discussion Evening

An evening of two halves. We reprise our traditional comp (remember the En-print) it's both fun and hard fought. After refreshments we discuss all things WHCC photographic.

#### February Thursday 6th: Practical Photography Group Meeting

Help is on hand! Same place same time but a Thursday.

#### February 12th: Italy, Exploring Venice and Sicily

A shared presentation – firstly long standing member Eric Needs. Eric, I feel the warmth, hopefully no need for wellies . . . Secondly, member David Belcher travels in Vancouver – The Rockies to Vancouver Island. Images captured throughout the seasons. What an evening to look forward to, definitely one (two) for the diary.

#### February 19th: Copyright and the law for Photographers – Cliff Hide advises

Cliff takes a high level view of copyright laws, key legal concepts and GDPR, covers both EU and US law so not to be missed, for very different reasons from the 12th. All the above from our photographic perspective.

#### February Thursday 20th: Rosebowl Competition – Round 3 (3 of 3) and final

New City Photographic Society are our host, Milton Keynes is the venue. Same rules, different opponents this time, Stoke Poges and Woodley (car sharing?)

#### February 26th: Print Competition, Round 3

Our set subject this evening is 'Night Photography'. We return to the comfort of 'home' turf to our take up challenge – roll on the light evenings!!

As we step into 2020, I share with you three club images: *Comma Butterfly*, and *Winter Fruits* by Tilly Jamieson and *A White Pangbourne* by myself.

WISHING A HAPPY NEW YEAR TO YOU ALL.

Lyn Higgs, Whitchurch Hill Camera Club



# LOCAL CLUBS

## CALLING ALL FOOTBALLERS

AFC Whitchurch are a fun, inclusive and competitive football club.

We are recruiting under 12 footballers (school year 7, born 2007/08) for the 2019/20 season.



We play matches on Saturday mornings in the Reading area and have a training session one evening a week.

Whatever your child's experience, if you are interested in joining us, please contact **Alex Hilton** –  
**hilts123@hotmail.com**  
**07802 881458**

## PANGBOURNE & DISTRICT BOWLS CLUB



*Bowls is a social sport, suitable for all levels of fitness – a gentle way to get active.*

### WE ARE LOOKING FOR NEW MEMBERS

Come along to our Open Day afternoon on Saturday 2nd May 2020 and meet us all or come down to the green on any Monday evening after that date at 6pm when we have our weekly coaching sessions.

Anyone interested in joining should contact [alan@alancopeland.co.uk](mailto:alan@alancopeland.co.uk) or visit the website [www.pangbournebowls.co.uk](http://www.pangbournebowls.co.uk).

## PURLEY HORTICULTURAL SOCIETY

### TRADING

The Store in the Memorial Hall car park is now closed and will re-open Saturday, 1st February 2020.

Mr. George Lockwood gave a very interesting talk to the Society on Wednesday 16th October on Plants to encourage wildlife in our gardens. He also gave us information on how to make up garlic and comfrey solutions to promote healthy growth in plants and help us cope with unwanted pests, etc. in our gardens.

On Wednesday, 20th November as Jim Buttress was unable to talk to us, Tony Weston gave us a very interesting talk about "Thames Crossings" – from ford to a flight – 2000 years of getting to the other side, across under, and over the River Thames.

### AGM

The Annual General Meeting of the Society will take place on Wednesday 19th February 2020 in Purley Memorial Hall, Glebe Road commencing at 7.45pm. After the official business has been completed we will have a "Bring & Share" finger buffet. If you will be participating in this, could you please bring along a plate of finger food. Any nominations for the Committee must be given to Paul Humphreys, 20 Brading Way, Purley-on-Thames by Wednesday, 12th February 2020.

### RHS

As an affiliated Society we hold a card that provides entry for one paid up member of P.H.S. and one adult guest at a 30% reduction on the normal adult entry rate to any of the RHS gardens. If you require further details or would like the card, please contact Wendy Chapman on 9429067.

If you are interested in more information on the Society's activities you can visit the Purley-on-Thames website, [www.purleyonthames.org.uk/Phs](http://www.purleyonthames.org.uk/Phs).

On behalf of the Committee I would like to wish you all a very happy New Year and enjoyable gardening in 2020.

Marion Dabbs  
9422349



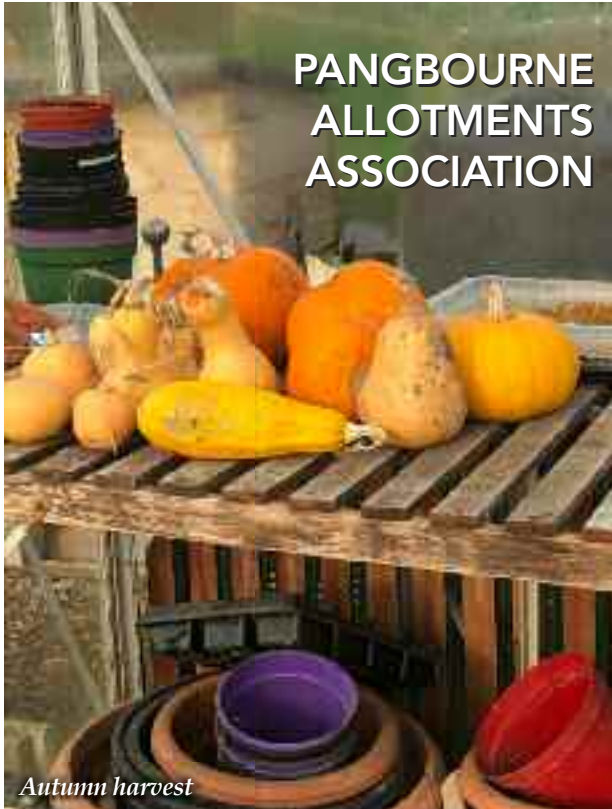

The short cold days mean that it's a quiet time on the allotments: a time to plan what and where to plant next year. This year, 21 people joined the National Society for Allotment and Leisure Gardeners (NSALG for short), which gives us access to legal and horticultural advice, insurance and heavily discounted seeds amongst other things. Two orders have already been received from King's Seeds, so we look forward to spring.

By the time this article appears, the last stretch of fencing should be completed round the allotments, so maybe some brave souls will risk planting sweetcorn again – having lost at least two years' worth to badgers/deer. The Parish Council has funded the fence, with a hefty contribution from the PAA thanks to The Good Exchange, Greenham Common Trust and some allotment holders. Plans are afoot to plant more hedging and trees along the line of the fence.

## BEES IN WINTER

Today (6 December) my car temperature recorded 13 degrees Celsius. When I got home I saw that the bees were flying freely. Once the temperature is above say 8 degrees they will fly freely. Honey bees do not hibernate. Instead they cluster together, rotating from the inside to the outside a bit like Emperor penguins, so the coldest on the outer part of the cluster get a chance to be warmer nearer the centre where the queen and newly developing bees are. Today lots of them were out and it is always great to see. There is little for them to forage at this time of year so often their flights are to gather water (to dilute their honey) or for 'cleansing' flights. Soon the winter honeysuckles will be in flower and they will be on them. You can tell that they are alive and well by placing a hand over the opening at the top of the hive and feeling and smelling the warm current of air. Early days for this winter but so far all is well.

*John White*



## PANGBOURNE TWINNING ASSOCIATION

This year we will be visiting our twin town of Houdan from Thursday May 7th to Sunday May 10th, taking in the VE day 75th anniversary celebrations. If you are considering joining the party, please do now contact us to book as soon as possible. Alison Hill is organising bookings. Contact details are on the website <http://www.pangbourne-twinning.org/>.

You will need to join the Twinning Association, which costs nothing and involves sharing your contact details with us. Pangbourne Twinning Association is open to all, including members of surrounding villages. Young people and families are especially welcome.



Visiting Houdan is always an interesting and friendly affair. Our French partners entertain us very well, and provide a lot of fun, including cultural visits and social events. It is absolutely not essential to be able to speak French; the French are keen to try out their English. Very few of us current members are fluent French speakers; we all get by with a little help from translation aids and a healthy dose of good will.

We have booked a coach for the journey out on Thursday and return on Sunday, via the Channel Tunnel. Some of our members prefer to drive themselves. The only cost to you is travel. Houdan is an attractive and historic market town 63 km west of Paris, on the old route to Brittany. For more details about the visit and about Houdan itself, please look at our website. Our French partners accommodate us in private houses. If you would like to come but staying with families does not appeal, please let us know as it may be possible to make alternative arrangements.

PHOTOGRAPHS COURTESY OF MIKE POWER AND GEORGE FREEMAN.



Our French partners in Houdan have secured some funding to encourage sports exchanges among young people, beginning this year over the first week end in April. Sadly we have not been able to find any youth teams to go. This will be repeated over the next four years up to the French hosting the Olympics and promises to be a lot of fun. These will be international events involving other twinning partners of Houdan and nearby villages. If you know of a local youth sports club that might be interested in joining in, please contact Alison Hill or Antonia des Forges.

We have started a new activity, "Marcher et Parler", (Walk and Talk) for those who want to practice their French conversation. Antonia des Forges and Lauren Kilsby are organising country walks followed by refreshment. Details are on our Facebook page and website.

Our successful French Film nights continue until March, a great way to spend a dark Sunday night in friendly company. These take place on the last Sunday of the month, in Pangbourne Village Hall at 6.45pm for 7.30pm, and are open to all. Entry is £6.00 and there is a cash bar. Films are shown in French with English subtitles. On 26th January we will be showing "L'homme du train" (The Man on the Train). A 2001 film by Patrice Leconte and with stunning central performances by the two stars, Johnny Halliday and Jean Rochefort. BBFC Classification 12. In this comedy drama, a man gets off a train in an unfamiliar place, looking for aspirin tablets for a headache, when he meets a stranger. These men seem to be opposites but as their relationship develops it becomes apparent that each really wanted the other's way of life. Described by the Sunday Times as "funny, moving, poetic, and an unsentimental look at failure".

On February 23rd we will be showing "Aurore" (I've got Life) (Cert 15) made in 2017 by Blandine Renoir, starring Agnes Jaoui as a fifty-something woman who's life has gone a little flat until she meets up again with an old love. This witty film is a "joyous observation of motherhood, friendship and femininity" (Diva Magazine). On 29th March, our last film of the season will be "The Diving Bell and the Butterfly". See our face book page for more details. <https://www.facebook.com/pangbournetwinning/>.

As we go to press, there are still a few places left for our Annual Epiphany Feast at the Ferry Boat, Whitchurch on Thames on January 10th. For menu details and a booking form contact Alison Hill [alisonpaicehill@gmail.com](mailto:alisonpaicehill@gmail.com), or check our Facebook page.

The PTA Management Committee has been looking into the origins of the Twinning between Pangbourne and Houdan and is working to encourage closer involvement of the current Parish Council in this civic enterprise. Look out for an article in the next issue of this magazine based on archive material and local memories. Also look out for the notice of our AGM in March.

A Happy New Year to all our members.

"Bonne Année!"

Alison Hill, Chairman ([alisonpaicehill@gmail.com](mailto:alisonpaicehill@gmail.com))



## NEWS FROM PANGBOURNE TENNIS CLUB

### WELCOME TO 2020!

If one of your New Year's resolutions is to take more exercise, tennis could be for you! These days, tennis is very much a fitness thing. Leading tennis coaches point out that tennis, on its own, is enough to keep a person fit into the 80s. So we are keen to keep everyone playing all year round for great exercise and fun. And you can take advantage of a winter membership, running to 31st March for just £10 for adults and £5 for children.



### CONGRATULATIONS TO BERKSHIRE LTA'S COACH OF THE YEAR – DAMIAN LANE

We are delighted that our club coach, Damian Lane, has been named Coach of the Year by Berkshire LTA. Damian has coached both adults and juniors at Pangbourne for many years. Damian is a great asset to the club, particularly because he is superb at tailoring his coaching so that everyone gets the most out of the sessions. You too can be coached by Berkshire's Coach of the Year by signing up for our coaching programme!

*Damian Lane:  
Berkshire LTA  
Coach of the Year*

### WINTER COACHING – STARTS ON SUNDAY 5TH JANUARY

Over the winter, Damian Lane will be coaching on Sundays from 11:30 to 13:00 from January to March. We are running two blocks: six sessions from 5th January to 9th February and then four sessions from 1st March to 22nd March.

"Pay and play" is £10 per session for members. We offer discounts for advanced booking; it's £45 for six sessions, or £32 for any four sessions over the season. Non-members are very welcome (the standard cost is £15 per session). Full details and the booking form are on our website: [pangbournetennis.org/coaching](http://pangbournetennis.org/coaching), email us at [info@pangbournetennis.org](mailto:info@pangbournetennis.org) to find out more.

### A SMASHING FINALE TO 2019

Members gathered on 8th December for our end of year festive tournament. The seasonal jumpers and Santa hats kept us warm on a breezy afternoon on court, before enjoying mince pies, mulled wine and hot chocolate. Many thanks to everyone for supporting the Christmas raffle to fund raise for court resurfacing in 2020.

### SPRING IS ON THE WAY

Looking ahead to the lengthening evenings and warmer weather, our spring programme for adults gets underway on Tuesday 7th April at 6pm. The very popular junior coaching starts on Friday 24th April. Register your interest by email us at [info@pangbournetennis.org](mailto:info@pangbournetennis.org), or find out more about the club by coming down to one of the coaching sessions. The club is located between the river and the railway on the Recreation Ground and we share the club house with Pangbourne Bowls Club.

*Pangbourne Tennis Club Committee*

**pangbourne**  
tennisclub



Show off **your** smile  
with straighter teeth!

*"Amazing service and care  
from start to finish"*  
Brenda Butcher



Enhance your appearance, ask us about Invisalign® clear braces.

High Street, Goring on Thames, Oxfordshire RG8 9AB

Email [reception@boathousedental.co.uk](mailto:reception@boathousedental.co.uk)

Call 01491 872394 to book a consultation

# themovementclinic



## Radiant Body Yoga

Saturday Mornings

*Start your weekend with an energetic, dynamic blend of Ashtanga & Kundalini yoga suited to all abilities, with Joy Golding*

## Physio-led Pilates

Beginners & Improvers: Mon & Thurs Evenings

**3D Pilates: Monday Mid-Morning**

*3D Pilates is performed solely in seated and standing positions to suit all ages and abilities. One-to-One Pilates training available. Led by chartered physiotherapist Vicky Elson-Smith*

## Massage

Deep Tissue Therapy • Sports Massage  
Upper-Back & Neck • Strapping & Taping  
*With Samantha Hinkley*

## Personal Coaching

Weight Loss • Nutrition • Fitness  
Strength & Conditioning  
Injury Rehab • Corrective Exercise  
Running Technique Specialists  
Event Preparation & Training Programs  
*With Robby Elson*

[www.themovementclinic.co.uk](http://www.themovementclinic.co.uk) • 41 Reading Road, Pangbourne, RG8 7HY  
info@themovementclinic.co.uk • 0118 327 9405



- Osteopathy & Cranial Osteopathy
- Podiatry & Chiropody
- Sports & Remedial Massage
- Acupuncture
- Reflexology
- Counselling - Adults & Adolescents
- Hypnotherapy & NLP
- Thai Yoga Massage
- Homeopathy
- Nutrition

Some of the conditions we treat at the Centre:

**Back Pain** **Headaches** **Neck Pain** **Sports Injuries** **Foot Problems** **Sciatica**  
**Muscle Tension** **Whiplash** **Smoking Cessation** **Weight Control** **Stress**  
**& Phobias** **Dietary advice for IBS**

Visit our website to see what else we can treat [www.thealewellbeingcentre.co.uk](http://www.thealewellbeingcentre.co.uk)



37 High Street, Theale,  
Reading RG7 5AH  
**0118 930 3535**  
[www.thealewellbeingcentre.co.uk](http://www.thealewellbeingcentre.co.uk)





**Spring 8-Week MINDFULNESS Course 2020**

**Good Health • Happiness  
Stress Reduction • Pain Relief**

The Care Hub, **Goring** Arcade, RG8 9AY

Tuesdays: 7-9pm from 28 January – 24 March (not 18 Feb)

Cost: £185 includes all course materials (approx £11/hr)

Open to Individuals, Groups and Businesses.

Fully qualified and accredited teacher.

E: [bonnie@positiveconsultancy.net](mailto:bonnie@positiveconsultancy.net) M: 07957 571620

**David Jones & Company**

Chartered Certified Accountants  
Registered Auditors

*Full Range of Accounting  
and Business Services including:  
Accounts Preparation, Company Audits  
Self Assessment Tax Returns  
Payroll Bureau  
Tax & Business Planning  
Company Formation and Secretarial  
Computer Systems Consultancy*

*Professional Services with  
a personal touch*

*Ask us for a quote*

19 Reading Road  
Pangbourne  
Reading RG8 7LR

Tel: 0118 984 5544

Fax: 0118 984 2304

Email: [info@davidjonesco.co.uk](mailto:info@davidjonesco.co.uk)

**MWB Carpentry**

Where Detail Matters

Specialist in second fix and bespoke furniture

Storage Units, Bookshelves, Media Cabinets  
Kitchens and Worktops  
Cupboards, Wardrobes, Fireplaces,  
Flooring, Skirting, Architrave, Doors inc: Bespoke  
Office Desks, Shelving and Stud Wall construction  
Garden Rooms, Workshops, Gates, Decks, Cladding

Call Matt - 07850 310220

e-mail - [matt@mwbcarpentry.com](mailto:matt@mwbcarpentry.com)

[www.mwbcarpentry.com](http://www.mwbcarpentry.com)



**How to deal with the cat conundrum**



Has your loved one been admitted to hospital?

Are they like Mrs Miggins and worrying who will feed the cat?

Do you need some support?

We offer domiciliary and live-in care on both a short and long term basis. Ensuring your loved ones to feel safe and secure in their own home. For more information and a FREE assessment please contact us 01189 323 865 or email [info@Q1care.co.uk](mailto:info@Q1care.co.uk)

*We are rated GOOD by the CQC (August 2018)*

Q1Care Ltd  
Unit 7, The Old Mill Trading Estate  
61 Reading Road, Pangbourne, Berkshire RG8 7HY  
T. 0118 9323 865

The Care Hub  
8 The Arcade, Goring  
Reading, Berkshire RG8 9AY  
T. 01491 525639

## **Cleaver Cars Ltd**

Independent Citroën Specialist



Servicing, repairs and MOTs  
All makes and models



Free local collection  
and delivery service



**Tel. 0118 957 6405**

67 Loverock Road  
Reading, RG30 1DZ

Email: [cleavercars@btconnect.com](mailto:cleavercars@btconnect.com)

[www.cleavercars-reading.co.uk](http://www.cleavercars-reading.co.uk)



Offering quality tree care  
from a family run firm

40 years experience in  
planting, pruning and removal

Free estimates and advice

Contact Stewart Bee on

**0118 9595 222**

**07976 611128**

[beetreeservices@tiscali.co.uk](mailto:beetreeservices@tiscali.co.uk)

*Seasoned firewood always available*



# **VISION**

*Your Local*  
**Timber Frame Manufacturers**  
**New Build Homes & Extensions**

**Build Fast, Strong & Energy Efficient 01189 712 181**

**[www.timber-frame-suppliers.co.uk](http://www.timber-frame-suppliers.co.uk)**



**BTL EMSELLA™**

# A breakthrough treatment for complete pelvic floor rehabilitation

Over 40% of women in the UK suffer from embarrassing "oops" moments, also known as urinary incontinence.

Andresa is the **FIRST** clinic in the south of the UK to offer **The BTL Emsella, a non-invasive, clinically proven solution.**

- 95% success rate
- Results in just 3 weeks
- Remain fully clothed and seated throughout
- Backed by science - FDA approved



If you would like to find out more about this unique, life-changing treatment or would like to book a complimentary and confidential consultation, call **01635 800183** | [info@andresa.co.uk](mailto:info@andresa.co.uk) | [www.andresa.co.uk](http://www.andresa.co.uk)



## ADEPT DIGITAL SYSTEMS

TV AERIAL & SATELLITE SERVICES

Members of Trustatrader

0118 941 9615 [www.adeptaerials.com](http://www.adeptaerials.com)

## DANCE FITNESS CLASS

Pangbourne Primary School, Wednesdays 7.30-8.30pm

Fun Sessions, everyone welcome.

Just come along or contact Andrea for more info: 0771 7023 007 or [turners.the@icloud.com](mailto:turners.the@icloud.com)



We stock delicious local, British & Continental cheeses as well as a wide range of delicatessen products. We're proud to support small artisan producers.

We pride ourselves on our customer service and are dedicated to providing cheese at its very best.

Come and visit us at 17 Reading Road, Pangbourne  
Find us on Facebook – The Pangbourne Cheese Shop  
Follow us on Twitter @PangCheeseShop

[www.pangbournecheeseshop.co.uk](http://www.pangbournecheeseshop.co.uk) 0118 984 3323



REBECCA KINGWELL  
WEALTH MANAGEMENT

Comprehensive, bespoke, financial services & planning



Rebecca Kingwell  
Wealth Management

I offer specialist advice across all areas of financial planning.

My expertise includes: planning for retirement, savings, investment planning, estate planning and tax efficiency.

For further details please contact:  
T: 01635 029 265 M: 07919 543 664

[rebecca.kingwell@slap.co.uk](mailto:rebecca.kingwell@slap.co.uk)

[www.rebeckakingwell.co.uk](http://www.rebeckakingwell.co.uk)

17 Sheepcote Farm, Wargrave,  
Berkshire RG10 8DQ

# CROSSWORD

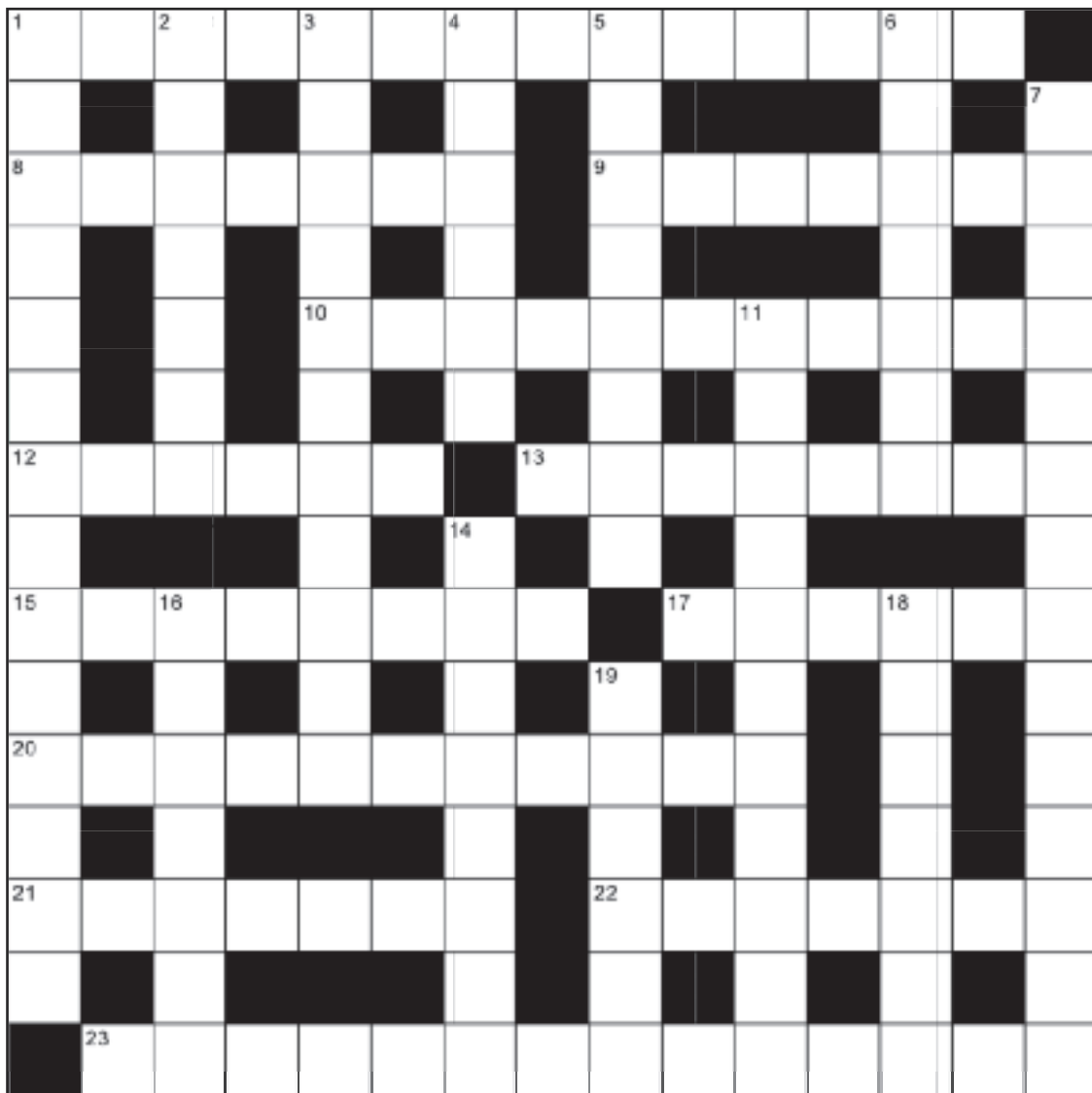

CANTOR'S CROSSWORD NO. 9

## ACROSS

1. Blaming the US currency market avoids the issue (7,3,4)
8. Here, just as a treat he was allowed to play his role (7)
9. This blessed man is missing his horse in Cornwall (7)
10. To accompany and fill his bare canvas, Ken buys over a Velasquez (6,5)
12. Scrumptious! Taste, age and opportunity for fruit (6)
13. A classic and legendary case of his finally being found down at heel (8)
15. How one keeps an eye on what's abroad (8)
17. Do such moments eventually come to naval personnel . . . sometimes at sea? (6)
20. Aquatic study could well lead you there (11)
21. Rooted underground growth has offshoot for gardeners (7)
22. Faulty card distribution in Kent (7)
23. Once, a coin that showed thrift – so why not try Ben's pie now? (10,4)

## DOWN

1. Verbal promise of singular support here (3,2,1,4,4)
2. Is an old time copper now out of the ordinary? (7)
3. Bury someone at the outset speaking on one's behalf (11)
4. Classic! Watch out for them bringing presents: that stinks! (6)
5. Such a moody marine mammal? Get over it! (8)
6. Get over or under it, or across it . . . or just along it – all are possible (7)
7. Beset by social and academic problems, they continue still (5,9)
11. Here, surely only actions can speak louder? The words simply aren't there (11)
14. The "fall guy" is told to get the next round in (3,3,2)
16. Categorical imperative for Pisceans? (3,4)
18. So here's the one who rails i.e speaks angrily about his Middle Eastern problem (7)
19. He sounded a great candidate for the brewery presidency (6)

(ANSWERS ON PAGE 62)



## PANGBOURNE VALLEY PLAYGROUP (PVPG)

Pangbourne Valley Playgroup is happy to welcome the new management committee members as appointed at the Annual General Meeting held on the 21st of November 2019. Pangbourne Valley Playgroup is a non-profit, registered charity, managed by the local families whose children attend Playgroup sessions. It has been successfully run by the community for the community for the last 25 years and it continues to offer a much needed childcare option for local families.

Pangbourne Valley Playgroup aims to enhance the development, education and welfare of children aged 2 to 5 through a wide range of activities and social experiences in a safe and happy environment with a “family atmosphere.” The welfare, happiness and development of the children is at the heart of everything we do, and children just love going to the Playgroup. Pangbourne Valley Playgroup welcomes children from all backgrounds ensuring that they are integrated, supported and develop their self-confidence through structured play and a variety of experiences.



At Pangbourne Valley Playgroup, children learn and gain their independence through play, the method that allows them to explore and make sense of the world around them, as well as developing their imagination and creativity. The weekly activities include cookery, music, singing, painting, water play, craft and dressing up. There is a secure garden area where the children can play with a wide range of outdoor toys. In addition to this, there are a number of outings and visits organised throughout the year (e.g., library, park and allotments).



Pangbourne Valley Playgroup operates alongside the West Berkshire school term timetable, providing morning and afternoon sessions as well as lunch club from Monday to Friday. The charity is registered and regularly inspected by Ofsted (currently rated Good), and as a member of the Pre-school Learning Alliance, its staff and members regularly review and update their skills and undertake any relevant training courses. In order to ensure the quality of the day care, a childcare development worker from the Early Years Development and Childcare Partnership pays regular visits to Pangbourne Valley Playgroup offering help and advice in all aspects of the pre-school.

Pangbourne Valley Playgroup is very fortunate to share the grounds with Pangbourne Primary School, which means that children get access to the well-planned and stimulating curriculum at the Foundation Stage 1 class offered five mornings a week during term time by Pangbourne Primary School to all 3-4 year olds. Our staff members have close relationships with the teachers from the school and support our children during the transition from pre-school to school. We offer a service to collect children from FS1 and bring them to Pangbourne Valley Playgroup for lunch club and afternoon sessions. Pangbourne Valley Playgroup provides 15 and 30-hour funded places to eligible children, with the possibility to split those with another provider (ie, FS1 Pangbourne Primary).

In order to maintain the high quality and affordable childcare service, we are heavily reliant on the generosity of parents and the local community. Donations of personal time, books, toys and other equipment, and money are always gratefully received and much needed. In addition to this, we run a number of fundraising events throughout the year such as our famous Pamper Evening at the Elephant Hotel, planned for the 6th March (6pm onwards), contact us for further details and tickets.

- a non-profit, registered charity, managed by the local families for the last 25 years
- enhances the development, education and welfare of children aged 2 to 5
- a safe and happy environment with a “family atmosphere”
- welcomes children from all backgrounds
- safely and securely located within the grounds of Pangbourne Primary School
- donations of personal time, books, toys and other equipment, and money gratefully received

For more details please visit [www.pvpg.org.uk](http://www.pvpg.org.uk) or email us at [pvpg.enquiries@gmail.com](mailto:pvpg.enquiries@gmail.com).

Pangbourne Valley Playgroup Committee





## PANGBOURNE PRIMARY SCHOOL

Pangbourne Primary School has many success stories to share and good news items to celebrate! It has been a very busy but exciting term.

### CHILDREN IN NEED – FRIDAY 14TH NOVEMBER

We were delighted to have a visit from the famous 'Pudsey Bear' to start their week of fund raising for 'Children In Need'. The staff had kept Pudsey's visit as a surprise and there were gasps of awe and excitement as Pudsey burst into a whole school assembly!! Thank you to Pangbourne Rotary Club who provided the support team for Pudsey!! Thank you school council for organising a week of fund raising for this charity and having takings of £687.24



### WE WILL REMEMBER THEM!

Have you seen the fantastic Year 6 'Remembrance Poppies' on the school fence?



### 28TH NOVEMBER – WATERMILL THEATRE TRIP

Year 1 – Year 6 had a fantastic trip to The Watermill Theatre to see The Prince and the Pauper. It was a great way to start the Christmas celebrations. Thank you FOPPS for supporting us with the cost of this event.

### ASSEMBLY FOCUS

For the next few weeks the focus in assembly with the pupils is around the life learning skill of 'communication'. We will be looking at all the great ways we positively communicate in different situations.

### GOVERNOR WORKSHOP

Mrs Fry and Mr Jackman ran a workshop for our governors on the new Ofsted framework and Curriculum focus. It is great to have such supportive governors on our governing board.

### Y1 WINDSOR CASTLE TRIP

Year 1 had a fun day trip to Windsor castle to learn about the 'Royal Family' and castles.



### Y4 NEWBURY MUSEUM TRIP

'Take Over Museum Event' This was a fantastic trip where the pupils were able to take over Newbury museum and do presentations about artefacts to others.



### ELECTRICITY WORKSHOP

Year 6 were delighted to have a presentation from SSE on electricity in school.



### YEAR 4 DT DAY – PANGBOURNE COLLEGE

'When four children from Pangbourne Primary School went to DT day this is what they did: First they drew bug-houses on a-symmetric paper (paper that helps you draw 3-d). Next they had a biscuit and a drink. Third they used wood-glue and wood blocks to build a frame for their bug-house. Fourth using a saw they cut bamboo at three inches long. Fifth they stuck the bamboo using hot glue! (Three people got burnt.) Then it was lunch time. The main course was yummy and the pudding was scrumptious. Sixth they drilled holes in small cubes and glued them in. Seventh they glued leaves in and the bug house was complete!' Written by Edgar and Yvie Year 4.



Melissa Fry – Headteacher, Pangbourne Primary School





The Autumn term is always busy for FOPPS, as we had the Pangbourne 10k Race (22 September), held a Social Disco at the Working Men's Club in October, made a bang with the amazing Fireworks Fiesta on Saturday 9 November and wrapped it up with a Christmas Fair at the school on Monday 16 December.

Thank you so much to all of our amazing volunteers, donors and helpers for all their work during this busy term! All the hard work from our teams of volunteers really paid off, as we raised £4000 from the 10k Race and around £6600 from Fireworks Fiesta.

## PANGBOURNE 10K

On Sunday 22 September, FOPPS managed the 10k run. Despite the heavy rain, some 300 runners set off for on our undulating route across the West Berkshire countryside, and benefited from tea, coffee, a cake stall and an amazing raffle on site.

## FIREWORKS FIESTA

The jewel in the crown of FOPPS events, the Fireworks Fiesta on 9 November was a success. Rain continued a theme but over 1000 hardy souls braved the drizzle and the puddles to attend the event, enjoying a bar, BBQ, toy stalls and tombolas. It was a fabulous evening. We even had volunteers from the 501st Legion, a volunteer group who dress up in Star Wars costumes to help raise money for charities.

This year, we welcomed lots more new volunteers including the Pangbourne Rotary, 80th Reading Scout Group and 1st P&P Scout Group helping out with various things from putting up a marquee, selling glow-toys, cooking or serving on the BBQ and helping us clear up again afterwards! Your help was very much appreciated – thank you.

We were also able to donate the additional food from the BBQ to Cirdic Soup Kitchen this year, reducing our waste and helping those in need.

## SUPPORTING OUR CHILDREN AT SCHOOL

This year FOPPS continues to make some really exciting investments for the children. We will be funding more ICT equipment, and are setting aside funds to add an additional Class's worth of Chromebooks. We have already bought new interactive whiteboards for two classes: and agreed to replace the whole school's whiteboards over time.

FOPPS always funds the coaches for trips that large groups take, and so far this year has provided coach funding for years 5 and 6 to attend the Henley Literary Festival and for the whole school to go to the Watermill Theatre in Newbury to see *The Prince and the Pauper*.

We are also now onto phase two of our playground equipment funding, and the next area due for refurbishment is the Foundation Stage.

## SUPPORT FROM THE CO-OP PANGBOURNE

We are again one of the local community fund charities in the Co-op in Pangbourne. 1% of spending on Co-op branded products is divided among the local community funds, and if you have a Co-op card you can log on to your account and nominate FOPPS as your chosen charity. Please consider supporting your local primary school by shopping at the Co-op over the next few months.



*The runners cross the start line*



*The amazing display*



*Visitors from a galaxy far, far away . . . or the 501st Legion*

# PANGBOURNE COLLEGE

---

## COLLEGE COMES TOGETHER WITH VILLAGE TO COMMEMORATE REMEMBRANCE SUNDAY

Pangbourne College's Marching Band led the village's parade of uniform organisations to mark Remembrance Sunday. The procession moved through the streets of Pangbourne to the Great War Memorial in the churchyard of St James the Less. This year, several members of the village Scouts joined the Band. At the service, the



Band led the singing, Upper Sixth student Maddy Sawbridge read the New Testament lesson, and the College's Drum Major, Lucy Perring, movingly played the Last Post.

Earlier in the day, the College community gathered to remember those who gave their lives in the major conflicts of the Twentieth Century. With hundreds in attendance for the Service in the Falkland Islands Memorial Chapel and even more present for the Parade which followed, it was a fitting tribute.



Four wreaths were laid by: Rear Admiral Roger Lane-Nott on behalf of the school Governors, Senior Deputy Head Mr Will Williams on behalf of the school, Chairman of the OP Society Mr David Nicholson (1964-68) on behalf of all Old Pangbournians, and Flight Officer Chloe Sainsbury on behalf of RAF Benson. RAF Benson also provided a Chinook and Puma flypast after the service.

Head of the College's CCF, RSM Colin Hearn, led the tribute to the fallen and the names of all 178 Old Pangbournians who were killed in World War Two were read out by students, Rebecca Follett, Daniel Gosney, Charlie King and Maddy Sawbridge.

---

## OLD PANGBOURNIAN AND INDUSTRY PROFESSIONALS OFFER ADVICE

Pangbourne pupils and families were able to gain insight and advice on career opportunities after their time at the College has come to an end thanks to the annual Apprenticeships Evening.

The event is held on two occasions during the academic year to introduce pupils to the range of options available to them after they leave Pangbourne.

The latest edition took place in November and saw industry professionals from Worley, Vodafone, Aim Group, Gillette, and GlaxoSmithKline provide inspirational and invaluable information on the night.

This year, the College was also joined by Old Pangbournian, Tom Nash, who is carrying out an apprenticeship at Ultima.



## RECENT COLLEGE LEAVER SCOOPS SECOND PLACE IN SPORTSAID AWARD

Dan Atkins (OP 2019) finished runner up in the SportsAid's 'One-to-Watch' Awards, in recognition of his superb kayaking performances throughout the year. Dan, who was shortlisted in the top 10 athletes, came in second place at the awards ceremony on Tuesday 19 November. He will be provided with a kit allowance by global sportswear brand Nike thanks to an ongoing partnership with SportsAid, and will receive £2,750.



The former Harbinger student dominated at major junior events in 2019 as he earned himself gold medals at both the Junior World and Junior European Championships in the K1 men's 200m discipline. He also swooped gold medals in the K1 men's 200m and the K2 men's 200m at the National Junior Championships this year, whilst tackling his A Levels at Pangbourne!

Dan was in fine company in terms of current nominees and past winners. Other athletes in the running this year included representatives from Taekwondo, Squash, Cycling, Boxing and Swimming, with ages ranging from 13 up to 19. Former winners of the award, launched in 2006, include Tom Daley, Amber Hill, Courtney Tulloch, and Morgan Lake.

The 18-year-old from Pangbourne commented on the assistance SportsAid has provided him so far, saying: "It's been a massive support – at the moment I don't have any other funding from my sport and sponsorship is quite hard to come by in kayaking. It allowed me to train more comfortably not really worrying about money. For me, kayaking is the sport I care about and love." He also discussed his wins earlier in 2019, saying: "The [world title] win was pretty eye-opening to be honest because it was the first time I'd thought to myself, 'wow, I can actually do this'. I am so happy that I could do it for all my coaches and the sport itself."

Dame Katherine Grainger presented the prizes on the night, much to the delight of the young athletes. Daniel said: "Meeting Katherine Grainger was amazing – she's done everything you can do in a sport and gone on to achieve all her goals and that's inspiring. This gives me the confidence to go on and do exactly what I want to do. I'm being recognised for my efforts and that gives you a bit of grounding and allows you to realise you're doing something substantial."

Everyone at Pangbourne College would like to congratulate Dan and continue to wish him well on his path to even greater achievements within the sport.

---

# neville & turner

Village & Country Property Agents

## *Thinking of selling or letting?*

*Whether you require specific valuation and marketing advice or wish to discuss general property matters and requirements, please call us - we are here to help.*

T: 0118 984 1841 E: [post@neville-turner.co.uk](mailto:post@neville-turner.co.uk)

A: 2 High Street, Pangbourne, Berkshire RG8 7AB

W: [www.neville-turner.co.uk](http://www.neville-turner.co.uk)

# Pangbourne Club

NEW MEMBERS WELCOME



## Facilities

- Air Con throughout
- 3 full size snooker tables
- Pool Table
- 2, 2mx2m projector screens and large TV's
- BT Sports
- Conference Facilities
- Function Room for hire with kitchen facilities and licenced bar

## Entertainment

- Live Entertainment every second saturday of the month
- Bingo every Thursday evening
- Jazz 1st Sunday evening of every month (fee applies)
- Ballroom Dancing every Tuesday evening
- Regular exercise classes
- Weekly raffles



## Teams

- Cribs teams
- Snooker Teams
- Dart Teams

LOWEST DRINK PRICES IN THE VILLAGE

## Objectives

PWMC is run as a non-profit making organisation by its members through an elected committee, which provides a social facility for residents of Pangbourne, the surrounding area and for people working in the village.

## Pangbourne Club

Rosewood Hall, Whitchurch Rd,  
Pangbourne, Reading,  
Berkshire RG8 7BS



Visit us on Facebook

[www.pangbourneclub.co.uk](http://www.pangbourneclub.co.uk)



## SPB STONERWORKS LTD

Tel: 01189371827 or 07971881504

Visit us @ [www.spbstoneworks.co.uk](http://www.spbstoneworks.co.uk)

Email: [simonbeale@spbstoneworks.co.uk](mailto:simonbeale@spbstoneworks.co.uk)

Special offers on all types of memorials: Headstones, Full memorials, Cremation stones, Children's memorials & Vases

FREE NO OBLIGATION QUOTES and FREE FULL COLOUR BROCHURE ON REQUEST



- **MONUMENTAL STONE MASONS**
- **SUPPLYING NEW MEMORIALS & HEADSTONES**
- **30 YEAR GUARANTEE ON ALL NEW WORK**
- **MEMBERS OF BRAMM & THE GUILD OF MASTER CRAFTSMEN**
- **RENOVATIONS & CLEANING OF EXISTING MEMORIALS**
  - **ADDITIONAL INSCRIPTIONS ALL STYLES**
  - **REPAIRS & RE-LEVELLING**
- **FAST & FRIENDLY SERVICE WITH HOME VISITS ON REQUEST**



**Come and visit us at our new showroom**

**Unit 3 & 5 of the Old Mill Trading Estate,  
Reading Road, Pangbourne RG8 7HY**

Appointment Only



# STANROD MOTORS 2

**is happy to collect and deliver your car  
for all your MOT and servicing needs**

**Call Steve or Sean  
at STANROD MOTORS 2  
today on 0118 976 7686**

Open 8am-6pm Mon-Fri • 8am-Noon Sat  
14 Station Road, Pangbourne, Reading RG8 7AN

[email: info@stanrodmotors2.com](mailto:info@stanrodmotors2.com)

## Plumbing, Heating and Property Maintenance CMC Boiler Services Ltd



01491 873535

[www.cmcboilerservicesltd.co.uk](http://www.cmcboilerservicesltd.co.uk)



- Oil, natural gas, LPG and renewable energy
- Renewable energy installations and repairs
- Boiler servicing, repairs and installation
- Gas fire servicing, repairs and installation
- Underfloor heating installations and repairs
- Full heating installations and repairs
- Power flushing, chemical treatment and descaling
- Landlords Gas Safety certificates (CP12)
- Bathroom installations, renovations, wall and floor tiling
- Property repairs, alterations and extensions

*Family run business, with over 40 years' experience locally*

## Coombe House RESIDENTIAL CARE

- Retirement home in Streatley on Thames
- 24 hour care and support by well qualified staff
  - Elegant, homely and relaxed country house in attractive grounds
  - Peace, privacy and independence in caring surroundings
  - Serving the local community for over 30 years



01491 872174 [www.coombehouse.co.uk](http://www.coombehouse.co.uk) [enquiries@coombehouse.co.uk](mailto:enquiries@coombehouse.co.uk)



## PERSONAL TAX RETURNS

Contact Geoffrey Cole  
**Geoffrey Cole & Co**

*Chartered Accountants & Registered Auditors*

**4 Reading Road Pangbourne Berkshire RG8 7LY**

**Telephone 0118 984 1556 Email [post@geoffreycole.co.uk](mailto:post@geoffreycole.co.uk)**

**[www.geoffreycole.co.uk](http://www.geoffreycole.co.uk)**

# PANGBOURNE PLACE-NAMES

## MARSH PLACE

**Marsh Place** is a development that was completed in 2005, built on the site of the former Marsh Farm Farmhouse. The house itself had fallen into disrepair in the 1960s and was demolished. The cowman's cottage and the milking parlour stood on the site of the Primary School, and all that now remains of the farm are the cottages, dating from 1730 and renamed in modern times Coach House Cottages.



Marsh Farm cowman's cottage in the 1930s (bottom right on the plan).

**Marsh Place** recalls **Pangbourne Marsh**, an extensive area of marshy ground on the eastern side of our village bordering Sulham Brook. **Marsh Place** is on the north side of Reading Road, but on a map of 1840 the marsh is shown as only starting from the south side. This marsh stretched well up towards **Tidmarsh**, where in Anglo-Saxon times it may have been 'in common ownership' (Tid-).

There is on-going scholarly debate about the exact difference in place-names between *mersc* (marsh) and *mor* (moor), both of which feature in our village place-names. As the late Professor Margaret Gelling observes, the general tenor of English place-names suggests that the Anglo-Saxons were much more aware than we are of the importance of drainage arrangements, and it would seem that, broadly speaking, a *mersc* represented more valuable agricultural land than a *mor*. This certainly appears to be borne out down to the present day in our own parish, where the land towards Sulham Brook, historically called *Pangbourne Marsh*, is more productive than the land beside the Tidmarsh Road, where many of our local *mor* names lie.

Further up the valley of Sulham Brook, beyond Sulham, the volume of water passing down that stream becomes less significant. This is implied in the name **Malpas**, Theale, which, unusually for a minor name, is of French origin. Meaning 'bad (Mal-) passage (-pas)', it seems certain that the reference is to marshy ground that was difficult to cross. The same was true at the marsh (*strod*) at **Stroud Green**, Greenham, so a route through it may have been marked by the stakes (*pil*) which led to **Pile Hill**.

There is a range of words in our area referring to areas of marshland in different conditions. The marsh was 'overgrown with brushwood' (*strod*) at **Stroud's**, Bradfield. At **Wash Common**, Newbury, simply called *Le Weshe* in a document of 1547, the low-lying ground was 'liable to flooding', and the same problem was encountered at **Wash Water Farm**, Enborne. **Laggs**, a field-name at Warfield, was a 'narrow marshy meadow by a stream'. Other unusual words for marshy or swampy ground are recalled at curiously colourful names in our area, like **Quab Hill**, East Hendred (*cwabba*), **Big and Little Gogs**, Sonning Town (*gogge*), **Snap**, Aldbourne (*snaep*), and **Van Place**, Eversley (*fenn*). At **Spring Galls Farm**, Swallowfield, there was a 'wet spot in a field' (*galla*), as too as **Gormoor Cottages**, Easthampstead, *Gall Moore* in 1607.

**Slough** presents an interesting problem. If one follows the Celtic linguists, the settlement takes its name from a granary, *ysleow*, that must have stood at the crossroads where in pre-Anglo-Saxon times the road to Windsor, the 21st century A332, met what is now the Great West Road. Later, not recognizing this word, the Anglo-Saxons took it to be *sloh*, meaning just a 'muddy place'. Only later did 'slough' develop a marshy meaning, as in the 'Slough of Despond' of Bunyan's *Pilgrim's Progress*, where it is a deep bog that Christian has to cross in order to get to the Wicked Gate. The original meaning of *sloh* is borne out by the closely related *sol* 'wallowing place for animals', as at **Grazeley**. Called *graegsole* in a document said to be dated 950, this was the wallowing place of a 'grey (*graeg-*)' animal, thought to be either a badger or a wolf.

On occasion, marshland is implied in the place-name, although not actually stated. At **Drayton** there was an estate (-ton) where sledges (Dray-) were used instead of carts, being no doubt easier to propel over the marshy ground on the land there by the Thames. **Cholsey**, 'Ceol's island', which is some way from the Thames, represents, not literally an island (eg, developed to -ey), but an area of dry ground in a marsh. Similarly, at Bucklebury, the curiously named **The Forty** is an 'island' (-y) standing out from surrounding marsh. It is thrust 'forth' (Fort-), lying on a spur of land between two streams. More colourfully, **The Bellows**, Sulhamstead, refers, not to some long abandoned piece of blacksmith's equipment, but to a narrow belt of marsh perceived as being shaped in that way.

As land has been drained over the centuries, it is difficult to comprehend that many areas were originally marshland whose condition is now only recalled in a place-name. **Marsh Farm** is surely a case in point.

Nigel Suffield-Jones

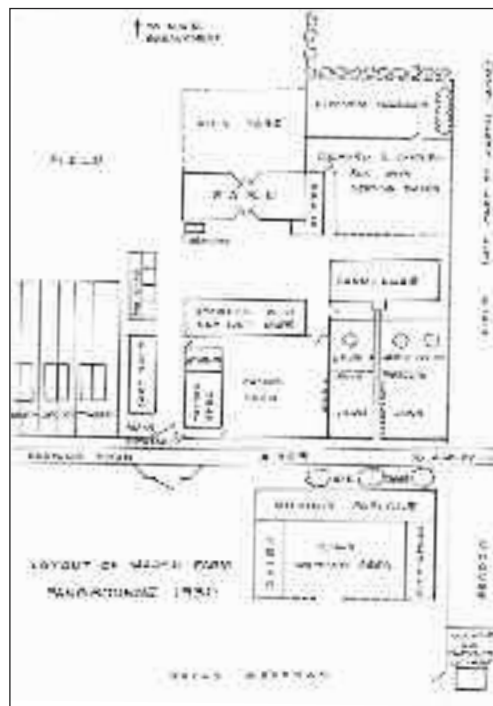

Layout of Marsh Farm in 1930.

ILLUSTRATIONS COURTESY OF PANGBOURNE HERITAGE GROUP



**“Lafford & Leavey, experts in bringing the outside - inside”**

## **Windows - Doors -Conservatories UPVC or Timber**

One of the leading window, door and conservatory installers in Berkshire, offering free quotations and advice from a company with a formidable reputation spanning 50 years. Choose from a wide range of products in a style and finish which will suit your budget and needs, we are only a phone call away.

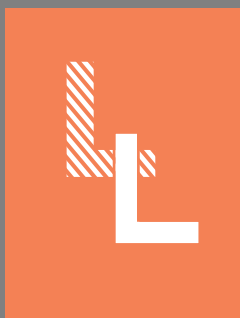

# **LAFFORD & LEAVEY LTD**

ARROWHEAD ROAD, THEALE, READING, RG7 4AZ

Tel: Reading (0118) 9303333 Fax: (0118) 9323707

Email: [lafford.leavey@btconnect.com](mailto:lafford.leavey@btconnect.com)





## The Beetle & Wedge Boathouse

Moulsford-on-Thames

The Beetle & Wedge Boathouse enjoys a wonderful riverside setting. Whether a dish from the charcoal grill, a light lunch or a special occasion, come and experience a unique welcome.

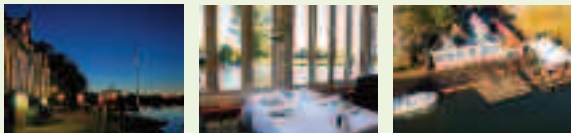

### 15% OFF FOOD!

PLEASE PRESENT THIS ADVERT ON ARRIVAL

Valid from 2nd January – 31st March 2020. Main course per person must be ordered. Exempts all beverages. Not valid in conjunction with any other promotion including Steak & Chip night. Not valid on Friday 14th February. One voucher per table.

Don't forget . . .

EVERY TUESDAY NIGHT IS STEAK NIGHT – £38 for two  
Steak, Chips, Onion Rings and a Bottle of Merlot

Telephone 01491 651381  
[www.beetleandwedge.co.uk](http://www.beetleandwedge.co.uk)



## ARUM

Tree Services

0118 971 2224  
07876 232 282

[www.arumtreeservices.co.uk](http://www.arumtreeservices.co.uk)

Professional | Dedicated | Specialists

## Charles Darrington

### FCA

Local Accountant

### Services Include...

- Bookkeeping.....from £18p/h
- Ltd Co. Accounts.....from£700p/a
- VAT Returns.....from £100p/a
- Self Assessments.....from£70p/a

All prices excluding VAT

For a free quote call or email

07887910000

CHARLESDARRINGTON@GMAIL.COM

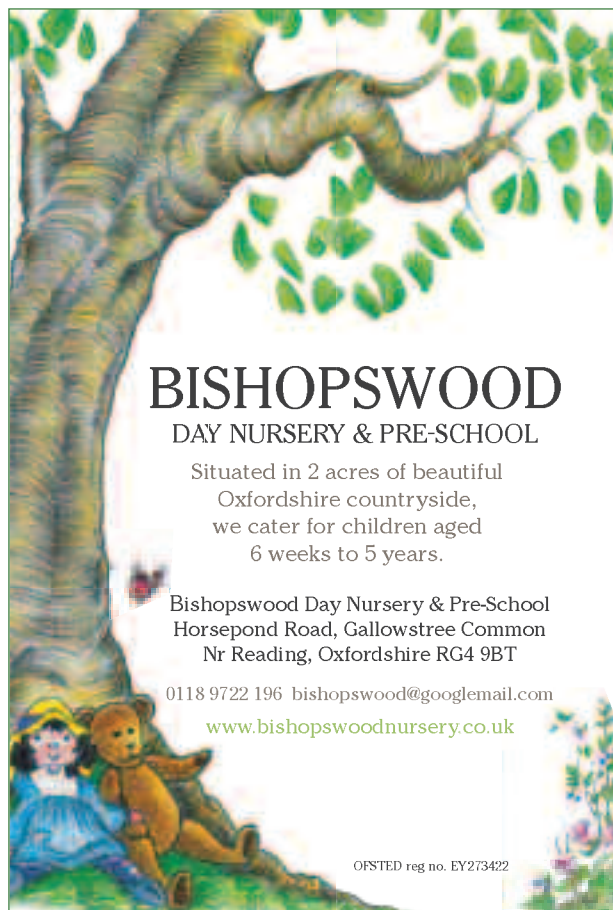

## BISHOPSWOOD

### DAY NURSERY & PRE-SCHOOL

Situated in 2 acres of beautiful  
Oxfordshire countryside,  
we cater for children aged  
6 weeks to 5 years.

Bishopswood Day Nursery & Pre-School  
Horsepond Road, Gallowstree Common  
Nr Reading, Oxfordshire RG4 9BT

0118 9722 196 [bishopswood@googlemail.com](mailto:bishopswood@googlemail.com)

[www.bishopswoodnursery.co.uk](http://www.bishopswoodnursery.co.uk)

OFSTED reg no. EY273422



## PANGBOURNE AND WHITCHURCH SUSTAINABILITY NEWS



I was speaking to someone who had been shopping yesterday, just for socks in Marks and Spencer, and came home with seven pairs of multi coloured socks packaged on a plastic ladder held together by a cardboard sleeve. Ten marks for no outer plastic covering, but minus ten marks for the moulded plastic unless of course Marks and Spencer make it clear that they will have it back and recycle it! I know many people are removing plastic packaging and leaving at the till, but is there a policy of reusing these moulded plastic hangers? The plastic problem does not just lie with bags and bottles, but with the infrastructure of modern packaging and marketing. We need socks, but we do not need to be seduced into buying them by the way they are displayed.

Extinction Rebellion? Love them or hate them? The press is having a field day as indeed is our Prime Minister, but by whatever means they are trying to bring our environment crisis to the heart of all decision making. Britain has already had a few days of all power being generated by renewables and our offshore wind farms are proving very successful. There is already a success story in some areas of renewables, but why is it not consistent? Why is it no longer financially viable for homeowners to install solar panels? Why is it not possible to have a consistent, equitable recycling policy across the country avoiding the frustration many people feel about recycling because they do not have the knowledge or provision to avoid their waste going into landfill?

PAWS continues to investigate alternative recycling projects. Many thanks to Jathan who organised a trip to Ardley. This is his report:

“At the beginning of September a group of PAWS members visited the Ardley Energy Recover Facility near Bicester in Oxfordshire which was built in 2014. The location is a significant archaeological site, and we saw within the grounds the longest run of dinosaur foot prints in Europe of a type of megalosaurus. (The one in the picture by the way is a life-size model made completely of rubbish.)

The group was shown round the plant by Education and Visitor Centre Officer Susan Benson. After an introductory briefing at the visitor centre we were escorted to parts of the plant. The ‘bunker’ is where unrecyclable domestic and business waste is lifted by giant grabbers, rather like an oversized amusement game, onto conveyors. The facility treats 326,300 tonnes of non-recyclable waste each year, diverting more than 95% of Oxfordshire’s residual municipal waste away from landfill. There are two lines of waste flow into the incinerator furnace which is burnt at over 850°C. The heat drives a turbine producing up to 30MW of electric power. (The cooling towers apparently house peregrine falcons which can sometimes be seen flying from their nest.) The remaining waste output is processed into gases including carbon monoxide which are processed and released to the atmosphere under Environment Agency supervision and solids which are turned into a form of limestone used for building materials. This was a fascinating visit, looking at a method of energy recovery and waste disposal – a ‘less bad’ option until we can make our economy more fully circular with respect to processing our rubbish. Further information can be found at [www.viridor.co.uk/energy/energy-recovery-facilities/ardley-erf/ardley-visitor-centre](http://www.viridor.co.uk/energy/energy-recovery-facilities/ardley-erf/ardley-visitor-centre).”



Also in September Jackie S and Jo organised a children's clothes swap in Pangbourne Village Hall – a very big thank you to them.

In October we had a beautiful afternoon for apple pressing at the maze in Whitchurch. Enjoying a break in the rain about thirty people joined in, bringing apples from gardens and collected from fallen apples on the roads and paths around the area. Nature's bounty was not overlooked and instead of wasting we were able to take home bottles of extremely sweet apple juice.



The Barn Dance provided an evening of fun and relief from the weather raising money for the drinking water fountain to be installed by Action for Pangbourne Toilets. Thank you to all who came, to those organising the food and to the band for a lovely evening's music and dancing.

In November we spent an evening looking at the history of the electric car. Did you know that from 1899 to 1920 the electric car dominated the market, certainly in the USA, but fell out of favour when the self-starter was invented allowing petrol cars to be started without the crank handle? This coincided with the new love affair for cheap oil.

Fast forward to the 1990s when General Motors spent over \$1 billion producing a fleet of electric cars which by 2005 were mysteriously withdrawn and shredded. Why? There were many potential suspects: the power of the oil moguls, US state politics, fear of change, lack of demand? We don't know but the few thousand customers who did manage to lease one maintained that it was the best car they had ever driven; they had to see their cars reclaimed and destroyed. Where might we be now if this story had ended differently?

Heather Thorne

## PAWS FORTHCOMING EVENTS

WHEN	WHAT	WHERE
Thursday 16th January 2020 8pm	PAWS 2020 Planning Meeting	Pangbourne Village Hall



Please find enclosed a leaflet from the Pangbourne Flood Group giving advice on action in the event of flooding.

### Pangbourne Flood Wardens:

Kay – kay@laceysmk.plus.com  
Tel: 0118 984 2221 / 07889 231136

Stephen – stephenbillyeald@btinternet.com  
Tel: 0118 984 3368



# Cosmetic & Laser Skin Clinic



- laser hair removal
- lines / wrinkles
- crows feet
- lip enhancement
- microdermabrasion
- skin tightening
- brown spots
- skin peels
- mole, cyst, skin tag
- tattoo removal
- facial / leg veins
- Vaser - fat removal
- eye lid surgery
- dermaroller
- underarm sweating
- acne

Professional, Caring and Confidential

Treatments for Men and Women

The  
**CHILTERN** *medical clinic*

Dr N. Munnelly Medical Director



60 Broad Street • Reading • RG1 2AF  
1 Thames Court • High Street • Goring • RG8 9AQ

HIGHLY SKILLED DOCTORS RENOWNED FOR EXCELLENCE

Call 01491 873 989 or 0118 958 2016

[www.chilternmedical.co.uk](http://www.chilternmedical.co.uk)



**TAPROOM  
+ KITCHEN**  
WEST BERKSHIRE BREWERY

- EVENTS
- TOURS
- **REAL ALE**
- CRAFT BEER
- SHOP
- TAPROOM
- KITCHEN

**OPENING HOURS**

SUN - TUES | 10AM-6PM  
WED - SAT | 10AM-11PM  
SHOP OPEN DAILY 10AM-6PM

01635 767090

TAPROOMANDKITCHEN@WBBREW.CO.UK

**WBBREW.COM** **WESTBERKS BREW**

WEST BERKSHIRE BREWERY | THE OLD DAIRY | YATTENDON | RG18 0XT



**Cold nights. Warming dinners.**

Try one of our award winning pies today -  
the perfect comfort food this Winter.



Visit our website for more information.

[greensofpangbourne.com](http://greensofpangbourne.com) 0118 9842063



GoPButchers



GreensOfPangbourne



**E. A. LAMING**  
FLAT ROOFING

15 years guarantee  
on all high performance felts

also

Tiling and Lead Repairs

Phone Bradfield  
0118 9744701 or  
07880 930 958

Email: [eddylaming@hotmail.co.uk](mailto:eddylaming@hotmail.co.uk)

*38 years experience*



**J A M Upholstery**

Traditional Antique & Modern Upholstery  
& Re-covering

Seat feeling soft and saggy?  
Arms need firming up?  
Lumbar lacking support?

Jenny can give your favourite chair the love and  
attention needed to get it back in shape,  
or simply give it a new look in a new fabric.

[www.jamupholstery.co.uk](http://www.jamupholstery.co.uk)

[jenny@jamupholstery.co.uk](mailto:jenny@jamupholstery.co.uk) 07976 443972  
Based in Lower Basildon



**BUILDING, CARPENTRY AND  
HOME IMPROVEMENT SPECIALISTS**

**ALL WORK GUARANTEED**  
OVER 15 YEARS EXPERIENCE

- EXTENSIONS
- ALTERATIONS
- RENOVATIONS
- EXTERNAL DECOR
- CONVERSIONS
- KITCHENS/BATHROOMS
- PATIOS/DRIVES
- LISTED BUILDING WORKS

**ALL ASPECTS OF BUILDING WORK UNDERTAKEN**  
**FULLY INSURED - REFERENCES AVAILABLE**

**0118 9845959 0791 7095379**

**Plant & tool hire for  
trade & DIY.**

Your first choice for the best  
equipment, service and price.  
Go to [www.didcotplant.co.uk](http://www.didcotplant.co.uk) to  
check our online catalogue.



**DIDCOT PLANT**  
PLANT AND TOOL HIRE FOR TRADE & D.I.Y.  
[www.didcotplant.co.uk](http://www.didcotplant.co.uk)

**01235 814000**

Unit 12,  
Manor Farm,  
Peppard Common,  
RG9 5LA



**YOUR LOCAL GLASS  
AND GLAZING COMPANY**

- All types of glass cut to size
- Mirrors, shelves and table tops
- Greenhouse glass and picture glass
- Full glazing service, trade and domestic
- Broken windows and shopfront glass replaced
  - Traditional leadlights repaired
  - Broken and misted double glazed sealed units replaced
- UPVC, aluminium and hardwood windows, doors and conservatories
  - Delivery service

**CALL FOR ADVICE AND FREE QUOTATION**

**01491 629901**



## PANGBOURNE PARISH COUNCIL

*Best Wishes for 2020 from Pangbourne Parish Council*

### GRANT APPLICATIONS 2020

The Parish Council have limited funds available each year for grants to groups, charities and organisations within the Parish that meet certain criteria.

The Parish Council would like to invite applications for 2020 Financial Year from local groups that meet these criteria to fund projects for the benefit of the residents of Pangbourne.

Applications should be received by 1st April 2020, although it is possible that applications received after this date may be considered in a second round of grants if there are funds remaining.

Please see the website or contact the Clerk on [Clerk@Pangbourne-pc.gov.uk](mailto:Clerk@Pangbourne-pc.gov.uk) for further information or an application form.

In 19/20 Year the Parish Council was able to help fund a number of projects including new school playground equipment for Pangbourne Primary School and support for the continued operation of the Public Toilets at Station Road Carpark:



In addition to this the Parish Council continues to provide funds to support the operation of the local Bus Service and Pangbourne Library.



---

### MILLENNIUM AWARD 2020

The Millennium Award returns for 2020 and will be presented at the Annual Parish Meeting on TUESDAY 21st APRIL 2020.

This is a really exciting opportunity to vote for residents or groups who have made a significant contribution to the Village. It would be lovely to see nominations by and representing all age groups and interest groups and organisations in the village. Please see the separate form and information on how to nominate elsewhere in this issue. Nominations close on Friday 27th March 2020.

### PLAYGROUND VANDALISM

It is very disappointing to report that the Children's Playground at the Recreation Ground has recently been subject to vandalism which forced its temporary closure on safety grounds. This is in addition to a spate of vandalism over the spring and summer.

The Parish Council are working hard to arrange the necessary repairs to the playground however this may take some time while the replacement parts are on order and the ground dries out enough for new surfacing to be laid.

In the meantime, temporary fencing has been arranged so that the unaffected pieces of equipment can be re-opened. We apologise for the inconvenience and thank parents and children alike for your patience and understanding. Please do not use any of the equipment that is closed off as it is not safe to do so.

Meanwhile security at the playground and Recreation Ground remains a focus for the Parish Council. If you see anything unusual or suspicious, please do let the council know if it is safe to do so.

### PANGBOURNE & DISTRICT BOWLS CLUB

New Year, New Sport? Ever considered Bowls?

Pangbourne Bowls Club has a rich history with the village. It is coming up to its 100th Birthday having been founded in 1922. Numbers at the Club are currently low and it is actively looking for new members in order to continue to provide all of its current services. Look out for our special feature on the bowls club next month.

Anyone interested in joining should contact [alan@alancopeland.co.uk](mailto:alan@alancopeland.co.uk) or visit the website [www.pangbournebowls.co.uk](http://www.pangbournebowls.co.uk).

### OPEN SPACES & AMENITIES WARDEN

It gives the Parish Council great pleasure to announce the appointment of an OPEN SPACES AND AMENITIES WARDEN.

Alise will be patrolling the Recreation Ground and Meadows regularly checking for litter, overstaying moorings, the condition of bins and so on. She will be working closely with the Clerk to ensure that the facilities in these areas are kept in good condition, reporting on equipment at the playground, the cleanliness of Recreation Ground Toilets, reporting on vandalism, fly tipping and graffiti and reporting potholes and other such issues on non parish council land to West Berkshire Council. Patrols will also extend to the Chiltern Walk play area, allotments and the Cemetery. It is hoped that this role will cover many of those previously taken on by the Neighbourhood Wardens.

The Warden can be contacted on [villagewarden@pangbourne-pc.gov.uk](mailto:villagewarden@pangbourne-pc.gov.uk).

*If you see Alise on patrol, please feel free to say hello!*

## RECREATION GROUND MANAGEMENT COMMITTEE

The Parish Council is seeking to set up a recreation Ground Management Committee formed of two councillors and 4-5 residents, members of sports clubs or those with an interest in seeing this area develop to its full potential for anyone and everyone who wishes to use it.

The Committee will work jointly with all the clubs currently operating at the Recreation Ground and assist in developing an overarching vision of how this open space can best serve the needs of the community going forward. The Committee will report back to the Parish Council and it is anticipated that once established, they will work with the council to deliver better services and facilities here.

If you are interested in joining the committee or want to discuss this further please contact:

*The Clerk –*

clerk@pangbourne-pc.gov.uk, or

*Cllr Matt Shakespeare –*

mattpangbournepc@gmail.com, or

*Chairman Peter MacIver –*

peterpangbourne@gmail.com, or

*Grounds Chairman –*

chrispangbourne@gmail.com

## CAR PARK SURVEY

The Parish Council are seeking to undertake a car parking survey to better understand usage across the village. Whilst it is well known that parking spaces in the village are at a premium, a better understanding and record of usage is now needed to push for improvements and to address this issue with West Berkshire Council. It is likely that this survey will take place in April once the weather is more conducive, either immediately before or after the Easter Break.

**The success of this survey will be dependent on a fairly large number of volunteers** being able to do short shifts (approx. 1-2 hours) at one of the car parks in the village and requesting visitors to the car parks complete a short survey. Please Contact the Clerk if you are able to help with this important project.

## REMEMBRANCE DAY

Thank you to everyone who attended and helped organise the Remembrance Day parade and service.

Special thanks go to the Marshalls who volunteer their time to manage the official road closures to ensure this event can happen and to the Pangbourne Band for once again leading the parade.

## DATES FOR YOUR DIARY

### Annual Litter Pick Day

Saturday 28th March 10am – 2pm

The date for the Annual Litter Pick has been set. Once again a dedicated group of volunteers, Councillors and PAWS are helping to run the event and everyone is welcome to come along and support this worthy event and keep our village litter free!

Litter pickers, gloves and all equipment will be provided. We are hoping for a repeat of last year when the sun shone gloriously and we had a great turn out. Families and volunteers of all ages are welcome.

Just turn up on the day at Pangbourne Recreation Ground to collect your kit and be assigned an area. We would particularly welcome anyone who can help organise the day so please do contact the Clerk on clerk@Pangbourne-pc.gov.uk in advance if you would like to be involved.

There was such good turn out last year that we are hoping to organise a few small additional projects to take place over this weekend, such as re-painting and repairing fences, painting the pergola at the cemetery, work at the sports pavilion and gardening work around the village and at the cemetery. **THIS CAN ONLY BE DONE IF WE HAVE ENOUGH VOLUNTEERS.** If you have a project you would like to suggest that you can help organise or take part in, please contact the Clerk on the email above or pop into the Parish Office.

### Annual Parish Meeting

Tuesday 21st April 7.30pm

The Annual Parish Meeting will be held at the Village Hall again this year. Doors open at 7.00pm and the Meeting commences at 7.30pm. Refreshments will be available from 7.00pm onwards.

The meeting is open to ALL RESIDENTS of Pangbourne and we hope to see as many of you as possible on the night. For those who have never been before, this is a meeting of and for the residents rather than a normal Council meeting. It is your opportunity to hear updates on what local groups and the Parish Council are working on and to find out how to get involved. It is also a chance to have your say or share ideas! The Millennium Award for 2020 will also be presented (see nomination form). We would love to see as many people there as possible so please make a note in your diary!

If you would like to present on behalf of a group or project please contact the Clerk.

### Watermill Theatre Production

Saturday 20th June

We are very pleased to welcome back to Pangbourne Village Hall the ever popular Watermill Touring Production this year. The production is "CAMP ALBION". More information on the production please see the advertisement listed elsewhere in the magazine. We would recommend early booking as space is limited for this often sold out event. The Box Office for this event is expected to open towards the end of January and tickets are available through the main Watermill theatre Box Office. Refreshments will be available.

# COUNCIL NEWS



PANGBOURNE PARISH COUNCIL SEEKS A  
HIGHLY MOTIVATED, ENTHUSIASTIC PERSON TO TAKE ON THE POST OF  
**ASSISTANT CLERK TO THE COUNCIL**

20 hrs per week including some evening work

Duties include: liaising with the public, agenda preparation and minute taking and willingness to undertake training in aspects of local authority administration

Closing date 31st January 2020

Full details on the website: [www.pangbourne-pc.gov.uk](http://www.pangbourne-pc.gov.uk)

## MILLENNIUM



## AWARD 2020

DO YOU KNOW OF  
AN UNSUNG HERO IN PANGBOURNE?

SOMEONE WHO VOLUNTEERS TIRELESSLY  
OR GOES THE EXTRA MILE TO HELP OTHERS  
OR DELIVER PROJECTS?

SOMEONE WHO SUPPORTS YOUTH SERVICES,  
SPORTS CLUBS AND FACILITIES, ADULT SOCIAL CARE,  
PLAYGROUP, CHURCH GROUPS, SCHOOL SERVICES  
OR RUNS A CLUB OR SOCIETY?

HAS ANYONE DRIVEN A PROJECT OR RUN A CAMPAIGN  
TO IMPROVE THE VILLAGE OR LOCAL AREA?

IF SO, THEY DESERVE YOUR VOTE.

Pangbourne Parish Council are pleased to be able to announce that nominations are once again open for the **Millennium Award**. The winner of the 2020 award will be presented with Award Bowl at the Annual Parish Meeting on Tuesday 21st April 2020.

The **Millennium Award** is awarded to a variety of groups and individuals, in recognition of their contribution to the village, either through their work or voluntary activities. No one individual or group is allowed to win for a second time.

Please fill in the nomination form below and post/drop it in to the Parish Office at the Village Hall, Attn Clerk, Pangbourne Parish Council, Parish Office, Pangbourne Village Hall, Pangbourne RG8 7AN or email the Parish Council on [clerk@pangbourne-pc.gov.uk](mailto:clerk@pangbourne-pc.gov.uk), to arrive no later than Friday 27th March 2020.



### MILLENNIUM AWARD

I would like to nominate: \_\_\_\_\_

Contact information of nominee (if known): \_\_\_\_\_

I feel that they should be given the Pangbourne Millennium Award because: \_\_\_\_\_

\_\_\_\_\_

\_\_\_\_\_

My name is: \_\_\_\_\_

*(It is not essential to give your own name if you would rather not)*



# COUNCIL PLANNING

## PLANNING APPLICATIONS REVIEWED BY THE PARISH COUNCIL SINCE LAST ARTICLE

APP NO:	PROPOSAL	RECOMMENDATION
19/0286/ HOUSE	Garage conversion, new pergola and replacement driveway 24 Horseshoe Road, Pangbourne RG8 7JQ	NO OBJECTION
19/02922/ HOUSE	Erection of two storey side extension and single storey rear extension replacing existing 42 Horseshoe Road, Pangbourne RG8 7JH	NO OBJECTION
19/02897/ PACOU	Prior approval for change of use under Class PA from B1(c) to C3 Kiosks Water Pumping Station, Tidmarsh Road, Pangbourne	COMMENT
19/02882/ LBC2	Removal of internal masonry to existing "blocked" sash windows to allow windows to be used fully for increased daylight to the rooms internally and to improve the external appearance by removing the "blacked out" appearance Bere Court, Bere Court, Pangbourne RG8 8HT	NO OBJECTION
19/02881/ LBC2	Formation of new Kitchen in SW corner of the Ground floor of the house, removal of internal non-loadbearing wall to passage, and forming opening in wall dividing current Kitchen and Utility area, new limecrete floor with stone tiles over and new ceiling formed under existing ceiling level. Replacement of south door with French doors, new sash window to West elevation and replacement of panels in West door with glass. Bere Court, Bere Court, Pangbourne RG8 8HT	NO OBJECTION
19/02832/ LBC2	Removal of C19th and C20th chimney pots to allow flue size to be increased to original intended volume to allow use of open fireplaces on the ground and first floors Bere Court, Bere Court, Pangbourne RG8 8HT	NO OBJECTION
19/02739/ LBC2	Removal of late C20th screen from lobby area and wc behind screen and formation of new ground floor wc in link area under first floor bathroom. Bere Court, Bere Court, Pangbourne RG8 8HT	NO OBJECTION
19/02413/ LBC2	Repairs, replacement and alterations to existing basement and ground floors after Asbestos removal works and insertion of access hatch and stair to basement Bere Court, Bere Court, Pangbourne RG8 8HT	NO OBJECTION
19/02562/ HOUSE	Demolition of existing conservatory, erection of single storey side and rear extensions, first floor extension and new roof over porch and front part of the garage. 19 Briars Close, Pangbourne RG8 7LH	NO OBJECTION
19/02460/ FULD	Planning application for block of nine flats and reconfigured car park Clifton House, 17 Reading Road, Pangbourne RG8 7LU	OBJECTION
19/02758/ HOUSE	Construction of new single storey rear extension replacing existing single Storey lean-to 99 Horseshoe Road Pangbourne RG8 7 JL	NO OBJECTION
19/02721/ LBC2	Proposed internal alterations to the existing premises at ground floor level and formation of a new single storey infill extension between the main public house building and the detached outbuilding and redecoration of the exterior of the building with new paint colours intended to reinstate the main white building colour to the premises. The Swan Hotel, Shooters Hill, Pangbourne RG8 7 DU	NO OBJECTION
19/02720/ FUL	Proposed internal alterations to the existing premises at ground floor level and formation of a new single storey infill extension between the main public house building and the detached outbuilding and redecoration of the exterior of the building with new paint colours intended to reinstate the main white building colour to the premises. The Swan Hotel, Shooters Hill, Pangbourne RG8 7 DU	NO OBJECTION

APP NO:	PROPOSAL	RECOMMENDATION
<i>For Information only</i>		
19/02532/ CERTP	Proposed conversion of loft space to include new dormer extension. 34 Bourne Road, Pangbourne RG8 7JS	
<b>APPLICATIONS DETERMINED BY WBC:</b>		<b>WBC DECISION</b>
19/02196/ COMIND	Section 73 Variation of condition 2 approved plans of approved 16/01419/COMIND Bere Court Farm Bungalow, Bere Crt, Pangbourne RG8 8HT	REFUSAL
19/02532/ CERTP	Proposed conversion of loft space to include new dormer extension 34 Bourne Road, Pangbourne RG8 7JS	WITHDRAWN
19/02359/ CERTP	Single storey rear extension to dwelling. Insertion of roof windows to existing rear lower roof 53 Horseshoe Road, Pangbourne RG8 7JH	APPROVAL
19/02377/ CERTP	Approval of details reserved by condition 4 (archaeological written scheme of investigation) of approved application 19/01028/LBC2 (The proposed works are to prevent further deterioration of the interior fabric of Bere Court through the replacement of the existing slate and tile finishes, defective external parapet gutter and inner roof, and consequential alterations.) Bere Court, Bere Court, Pangbourne RG8 8HT	APPROVAL
19/02323/ HOUSE	Erection of two storey and single storey front extensions (west). Erection of single storey rear extension (east) and erection of single storey side extension (south). 8 St James Close, Pangbourne RG8 7AP	APPROVAL
19/02263/ ADV	Two Fascia Signs Strutt and Parker 1 High Street, Pangbourne RG8 7AE	APPROVAL
19/02263/ ADV	Construction of a new dwelling with associated parking and landscaping Land Adjoining 32 The Moors, Pangbourne RG8 7LP	REFUSAL
19/002372/ HOUSE	Single storey rear extension Blue Doors, Pangbourne Hill, Pangbourne RG8 7AS	APPROVAL
19/02159/ HOUSE	New porch to front and single storey extension to the rear and side 23 St James Close, Pangbourne RG8 7AP	APPROVAL
19/02076/ HOUSE	Creation of Home and General use area over existing garage with Ground floor linkage to main dwelling 1 Croft Drive, Pangbourne RG8 8AN	APPROVAL
19/01623/ HOUSE	Alterations to existing garage including enclosing external staircase, additional doors and windows, pergola and decking (part retrospective) Bere Court Farm Bungalow, Bere Crt Pangbourne RG8 8HT	APPROVAL
19/01344/ FULD	Section 73A: Variation of conditions (2) approved plans and (4) Parking of approved application 18/00856/FULD: New dwelling and garden land./Condition floor linkage to main dwelling 2 Woodview Road, Pangbourne RG8 7JN	APPROVAL
19/02296/ HOUSE	Alterations include new windows and balcony conversion, pitched roofs to existing dormer windows, replacement cladding and windows throughout. Single storey side extension. Coppinger, Riverview Road, Pangbourne RG8 7AU	APPROVAL



**EXTENSIONS / ALTERATIONS / MAINTENANCE /  
BRICKWORK / CARPENTRY**

Painting & Decorating • Plumbing  
General Building and Structural Work  
Slating and Tiling • All types of Roofing

**07831 500 004**  
**kelvinwoolford@aol.com**

YOUR LOCAL BUILDER IN PANGBOURNE  
*Covering all areas • All work guaranteed • Local references available*

**Aylett Electrical**



Kevin Aylett – your local,  
reliable, registered and  
insured electrician.

- Domestic installations
- Testing and repair
- Free quotes and advice
- All maintenance and repairs undertaken

Blossomsend Cottage Blossom Lane Theale RG7 5BE  
Tel: 0118 9302037 Mob: 07986 033 051

**CIG.**

Chiltern Insurance Group  
Pangbourne

Business and Personal Insurance  
from your Local Broker

**Call 0118 984 3355**

[www.chilterninsurance.co.uk](http://www.chilterninsurance.co.uk)

St James House, Church Road,  
Pangbourne, RG8 7AR

Chiltern Insurance Consultants Ltd are authorised and  
regulated by the Financial Conduct Authority  
for General Insurance Business.

**ADVERTISE IN THE  
PANGBOURNE MAGAZINE**



Pangbourne Magazine is  
issued every other month  
and has a distribution  
of 1,600 copies locally.

Contact Herald Graphics  
on 0118 9311488 or  
[pangbourne@heraldgraphics.co.uk](mailto:pangbourne@heraldgraphics.co.uk)

A . B .

# WALKER

THE FUNERAL PEOPLE

A FAMILY BUSINESS SINCE 1826  
 THATCHAM – 01635 873672  
 TILEHURST – 0118 304 0068  
 READING – 0118 957 3650

ALSO AT BRACKNELL, CAVERSHAM,  
 HENLEY, MAIDENHEAD, WOKINGHAM.

TRADITIONAL AND CONTEMPORARY  
 FUNERAL SERVICE AND DIRECT CREMATION  
 FLORAL DESIGN AND MONUMENTAL MASONRY  
 PRE-PAID FUNERALS, LATER LIFE LEGAL SERVICES  
 BEREAVEMENT CARE



WWW.ABWALKER.CO.UK



**Golden Charter**  
 Funeral Plans



- Commercial clearances • Domestic clearances
- Man and van services • Garden clearance
- Sheds demolished • Attic clearance
- Fully licensed waste carrier
- Honest and reliable

Serving domestic and business customers  
 across Berkshire and the surrounding villages –  
 from single items to full house clearance.

**Get in touch for a FREE QUOTE**

0118 9019935 or 07889 851 600

[lindsaysclearance@outlook.com](mailto:lindsaysclearance@outlook.com)

@lindsaysclearance



## Sapphire Furnishings

Woodcote Based



Hand Made Curtains • Soft Furnishings  
 Blinds • Fabrics Supplied

**07710 621932 • 01488 686936**

[barbara@sapphirefurnishings.co.uk](mailto:barbara@sapphirefurnishings.co.uk)

[www.sapphirefurnishings.co.uk](http://www.sapphirefurnishings.co.uk)

Studio/Workroom:

10 Leverton Farm Buildings RG17 0TA

## Monumental & Masonry Craftsmen

Family run business since 1858

**A.F. JONES**  
 33 Bedford Road  
 Reading  
 RG1 7EX

Tel: 0118 9573537

email

[info@afjones.co.uk](mailto:info@afjones.co.uk)

**E.T. SHEPPARD**  
 36 Reading Road  
 Henley on Thames  
 RG9 1AG

Tel: 01491 574644

email

[info@etsheppard.co.uk](mailto:info@etsheppard.co.uk)

**Specialists in all stonework  
 Memorials, Restoration, Kitchens, Bathrooms**

**St Andrew's**  
 FULBROOK

An outstanding co-educational day and boarding  
 school set in 54 acres of Berkshire woodland for pupils  
 aged 3-13

To arrange a visit, please contact:  
[registrar@standrewspangbourne.co.uk](mailto:registrar@standrewspangbourne.co.uk)  
 0118 974 4276 [www.standrewspangbourne.co.uk](http://www.standrewspangbourne.co.uk)

**HIGHLY RECOMMENDED**

## DRAIN & ABLE

Independent Drainage Service  
**24/7 EMERGENCY SERVICE**  
**GUARANTEED ARRIVAL**  
**ALL TELEPHONE CALLS ANSWERED PERSONALLY**

Call anytime on 0118 957 6244/  
 07795 598207  
[www.drainandable.co.uk](http://www.drainandable.co.uk)

## FAMILY TREE

GROUNDS MAINTENANCE AND CONSTRUCTION  
**Garden Maintenance**

- Fencing • Gates • Hedge cutting
- Decking • Patios • Grass cutting

**TEL. 07736 650 477**  
 email: familytreegmc@gmail.com

**OVENCLEAN**  
 The original oven cleaning specialists

**We can make your oven look sparkling clean!**

**Before**      **After**

**"I'm simply delighted at how sparkly clean my oven and hob look now! It really does look like the cooker is brand new again!"**

Martin Belcher

- Ovens
- Grills
- Extractors
- Filters
- BBQs
- Microwaves
- Hobs
- Ranges
- AGAs

Call Trevor and Dominic Cox today on  
 07397 394232 or 0800 840 7127  
[www.ovenclean.com](http://www.ovenclean.com)

## PAUL BELCHER

**PROPERTY SERVICES OF PANGBOURNE**

01189843722 M 07888680834  
[paulbelcherpropertyservices@yahoo.co.uk](mailto:paulbelcherpropertyservices@yahoo.co.uk)

**ALL INTERIOR & EXTERIOR WORK UNDERTAKEN AND COMPLETED TO A HIGH STANDARD**

**CALL OR EMAIL FOR FREE INDEPENDENT ADVICE AND A NO OBLIGATION QUOTE**

**ALL WORK FULLY INSURED - NO JOB TOO SMALL**

01635 202282 07831 277668  
[trevor@howardthesweep.co.uk](mailto:trevor@howardthesweep.co.uk)

- Guild of Master Sweepers & HETAS accredited
- Traditional & power sweeping methods
- Rust flues & wood chimneys installed
- Gullies/roofs/rajas repaired/checked
- Bird nests removed
- Sealing & repairs
- Camera inspections
- Insurance certificates
- Fully insured

**Howard the Sweep**  
 Cleaner chimney sweeping & stove installations

## MADE TO MEASURE

*Curtains, Roman Blinds, Cushions Covers, etc at competitive prices.*

Call Caroline on  
 (0118) 9542448  
 or 07815 610 007

## LOCKSMITH

Locks changed, fitted, repaired & opened.  
 Yale locks, five lever mortice locks, digital locks,  
 UPVC door locks & handles, UPVC window locks.

**Emergency callout service**

Over thirty years of experience. Free quotations

Tel: **01491 682050** or **07710 409216**  
[www.acgservices.co.uk](http://www.acgservices.co.uk)

Office: 3 Wayside Green, Woodcote, Oxon RG8 0PR. Proprietor Richard Homden

## PICTURE FRAMING PICTURE RESTORATION

**R. G. Bridgewater**  
*(established in the trade since 1956,  
 apprenticed at Reading Fine Art Gallery,  
 also with Picture Crafts of London Street, Reading)*

- Oils and pastels restored
- Watercolours, engravings, prints de-foxed and cleaned
- Conservation mounting and framing
- All aspects of framing undertaken (tapestries, silks, butterflies, medals, etc)

**Tel: 0118 984 4622**

## AERIAL SERVICES

### Adept Digital Systems

Digital Aerials, Satellite Systems, Home Cinema and Flatscreen mounting, Sky agents, all work guaranteed. No call-out.

www.adeptaerials.com  
0118 941 9615

## ELECTRICIANS

### Aylett Electrical

Kevin Aylett – your local, reliable, fully qualified and insured, domestic electrician.

0118 9302037  
Mob: 07986 033 051

## FUNERAL SERVICES

### A B Walker

See main advert on page 59.

Thatcham – 01635 873672  
Tilehurst – 0118 304 0068  
Reading – 0118 957 3650

## GARDEN SERVICES

### MOLES? Are they ruining your lawn?

Call MoleMan Mark to get rid of them.  
*British Mole Catchers Register* accredited.

07887 480014

## HAIRDRESSERS

### FinnHair

9 High Street, Pangbourne RG8 7AE. 0118 984 2719

## JEWELLERY REPAIRS

### Sandy Ebdon-Jackson B.A.

Re-stringing, re-designing, replacing lost parts etc.  
Jewellery surgery at village hall every Friday 9.30am – 11.30am, and also every first Saturday of month 10.00am – 3.00pm

07789 238557

## LAUNDRY/DRY CLEANERS

### Launderclean

4 Station Road, Pangbourne.  
Launderette and dry cleaners.

0118 984 2197

## PAINTER

### Andy The Painter

Interior and Exterior Painting.  
Fully Qualified and Insured.

07933 266874  
andyblack007@outlook.com  
www.andy2know.com

## PET CARE

### Purley Pet Care

Pet boarding, walking and feeding for happy paws and waggy tails. Fully licenced and insured. Boarding or day care. Big animals or small. References available on request. Call Joan.

07867 676675  
joanjack@sky.com

## PLAYGROUPS

### Pangbourne Valley Playgroup

Kennedy Drive (school grounds) 2 to 5 year olds

Open: Mon-Fri 9am-11.30am and

Mon-Thurs 12.45pm-3.15pm

Lunch Club: Mon-Thurs 11.30am-12.45pm

0118 984 1661

## PLUMBER & BATHROOM FITTER

Happy to undertake the smallest of jobs.  
Call Richard.

0771 333 6661  
0118 967 6384

## WASTE CLEARANCE

### The Rubbish Van

The low cost way to clear your bulky household / garden waste. Phone Mark after 7pm.

01235 511846

## SUBMISSION OF ARTICLES\* AND ADVERTS†

	COPY DEADLINE	DISTRIBUTED
Issue 155 – March/April	7th February	27th February
Issue 156 – May/June	3rd April	30th April
Issue 157 – July/August	5th June	25th June

Please send all submissions to [pangbourne@heraldgraphics.co.uk](mailto:pangbourne@heraldgraphics.co.uk).  
Please bear in mind the distribution date when including dates in your articles.

(\*receipt of an article is not a guarantee of inclusion; †payment is required in full prior to publication)

# USEFUL NUMBERS

---

## USEFUL NUMBERS

POLICE	Non-emergency number	101
CRIMESTOPPERS		0800 555 111
PANGBOURNE PARISH COUNCIL (at Village Hall)		
	www.pangbourne-pc.gov.uk	0118 984 1118
	Parish Office opening hours – Mon am, Tues am, Thurs pm	
CHAIRMAN OF PANGBOURNE PARISH COUNCIL		
	Peter Maclver – peterpangbourne@gmail.com	07768 004844
VICE CHAIRMAN OF PANGBOURNE PARISH COUNCIL		
	John Higgs – jhiggs@pangbourne-pc.gov.uk	0118 984 4758
CLERK TO PANGBOURNE PARISH COUNCIL		
	Becky Elkin – clerk@pangbourne-pc.gov.uk	0118 984 1118
WEST BERKSHIRE COUNCIL		
	Switchboard	01635 551111
CITIZENS ADVICE BUREAU		01635 516 605
MP FOR READING WEST		
	Alok Sharma	0118 941 3803
SURGERY		0118 984 2234
	Emergency out-of-hours (7.00pm – 7.00am)	0118 976 7193
PHARMACY		0118 984 2935
LIBRARY		0118 984 4117
VOLUNTEER CENTRE		0118 984 4586
PANGBOURNE PARISH PRIEST		
	Reverend Heather Parbury – rector@pangbournechurches.info	0118 984 2928
FLOOD WARDENS		
	Kay Lacey	0118 984 2221 or 07889 231136
	Stephen Billyeald	0118 984 3368

## CANTOR'S CROSSWORD NO. 9 ANSWERS

### Across

1 PASSING THE BUCK, 8 THEATRE, 9 MICHAEL, 10 ROKEBY VENUS, 12 GOLDEN, 13 ACHILLES, 15 OVERSEES, 17 SENIOR, 20 WATERCOURSE, 21 RHIZOME, 22 MISDEAL, 23 THREEPENNY BITS

### Down

1 PUT IN A GOOD WORD, 2 SPECIAL, 3 INTERCESSOR, 4 GREEKS, 5 HUMPBACK, 6 CHANNEL, 7 CLASS STRUGGLES, 11 VOICELESSLY, 14 SET ONE UP, 16 EAT FISH, 18 ISRAELI, 19 TRUMAN

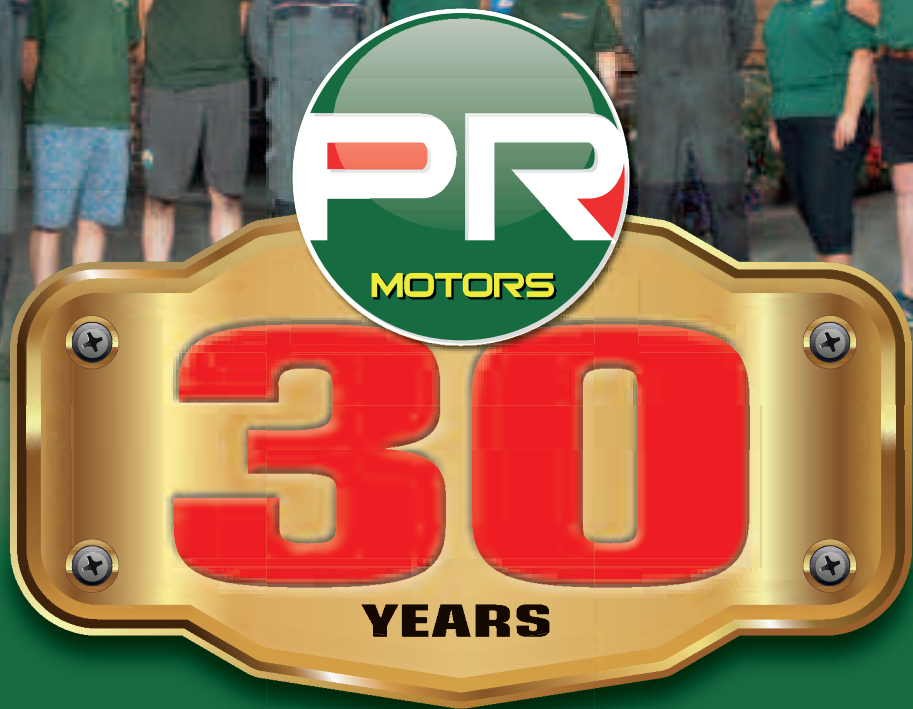

**PR**oudly celebrating 30 years of committed, quality service in the local community

**Our garage really cares**

**We provide all garage services for your car**

All car MOTs now only

**£35**

Includes FREE retest

**FREE** Local collection & delivery service

Opening times:  
Mon-Fri: 7:30am - 5:30pm



A very British company

Email: [enquiries@prmotors.biz](mailto:enquiries@prmotors.biz) Web: [prmotors.biz](http://prmotors.biz)

**Tel: 0118 984 4889**



# MAS KÜCHEN

**Affordable bespoke German kitchens**

**“Great Company!!**

I usually don't leave reviews but on this occasion I felt I had to. Marco has been great to deal with from start to finish, he delivered exactly what he promised and we're really happy with the finished product.

Would highly recommend!” - Trustpilot.com



---

**Visit our Reading showroom**

---

Unit 10, Oxford Road Industrial Estate, Gresham Way, Reading, Berkshire, RG30 6AW

**0118 214 8498**

[www.maskuchen.co.uk](http://www.maskuchen.co.uk)

