

# City of Newton

108 N. Van Buren Street, Room A

Newton, Illinois 62448

[www.Cityofnewtonil.com](http://www.Cityofnewtonil.com)

Phone (618) 783-8451

Incorporated City 1887

A city for Progress

## Information Required for Permit

All Building, electrical, water and sewer permits are recorded by the City of Newton.

### The Following Information is required on ALL Permits:

1. Complete Name, Address and telephone number of property Owner.
2. Complete address of property.
3. Legal Description- Including Lot, Block, Subdivision or Meets & Bounds description.
4. Property Tax I.D. Number, Located on owner's deed, tax bill, abstract, or contact Jasper County Assessor's Office.
5. Complete names, addresses & Telephone numbers of ALL Contractors and Sub-Contractors.

- NO WORK WITHOUT PERMIT!
- Note: PERMITS will not be issued with incomplete information.
- Permit issued with paid permit fees only.
- Permit must be displayed in prominent location on job site.

### Types of Permits

A building permit is required for all new construction. Permits are also required for additions, rehabilitation, renovation, demolition or repairs that will alter the structure or the means of egress. This also includes Residential and Commercial accessory structures, such as garages, tools sheds and swimming pools. Permits are also required for one and two family dwellings, Multi-Family Residential, Commercial and Industrial Buildings and Signs. Permit application are available at Newton City Hall located at 108 N Van Buren.

### Required Inspections for Construction Projects

Inspections to confirm code compliance at the following times:

- Footing inspection after digging but prior to concrete pour
- Framing inspection, before drywall
- Rough-in plumbing inspection, before drywall and insulation (State Plumbing inspector will be contacted by plumbing contractor)
- Rough-in HVAC inspection, before drywall and insulation
- Rough-in Electrical inspection, before drywall and insulation

- Tagging of gas meter installation by Gas Company.
- Final Carpentry inspection
- Final plumbing inspection ( By state plumbing inspector)
- Final HVAC inspection
- Sewer and Water service inspection, prior to backfill
- Site inspections
- Any other inspections deemed necessary by the code official
- Final occupancy inspection

Inspections require a 24hrs notice and are the duty of the person doing the work, please do not request inspections if the work to be inspected will not be completed. A re-inspection fee may be assessed if another visit is necessary due to incomplete work.

### **General Information**

The City of Newton has adopted National recognized codes and recognizes State Law for Energy code, Commercial Building Codes and Energy Codes to govern building construction. The codes are as follows:

- 2003 International Residential Code
- 2002 National Electric Code
- 2012 IECC RESCHECK for residential or COMCHECK for Commercial
- IBC 2006 Edition for Commercial
- NEC 2008 Edition for Commercial
- Flood Plain
- Subdivision and zoning ordinances

### **Fees for Permits**

Permits will not be issued until all required information on application is filled out and fees are paid. \$100.00 fine per day for commencement of work without permit

One and Two Family Dwellings-----	\$75.00
Commercial -----	\$100.00
Multifamily-----	\$100.00
Accessory Structure > 100sq feet-----	\$25.00
Accessory Structure < 100sq feet-----	\$0.00
Electric service upgrade-----	\$25.00
Mechanical service upgrade-----	\$25.00
Demolition-----	\$0.00

All required inspections are included for this fee. **The Code Official must be contacted prior to and after any work is conducted.**

**CITY OF NEWTON**  
**Application for Permit Under**  
**Building Regulations of the City**  
**108 N. Van Buren, Newton, IL 62448**  
**618-783-8451**

Applicant (Print) \_\_\_\_\_ Phone \_\_\_\_\_

Address of Applicant \_\_\_\_\_ E-mail address \_\_\_\_\_

Owner of Property \_\_\_\_\_  
(if different than applicant)

Address of Owner \_\_\_\_\_

Address of Property \_\_\_\_\_

Legal Description of Property \_\_\_\_\_

\_\_\_\_\_  
\_\_\_\_\_  
\_\_\_\_\_

Present Use of Property \_\_\_\_\_

Description of proposed construction, placement, alteration, removal or demolition \_\_\_\_\_

\_\_\_\_\_

Plans and Drawings with measurements and/or distances showing the proposed construction, placement, alteration, removal, demolition, utilities and drainage in relation to the property lines and city streets, alleys, utilities and rights of way are attached. The Applicant acknowledges full responsibility for ascertaining the existence and applicability of any restrictive covenants and other building limitations.

If boring under the street or cutting the street, a deposit and permit are required by the City. A copy of your insurance is also required.

Signature of Owner \_\_\_\_\_ Date \_\_\_\_\_ Signature of Applicant \_\_\_\_\_ Date \_\_\_\_\_

**DO NOT FILL IN BOTTOM PORTION – FOR CITY USE ONLY**

-----

	<u>Plan Provides</u>	<u>Ordinance Requires</u>
Lot Width _____		
Lot Depth _____		
Total Lot Area _____		
Building Height _____		
Impervious Surface Area _____		
Front Yard _____		
Side Yards _____		
Rear Yard _____		
Off Street Parking Spaces _____		

Permit: Issued \_\_\_\_\_ Denied \* \_\_\_\_\_

\_\_\_\_\_  
Building Official \_\_\_\_\_ Date \_\_\_\_\_

\*If denied, section that proposed activities do not comply with: \_\_\_\_\_

Committee Action Required _____	Date Filed _____
Other Action Required _____	Date Filed _____
Action by Committee _____	Date _____
Other Action _____	Date _____
Fees Required _____	

# City of Newton

(This must be completed before a permit will be issued)

Owners name: \_\_\_\_\_

Address: \_\_\_\_\_

Phone: \_\_\_\_\_

General Contractor: \_\_\_\_\_

Address: \_\_\_\_\_

Phone: \_\_\_\_\_

Concrete Contractor: \_\_\_\_\_

Address: \_\_\_\_\_

Phone: \_\_\_\_\_

Framing Contractor: \_\_\_\_\_

Address: \_\_\_\_\_

Phone: \_\_\_\_\_

Electrical Contractor: \_\_\_\_\_

Address: \_\_\_\_\_

Phone: \_\_\_\_\_

Plumbing Contractor: \_\_\_\_\_

Address: \_\_\_\_\_

Phone: \_\_\_\_\_

Insulation Contractor: \_\_\_\_\_

Address: \_\_\_\_\_

Phone: \_\_\_\_\_

Mechanical Contractor: \_\_\_\_\_

Address: \_\_\_\_\_

Phone: \_\_\_\_\_

Estimated cost of completed project including labor: \$ \_\_\_\_\_

# City of Newton

1. ROOF PITCH \_\_\_\_\_ IN 12
2. ROOF SHEATHING MATERIAL \_\_\_\_\_
3. ROOF TRUSSES YES  NO

**\*IMPORTANT-DESIGN AND LAYOUT MUST BE AVAILABLE ON THE SITE FOR INSPECTION**

4. ROOF RAFTERS 2" X \_\_\_\_\_ " X \_\_\_\_\_ LENGTH  
SPACING 16" O.C. \_\_\_\_\_ 24" O.C. \_\_\_\_\_
5. CEILING JOIST 2" X \_\_\_\_\_ " X \_\_\_\_\_ LENGTH
6. ATTIC INSULATION R-VALUE \_\_\_\_\_
7. VAPOR BARRIER YES  NO
8. WALL FRAMING - STUDS CEILING HEIGHT \_\_\_\_\_  
SIZE 2" X 4" \_\_\_\_\_ 2" X 6" \_\_\_\_\_  
SPACING 16" O.C. \_\_\_\_\_ 24" O.C. \_\_\_\_\_  
HEADER DETAIL SIZE \_\_\_\_\_ LENGTH \_\_\_\_\_

9. EXTERIOR SHEATHING MATERIAL \_\_\_\_\_  
WEATHER-RESISTANT BARRIER \_\_\_\_\_
10. WALL INSULATION R-VALUE \_\_\_\_\_
11. VAPOR BARRIER YES  NO
12. SUBFLOOR MATERIAL \_\_\_\_\_
13. BOX SILL MATERIAL/SIZE \_\_\_\_\_
14. BOX SILL INSULATION R-VALUE \_\_\_\_\_
15. MANUFACTURED FLOOR TRUSSES OR I-JOISTS  
YES  NO

**\*\*IMPORTANT-DESIGN AND LAYOUT MUST BE AVAILABLE ON THE SITE FOR INSPECTION.**

16. CONVENTIONAL FLOOR JOIST  
SIZE 2" X \_\_\_\_\_ " X \_\_\_\_\_ LENGTH  
SPACING 16" O.C. \_\_\_\_\_ 24" O.C. \_\_\_\_\_
17. SHOW THE SIZE & LENGTH OF BUILT-UP GIRDER OR BEAM (FOR FLOOR SYSTEM) ON DRAWINGS
18. SILL SEALER & TREATED SILL PLATE REQUIRED \_\_\_\_\_
19. FOUNDATION CONCRETE  OTHER   
REINFORCEMENT SIZE OF BARS \_\_\_\_\_ SPACING \_\_\_\_\_  
VERTICAL \_\_\_\_\_ HORIZONTAL \_\_\_\_\_  
WALL THICKNESS \_\_\_\_\_ " WALL HEIGHT \_\_\_\_\_ feet

20. FOUNDATION COATING \_\_\_\_\_
21. FOUNDATION INSULATION (R-10 CONTINUOUS OR R-13 CAVITY REQUIRED) R- \_\_\_\_\_
22. DEPTH OF FOOTINGS (32" MINIMUM) \_\_\_\_\_
23. FOOTING THICKNESS \_\_\_\_\_ "
24. FOOTING WIDTH \_\_\_\_\_ " REINFORCEMENT SIZE OF BAR \_\_\_\_\_ SPACING \_\_\_\_\_
25. GROUND COVER UNDER SLAB-ON-GRADE OR BASEMENT FLOOR (AGGREGATE, VAPOR BARRIER) \_\_\_\_\_
26. SUMP PUMP TO BE INSTALLED? YES  NO
27. DRAIN TILE LOCATION INSIDE \_\_\_\_\_ OUTSIDE \_\_\_\_\_
28. EXTERIOR WALL HEIGHT \_\_\_\_\_ feet
29. EXTERIOR FINISH BRICK  E.I.F.S.  VINYL  OTHER(specify) \_\_\_\_\_
30. BEDROOM WINDOW CLEAR OPENING DIMENSIONS (Window in fully opened position - list all) R310

31. INTERCONNECTED SMOKE DETECTORS ARE REQUIRED IN EACH BEDROOM, WITHIN 15 FEET OUTSIDE ALL BEDROOMS, AND ON ALL LEVELS. CARBON MONOXIDE DETECTORS ARE REQUIRED WITHIN 15 FEET OF ALL BEDROOMS. NUMBER OF SMOKE DETECTORS \_\_\_\_\_  
NUMBER OF CO DETECTORS \_\_\_\_\_

32. NUMBER OF EMERGENCY ESCAPE AND RESCUE OPENINGS IN BASEMENT \_\_\_\_\_ (\*\*All basements are required to have at least one EERO window. Every bedroom in a basement requires an EERO window)

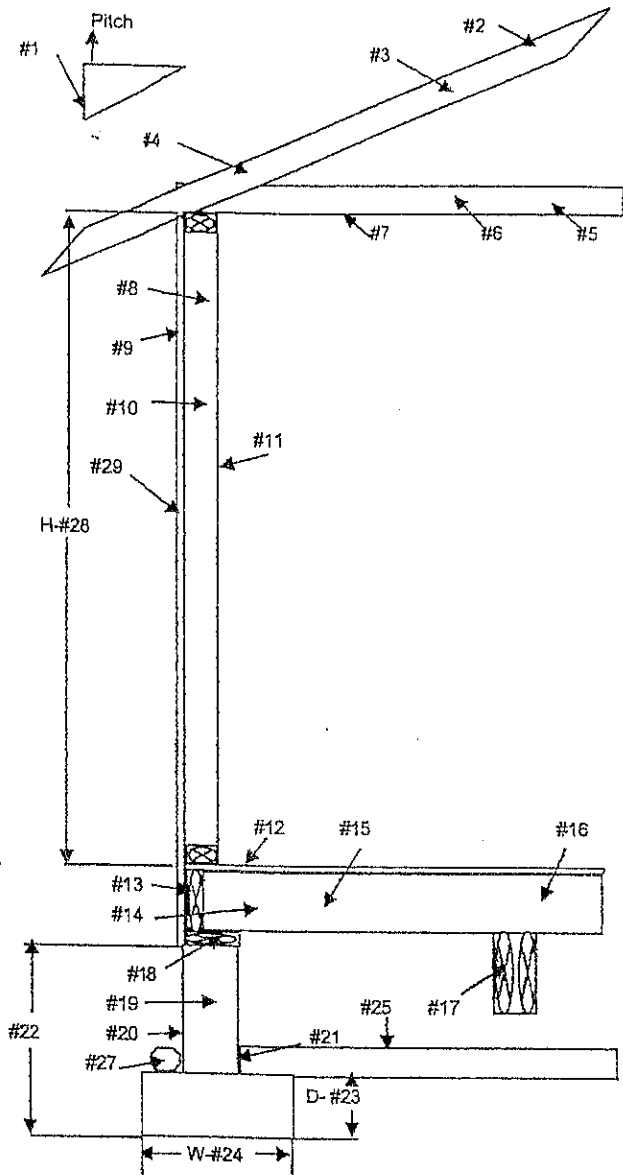

# City of Newton

## SITE PLAN

### INSTRUCTIONS:

1. Show and label all streets, side streets and alley.
2. Show distances between structures and property lines
3. Show plan detail of fence as follows: X-----X-----X-----X
4. Describe fence, show dimensions, where it starts, runs and stops.
5. Show location of accessory buildings and distances from house and the lot lines.
6. Show locations of all easements.

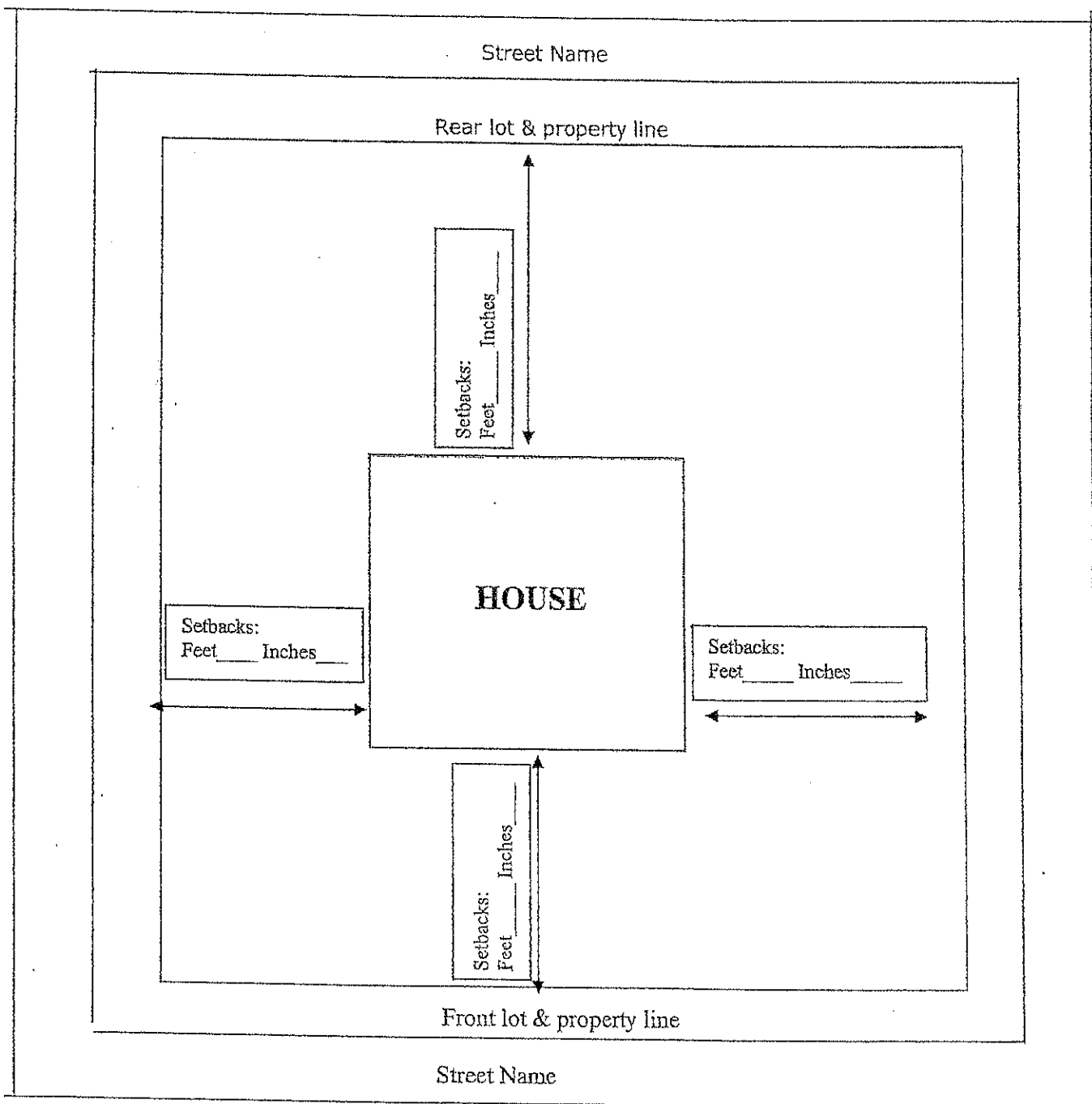

# City of Newton

## FLOOR FRAMING

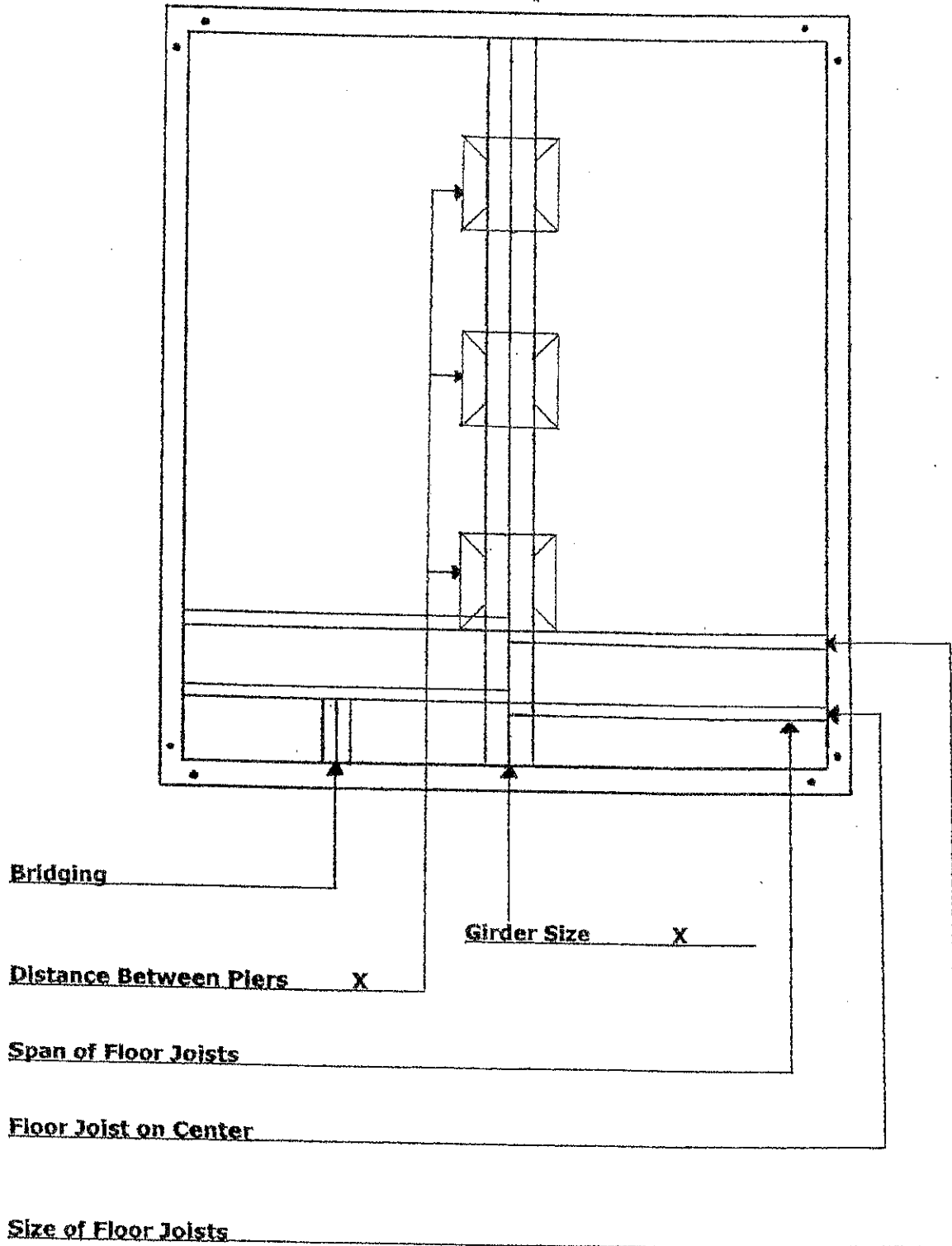

# City of Newton

## FOUNDATION DETAILS

Footing Width \_\_\_\_\_  
 Footing Depth \_\_\_\_\_  
 Rebar Size \_\_\_\_\_  
 Rebar Spacing \_\_\_\_\_  
 Anchor Bolt Size \_\_\_\_\_  
 Anchor Bolt Spacing \_\_\_\_\_  
 Foundation Block Size \_\_\_\_\_

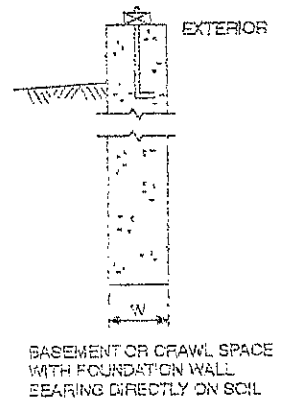
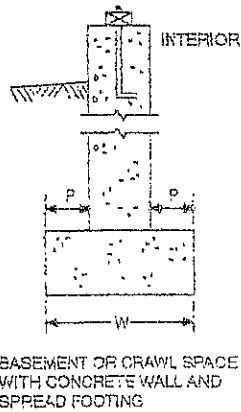
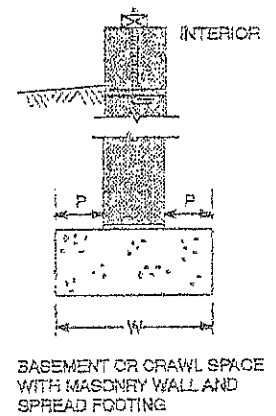
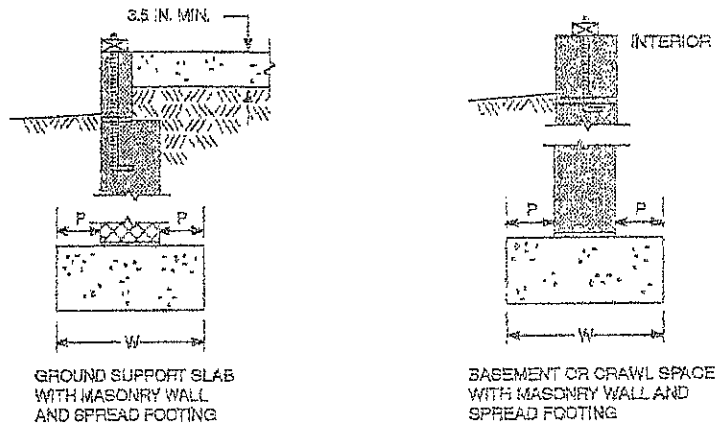
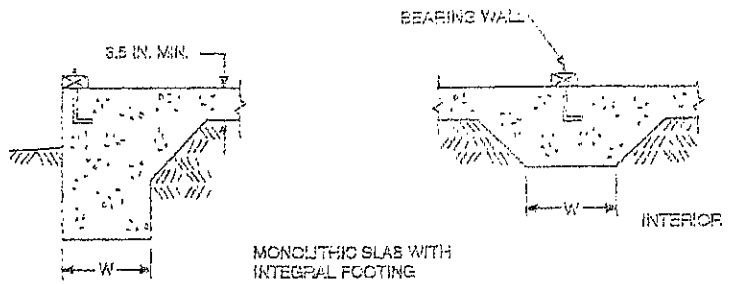

For SI: 1 inch = 25.4 mm, 1 foot = 304.8 mm