



SVI Strainers:

- **Y Type Strainer**
- **Basket Strainer**
- **Duplex Strainer**

Size: ½” ~ 24”

Pressure:

Class125~Class1500

End Connection Type:

Threaded/ BW/ Flanged



SVI Cast Iron Y Type Strainer with Threaded End

Product Line Technical Data

YOUR ONE-STOP VALVE SOURCING CHANNEL

Cast Iron Y Type Strainer With Threaded End

Pressure Class: 250
Size: 1/4" thru 3"

Design Feature

Design and Manufacturing Standards

Threaded End : ANSI B 1.20.1 (NPT)

- Economical and practical, suitable for pipelines with general pressure and temperature.
- Easily replaceable filter screen.
- Suitable mesh size to avoid choked flow.
- Strainer can be installed vertically and horizontally.



Application

Medium	Steam	Water/Oil/Gas
Pressure	250PSI	400PSI
Temperature	400°F	150°F

Materials specification

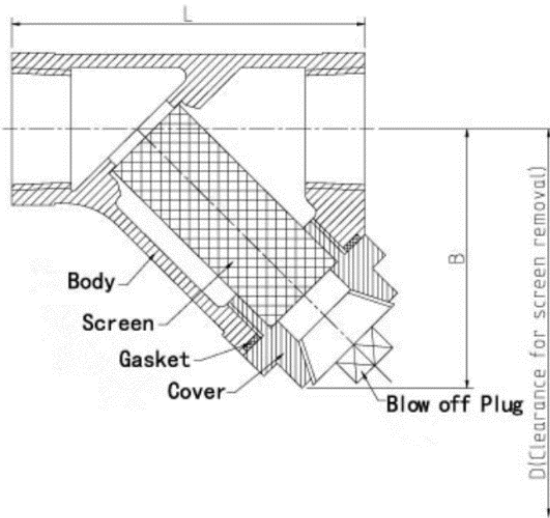

Description	Material
Body	Cast Iron ASTM A126 Class B
Cover	Cast Iron ASTM A126 Class B
Screen	SS304
Gasket	Non-asbestos
Plug	Carbon Steel

Dimension

Dimension(mm) Class 250				
Size	L	B	D	Blow Off Plug
1/4	81	50	100	NPT 1/4
3/8	81	50	100	NPT 1/4
1/2	81	50	100	NPT 1/4
3/4	95	68	137	NPT 3/8
1	102	76	152	NPT 3/8
1¼	127	87	175	NPT 3/4
1½	146	96	192	NPT 3/4
2	178	110	221	NPT 1
2½	235	155	310	NPT 1½
3	254	188	376	NPT 1½

Standard Screen		
Size	Hole Size	Hole Qty
1/4"-2"	1/32" openings	20 Mesh
1½"-3"	0.045" Dia. Hole	225 Holes per in ²

Note: SVI reserves the right to modify dimensions, material or design. Consult sales for update when order.

SVI Cast CS/SS Y Type Strainer with Threaded/SW End

Product Line Technical Data

YOUR ONE-STOP VALVE SOURCING CHANNEL

Cast Carbon Steel/Stainless Steel Y Type Strainer With Threaded/SW End
Pressure Class: 150 thru 2500
Size: 1/2" thru 3"

Design Feature

Design and Manufacturing Standards

Threaded End: ANSI B 1.20.1 (NPT)

- Economical and practical, effective to protect pipeline facilities.
- Easily replaceable filter screen.
- Big mesh size to avoid pressure loss.
- Strainer can be installed vertically and horizontally.

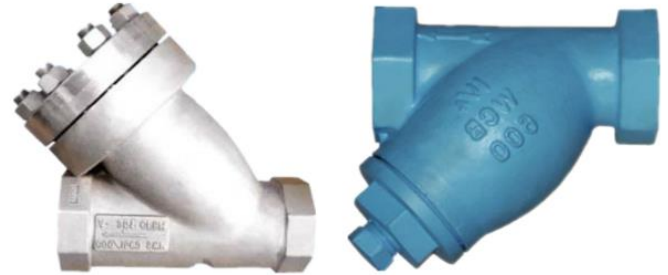

Application

Pressure-Temperature Rating			
Class	Material	Medium	
		Steam	Water/Oil/Gas
150	CS	150PSI @ 565°F	285PSI @ 100 °F
	SS	150PSI @ 565°F	275PSI @ 100 °F
300	CS	300PSI @ 838 °F	740PSI @ 100 °F
	SS	300PSI @ 1125 °F	720PSI @ 100 °F
600	CS	600PSI @ 838 °F	1480PSI @ 100 °F
	SS	600PSI @ 1125 °F	1440PSI @ 100 °F
1500	CS	1500PSI @ 838 °F	3705PSI @ 100 °F
	SS	1500PSI @ 1125 °F	3600PSI @ 100 °F
2500	CS	2500PSI @ 838 °F	6170PSI @ 100 °F
	SS	2500PSI @ 1125 °F	6000PSI @ 100 °F

Materials specification

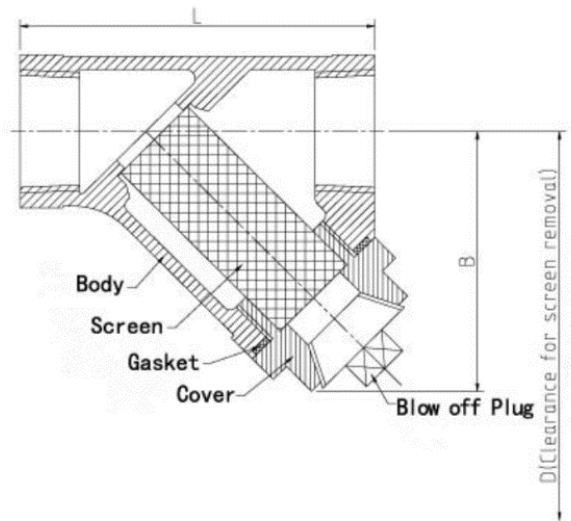

Dimension

Description	Material	
Body	WCB	SS316
Cover	WCB	SS316
Screen	SS304	SS316
Gasket	Graphite Plus SS304	Graphite Plus SS304
Plug *	Carbon Steel	SS316

Note: Plug * for Class 150/300/600 Bolted Cap on Class 1500 and over

Standard Screen		
Size	Hole Size	Hole Qty
1/4"-2"	1/32" openings	20 Mesh
1½"-3"	0.045" Dia. Hole	225 Holes per in ²

Note: SVI reserves the right to modify demensions, material or design. Consult sales for update when order.

Dimension(mm) for Class 150/300/600				
Size	L	B	D	Blow Off Plug
1/2	83	56	76	NPT1/4
3/4	94	70	83	NPT1/4
1	108	81	105	NPT1/2
1¼	133	98	127	NPT1/2
1½	156	121	149	NPT1/2
2	194	152	206	NPT3/4
2½	213	178	222	NPT 1¼
3	241	216	254	NPT 1¼

Dimension(mm) for Class 1500/2500			
Size	L	B	D
1/2	92	97	172
3/4	108	122	216
1	124	144	252
1½	162	186	331
2	218	240	432
2½	229	259	467
3	245	278	505

SVI Cast Iron Y Type Strainer with Flanged End

Product Line Technical Data

YOUR ONE-STOP VALVE SOURCING CHANNEL

Cast Iron Y Type Strainer with Flanged End

Pressure Class: 125/250

Size: 2" thru 20"

Design Feature

Design and Manufacturing Standards
Flanged End Standard: ANSI B16.15/ANSI B16.1

Application

Size	Steam	Water/Oil/Gas
2"-12"	125PSI @ 450°F	200PSI @ 150°F
14"-20"	100PSI @ 353°F	150PSI @ 150°F

Materials specification

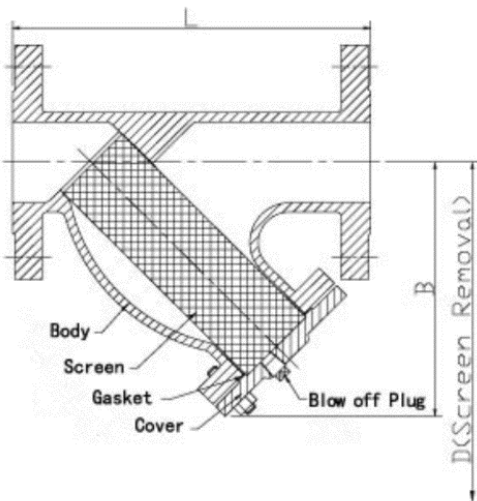

Description	Material
Body	Cast Iron ASTM A126 Class B
Cover	Cast Iron ASTM A126 Class B
Screen	SS304
Gasket	Non-asbestos
Plug	Carbon Steel

Standard Screen		
Size	Hole Size	Hole Qty
2"-4"	1/16" Dia.Hole	132 Holes per in ²
5"-20"	1/8" Dia.Hole	32 Holes per in ²

Dimension

Dimension(mm)							
Size	L		B		D		Blow Off Plug
	Class125	Class250	Class125	Class250	Class125	Class250	Class125/250
2	200	295	130	165	266	330	NPT1/2
2½	254	297	159	178	330	356	NPT3/4
3	257	321	173	203	356	406	NPT3/4
4	308	394	204	273	420	546	NPT1
5	397	489	298	343	572	686	NPT1
6	470	514	332	413	686	826	NPT1
8	549	559	386	495	788	990	NPT1
10	654	708	438	540	940	1080	NPT1
12	759	829	440	635	1104	1270	NPT1
14	949	956	737	749	1474	1498	NPT2
16	1080	981	838	851	1676	1702	NPT2
18	1172	1210	902	927	1804	1854	NPT2
20	1384		933		1866		NPT2

Note: SVI reserves the right to modify demensions, material or design. Consult sales for update when order.

Carbon Steel/Stainless Steel Y Type Strainer with Flanged End/BW End
Pressure Class: 150 thru 2500
Size: 1/2" thru 12"

Design Feature

Design and Manufacturing Standards
Flanged End Standard: ANSI B16.15/ANSI B16.1
Butt Welded End Standard: ANSI B16.25

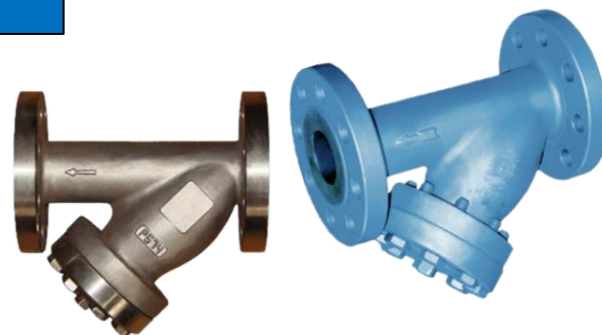

Application

Pressure-Temperature Rating			
Class	Material	Medium	
		Steam	Water/Oil/Gas
150	CS	150PSI @ 565 °F	285PSI @ 100 °F
	SS	150PSI @ 565 °F	275PSI @ 100 °F
300	CS	300PSI @ 838 °F	740PSI @ 100 °F
	SS	300PSI @ 1125 °F	720PSI @ 100 °F
600	CS	600PSI @ 838 °F	1480PSI @ 100 °F
	SS	600PSI @ 1125 °F	1440PSI @ 100 °F
900	CS	900PSI @ 838 °F	2220PSI @ 100 °F
	SS	900PSI @ 838 °F	2160PSI @ 100 °F
1500	CS	1500PSI @ 838 °F	3705PSI @ 100 °F
	SS	1500PSI @ 1125 °F	3600PSI @ 100 °F
2500	CS	2500PSI @ 838 °F	6170PSI @ 100 °F
	SS	2500PSI @ 1125 °F	6000PSI @ 100 °F



Materials specification

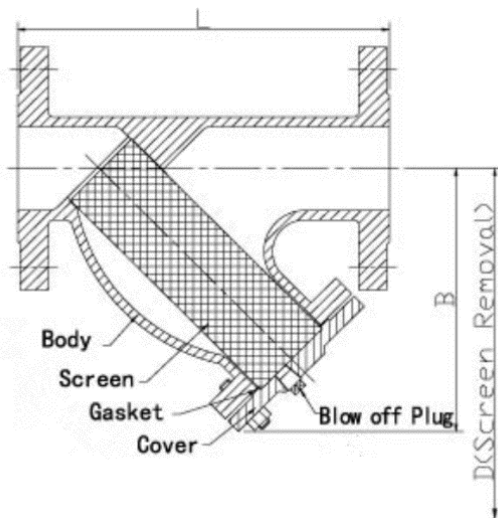

Description	Material	
Body	WCB	CF8M(SS316)
Cover	WCB	CF8M(SS316)
Screen	SS304	SS316
Gasket	Graphite Plus SS304	Graphite Plus SS304
Plug *	Carbon Steel	SS316

Note: Blow off Plug only for Class 150/300/600 , Fabricated body also available

Standard Screen		
Size	Hole Size	Hole Qty
2"-4"	1/16" Dia.Hole	132 Holes per in ²
5"-20"	1/8" Dia.Hole	32 Holes per in ²

SVI Threaded End Basket Strainer

Product Line Technical Data

YOUR ONE-STOP VALVE SOURCING CHANNEL

Threaded End Basket Strainer
Pressure Class: 125/150
Size: 3/8" thru 3"

Design Feature

Design and Manufacturing Standards
Threaded End Standard: ANSI B1.20.1

- Better design of screen with larger flow area than Y type's to reduce flow resistance.
- Low frequency to change screens.
- Better design of screen seat to avoid that media flows via the gaps of screen seat.
- Strainer should be installed horizontally.

Application

Material	Steam	Water/Oil/Gas
Cast Iron	125PSI @ 450°F	200PSI @ 150°F
Cast Steel	150PSI @ 565°F	285PSI @ 100°F
Stainless Steel	150PSI @ 565°F	275PSI @ 100°F



Materials specification

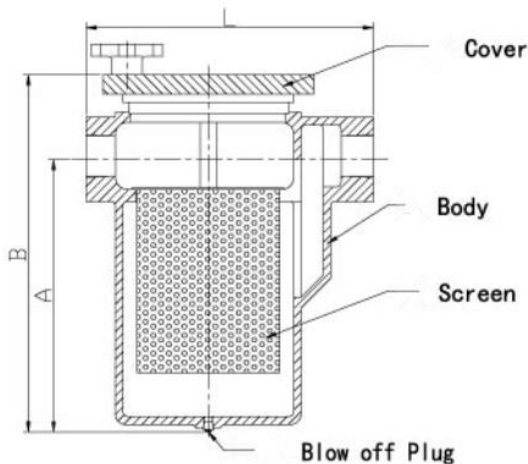

Description	Material		
	Cast Iron	Cast Steel	Stainless Steel
Body	ASTM A126 Class B	WCB	CF8M
Cover	ASTM A126 Class B	WCB	CF8M
Screen	SS304	SS304	SS316
Plug	Carbon Steel	Carbon Steel	SS304

Standard Screen		
Size	Hole Size	Hole Qty
3/8"-3"	1/32" Dia.Hole	225 Holes per in ²

Dimension

Dimension (mm)				
Size	L	A	B	Blow Off Plug
	Class125/150	Class125/150	Class125/150	Class125/150
3/8	162	133	183	NPT1/2
1/2	162	133	183	NPT1/2
3/4	175	132	192	NPT1/2
1	175	132	192	NPT1/2
1 1/4	213	187	251	NPT3/4
1 1/2	213	187	251	NP3/4
2	219	181	254	NPT1
2 1/2	324	220	307	NPT1 1/2
3	337	303	397	NPT1 1/2

SVI Cast Iron Flanged End Basket Strainer

Product Line Technical Data

YOUR ONE-STOP VALVE SOURCING CHANNEL

Cast Iron Flanged End Basket Strainer Pressure Class: 125 Size: 2" thru 30"

Design Feature

Design and Manufacturing Standards

Flanged End Standard: ANSI B16.1

- Better design of screen with lager flow are than Y type to reduce flow resistance.
- Low frequency to change screens.
- Better design of screen seat to avoid that media flows via the gaps of screen seat.
- Strainer should be installed horizontally.

Application

Size	Steam	Water/Oil/Gas
2"-12"	125PSI @ 450°F	200PSI @ 150°F
14"-24"	100PSI @ 353°F	150PSI @ 150°F

Materials specification

Description	Material
Body	Cast Iron ASTM A126 Class B
Cover	Cast Iron ASTM A126 Class B
Screen	SS304
Gasket	Non-asbestos
Plug	Carbon Steel
Bolt	Carbon Steel

Standard Screen

Size	Hole Size	Hole Qty
2"-4"	1/16" Dia.Hole	132 Holes per in ²
5"-30"	1/8" Dia.Hole	32 Holes per in ²

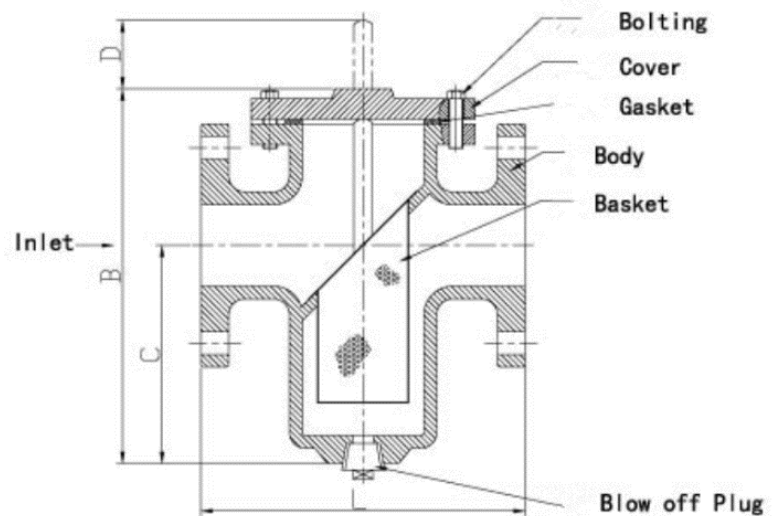

Dimension

Dimension(mm)

Size	L	B	C	D	Blow Off Plug
	Class125	Class125	Class125	Class125	Class125
2	206	213	127	137	NPT3/4
2½	210	252	137	160	NPT3/4
3	251	270	165	203	NPT3/4
4	292	376	203	237	NPT1
5	333	371	203	260	NPT1
6	378	387	219	283	NPT1
8	475	533	298	395	NPT1
10	511	624	349	457	NPT1
12	667	756	416	591	NPT1
14	768	924	559	667	NPT2
16	841	1008	591	714	NPT2
18	975	1156	711	679	NPT2
20	1054	1297	822	1453	NPT2
24	1054	1356	822	1555	NPT2
28	1200	1675	1085	1980	NPT2
30	1200	1746	1120	2040	NPT2

SVI Cast Steel Flanged End Basket Strainer

Product Line Technical Data

YOUR ONE-STOP VALVE SOURCING CHANNEL

CS/SS Flanged End Basket Strainer Pressure Class: 150 Size: 1" thru 24"

Design Feature

Design and Manufacturing Standards
Flanged End Standard: ANSI B16.1

- Better design of screen with lager flow are than Y type's to reduce flow resistance.
- Low frequency to change screens.
- Better design of screen seat to avoid that media flows via the gaps of screen seat.
- Strainer should be installed horizontally.



Application

	Steam	Water/Oil/Gas
CS	150PSI @ 565°F	285PSI @ 100°F
SS	150PSI @ 565°F	275PSI @ 100°F

Materials specification

Description	Material	
Body	WCB	CF8M
Cover	WCB	CF8M
Screen	SS304	SS316
Gasket	Graphite Plus SS304	Graphite Plus SS304
Plug	Carbon Steel	Carbon Steel
Bolt	Carbon Steel	Carbon Steel

Standard Screen		
Size	Hole Size	Hole Qty
2"-4"	1/16" Dia.Hole	132 Holes per in ²
5"-24"	1/8" Dia.Hole	32 Holes per in ²

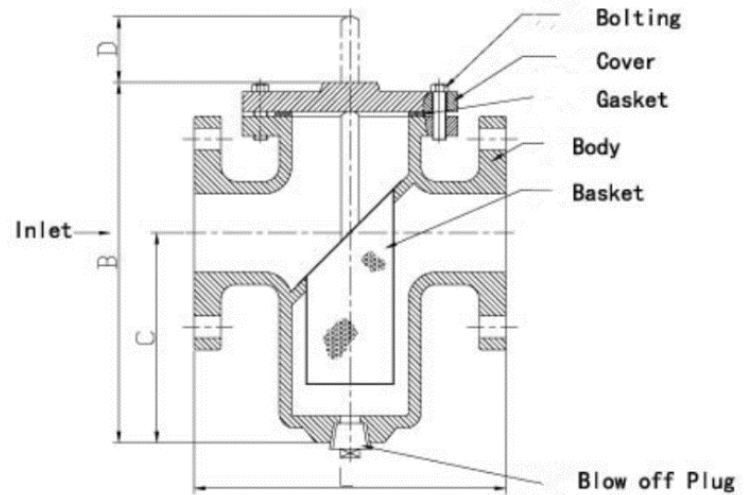

Dimension

Dimension(mm)					
Size	L	B	C	D	Blow Off Plug
	Class150	Class150	Class150	Class150	Class150
1	156	189	103	130	NPT1/2
1½	165	230	129	155	NPT1/2
2	206	229	137	160	NPT1
3	251	300	181	203	NPT1
4	292	346	213	237	NPT1
5	333	371	205	260	NPT1
6	378	397	229	283	NPT1
8	475	533	308	395	NPT1
10	511	622	359	457	NPT1
12	667	756	425	591	NPT1
14	1197	1359	873	667	NPT2
16	1197	1359	873	714	NPT2
20	1054	1287	813	867	NPT2
24	1054	1346	813	1100	NPT2

Note: SVI reserves the right to modify demensions, material or design. Consult sales for update when order.

SVI Cast Iron Threaded End Duplex Strainer

Product Line Technical Data

YOUR ONE-STOP VALVE SOURCING CHANNEL

Cast Iron Threaded End Duplex Strainer Pressure Class: 125 Size: 3/4" thru 4"

Design Feature

Design and Manufacturing Standards

Threaded End Standard: ANSI B1.20.1

- Better design of screen with lager flow to reduce flow resistance.
- Better design of screen seat to avoid that media flows via the gaps of screen seat.
- It will not stop the media flowing while cleaning or replacing screens.
- Strainer should be installed horizontally.



Application

Steam	Water/Oil/Gas
150PSI @ 353°F	200PSI @ 150°F

Materials specification

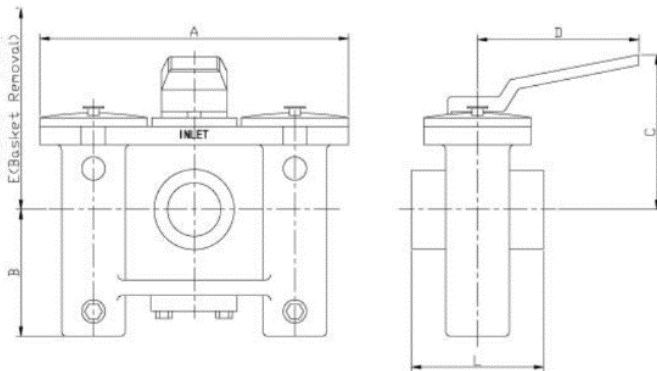

Description	Material
Body	Cast Iron ASTM A126 Class B
Cover	Cast Iron ASTM A126 Class B
Screen	SS304
O-ring	Viton
Plug	Carbon Steel
Bolt	Carbon Steel
Sleeve	Bronze
Disc	SS316
Shaft	SS316
Bushing	Bronze
Seat Ring	PTFE
Other Inner Parts	SS316

Standard Screen		
Size	Hole Size	Hole Qty
3/4"-4"	1/16" Dia.Hole	132 Holes per in ²

Dimension

Dimension(mm)						
Size	A	B	C	D	E	L
	Class125	Class125	Class125	Class125	Class125	Class125
3/4	285	105	185	214	230	128
1	285	105	185	214	230	128
1¼	325	119	216	214	250	138
1½	325	119	216	214	250	138
2	404	145	265	225	340	240
2½	404	145	265	225	340	240
3	484	164	269	255	380	260
4	518	220	306	283	510	308

Note: SVI reserves the right to modify dimensions, material or design. Consult sales for update when order.

SVI Cast Steel Threaded End Duplex Strainer

Product Line Technical Data

YOUR ONE-STOP VALVE SOURCING CHANNEL

CS/SS Threaded End Duplex Strainer Pressure Class: 150 thru 600 Size: 3/4" thru 4"

Design Feature

Design and Manufacturing Standards

Threaded End Standard: ANSI B1.20.1

- Better design of screen with lager flow to reduce flow resistance.
- Better design of screen seat to avoid that media flows via the gaps of screen seat.
- It will not stop the media flowing while cleaning or replacing screens.
- Strainer should be installed horizontally.

Application

	Steam	Water/Oil/Gas
CS	230PSI @ 300°F	285PSI @ 100°F
SS	215PSI @ 300°F	275PSI @ 100°F



Materials specification

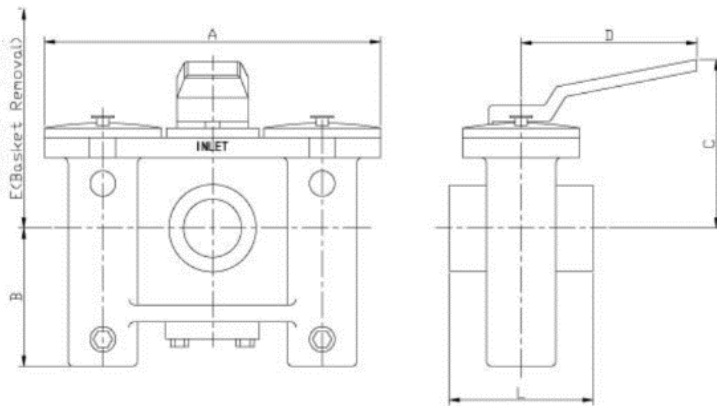

Description	Material	
Body	WCB	CF8M
Cover	WCB	CF8M
Screen	SS304	SS316
Gasket	Non-asbestos	Non-asbestos
Plug	Carbon Steel	SS316
Bolt	Carbon Steel	SS316
Sleeve	Bronze	
Disc	SS316	
Shaft	SS316	
Bushing	Bronze	
Seat Ring	PTFE	
Other Inner Parts	SS316	

Standard Screen		
Size	Hole Size	Hole Qty
3/4"-4"	1/16" Dia.Hole	132 Holes per in ²

Dimension

Dimension(mm) for Class 150/300/600						
Size	A	B	C	D	E	L
3/4	285	105	185	215	230	140
1	285	105	185	215	230	140
1¼	325	119	216	280	250	191
1½	325	119	216	280	250	191
2	404	145	265	280	340	254
2½	404	145	265	280	340	292
3	484	164	269	315	380	292
4	518	220	325	315	510	308

Note: SVI reserves the right to modify dimensions, material or design. Consult sales for update when order.

SVI CI/CS/SS Flanged End Duplex Strainer

Product Line Technical Data

YOUR ONE-STOP VALVE SOURCING CHANNEL

CI/CS/SS Flanged End Duplex Strainer Pressure Class: 125 thru 600 Size: 3/4" thru 6"

Design Feature

Design and Manufacturing Standards

Flanged End Standard: ANSI B16.1

- Better design of screen and body with lager flow to reduce flow resistance.
- Better design of screen seat to avoid that media flows via the gaps of screen seat.
- It will not stop the media flowing while cleaning or replacing screens.
- Strainer should be installed horizontally.

Application

Steam

150PSI @ 353°F

Water/Oil/Gas

200PSI @ 150°F

Materials specification

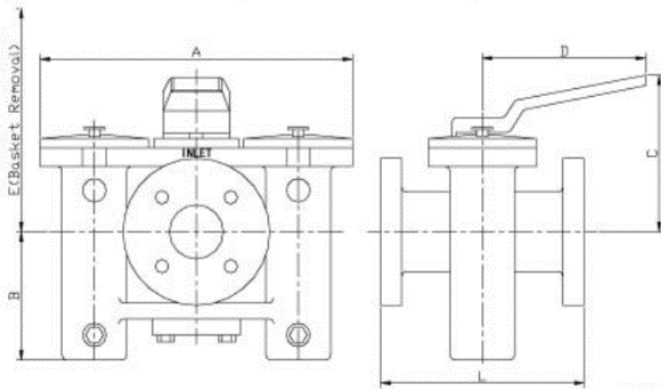

Description	Material		
Class	125	150/300/600	
Body	A126 Class B	WCB	CF8M
Cover	A126 Class B	WCB	CF8M
Screen	SS304	SS304	SS316
Gasket	/	Non-asbestos	
O-ring	Viton	/	
Plug	Carbon Steel	Carbon Steel	SS316
Bolt	Carbon Steel	Carbon Steel	SS316
Sleeve	Bronze	SS316	
Disc	SS316		
Shaft	SS316		
Bushing	Bronze		
Seat Ring	PTFE		
Other Inner Parts	SS316		

Standard Screen

Size	Hole Size	Hole Qty
3/4"-4"	1/16" Dia.Hole	132 Holes per in ²
5"-6"	1/8" Dia.Hole	32 Holes per in ²

Dimension

Dimension(mm) for Class 125/150/300/600

Size	A	B	C	D	E	L
3/4	285	105	185	215	230	175
1	285	105	185	215	230	175
1¼	325	119	216	280	250	238
1½	325	119	216	280	250	238
2	404	145	265	280	340	270
2½	404	145	265	280	340	343
3	484	164	269	315	380	343
4	518	220	325	315	510	406
5	850	306	396	360	740	559
6	850	306	396	360	740	559

Note: SVI reserves the right to modify demensions, material or design. Consult sales for update when order.

SVI Simple Basket/Conical/Plate Strainer
Pressure Class: 125 thru 600
Size: 1 1/2" thru 24"

Application

Available materials: Stainless Steel/Bronze

Standard Perforation		
Size	Water	Steam/Gas/Air
1/2"-2"	1/16"	1/32"
Above 2 1/2"	1/8"	Mesh Lined

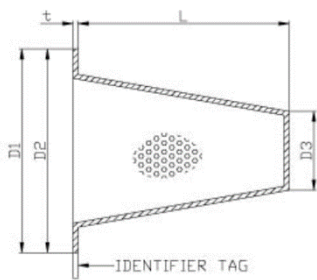

BASKET TYPE

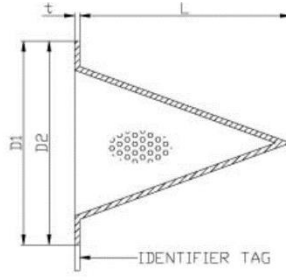

CONICAL TYPE

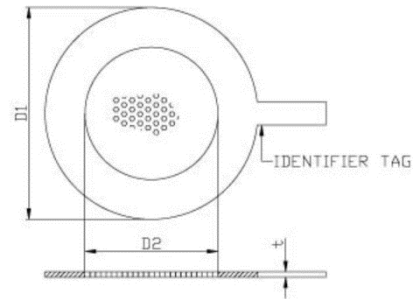
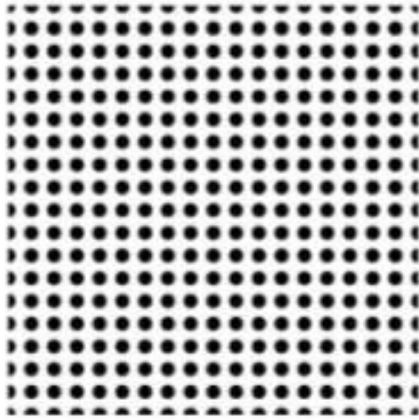

PLATE TYPE

Dimension(mm)																
Size	D1			D2			D3	t	Ratio of Open Area Compared to CSA of Pipe with Standard Thickness							
									Conical				Basket			
									100%	150%	200%	300%	100%	150%	200%	300%
Class	150	300	600	150	300	600	All	All	100%	150%	200%	300%	100%	150%	200%	300%
1 1/2	3 1/4	3 1/4	3 5/8	1 9/16	1 9/16	1 3/8	1	16GA	3	4	5 3/4	8 1/4	1 3/4	2 1/4	3	4 1/2
2	4	4	4 1/4	2	2	1 3/4	1 1/4		3 3/4	5	7 1/4	10 1/2	2	2 3/4	3 3/4	5 3/4
2 1/2	4 3/4	4 3/4	5	2 7/16	2 7/16	2 1/4	1 1/2		4 1/4	5 3/4	8	11 3/4	2 1/4	3 1/4	4 1/2	6 1/2
3	5 1/4	5 1/4	5 3/4	3	3	2 3/4	2		5	6 3/4	9 1/2	14	2 1/2	3 3/4	5	7 3/4
4	6 3/4	6 3/4	7 1/2	3 15/16	3 15/16	3 11/16	2 1/2		6	8 1/2	11 3/4	17 1/4	3 1/4	5	6 1/2	10
6	8 5/8	8 5/8	10 3/8	6	6	5 11/16	4		8 3/4	12 1/2	17 1/2	26	4 1/2	6 3/4	9 1/4	14 1/4
8	10 7/8	10 7/8	12 1/2	7 7/8	7 7/8	7 9/16	5 1/2	14GA	11	16	22	32 3/4	5 3/4	8 1/2	11 1/2	17 3/4
10	13 1/4	13 1/4	15 5/8	9 15/16	9 15/16	9 5/8	7		13 1/2	20	27	40 1/2	7	10 1/2	14 1/4	22
12	16	16	17 7/8	11 7/8	11 7/8	11 1/2	8 1/2		15 3/4	23 1/2	32	48	8	12 1/4	17	26
14	17 5/8	17 5/8	19 1/4	13	13		10		17 1/4	26	35	52 1/2	8 1/4	13	18	27 1/2
16	20 1/8	20 1/8	22 1/8	14 7/8	14 7/8		11 1/2		19 1/2	29	40	60	9 1/4	14 1/2	20 1/4	31
18	21 1/2	21 1/2	24	16 3/4	16 3/4		13		21 1/2	32 1/2	44	66 1/2	10 1/2	16 1/2	22 1/2	35
20	23 3/4	23 3/4	26 3/4	18 3/4	18 3/4		14 1/2		23 1/2	36	48 1/2	73 1/2	11 1/2	19	25 1/2	39
24	28 1/8	28 1/8	31	22 1/2	22 1/2		17		11GA	28 1/4	43	58 1/2	-	13 3/4	22	30 1/2

Note: SVI reserves the right to modify demensions, material or design. Consult sales for update when order.

SVI Optional Perforated Screen Types



0.033 DIA. (1/32") 0.85mm
324 Holes /in²
28 % Open Area

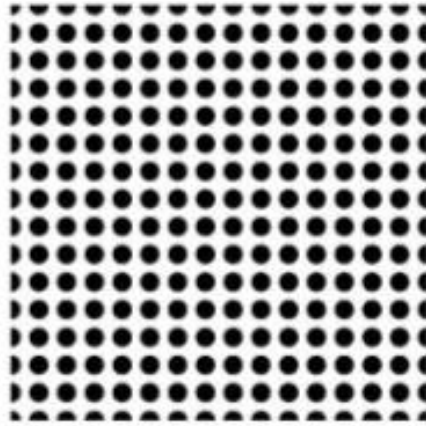

0.045 DIA. (3/64") 1.2mm
225 Holes /in²
36% Open Area

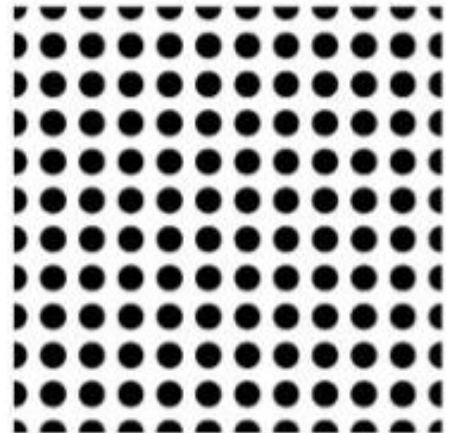

0.062 DIA. (1/16") 1.6mm
132 Holes /in²
37% Open Area

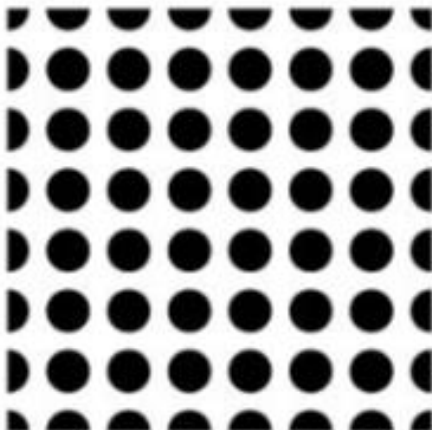

1/10" DIA. 2.5mm
49 Holes /in²
39 % Open Area

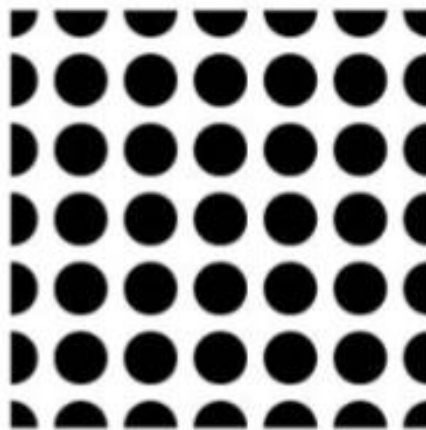

1/8" DIA. 3.2mm
32 Holes /in²
40 % Open Area

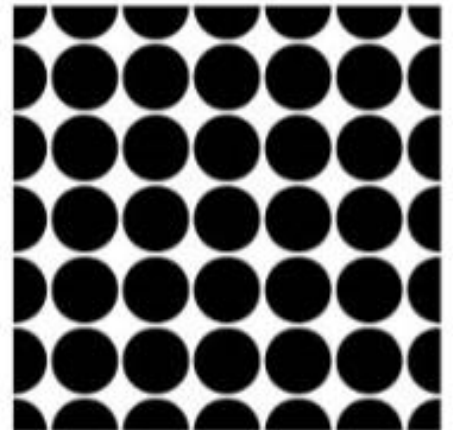

5/32" DIA. 4.0 mm
33 Holes /in²
62 % Open Area