



## 2-pc Flanged Floating Ball Valve

Size: 1/4" thru 2"

Class: 150 thru 1500

Design: API 608

Ends: Flanged

---



## 3-pc Floating Ball Valve

Size: 1/4" thru 2"

Class: 800 thru 1500

Design: API 608

Ends: SW NPT

---



## Small Forged Floating Ball Valve

---



**3-PC Floating Ball Valve**  
**Pressure Class: 800 ~ 1500**  
**Size: 1/2" thru 2"**

Design and Manufacturing Standards	
DESIGN:	API 608 ASME B16.34
TESTING:	API 598
PRESSURE CLASS:	NPT & SW – 800, 900, 1500
CONNECTIONS:	NPT – ASME B1.20.1 SW - ASME B16.11 FACE TO FACE– ASME B16.10

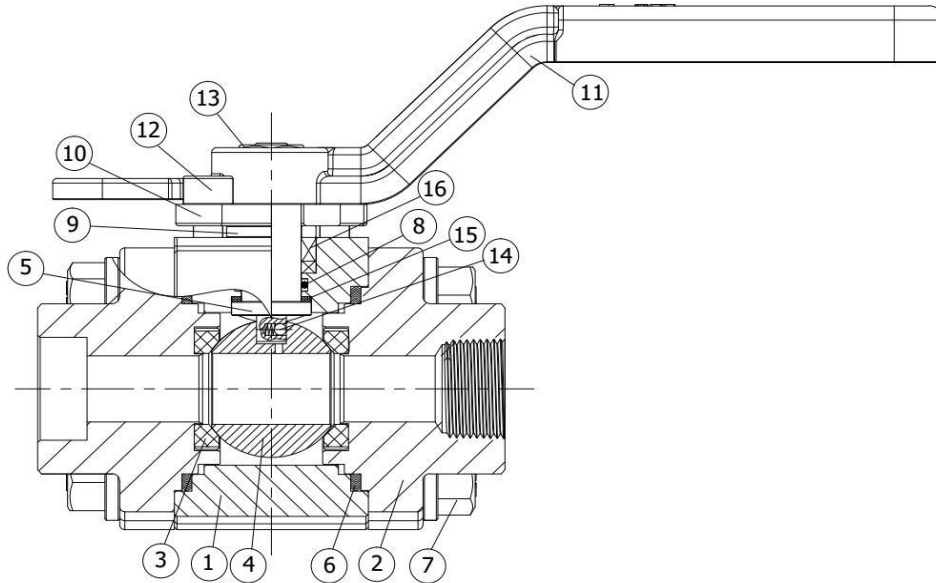

**CLASS 800 Material list accordance to Application type**

NO.	Description	Standard	Low Temp	High Temp	Stainless	Sour Service
1	BODY	ASTM A105N	ASTM A350 LF2	ASTM A182F11	ASTM A182 F316L	ASTM A182 F51
2	BONNET	ASTM A105N	ASTM A350 LF2	ASTM A182F11	ASTM A182 F316L	ASTM A182 F51
3	SEAT RING	R-PTFE	R-PTFE	R-PTFE	R-PTFE	R-PTFE
4	BALL	ASTM A182 316	ASTM A182 316	ASTM A182 316	ASTM A182 316	ASTM A182 F51
5	STEM	ASTM A276 316	ASTM A276 316	ASTM A276 316	ASTM A276 316L	ASTM A182 F51
6	GASKET	316+Graphite	316+Graphite	316+Graphite	316+Graphite	F51+Graphite
7	BOLTS	ASTM A193-B7/ <b>B7M</b>	ASTM A320 - L7/ <b>L7M</b>	ASTM A193 B16	ASTM A193 B8M	ASTM A193 B8M
8	O-RING	NBR	NBR	NBR	NBR	NBR
9	GLAND	ASTM A276 316	ASU1 A276 316	ASTM A276 316	ASTM A276 316	ASTM A182 F51
10	GLAND FLANGE	ASTM 304 SS	ASTM 304 SS	ASTM 304 SS	ASTM 304 SS	ASTM 304 SS
11	LEVER	ASTM A216 WCB	ASTM A216 WCB	ASTM A216 WCB	ASTM A216 WCB	ASTM A216 WCB
12	BOLT	304 SS	304 SS	304 SS	304 SS	304 SS
13	NUT	304 SS	304 SS	304 SS	304 SS	304 SS
14	ANTI-STATIC BALL	316 SS	316 SS	316 SS	316 SS	316 SS
15	THRUST WASHER	R-PTFE	R-PTFE	R-PTFE	R-PTFE	R-PTFE
16	PACKING	Graphite	Graphite	Graphite	Graphite	Graphite

\*Note: Material requested according to NACE-MR-0175 as marked in red. Other material upon request.

**3-PC Floating Ball Valve**  
**Pressure Class: 900 ~ 1500**  
**Size: 1/2" thru 2"**

Design and Manufacturing Standards	
DESIGN:	API 608 ASME B16.34
TESTING:	API 598
PRESSURE CLASS:	NPT & SW – 800, 900, 1500
CONNECTIONS:	NPT – ASME B1.20.1 SW - ASME B16.11 FACE TO FACE– ASME B16.10

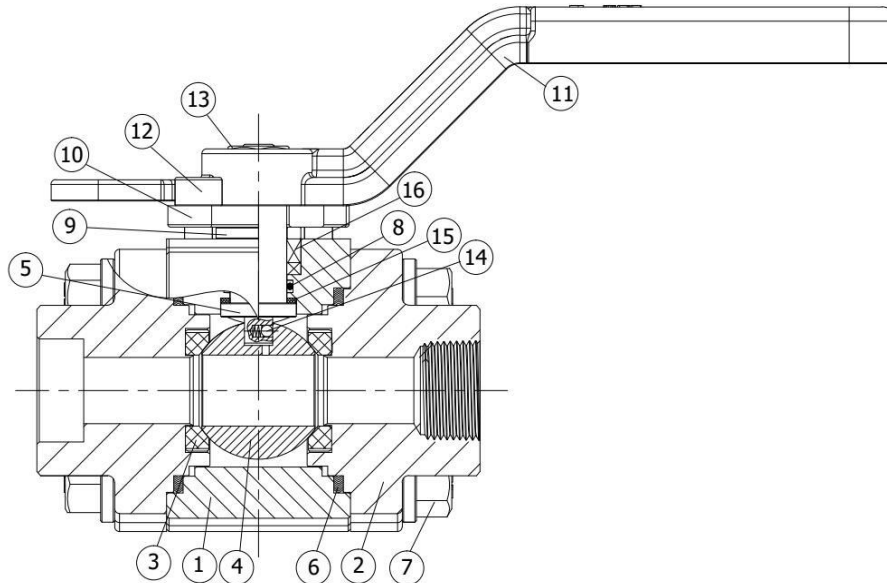

**CLASS 900/1500 Material list accordance to Application type**

NO.	Description	Standard	Low Temp	High Temp	Stainless	Sour Service
1	BODY	ASTM A105N	ASTM A350LF2	ASTM A182F11	ASTM A182 F316L	ASTM A182 F51
2	BONNET	ASTM A105N	ASTM A350 LF2	ASTM A182F11	ASTM A182 F316L	ASTM A182 FS1
3	SEAT RING	PEEK	PEEK	PEEK	PEEK	PEEK
4	BALL	ASTM A182 316	ASTM A182 316	ASTM A182 316	ASTM A182 316	ASTM A182 F51
5	STEM	ASTM A276 316	ASTM A276 316	ASTM A276 316	ASTM A276 316L	ASTM A182 F51
6	GASKET	316+Graphite	316+Graphite	316+Graphite	316+Graphite	F51+Graphite
7	BOLTS	ASTM A193-B7/ <b>B7M</b>	ASTM A320 - L7/ <b>L7M</b>	ASTM A193 B16	ASTM A193 B8M	ASTM A193 B8M
8	O-RING	NBR	NBR	NBR	NBR	NBR
9	GLAND	ASTM A276 316	ASTM A276 316	ASTM A276 316	ASTM A276 316	ASTM A182 F51
10	GLAND FLANGE	304SS	304SS	304SS	304SS	304SS
11	LEVER	A216WCB	A216WCB	A216WCB	A216WCB	A216WCB
12	BOLT	304SS	304SS	304SS	304SS	304SS
13	NUT	304SS	304SS	304SS	304SS	304SS
14	ANTI-STATIC	316SS	316SS	316SS	316SS	316SS
15	THRUST WASHER	R-PTFE	R-PTFE	R-PTFE	R-PTFE	R-PTFE
16	PACKING	Graphite	Graphite	Graphite	Graphite	Graphite

\*Note: Material requested according to NACE-MR-0175 as marked in red. Other material upon request.

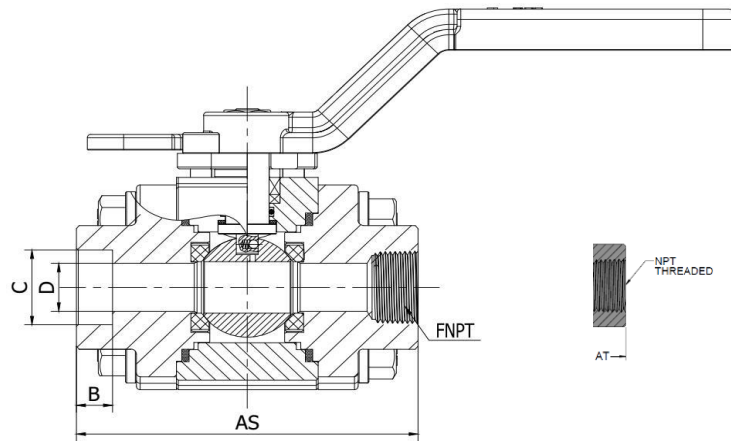

FULL PORT CLASS 800/900/1500 DIMENSIONS						WGT. (lb/Kg)
SIZE		AT / AS	B	C	D	CLASS 800/ 900/ 1500
1/2	Inch	3.54	0.39	0.86	0.50	4.19
	mm	90.0	10.0	21.8	12.7	1.9
3/4	Inch	3.94	0.51	1.07	0.75	5.29
	mm	100.0	13.0	27.2	19.1	2.4
1	Inch	4.33	0.51	1.33	1.00	9.04
	mm	110.0	13.0	33.9	25.4	4.1
1-1/4	Inch	5.00	0.51	1.68	1.25	10.58
	mm	127.0	13.0	42.7	31.8	4.8
1-1/2	Inch	5.51	0.51	1.92	1.50	20.28
	mm	140.0	13.0	48.8	38.0	9.2
2	Inch	6.50	0.65	2.41	2.00	33.29
	mm	165.0	16.5	61.2	50.8	15.1

REGULAR PORT CLASS 800/900/1500 DIMENSIONS						WGT. (lb/Kg)
SIZE		AT / AS	B	C	D	CLASS 800/ 900/ 1500
1/2 * 3/8	Inch	3.54	0.39	0.86	0.43	4.41
	mm	90.0	10.0	21.8	11.0	2.0
3/4 * 1/2	Inch	3.94	0.51	1.07	0.55	6.61
	mm	100.0	13.0	27.2	14.0	3.0
1 * 3/4	Inch	4.33	0.51	1.33	0.79	11.24
	mm	110.0	13.0	33.9	20.0	5.1
1-1/2 * 1	Inch	5.51	0.51	1.92	1.28	24.69
	mm	140.0	13.0	48.8	32.5	11.2
2 * 1-1/2	Inch	6.50	0.65	2.41	1.54	42.11
	mm	165.0	16.5	61.2	39.0	19.1

# SVI Forged Steel Floating Ball valve

Product Line Technical Data

YOUR ONE-STOP VALVE SOURCING CHANNEL

**2-PC Forged Steel Floating Ball Valve**  
**Pressure Class: 150 ~ 1500**  
**Size: 1/2" thru 2"**

Design and Manufacturing Standards	
DESIGN:	API 608 ASME B16.34
TESTING:	API 598
PRESSURE CLASS:	FLANGED -150,300,600,900,1500
CONNECTIONS:	FLANGED - ASME B16.5 FACE TO FACE- ASME B16.10

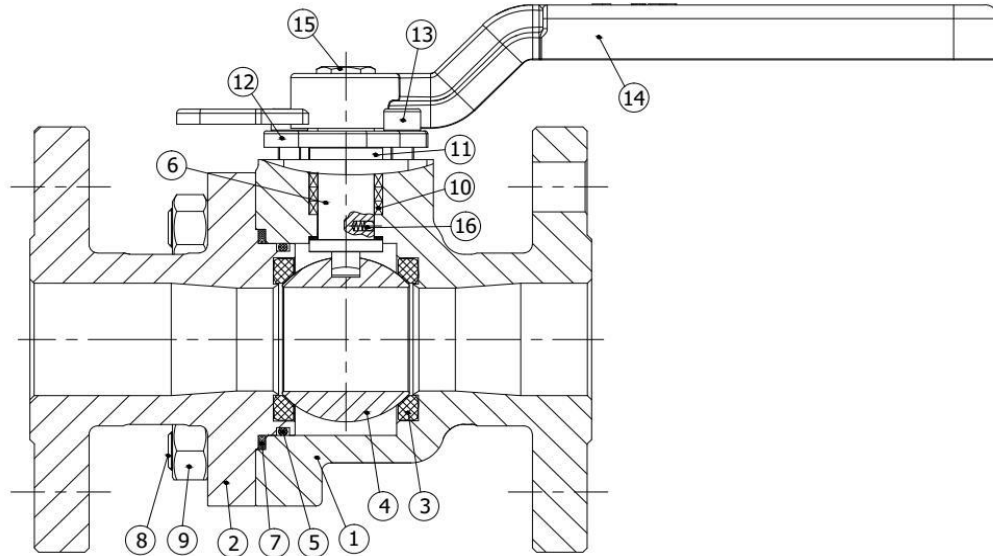

## CLASS 150~600 Material list accordance to Application type

NO.	Description	Standard	Low Temp	High Temp	Stainless	Sour Service
1	BOOY	ASTM A105N	ASTMA350 LF2	ASTMA182F11	ASTMA182 F316L	ASTM A182 F51
2	BONNET	ASTM A105N	ASTMA350 LF2	ASTMA182F11	ASTMA182 F316L	ASTM A182 F51
3	SEATRMC	R-PTFE	R-PTFE	R-PTFE	R-PTFE	R-PTFE
4	BALL	ASTM A182 F316	ASTM A182 F316	ASTM A182 F316	ASTM A182 F316	ASTM A182 F51
5	O-RING	NBR	NBR	NBR	NBR	NBR
6	STEM	ASTM A276 316	ASTM A276 316	ASTM A276 316	ASTMA276 316/316L	ASTM A182 P51
7	GASKET	316+Graphite	316+Graphite	316+Graphite	316+Graphite	F51+Graphite
8	BOLTS	ASTM A193-B7/ <b>B7M</b>	ASTM A320-L7/ <b>L7M</b>	ASTM A193 B16	ASTM A193 B8M	ASTM A193 B8M
9	NUT	ASTM 194-2H/ <b>2HM</b>	ASTM A194-4/ <b>7M</b>	ASTM A194 7	ASTM A194 8M	ASTM A194 8M
10	PACKNG	Graphite	Graphite	Graphite	Graphite	Graphite
11	GLAND	ASTM A276 316	ASTM A276 316	ASTM A276 316	ASTM A276 316	ASTM A276 316
12	GLAND FLANGE	304SS	304SS	304SS	304SS	304SS
13	CAP SCREWS	304SS	304SS	304SS	304SS	304SS
14	HANDLE	ASTM A216 WC8	ASTM A216 WC8	ASTM A216 WC8	ASTM A216 WC8	ASTM A216 WC8
15	NUT	304SS	304SS	304SS	304SS	304SS
16	ANTISTATIC BALL	316SS	316SS	316SS	316SS	316SS

\*Note: Material requested according to NACE-MR-0175 as marked in red. Other material upon request.

Product Line Technical Data

**Forged RF Ball Valve**  
**Pressure Class: 900,1500**  
**Size: 1/2" thru 2"**

Design and Manufacturing Standards	
DESIGN:	API 608 ASME B16.34
TESTING:	API 598
PRESSURE CLASS:	FLANGED -900,1500
CONNECTIONS:	FLANGED - ASME B16.5 FACE TO FACE- ASME B16.10

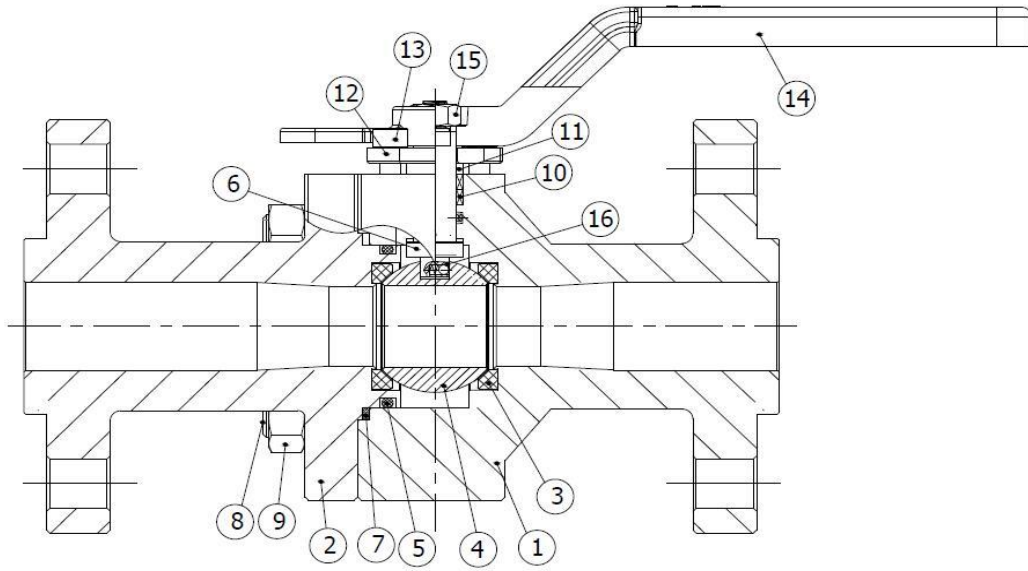

### CLASS 900/1500 Material list accordance to Application type

NO.	Description	Standard	Low Temp	High Temp	Stainless	Sour Service
1	BODY	ASTMA10SN	ASTMA350LF2	ASTMA182F11	ASTM A182 F316L	ASTM A182 F51
2	BONNET	ASTMA10SN	ASTMA350 LF2	ASTMA182F11	ASTM A182 F316L	ASTM A182 F51
3	SEAT RING	PEEK	PEEK	PEEK	PEEK	PEEK
4	BALL	ASTM A182 F316	ASTM A182 F316	ASTM A182 F316	ASTM A182 F316	ASTMA182 F51
5	O-RING	NBR	NBR	NBR	N8R	NBR
6	STEM	ASTM A276 316	ASTM A276 316	ASTM A276 316	ASTM A276 316L	ASTM A182 F51
7	GASKET	316SS+Graphite	316SS+Graphite	316SS+Graphite	316SS+Graphite	F51+Graphite
8	BOLT	ASTM A193-B7/ <b>B7M</b>	ASTM A320-L7/ <b>L7M</b>	ASTM A193 B16	ASTM A193 B8M	ASTM A193 B8M
9	NUT	ASTM 194-2H/ <b>2HM</b>	ASTM A194-4/ <b>7M</b>	ASTM A194 7	ASTM A194 8M	ASTM A194 8M
10	PACKING	Graphite	Graphite	Graphite	Graphite	Graphite
11	GLAND	ASTMA276 316	ASTMA276 316	ASTM A276 316	ASTM A276 316	ASTM A182 F51
12	GLAND FLANGE	304SS	304SS	304SS	304SS	304SS
13	CAP SCREWS	304SS	304SS	304SS	304SS	304SS
14	HANDLE	A3	A3	A3	A3	A3
15	NUT	304SS	304SS	304SS	304SS	304SS
16	ANTISTATIC BALL	316SS	316SS	316SS	316SS	316SS

\*Note: Material requested according to NACE-MR-0175 as marked in red. Other material upon request.

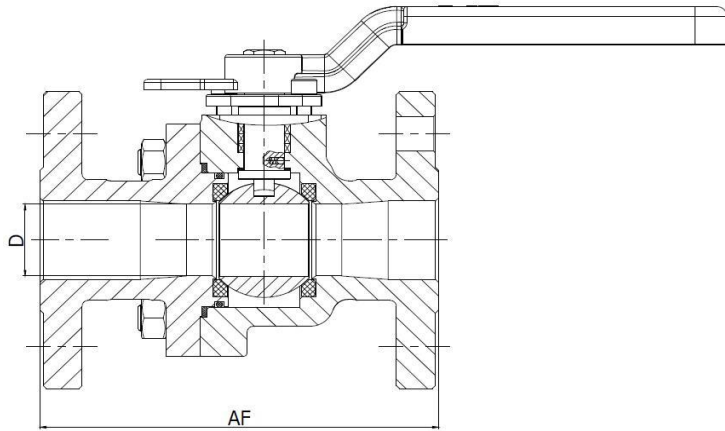

FULL PORT DIMENSIONS CLASS 150~600						WGT(lb/kg)		
SIZE		AF-150	AF - 300	AF - 600	D-RF	150	300	600
1/2	Inch	4.25	5.51	6.50	0.5	4.85 lb	5.95 lb	7.05 lb
	mm	108.0	140.0	165.0	14.0	2.2 kg	2.7 kg	3.2 kg
3/4	Inch	4.61	5.98	7.48	0.75	5.29 lb	8.60 lb	9.48 lb
	mm	117.0	152.0	190.0	18.5	2.4 kg	3.9 kg	4.3 kg
1	Inch	5.00	6.50	8.50	1.00	8.82 lb	11.68 lb	14.99 lb
	mm	127.0	165.0	216.0	24.5	4.0 kg	5.3 kg	6.8 kg
1-1/2	Inch	6.50	7.48	9.49	1.55	20.50 lb	26.46 lb	29.1 lb
	mm	165.0	190.0	241.0	38.0	9.3 kg	12.0 kg	13.3 kg
2	Inch	7.01	8.50	11.50	2.02	27.12 lb	41.89 lb	63.9 lb
	mm	178.0	216.0	292.0	49.5	12.3 kg	19.0 kg	29.2 kg

FULL PORT DIMENSIONS CLASS 900/1500					WGT(lb/kg)
SIZE		AF	D-RF	900 /1500	
1/2	Inch	8.50	0.5	15.5 lb	
	mm	216.0	14.0	6.8 kg	
3/4	Inch	9.02	0.75	24.3 lb	
	mm	229.0	18.5	11.0 kg	
1	Inch	10.00	1.00	35.4 lb	
	mm	254.0	24.5	16.9 kg	
1-1/2	Inch	12.01	1.55	71.9 lb	
	mm	305.0	38.0	32.6 kg	
2	Inch	14.49	2.02	141.1 lb	
	mm	368.0	49.5	64.0 kg	

**Seat Selection Guide**

Seat Type		PTFE	NYLON	PEEK	PCTFE	DEVLON
Temperature Range °F		-328 ~ 428	-58 ~ 248	-148 ~ 500	-328 ~ 302	-148 ~ 302
Temperature Range °C		200 ~ 220	-50 ~ 120	100 ~ 260	-200 ~ 150	-100 ~ 150
Pressure Rating Class		150 ~ 600	150 ~ 1500	150 ~ 2500	150 ~ 1500	150 ~ 1500
Mechanical Property	Hardness (D)	58	72	88	85	78
	Tensile Strength ( MPa )	14-34	55.2	134	35.9	79.9
	Tensile Elongation (Break, %)	350	250	2.2	150	5.4
Physical Property	Specific Gravity (g/cm3)	2.17	1.02	1.44	2.12	1.14
	Water Absorption 24hrs (%)	0	1	0.06	0	0.1
	Water Absorption saturation	<0.01	1.6	0.2	<0.01	3
Service Application		Chemical & Low Temperature	High Pressure & Hydrocarbon	High Pressure & Hydrocarbon	Cryogenic	High Pressure & Hydrocarbon

**FLOATING BALL STYLE**

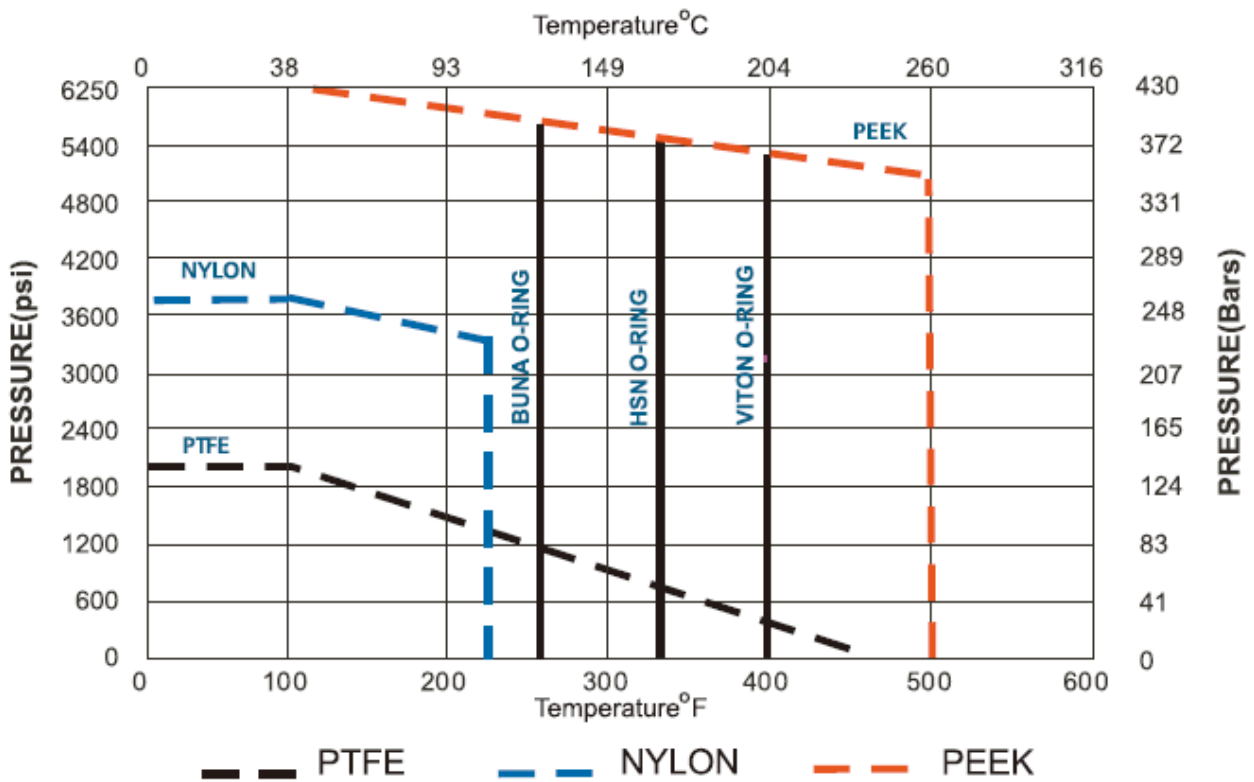

**O-Ring materials for floating ball valves are for seat and stem. All Body/bonnet seals are graphite.**  
 Above ratings are for soft seal components. Please consult ASME B16.34 for Body and Closure Pressure /Temperature ratings.



Material P&T Rating

PRESSURE TEMPERATURE RATINGS																																				
Working Pressure BY PSI Class 150/300/600/800/900/1500/2500																																				
Material	A105N/LF2/LF3							A182-F11/F22		F51/F44/F53/F55					N08020		A182-F304/F304H/F316/F316H/F347/F347H							A182-F304L/F316L							Material					
Class/ °F	150	300	600	800	900	1500	2500	150	300	600	800	900	1500	2500	150	300	600	800	900	1500	2500	150	300	600	800	900	1500	2500	150	300	600	800	900	1500	2500	Class/ °C
-20~100	285	740	1480	1975	2220	3705	6170	290	750	1500	2000	2250	3750	6250	275	720	1440	1920	2160	3600	6000	230	600	1200	1600	1800	3000	5000	230	600	1200	1600	1800	3000	5000	-30~37
200	260	680	1360	1810	2035	3395	5655	260	750	1500	2000	2250	3750	6250	230	600	1200	1600	1800	3000	5000	195	510	1020	1365	1535	2555	4260	195	510	1020	1365	1535	2555	4260	93
300	230	655	1310	1745	1965	3270	5450	230	720	1445	1925	2165	3610	6015	205	540	1075	1435	1615	2690	4480	175	455	910	1215	1370	2280	3800	175	455	910	1215	1370	2280	3800	149
400	200	635	1265	1690	1900	3170	5280	200	695	1385	1850	2080	3465	5775	190	495	995	1325	1490	2485	4140	160	420	840	1120	1260	2100	3500	160	420	840	1120	1260	2100	3500	204
500	170	605	1205	1610	1810	3015	5025	170	665	1330	1775	1995	3325	5540	170	465	930	1240	1395	2330	3880	150	395	785	1050	1180	1970	3280	150	395	785	1050	1180	1970	3280	260
600	140	570	1135	1515	1705	2840	4730	140	605	1210	1615	1815	3025	5040	4140	440	885	1180	1325	2210	3680	140	370	745	990	1115	1860	3100	140	370	745	990	1115	1860	3100	316
650	125	550	1100	1465	1650	2745	4575	125	590	1175	1570	1765	2940	4905	125	430	865	1150	1295	2160	3600	125	365	730	975	1095	1825	3040	125	365	730	975	1095	1825	3040	343
700	110	530	1060	1415	1590	2665	4425	110	570	1135	1515	1705	2840	4730	110	420	845	1125	1265	2110	3520	110	360	720	960	1080	1800	3000	110	360	720	960	1080	1800	3000	371
750	95	505	1015	1350	1520	2535	4230	95	530	1065	1420	1595	2660	4430	95	415	825	1100	1240	2065	3440	110	355	705	940	1060	1765	2940	110	355	705	940	1060	1765	2940	399
800	80	410	825	1100	1235	2055	3430	80	510	1015	1355	1525	2540	4230	80	405	810	1080	1215	2030	3380	80	345	690	920	1035	1730	2880	80	345	690	920	1035	1730	2880	427
850	65	320	640	850	955	1595	2655	65	485	975	1300	1460	2435	4060	65	395	790	1055	1190	1980	3300	65	340	675	900	1015	1690	2820	65	340	675	900	1015	1690	2820	454
900	50	230	460	615	690	1150	1915	50	450	900	1200	1350	2245	3745	50	390	780	1035	1165	1945	3240															482
950	35	135	275	365	410	685	1145	35	320	640	850	955	1595	2655	35	380	765	1020	1145	1910	3180															510
1000	20	85	170	225	255	430	715	20	215	430	575	650	1080	1800	20	355	710	945	1065	1770	2950															538
1050								20	145	290	385	430	720	1200	20	325	650	865	975	1630	2715															566
1100								20	95	190	255	290	480	800	20	255	515	685	770	1285	2145															593
1150								20	65	130	175	195	325	545	20	205	410	645	615	1030	1715															621
1200								15	40	80	110	125	205	345	20	165	330	440	495	825	1370															649
1250															20	135	265	355	400	670	1115															677
1300															20	115	225	300	340	565	945															704
1350															20	95	185	250	280	465	770															732
1400															20	75	150	200	225	380	630															760
1450															20	60	115	155	175	290	485															788
1500															15	40	85	110	125	205	345															816

NOTE: °F=(°C\*9/5)+32  
 °C=(°F-32)\*5/9

Data reference ASME 16.34