



Production Collet Closers

Air Operated — Hand Wheel

Special Instructions: You MUST indicate Index Ring on lathe to have Collet Closer operate correctly.

TO INSTALL AIR OPERATED CLOSER

1. Mount the unit following the instructions for the *Hand Lever Closer* where applicable.
2. Mount air valve within convenient reach of operator. To assure long life for the unit avoid excessive pressure. Unit should operate satisfactorily on 40 psi. or less.

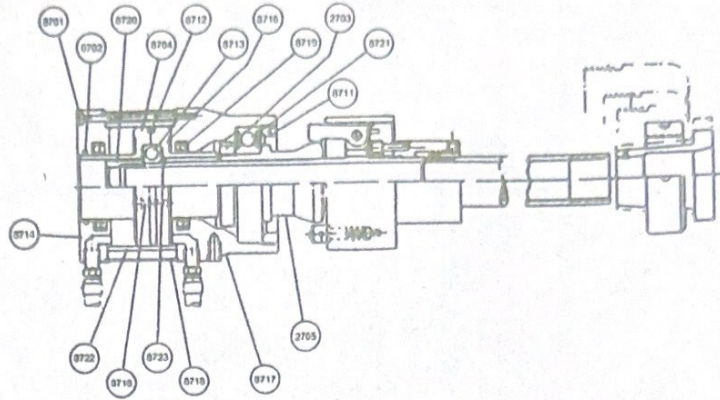

AIR OPERATED COLLET CLOSER PARTS LIST

| | | | |
|---|-----|-------------------------------------|-----|
| 2703 Threaded Nut (Steel)..... | | 8714 Head Rear Cylinder (Alum)..... | |
| 2705 Cam (Steel)..... | | 8716 Socket Head Cap Screw..... | (6) |
| 8701 Socket Head Cap Screw..... | (4) | 8717 Head Front (Alum)..... | |
| 8702 O-Ring (Wiper) For Rear of Head #224... | | 8718 Piston Front (Alum)..... | |
| 8704 Piston Rear (Alum)..... | | 8719 Seal 6226-29 Buna..... | (2) |
| 8705 Actuator, Brazed Assy. With Fingers, Springs and Knurled Collar..... | | 8720 Retainer Nut (Steel)..... | |
| 8711 Threaded Retainer Nut (Steel)..... | | 8721 Bearing For Front Head..... | |
| 8712 O-Ring For Piston #336..... | | 8722 Cylinder (Alum)..... | |
| 8713 Bearing For Piston..... | | 8723 Ring Stop (Steel)..... | |
| | | Finger Springs..... | (3) |
| NOTE: 8702 Obsolete — New Model | | | |

TO INSTALL HAND WHEEL CLOSER

1. Install collet adapter (201), nose ring (202) and collet in the same manner as the hand lever closer.
2. Insert unit thru back end of spindle and engage collet by turning wheel.
3. With material of required size in collet turn the wheel until material is firmly grasped.

Caution: Avoid excessive tension on collet.



HAND WHEEL COLLET CLOSER PARTS LIST

| | | |
|-------|----------------------|-----|
| 201-A | Adapter, Collet | 2½" |
| 201-B | Adapter, Collet | 3" |
| 201-C | Adapter, Collet | 3½" |
| 201-K | Key | |
| | | |
| | | |
| | | |
| 503 | Tube, Draw | |
| 504 | Collar, Thrust | |
| 505 | Bearing, Thrust | |
| 508 | Wheel, Hand-Machined | |

..... distributed by

J. F. K. Co.