

St. Paul's Lutheran Church of Smithfield
139 Craig's Meadow Rd.
East Stroudsburg, Pa. 18301
Phone: 570-223-9422

E-mail: stpaulscraigsmeadow@verizon.net
Web Site: stpaulscommunitychurch.com
Facebook: St. Paul's Lutheran Church of Smithfield

ST. PAUL'S CALL

MARCH 2025

Pastor Deb Staniszewski

**EVERYONE WELCOME TO JOIN US FOR
PRAYER, WORSHIP & FELLOWSHIP**

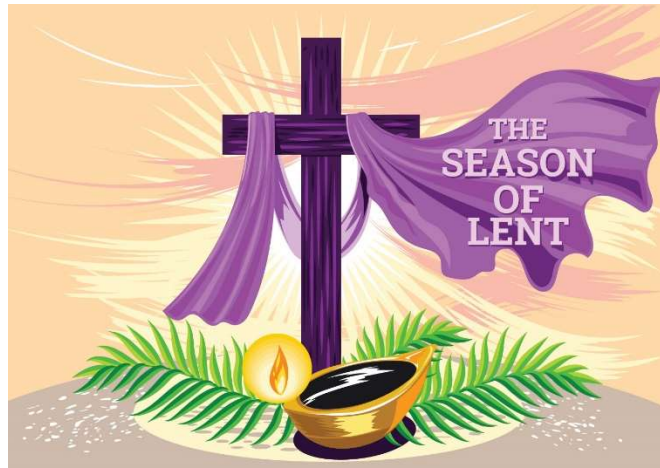

SUNDAY SERVICES 8:30AM AND 10:00AM

Sunday School 9:00 – 9:45am

LIVE STREAMING AVAILABLE

10:00AM SERVICE.

Connect to Facebook direct or go to our web site FB tab.

A PDF of the 10:00am service bulletin is on the web site.

St. Paul's Mission Statement

We are a community of faith called to share the good news of Jesus as our model of life. We seek spiritual maturity through worship, learning and serving. We invite and welcome all who desire to share this journey of faith active in love.

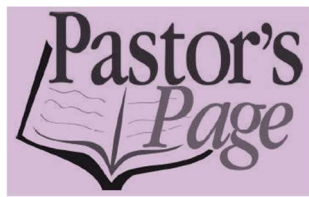

Greetings Friends!

Driving last week I praised God when I saw a gorgeous blue bird! Her colors were amazing and I was delighted not just by her beauty, but that I had witnessed a sign of the arrival of spring, and the presence of the wisdom of God in creation! In the book of Job chapter 12, Job says this, (The interpretation in The Message)

“But ask the animals what they think—let them teach you; let the birds tell you what’s going on.

Put your ear to the earth—learn the basics. Listen—the fish in the ocean will tell you their stories.

Isn’t it clear that they all know and agree that God is sovereign, that he holds all things in his hand— Every living soul, yes, every breathing creature?” (Job 12:7-12, Message)

God’s grace and wisdom is everywhere in nature, and as humans, we have been tasked by God since Adam, to be good stewards of the earth, and to exercise care for all of God’s creatures, the large and small, the magnificent and the bizarre.

Here at St. Paul’s, we have decided to repurpose our community vegetable garden, by planting a flower garden that supports local wildlife. We are hoping that birds, bees, and butterflies, are just some of the creatures who will visit our garden for refreshment and shelter.

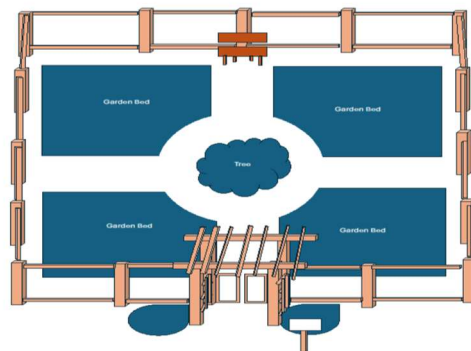

This is a drawing of the garden space that we are building to share with our wildlife friends! If you have a green thumb, love digging in the dirt, or suspect that you have an inner gardener waiting to bloom, please call the office or reach out to Tracey Lasslett, Carol Raughley, Kathy Ertle, Alisa Nixon or Pastor Deb.

The beauty of creation is all around us. I invite you to take a moment, or even an hour today to Praise God and contemplate the magnificence of the earth, and listen to the stories of her creatures, as you wonder at the miracle of nature.

Your Sibling in Christ,

Pastor Deb



Worship & Music 40 Days of Lent



Daylight Savings – March 9th

(spring forward – more sunshine!) Remember to set your clocks forward 1 hour.

Lent Soup & Services

Ash Wednesday – March 5th

Labyrinth 12pm, Service at 5pm, Ashes to Go anytime between 10 & 1pm

Lenten Soup Suppers – Wednesdays 5pm

March 12th, 19th, 26th, April 2nd & Agape Feast on April 8th with Mediterranean delights!

5:45pm Reflecting on Scriptural Images of God through Prayer Practice

Please sign up on the bulletin board if you can make soup or dessert. Thank you!

Holy Week

Palm Sunday – April 13th 8:30 & 10am

Pocono Mountain Community Chorus 2025 Holy Week Concert –

Palm Sunday April 13th 7pm at St. John's Lutheran Church 9 North 9th St, Stroudsburg

Maundy Thursday – April 17th 6pm

Good Friday – April 18th 12 noon Stations of the Cross & 6pm Service

He Is Risen!

Easter – April 20th 8:30 & 10am

Check the bulletin board for sponsorship opportunities!

Next meeting – Monday, March 3rd 6pm
Blessings from your,
Worship & Music Committee



Labyrinth Walk IN THE CHAPEL

Mon, Wed, Thu & Friday
Anytime between 9-12pm
(If locked, ring the doorbell)

St. Paul's Lutheran Church
139 Craig's Meadow Rd, East Stbg, PA
FMI, Call 570-223-9422

soup's on WEDNESDAYS IN LENT



SOUP DINNER 5PM

**Reflecting on Scriptural Images
of God through Prayer Practice**

Beginning at 5:45PM

March 12, 19, 26 & April 2
April 9 – Agape Feast

St. Paul's Lutheran Church Smithfield
139 Craig's Meadow Rd, East Stroudsburg, PA
FMI, 570-223-9422

**ASH
WEDNESDAY**

**Wednesday
March 5th**

**Labyrinth 12pm
Service 5pm**

**Stop in for
Ashes to Go
10:00-12:00noon**

St. Paul's Lutheran Church Smithfield
139 Craig's Meadow Rd, East Stroudsburg, PA
FMI, Call 570-223-9422



**Thursday March 13th and 27th
9:30am – 12:00noon**

Contact Wanda Richardson with any questions.

The food pantry needs: Boxed macaroni & cheese, cereal, jelly and canned Tuna.

Anything else you would like to donate is appreciated - It must be non-perishable in can, box or bag. Please check the "best by" and expiration dates, we cannot accept anything past the best by or expiration date.

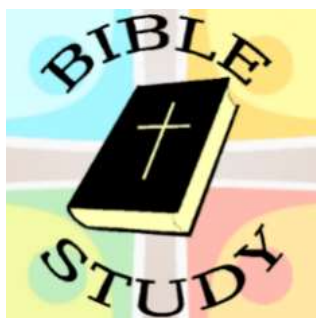

**Every Tuesday 11:30am to 12:30pm.
JOIN US**

FRIDAY LADIES

Friday's 9:00 – 12:00 noon



The ladies make lovely lap robes that they share with hospitals, nursing & retirement homes plus our newly baptized babies go home with one. They are always appreciated and if you know of someone that might need one, please let Edie know.

Come on Friday and join in.

Donations always welcome of clean cotton fabric printed or solid. Large pieces of fabric for backing, quilting thread or just ask the ladies if you have something they might use.



**Come join us for Pickleball in Celebration Hall!
Beginners and more experienced players welcome.**

Download the app TeamReach and use the code STPAULS. Once in the app you can look at the calendar for times.

ANY questions text or call Laura Biddulph.
570-369-0359





Hello Church Youth Families,



Sunday School class is held on Sunday mornings from 9-9:45 am. All children from preschool and up are welcome! We meet in the room to the left of the sanctuary.

Confirmation Class for this month (1-3pm):

March 9th

March 23rd

Confirmation Class Retreat: March 14-15

On March 16th, Brooke's Girl Scout Troop will join us for Sunday School and the 10 am service in celebration of Girl Scout Week.

Sunday School and Confirmation Class packed 18 boxes for Touch of Home in February. They did a fantastic job! Thank you so much to the congregation for donations and support of this service project!

Blessings always,

Christian Education Team

Alisa Nixon (908) 279-5242

Pastor Deb (570) 350-5115



Touch of Home packages blessed by Pastor.

VOLUNTEERS NEEDED !!



Please see Nancy Fritz or leave your name in the office.

No experience necessary you will be instructed and helped as much as you need. Assistance is needed for a month at a time.

FELLOWSHIP COMMITTEE



Sunday Coffee Hour

Help with Funeral Luncheons



Contact Jeannette Richardson or Faye Jones if interested.



Food Pantry

Contact Wanda Richardson or office If you would like help for Thursday Food Pantry or special holidays.

SUNDAY SERVICE



If you would like to help on a Sunday contact Barbara Edwards or office.

Ushers and Lay Readers

Contact Pastor direct.

If you are interested in leading a service on one of Pastor's Sundays when she is away.

Musical Opportunities –



CHOIR meets Thursdays at 6:30pm in the sanctuary.
If interested, contact Kathy Ertle.

THE PRAISE TEAM meets on the 1st and 3rd
Wednesday of every month at 6:30pm and
plays for the Contemporary service at 10am on
the 4th Sunday of the month.

Please reach out to Chris Matthy if interested.

Sponsor Opportunities – Sign up sheets on Narthex Bulletin Board

Be A Worship Sponsor! – For \$22.00, or split with another, you can sponsor a worship service. The money goes towards expenses for web sites used in bulletin preparation, copyright for songs and supplies like paper and toner. Checks can be given to Dana Strohl or Secretary Lynne Williams.



NO FLOWERS DURING LENT

Flowers – The flower sign up sheet is on the bulletin board. Celebrate a loved one with a fresh flower arrangement from Floral Boutique. Please find someone to share with you if you'd like to. Order forms and checks may be given to Dana Strohl or Lynne Williams.

*In case of
Inclement
Weather* 

The following is the procedure for the inclement weather. The church council will make the decision if services will be delayed or cancelled due to weather. If there will be a delay or closing or Sunday School is cancelled, this information will be on Facebook. There will also be a message put on the answering machine for the church. If you are not sure if services are cancelled, please call the church at 570-223-9422 and listen for a message. **If there is not a special message... Then services are their usual times.**



Building Connections, Strengthening Mission: The Impact of Staff Development

Since 2021, when I joined the synod staff, I have felt a deep passion and dedication for the work God is calling me to do. Over the past three years, the relationships I have built, both with synod staff and throughout the synod regions and beyond, have been some of the strongest of my career. I have been a Lutheran all my life, raised in a church and family of faith. So, when the job opened at the synod office, applying felt like a natural choice.



My time on synod staff has shaped my spiritual journey, revealing how God's presence is truly in everyone, including me, in both joyful and challenging times. I often find myself asking, "What is God calling us to do?" "What is God calling *me* to do?" It's funny how sometimes God's answers are loud and clear, while other times, there seems to be silence, much like a parent stepping back to let a child solve a puzzle or get dressed all on their own.

However, God is not silent in the Northeastern Pennsylvania Synod. God is actively working through all of us to move mountains and embody the change Jesus modeled for us. The synod staff have been focusing more intentionally on communication and staff development. Over the past year, the full synod staff, including building staff and the Associates of the Bishop, have gathered for retreats to strengthen our communication. One of these retreats also included the Synod Council, the redesign team, and other key stakeholders around the synod, providing a space for collaboration. Pastor Doug Hill from Abiding Hope in Littleton, Colorado, has helped facilitate some of these retreats, incorporating insights from the Gaining Strength cohorts. Through this work, staff have explored their enneagram numbers, gaining a deeper understanding of how our personalities intertwine and complement one another.

Pastor Rachael Dietz, Associate to the Bishop, comments on the retreat by saying, "*Intentional investment*



in staff help us grow into the disciples God would have us be. We're not static blobs; we're human beings with hearts, hands, feet, and brains. When we practice and learn, we become more aligned and attuned to the Spirit's work in us and the synod. Your mission support then gets turned inside out as we support the mission of congregations: to proclaim Jesus, crucified and risen, to all."

This investment in staff development is not just about strengthening our internal team, it is about equipping us to better serve the entire synod. As we grow in communication, collaboration, and leadership, we become more responsive to the needs of the congregations, more effective in our ministries, and more connected as a community of faith. By modeling teamwork and intentional growth, we hope to inspire congregations and leaders to do the same in their own contexts. Ultimately, this work is about aligning ourselves more fully with God's call, ensuring that together, as one synod, we continue to move mountains and embody the change Christ has set before us.

We would like to extend our gratitude to Trinity Lutheran Church in Lehighton and St. John's Lutheran Church in Allentown for hosting staff retreats. Your hospitality is deeply appreciated and truly a blessing.

Submitted by: Stacey Burke (she/her) Communications & Growing Young Coordinator

DID YOU KNOW that your Mission Support helps fund areas of the synod like this one and many other important initiatives? Your contributions are making a significant impact and helping others grow in faith, supporting the synod's lanes of Growing Young, Gaining Strength, and Going Beyond Death to Life, along with the directions of loving like Jesus, healing like Jesus, and engaging like Jesus. To learn more, visit godslove.org/missionsupport.



Christ Hamilton United Lutheran Church
Stroudsburg, PA

2025
**Connect
the Dots**
Northeastern PA Synod Assembly

godslove.org/assembly2025

May
30-31
Registration
opens April 1

CELEBRATION HALL RENTALS

Please share with friends. For information contact

SONJI PATRICK (CALL OFFICE FOR PHONE #.)



Celebrate Your Event



- Full Commercial Kitchen
- Seating: 160 Banquet Style
180 Assembly
- Parking: Up to 75 Vehicles
- Handicap Accessible
- Wi-Fi Ready

- Weddings
- Birthday Parties
- Anniversary Parties
- Banquets
- Meetings
- Workshops



Sweet 16 Party



Sunday March	Monday 2025	Tuesday	Wednesday	Thursday	Friday	Saturday
						1
2 Transfiguration Of our Lord 8:30 & 10:00am Sunday School 9:00 – 9:45am	3 Worship and Music 6:30pm	4 Bible Study 11:30 – 12:30pm	5 Ash Wed. Ashes to go. 10-12pm Labyrinth 12pm Service 5pm	6 Choir 6:30pm	7 Friday Ladies 9:00am - 12:00noon	8
9 1 Lent 8:30 & 10:00am Sunday School 9:00 – 9:45am	10 Vison Meeting In Chapel	11 Bible Study 11:30 – 12:30pm Council Meeting 6:30	12 Lent Soup and Service 5:00 – 6:15	13 Food Pantry 9:30-12:00 Choir 6:30pm	14 Friday Ladies 9:00am - 12:00noon Confirmation Class Retreat Over night	15 Girl Scouts Cele. Hall Over night
16	17	18	19	20	21	22
2 Lent 8:30 & 10:00am Sunday School 9:00 – 9:45am Girl Scouts in Choir Praise Team Rehearsal 12noon		Bible Study 11:30 – 12:30pm	Lent Soup and Service 5:00 – 6:15	Finance Meeting 6:00pm Choir 6:30pm	Friday Ladies 9:00am - 12:00noon	
23	24	25	26	27	28	29
3 Lent 8:30 10:00am Contemporary with Praise Team Sunday School 9:00 – 9:45am		Bible Study 11:30 – 12:30pm	Lent Soup and Service 5:00 – 6:15	Food Pantry 9:30-12:00 Choir 6:30pm	Friday Ladies 9:00am - 12:00noon	
30 4 Lent 8:30 – 10:00am Sunday School 9:00- 9:45 Healing Service	31					