



AquaSpray
High Speed Air
Handpiece
with water mist

Instruction
Manual

Table of Contents

Introduction.....	Page 3
Upon Receiving your AquaSpray.....	Page 4
Installation.....	Page 4 - 5
Maintenance.....	Page 5
Warranty.....	Page 5
Technical Information.....	Page 6
Accessories & Spare Parts.....	Page 6
Chuck Replacement Instructions.....	Page 7
AquaSpray Schematic.....	Page 8

INTRODUCTION

Trident Sales Associates thanks you and congratulates you for choosing the AquaSpray as your new High Speed Air Handpiece. The AquaSpray was designed and engineered by highly qualified personnel with many years of experience and expertise in handpiece manufacturing. Its construction underlines the high standards of quality that have always distinguished our products.

Special “unique” features of the AquaSpray include:

- * High-speed, low-noise zirconia bearings
- * An adjustable, easily replaceable chuck system
- * An ergonomic comfort grip
- * 300,000 rpm of power
- * Can be used with or without water mist

This instruction manual will help familiarize you with the AquaSpray. Please read it carefully. Keep the manual in a safe place so that it can be consulted whenever necessary. Should you have any questions please contact:

Trident Sales Associates
195 Basik Drive, Suite 506
Naples, FL 34114

Tel: 561-826-9331
Fax: 561-353-0895
Email: walter@tridentsales.us

UPON RECEIVING YOUR AQUASPRAY

Carefully inspect the unit to insure that it has not been damaged in shipping. In the event of any damage, immediately contact the shipping company to report it.

The AquaSpray comes with the following:

- * AquaSpray handpiece
- * Control Box
- * Foot Pedal
- * Barbed Hose Connector
- * Bur Insertion Tool (BIT)
- * Warranty Card
- * Instruction Manual

INSTALLATION

Remove all items from the shipping box.

Place the Control Box on the bench in the area where it will be used.

Connect the handpiece to the round connector on the hose attached to the Control Box. Secure this connection in place by tightening the locking ring.

Insert the smaller end of the plastic barbed fitting into the hose that is attached to the foot pedal assembly. Attach the larger end of the barbed fitting into your air compressor hose.

Water Reservoir: Fill the tank with **distilled water** by unscrewing the water cap located at the top of the control box. Water Spray intensity can be adjusted by turning the water spray knob on the front panel of the control box to the desired intensity. Turn counter clockwise to increase intensity, clockwise to decrease intensity. Note that the AquaSpray can be used with or without any water spray.

Air Pressure Setting: Adjust the pressure regulator located at the top of the control box to 35 psi MAX (2.5 bar). **Do Not** use the AquaSpray above 35 psi (2.5 bar) or you will damage the turbine cartridge.

FG Bur Insertion: Use the Bur Insertion Tool (BIT) to correctly insert the bur into the chuck. Place the bur into the chuck; place the BIT over the bur and firmly press straight down. The bur is now properly in place.

FG Bur Removal: Firmly hold the center of the handpiece with one hand and push the rear of the handpiece forward with your other hand. This will activate the bur ejection mechanism and allow the bur to be easily removed.

MAINTENANCE

The AquaSpray is equipped with high-speed, zirconia bearings. **DO NOT LUBRICATE THESE BEARINGS.**

Periodically check the air ducts at the rear of the Handpiece. Air should always exit from them. Remove any material that may be obstructing these ducts.

Use only distilled water.

WARRANTY

The AquaSpray is warranted for a full year from date of purchase. If the serial number label is removed, the warranty becomes null and void.

TECHNICAL INFORMATION

Speed.....300,000rpm
Recommended Air Pressure (max).....35 psi (2.5 bar)
Handpiece weight.....2 oz.
Bur Type.....Straight FG
Bur Diameter.....1.59 – 1.60 mm
Bur Length.....25 mm

ACCESSORIES & SPARE PARTS

Turbine Cartridge.....p/n AFTC
Chuck.....p/n COAF

CHUCK REPLACEMENT

Remove the complete turbine assembly from the handpiece by turning the front end counter-clockwise.

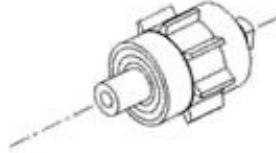

Align the chuck tool so that it fits into the rear of the chuck. Securely hold the turbine assembly with a piece of cloth to protect it and remove the chuck by turning the chuck tool clockwise.

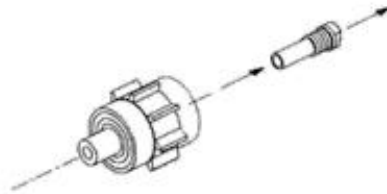

Insert a bur or probe into the front spindle of the turbine. By doing so any residue will be automatically eliminated from the turbine.



Place the chuck into the turbine and tighten by turning the chuck tool counter-clockwise.

