

### ELECTRICAL DATA

Impedance : 50ohm

Frequency range : DC to 4GHz

Contact current : DC 1.5A max.

Voltage rating : 250V rms

Contact resistance : 3.0 M $\Omega$  - Center contacts  
0.5 M $\Omega$  - Outer contacts

Insulation resistance : 1000 M $\Omega$  min.

Insertion loss : 0.6dB max.

VSWR : 1.4+0.06f(GHz)

RF leakage : -55dBm min. between 2-3GHz

Part	Material	Plating
Body	Brass	Gold
Sleeve	Brass	Gold
Center Contact	Beryllium Copper	Gold
Insulator	PTFE	—

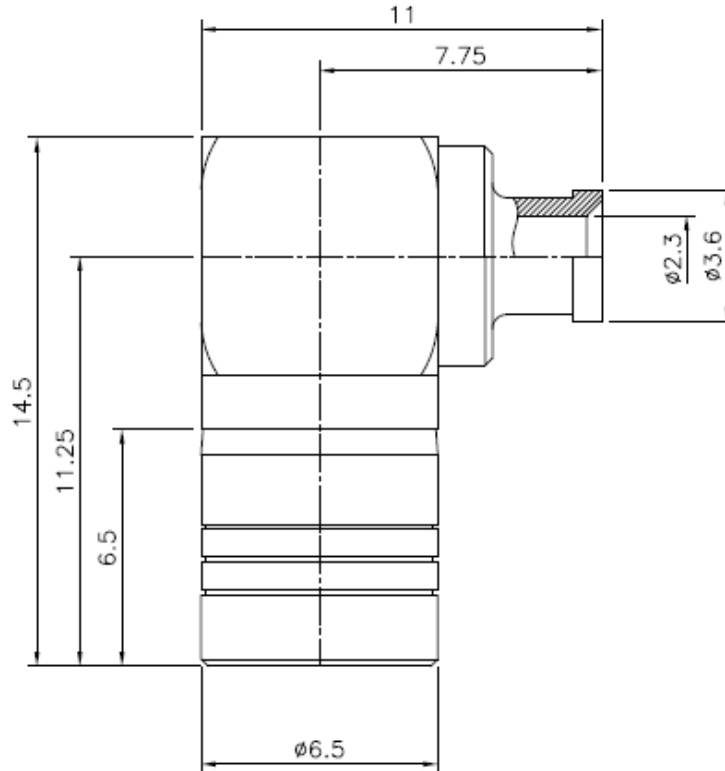

### MECHANICAL DATA

Engagement force : Max. 63N

Life : 500 matings

Contact captivation : Max. 15N

### ENVIRONMENTAL DATA

Temperature range : -65°C ~ +125°C

Corrosion resistance : MIL-STD-202, Method 101, Condition B

Moisture resistance : MIL-STD-202, Method 106

Thermal shock : MIL-STD-202, Method 107, Condition B

Vibration : MIL-STD-202, Method 204, Condition D

Dimensions are in mm,  
for reference only, and are  
subject to change  
without notice.



**Premier RF**

17 Roslyn CT  
Patchogue, NY 11772  
PH: 631-447-3804  
sales@premierRF.com  
www.premierRF.com

**PART NUMBER**

**PRF-CO8FR1-BG**

**DESCRIPTION**

**SMB RIGHT ANGLE PLUG  
FEMALE, FOR .085 CABLE**

8/23/2013

APPROVED

A. Ianacci