

The HA9 card ejector handle has been redesigned to extract 0.063" - to 0.093" thick cards from their receptacles (connectors). It is often essential to have some mechanical means of extracting boards from connectors that have high withdrawal forces. This cam-style ejector provides an inexpensive, on-the-board, low profile method for extracting up to 40 pounds per ejector when properly used.

MOUNTING

The corner of the board must be notched 0.125" X 45° and drilled 0.250" X 0.250" from the edges with a #39 drill (0.0995" dia.) as shown in the illustration. The HA9 ejector is then placed in alignment with the board hole as shown, and the roll pin tapped into position. One ejector is usually sufficient on boards up to 3.0"; two ejectors should be used on larger boards.

ILLUSTRATION SHOWING MOUNTING OF HA9 CARD EJECTOR HANDLE ON 0.063"-0.093" THICK CIRCUIT CARD

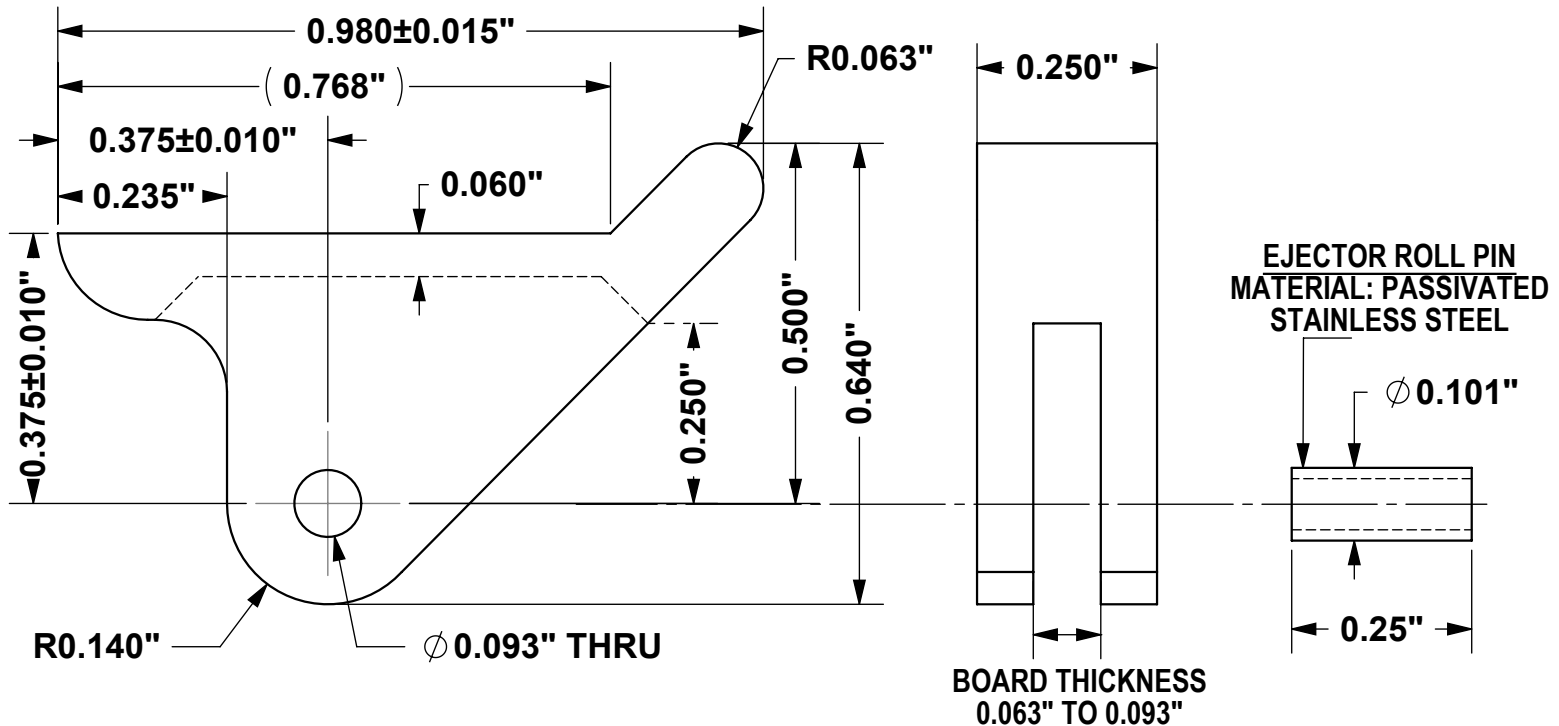

Once the ejector is installed, proper adjustment of the board in relation to the card guides will influence the effectiveness of the ejector. The ejector must have a surface to bear against within 0.150" of the edge of the board. The ejector lever arm must rest on this surface. If the card is pushed deeper into its card guides the ejector will lose its mechanical advantage.