

VANEC

Model 321 Intake Silencer

Standard Features:

- ✓ All Steel Welded Construction
- ✓ Quality Fabrication Techniques
- ✓ Hair Felt Absorptive Pack
- ✓ Maximum Operating Temperature of 250°F
- ✓ Plate Flanges to Match ASA 125# Flanges
- ✓ Prime Coated Exterior Surfaces

Optional Features:

- ✓ Materials as Specified
- ✓ Finish as Specified
- ✓ Pack Material as Specified
- ✓ Mounting Brackets
- ✓ Threaded Connections Available
- ✓ Companion Flanges
- ✓ Flange Drilling as Specified

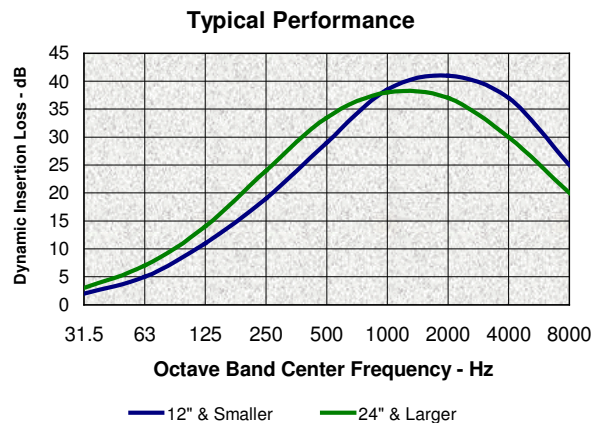
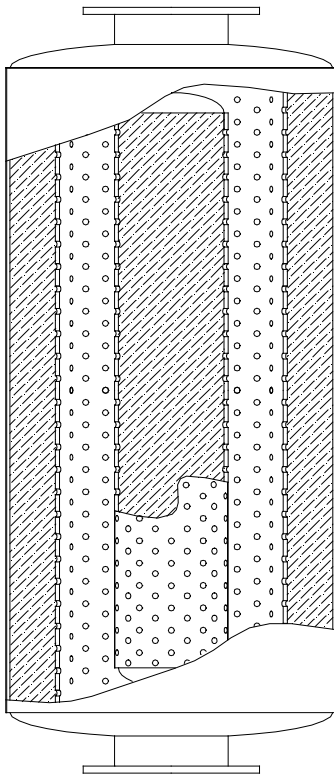

Application:

The **VANEC** Model 321 Intake Silencer is designed for use in suppressing the intake noise from high speed blowers, fans, engines and centrifugal air handling devices with an atmospheric suction.

The Model 321 Intake Silencer, when properly applied, will reduce intake noise to a community acceptable level for dwellings located further than 400 ft. from the intake opening. Silencer performance will depend upon actual operating conditions.

The **VANEC** Model 321 Intake Silencer may be mounted either vertically or horizontally.

Issue: 10/2002

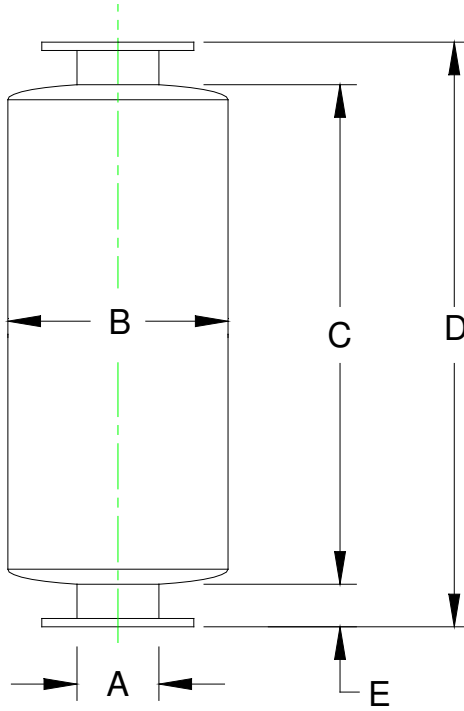

VANEC Model 321

Size	Dimensions in Inches					Est. Wt. Lbs.
	A	B	C	D	E	
321-08	8	18	35	41	3	141
321-10	10	20	47	53	3	228
321-12	12	24	58	64	3	363
321-14	14	26	60	68	4	455
321-16	16	30	67	75	4	657
321-18	18	32	74	82	4	769
321-20	20	34	80	88	4	943
321-22	22	38	87	97	5	1,251
321-24	24	40	99	109	5	1,655
321-26	26	42	99	109	5	1,768
321-28	28	46	110	120	5	2,399
321-30	30	48	117	129	6	2,670
321-32	32	54	119	131	6	3,292
321-34	34	54	130	142	6	3,527
321-36	36	60	137	149	6	4,359
321-38	38	60	150	164	7	4,965
321-40	40	66	157	171	7	6,364
321-42	42	66	162	176	7	6,497
321-44	44	72	160	174	7	7,435
321-46	46	72	183	199	8	8,087
321-48	48	74	183	199	8	8,448

VANEC Industrial Silencers
716-827-4959