

# DOORS & ACCESSORIES

## HOLLOW METAL DOORS & ACCESSORIES

### HOLLOW METAL DOORS

#### SPECIAL SERVICE

Our door facilities have the expertise to prepare our stock doors and non-stock doors for specific requirements. These services include: special hinge templating, door lites, special lock preparation, e-channels for electric lock applications, flush bolt preparations, etc. Non-standard doors with steel stiffened cores filled with fiberglass insulation, 16, and 14 gauge sheets can also be special ordered. We can prepare full shop drawings & elevations.

MFG #	WIDTH	HEIGHT	PREP	HAND	EZ #
<b>INSULATED CORE, 18 GAUGE</b>					
INS18G3068161	3'0"	6'8"	Knob/Lever	Reversible	103834
INS18G3068RP	3'0"	6'8"	Rim Panic	Reversible	103835
INS18G3070161DBLH	3'0"	7'0"	Deadbolt	Left	104874
INS18G3070161DBRH	3'0"	7'0"	Deadbolt	Right	104873
INS18G3070161LH	3'0"	7'0"	Knob/Lever	Left	103832
INS18G3070161RH	3'0"	7'0"	Knob/Lever	Right	103831
INS18G3070RP	3'0"	7'0"	Rim Panic	Reversible	103833
INS18G3070RPNB	3'0"	7'0"	Slab Only	Reversible	103830
INS18G3670RP	3'6"	7'0"	Rim Panic	Reversible	103829
INS18G4070RP	4'0"	7'0"	Rim Panic	Reversible	103828
<b>INSULATED CORE, 20 GAUGE</b>					
INS20G21068RP	2'10"	6'8"	Rim Panic	Reversible	103851
INS20G21070RP	2'10"	7'0"	Rim Panic	Reversible	103848
INS20G2868161	2'8"	6'8"	Knob/Lever	Reversible	103852
INS20G3068161	3'0"	6'8"	Knob/Lever	Reversible	103849
INS20G3068RP	3'0"	6'8"	Rim Panic	Reversible	103850
INS20G3070161LH	3'0"	7'0"	Knob/Lever	Left	103846
INS20G3070161RH	3'0"	7'0"	Knob/Lever	Right	103845
INS20G3070RP	3'0"	7'0"	Rim Panic	Reversible	103847

D

### ASTRAGALS & LITE KIT ACCESSORIES

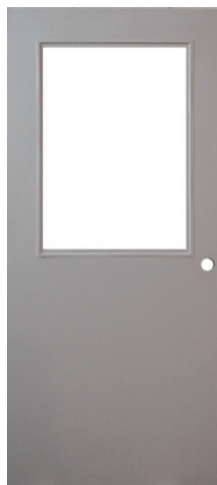

HOLLOW METAL DOOR WITH INSTALLED LITE KIT

MFG #	DESCRIPTION	SIZE	EZ #
<b>ASTRAGALS</b>			
ZASTRAGAL70	Blank Astragal	7'0"	083792
ZASTRAGALASA68	ASA Astragal	6'8"	082367
ZASTRAGALASA68FBOLT	ASA Astragal With Flush Bolt	6'8"	082981
ZASTRAGALASA70LH	ASA Astragal LH	7'0"	082368
ZASTRAGALASA70LHFBOLT	ASA Astragal With Flush Bolt LH	7'0"	082369
ZASTRAGALASA70RH	ASA Astragal RH	7'0"	082670
ZASTRAGALASA70RHBOLT	ASA Astragal With Flush Bolt RH	7'0"	082982
<b>LITE KIT ACCESSORIES</b>			
NLT6H	Door Lite Snap-In Horizontal Track	6-1/4"	082359
NLT21V	Door Lite Snap-In Vertical Track	21"	082360
NLT24H	Door Lite Snap-In Horizontal Track	24-1/4"	082361
NLT25V	Door Lite Snap-In Vertical Track	25-1/4"	082363
NLT32V	Door Lite Snap-In Vertical Track	32-3/4"	082364
NLT36V	Door Lite Snap-In Vertical Track	36-3/4"	082362
THERMAL LITE KIT10'	Thermal Lite Kit Track	10'	083386

# DOORS & ACCESSORIES

## WOOD DOOR & ACCESSORIES

### WOOD DOORS

ALL WOOD DOORS ARE UNDERSIZED 1/4" IN WIDTH AND 7/8" IN HEIGHT



**HARDBOARD**



**BIRCH**

MFG #	FACE	WIDTH	HEIGHT	EZ #
<b>SLAB, PARTICLE BOARD CORE</b>				
8100BIRCH PT GR SLAB	Paint Grade Birch	3'0"	7'0"	083551
8100HARDBOARD21068	Hardboard	2'10"	6'8"	083547
8100HARDBOARD21070	Hardboard	2'10"	7'0"	083548
8100HARDBOARD2668	Hardboard	2'6"	6'8"	083545
8100HARDBOARD2670	Hardboard	2'6"	7'0"	083546
8100HARDBOARD2868	Hardboard	2'8"	6'8"	082382
8100HARDBOARD2870	Hardboard	2'8"	7'0"	082381
8100HARDBOARD3670	Hardboard	3'6"	7'0"	090078
8100HARDBOARD4070	Hardboard	4'0"	7'0"	090781
8100PGB3068SLAB	Paint Grade Birch	3'0"	6'8"	086905
8100SCHB3070FB	Hardboard	3'0"	7'0"	083706
<b>SLAB, PARTICLE BOARD CORE, 20 MINUTE FIRE RATING</b>				
8100HARDBOARD3070	Hardboard	3'0"	7'0"	083550
8120 6P20MIN3068	6 Panel	3'0"	6'8"	083707
8100HARDBOARD3068	Hardboard	3'0"	6'8"	083549
8100HDBD3070LH161	Hardboard	3'0"	7'0"	086903
8100HDBD3070RH161	Hardboard	3'0"	7'0"	086904

### WOOD DOOR ACCESSORIES

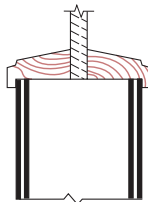

MFG #	DESCRIPTION	SIZE	EZ #
BIRCH MOULDING	Birch Trim Moulding	1'	082385
LITE KIT 6X20	Birch Wood Mould Lite Kit	6" x 20"	083651
LITE KIT 24X32	Birch Wood Mould Lite Kit	24" x 32"	083652
LITE KIT 24X36	Birch Wood Mould Lite Kit	24" x 36"	083653
LITE KIT 24X64	Birch Wood Mould Lite Kit	24" x 64"	083654

### DOOR HANDING CHART

• INDICATES LOCK SIDE

#### THINGS TO CONSIDER:

- Is the opening fire rated?
- Is the door insulated?
- Do you need weatherstrip or a threshold?
- Do you need a window in the door?
- Is the frame welded or knock down?
- What is the wall thickness?

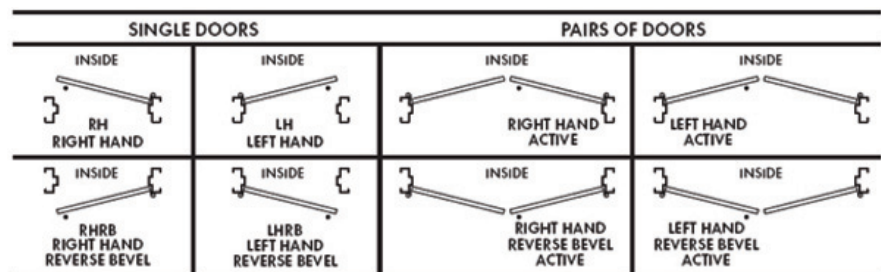

# DOORS & ACCESSORIES

## DOOR ACCESSORIES & FASTENERS

### ANCHORS & SHIMS

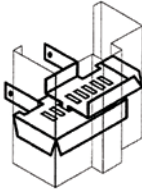

METAL OR WOOD STUD ANCHOR

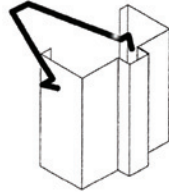

WIRE ANCHORS

#### METAL OR WOOD STUD ANCHOR

- 2 piece style

#### WIRE ANCHORS

- For new block construction

MFG #	DESCRIPTION	EZ #
<b>ANCHORS</b>		
MMT129	Drywall Anchor	082612
MMT129A	Large Drywall Anchor	082613
MMT130	Masonry Wire Anchors	082615
<b>SHIMS</b>		
MMT132	Large Hinge Shim	082617
MMT133	Small Hinge Shim	082618

D

### DOOR SILENCER FOR HOLLOW METAL DOORS



- Door silencers for use with 9/32" silencer holes
- Use 3 for single door opening located in strike jamb, and 2 for double door openings located in head
- For door thickness: 1-3/4"

MFG #	DESCRIPTION	EZ #
8050800	1-3/4" Door Silencer/Bumpers	082212

### GLASS & GLASS ACCESSORIES



MFG #	DESCRIPTION	EZ #
<b>GEORGIAN POLISHED WIRE GLASS</b>		
GLASS6X19.75GPW	6" X 19-3/4"	086448
GLASS24X31.5GPW	24" X 31-1/2"	086450
GLASS24X35.5GPW	24" X 35-1/2"	086451
<b>GLASS ACCESSORIES FOR METAL DOORS</b>		
GLASS TAPE PER FOOT	1/8" x 1' Butyl Glazing Tape	086452