

# 8,000 sq.ft. For Lease

## 26409 Northline Rd, Taylor, MI 48180



Listing ID: 30270445  
 Status: Active  
 Property Type: Industrial For Lease  
 Industrial Type: Industrial-Business Park, Manufacturing  
 Contiguous Space: 8,000 SF  
 Total Available: 8,000 SF  
 Lease Rate:  
 Lease Type: Modified Gross  
 Ceiling: 18 ft.  
 Office SF:  
 Drive-In Bays: 2 Bay



### Overview/Comments

8,000 sq.ft. of light industrial for lease at Taylor Trade Center 2. 26469 Northline Rd. Two grade level overhead doors, private entrance. Gross Lease available. Possible Build to suit office. We pay for building taxes, insurance, landscaping and snow removal. Call REA Construction at 734-946-8730 for a tour. Copy and paste this link for a virtual tour. <https://mls.ricohtours.com/d8983d3f-f3ac-4333-b976-56eedbdc503d>  
<http://www.rea-construction.net/>

Industrial Type:	Industrial-Business Park, Manufacturing, Light Industrial, Warehouse/Distribution	Gross Building Area:	78,000 SF
Zoning:	LIGHT INDUSTRIAL	Building/Unit Size (RSF):	8000SF
Building Name:	Taylor Trade Center 2	Usable Size (USF):	8000 SF
		Land Area:	3.53 Acres

### Available Space

Suite/Unit Number:	26469	Rent Escalators:	Fixed Lease
Space Available:	8,000 SF	Conference Rooms:	
Minimum Divisible:	4,000 SF	Offices:	
Maximum Contiguous:	8,000SF	Office SF:	
Space Type:	Relet	Parking Spaces:	16
Date Available:	01-01-2020	Drive In Bays:	2
Lease Rate:		Ceiling Height:	18
Lease Type:	Modified Gross	Clear Height:	16

Space Description 8,000 sq.ft. of light industrial for lease in Taylor Trade Center 2. Call Rea Construction at 734-946-8730 for a tour.

<http://www.rea-construction.net/>

Property Located Between: Beech Daly and Lang  
 194 Highway1 mile away  
 Detroit Metropolitan Airport

Tenancy:	Multiple Tenants	Construction/Siding:	Brick
Total Number of Buildings:	2	Parking Ratio:	2 per 1000 SF)
Number of Stories:	1	Parking Type:	Surface
Office Space SF:		Parking Description:	Asphalt
Property Condition:	Good	Total Parking Spaces:	16
Year Built:	1972	Column Spacing:	40
Roof Type:	Flat	Passenger Elevators:	0

Freight Elevators: 0  
Amps: 400  
Volts: 240  
X-Phase: 3

Heat Type: Natural Gas  
Heat Source: Space  
Lighting: T-8  
Internet Access: Cable

**Land Related**

Zoning Description: L 1  
Water Service: Municipal

Sewer Type: Municipal  
Legal Description: 60-077-99-0002-014 Parcel ID

**Location**

Address: 26469 Northline Rd, Taylor, MI 48180  
County: Wayne

MSA: Detroit-Warren-Dearborn  
Submarket: Airport District

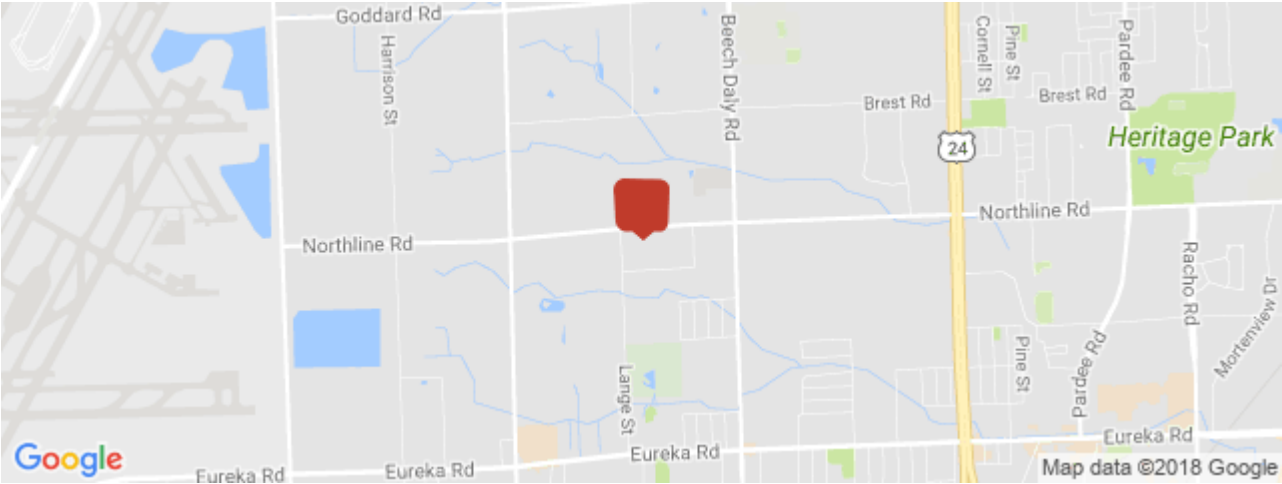

**Property Images**



taylor trade center 2



26469 Northline (11)

**26469 Northline Rd.**

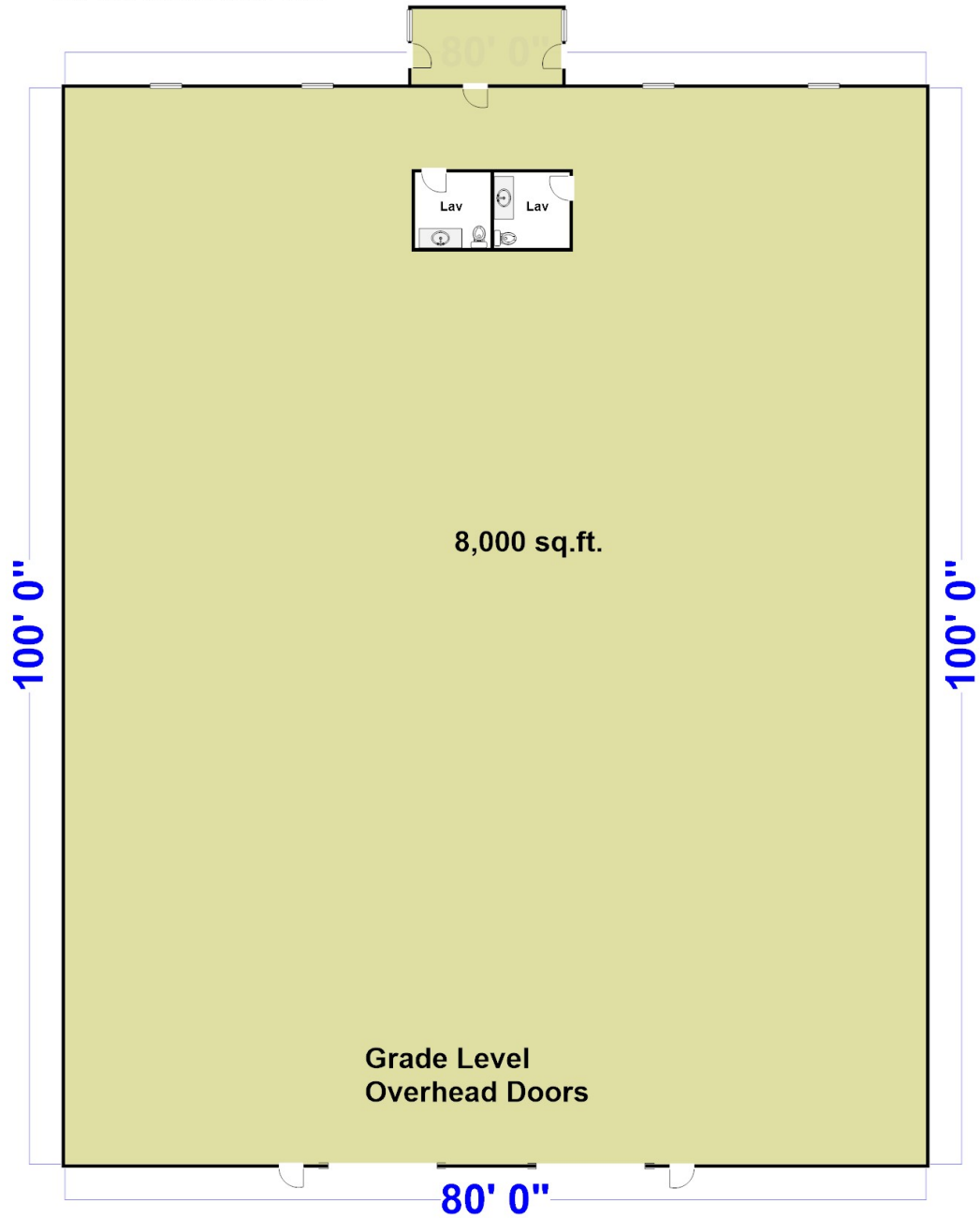

## Property Contacts

---



**Yvon Rea**

Rea Construction

734-946-8730 [0]