

STAINLESS
STEEL
KITCHENS

Installation Instructions Cabinets and Countertops



PLEASE READ FIRST

Handles are included with shipment, usually inside a cabinet in a box marked “Handles”. Please look for handles before packaging is thrown away.

Peel white paper (pvc) as the very last step in the process. It will protect cabinets from scratches, dust, spills, etc.

Cabinets are heavy; adequate care should be taken to properly support cabinets. Do not lift cabinets by doors.

Base cabinet installation:

Place cabinets in order shown on layout.
(provided with cabinet order).

Remove doors and drawers.

Level cabinets, either by shimming
(for standard cabinets) or by using leveling legs
(commercial style cabinets), with adjustable legs.

Clamp cabinets together side-by-side. (See Illustration 1)

Using screws provided, screw cabinet together
through pre-drilled holes in side of cabinet.
(Illustration 2)

Confirm cabinets are still level.
Adjust if necessary.

Replace doors and drawers. (See separate instructions for door installation and adjustment.) *Hint: For ease of peeling paper later, start a corner before re-installing.*

Peel paper (whitePVC).

Attach handles (handles and screws are included with shipment).

See “After installation guide” for final cleanup.

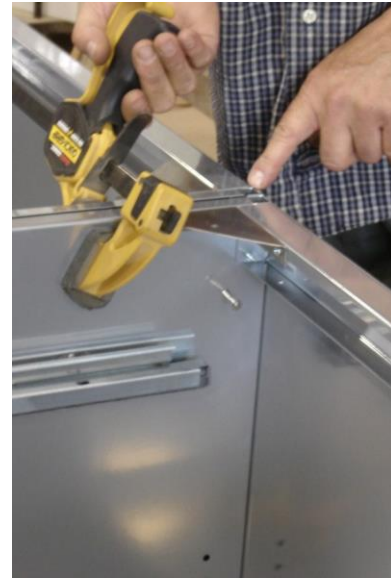

Illustration 1

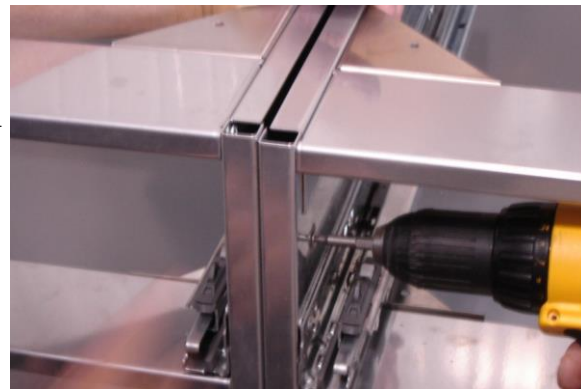

Illustration 2

Tools required: Screwdriver, clamps, drill, level.



Included with shipment: handles and screws, shelf pins/supports,
1 shelf per base cabinet, other items (if ordered).

Stainless Steel Kitchens PH: 574-272-2530 FX: 312-264-0221 Email: stainlesssteelkitchens@hotmail.com

Door Installation and Hinge Adjustments

Door installation

To install, place the hinge on the mounting plate and push the back of the hinge arm down with finger pressure. The "click" sound confirms a secure attachment.

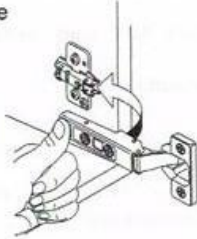

CLIP top BLUMOTION deactivation

For small or light doors, the BLUMOTION can be deactivated on one of the hinges. Door must be closed once for the deactivation to be complete. To reactivate, move switch back to the original position.

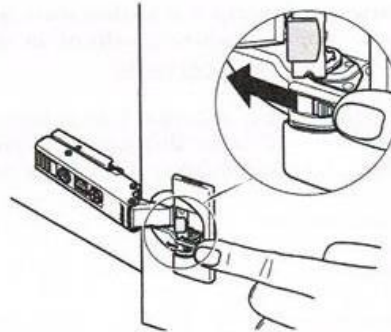

Door removal

Release the lever under the hinge arm to remove.

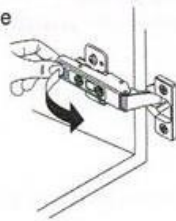

Side adjustment

Rotate the front screw to increase or decrease the door overlay (+/- 2 mm).

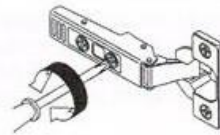
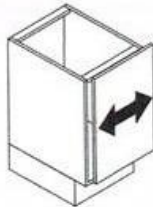

Depth adjustment

Rotate the rear spiral tech cam screw to adjust the door position (+ 3/- 2 mm).

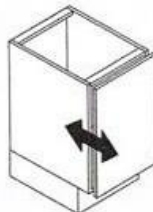

For CLIP hinges, loosen the rear screws on all hinges, adjust and retighten.

Height adjustment

Cam wing mounting plate

Rotate cam screw on the mounting plate to adjust door position (+/- 2 mm).

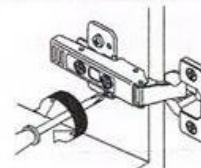
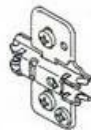

Drawer Installation and Adjustments

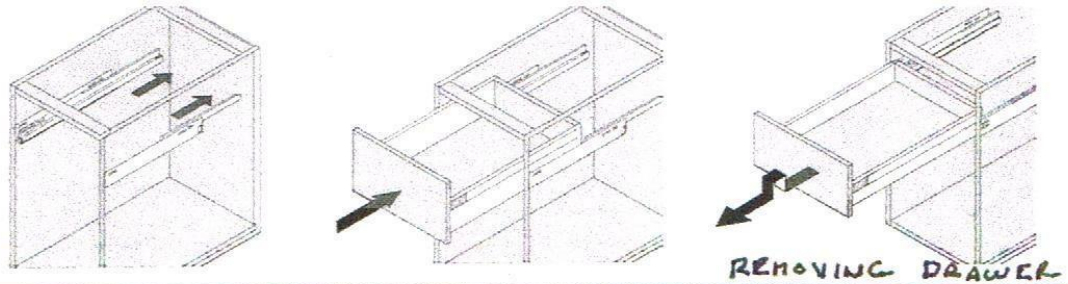

Verstellung / Adjustment / Réglage

Verstellung Seite / Side adjustment / Réglage latéral ± 1 mm

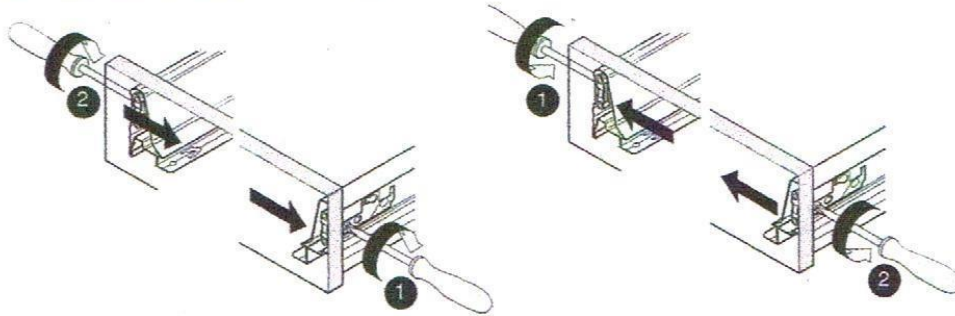

Verstellung Höhe / Height adjustment / Réglage en hauteur ± 2 mm

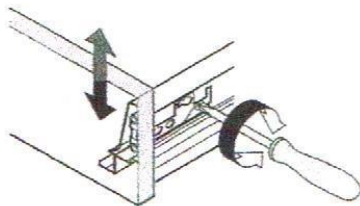

Verstellung Neigung / Tilt adjustment / Réglage de l'inclinaison

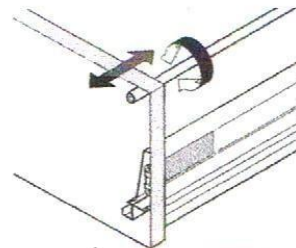

Countertop Installation (standard)

Level cabinets, using shims (standard cabinets) or adjustable leveling feet (commercial style on legs).

Place 5/8" thick marine plywood runners at intervals along length of countertop.

Place countertop on top of cabinets.

Level countertop; shim if needed.

From inside cabinet, screw runner into bottom of countertop. Use 5/8" screws maximum; **be careful not to run screw all the way to the stainless steel.** (Bumps in surface will appear if screws are too long.)

For countertops with overlapping sections, see separate sheet.



Tools required: Screwdriver, clamps, drill, level.

Included with shipment: Countertop only.

Upper cabinet installation

Establish level line at bottom of cabinet.
(Recommended method: attach 2 x 4 to wall as a horizontal level. Remove when cabinets are done).

Remove doors.

Screw cabinet sides together. (For Architectural Series, use holes located next to hinge plates.)

Shim cabinets to make level front to back.

Screw cabinet into wall, using holes

provided and 1-1/2" screws. For Architectural Series, if screw holes do not coincide with studs, use a titanium bit to drill holes into back of cabinet.

Note: Screw holes in back of Architectural Series cabinets are reinforced with 1- 1/2" diameter steel plate; it is recommended that the holes provided be used if at all possible.

Cabinets are heavy; take care to make sure adequate support is provided.

Peel paper (PVC)

Re-attach doors. (See attached information on how to adjust doors).

Hint: For ease of peeling paper later, start a corner before reinstalling.

Install handles, using hardware provided.

See "After installation guide" for final cleanup.



Illustration 3



Tools required: Screwdriver, clamps, drill, level, 2 x 4 for horizontal leveling.

Included with shipment: handles and screws, shelf pins/supports, 2 shelves per upper cabinet over 15" h, other items (if ordered).

Countertop with overlapping butt seam



Left side has tongue extending beyond edge of countertop. Right side has stainless steel overhang

Installation Instructions:

Place countertop section with tongue on top of cabinets. Put small amount of silicone on tongue and place other section of countertop (with overhang) on top of tongue. From inside the cabinet, use draw bolts to line up edges. Once edges are lined up, screw in leveling plates to fix countertop sections in place. All countertops are tested before shipment to assure a perfect fit.

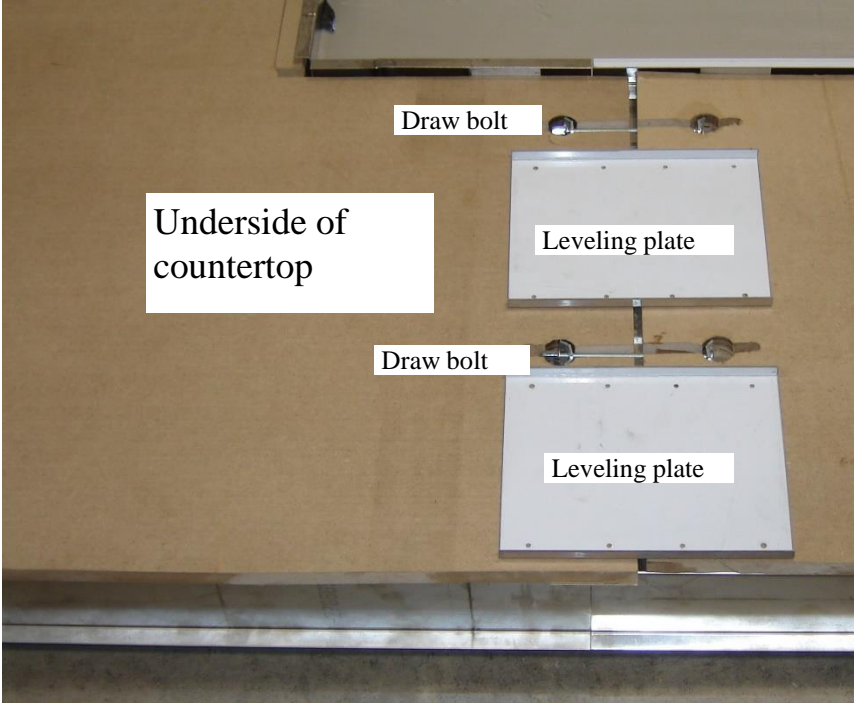

Underside of countertop

Draw bolt

Leveling plate

Draw bolt

Leveling plate

Shown above: underside of countertop, with leveling plates and inset drawbolts provided with countertop.

Tools required: wrench, silicone, 5/8" wood screws.



Remove doors and drawers for access to underside of countertop.



Use drawbolts and leveling plates to install top.



Stainless Steel Kitchens PH: 574-272-2530 FX: 574-383-5385

Email: stainlesssteelkitchens@hotmail.com

After Installation Guide

Do not remove plastic from cabinets or countertops until entire installation is finished.

1. Remove protective plastic covering from all stainless steel surfaces. Start by peeling the plastic material from the corners, then move toward middle.

Do not use knife or any other sharp or blunt object to remove plastic; this will cause scratches, gouges and scrapes on your new stainless steel surfaces.

2. Glue line from plastic covering may appear near bends. Remove with white vinegar and water solution. (See below)
3. Prepare a solution of 1 part water and 1 part white vinegar in a spray bottle. Wet down surface and gently rub with grain, using a green scotchbrite pad with holder.
4. Cleaning with water/vinegar solution on an ongoing basis is recommended. A simple non-abrasive cloth will work well. Microfiber cloths also work well.
5. Minor scratches can be removed by combining the water/vinegar solution and rubbing firmly along the grain with the green scotchbrite pad.

Stainless Steel Kitchens

PO Box 877

Mishawaka IN 46546

PH: 574-272-2530 FX: 574-383-5385

Email: stainlesssteelkitchens@hotmail.com