

Smoking Gun Plantation Worth & Turner County GA +-759 GIS Mapped Acres +-752.08 Taxed Acres

Legend

- Tracts
- Stands**
- <all other values>
- TractNum, Label**
- 1074, PLBstqw
- 1074, PLBst
- 1074, PLLpw
- 1074, Natural
- TractNum, Descrip**
- 1074, Lake
- 1074, Open
- Lines**
- ▶ 1074, Named Creek
- - - 1074, Woods Rd
- - - 1074, Drain
- Buildings

Notes:
 PLBstqw: Planted Lob, Sawtimber Class, Mostly groomed for Quail Hunting
 PLBst: Planted Lob, Sawtimber is present, mostly never thinned
 PLLpw: Planted Longleaf, Pulpwood Class, some CRP, never thinned
 Natural: Mature Natural Hardwood/Pine Mix. Some planted pines present. Mix of bottom, low, and some high ground.

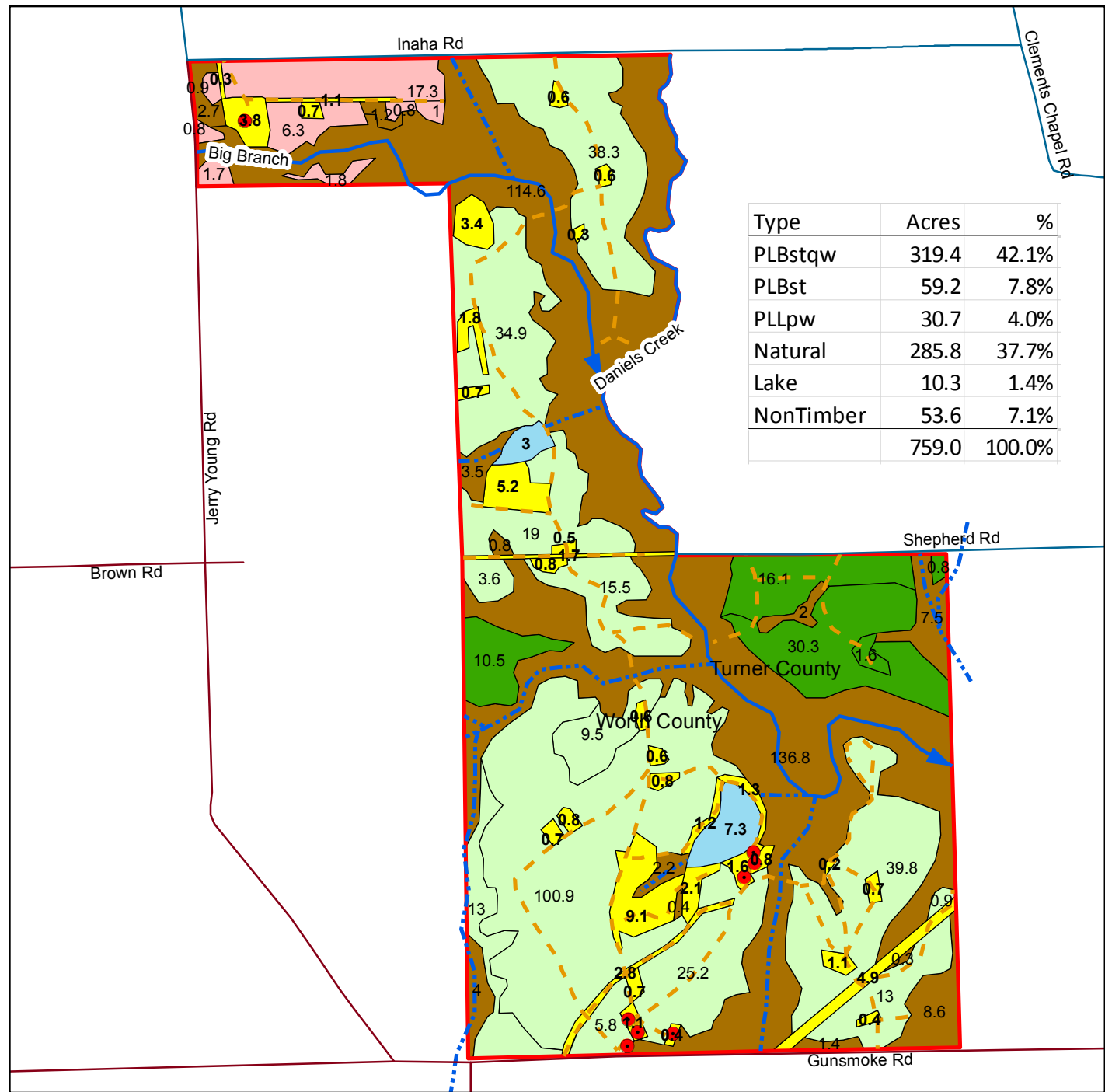

Type	Acres	%
PLBstqw	319.4	42.1%
PLBst	59.2	7.8%
PLLpw	30.7	4.0%
Natural	285.8	37.7%
Lake	10.3	1.4%
NonTimber	53.6	7.1%
	759.0	100.0%



www.matreforestry.com
 Albany, Georgia
 229-639-4973

Mapped by Mike Matre in ArcGIS.
 Map information is not guaranteed.

1:16,800
 1 in = 1,400 ft

1 inch equals 0.27 miles

0 330660 1,320 Feet

Date: 5/4/2016