

FINAL PLAT

CONTINENTAL MOUNTAIN ESTATES

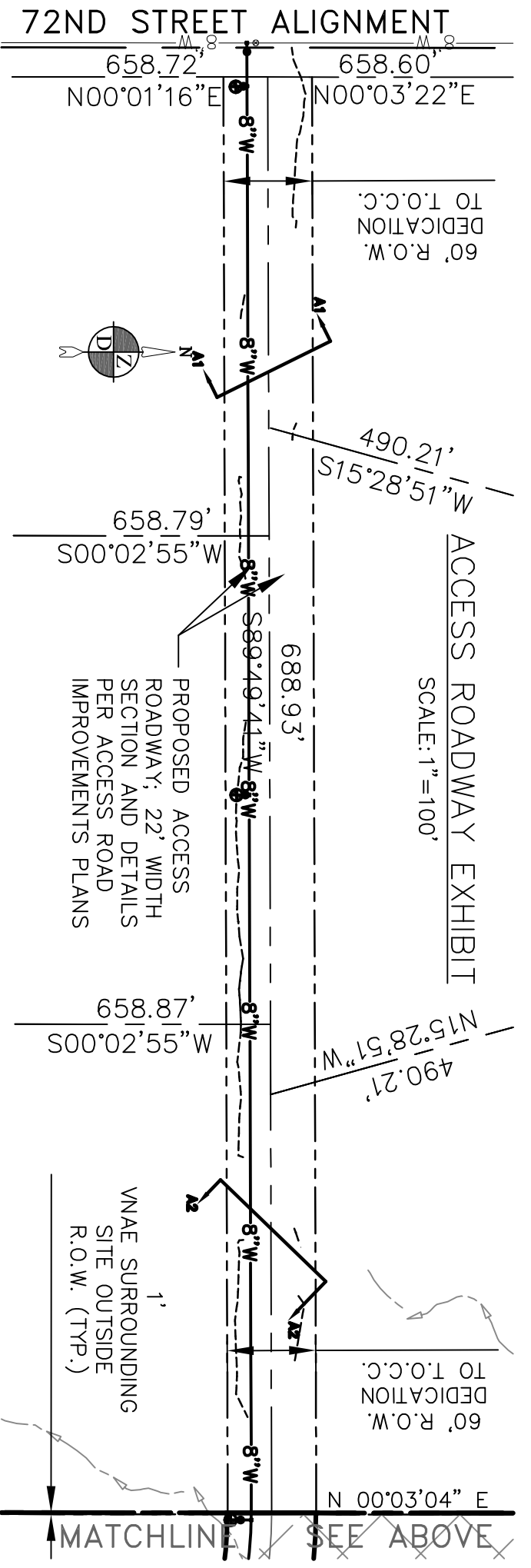

- NOTES:**
1. GRADING AND DRAINAGE AND OTHER IMPROVEMENTS DETAILS SHOWN ON IMPROVEMENT PLANS.
 2. DRAINAGE EASEMENT AND BUILDING ENVELOPE LINE AND CURVE DATA TABLE SHOWN ON SHEET C-5.
 3. VEGETATION NOT SHOWN FOR CLARITY PURPOSES.
 4. 12 NATIVE HABIT CORRIDOR AROUND EACH LOT NOT SHOWN FOR CLARITY PURPOSES.
 5. FLOOD PLAIN DELINEATION AND EROSION SETBACKS SHOWN ON SHEET C-4 FOR CLARITY PURPOSES.
 6. ALL ON LOT DISTURBANCE INCLUDING SEPTIC, UTILITIES AND ACCESS TO REMAIN WITHIN THE LIMITS OF THE DEVELOPMENT ENVELOPE.
 7. ALL LOT AREA OUTSIDE OF THE DEVELOPMENT ENVELOPE AND DRAINAGE EASEMENTS ARE TO BE DEDICATED AND REMAIN AS PERPETUAL UNDISTURBED NATURAL OPEN SPACE AREAS AND IS DEMED.
 8. EACH LOT WILL REQUIRE AN INDIVIDUAL GRADING AND DRAINAGE PLAN SEPARATE FROM THE PLAT AT THE TIME OF DEVELOPMENT.
 9. TRAIL EASEMENTS DEDICATED FOR EQUESTRIAN/REGISTRAR AND NON-MOTORIZED VEHICULAR ACCESS.
 10. CONSTRUCTION FENCE TO BE PLACED ALONG DEVELOPMENT ENVELOPE AT TIME OF CONSTRUCTION TO MINIMIZE DISTURBANCE.

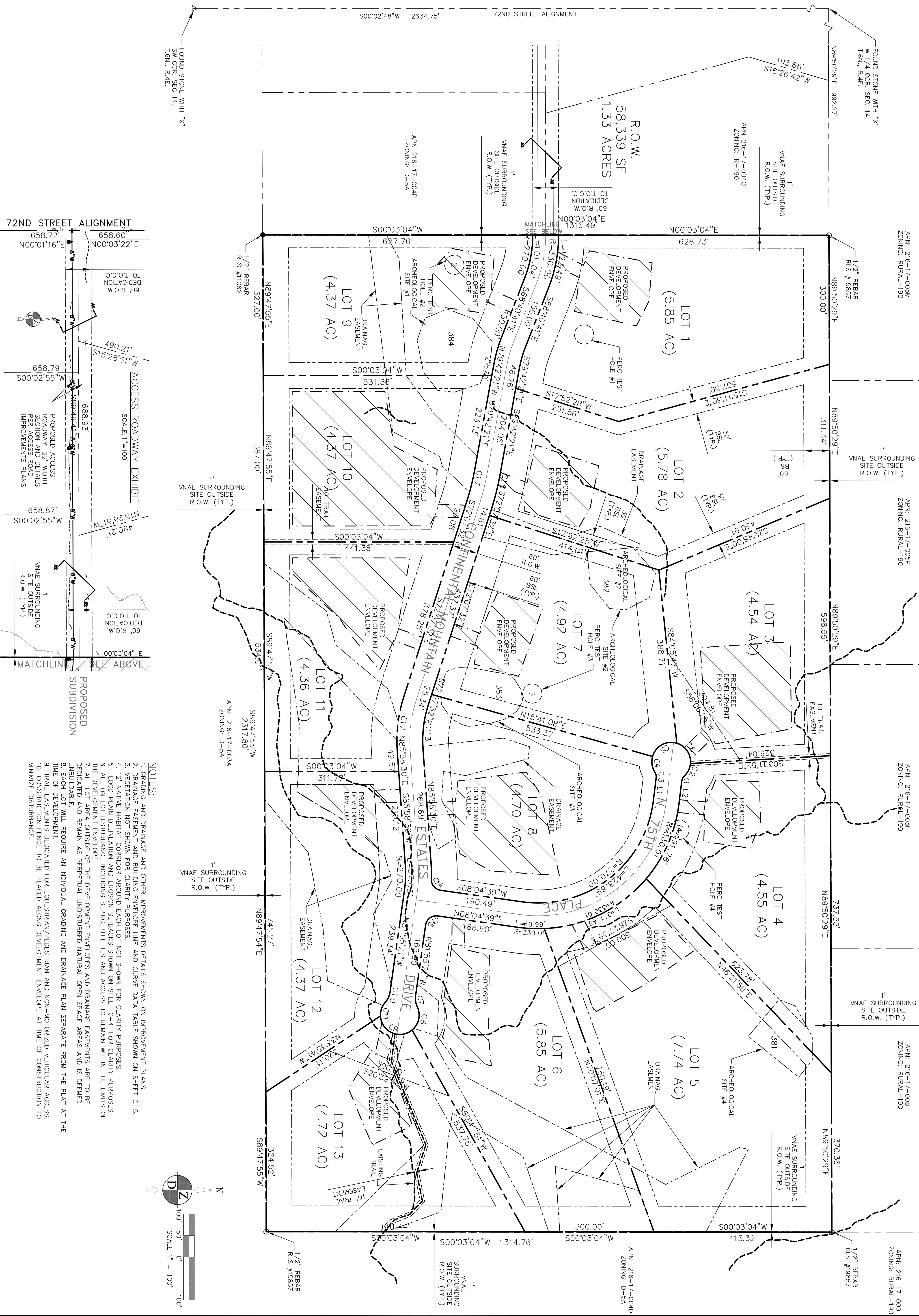
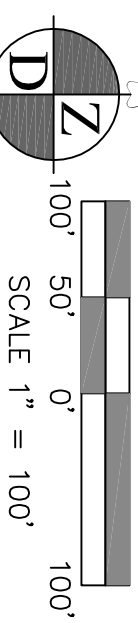

- NOTES**
1. TOPO COMPILED FROM AERIAL MAPPING. FLIGHT DATE MAY 12, 1998.
 2. BASIS OF BEARING, N 89°50'29"E ALONG THE NORTH LINE OF THE SOUTH HALF OF SECTION 14, T6N, R.4E.
 3. SURVEY BASED ON TITLE REPORT PREPARED BY FIRST AMERICAN TITLE INSURANCE COMPANY. COMMITMENT NO. 229-185-1133774, DATED MARCH 30, 1998 AT 7:30 AM.

CURVE TABLE

CURVE	LENGTH	BEARING	RADIUS
C1	13.86	20.00	20.00
C2	32.54	45.00	45.00
C3	13.86	20.00	20.00
C4	37.96	45.00	45.00
C5	71.61	45.00	45.00
C6	61.64	45.00	45.00
C7	26.36	45.00	45.00
C8	39.69	45.00	45.00
C9	99.73	45.00	45.00
C10	26.36	45.00	45.00
C11	34.66	45.00	45.00
C12	126.13	330.00	330.00
C13	103.20	270.00	270.00
C14	36.69	25.00	25.00
C15	39.27	25.00	25.00
C16	83.35	630.00	630.00
C17	75.41	570.00	570.00



09-02-05 TOWN OF CAVE CREEK APPROVAL
 REV DATE ISSUED FOR

JOB NO. 010215
 SCALE: 1"=100'
 DRAWN: D. NOE
 DESIGNER: F. TACK III
 CHECKER:

Firm Name and Address
 DZ Engineering, Inc.
 4648 E. Shea Blvd.
 Suite A-170
 Scottsdale, AZ 85254
 (602) 923-0272
 (602) 923-0474 fax

CIVIL ENGINEERS

Project Name and Address
 CONTINENTAL MOUNTAIN ESTATES
 A PORTION OF THE SOUTH HALF OF SECTION 14, T6N R4E OF THE G&SRB&M MARICOPA COUNTY, ARIZONA

FINAL PLAT

Sheet
C-2