

SEE ADDENDUM FOR ADDITIONAL/CORRECTED INFORMATION

Ohio Historic Preservation Office
1985 Verma Avenue
Columbus Ohio 43211
614 466-1500



OHIO HISTORIC INVENTORY

1. No. ERI-1505		4. Present Name(s) Crotser Residence		1. No. ERI-1525	
2. County Erie		5. Other Name(s) Frank Kelley Residence			2. County ERIE
3. Location of Negatives OHS					
6. Specific Location East side of Addison St., first north of Kelley Mansion		16. Thematic Category Manufactur., commerce		3. Present Name(s) CROTSEY RESIDENCE	
7. City or Town Kelleys Island		17. Date(s) or Period 1881			
8. Site Plan with North Arrow Woodford Rd.		18. Style or Design Vernacular with 2nd Empire elements		4. Present Name(s) CROTSEY RESIDENCE	
		19. Architect or Engineer			
9. U.T.M. Reference 17 357840 4605840		20. Contractor or Builder		5. Other Name(s) FRANK KELLEY RESIDENCE	
10. Site Building <input type="checkbox"/> Structure <input type="checkbox"/> Object <input type="checkbox"/>		21. Original Use, if apparent Residence			
11. On National Register? Yes <input type="checkbox"/> No <input checked="" type="checkbox"/>		22. Present Use Residence		6. Other Name(s) FRANK KELLEY RESIDENCE	
12. Is It Eligible? Yes <input checked="" type="checkbox"/> No <input type="checkbox"/>		23. Ownership Public <input type="checkbox"/> Private <input checked="" type="checkbox"/>			
13. Part of Estab. Hist. Dist.? Yes <input type="checkbox"/> No <input checked="" type="checkbox"/>		24. Owner's Name & Address, if known Jm. Crotser 19 Owaissa Dr. Timberlake, Oh 44099		7. Other Name(s) FRANK KELLEY RESIDENCE	
14. District Potent? Yes <input type="checkbox"/> No <input checked="" type="checkbox"/>		25. Open to Public? Yes <input type="checkbox"/> No <input checked="" type="checkbox"/>			
15. Name of Established District N/A		26. Local Contact Person or Organization Kevin Pape, K.I. Survey		8. Other Name(s) FRANK KELLEY RESIDENCE	
		27. Other Surveys in Which Included N/A			
42. Further Description of Important Features (Continue on reverse if necessary) A single brick chimney rises from the center of a pressed metal mansard roof. A front facing end pavilion projects above the roof line and is capped by a hipped gable roof. The hipped gable is pierced by a front facing wall dormer that also has a hipped roof. The dormer has a dentilated cornice and is capped by an ornamental central finial. Its window is a		28. No. of Stories 2 1/2		9. Other Name(s) FRANK KELLEY RESIDENCE	
		29. Basement? Yes <input checked="" type="checkbox"/> No <input type="checkbox"/>			
		30. Foundation Material limestone block		10. Other Name(s) FRANK KELLEY RESIDENCE	
		31. Wall Construction			
		32. Roof Type & Material mansard/pressed ti		11. Other Name(s) FRANK KELLEY RESIDENCE	
		33. No. of Bays Front 4 Side 3			
		34. Wall Treatment STUCCO		12. Other Name(s) FRANK KELLEY RESIDENCE	
		35. Plan Shape rectangular			
		36. Changes (Explain in #2) Addition <input checked="" type="checkbox"/> Altered <input checked="" type="checkbox"/> Moved <input type="checkbox"/>		13. Other Name(s) FRANK KELLEY RESIDENCE	
		37. Condition Interior good Exterior good			
		38. Preservation Underway? Yes <input checked="" type="checkbox"/> No <input type="checkbox"/>		14. Other Name(s) FRANK KELLEY RESIDENCE	
		39. Endangered? By What? Yes <input type="checkbox"/> No <input checked="" type="checkbox"/>			
		40. Visible from Public Road? Yes <input checked="" type="checkbox"/> No <input type="checkbox"/>		15. Other Name(s) FRANK KELLEY RESIDENCE	
		41. Distance from and Frontage on Road .56ac 70ft/140ft			
43. History and Significance This house was built for Frank Kelley, son of Addison, in 1881. He and his wife lived here until Addison died, they then moved to Addison mansion and Frank's sister-in-law, Angeline (widow of brother Fredrick), lived here. Frank Kelley was Superintendent of the Kelleys Island Wine Co. in 1887. circa 1926, the house was owned by the family of Frank and Stella Lange. Frank				16. Other Name(s) FRANK KELLEY RESIDENCE	
44. Description of Environment and Outbuildings This unique building sits in a mowed lot that borders the northern edge of the Addison Kelley Estate. A sidewalk leads from the front porch to the street. A gable roofed, board and batten carriage house (now garage) sits in the northeast corner of the lot. It has a corrugated metal					
15. Sources of Information Observation Frank Hamilton and Jeanette Cleary, Kelley descendants		46. Prepared by B. Pape & J. Campbell		17. Other Name(s) FRANK KELLEY RESIDENCE	
		47. Organization K.I. Flann. Comm.			
		48. Date 8/85		18. Other Name(s) FRANK KELLEY RESIDENCE	
		49. Revision Date(s)			

50. House Type No.

Code No. Name

51. Historic Outbuildings and Dependencies

Barn Type(s)

Code No. Type

Corn Crib or Shed Smoke House Privy
 Silo Spring House Carriage House
 Summer Kitchen or Ice House

Other _____

52. Archaeological Site on Property?

Yes
No

Basis for Information

Owner Collection
 Above Ground Earthworks or Mound
 Cultural Materials Noted

QAI No. _____

53. Farmstead Plan

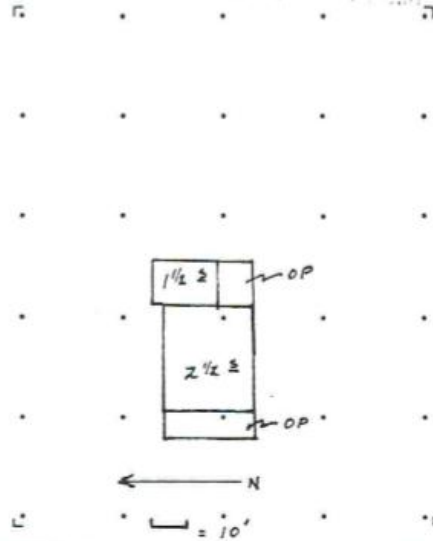

54. Photo

Roll No. 21

Picture No(s) 9&10

double hung, 1/1 light with a stone lug sill. wall dormers also pierce the mansard on the north and south sides of the house. The dormers are finished with ship-lap siding and have plain cornices. Their windows are double hung 1/1 and 2/1 light on the south and north sides respectively, sills on stone lug. Windows in the rest of the house are double hung 1/1 light and are positioned symmetrically across the first and second floors. In the front of the house, the end pavillion is pierced by two windows each on the first and second floors while the opposite end of the wall contains a doorway with transom light on the first floor and two 3/4 size windows to balance the second floor. An open porch projects out from the front of the house. Its hipped roof is supported by round columns placed atop coursed limestone block pillars. In the rear of the house is a 1 1/2 story wing. A brick chimney rises from the east end of a tarpapered gable roof. The frame structure is finished with clapboard siding and end boards. A small porch juts off the rear of the wing. A mansard roofed porch extends out from the east wall of the main block and protects the rear entrance. Additions and alterations include some replacement windows, the front porch, and the frame wing in the rear.

#43 (cont'd) worked as a clerk in the office of the Kelleys Island Lime and Transport Co. After the quarry closed he went into partnership with Walter Brown to operate Lange and Brown General Store which they bought from John Reinheimer. Walter's sons, Howard and Clifford, succeeded their father at the store.

#44 (cont'd) roof and a barn style double sliding door. windows include a double hung 6/6 light, a single hung 6 light, and a single hung 3 light.