



4500 WEST CORTLAND STREET
CHICAGO, ILLINOIS 60639

MIDSIZE 3/4" FILTERS: 1022-8 & 1022-10

Bowl	Max Pressure	Temperature Range
Metal W/Sight	250 PSI	40°F to 160°F

WARNING!: For Compressed Air Service only. Not to be used on life support or breathing air systems. Metal bowl sight glass is made of polycarbonate and will crack or rupture if exposed to any chemicals, such as synthetic oils, that are unsuitable for use with polycarbonate.

INSTALLATION: Install Filter units so the air flow is in the direction of the arrow on the head of the unit. The filter should be installed upstream of any regulators, and lubricators. The filter should also be placed as close as possible to the air tool, or apparatus being utilized.

WARNING!: Units are die cast aluminum, do not torque when installing. Also, pressurize unit slowly after installation of unit or new element to avoid damage to element.

MAINTENANCE AND OPERATION: When there is air flow, any foreign particles, and the separation of moisture, is automatic. There are no moving parts and no adjustments necessary. Any sludge and moisture that has collected, should be drained off. Sediment should not be allowed to reach the lower baffle. The Automatic Overnight Drain will automatically drain accumulated oil and moisture when line pressure falls below 5 PSIG. The Overnight Drain can also be operated manually by turning in a counter clockwise rotation.

The unit should be cleansed at regular intervals. Depressurize the system, unscrew the bowl and then unscrew the sintered bronze element from the head. Wash the element with a mild dishwasher detergent and rinse thoroughly to maintain the filtering efficiency. Make sure the element is completely dry before reassembling the unit (the filter element may be blown dry). Clean the filter bowls with soapy water only. Examine the O-ring, and replace it if damaged or distorted. When reassembling use care not to strip the threads on the bowl. After the bowl has been tightened completely, it may be necessary to line up sight glass for proper viewing by backing-off up to 180°.

FILTER INSTRUCTION SHEET

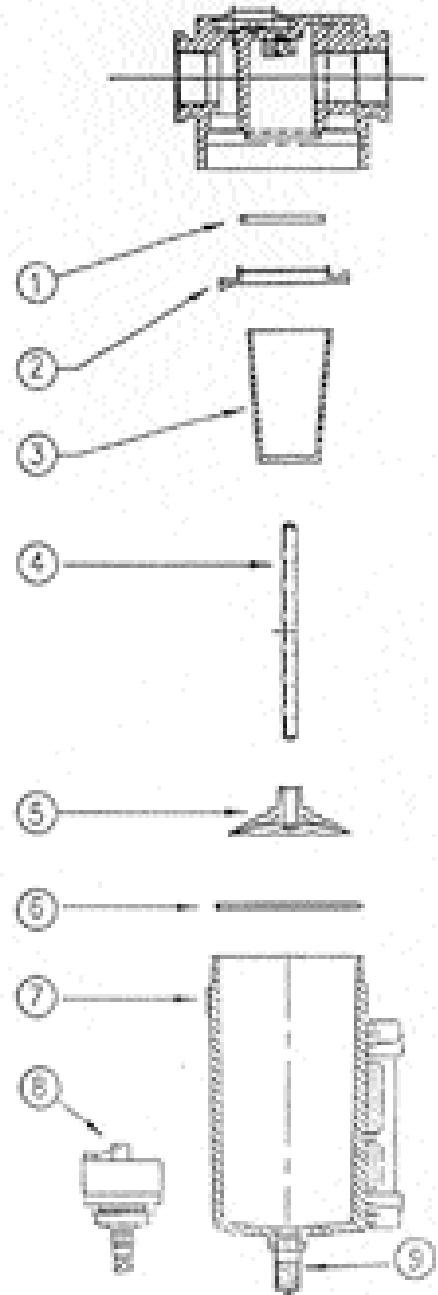

ITEM	DESCRIPTION	1022-8 KIT NO.	1022-10 KIT NO.	CONTENTS
3	Element Kit	1022-18	1022-20	40 Micron Sintered Bronze Element
		1022-28	1022-30	5 Micron Sintered Bronze Element
1,2,4,5	Repair Kit	1022-13	1022-14	Gasket, Vane Baffle, Threaded Rod, Lower Baffle
6,7,9	Bowl Kit	1022-11 10 oz.	1022-12 20 oz.	Metal Bowl w/Sight. Overnight Drain & O-ring.
Not Shown	Sight Kit Replacement	1022-2	1022-2	Sight Tube, Retainer (2) Indicator Ball, O-ring (4)
8	Auto Drain	1168	1168	Float Drain Assembly, Bowl, Insert, O-ring, Retainer Ring
6	Bowl O-ring	1022-15	1022-15	O-ring
9	Overnight Drain	1120-16	1120-16	Overnight Drain for Metal Bowl