

35th ANNUAL

SALMON RUINS ARTS & CRAFTS FAIR

SATURDAY, DECEMBER 7, 2024

@McGee Park 17 Road 5500, Farmington, NM

BOOTH APPLICATION and RULES

1. The San Juan County Museum Association (SJCMA) will act only as the event promoter, not as artist agents. As promoter, the SJCMA may use any artist's name or photographs for promotional purposes.
2. All sales/proceeds will go directly to the artists. No commissions will be charged.
3. All exhibitors will be responsible for any state or federal tax liabilities.
4. The SJCMA will not be responsible for any injury, damage, or loss sustained during this event.
5. Limited spaces are available and are on a first-come first-served basis.
6. Vendors are asked to donate a small item for a raffle to stimulate attendance.
7. Promoters reserve the right to exclude any artist's work not conforming to the regulations.
- 8. ALL VENDORS MUST BRING THEIR OWN TABLES AND CHAIRS.**

NAME _____

ADDRESS _____

CITY, STATE, ZIP _____

PHONE _____ EMAIL _____

TYPE OF WORK MADE: _____ SPACE(S)# _____

I have read and agree to abide by the regulations set forth and have enclosed the proper booth fee.

SIGNATURE: _____ DATE: _____

**BOOTH FEE IS \$50.00 PER BOOTH AND
MUST BE PAID IN CASH OR MONEY ORDER (NO CHECKS, PLEASE).**

**MAKE PAYABLE TO: SALMON RUINS MUSEUM
RETURN APPLICATION TO: SALMON RUINS MUSEUM
P.O. BOX 125, BLOOMFIELD, NEW MEXICO, 87413**

APPLICATIONS WILL NOT BE ACCEPTED UNTIL September 3, 2024

Dear Vendors,

This will be our 35th year for the Salmon Ruins Holiday Arts & Crafts Fair and will be held at McGee Park as usual. This year the event will take place on **DECEMBER 7, 2024**. I will be taking applications **BEGINNING September 3, 2024**. The booth rental fee will be \$50 again this year for a 10x10 space and \$40 for 5x10. Just a few reminders for vendors:

1. VENDORS are responsible for anything needed for set up i.e. tables, chairs, etc. We do not have access to any of that in the building.
2. There will be NO refunds for no-shows. If something comes up before the show and a vendor contacts me, we will work something out.
3. The kitchen space is \$125.00, deposit is \$100.00.
4. Set up time is 7:00 am the morning of the show. NO ONE can set up the day before.
5. The show is over at 5:00pm. We ask that you stay in place, set up until at least 4:00. It doesn't look good to have big vacancies on the event's floor. If you cannot stay this late please do not submit an application. It has become a growing issue every year. People who leave early will not be invited back.
6. We ask that everyone donates a "small something" for our door prize drawings. Please bring it to the front desk and drop it off by 10am and let us know your space number.
7. ALL spaces are first come first served so if you have a specific space you want be prompt in turning in your application. No spaces will be reserved without payment!! **There will be no ability to change your space once it has been selected.**

If you have any questions feel free to give me, Brandi Amarilla, a call (505)632-2013. Thank you for your participation and cooperation in this event. I look forward to seeing everyone back this year!!

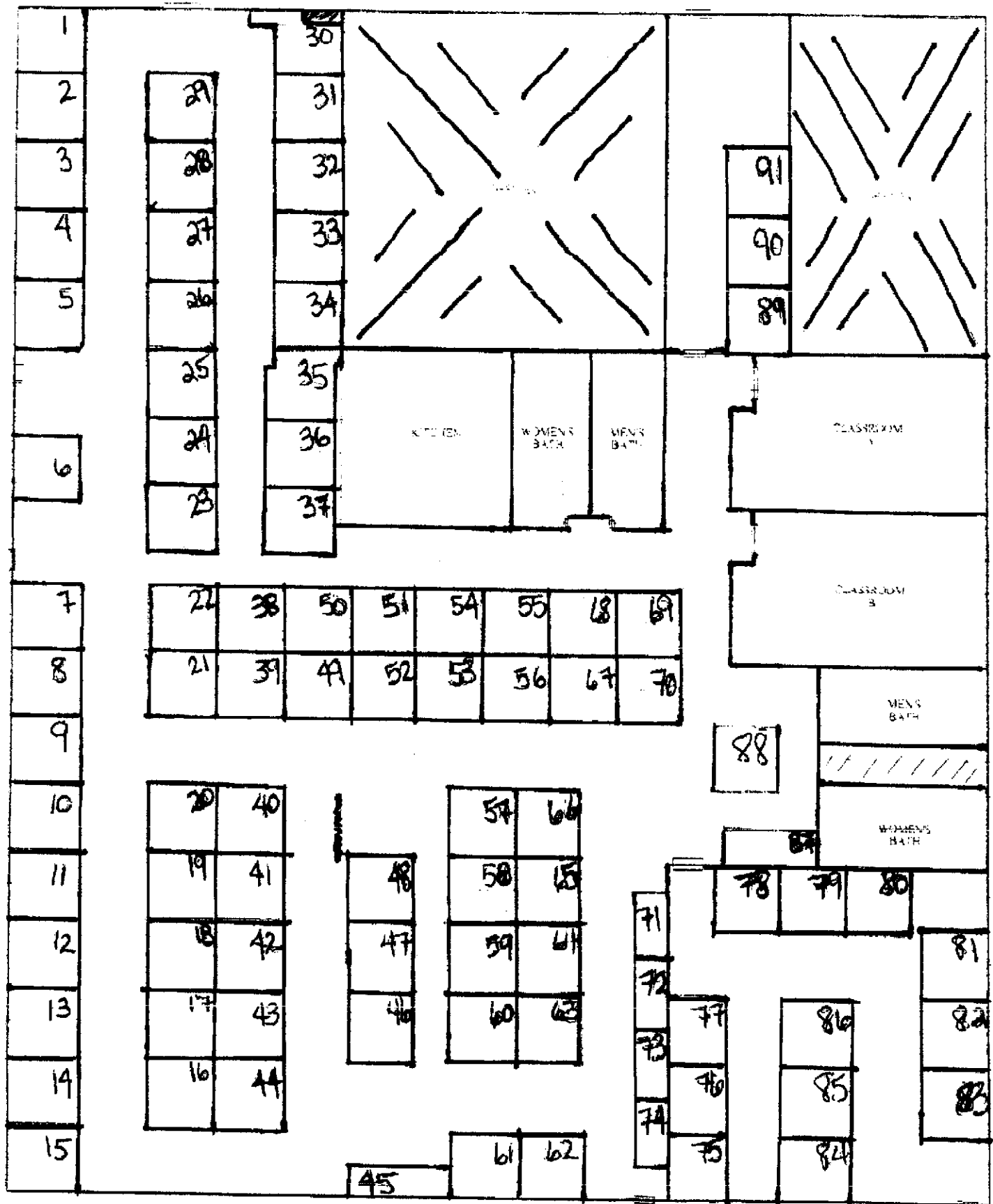

10x10 - \$50.-
 5x10 - \$40.-